

F.A.P. RTE.	SECTION	COUNTY	TOTAL SHEETS	SHEET NO.
326	(111CS) W&RS-21	GRUNDY	85	85-0
STA. TO STA.			FED. AID PROJECT	
FED. ROAD DIST. NO. ILLINOIS				



**The Subsurface Utility Engineering Company**  
449 Monroe Falls Road  
Tallmadge, OH 44278  
(330) 794-4455

### So-Deep Test Hole Certification Form

© So-Deep 1988, 1991

So-Deep, Corporate Office  
8397 Euclid Avenue  
Manassas Park, VA 20111  
(703)361-6005  
Control # **SLB433**  
Test Hole # **125**  
Plan Scale **1"=20'**  
Sheet # **4**  
Proposed **CURB & CUTTER**  
Date **JULY 10, 2000**

City, County, State **CITY OF MORRIS, IL**  
Gen. Loc. **DIVISION ST SOUTH OF BENTON ST**  
Recorded Size/Material/Type **2" STEEL (NICOR) GAS LINE**  
Foreman/Truck/Form By **J. CLINE / 219 / P. REYNOLDS**

Condition of paving prior to work  
**NO PAVING**

B.M. 1 Elev. = **528.70** Description: (BM #109) TOP OF SURVEY NAIL FOUND, @ STA. 28+19.8, DIVISION ST.  
is GIVEN  
B.M. 2 Elev. = **528.88** Description: (BM #104) CHIB "X" FOUND NE CAP BOLT OF F.H., 40' RT OF STA. 21+33.2, DIVISION ST.  
is GIVEN  
Benchmarks check BY **BM#**  
Elevations are referenced to **B.M.#2**

SO-DEEP will attempt to use the B.M.#1 most applicable to your design. If however, B.M.#1 differs by more than .05', resulting differences could cause design conflicts.

Recorded Size/Type of utility **WAS FOUND**

There **WERE** additional utilities in the test hole.

The utility **WAS** in good condition.

Paving Thickness and type **NO PAVING**

Color of ribbon installed **YELLOW**

Soil Type **MOIST SAND**

Field Condition **GRASS RW**

T.H. led to **PEG**

**2 3/4" WRAPPED STEEL (NICOR) GAS LINE @ D.E.**  
Size/Material/Type  
Portion of pipe exposed for O.D. measurement  
**FULL**

Remarks: **"ALSO FOUND BY TEST HOLE A 2" STEEL (DOT) TRAFFIC CONTROL CONDUIT RUNNING ABOVE & PARALLEL TO THE 2 3/4" GAS LINE.**

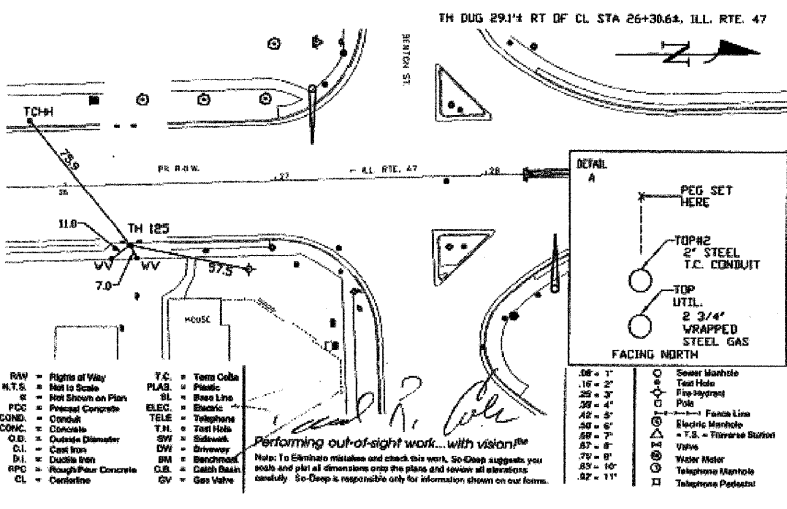
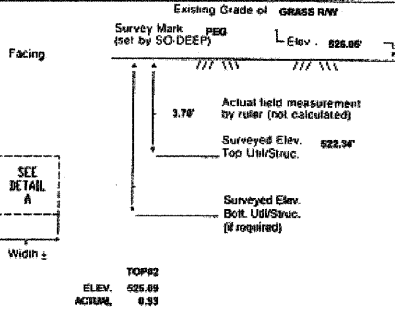

- |                              |                       |           |                              |
|------------------------------|-----------------------|-----------|------------------------------|
| R/W = Right of Way           | T.C. = Trench Cutback | 16" - 2"  | ○ = Sewer Manhole            |
| R.T.S. = Not to Scale        | PLAS. = Plastic       | 18" - 2"  | ○ = Test Hole                |
| ≡ = Not Shown on Plan        | BL. = Base Line       | 20" - 2"  | ○ = Fire Hydrant             |
| PCD = Precast Concrete       | ELEC. = Electric      | 24" - 2"  | ○ = Pole                     |
| CONC. = Concrete             | TELE. = Telephone     | 30" - 2"  | ○ = Pole                     |
| O.D. = Outside Diameter      | T.H. = Test Hole      | 36" - 2"  | ○ = Electric Manhole         |
| CL. = Cast Iron              | DW. = Driveway        | 42" - 2"  | ○ = T.S. = Telephone Station |
| DL. = Double Line            | DM. = Driveway        | 48" - 2"  | ○ = Valve                    |
| RFC = Rough/Precast Concrete | DM. = Driveway        | 54" - 2"  | ○ = Water Meter              |
| CL. = Centerline             | DM. = Driveway        | 60" - 2"  | ○ = Telephone Manhole        |
|                              | DM. = Driveway        | 66" - 2"  | ○ = Telephone Pedestal       |
|                              | DM. = Driveway        | 72" - 2"  |                              |
|                              | DM. = Driveway        | 78" - 2"  |                              |
|                              | DM. = Driveway        | 84" - 2"  |                              |
|                              | DM. = Driveway        | 90" - 2"  |                              |
|                              | DM. = Driveway        | 96" - 2"  |                              |
|                              | DM. = Driveway        | 102" - 2" |                              |

*Performing out-of-sight work... with vision!*  
Note: To eliminate mistakes and check this work, So-Deep suggests you look and jot all dimensions onto the plans and review all elevations carefully. So-Deep is responsible only for information shown on our forms.



### So-Deep Test Hole Certification Form

© So-Deep 1988, 1991

So-Deep, Corporate Office  
8397 Euclid Avenue  
Manassas Park, VA 20111  
(703)361-6005  
Control # **SLB433**  
Test Hole # **125**  
Plan Scale **1"=20'**  
Sheet # **4**  
Proposed **GRADE CHANGE**  
Date **JULY 10, 2000**

City, County, State **CITY OF MORRIS, IL**  
Gen. Loc. **DIVISION ST SOUTH OF BENTON ST**  
Recorded Size/Material/Type **8" UNK TYPE (C.O.M.) WATER LINE**  
Foreman/Truck/Form By **J. CLINE / 219 / P. REYNOLDS**

Condition of paving prior to work  
**CONC. SW IN GOOD CONDITION**

B.M. 1 Elev. = **528.70** Description: (BM #109) TOP OF SURVEY NAIL FOUND, @ STA. 28+19.8, DIVISION ST.  
is GIVEN  
B.M. 2 Elev. = **528.88** Description: (BM #104) CHIB "X" FOUND NE CAP BOLT OF F.H., 40' RT OF STA. 21+33.2, DIVISION ST.  
is GIVEN  
Benchmarks check BY **BM#**  
Elevations are referenced to **B.M.#2**

SO-DEEP will attempt to use the B.M.#1 most applicable to your design. If however, B.M.#1 differs by more than .05', resulting differences could cause design conflicts.

Recorded Size/Type of utility **WAS FOUND**

There **WERE NOT** additional utilities in the test hole.

The utility **WAS** in good condition.

Paving Thickness and type **4" CONCRETE**

Color of ribbon installed **BLUE**

Soil Type **MOIST SAND**

Field Condition **CONC. SW**

T.H. led to **CHIB "X"**

**3 3/4" D.I. (C.O.M.) WATER LINE**  
Size/Material/Type  
Portion of pipe exposed for O.D. measurement  
**FULL**

Remarks: **NONE**

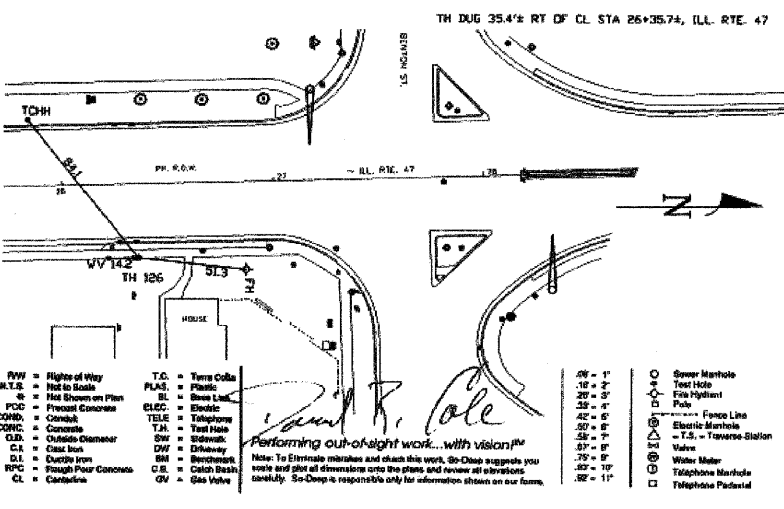
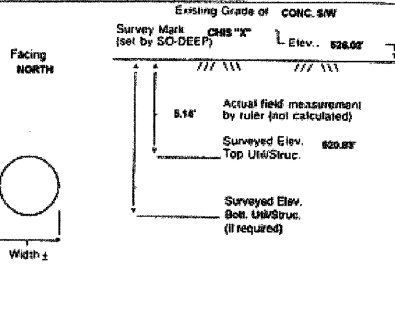

- |                              |                       |           |                              |
|------------------------------|-----------------------|-----------|------------------------------|
| R/W = Right of Way           | T.C. = Trench Cutback | 16" - 2"  | ○ = Sewer Manhole            |
| R.T.S. = Not to Scale        | PLAS. = Plastic       | 18" - 2"  | ○ = Test Hole                |
| ≡ = Not Shown on Plan        | BL. = Base Line       | 20" - 2"  | ○ = Fire Hydrant             |
| PCD = Precast Concrete       | ELEC. = Electric      | 24" - 2"  | ○ = Pole                     |
| CONC. = Concrete             | TELE. = Telephone     | 30" - 2"  | ○ = Pole                     |
| O.D. = Outside Diameter      | T.H. = Test Hole      | 36" - 2"  | ○ = Electric Manhole         |
| CL. = Cast Iron              | DW. = Driveway        | 42" - 2"  | ○ = T.S. = Telephone Station |
| DL. = Double Line            | DM. = Driveway        | 48" - 2"  | ○ = Valve                    |
| RFC = Rough/Precast Concrete | DM. = Driveway        | 54" - 2"  | ○ = Water Meter              |
| CL. = Centerline             | DM. = Driveway        | 60" - 2"  | ○ = Telephone Manhole        |
|                              | DM. = Driveway        | 66" - 2"  | ○ = Telephone Pedestal       |
|                              | DM. = Driveway        | 72" - 2"  |                              |
|                              | DM. = Driveway        | 78" - 2"  |                              |
|                              | DM. = Driveway        | 84" - 2"  |                              |
|                              | DM. = Driveway        | 90" - 2"  |                              |
|                              | DM. = Driveway        | 96" - 2"  |                              |
|                              | DM. = Driveway        | 102" - 2" |                              |

*Performing out-of-sight work... with vision!*  
Note: To eliminate mistakes and check this work, So-Deep suggests you look and jot all dimensions onto the plans and review all elevations carefully. So-Deep is responsible only for information shown on our forms.



### So-Deep Test Hole Certification Form

© So-Deep 1988, 1991

So-Deep, Corporate Office  
8397 Euclid Avenue  
Manassas Park, VA 20111  
(703)361-6005  
Control # **SLB433**  
Test Hole # **125**  
Plan Scale **1"=20'**  
Sheet # **3**  
Proposed **GRADE CHANGE**  
Date **JULY 10, 2000**

City, County, State **CITY OF MORRIS, IL**  
Gen. Loc. **DIVISION ST SOUTH OF CHAPIN ST**  
Recorded Size/Material/Type **3-WAY UNK. TYPE (AT&T) TELE. DUCT**  
Foreman/Truck/Form By **J. CLINE / 219 / P. REYNOLDS**

Condition of paving prior to work  
**NO PAVING**

B.M. 1 Elev. = **529.70** Description: (BM #108) TOP OF SURVEY NAIL FOUND, @ STA. 28+19.8, DIVISION ST.  
is GIVEN  
B.M. 2 Elev. = **528.88** Description: (BM #104) CHIB "X" FOUND NE CAP BOLT OF F.H., 40' RT OF STA. 21+33.2, DIVISION ST.  
is GIVEN  
Benchmarks check BY **BM#**  
Elevations are referenced to **B.M.#2**

SO-DEEP will attempt to use the B.M.#1 most applicable to your design. If however, B.M.#1 differs by more than .05', resulting differences could cause design conflicts.

Recorded Size/Type of utility **WAS FOUND**

There **WERE** additional utilities in the test hole.

The utility **WAS** in good condition.

Paving Thickness and type **NO PAVING**

Color of ribbon installed **ORANGE**

Soil Type **MOIST SAND**

Field Condition **GRASS RW**

T.H. led to **PEG**

**3 3/4" P.L.A. (AT&T) TELE. CONDUITS 1.12"**  
Size/Material/Type  
Portion of pipe exposed for O.D. measurement  
**FULL**

Remarks: **"ALSO FOUND BY TEST HOLE A 1.12" PRE-CAST CONCRETE (AT&T) TELE. DUCT, (2) 4 1/2" TRANSITE (AT&T) TELE. CONDUITS, RR #4 WAS TAKEN ON THE NORTHERN MOST EDGE OF THE TELEPHONE VAULT. TELE. DUCT CONTAINS FIBER OPTICS AT THIS LOCATION.**

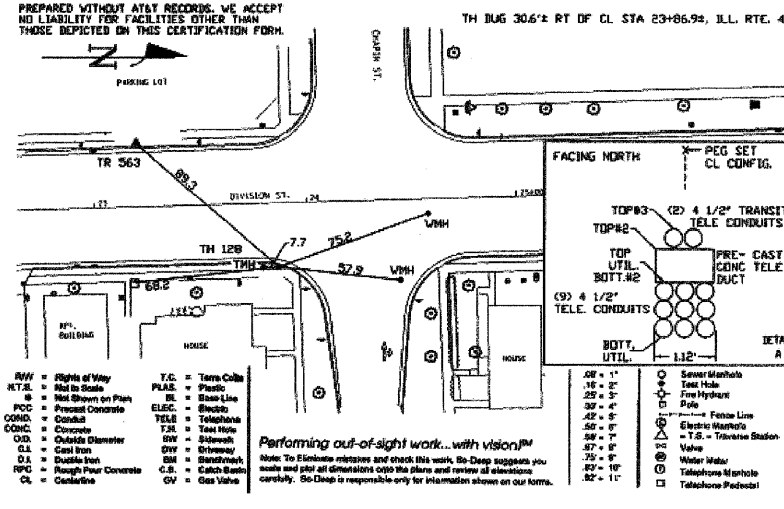
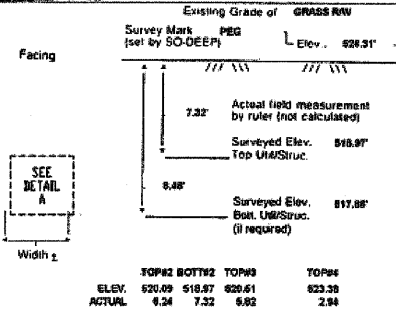

- |                              |                       |           |                              |
|------------------------------|-----------------------|-----------|------------------------------|
| R/W = Right of Way           | T.C. = Trench Cutback | 16" - 2"  | ○ = Sewer Manhole            |
| R.T.S. = Not to Scale        | PLAS. = Plastic       | 18" - 2"  | ○ = Test Hole                |
| ≡ = Not Shown on Plan        | BL. = Base Line       | 20" - 2"  | ○ = Fire Hydrant             |
| PCD = Precast Concrete       | ELEC. = Electric      | 24" - 2"  | ○ = Pole                     |
| CONC. = Concrete             | TELE. = Telephone     | 30" - 2"  | ○ = Pole                     |
| O.D. = Outside Diameter      | T.H. = Test Hole      | 36" - 2"  | ○ = Electric Manhole         |
| CL. = Cast Iron              | DW. = Driveway        | 42" - 2"  | ○ = T.S. = Telephone Station |
| DL. = Double Line            | DM. = Driveway        | 48" - 2"  | ○ = Valve                    |
| RFC = Rough/Precast Concrete | DM. = Driveway        | 54" - 2"  | ○ = Water Meter              |
| CL. = Centerline             | DM. = Driveway        | 60" - 2"  | ○ = Telephone Manhole        |
|                              | DM. = Driveway        | 66" - 2"  | ○ = Telephone Pedestal       |
|                              | DM. = Driveway        | 72" - 2"  |                              |
|                              | DM. = Driveway        | 78" - 2"  |                              |
|                              | DM. = Driveway        | 84" - 2"  |                              |
|                              | DM. = Driveway        | 90" - 2"  |                              |
|                              | DM. = Driveway        | 96" - 2"  |                              |
|                              | DM. = Driveway        | 102" - 2" |                              |

*Performing out-of-sight work... with vision!*  
Note: To eliminate mistakes and check this work, So-Deep suggests you look and jot all dimensions onto the plans and review all elevations carefully. So-Deep is responsible only for information shown on our forms.

REVISIONS	
NAME	DATE

ILLINOIS DEPARTMENT OF TRANSPORTATION

### SUBSURFACE UTILITY ENGINEERING TEST HOLES

SCALE: NONE  
DATE: 09/2007

DRAWN BY: KKH  
CHECKED BY: FML