

F.A. RTE.	SECTION	COUNTY	TOTAL SHEETS	SHEET NO.
326	(111CS)W&RS-2,1	GRUNDY	85	22
STA. 8+00		TO STA. 13+50		
FED. ROAD DIST. NO. ILLINOIS FED. AID PROJECT				

NOTES:  
 1. ALL STORM SEWER TO BE CLASS "A" UNLESS NOTED OTHERWISE.  
 2. RIM ELEVATIONS & OFFSETS FOR DRAINAGE STRUCTURES CONSTRUCTED IN CONJUNCTION WITH GUTTER OR CURB & GUTTER ARE CALLED OUT TO THE EDGE OF THE GUTTER PAN. ALL OTHER DRAINAGE STRUCTURES ARE CALLED OUT TO THE CENTER OF STRUCTURE.

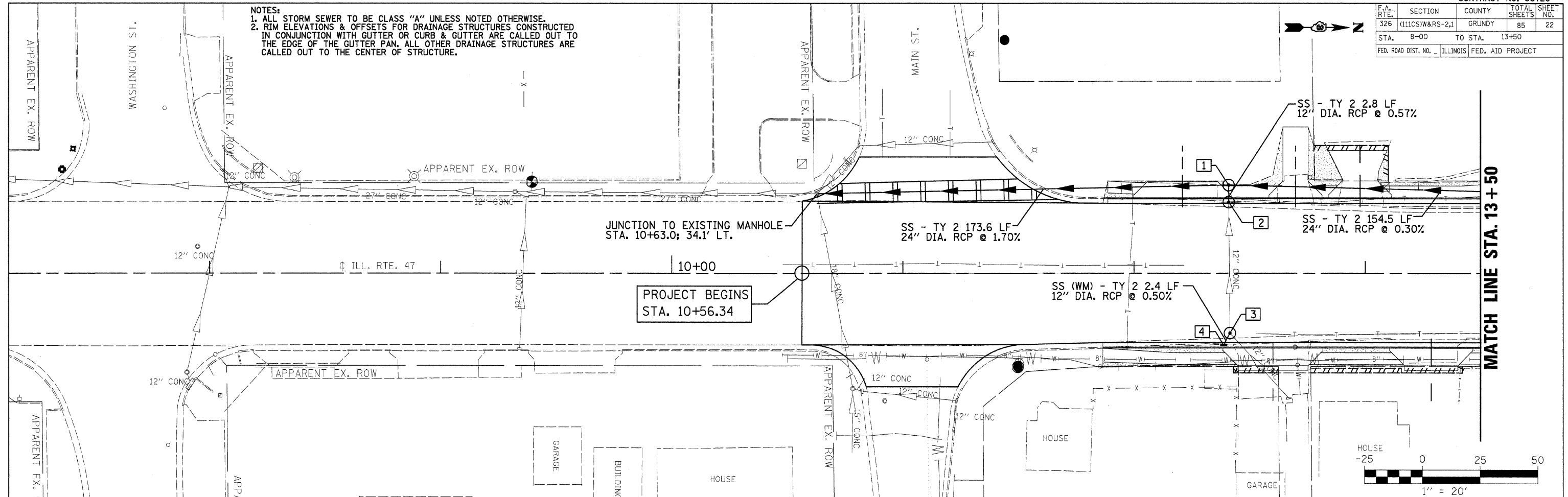

STRUCT NUMBER	STATION	OFFSET	RIM ELEV.	INVERT ELEV.	STRUCTURE TYPE	
535	1	12+41.0	37.9' LT.	520.50	515.90 N; 515.02 S; 515.76 E	MANHOLE TYPE A 5' DIA. W/ TYPE 1 FRAME CL
	2	12+41.0	30.1' LT.	520.07	515.80 E; 515.80 W	MANHOLE TYPE A 5' DIA. W/ TYPE 3 FRAME & GRATE
	3	12+41.5	25.8' RT.	520.13	516.02 W; 516.07 NE; 516.02 SE	MANHOLE TYPE A 5' DIA. W/ TYPE 1 FRAME CL
	4	12+38.8	29.9' RT.	520.07	516.05 NW	INLET TYPE A W/ TYPE 3 FRAME & GRATE
530						
525						
520						
515						
510						
505						
500						
495						

517.58	517.95	518.32	518.93	519.58	520.17	520.75	521.27	521.79	522.25	522.71
11+00	11+50	12+00	12+50	13+00	13+50					

IL ROUTE 47 - DRAINAGE & EROSION CONTROL PLANS

PLAN  
 SURVEYED  
 ALIGNED  
 CHECKED  
 DRAWN  
 DATE

PROFILE  
 SURVEYED  
 GRADES CHECKED  
 STRUCTURE NOTATIONS CHECKED  
 DATE

\*DATE-TIME\*  
 \*DGN-SPEC\*