

F.A. RTE.	SECTION	COUNTY	TOTAL SHEETS	SHEET NO.
326	(111CS)W&RS-2.1	GRUNDY	85	25
STA. 25+50		TO STA. 32+00		
FED. ROAD DIST. NO. ILLINOIS		FED. AID PROJECT		

NOTES:
 1. ALL STORM SEWER TO BE CLASS "A" UNLESS NOTED OTHERWISE.
 2. RIM ELEVATIONS & OFFSETS FOR DRAINAGE STRUCTURES CONSTRUCTED IN CONJUNCTION WITH GUTTER OR CURB & GUTTER ARE CALLED OUT TO THE EDGE OF THE GUTTER PAN. ALL OTHER DRAINAGE STRUCTURES ARE CALLED OUT TO THE CENTER OF STRUCTURE.

MATCH LINE STA. 25+50

PROJECT ENDS
STA. 31+10.00

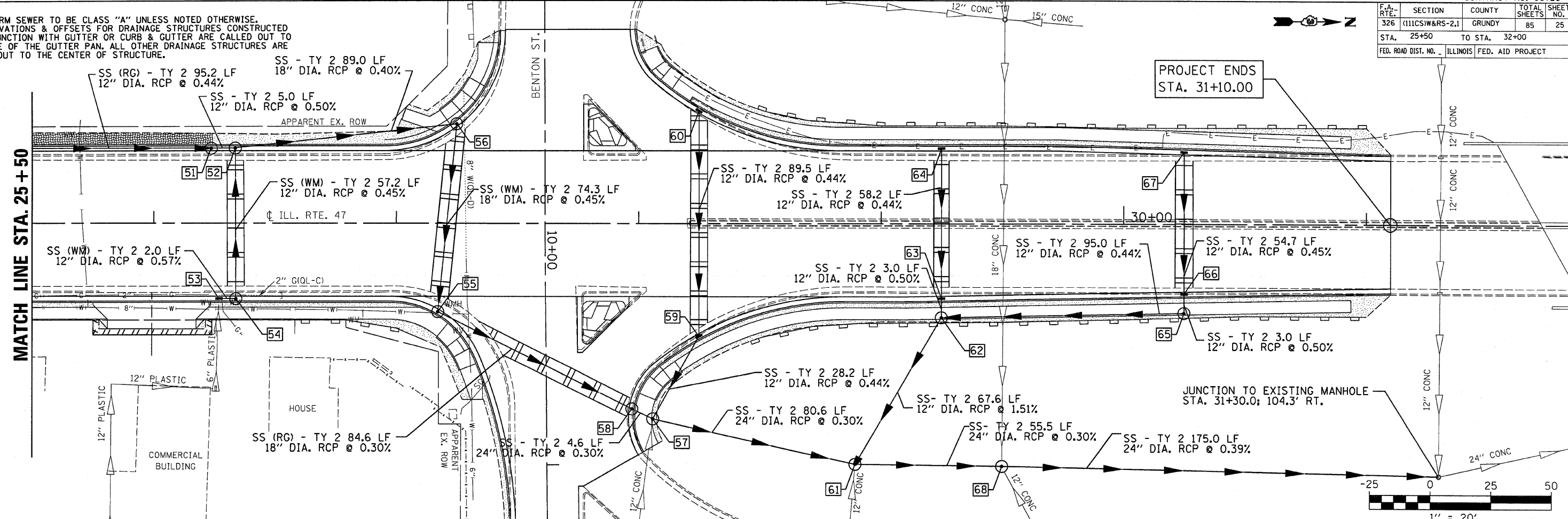

STRUCT NUMBER	STATION	OFFSET	RIM ELEV.		INVERT ELEV.		STRUCTURE TYPE	STRUCT NUMBER	STATION	OFFSET	RIM ELEV.		INVERT ELEV.		STRUCTURE TYPE
			N	S	N	S					N	S	N	S	
550	51	26+23.6	30.0' LT.	525.57	521.73 N; 521.73 S		MANHOLE TYPE A 5' DIA. W/ TYPE 3 FRAME & GRATE	65	30+24.9	36.7' RT.	539.17	531.52 S; 535.57 W		MANHOLE TYPE A 5' DIA. W/ TYPE 1 FRAME CL	
	52	26+33.6	30.0' LT.	525.57	521.68 S; 521.68 E; 521.60 N		MANHOLE TYPE A 5' DIA. W/ TYPE 3 FRAME & GRATE	66	30+25.0	27.7' RT.	538.87	535.61 E; 535.61 W		INLET TYPE B W/ TYPE 3 FRAME & GRATE	
	53	26+26.9	30.0' RT.	525.57	522.04 N		INLET TYPE A W/ TYPE 3 FRAME & GRATE	67	30+25.0	28.5' LT.	538.87	535.87 E		INLET TYPE A W/ TYPE 3 FRAME & GRATE	
	54	26+34.0	30.0' RT.	525.57	521.94 W; 522.02 S		MANHOLE TYPE A 4' DIA. W/ TYPE 3 FRAME & GRATE	68	29+49.9	100.4' RT.	524.40	514.30 N; 515.30 S; 518.43 E; 514.30 W		MANHOLE TYPE A 5' DIA. W/ TYPE 1 FRAME CL	
545	55	27+17.1	35.4' RT.	526.31	520.83 W; 520.75 NE		MANHOLE TYPE A 5' DIA. W/ TYPE 3 FRAME & GRATE								
	56	27+25.0	40.3' LT.	526.25	521.24 S; 521.16 E		MANHOLE TYPE A 5' DIA. W/ TYPE 3 FRAME & GRATE								
540	57	28+05.9	80.8' RT.	526.60	518.76 E; 518.76 NE; 518.76 SW; 523.64 NW		MANHOLE TYPE A 5' DIA. W/ TYPE 1 FRAME CL								
	58	27+97.2	76.1' RT.	524.99	518.79 NE; 520.50 SW		MANHOLE TYPE A 5' DIA. W/ TYPE 3 FRAME & GRATE								
	59	28+25.0	45.4' RT.	528.63	524.80 W; 523.80 SE		INLET TYPE B W/ TYPE 3 FRAME & GRATE								
	60	28+25.0	45.4' LT.	528.58	525.21 E		INLET TYPE A W/ TYPE 3 FRAME & GRATE								
535	61	28+89.4	99.6' RT.	524.93	515.48 N; 518.95 E; 518.50 SW; 520.43 NW		MANHOLE TYPE A 5' DIA. W/ TYPE 1 FRAME CL								
	62	29+24.9	38.7' RT.	534.34	531.08 N; 530.77 W; 521.50 SE		MANHOLE TYPE A 5' DIA. W/ TYPE 1 FRAME CL								
530	63	29+25.0	29.7' RT.	534.07	530.81 E; 530.81 W		INLET TYPE B W/ TYPE 3 FRAME & GRATE								
	64	29+25.0	30.1' LT.	534.07	531.08 E		INLET TYPE A W/ TYPE 3 FRAME & GRATE								
525	51				SS - TY 2 95.2 LF 12" DIA. RCP @ 0.44%			57							
	52				SS - TY 2 5.0 LF 12" DIA. RCP @ 0.50%			58							
520	55				SS - TY 2 57.2 LF 12" DIA. RCP @ 0.45%			61							
	56				SS - TY 2 89.0 LF 18" DIA. RCP @ 0.40%			62							
515	57				SS - TY 2 74.3 LF 18" DIA. RCP @ 0.45%			63							
	58				SS - TY 2 84.6 LF 18" DIA. RCP @ 0.30%			64							
510	59				SS - TY 2 28.2 LF 12" DIA. RCP @ 0.44%			65							
	60				SS - TY 2 4.6 LF 24" DIA. RCP @ 0.30%			66							
	61				SS - TY 2 67.6 LF 12" DIA. RCP @ 1.51%			67							
	62				SS - TY 2 80.6 LF 24" DIA. RCP @ 0.30%			68							
	63				SS - TY 2 55.5 LF 24" DIA. RCP @ 0.30%										
	64				SS - TY 2 175.0 LF 24" DIA. RCP @ 0.39%										

May 15, 2008 - 04:04:32 PM
c:\pro\ecr\ep05802\corus\1\phase 2\pdp.dgn

DATE	BY	REVISION

DATE	BY	REVISION