

- NOTES**
1. STANDARD 701423 SHALL BE USED ON US 50
  2. CONFLICTING SIGNAGE FROM THE APPLICATION OF STANDARD 701423 SHALL BE COVERED OR REMOVED AS DIRECTED BY THE ENGINEER.
  3. THE WORK ZONE SPEED LIMIT SHALL BE LOWER THAN OR EQUAL TO THE EXISTING POSTED SPEED LIMIT.

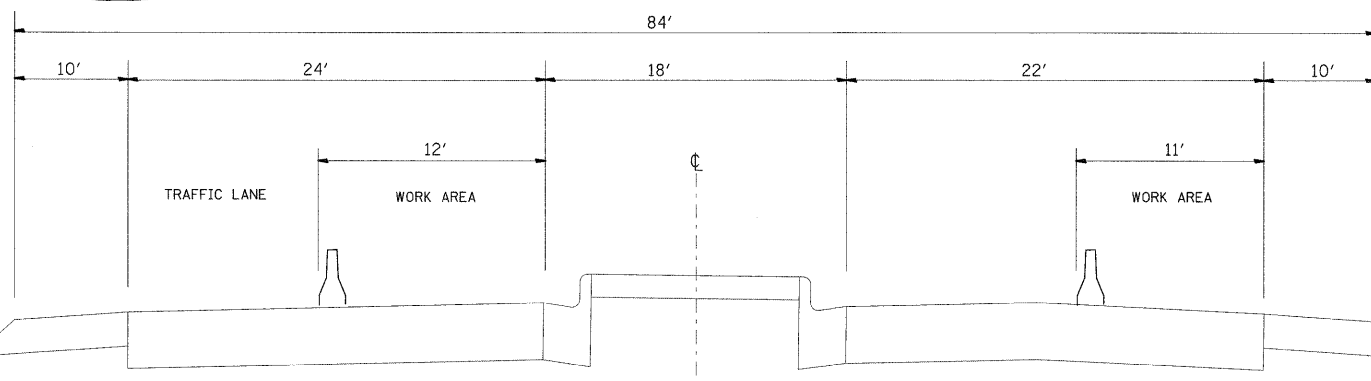

**TYPICAL SECTION**  
US 50  
(NTS)

FILE NAME =	USER NAME = gelinh	DESIGNED -	REVISED -	<b>STATE OF ILLINOIS DEPARTMENT OF TRANSPORTATION</b>	<b>TRAFFIC CONTROL (US 50)</b>			F.A.I. RTE.	SECTION	COUNTY	TOTAL SHEETS	SHEET NO.
ct:\projects\0876c17\design\d76c17-sht-5.dgn	PLOT SCALE = 50.0000' / IN.	DRAWN -	REVISED -					57	61-3HB-1HDF	MARION	7	5
PLOT DATE = 7/7/2008	DATE -	CHECKED -	REVISED -		SCALE: _____ SHEET NO. 5 OF 7 SHEETS STA. _____ TO STA. _____			CONTRACT NO. 76C17				
					FED. ROAD DIST. NO. _____ ILLINOIS FED. AID PROJECT							