

F.A.U. SECTION	COUNTY	TOTAL SHEETS	SHEET NO.
3887 96-00159-00-CH	KANE	70	12
STA. 4+60.20 TO STA. 8+83.13			
FED. ROAD DIST. NO.	ILLINOIS FED. AID PROJECT		

CONTRACT NO: 83943

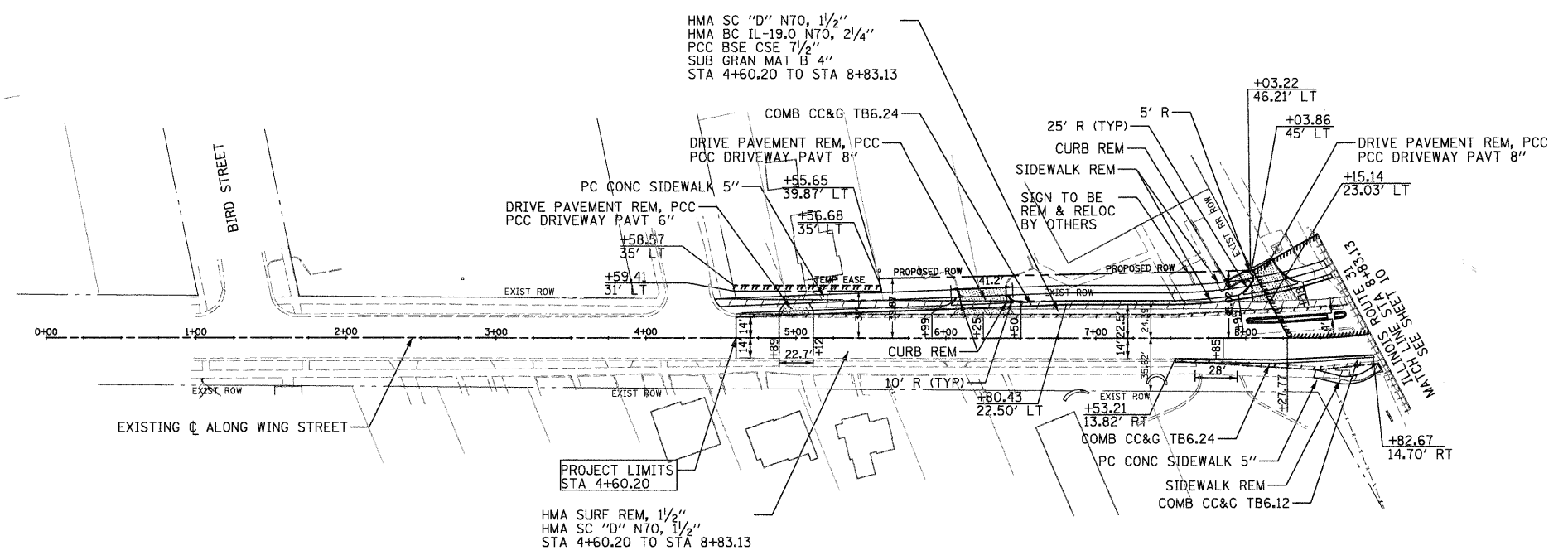
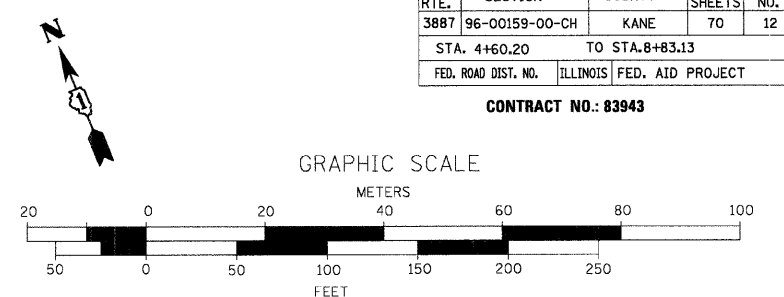

NOTES:

1. CONCRETE CURB, TYPE B WILL BE INSTALLED AT COMMERCIAL DRIVEWAY APPROACHES.
2. SEE SHEET 25 FOR INTERSECTION DETAILS.
3. AGGREGATE SURFACE COURSE FOR TEMPORARY ACCESS, 8" WILL BE INSTALLED AT DRIVEWAY APPROACHES.

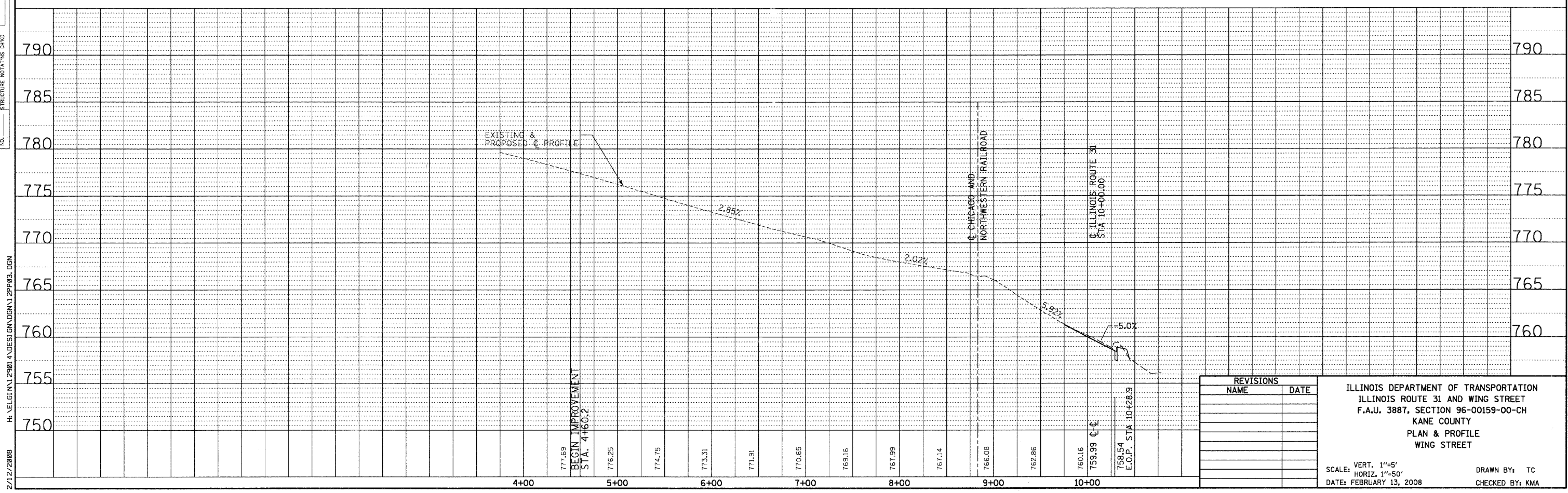

REVISIONS	
NAME	DATE

ILLINOIS DEPARTMENT OF TRANSPORTATION
 ILLINOIS ROUTE 31 AND WING STREET
 F.A.U. 3887, SECTION 96-00159-00-CH
 KANE COUNTY
 PLAN & PROFILE
 WING STREET

SCALE: VERT. 1"=5'
 HORIZ. 1"=50'
 DATE: FEBRUARY 13, 2008

DRAWN BY: TC
 CHECKED BY: KMA

PLAN	DATE
BY	
SURVEYED	
ALIGNED	
CHECKED	
NO.	

PROFILE	DATE
BY	
SURVEYED	
GRADES	
CHECKED	
NO.	

2/12/2008 H:\NELGIN\129014\DESIGN\DN\2PP03.DGN