

F.A. SITE	SECTION	COUNTY	TOTAL SHEETS	SHEET NO.
FAP134	98-00480-00-BR 03-00522-00-TL	WINNEBAGO	62	18
STA. _____		TO STA. _____		
FED. ROAD DIST. NO. _____		ILLINOIS FED. AID PROJECT		

DATE	BY	REVISION

DATE	BY	REVISION

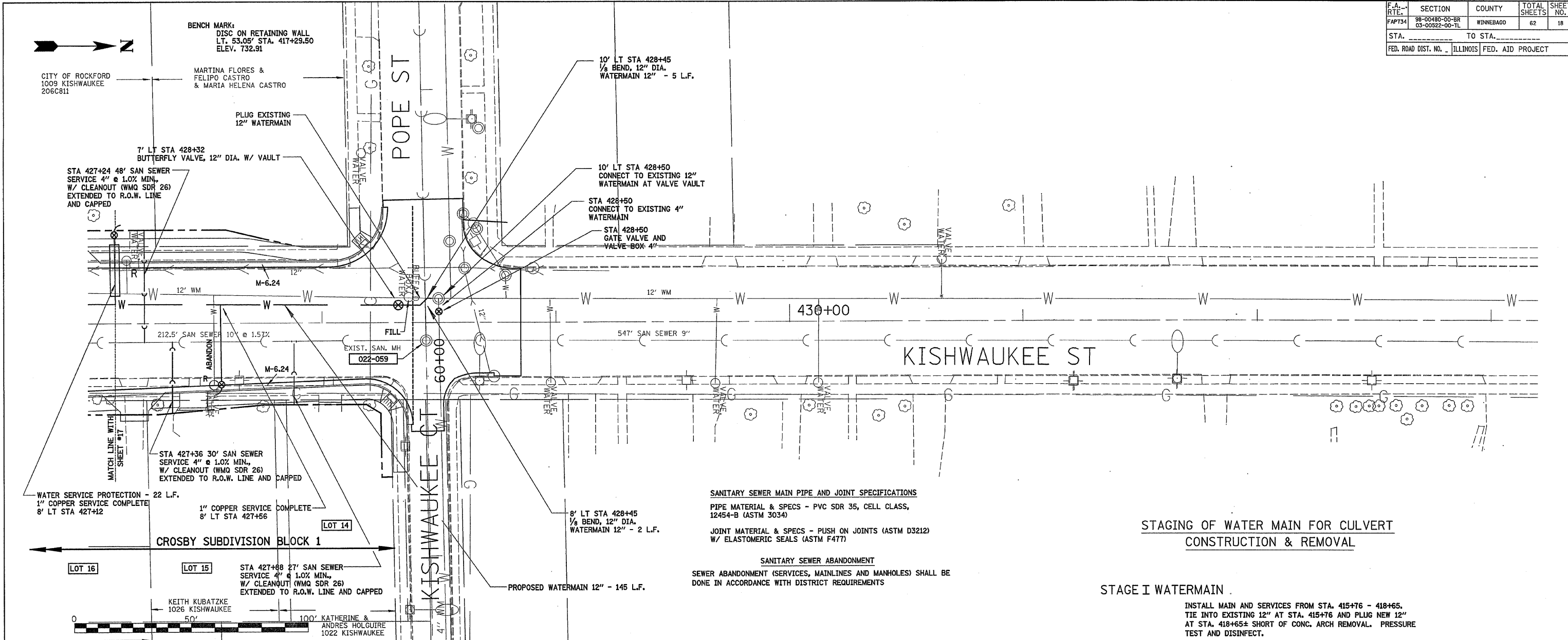

SANITARY SEWER MAIN PIPE AND JOINT SPECIFICATIONS
 PIPE MATERIAL & SPECS - PVC SDR 35, CELL CLASS, 12454-B (ASTM 3034)
 JOINT MATERIAL & SPECS - PUSH ON JOINTS (ASTM D3212) W/ ELASTOMERIC SEALS (ASTM F477)

SANITARY SEWER ABANDONMENT
 SEWER ABANDONMENT (SERVICES, MAINLINES AND MANHOLES) SHALL BE DONE IN ACCORDANCE WITH DISTRICT REQUIREMENTS

STAGING OF WATER MAIN FOR CULVERT CONSTRUCTION & REMOVAL

- STAGE I WATERMAIN**
 INSTALL MAIN AND SERVICES FROM STA. 415+76 - 418+65. TIE INTO EXISTING 12" AT STA. 415+76 AND PLUG NEW 12" AT STA. 418+65± SHORT OF CONC. ARCH REMOVAL. PRESSURE TEST AND DISINFECT.
- STAGE II WATERMAIN**
 INSTALL MAIN AND SERVICES FROM STA. 423+96 VALVE TO 428+45. NO HOOK-UP TO MAIN OR HOMES. INSTALL 12" MAIN AND HYDRANT FROM STA. 421+65 - 422+90± AND PLUG MAIN WEST OF 421+65. DISINFECT DURING STAGE III
- STAGE III WATERMAIN**
 INSTALL PARTIAL CULVERT AT STA. 423+60 AND THEN CONNECT STAGE II MAIN OVER CULVERT. MAKE CONNECTION TO MAIN AT STA. 428+50 AND 423+96. PRESSURE TEST AND DISINFECT. CONNECT SERVICES TO HOMES.
- STAGE IV WATERMAIN**
 REMOVE CONC. ARCH AT STA. 418+69 - 419+49 AND INSTALL 12" MAIN FROM STA. 418+65 - 421+62. PRESSURE TEST AND DISINFECT. MAKE CONNECTION TO LIVE MAIN.

