

F.A. RTE.	SECTION	COUNTY	TOTAL SHEETS	SHEET NO.
FAP134	95-00480-00-BR 03-00522-00-TL	WINNEBAGO	62	35
STA.	TO STA.			
FED. ROAD DIST. NO.	ILLINOIS	FED. AID PROJECT		

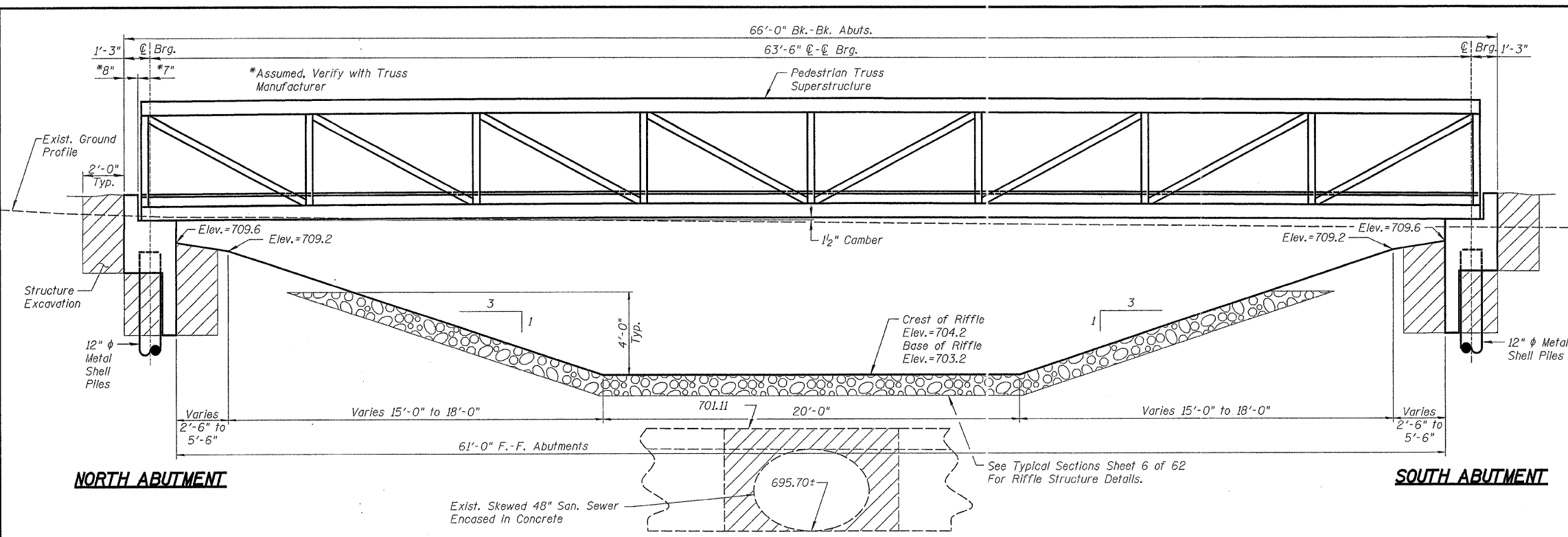

BILL OF MATERIALS - BRIDGE

ITEM	UNIT	SUB.	SUPER.	TOTAL
Porous Granular Embankment	Cu. Yd.	10	—	10
Structure Excavation	Cu. Yd.	52	—	52
Concrete Structures	Cu. Yd.	13.7	—	13.7
Reinforcement Bars	Pound	1130	—	1130
Furnishing Metal Shell Piles 12" X 0.179"	Foot	145	—	145
Driving Piles	Foot	145	—	145
Test Pile Metal Shells	Each	1	—	1
Pedestrian Truss Superstructure	Sq. Ft.	—	889	889
Form Liner Textured Surface	Sq. Yd.	8	—	8
Anti-Graffiti Coating	Sq. Ft.	76	—	76

ELEVATION LOOKING NORTHEAST

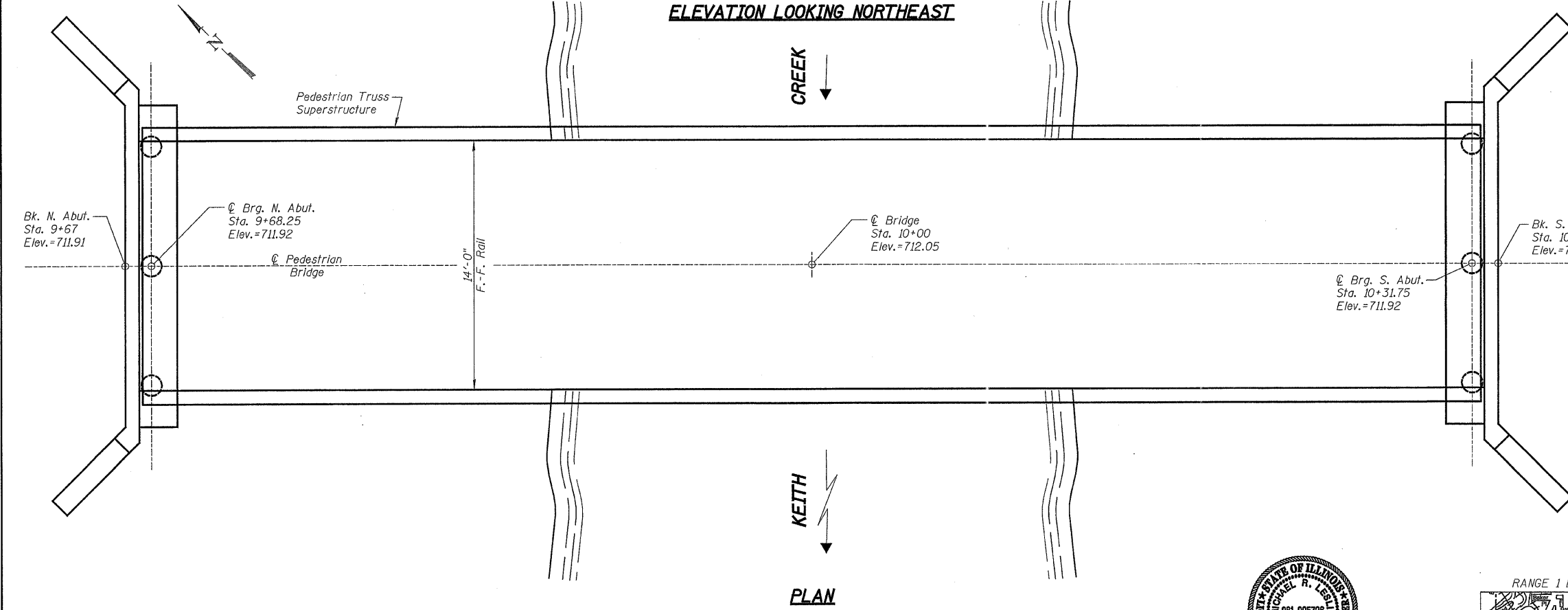

PLAN

GENERAL NOTES

Reinforcement Bars shall conform to the Requirements of AASHTO M-31, M-42, or M-53 Grade 60.

The Contractor Shall Drive a Test Pile in a Permanent Location at the North Abutment, as Directed by the Engineer Prior to Ordering the Remainder of the Piles.

Porous Granular Embankment shall be Placed a Distance of 2 Feet Behind Each Abutment from Bottom of Cap to Top of Backwall.

Anchor Bolt Sizes and Layout and Bearing Design and Materials by Bridge Manufacturer.

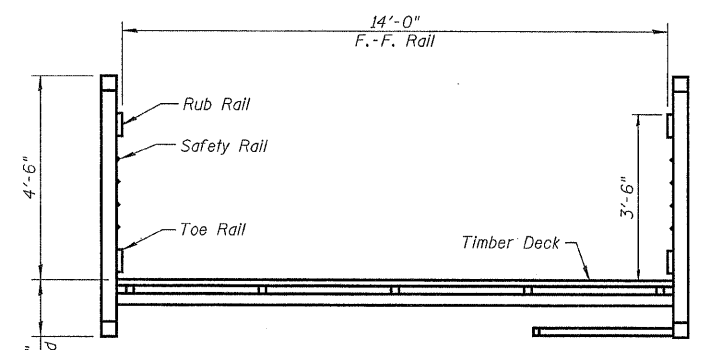

TYPICAL SECTION THRU TRUSS

** To be Determined by Truss Manufacturer.

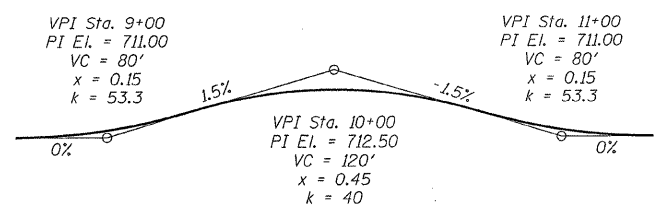

PROFILE GRADE

DESIGN STRESSES

FIELD UNITS
 $f'_c = 3500$ psl
 $f_y = 60000$ psl

LOADING

85 psf Pedestrian & 20,000 lb. Emergency Vehicle

ASSUMED TRUSS LOADS

Vertical LL = 38.7 k/Abut.
 Vertical DL = 22.0 k/Abut.
 Horizontal WL = 8.0 k/Abut.

DESIGN SPECIFICATIONS

Design in Accordance with AASHTO Guide for Development of Bicycle Facilities, 1999 and AASHTO Guide Specifications for Design of Pedestrian Bridges, 1997



Michael R. Leslie
 DATE: 4/17/08
 EXPIRES 11/30/08

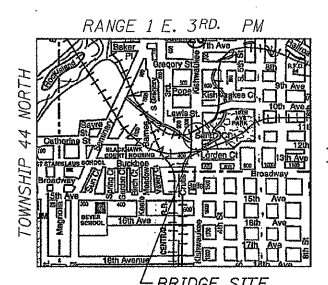

LOCATION SKETCH

**GENERAL PLAN AND ELEVATION
 KISHWAUKEE STREET PEDESTRIAN BRIDGE
 OVER KEITH CREEK
 ROCKFORD, ILLINOIS**



800 East Second Street
 Dixon, Illinois 61021
 Phone 815.294.2881 Fax 815.294.3985
 Design Firm #164-000018
 www.willett-hofmann.com
 WHA # 1158D03

DESIGNED BY:
 M.R. Leslie
 DATE: 3/06
 CHECKED BY:
 B.K. Converse
 DATE: 3/06
 DRAWN BY:
 R.D. Allen
 DATE: 3/06