

F.A. RTE.	SECTION	COUNTY	TOTAL SHEETS	SHEET NO.
FAPT34	98-00480-00-BR 03-00522-00-TL	WINNEBAGO	62	39
STA.		TO STA.		
FED. ROAD DIST. NO.		ILLINOIS FED. AID PROJECT		

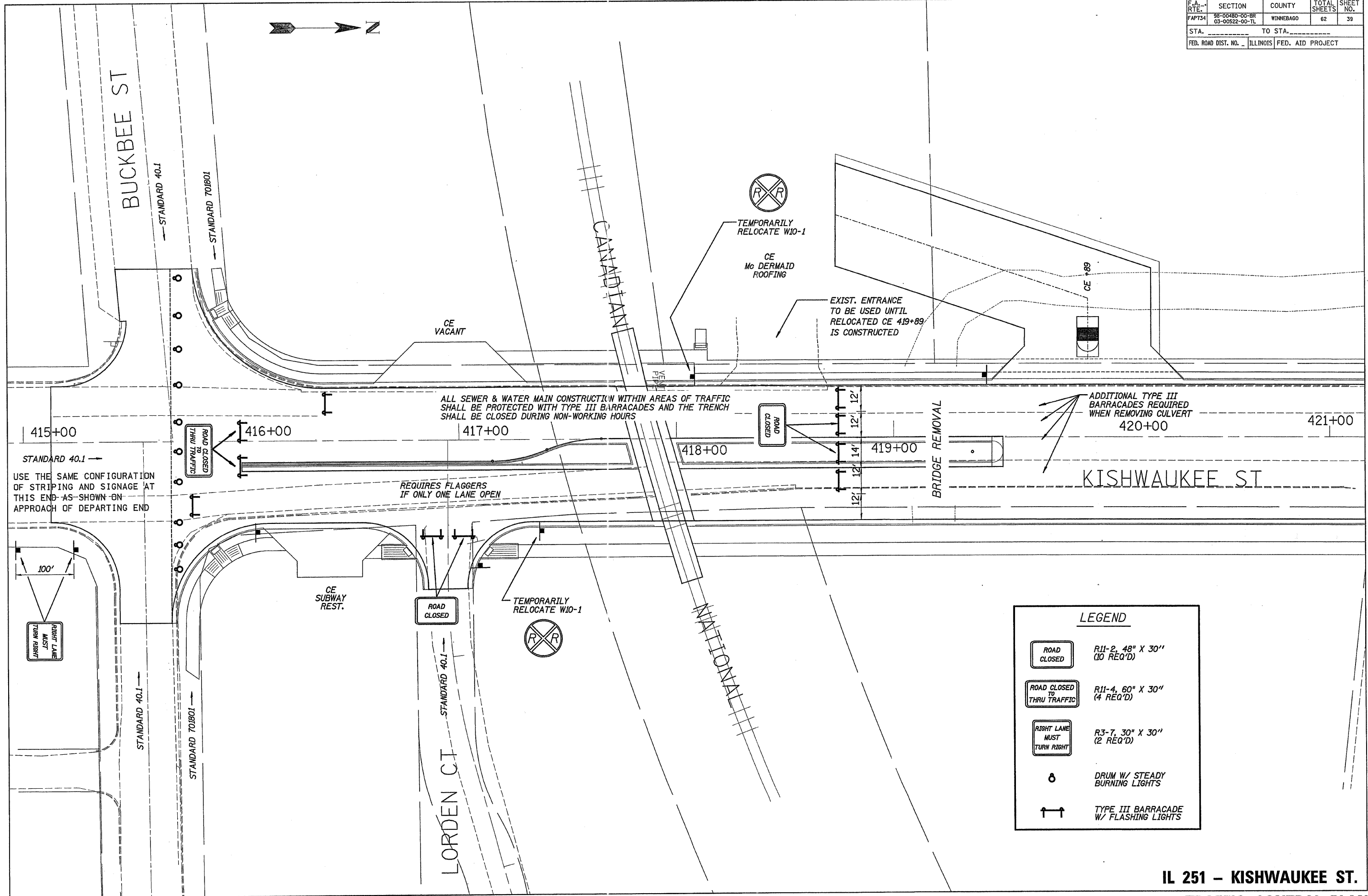

STANDARD 40.1 —  
USE THE SAME CONFIGURATION OF STRIPING AND SIGNAGE AT THIS END AS SHOWN ON APPROACH OF DEPARTING END

ALL SEWER & WATER MAIN CONSTRUCTION WITHIN AREAS OF TRAFFIC SHALL BE PROTECTED WITH TYPE III BARRICADES AND THE TRENCH SHALL BE CLOSED DURING NON-WORKING HOURS

REQUIRES FLAGGERS IF ONLY ONE LANE OPEN

ADDITIONAL TYPE III BARRICADES REQUIRED WHEN REMOVING CULVERT 420+00

**LEGEND**

	R11-2, 48" X 30" (10 REQ'D)
	R11-4, 60" X 30" (4 REQ'D)
	R3-7, 30" X 30" (2 REQ'D)
	DRUM W/ STEADY BURNING LIGHTS
	TYPE III BARRICADE W/ FLASHING LIGHTS

**IL 251 – KISHWAUKEE ST.  
TRAFFIC CONTROL PLAN**