

| F.A.P. RTE.         | SECTION      | COUNTY        | TOTAL SHEETS     | SHEET NO. |
|---------------------|--------------|---------------|------------------|-----------|
| 781                 | 1YRS, 2ZRS-1 | CRAWFORD      | 378              | 62        |
| STA. 1+925          |              | TO STA. 2+275 |                  |           |
| FED. ROAD DIST. NO. |              | ILLINOIS      | FED. AID PROJECT |           |

**CURVE P2 DATA**

PI STA. 2+006.106  
 $\Delta = 41^\circ 59' 15''$  (LT)  
 T= 118.158 m  
 R= 307.912 m  
 L= 225.644 m  
 E= 21.893 m  
 $e = 6.0\%$   
 T.R.= 11.000 m  
 S.E. RUN ( $L_1$ )= 43.000 m  
 PC STA. 1+887.948  
 PT STA. 2+113.592

**CURVE TR100E DATA**

PI STA. 10+026.560  
 $\Delta = 26^\circ 58' 30''$  (LT)  
 T= 11.992 m  
 R= 50.000 m  
 L = 23.540 m  
 E = 1.418 m  
 $e =$  NORMAL CROWN  
 T.R.= ---  
 S.E. RUN ( $L_1$ )= ---  
 PC STA. 10+014.568  
 PT STA. 10+038.108

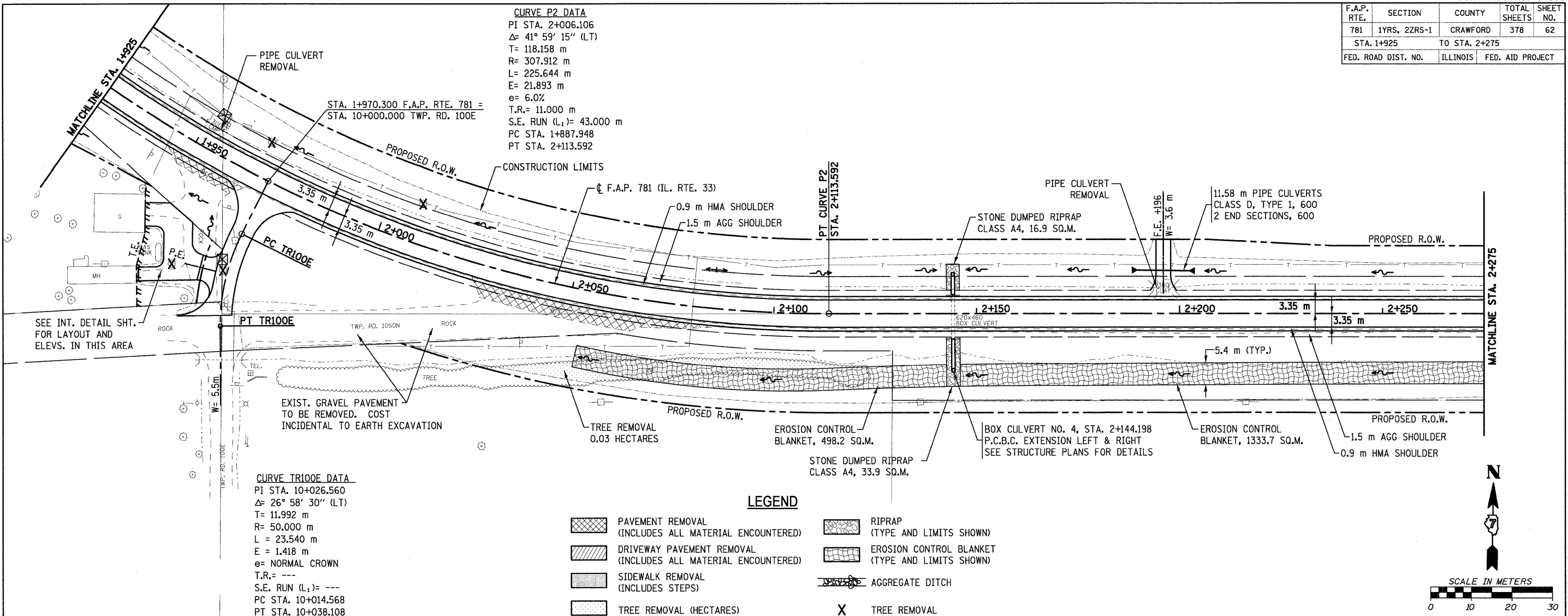

**LEGEND**

- PAVEMENT REMOVAL (INCLUDES ALL MATERIAL ENCOUNTERED)
- DRIVEWAY PAVEMENT REMOVAL (INCLUDES ALL MATERIAL ENCOUNTERED)
- SIDEWALK REMOVAL (INCLUDES STEPS)
- TREE REMOVAL (HECTARES)
- RIPRAP (TYPE AND LIMITS SHOWN)
- EROSION CONTROL BLANKET (TYPE AND LIMITS SHOWN)
- AGGREGATE DITCH
- TREE REMOVAL

