

F.A.P. RTE.	SECTION	COUNTY	TOTAL SHEETS	SHEET NO.
781	1YRS, 2ZRS-1	CRAWFORD	378	129
STA. 4+025		TO STA. 4+200		
FED. ROAD DIST. NO.	ILLINOIS	FED. AID PROJECT		

- | | | | |
|--|---|---|---|
| P500 STORM SEWER, CL.A, TY.1, 300
8.496m @ 0.50% | P505 STORM SEWER, CL.A, TY.1, 300
8.496m @ 0.50% | P510 STORM SEWER, CL.A, TY.1, 300
6.981m @ 0.50% | T50 REINFORCED CONC. PIPE TEE
450 PIPE WITH 300 RISER |
| P501 STORM SEWER, CL.A, TY.1, 300
0.923m @ 0.50% | P506 STORM SEWER, CL.A, TY.1, 300
1.498m @ 2.00% | P511 STORM SEWER, CL.A, TY.1, 300
8.806m @ 0.50% | T51 REINFORCED CONC. PIPE TEE
450 PIPE WITH 300 RISER |
| P502 STORM SEWER, CL.A, TY.1, 450
108.763m @ 0.40% | P507 STORM SEWER, CL.A, TY.1, 300
1.065m @ 1.00% | P512 STORM SEWER, CL.A, TY.1, 600
60.815m @ 1.00% | T52 REINFORCED CONC. PIPE TEE
600 PIPE WITH 300 RISER |
| P503 STORM SEWER, CL.A, TY.1, 300
8.496m @ 0.50% | P508 STORM SEWER, CL.A, TY.1, 450
16.466m @ 0.40% | P513 STORM SEWER, CL.A, TY.1, 300
8.496m @ 0.50% | |
| P504 STORM SEWER, CL.A, TY.1, 300
1.498m @ 2.00% | P509 STORM SEWER, CL.A, TY.1, 300
9.610m @ 0.50% | P514 STORM SEWER, CL.A, TY.1, 300
1.498m @ 2.00% | |

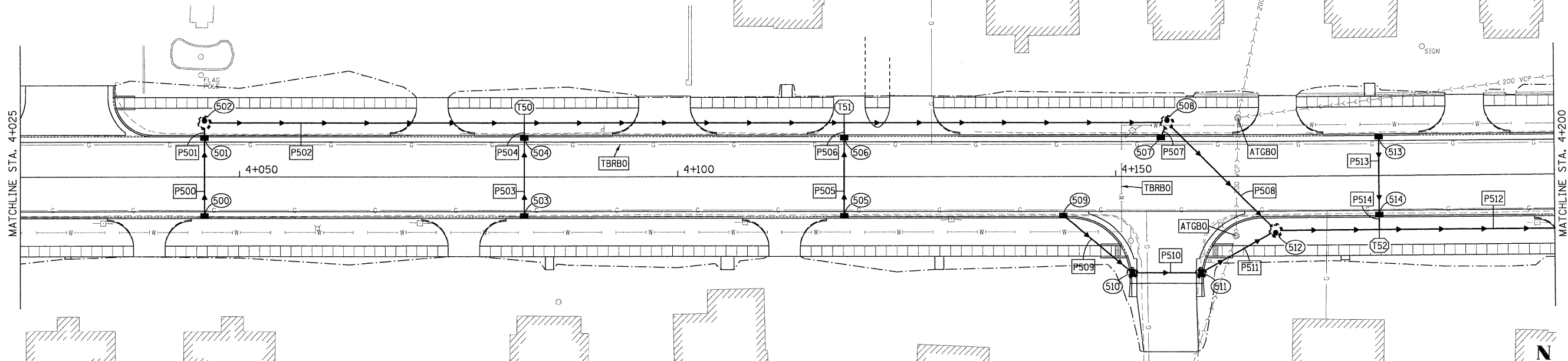

- | | | | | |
|---|--|---|--|--|
| 500 INLET TY.A, TY.3 F&G
STA. 4+046.000, 4.475m RT.
GRATE 153.386
INV. 152.400 | 503 INLET TY.A, TY.3 F&G
STA. 4+082.500, 4.475m RT.
GRATE 153.284
INV. 152.206 | 506 INLET TY.A, TY.3 F&G
STA. 4+119.000, 4.475m LT.
GRATE 153.182
INV. 152.017 | 509 INLET TY.A, TY.3 F&G
STA. 4+144.000, 4.475m RT.
GRATE 153.094
INV. 151.979 | 512 MH. TY.A, RESTRICTED DEPTH
1.2m DIA., TY.1 FRAME, CL. LID
STA. 4+168.233, 6.200m RT.
SEE DETAIL FOR FRAME OFFSET
TOP 153.096
INV.(NW) 151.700
INV.(E) 151.547
INV.(SW) 151.852 |
| 501 INLET TY.A, TY.3 F&G
STA. 4+046.000, 4.475m LT.
GRATE 153.386
INV. 152.358 | 504 INLET TY.A, TY.3 F&G
STA. 4+082.500, 4.475m LT.
GRATE 153.284
INV. 152.163 | 507 INLET TY.A, TY.3 F&G
STA. 4+155.118, 4.475m LT.
GRATE 153.024
INV. 151.928 | 510 INLET TY.B, RESTRICTED DEPTH
0.9m DIA., TY.3 F&G
STA. 4+151.900, 11.000m RT.
GRATE 152.887
INV.(NW,E) 151.931 | 513 INLET TY.A, TY.3 F&G
STA. 4+180.000, 4.475m LT.
GRATE 152.795
INV. 151.658 |
| 502 MH. TY.A, RESTRICTED DEPTH
1.2m DIA., TY.1 FRAME, CL. LID
STA. 4+046.000, 6.200m LT.
SEE DETAIL FOR FRAME OFFSET
TOP 153.570
INV.(E) 152.201
INV.(S) 152.353 | 505 INLET TY.A, TY.3 F&G
STA. 4+119.000, 4.475m RT.
GRATE 153.182
INV. 152.060 | 508 MH. TY.A, RESTRICTED DEPTH
1.2m DIA., TY.1 FRAME, CL. LID
STA. 4+155.833, 6.200m LT.
SEE DETAIL FOR FRAME OFFSET
TOP 153.235
INV.(W,SE) 151.765
INV.(SW) 151.917 | 511 INLET TY.B, RESTRICTED DEPTH
0.9m DIA., TY.3 F&G
STA. 4+159.700, 11.000m RT.
GRATE 152.885
INV.(W,NE) 151.896 | 514 INLET TY.A, TY.3 F&G
STA. 4+180.000, 4.475m RT.
GRATE 152.795
INV. 151.616 |

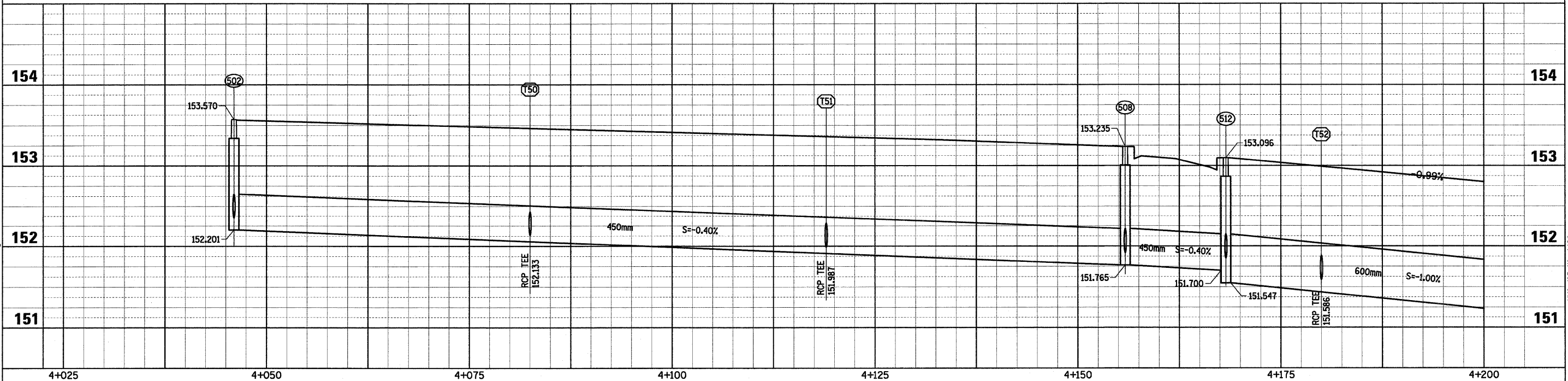
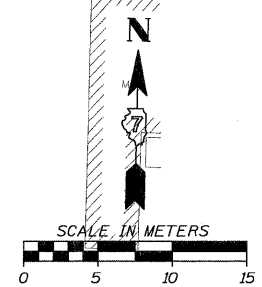

Sheet: 9
Angle: 1.3348
Chain: P_IL33

PLOT DATE = 3/29/2008
FILE NAME = H:\1420\70121.dwg

HMG JOB NO. 4480