

SECTION	COUNTY	TOTAL SHEETS	SHEET NO.
95-02130-00-HP	COLES	6	4

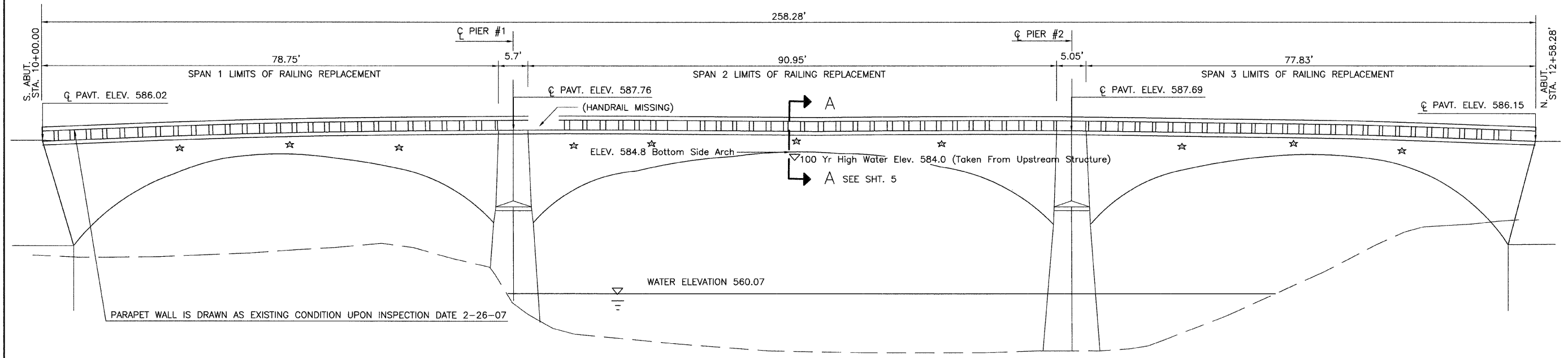

EAST ELEVATION

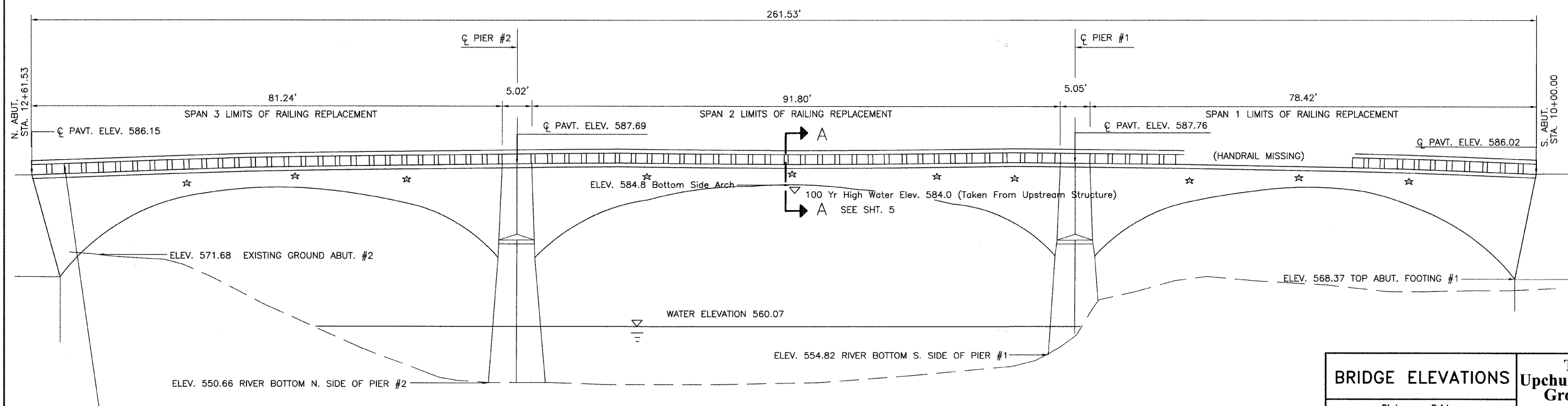

WEST ELEVATION

BRIDGE ELEVATIONS		The Upchurch Group architects engineers surveyors
Blakeman Bridge Section 95-02130-00-HP IHPA Log No. 018072707 TR 193 Over The Embarras River Coles County		
Drawn <u>AL BAKER</u>	Project No. <u>16102048</u>	4413 W. Roosevelt Rd. Suite 108 Holtville, IL 60142 Phone: 708-640-2321 upchurch@upchurchgroup.com
Checked <u>MED</u>		
Date <u>JULY 2008</u>	Professional Design Firm Corporation License No. 184-003401	
Rev. _____		123 North 15th Street Mason, IL 61838 Phone: 217-238-3177 upchurchgroup.com