

F.A.U. RTE.	SECTION	COUNTY	TOTAL SHEETS	SHEET NO.
9306	04-00042-01-PV	MONROE	39	10
STA. 26+50		TO STA. 32+50		
FED. ROAD DIST. NO.		ILLINOIS FED. AID PROJECT		

PLAN	DATE
BY	
CHECKED	
DESIGNED	
NOTED	
NO. OF SHEETS	
NO. OF SHEETS CHECKED	
NO. OF SHEETS NOT CHECKED	
NO. OF SHEETS REVISIONS	

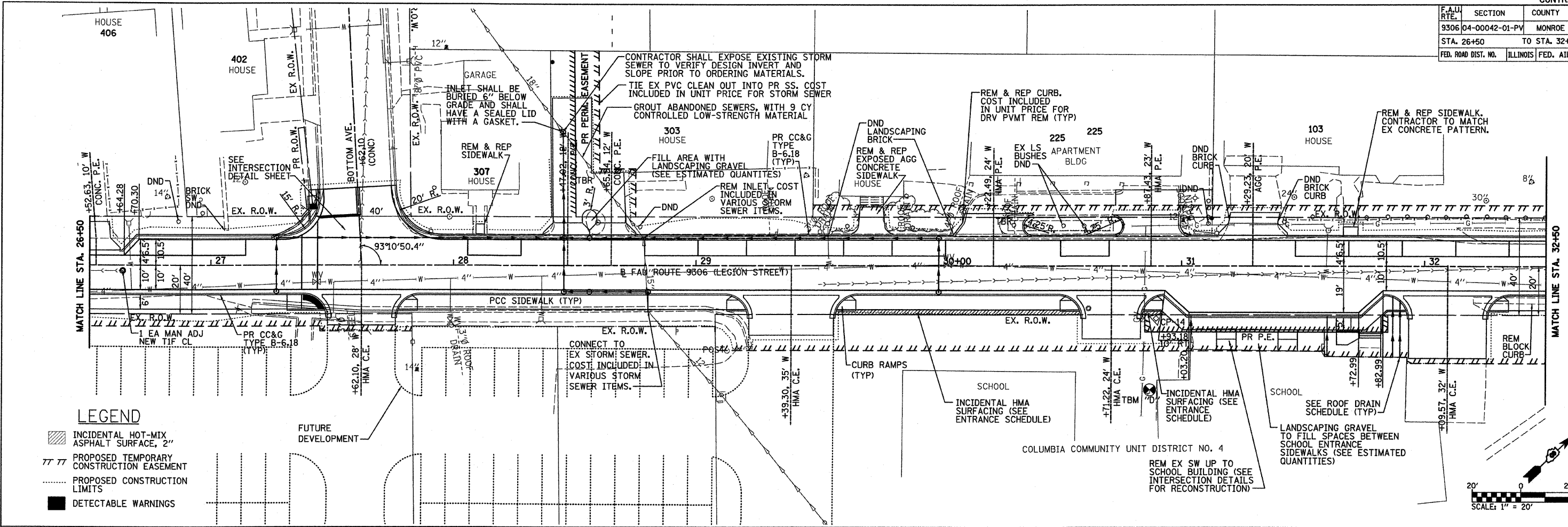

- LEGEND**
- INCIDENTAL HOT-MIX ASPHALT SURFACE, 2"
 - PROPOSED TEMPORARY CONSTRUCTION EASEMENT
 - PROPOSED CONSTRUCTION LIMITS
 - DETECTABLE WARNINGS

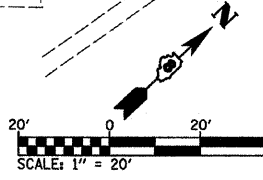

PROFILE	DATE
BY	
CHECKED	
DESIGNED	
NOTED	
NO. OF SHEETS	
NO. OF SHEETS CHECKED	
NO. OF SHEETS NOT CHECKED	
NO. OF SHEETS REVISIONS	

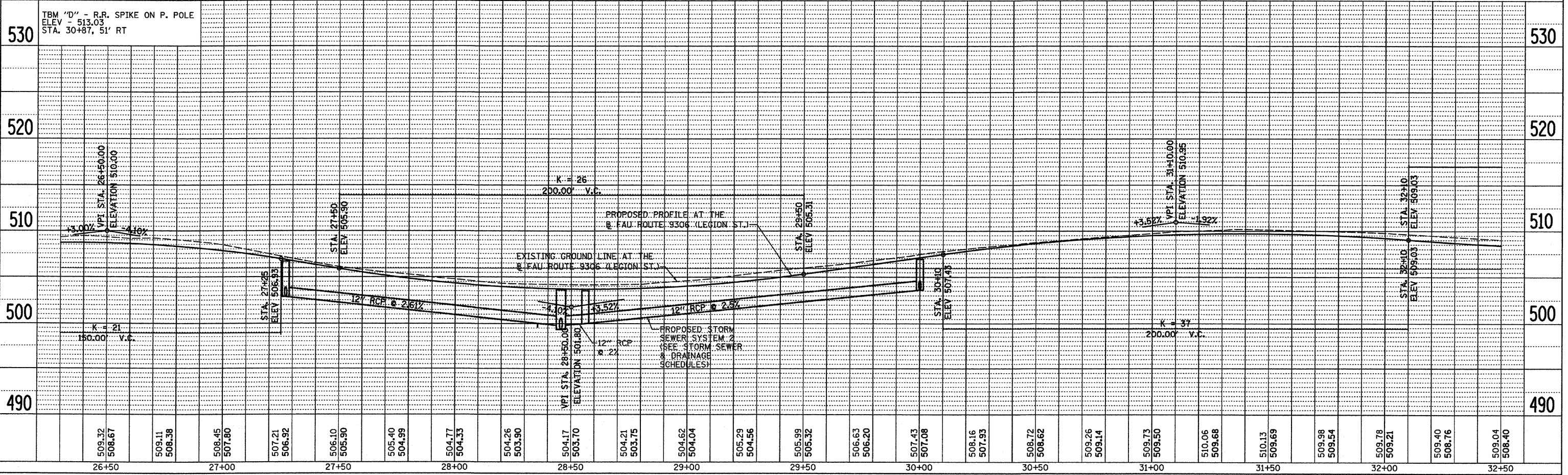

PLOT DATE = 7/11/2009
 PLOT SCALE = #SCALE#
 USER NAME = #USER#

LEGION ST. STA. 26+50 TO STA. 32+50