

STATE OF ILLINOIS
DEPARTMENT OF TRANSPORTATION

ROUTE NO. F.A.P. 322	SECTION 12-1, BR	COUNTY UNION	TOTAL SHEETS 36	SHEET NO. 23	SHEET NO. 7 20 SHEETS
FED. ROAD DIST. NO. 7		ILLINOIS	FED. AID PROJECT		

Contract #98886

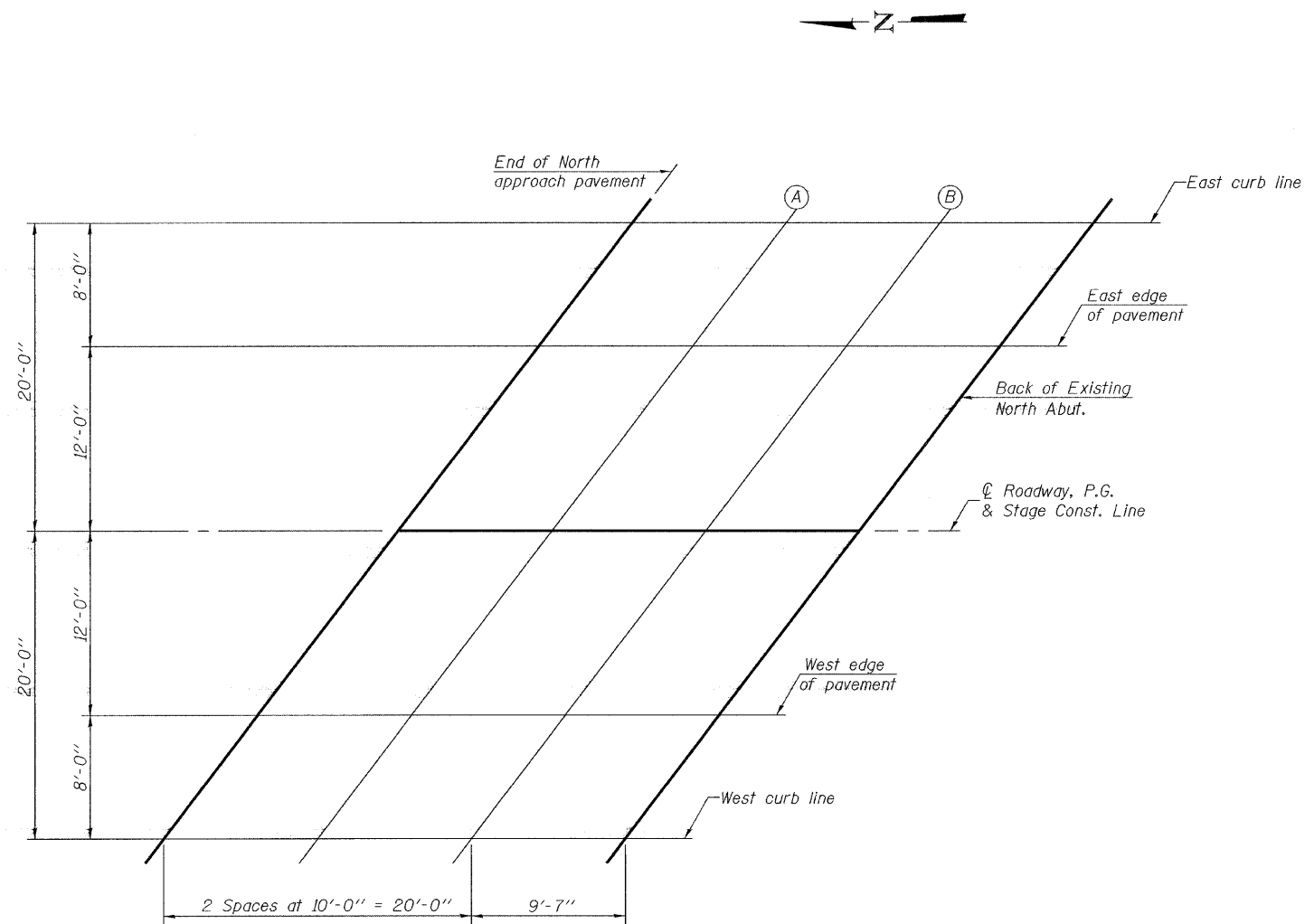

PLAN

EAST CURB LINE

Location	Station	Offset	Theoretical Grade Elevations	Theoretical Grade Elevations Adjusted For Grinding
End of N. Appr. Pav't	80125.60	-20.00	491.86	
A	80135.60	-20.00	491.81	
B	80145.60	-20.00	491.78	
Bk. of Exist. N. Abut.	80155.60	-20.00	491.76	

EAST EDGE OF PAVEMENT

Location	Station	Offset	Theoretical Grade Elevations	Theoretical Grade Elevations Adjusted For Grinding
End of N. Appr. Pav't	80119.46	-12.00	492.06	
A	80129.46	-12.00	492.01	
B	80139.46	-12.00	491.97	
Bk. of Exist. N. Abut.	80149.04	-12.00	491.94	

ROADWAY, P.G. & STAGE CONSTRUCTION JOINT

Location	Station	Offset	Theoretical Grade Elevations	Theoretical Grade Elevations Adjusted For Grinding
End of N. Appr. Pav't	80110.25	0.00	492.30	
A	80120.25	0.00	492.24	
B	80130.25	0.00	492.19	
Bk. of Exist. N. Abut.	80139.83	0.00	492.15	

WEST EDGE OF PAVEMENT

Location	Station	Offset	Theoretical Grade Elevations	Theoretical Grade Elevations Adjusted For Grinding
End of N. Appr. Pav't	80101.04	12.00	492.18	
A	80111.04	12.00	492.11	
B	80121.04	12.00	492.05	
Bk. of Exist. N. Abut.	80130.63	12.00	492.00	

WEST CURB LINE

Location	Station	Offset	Theoretical Grade Elevations	Theoretical Grade Elevations Adjusted For Grinding
End of N. Appr. Pav't	80094.90	20.00	492.06	
A	80104.90	20.00	491.99	
B	80114.90	20.00	491.92	
Bk. of Exist. N. Abut.	80124.49	20.00	491.86	

DESIGNED Patrick M. Petrone	EXAMINED Thomas J. Domagala
CHECKED Jay D. Edwards	PASSED Ralph E. Anderson
DRAWN BECKY M. LEACH	
CHECKED PMP/JDE	

July 22, 2008
ENGINEER OF BRIDGE DESIGN
ENGINEER OF BRIDGES AND STRUCTURES

NORTH APPROACH
TOP OF SLAB ELEVATIONS
F.A.P. ROUTE 322 - SECTION 12-1, BR
UNION CO.
STATION 801+60.00
STRUCTURE NO. 091-0022