

DATE	
BY	
SURVEYED	
REVISIONS	
NOTE BOOK	
AREAS CHECKED	

DATE	
BY	
ORIGINAL SURVEY	
REVISIONS	
NOTE BOOK	
AREAS CHECKED	

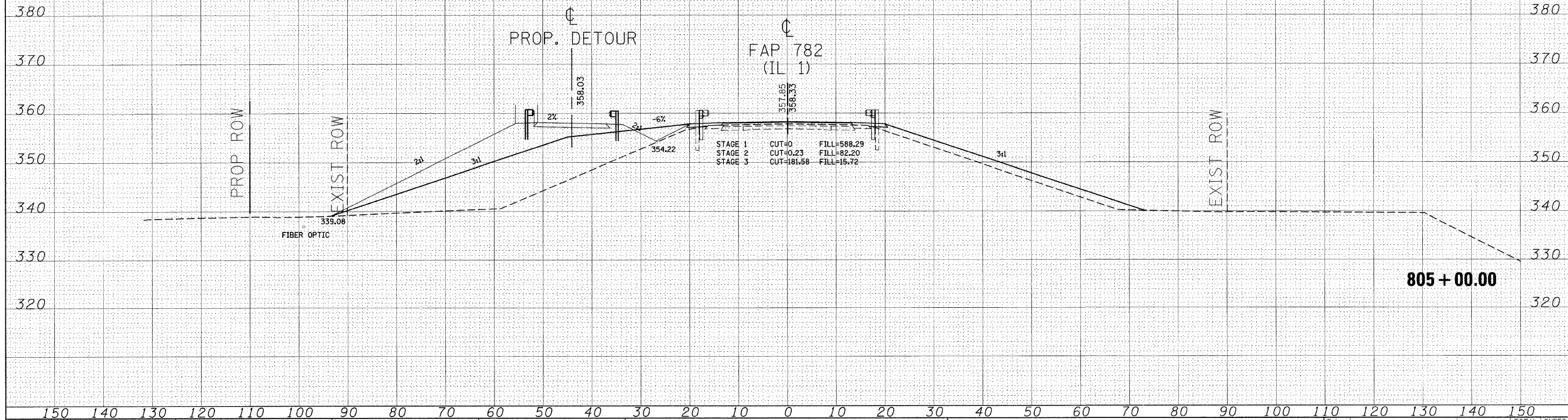
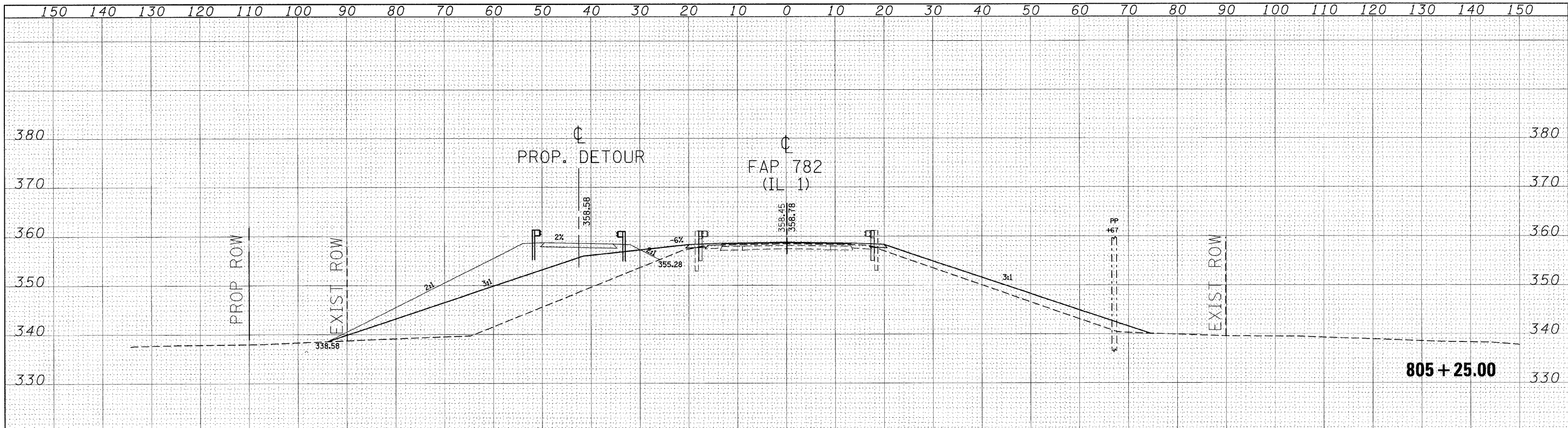

FILE NAME = c:\projects\4983084\washtr\l.m32	USER NAME = shepardgd	DESIGNED -	REVISED -	STATE OF ILLINOIS DEPARTMENT OF TRANSPORTATION	SCALE:	SHEET NO. 55 OF 62 SHEETS	STA. 805+00.00 TO STA. 805+25.00	F.A. RTE. 782	SECTION 114B-2	COUNTY 98887	TOTAL SHEETS 62	SHEET NO. 55
PLOT SCALE = 10.0000' / IN.	CHECKED -	REVISED -	CONTRACT NO. 98887									
PLOT DATE = 6/18/2008	DATE -	REVISED -	FED. ROAD DIST. NO. ILLINOIS FED. AID PROJECT									