

PE088

REVISIONS

NUMBER	BY	DATE

0 1 2
THIS BAR IS EQUAL TO 2'
AT FULL SCALE (34X22).
PLOT 1

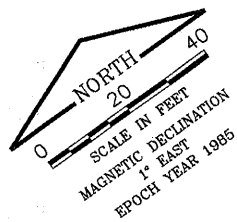

NOTES:

- 1.) THE CONTRACTOR IS TO LOCATE ALL UTILITIES BEFORE DIGGING.
- 2.) CABLES DAMAGED DURING CONSTRUCTION WILL BE REPAIRED TO THE SATISFACTION OF THE ENGINEER AND AT NO ADDITIONAL COST TO THE CONTRACT.
- 3.) REPLACEMENT OF THE GATE SHALL RESULT IN THE REUSE OF EXISTING CABLES, OPERATORS, SENSOR LOOPS, TRANSFORMERS, CARD READERS, AND OTHER AMENITIES THAT ARE CURRENTLY USED WITH THE EXISTING GATE.

LEGEND

— X — EXISTING FENCE
— XX — NEW FENCE

NOTE:
THE EXISTING ACCESS CONTROL SYSTEM IS MANUFACTURED BY NORTHERN COMPUTERS, INC. ALL PROPOSED ACCESS CONTROL SYSTEMS EQUIPMENT SHALL ALSO BE FROM NORTHERN COMPUTERS, INC.

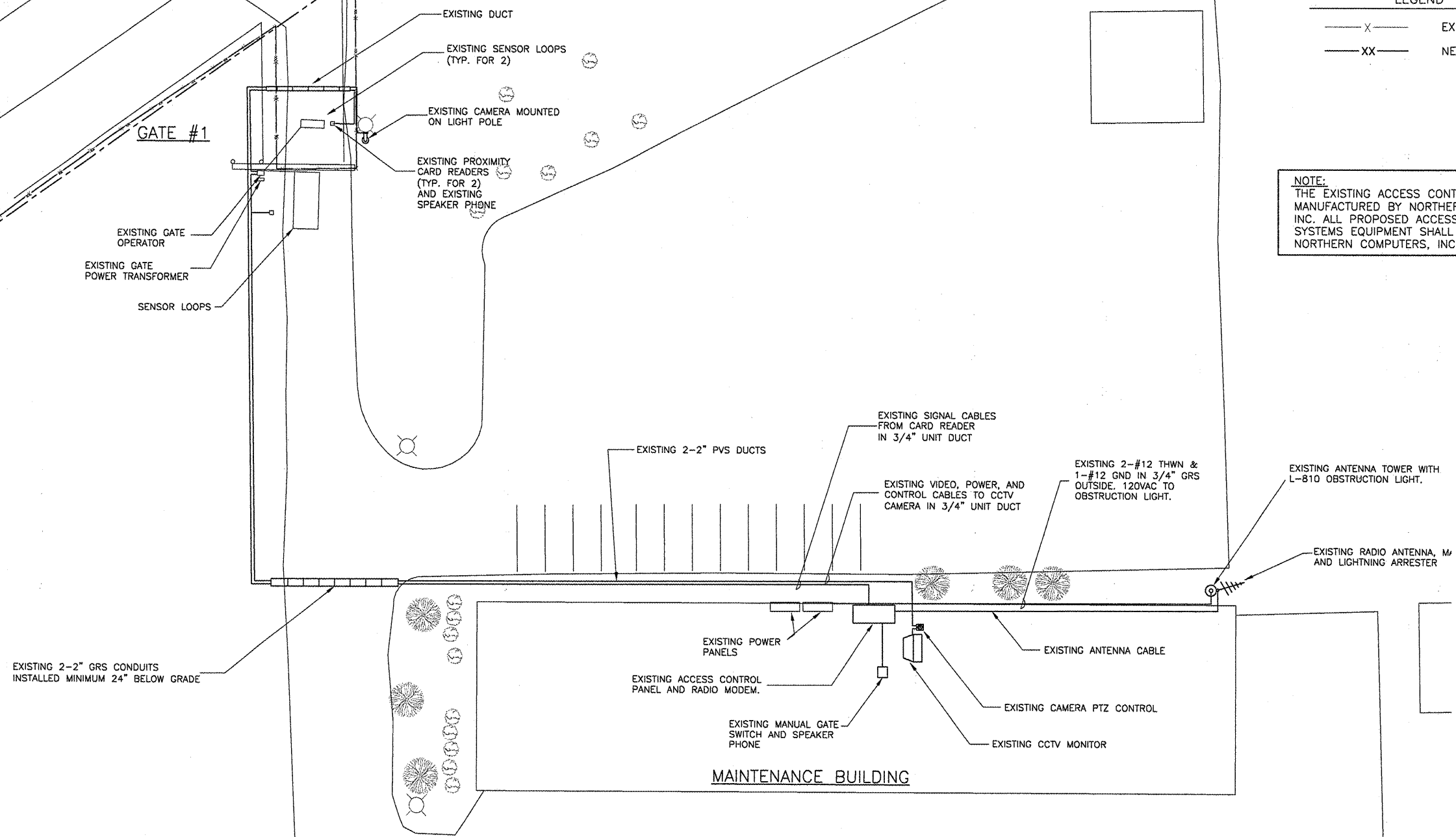

GREATER Peoria REGIONAL Airport
 CONSTRUCT NEW PERIMETER ROAD AND PERIMETER FENCE - PROJECT 2

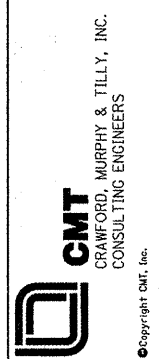

IL PROJECT: PIA-3811
AIP PROJ: 3-17-0080-45

DESIGN BY:	CET
DRAWN BY:	CMT
CHECKED BY:	CET
APPROVED BY:	CET
DATE:	08-21-2008
JOB No:	0706104

MAINTENANCE BUILDING
GATE LAYOUT

K:\Peoria\AP\070610400\Draw\Sheets\1_West_South_Fence\Phase 2_Sheets
 FILE: Gate_Maint.dwg
 DATE: 8/22/2008 1:07 PM