

THE LOCATION, SIZE AND TYPE OF MATERIAL OF EXISTING UNDERGROUND UTILITIES INDICATED ON THE PLANS IS NOT REPRESENTED AS BEING ACCURATE, SUFFICIENT OR COMPLETE. IT SHALL BE THE CONTRACTOR'S RESPONSIBILITY TO DETERMINE THE ACTUAL LOCATION OF ALL SUCH FACILITIES, INCLUDING SERVICE CONNECTIONS TO UNDERGROUND UTILITIES. PRIOR TO CONSTRUCTION, THE CONTRACTOR SHALL NOTIFY THE UTILITY COMPANIES OF HIS OPERATIONAL PLANS AND SHALL OBTAIN FROM THE RESPECTIVE UTILITY COMPANIES DETAILED INFORMATION AND ASSISTANCE RELATIVE TO THE LOCATION OF THEIR FACILITIES AND THE WORKING SCHEDULE OF THE COMPANIES FOR REMOVAL OR ADJUSTMENT WHERE REQUIRED. IN THE EVENT AN UNEXPECTED UTILITY INTERFERENCE IS ENCOUNTERED DURING CONSTRUCTION, THE CONTRACTOR SHALL IMMEDIATELY NOTIFY THE UTILITY COMPANY OF JURISDICTION. THE ENGINEER SHALL ALSO BE IMMEDIATELY NOTIFIED. ANY SUCH MAINS AND SERVICES SHALL BE RESTORED TO SERVICE AT ONCE AND PAID FOR BY THE CONTRACTOR AT NO ADDITIONAL COST TO THE CONTRACT.

CALL J.U.L.I.E. FOR UTILITY INFORMATION AT 1-800-892-0123. CONTACT FAA FOR ASSISTANCE IN LOCATING FAA CABLES AND UTILITIES.

- LEGEND**
- EXISTING PAVEMENT
 - EXISTING BUILDINGS
 - EXISTING ELECTRICAL CABLES
 - EXISTING ELECTRICAL
 - EXISTING GAS LINE
 - EXISTING WATER LINE
 - EXISTING FENCE
 - EXISTING TELEPHONE LINE
 - EXISTING FIBER OPTIC
 - EXISTING STORM SEWER
 - EXISTING SANITARY SEWER
 - EXISTING ROTATING BEACON
 - EXISTING ELECTRICAL HANDHOLE
 - EXISTING ELECTRICAL MANHOLE
 - PROPOSED L-807 WIND CONE
 - EXISTING WIND TEE
 - EXISTING ELECTRICAL TRANSFORMER
 - EXISTING ELECTRIC UTILITY POLE
 - PROPOSED ELECTRICAL HANDHOLE
 - PROPOSED SPLICE CAN
 - PROPOSED ELECTRICAL DUCT
 - PROPOSED 50 PAIR #19 AWG CONTROL CABLE
 - PROPOSED 3/C #6 XLP-USE 600V UG CABLE IN UD
 - PROPOSED 4/C #6 XLP-USE 600V UG CABLE IN UD

- NOTES**
- CONFIRM WITH THE AIRPORT THE AREA ALONG THE FENCE LINE THAT IS NOT SUBJECT TO FARMING. CABLES SHALL NOT BE INSTALLED IN THE AREAS SUBJECT TO FARMING.
 - SEE PROPOSED SAFETY PLAN FOR RUNWAY & TAXIWAY CLOSURE REQUIREMENTS. ALL RUNWAY & TAXIWAY CLOSURES MUST BE COORDINATED WITH AND APPROVED BY THE AIRPORT DIRECTOR.
 - PROPOSED L-807 LIGHTED WIND CONE TO BE INSTALLED IN SAME LOCATION AS EXISTING UNLIT WIND CONE TO BE REMOVED.

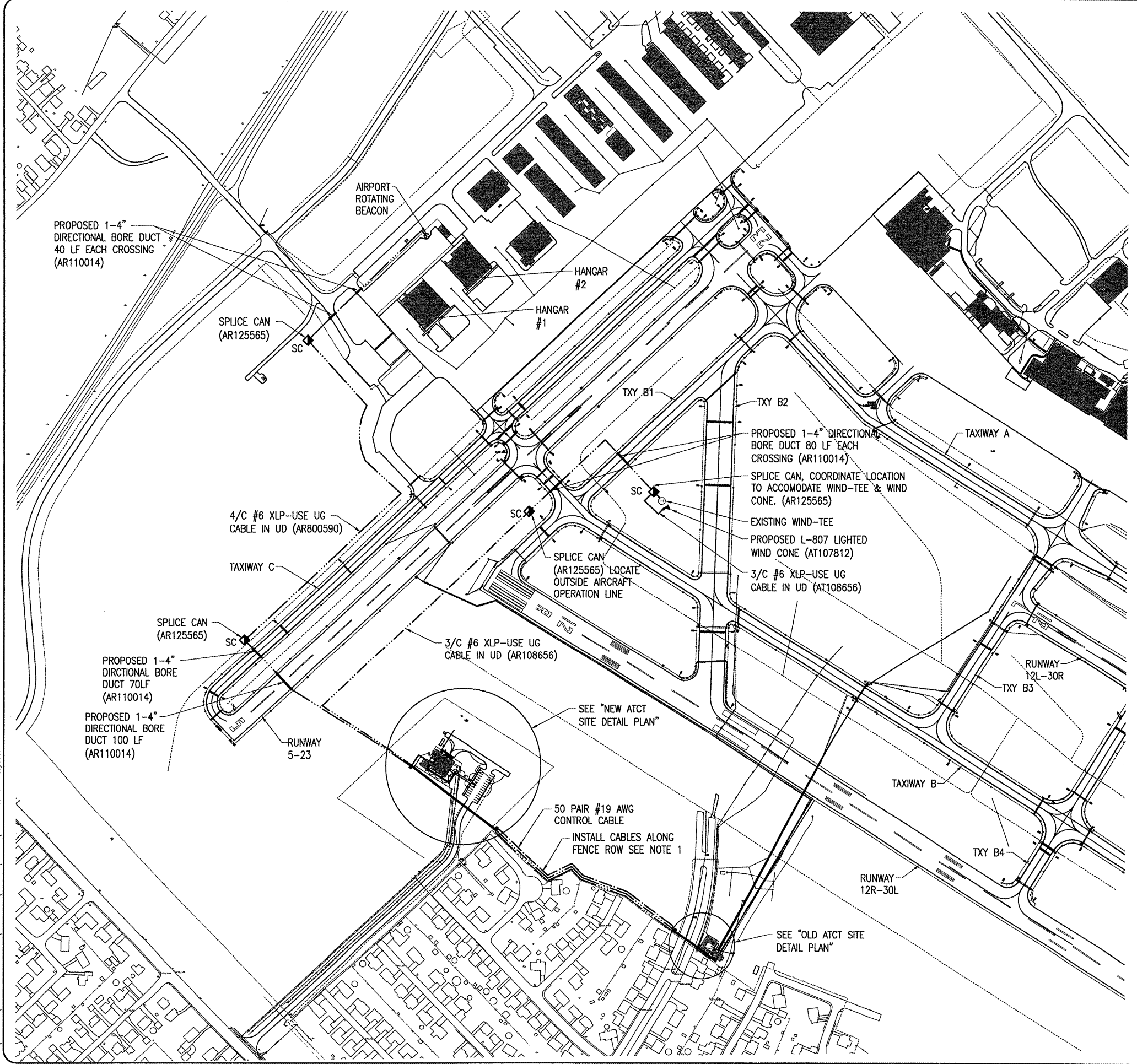
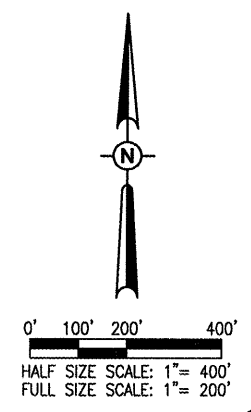

DATE	REVISION	BY

SAINT LOUIS DOWNTOWN AIRPORT
 A Division of Bi-State Development Agency
 ILL. PROJ.: 3-17-0039-819

Hanson Project No. 8450TELECD.0900	FILENAME R-101SIT.DWG	SCALE	DATE 07/16/07
LAYOUT	KNL	05/11/07	
DRAWN	BAK	05/11/07	
REVIEWED	CAH	07/13/07	

HANSON
 Hanson Professional Services Inc.
 4227 Earth City Expressway, Suite 130
 St. Louis, MO 63045-1308
 Offices Nationwide

ATCT INTERFACE TO VAULT
 PROPOSED ELECTRICAL SITE PLAN

5

5 of 26 sheets

JUL 25, 2008 9:41 AM V00RH00805
 I:\AIRPORTS\ST. LOUIS DOWNTOWN\8450TELECD\AIRPORT\ SHEETS\R-101SIT.DWG - Layout1