

ROUTE NO.	SECTION	COUNTY	TOTAL SHEETS	SHEET NO.	SHEET NO. S-17
S. B. I.	606-628VB	COOK	383	122	SHEETS S-48
F. A. U. 2746					
FED. ROAD DIST. NO. 7	ILL. NOTE	FED. AID PROJECT			

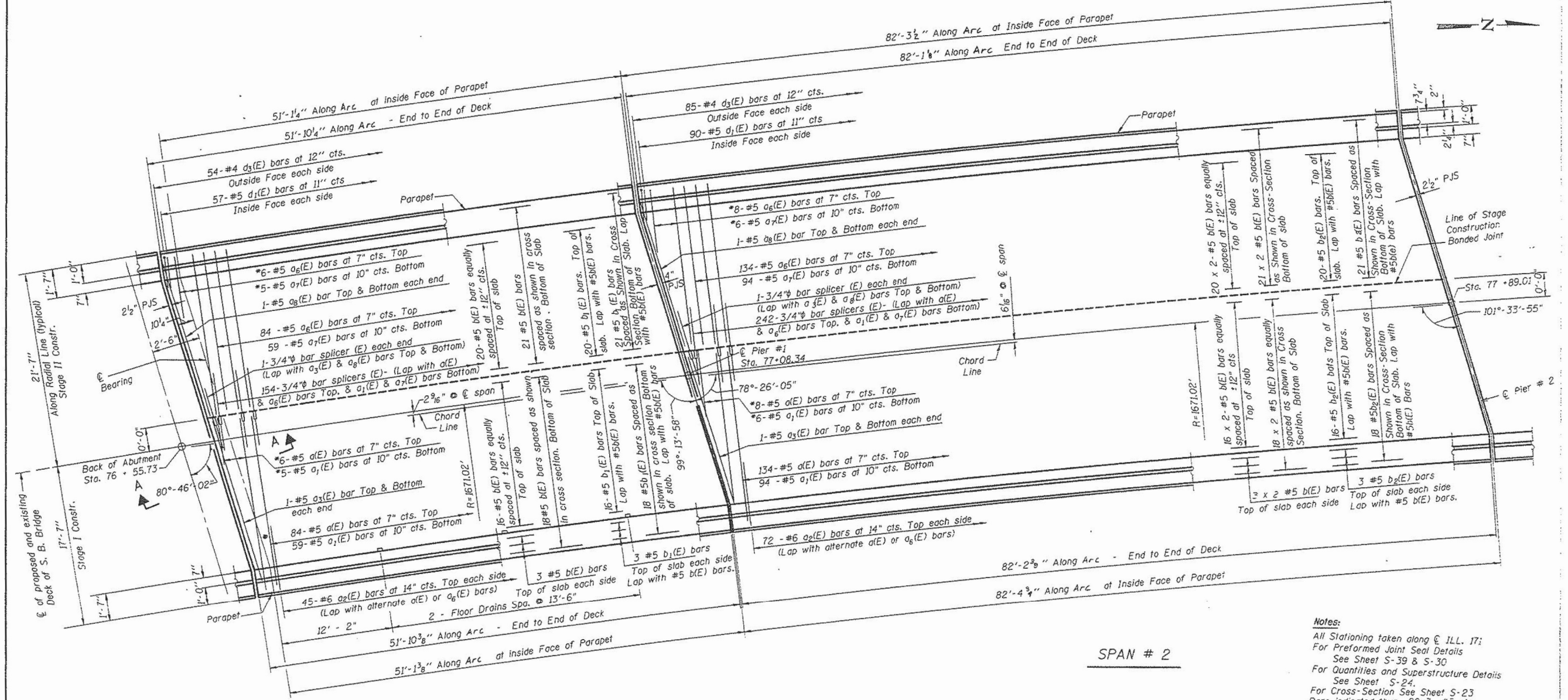

* Order a(E), a₆(E), a₇(E) & a₇(E) bars full length. Cut to fit skew and use remainder of bars in opposite end.

DESIGNED	MK
CHECKED	JAA
DRAWN	EF
CHECKED	JAA

MIN. BAR LAP
#5 BARS = 1'-8"

Notes:
All Stationing taken along ILL. 171;
For Preformed Joint Seal Details See Sheet S-39 & S-30
For Quantities and Superstructure Details See Sheet S-24.
For Cross-Section See Sheet S-23
Bars indicated thus 20x3 #5 etc. indicate 20 lines of bars with 3 lengths per line.

DECK PLAN SPAN NO.1 AND SPAN NO.2
BRIDGE REHABILITATION ILLINOIS ROUTE 171
NORTHBOUND & SOUTHBOUND
OVER JOLIET RD. & AT&SF R.R.
FAU 2746 SECTION 606-628 VB
STATION 77+49.4
COOK COUNTY
STRUCTURE NO. 016-1005 SOUTHBOUND

BOWMAN, BARRETT & ASSOCIATES INC.
CONSULTING ENGINEERS
222 N. MICHIGAN AVENUE SUITE 2200 CHICAGO, ILLINOIS 60601
JOB NO. 124

benesch
engineers · scientists · planners
Alfred Benesch & Company
205 North Michigan Avenue, Suite 2400
Chicago, Illinois 60601
312-565-0450 Job No. 10093

FOR INFORMATION ONLY

STATE OF ILLINOIS
DEPARTMENT OF TRANSPORTATION

EXISTING PLAN INFORMATION 3 OF 7
STRUCTURE NO. 016-1005
SHEET NO. SBX3 OF SBX7 SHEETS

F.A.P. RTE.	SECTION	COUNTY	TOTAL SHEETS	SHEET NO.
372	2013-038B-R	COOK	821	322
CONTRACT NO. 60J16				
ILLINOIS FED. AID PROJECT				

FILE NAME = 016-1005-60J16-009-deck1.dgn
PLOT DATE = 6/23/2014

USER NAME = tjenicke	DESIGNED - CMK	REVISED -
	CHECKED - JAW	REVISED -
PLOT SCALE =	DRAWN - CMK	REVISED -
PLOT DATE = 6/23/2014	CHECKED - JAW	REVISED -

X:\100005\10093\Eng_Docs_Phase_1\1016-1005-1006-1st-Ave-over-Joliet-Rd\Final\Plans\016-1005-60J16-009-deck1.dgn 6/23/2014 2:35:47 PM