

DESIGNER	DATE	COUNTY	SECTION	SHEET NO.
I-25	0707-0708	COOK	95	20
SHEETS				

**DESIGN LOADING:**  
A.A.S.H.O. H20-44 & 15% FUTURE WEARING SURFACE

**DESIGN STRESSES:**  
FC = 100 P.S.I. SUPERSTRUCTURE AND SUB-STRUCTURE WITHOUT EARTH PRESSURE.  
FC = 100 P.S.I. SUBSTRUCTURE WITH EARTH PRESSURE.  
FS = 20,000 P.S.I. REINFORCEMENT BARS.  
FS = 20,000 P.S.I. STRUCTURAL STEEL, A-36  
V = 75 P.S.I. SHEAR IN PIER FOOTINGS.  
MAX. L.L. + I DEFLECTION  $\leq$  L/1200 (COMPOSITE) AND L/1000 (NON-COMPOSITE).

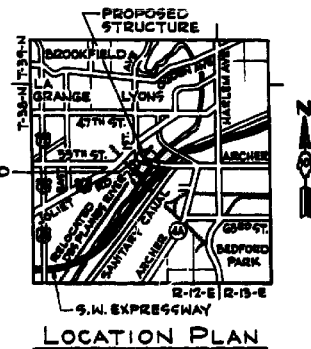
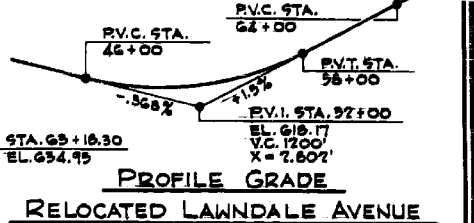

TOTAL BILL OF MATERIALS				
ITEM	UNIT	SUPER	SUB	TOTAL
EARTH EXCAVATION FOR CLASS 2 EXCAVATION FOR STRUCTURES	CU YD	-	16,230	16,230
ROCK EXCAVATION FOR STRUCTURES	CU YD	-	2,186	2,186
CLASS 2 CONCRETE	CU YD	3,950.1	2,068.0	5,918.1
PROTECTIVE COAT	SQ YD	14,221	-	14,221
REINFORCING & ERECTING STRUCTURAL STEEL	POUND	267,957	-	267,957
REINFORCING STEEL PILES	POUND	116,326	236,004	352,330
FORMS	LIN FT	-	11,586	11,586
REINFORCING STEEL PILES	LIN FT	-	3,861	3,861
TEST PILE STEEL	EACH	-	17	17
DRIVING STEEL PILES	LIN FT	-	15,997	15,997
NAME PLATES	EACH	2	-	2
CHAIN LINE FENCE (4")	LIN FT	-	2,300	2,300
CONCRETE IN CONCRETE, 1 1/2" DIA., GALVANIZED STEEL	LIN FT	100	-	100
CONCRETE IN CONCRETE, 1 1/2" DIA., GALVANIZED STEEL	LIN FT	50	-	50
ALUMINUM HANDRAIL	LIN FT	5,530	-	5,530
BRIDGE BEAT SEALANT	LAMP	3000	-	3000
CONCRETE ATTACHED TO STRUCTURE, 2" DIA., GALVANIZED STEEL	LIN FT	5600	-	5,600
C.I. JUNCTION BOX 12"x12"x12"	EACH	2	-	2
C.I. JUNCTION BOX 15"x12"x12"	EACH	1	-	1
C.I. JUNCTION BOX 18"x18"x18"	EACH	1	-	1

**ILLINOIS DIVISION OF HIGHWAYS**  
SOUTHWEST EXPRESSWAY  
**LAWNDALE AVE. VIADUCT**  
GENERAL PLAN AND ELEVATIONS

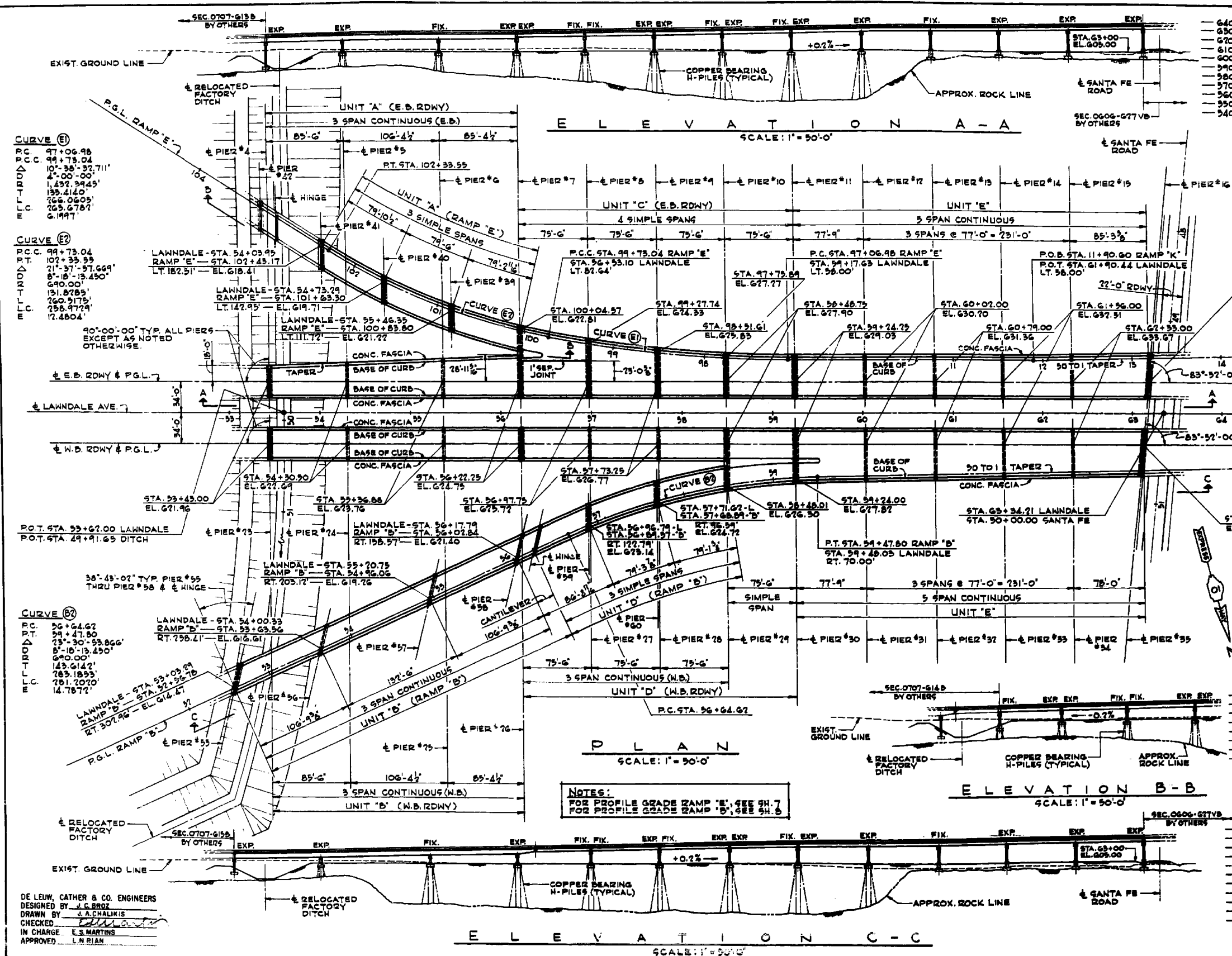

**CURVE (E1)**

P.C.	97+06.98
P.T.	99+73.04
P.C.C.	101+38.51
L.T.	4'-00'-00"
E.L.	1,432.3945'
E.L.	133.4140'
E.L.	766.0605'
E.L.	265.6787'
E.L.	6.1997'

**CURVE (E2)**

P.C.	99+73.04
P.T.	102+33.53
P.C.C.	101+37'-57.669'
L.T.	8'-10'-13.450'
E.L.	690.00'
E.L.	131.8785'
E.L.	760.9175'
E.L.	256.9772'
E.L.	17.4804'

**CURVE (E3)**

P.C.	56+64.62
P.T.	59+47.80
P.C.C.	57'-30'-53.866'
L.T.	8'-10'-13.450'
E.L.	690.00'
E.L.	143.6147'
E.L.	783.1853'
E.L.	281.2020'
E.L.	14.7872'

DE LEUW, CATHAR & CO. ENGINEERS  
DESIGNED BY J.C. BRIZ  
DRAWN BY J.A. CHALIKIS  
CHECKED [Signature]  
IN CHARGE E.S. MARTINS  
APPROVED L.N. RIAN

JOB NO. 1179  
Alfred Benesch & Company  
205 North Michigan Avenue, Suite 2400  
Chicago, Illinois 60601  
312-565-0450 Job No. 10093



FILE NAME =	USER NAME =	DESIGNED -	REVISOR -
0162457.60J16.084.existplan1.dgn	tjenicke	FSM	FSM
		CHECKED -	REVISOR -
		RMM	RMM
		DRAWN -	REVISOR -
		FSM	FSM
		CHECKED -	REVISOR -
		RMM	RMM
		PLOT DATE =	
		12/28/2013	

STATE OF ILLINOIS  
DEPARTMENT OF TRANSPORTATION

EXISTING PLAN INFORMATION (1 OF 26)  
STRUCTURE NO. 016-2457  
SHEET NO. SDX1 OF SDX26 SHEETS

FOR INFORMATION ONLY

F.A.P. RTE.	SECTION	COUNTY	TOTAL SHEETS	SHEET NO.
372	2013-038B-R	COOK	821	459
				CONTRACT NO. 60J16
ILLINOIS FED. AID PROJECT				

X:\100005\10093\Eng\_Docs\_Phase\_1\11\_S\016\_2456\_2457\_1st\_Ave\_cover\_Des\_Plaines\_River\_Volley\Final\2457\_60J16\_084\_existplan1.dgn 2/4/11 PM 6/23/2014