

TYPICAL WINGWALL ELEVATION

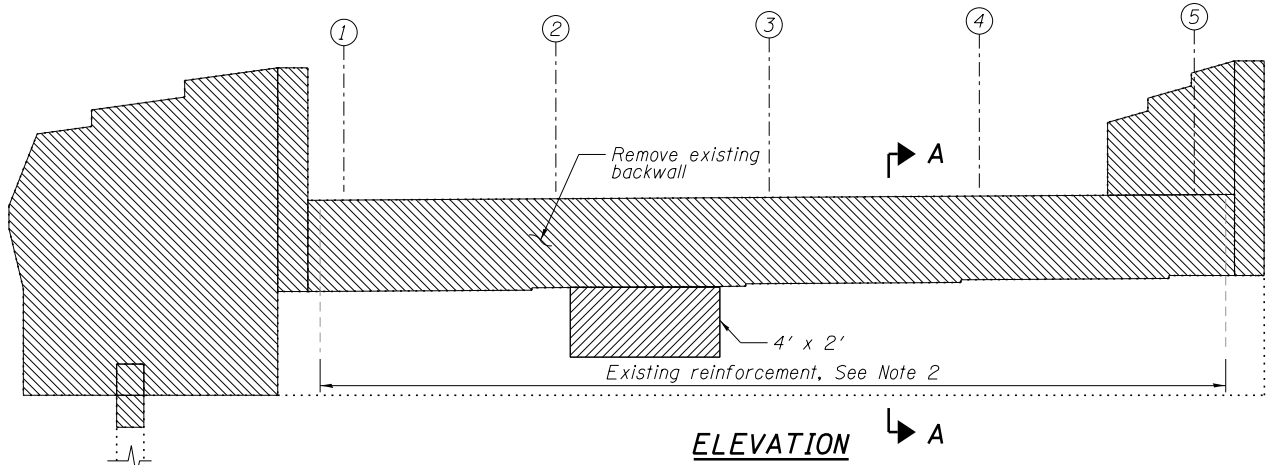

ELEVATION

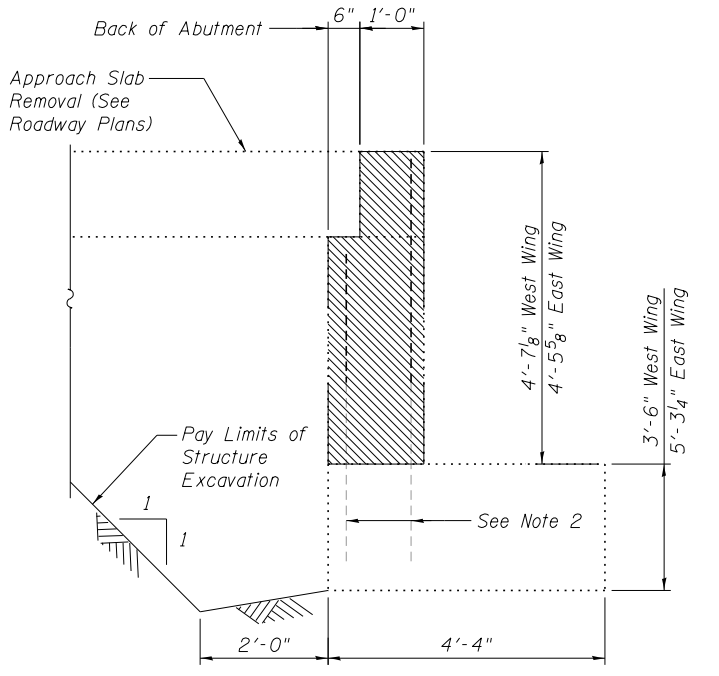

SECTION A-A

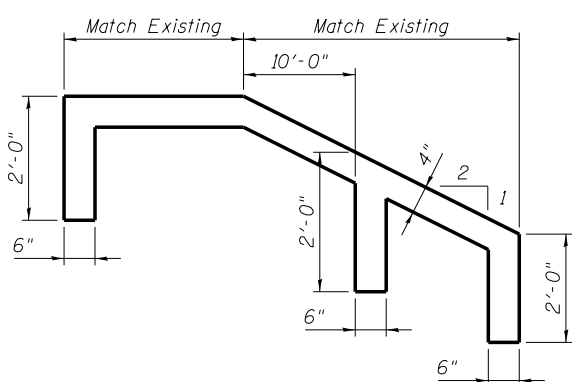

SECTION D-D

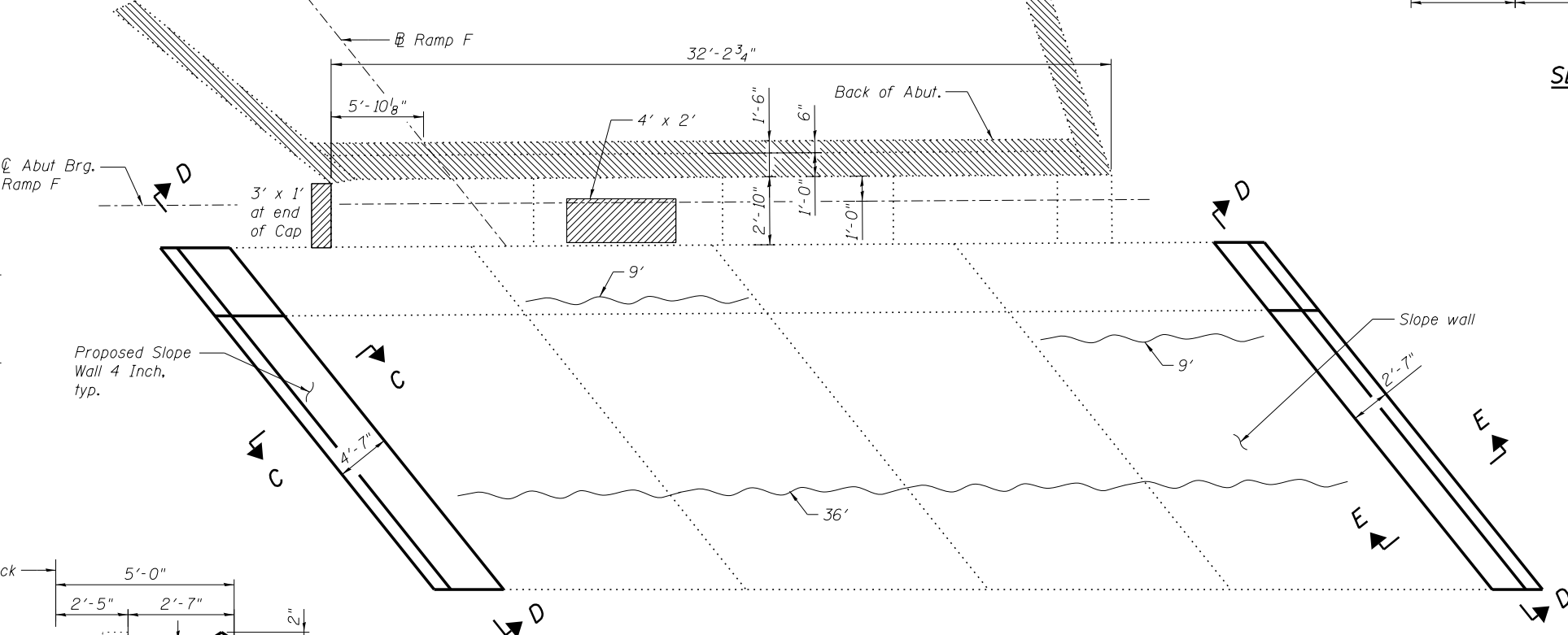

PLAN

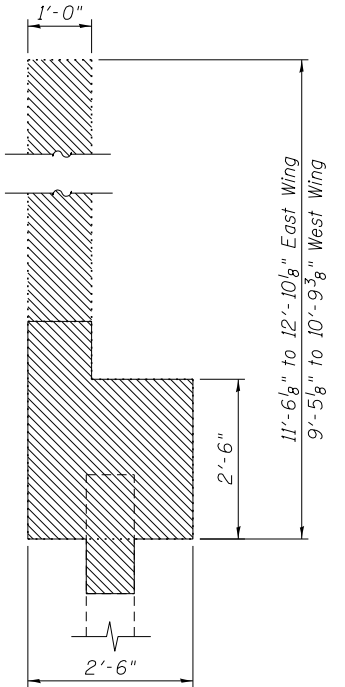

SECTION B-B

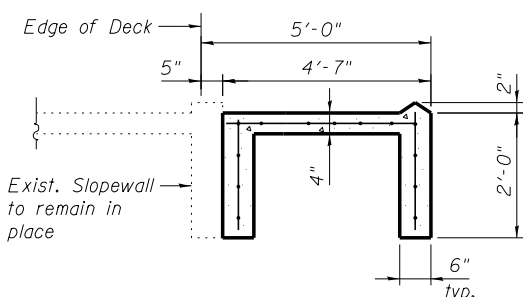

SECTION C-C

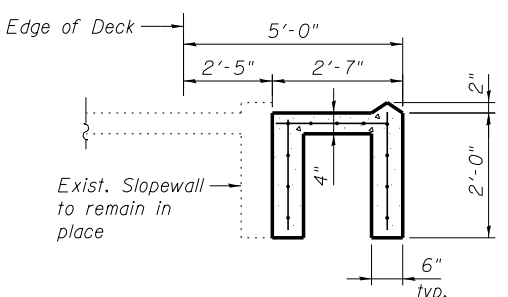

SECTION E-E

- LEGEND**
- Concrete Removal
  - Structural Repair of Concrete (Depth equal to or less than 5 inches)
  - Epoxy Crack Injection

**BILL OF MATERIAL**

ITEM	UNIT	TOTAL
Concrete Removal	Cu. Yd.	16.9
Slope Wall 4 Inch	Sq. Yd.	57
Structural Repair of Concrete (Depth equal to or less than 5 inches)	Sq. Ft.	19
Epoxy Crack Injection	Foot	54

- NOTES:**
- Actual quantities of repairs shall be approved by the Engineer.
  - Existing reinforcement shall be cleaned and incorporated into the new construction. Any reinforcement bars that are damaged during concrete removal operations shall be repaired or replaced using an approved bar splicer or anchorage system. Cost included with Concrete Removal.
  - Slopewall shall be reinforced with welded wire fabric, 6 in. X 6 in. W4.0 x W4.0, weighing 58 lbs per 100 sq ft.
  - Embankment required for for the slopewall widening shall be paid for as "Furnished Excavation".
  - Crack widths are 1/8" ± 1/16" unless otherwise noted.

**benesch**  
engineers · scientists · planners

Alfred Benesch & Company  
205 North Michigan Avenue, Suite 2400  
Chicago, Illinois 60601  
312-565-0450 Job No. 10093

FILE NAME =	USER NAME = jsurber	DESIGNED - JOB	REVISED -
0160486.60J16.066.RampFabutrepair.dgn		CHECKED - AWH	REVISED -
	PLOT SCALE =	DRAWN - FSM	REVISED -
	PLOT DATE = 8/6/2014	CHECKED - AWH	REVISED -

STATE OF ILLINOIS  
DEPARTMENT OF TRANSPORTATION

RAMP F ABUTMENT CONCRETE REMOVAL AND REPAIR DETAILS  
STRUCTURE NO. 016-0486

SHEET NO. SG66 OF SG100 SHEETS

F.A.P. RTE.	SECTION	COUNTY	TOTAL SHEETS	SHEET NO.
373	2013-038B-R	COOK	821	656
CONTRACT NO.			60J16	
ILLINOIS FED. AID PROJECT				

Y:\chicago\100005\10093\Eng\_Docs\Phase\_1\N\N\_016\_0486\_0487\_1st\_Ave.over\_Canal\Final\0486\0160486.60J16.066.RampFabutrepair.dgn 7:30:53 PM 8/6/2014