

F.A. RTE.	SECTION	EXPRESSWAY	TOTAL SHEETS	SHEET NO.
133	0707-626 B	SOUTHWEST	95	54
STA.		TO STA.		
PER. ROAD DIST. NO. 7		ILLINOIS FED. AID PROJECT		

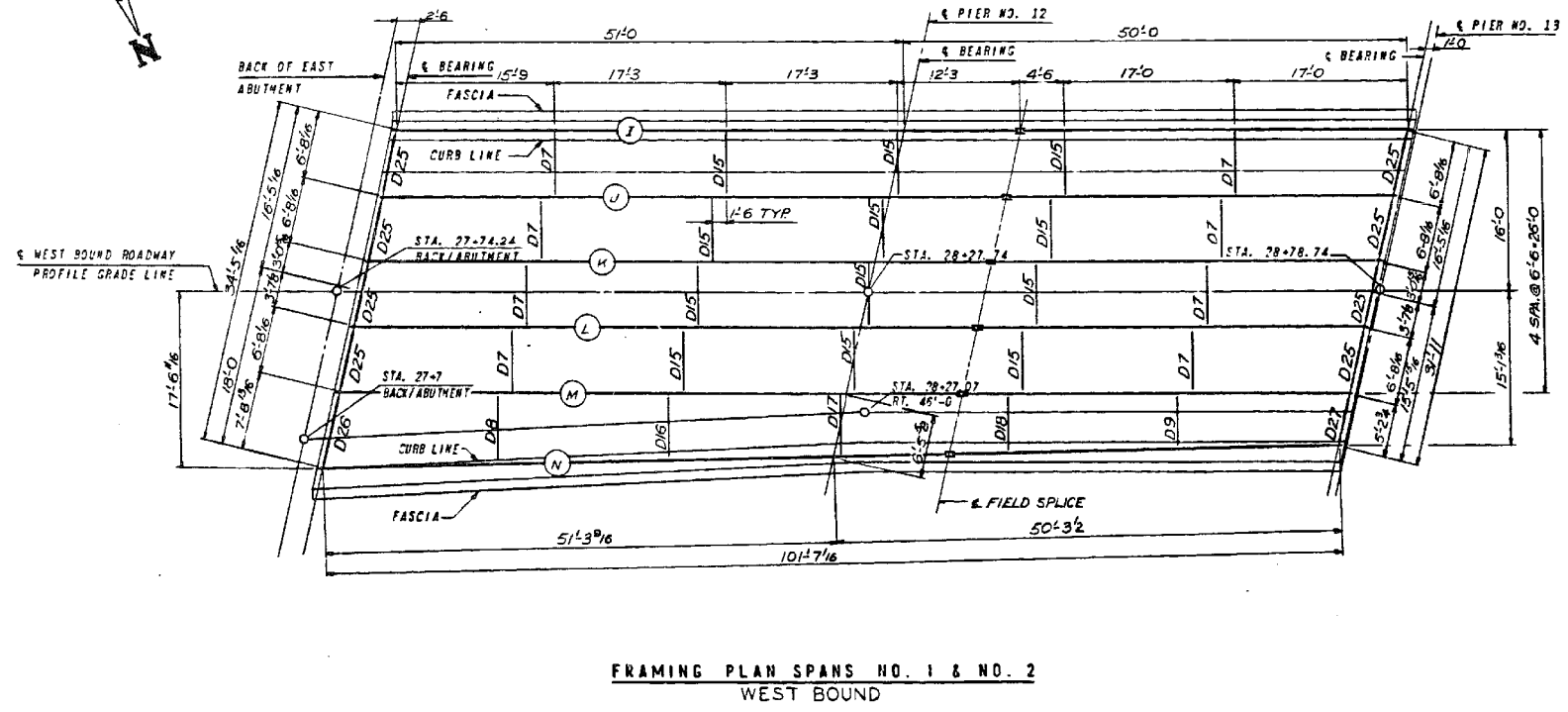
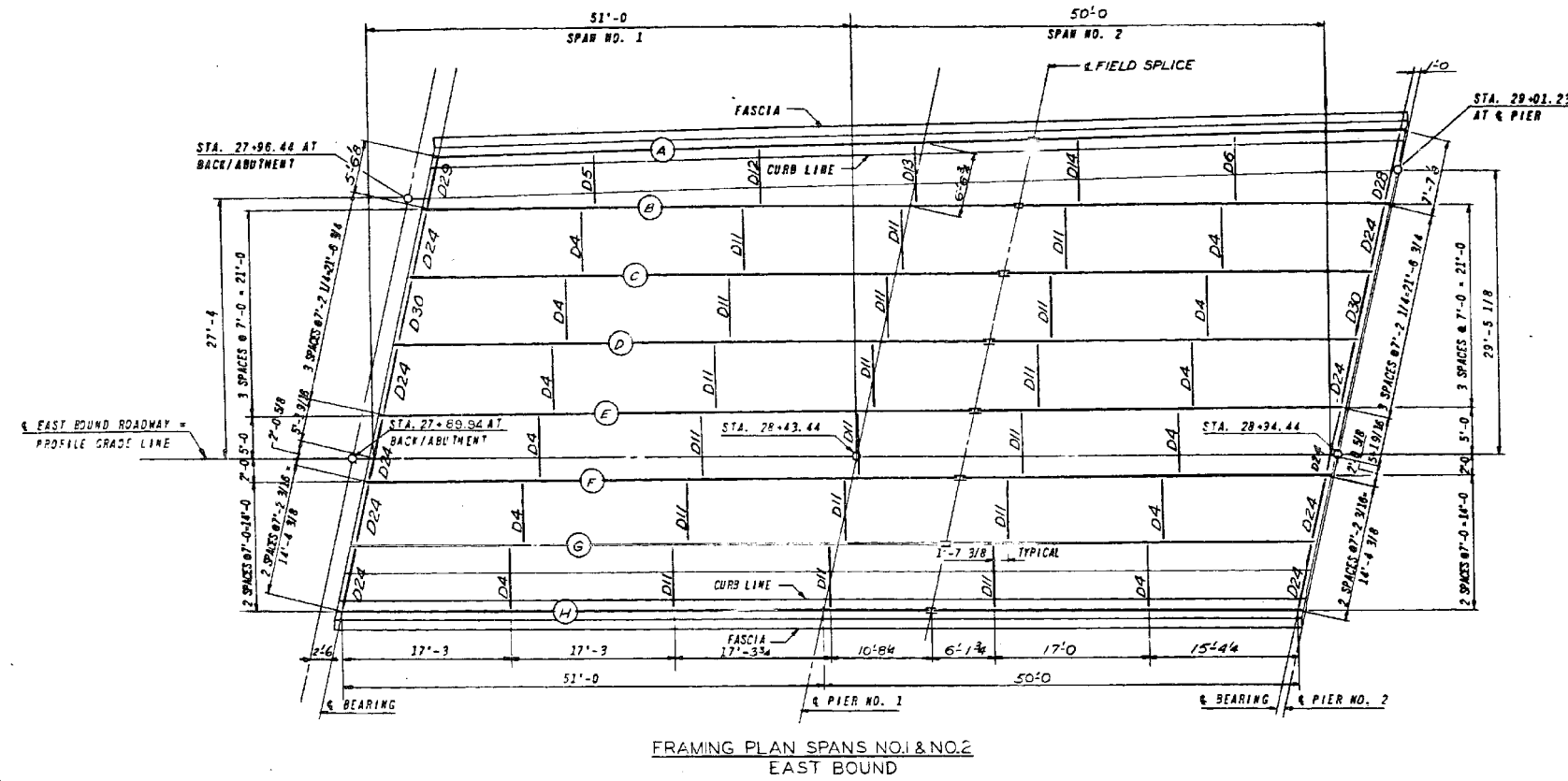

REVISIONS		NAME	DATE
NO.	DESCRIPTION		
DESIGNED	ST.	SCALE: HORIZ. VERT.	DATE 8-5-63
REVIEWED	CWW	DRAWN BY E.G.	CHECKED BY L.D.B.

ILLINOIS DIVISION OF HIGHWAYS
SOUTHWEST EXPRESSWAY
F.A. RT. 133
LAWDALE AVE. STRUCTURE OVER CHICAGO SANITARY AND SHIP CANAL
SECTION 0707-626B
FRAMING PLAN SPANS 1 AND 2 E.B. & W.B.
SCALE: HORIZ. VERT. DATE 8-5-63
DRAWN BY E.G.
CHECKED BY L.D.B.

benesch
engineers · scientists · planners
Alfred Benesch & Company
205 North Michigan Avenue, Suite 2400
Chicago, Illinois 60601
312-565-0450 Job No. 10093

FILE NAME =	0160486.60J16.X18.exist.framing12.dgn
USER NAME =	tjenicke
PLOT SCALE =	
PLOT DATE =	6/23/2014

DESIGNED -	FSM	REVISED -	
CHECKED -	RMM	REVISED -	
DRAWN -	FSM	REVISED -	
CHECKED -	RMM	REVISED -	

STATE OF ILLINOIS
DEPARTMENT OF TRANSPORTATION

EXISTING PLANS FRAMING PLAN SPANS 1 AND 2
STRUCTURE NO. 016-0486

FOR INFORMATION ONLY

F.A.P. RTE.	SECTION	COUNTY	TOTAL SHEETS	SHEET NO.
373	2013-038B-R	COOK	821	708
CONTRACT NO.			60J16	
ILLINOIS FED. AID PROJECT				

SHEET NO. SGX18 OF SGX48 SHEETS

X:\1000005\10093\Eng_Docs_Phase_1\1N_016_0486_0487_1st_Ave_cover_Conc\Final\Final_0486\0160486_60J16_X18.exist.framing12.dgn 2:57:00 PM 6/23/2014