

F.A. RTE	SECTION	EXPRESSWAY	TOTAL SHEETS	SHEET NO.
133	0707-626B	SOUTHWEST		61
STA.		TO STA.		
FED. ROAD DIST. NO. 7		LAWNSIDE		

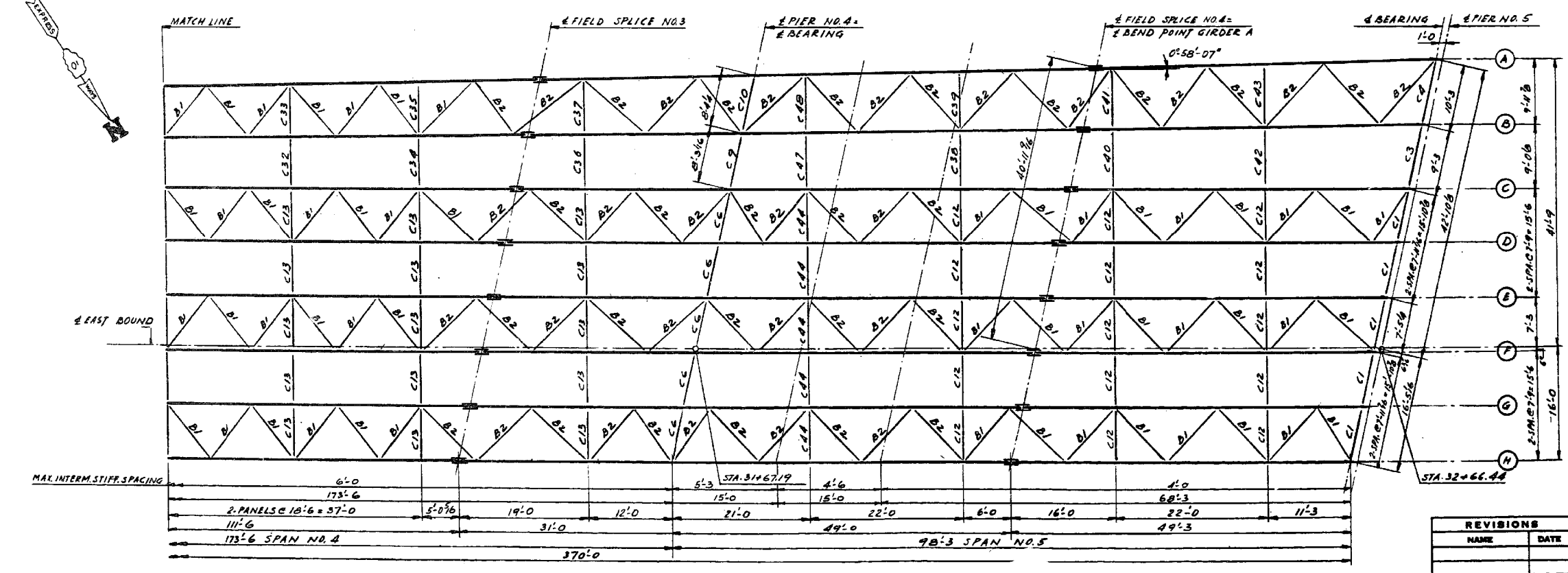
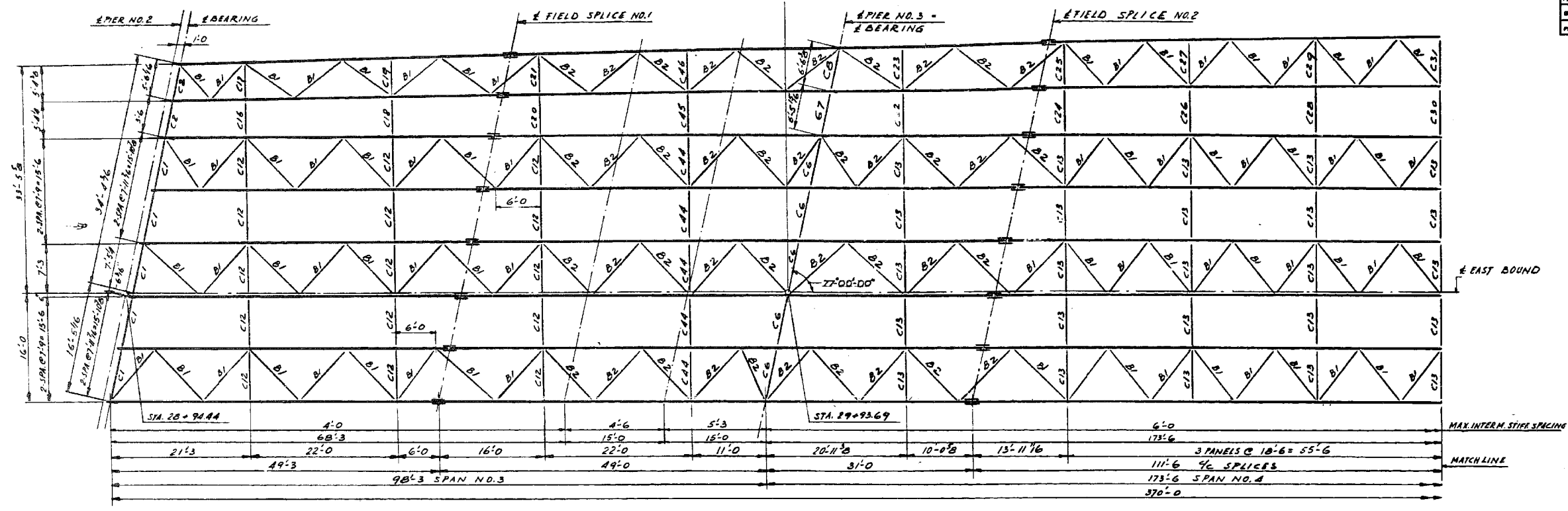

REVISIONS	
NAME	DATE
DESIGNED ST-PK	
REVIEWED CW:W	

ILLINOIS DIVISION OF HIGHWAYS  
**SOUTHWEST EXPRESSWAY**  
 F.A. RT. 133  
 LAWDALE AVE. STRUCTURE OVER  
 CHICAGO SANITARY AND SHIP CANAL  
 SECTION 0707- 626B  
 FRAMING PLAN SPAN 3 THRU 5 E.B.  
 SCALE: HORIZ. 1"=10'-0"  
 VERT. 1"=4'-0"  
 DATE 6-5-63  
 DRAWN BY J.S.  
 CHECKED BY L.D.B.

**benesch**  
 engineers · scientists · planners  
 Alfred Benesch & Company  
 205 North Michigan Avenue, Suite 2400  
 Chicago, Illinois 60601  
 312-565-0450 Job No. 10093

FILE NAME =	USER NAME = tjenicke	DESIGNED - FSM	REVISD -
0160486.60J16.X23.exist.framing35.dgn		CHECKED - RMM	REVISD -
	PLOT SCALE =	DRAWN - FSM	REVISD -
	PLOT DATE = 6/23/2014	CHECKED - RMM	REVISD -

STATE OF ILLINOIS  
 DEPARTMENT OF TRANSPORTATION

EXISTING PLANS FRAMING PLAN SPANS 3 THRU 5  
 STRUCTURE NO. 016-0486

SHEET NO. SGX23 OF SGX48 SHEETS

FOR INFORMATION ONLY

F.A.P. RTE.	SECTION	COUNTY	TOTAL SHEETS	SHEET NO.
373	2013-038B-R	COOK	821	713
CONTRACT NO.			60J16	
ILLINOIS FED. AID PROJECT				

X:\1000005\10093\Eng\_Docs\_Phase\_1\1\SN\_016\_0486\_0487\_1st.Ave.cover\_Canal\Final\Final\_0486\0160486\_60J16.X23.exist.framing35.dgn 2:57:09 PM 6/23/2014