

PLAN	DESIGNED	BY	DATE
	DRAWN		
	CHECKED		
	DATE		
	REVISIONS		
	NO.		
	DATE		
	BY		
	DATE		

PROFILE	DESIGNED	BY	DATE
	DRAWN		
	CHECKED		
	DATE		
	REVISIONS		
	NO.		
	DATE		
	BY		
	DATE		

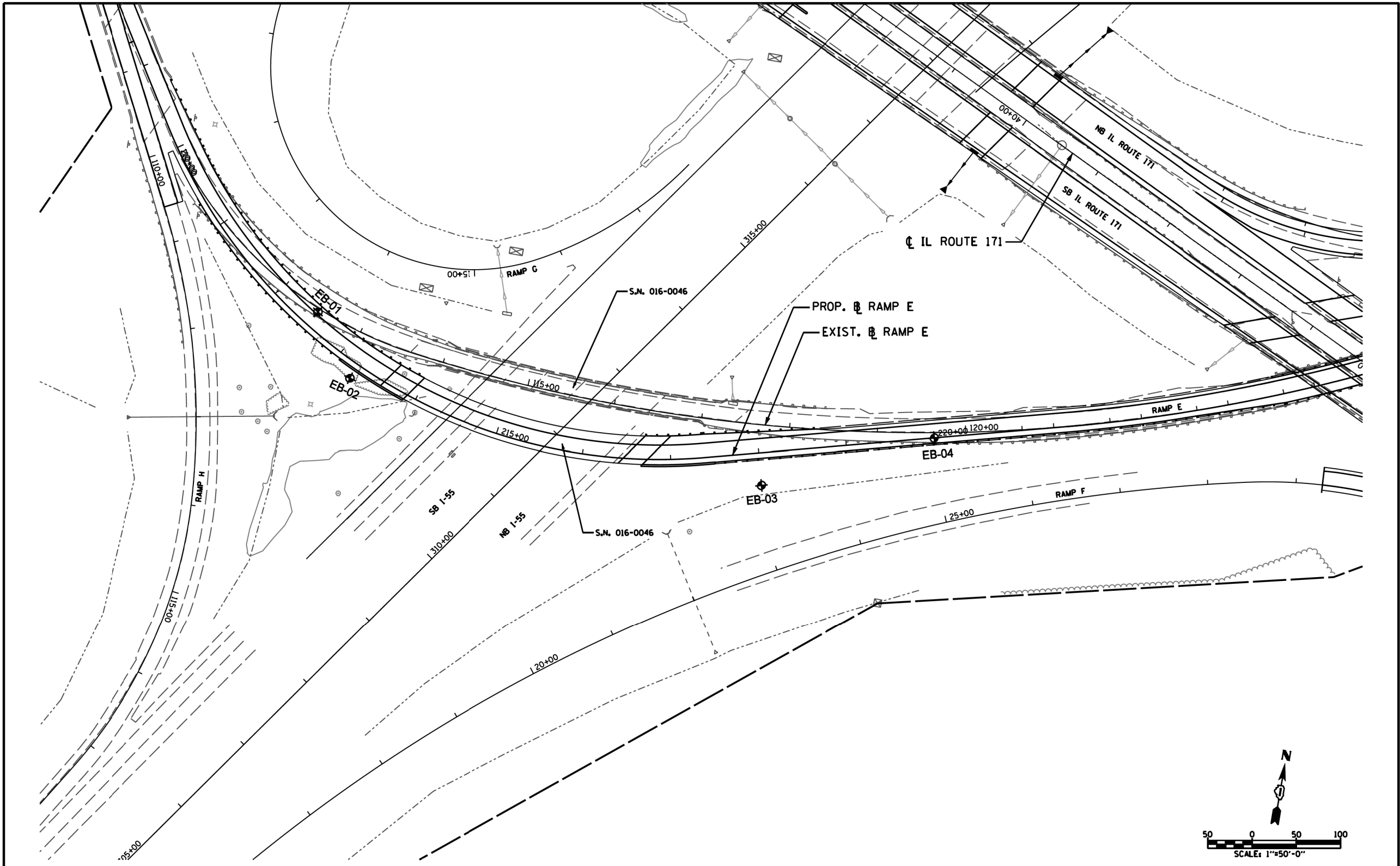

 Geotechnical Engineering & Construction 805 Industrial Center, Suite 204 Naperville, Illinois 60563	USER NAME *	DESIGNED - RWC	REVISED -	STATE OF ILLINOIS DEPARTMENT OF TRANSPORTATION	ILLINOIS ROUTE 171 EXISTING RAMP E SOIL BORING PLAN		F.A.P. RTE.	SECTION	COUNTY	TOTAL SHEETS	SHEET NO.
	PLOT SCALE *	DRAWN - RWC	REVISED -		372	XXX	COOK	1	1	CONTRACT NO. XXX	
PLOT DATE *	CHECKED - AJP	REVISED -		SCALE: 1"=50'	SHEET NO. 1 OF 1 SHEETS	STA. - TO STA. -	FED. ROAD DIST. NO. ILLINOIS FED. AID PROJECT				
	DATE - 6/20/2012	REVISED -									

FILE NAME =	DESIGNED -	REVISED -	STATE OF ILLINOIS DEPARTMENT OF TRANSPORTATION	SOIL BORING PLAN		F.A.P. RTE.	SECTION	COUNTY	TOTAL SHEETS	SHEET NO.			
... \D160J16-sht-bor-01.dgn	DRAWN -	REVISED -				372/373	2013-038B-R	COOK	821	813	CONTRACT NO. 60J16		
USER NAME = tblank	CHECKED -	REVISED -				SCALE:		SHEET	OF	SHEETS	STA.	TO STA.	ILLINOIS FED. AID PROJECT
PLOT DATE = 6/23/2014	DATE -	REVISED -											