

VIEW B-B

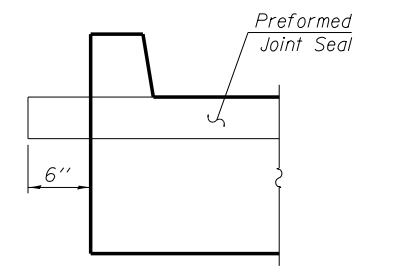

VIEW H-H

MINIMUM BAR LAP
 (Approach)
 #4 bar = 2'-7"
 #5 bar = 3'-3"

- NOTES:**
1. See sheet SB18 for Sections C-C & D-D, and E-E.
 2. The joint opening shall be determined per Article 520.04 except that on jointless structures, the distance described as the bridge length between the nearest fixed bearings each way from the joint shall be taken as half the bridge length plus the approach slab length. The minimum dimension shall be 1/2" for installation purposes.
 3. a47(E) thru a49(E) bar spacings measured along \hat{C} Rdwy.

* Tilt #9 b41(E) bars as required to maintain clearance.
 ** Preformed flexible foam expansion joint filler according to Article 1051.09 of the Std. Specifications; full depth of slab, full length of parapet. Typ. each parapet. Cost included with Concrete Superstructure.

benesch
 engineers - scientists - planners
 Alfred Benesch & Company
 205 North Michigan Avenue, Suite 2400
 Chicago, Illinois 60601
 312-965-0450 Job No. 10093

FILE NAME =	USER NAME = ksnider	DESIGNED - JHG	REVISED -
0161512.60W77.017_EApproach_Plan.dgn		CHECKED - KWS	REVISED -
	PLOT SCALE =	DRAWN - KMS	REVISED -
	PLOT DATE = 6/23/2014	CHECKED - KWS	REVISED -

STATE OF ILLINOIS
DEPARTMENT OF TRANSPORTATION

(Sheet 1 of 2)
EAST APPROACH SLAB PLAN
STRUCTURE NO. 016-1512
 SHEET NO. SB17 OF SB43 SHEETS

F.A.P. RTE.	SECTION	COUNTY	TOTAL SHEETS	SHEET NO.
373	(0707-608&611)HB-B	COOK	177	133
CONTRACT NO. 60W77			ILLINOIS FED. AID PROJECT	

X:\10000S\10093\Eng-Docs-Phase-11\SN-016-1512-SB-1st-Ave-to-NB-155-over-155\Final\0161512.60W77.017_EApproach_Plan.dgn
 10:36:56 AM
 6/23/2014