

MATCH LINE STA. 671+75

MATCH LINE STA. 686+50

IL RTE. 176



PROP. HMA SURFACE REMOVAL, 2 1/4"
PROP. POLY. LEVELING BINDER (MM), IL-4.75, N50, 3/4"
PROP. HMA SURFACE COURSE, MIX "D", N70, 1 1/2"

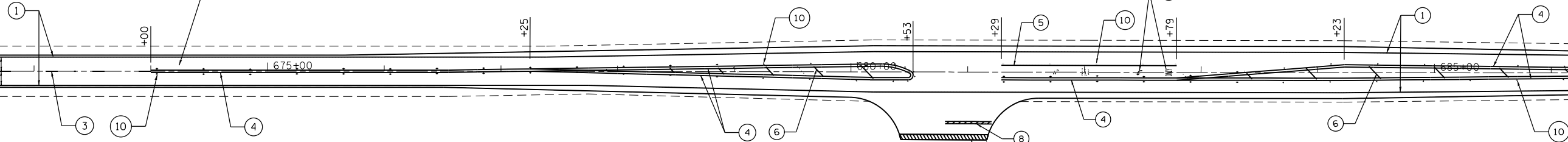

- ① PROP. THERMOPLASTIC PVMT. MARKING 4", LINE, WHITE (TYP.)
- ② PROP. THERMOPLASTIC PVMT. MARKING 4", LINE, YELLOW (TYP.)
- ③ PROP. THERMOPLASTIC PVMT. MARKING 4", 10' LINE - 30' SPACE, YELLOW (TYP.)
- ④ PROP. THERMOPLASTIC PVMT. MARKING 4", DOUBLE YELLOW (TYP.)
- ⑤ PROP. THERMOPLASTIC PVMT. MARKING 6", LINE, WHITE (TYP.)
- ⑥ PROP. THERMOPLASTIC PVMT. MARKING 12", DIAGONALS, YELLOW (TYP.), SEE DISTRICT DETAIL TC-13 FOR PROPER SPACING
- ⑦ PROP. THERMOPLASTIC PVMT. MARKING 12", DIAGONALS, WHITE (TYP.), SEE DISTRICT DETAIL TC-13 FOR PROPER SPACING
- ⑧ PROP. THERMOPLASTIC PVMT. MARKING 24", STOP BAR, WHITE (TYP.)
- ⑨ PROP. THERMOPLASTIC PVMT. MARKING LETTERS & SYMBOLS, WHITE (TYP.)
- ⑩ PROP. RAISED REFLECTIVE MARKERS (TYP.)
- ⑪ PROP. THERMOPLASTIC PVMT. MARKING 6", 2' LINE - 6' SPACE, WHITE (TYP.)

PROP. HMA SURFACE REMOVAL
BUTT JOINT (4.5') (TYP.)

LIPPOLD PARK
EAST ENTRANCE

MATCH LINE STA. 686+50

MATCH LINE STA. 701+25

IL RTE. 176



PROP. HMA SURFACE REMOVAL, 2 1/4"
PROP. POLY. LEVELING BINDER (MM), IL-4.75, N50, 3/4"
PROP. HMA SURFACE COURSE, MIX "D", N70, 1 1/2"

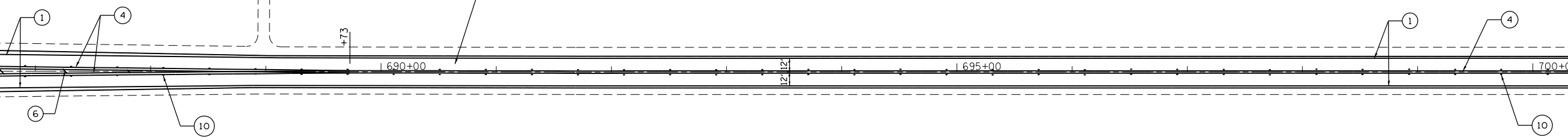

FILE NAME = \$FILEL\$



USER NAME = ccase	DESIGNED - JMT	REVISED -
DRAWN - CC	REVISED -	
PLOT SCALE = 100.0000' / 1" =	CHECKED - TM	REVISED -
PLOT DATE = 8/19/2014	DATE - 07/14/2014	REVISED -

STATE OF ILLINOIS
DEPARTMENT OF TRANSPORTATION

IL RTE. 176 FROM IL RTE. 47 TO US RTE. 14 (VIRGINIA ST.)
ROADWAY AND PAVEMENT MARKING PLAN

SCALE: SHEET 7 OF 8 SHEETS STA. 671+75 TO STA. 701+25

F.A.P. RTE.	SECTION	COUNTY	TOTAL SHEETS	SHEET NO.
335	(105&120)RS-8	McHENRY	21	12
CONTRACT NO. 60Y59				
ILLINOIS FED. AID PROJECT				