

**GENERAL NOTES**

1. Reinforcement bars designated (E) shall be epoxy coated.
2. Plan dimensions and details relative to existing plans are subject to nominal construction variations. The Contractor shall field verify existing dimensions and details affecting new construction and make necessary approved adjustments prior to construction or ordering of materials. Such variations shall not be cause for additional compensation for a change in scope of work, however, the Contractor will be paid for the quantity actually furnished at the unit price bid for the work.

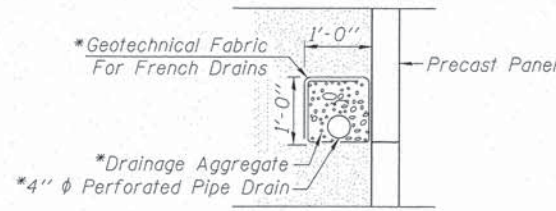

**PIPE UNDERDRAIN DETAIL**

\*Included in the cost of Pipe Underdrains for Structures 4".

**Note:**

All drainage system components shall extend to 2'-0" from the end of each MSE wall except an outlet pipe shall extend until intersecting with the side slopes. The pipes shall drain into concrete headwalls. (See Article 601.05 of the Standard Specifications and Highway Standard 601101).

**INDEX OF SHEETS**

- 1-2 General Plan and Elevation - South Retaining Walls
- 3 General Plan and Elevation - North Retaining Walls
- 4 General Data
- 5 Moment Slab Plan and Elevation - Southeast Retaining Wall 1
- 6 Moment Slab Plan and Elevation - Southeast Retaining Wall 2
- 7 Moment Slab Plan and Elevation - Northeast Retaining Wall
- 8 Retaining Wall
- 9 Transmission Main Protection System
- 10 Transmission Main Protection System Details
- 11 Bicycle Railing Details
- 12-16 Boring Logs

**TOTAL BILL OF MATERIAL**

| Item  | Unit    | Total  |
|---|---------|--------|
| Earth Excavation                                | Cu. Yd. | 570    |
| Structure Excavation                            | Cu. Yd. | 2473   |
| Concrete Structures                             | Cu. Yd. | 16.8   |
| Concrete Superstructure                         | Cu. Yd. | 129.8  |
| Form Liner Textured Surface                     | Sq. Ft. | 6476   |
| Protective Coat                                 | Sq. Yd. | 308    |
| Reinforcement Bars, Epoxy Coated                | Pound   | 20,720 |
| Bicycle Railing                                 | Foot    | 430    |
| Parapet Railing                                 | Foot    | 303    |
| Micro-Piles                                     | Each    | 20     |
| Micropile Proof Load Test                       | Each    | 1      |
| Furnishing and Erecting Precast Concrete Panels | Each    | 6      |
| Construction Vibration Monitoring               | L Sum   | 0.5    |
| Mechanically Stabilized Earth Retaining Wall    | Sq. Ft. | 8,890  |
| Pipe Underdrains for Structures 4"              | Foot    | 937    |

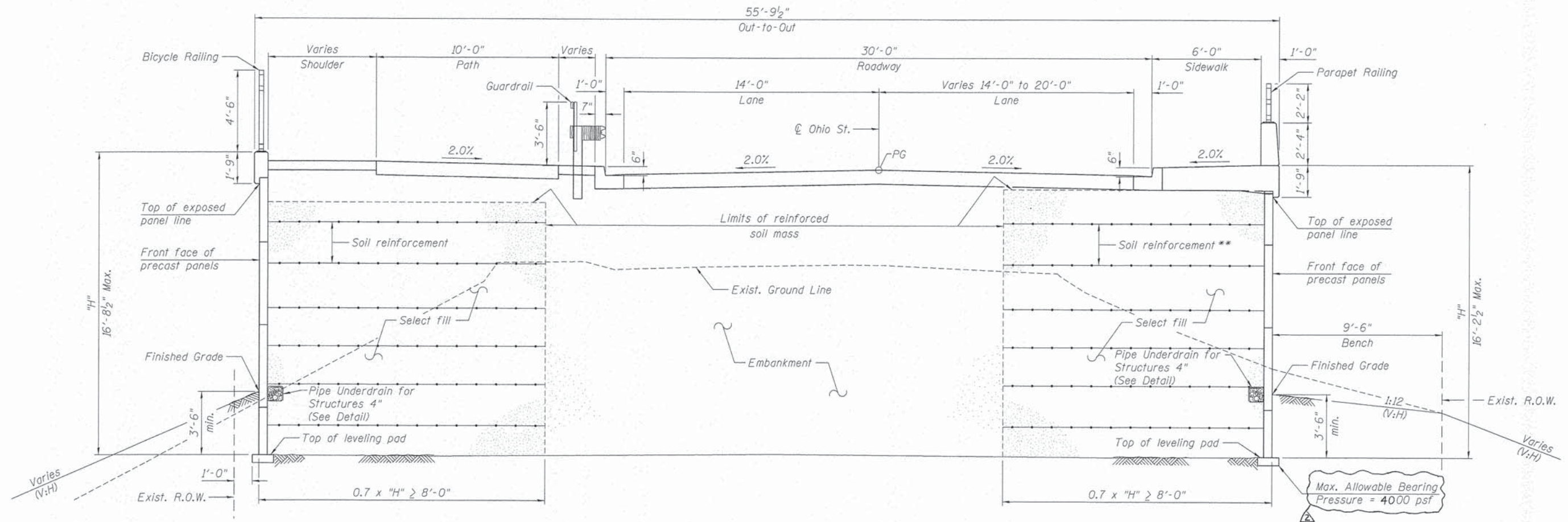

**CROSS SECTION THROUGH MSE WALLS**

(Looking North)

\*\*The M.S.E. wall supplier's internal stability design shall account for the anchorage slab's bearing pressure surcharge of 1.0 ksf and horizontal sliding force of 0.5 kips/ft of wall.

5/2/2014 5:35:47 PM - G:\CHN\030\B-Ridge\CADD\Sheets\0459942-63859-038-WDATA.dgn



|                         |                |                  |
|-------------------------|----------------|------------------|
| USER NAME = jmsakow     | DESIGNED - WJC | REVISED - 9-5-14 |
| PLOT SCALE = 3/8"=1'-0" | CHECKED - JRM  | REVISED -        |
| PLOT DATE = 5/12/2014   | DRAWN - WJC    | REVISED -        |
|                         | CHECKED - MDS  | REVISED -        |

**STATE OF ILLINOIS  
DEPARTMENT OF TRANSPORTATION**

**GENERAL DATA  
RETAINING WALLS**

SHEET NO. 4 OF 16 SHEETS

|                    |                        |             |                  |               |
|--------------------|------------------------|-------------|------------------|---------------|
| F.A.P. RTE. 4087   | SECTION 08-00278-00-BR | COUNTY KANE | TOTAL SHEETS 136 | SHEET NO. 109 |
| CONTRACT NO. 63859 |                        |             |                  |               |

ILLINOIS FED. AID PROJECT