

GUARDRAIL SCHEDULE

LOCATION	STATION	TO	STATION	63000001 STEEL PLATE BEAM GUARDRAIL TYPE A 8 FT POSTS (FOOT)	63100045 TRAFFIC BARRIER TERMINAL TYPE 2 (EACH)	63100167 TRAFFIC BARRIER TERMINAL TYPE 1(SPECIAL) TANGENT (EACH)	78200410 GUARDRAIL MARKER TYPE A (EACH)	78201000 TERMINAL MARKER DIRECT APPLIED (EACH)
E.B. P.L. SHLDR	591+40.00		591+90.00			1.0		1.0
E.B. P.L. SHLDR	591+90.00		592+90.00	100.0			4.0	
E.B. P.L. SHLDR	592+90.00		593+02.50		1.0			1.0
W.B. D.L. SHLDR	593+35.50		593+48.00		1.0			1.0
W.B. D.L. SHLDR	593+48.00		595+23.00	175.0			4.0	
W.B. D.L. SHLDR	595+23.00		595+73.00			1.0		1.0
W.B. P.L. SHLDR	593+19.50		593+32.00		1.0			1.0
W.B. P.L. SHLDR	593+32.00		595+32.00	200.0			4.0	
W.B. P.L. SHLDR	595+32.00		595+82.00			1.0		1.0
SUB-TOTAL =				475.0	3.0	3.0	12.0	6.0
				FOOT	EACH	EACH	EACH	EACH

OVERHEAD SIGN STRUCTURE

I-74 WB - MM 189.05

STRUCTURE NO.

5 S 010 1074 L189.05



SITE PLAN / CONDUIT & CABLE LAYOUT

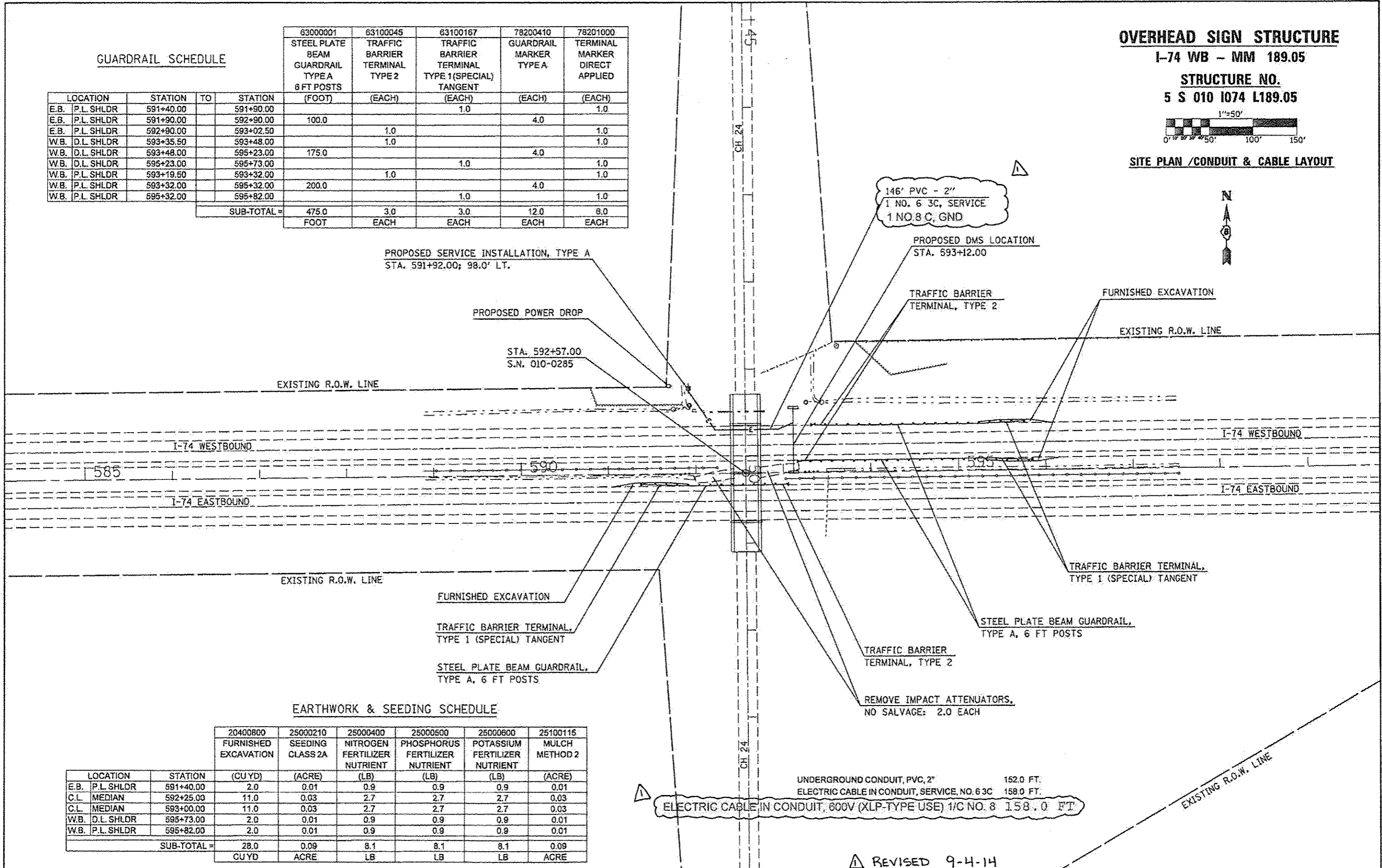

PROPOSED SERVICE INSTALLATION, TYPE A
STA. 591+92.00; 98.0' LT.

PROPOSED POWER DROP

STA. 592+57.00
S.N. 010-0285

146' PVC - 2"
1 NO. 6 3C, SERVICE
1 NO. 8 C, GND

PROPOSED DMS LOCATION
STA. 593+12.00

TRAFFIC BARRIER
TERMINAL, TYPE 2

FURNISHED EXCAVATION

EXISTING R.O.W. LINE

I-74 WESTBOUND

I-74 WESTBOUND

585

590

595

I-74 EASTBOUND

I-74 EASTBOUND

EXISTING R.O.W. LINE

FURNISHED EXCAVATION

TRAFFIC BARRIER TERMINAL,
TYPE 1 (SPECIAL) TANGENT

STEEL PLATE BEAM GUARDRAIL,
TYPE A, 6 FT POSTS

TRAFFIC BARRIER TERMINAL,
TYPE 1 (SPECIAL) TANGENT

STEEL PLATE BEAM GUARDRAIL,
TYPE A, 6 FT POSTS

TRAFFIC BARRIER
TERMINAL, TYPE 2

REMOVE IMPACT ATTENUATORS,
NO SALVAGE: 2.0 EACH

EARTHWORK & SEEDING SCHEDULE

LOCATION	STATION	20400800 FURNISHED EXCAVATION (CU YD)	25000210 SEEDING CLASS 2A (ACRE)	25000400 NITROGEN FERTILIZER NUTRIENT (LB)	25000500 PHOSPHORUS FERTILIZER NUTRIENT (LB)	25000600 POTASSIUM FERTILIZER NUTRIENT (LB)	25100115 MULCH METHOD 2 (ACRE)
E.B. P.L. SHLDR	591+40.00	2.0	0.01	0.9	0.9	0.9	0.01
C.L. MEDIAN	592+25.00	11.0	0.03	2.7	2.7	2.7	0.03
C.L. MEDIAN	593+00.00	11.0	0.03	2.7	2.7	2.7	0.03
W.B. D.L. SHLDR	595+73.00	2.0	0.01	0.9	0.9	0.9	0.01
W.B. P.L. SHLDR	595+82.00	2.0	0.01	0.9	0.9	0.9	0.01
SUB-TOTAL =		28.0	0.09	8.1	8.1	8.1	0.09
		CUYD	ACRE	LB	LB	LB	ACRE

ELECTRIC CABLE IN CONDUIT, 600V (XLP-TYPE USE) 1/C NO. 8 158.0 FT

REVISD 9-4-14