

PTZ CAMERA INSTALLATION

**UNIVERSITY AVE.
&
I-74**

(NOT TO SCALE)

CAMERA & CONDUIT /CABLE LAYOUT

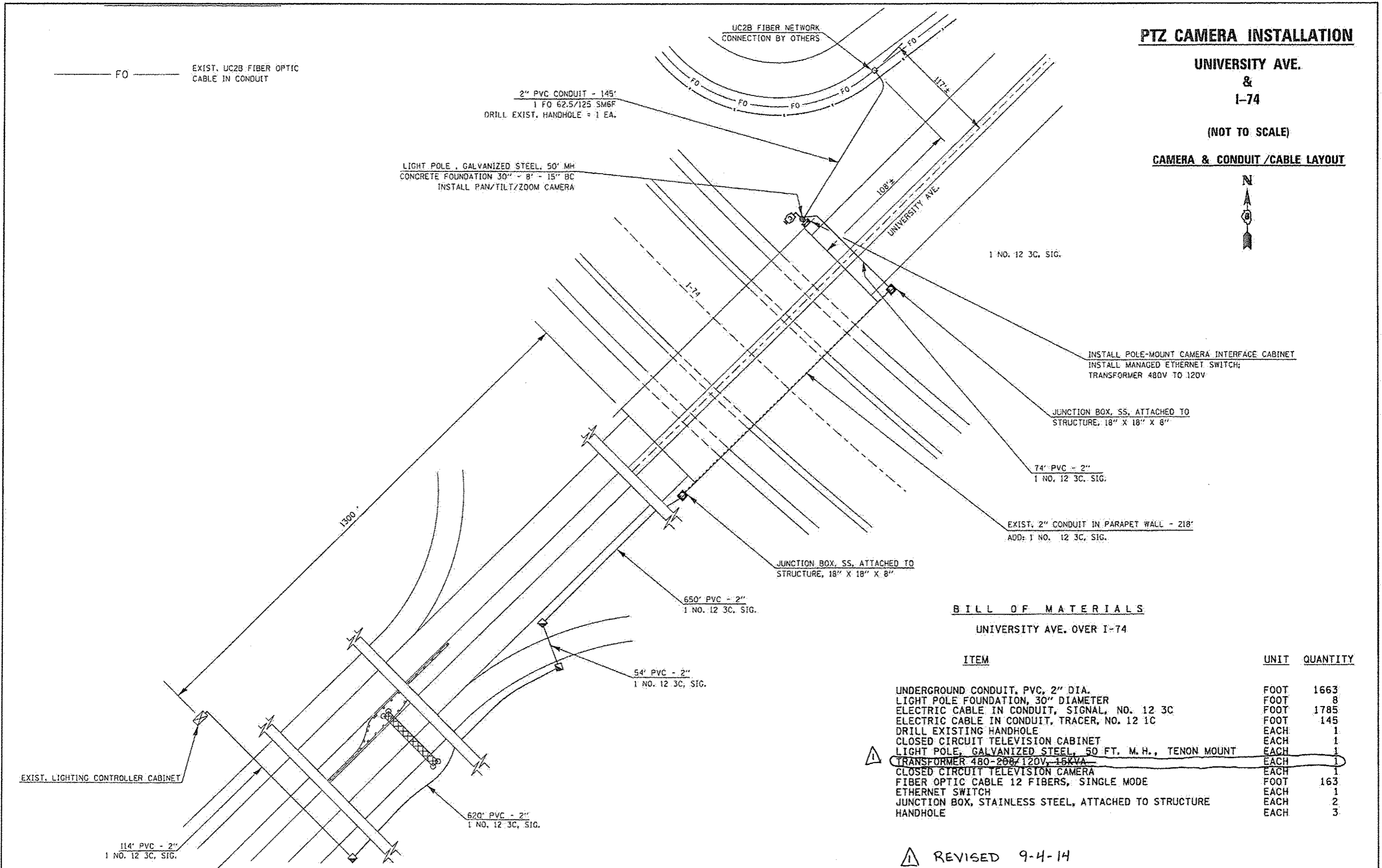

BILL OF MATERIALS

UNIVERSITY AVE. OVER I-74

ITEM	UNIT	QUANTITY
UNDERGROUND CONDUIT, PVC, 2" DIA.	FOOT	1663
LIGHT POLE FOUNDATION, 30" DIAMETER	FOOT	8
ELECTRIC CABLE IN CONDUIT, SIGNAL, NO. 12 3C	FOOT	1785
ELECTRIC CABLE IN CONDUIT, TRACER, NO. 12 1C	FOOT	145
DRILL EXISTING HANDHOLE	EACH	1
CLOSED CIRCUIT TELEVISION CABINET	EACH	1
LIGHT POLE, GALVANIZED STEEL, 50 FT. M.H., TENON MOUNT	EACH	1
TRANSFORMER 480-208/120V-15KVA	EACH	1
CLOSED CIRCUIT TELEVISION CAMERA	EACH	1
FIBER OPTIC CABLE 12 FIBERS, SINGLE MODE	FOOT	163
ETHERNET SWITCH	EACH	1
JUNCTION BOX, STAINLESS STEEL, ATTACHED TO STRUCTURE	EACH	2
HANDHOLE	EACH	3

REVISD 9-4-14

FILE NAME >	USER NAME : ccarlook.jd	DESIGNED -	REVISED -	STATE OF ILLINOIS DEPARTMENT OF TRANSPORTATION	F.A.P. R/E.	SECTION	COUNTY	TOTAL SHEETS	SHEET NO.	
or\p\work\p\idos\ccarlook.jd\8248463.VP	Z camera plans.dgn	DRAWN -	REVISED -		VAR.	FY2014 ITS-1	CHAMPAIGN	71	42	
PLOT SCALE x 1/8"=1'-0"		CHECKED -	REVISED -		SCALE:					
#MODELNAME#	PLOT DATE x 6/26/2014	DATE -	REVISED -		SHEET	OF	SHEETS	STA.	TO STA.	CONTRACT NO: 70A26
										ILLINOIS FED. AID PROJECT