

FIBER OPTIC BACKBONE CONNECTION

**SPRINGFIELD AVE.
&
3RD /4TH ST.**

(NOT TO SCALE)

CONDUIT & CABLE LAYOUT

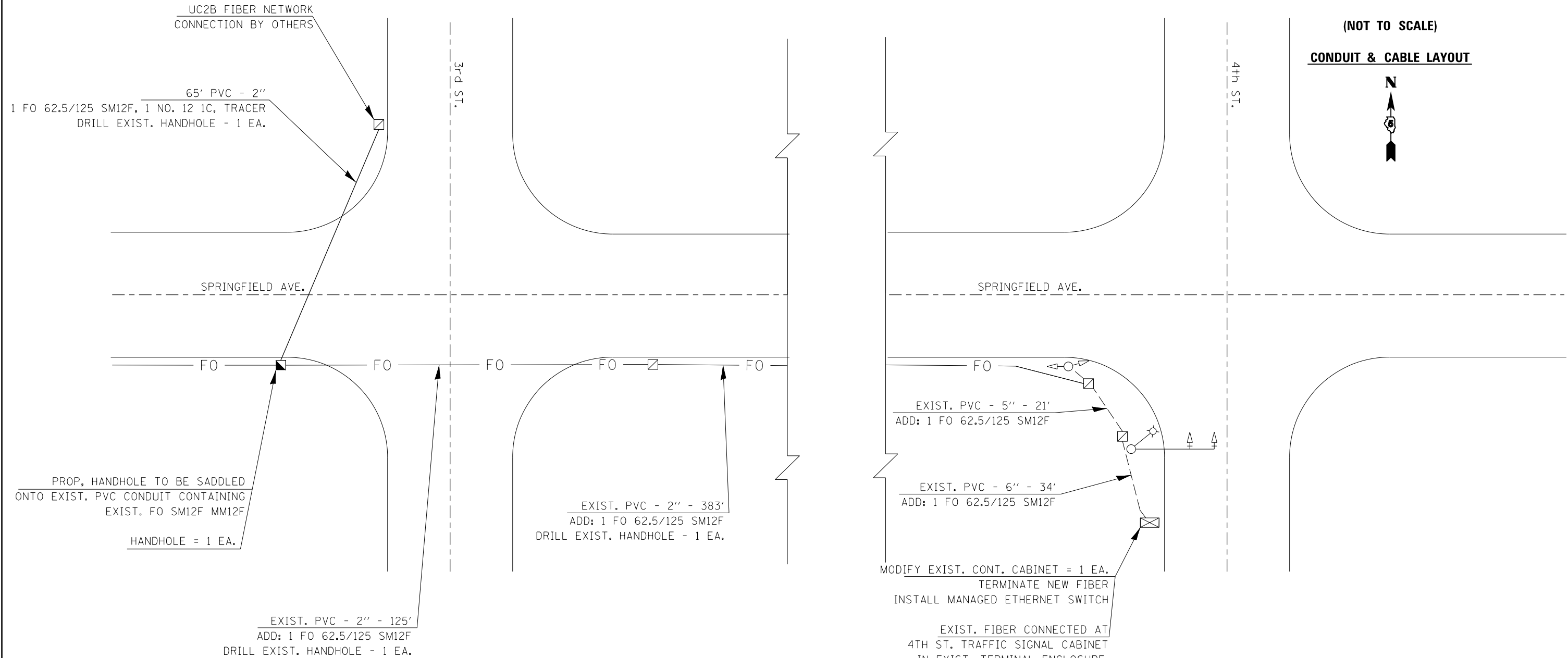

B I L L O F M A T E R I A L S
SPRINGFIELD AVE. - 3RD. ST. TO 4TH ST.

ITEM	UNIT	QUANTITY
UNDERGROUND CONDUIT, PVC, 2" DIA.	FOOT	65
HANDHOLE	EACH	1
DRILL EXISTING HANDHOLE	EACH	1
ETHERNET SWITCH	EACH	1
FIBER OPTIC CABLE 12 FIBERS, SINGLE MODE	FOOT	667
ELECTRIC CABLE IN CONDUIT, TRACER, NO. 12 1C	FOOT	65
MODIFY EXISTING CONTROLLER CABINET	EACH	1

FO ——— EXIST. UC2B FIBER OPTIC CABLE IN CONDUIT