

**FIBER OPTIC CONNECTION**

**I-57  
0.5 NORTH  
OF  
MARKET ST.**

**LEVERETTE STORAGE**

(NOT TO SCALE)

**CONDUIT /CABLE LAYOUT**

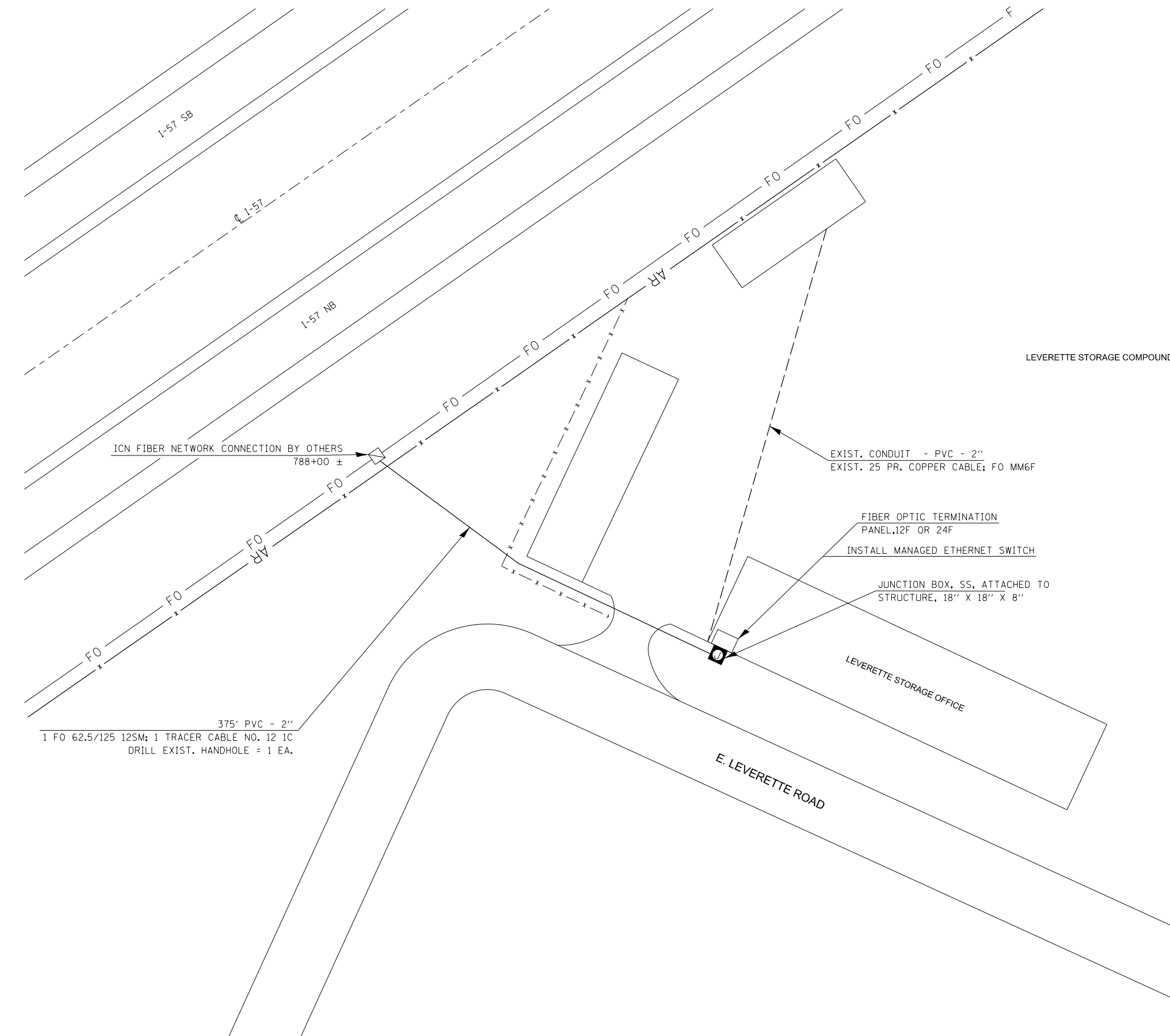

ICN FIBER NETWORK CONNECTION BY OTHERS  
788+00 ±

EXIST. CONDUIT - PVC - 2"  
EXIST. 25 PR. COPPER CABLE; FO MM6F

FIBER OPTIC TERMINATION  
PANEL, 12F OR 24F  
INSTALL MANAGED ETHERNET SWITCH

JUNCTION BOX, SS, ATTACHED TO  
STRUCTURE, 18" X 18" X 8"

**B I L L O F M A T E R I A L S**

**I-57 AT LEVERETTE STORAGE**

ITEM	UNIT	QUANTITY
UNDERGROUND CONDUIT, PVC, 2" DIA.	FOOT	375
JUNCTION BOX, STAINLESS STEEL, ATTACHED TO STRUCTURE	EACH	1
DRILL EXISTING HANDHOLE	EACH	1
ELECTRIC CABLE IN CONDUIT, TRACER, NO. 12 1C	FOOT	375
FIBER OPTIC CABLE 12 FIBERS, SINGLE MODE	FOOT	772
FIBER OPTIC TERMINATION PANEL, 12 F OR 24F	EACH	1
ETHERNET SWITCH	EACH	1

375' PVC - 2"  
1 FO 62.5/125 12SM; 1 TRACER CABLE NO. 12 1C  
DRILL EXIST. HANDHOLE = 1 EA.

FILE NAME =	USER NAME = ceorlockjd	DESIGNED -	REVISED -
c:\pwork\work\pwork\ceorlockjd\0340463\P	Z camera plans.dgn	DRAWN -	REVISED -
\$MODELNAME\$	PLOT SCALE = 100.0000' / in.	CHECKED -	REVISED -
	PLOT DATE = 6/26/2014	DATE -	REVISED -

**STATE OF ILLINOIS  
DEPARTMENT OF TRANSPORTATION**

SCALE: SHEET OF SHEETS STA. TO STA.

F.A.P. RTE.	SECTION	COUNTY	TOTAL SHEETS	SHEET NO.
VAR.	FY2014 ITS-1	CHAMPAIGN	71	50
			CONTRACT NO. 70A26	
ILLINOIS FED. AID PROJECT				