

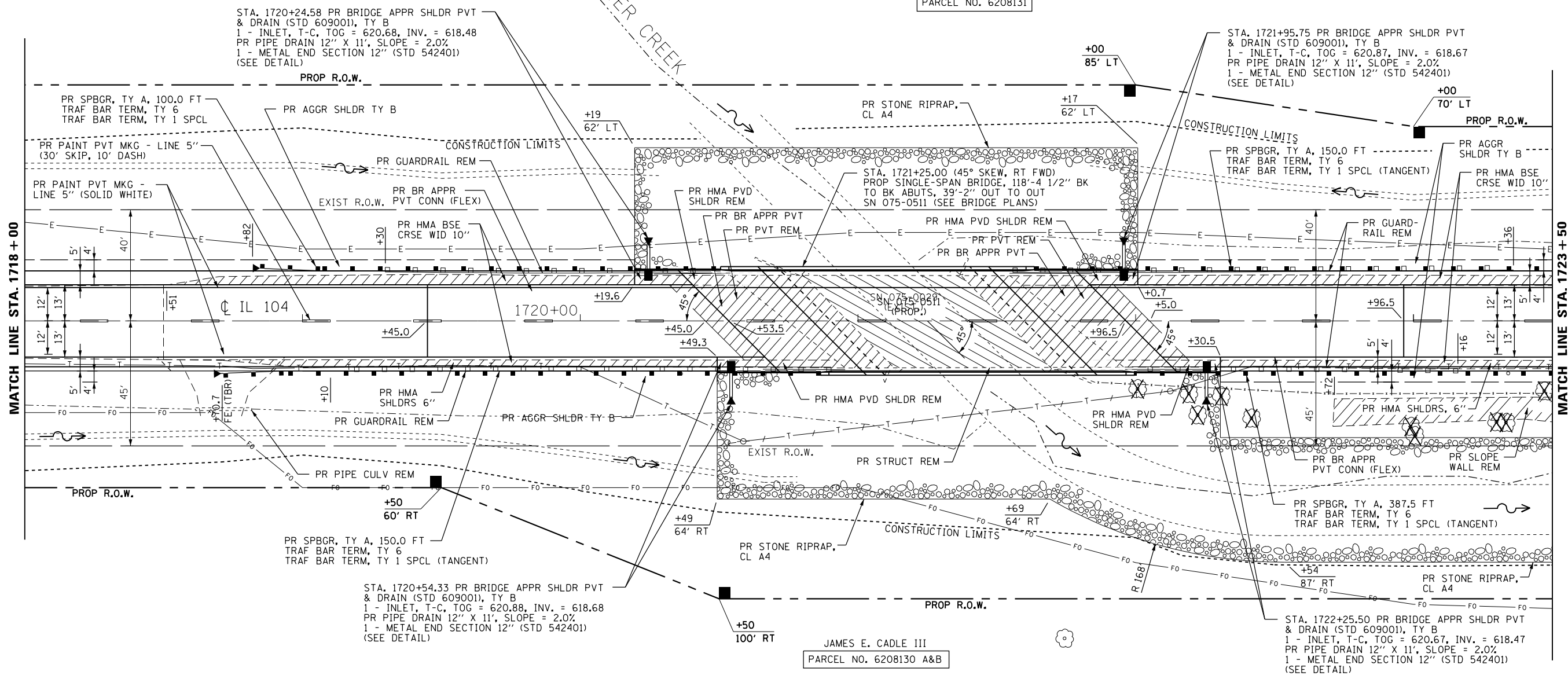

SEC 15, T3S, R4W, 4th PM

WEBEL FARMS II, LLC
PARCEL NO. 6208131



SEC 15, T3S, R4W, 4th PM

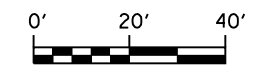

FILE NAME = I:\0807404-IL104 Over Brower Creek\CADD\to\CADsheets\CADsheets_JMC\0672861-sh4-PLN08.DWG	USER NAME = jowley	DESIGNED -	REVISED -	STATE OF ILLINOIS DEPARTMENT OF TRANSPORTATION	PLAN SHEET STA. 1718 + 00 TO STA. 1723 + 50			F.A.P. R.E. = 745	SECTION = 108B-3	COUNTY = PIKE	TOTAL SHEETS = 69	SHEET NO. = 25
	PLOT SCALE = 40.0000' / in.	CHECKED -	REVISED -		SCALE:	SHEET NO. OF SHEETS	STA. TO STA.	CONTRACT NO. 72B61				
PLOT DATE = 6/12/2014	DATE -	REVISED -	REVISED -	FED. ROAD DIST. NO. 6 ILLINOIS FED. AID PROJECT								