

**DEAD LOAD DEFLECTION DIAGRAM**

(Includes weight of concrete only.)

**Note:**

The above deflections are not to be used in the field if the engineer is working from the grade elevations adjusted for dead load deflections as shown on sheets 5 and 6 of 17.

**WEST EDGE OF DECK**

Location	Station	Offset	Theoretical Grade Elevations	Theoretical Grade Elevations Adjusted For Dead Load Deflection
Bk. S. Abut.	899+61.38	-16.50	677.16	677.16
☉ Brg. S. Abut.	899+62.67	-16.50	677.17	677.17
A	899+72.67	-16.50	677.22	677.23
B	899+82.67	-16.50	677.27	677.28
☉ S. Pier	899+90.38	-16.50	677.31	677.31
C	900+00.38	-16.50	677.38	677.38
D	900+10.38	-16.50	677.44	677.44
☉ N. Pier	900+18.46	-16.50	677.50	677.50
E	900+28.46	-16.50	677.58	677.59
F	900+38.46	-16.50	677.66	677.67
☉ Brg. N. Abut.	900+46.17	-16.50	677.73	677.73
Bk. N. Abut.	900+47.46	-16.50	677.74	677.74

**WEST EDGE OF ROADWAY**

Location	Station	Offset	Theoretical Grade Elevations	Theoretical Grade Elevations Adjusted For Dead Load Deflection
Bk. S. Abut.	899+60.18	-12.00	677.25	677.25
☉ Brg. S. Abut.	899+61.47	-12.00	677.26	677.26
A	899+71.47	-12.00	677.30	677.32
B	899+81.47	-12.00	677.36	677.37
☉ S. Pier	899+89.18	-12.00	677.40	677.40
C	899+99.18	-12.00	677.46	677.46
D	900+09.18	-12.00	677.53	677.53
☉ N. Pier	900+17.26	-12.00	677.59	677.59
E	900+27.26	-12.00	677.66	677.68
F	900+37.26	-12.00	677.74	677.76
☉ Brg. N. Abut.	900+44.97	-12.00	677.81	677.81
Bk. N. Abut.	900+46.26	-12.00	677.82	677.82

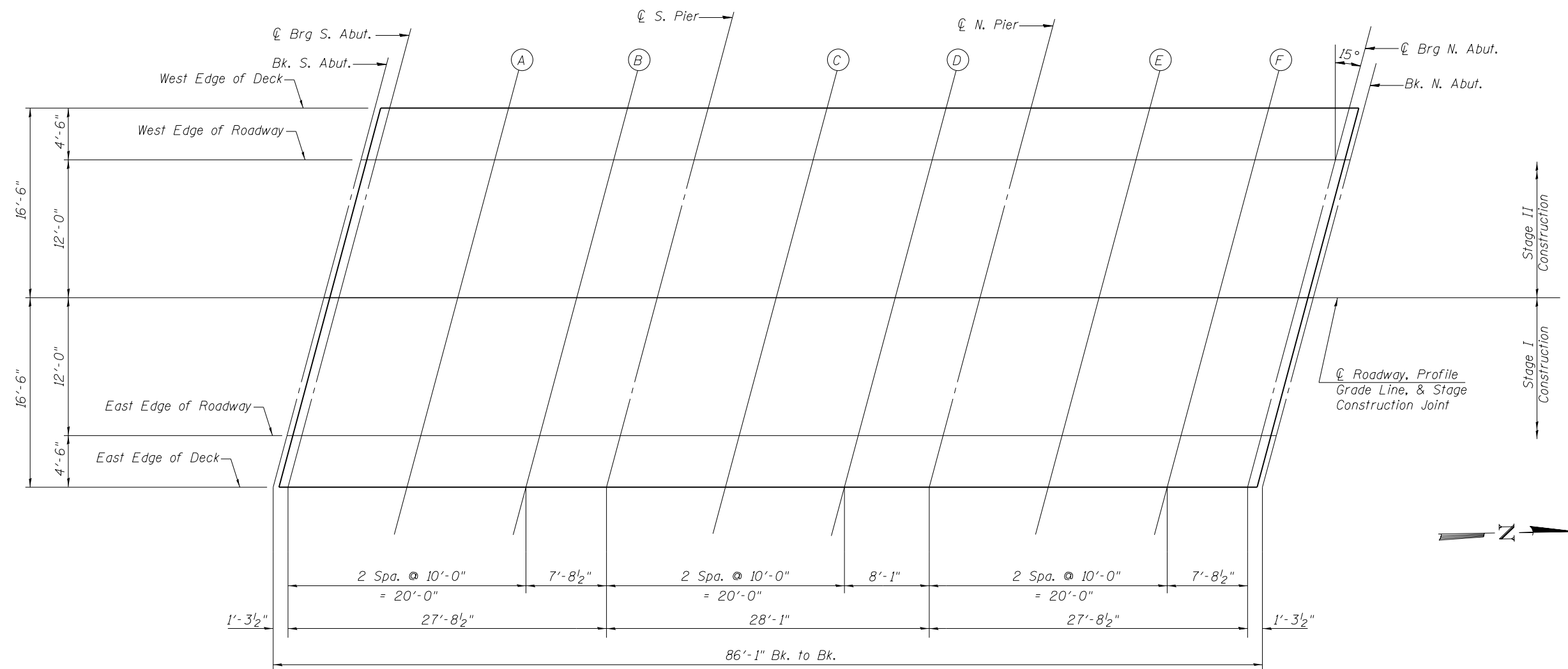

**PLAN**

E-S 7-1-10

**CEC** Cummins Engineering Corporation  
Civil and Structural Engineering

JOB = 2223.8  
FILE = 0150065-74167-05-06-TopofSlab.dgn  
DATE = 7/24/2014

DESIGNED - AAN  
CHECKED - MDC  
DRAWN - SJS  
CHECKED - MDC

REVISED -  
REVISED -  
REVISED -  
REVISED -

STATE OF ILLINOIS  
DEPARTMENT OF TRANSPORTATION

TOP OF SLAB ELEVATIONS  
STRUCTURE NO. 015-0065

SHEET NO. 5 OF 17 SHEETS

F.A.S. RTE.	SECTION	COUNTY	TOTAL SHEETS	SHEET NO.
673	2BR	COLES	24	12
CONTRACT NO. 74167				

ILLINOIS FED. AID PROJECT