

**WEST CURB LINE**

Location	Station	Offset	Theoretical Grade Elevations
S. End of S. Appr. Pav't	653+14.60	-16.50	630.63
A	653+24.60	-16.50	630.60
N. End of S. Appr. Pav't	653+36.35	-16.50	630.56

**WEST EDGE OF PAVEMENT**

Location	Station	Offset	Theoretical Grade Elevations
S. End of S. Appr. Pav't	653+14.60	-12.00	630.72
A	653+24.60	-12.00	630.69
N. End of S. Appr. Pav't	653+36.35	-12.00	630.65

**☉ ROADWAY & PG**

Location	Station	Offset	Theoretical Grade Elevations
S. End of S. Appr. Pav't	653+14.60	0.00	630.91
A	653+24.60	0.00	630.88
N. End of S. Appr. Pav't	653+36.35	0.00	630.84

**EAST EDGE OF PAVEMENT**

Location	Station	Offset	Theoretical Grade Elevations
S. End of S. Appr. Pav't	653+14.60	12.00	630.72
A	653+24.60	12.00	630.69
N. End of S. Appr. Pav't	653+36.35	12.00	630.65

**EAST CURB LINE**

Location	Station	Offset	Theoretical Grade Elevations
S. End of S. Appr. Pav't	653+14.60	14.17	630.68
A	653+24.60	14.17	630.65
N. End of S. Appr. Pav't	653+36.35	14.17	630.61

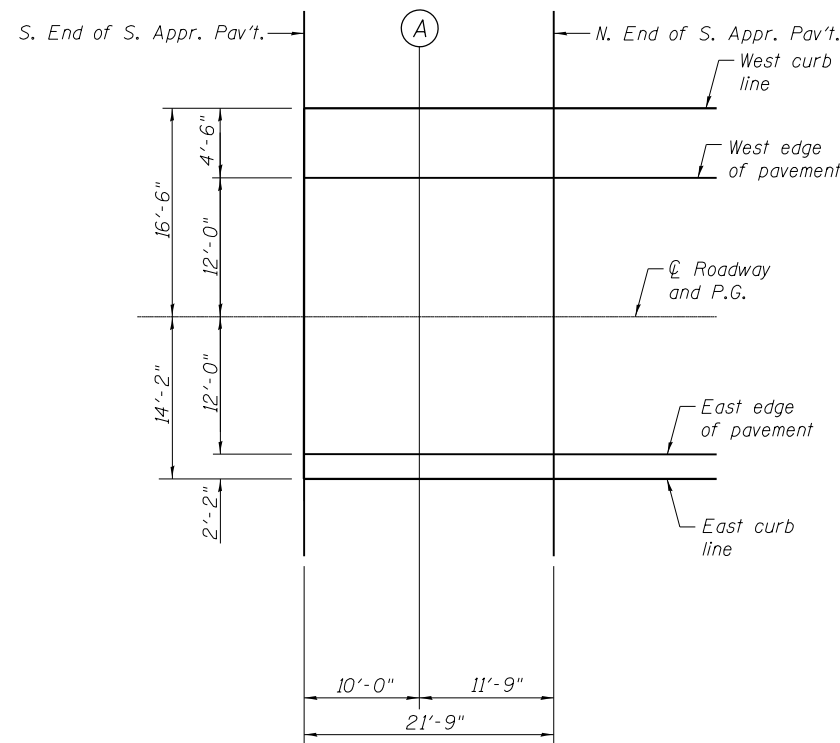

**PLAN**

E-AS

7-1-10

BLANK, WESSELINK, COOK & ASSOCIATES DECATUR, ILLINOIS ENGINEERS - CONSULTANTS DESIGN FIRM NO. 184000894

FILE NAME =	USER NAME =	DESIGNED <i>PBB</i>	REVISED -
		CHECKED <i>MCB</i>	REVISED -
		DRAWN <i>MLO</i>	REVISED -
		CHECKED <i>PBB/MCB</i>	REVISED -

**STATE OF ILLINOIS  
DEPARTMENT OF TRANSPORTATION**

**TOP OF SOUTH APPROACH SLAB ELEVATIONS  
STRUCTURE NO. 058-0010**

SHEET NO. 6 OF 34 SHEETS

F.A.P. RTE.	SECTION	COUNTY	TOTAL SHEETS	SHEET NO.
710	(48X-B-2)BR & (48BR)BR	MACON	144	83
<b>CONTRACT NO. 74438</b>				
ILLINOIS FED. AID PROJECT				