

**INSIDE ELEVATION OF WEST PARAPET**  
(Symmetric about C of Structure)

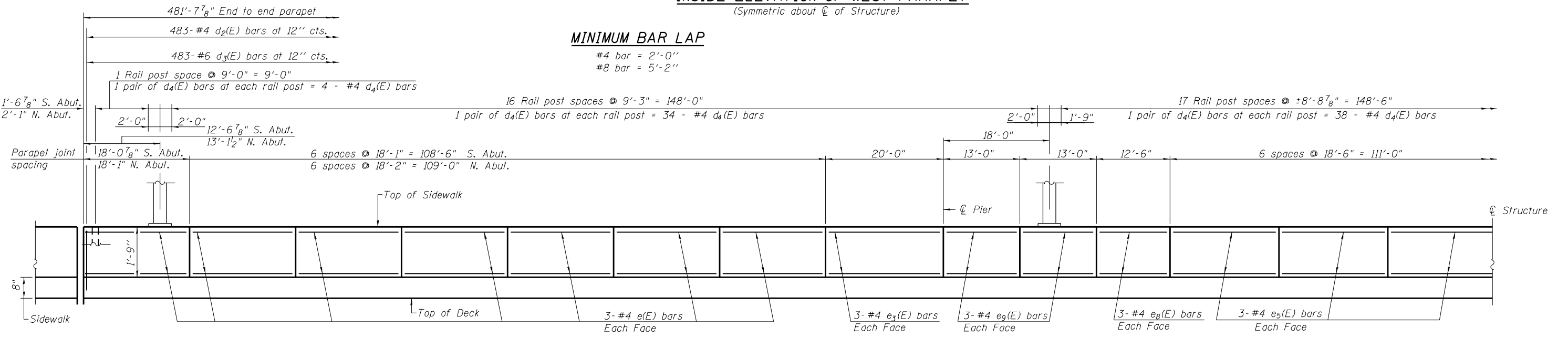

**INSIDE ELEVATION OF EAST PARAPET**  
(Symmetric about C of Structure)

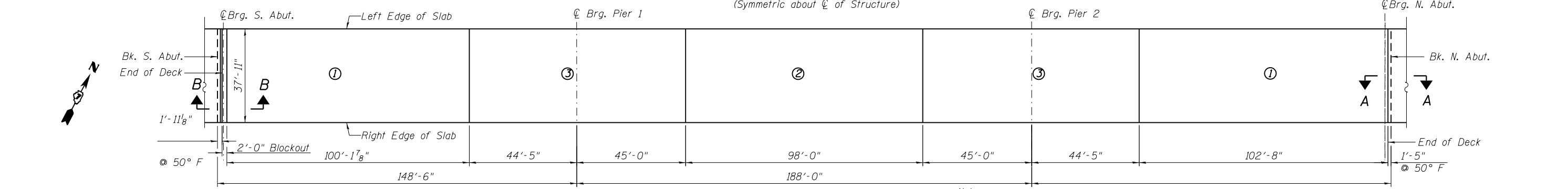

**DECK POURING SEQUENCE**

**Notes:**  
 When the deck pour is stopped for the day at one or more of the transverse bonded construction joints in the deck pouring sequence as shown, the next pour shall not be made until both of the following are met:  
 1. At least 72 hours shall have elapsed from the end of the previous pour.  
 2. The concrete strength shall have attained a minimum flexural strength of 650 psi or a minimum compressive strength of 3500 psi.  
 Contractor may deviate from the Deck Pouring Sequence shown upon approval of the Engineer. All deck concrete in the positive moment regions shall be placed and cured per Note 1 prior to pouring the deck concrete in the negative moment regions.  
 Expansion Joint Blockouts to be poured following pour ③, the approach spans and the sidewalk pour.  
 See Sheet 9 of 34 for blockout details.  
 See Sheet 9 of 34 for Sections A-A & B-B.

**Legend**  
 ① Deck Pouring Sequence Number

BLANK, WESSELINK, COOK & ASSOCIATES DECATUR, ILLINOIS ENGINEERS - CONSULTANTS DESIGN FIRM NO. 184000894

FILE NAME =	USER NAME =	DESIGNED <i>PBB</i>	REVISED -
		CHECKED <i>MCB</i>	REVISED -
	PLOT SCALE =	DRAWN <i>MLO</i>	REVISED -
	PLOT DATE =	CHECKED <i>PBB/MCB</i>	REVISED -

**STATE OF ILLINOIS**  
**DEPARTMENT OF TRANSPORTATION**

**SUPERSTRUCTURE DETAILS**  
**STRUCTURE NO. 058-0010**

F.A.P. RTE.	SECTION	COUNTY	TOTAL SHEETS	SHEET NO.
710	(48X-B-2)BR & (48BR)BR	MACON	144	87
CONTRACT NO. 74438				
ILLINOIS FED. AID PROJECT				

SHEET NO. 10 OF 34 SHEETS