

* Order a(E) & a₁(E) bars full length.
Cut to fit skew and use remainder
of bars in opposite end.

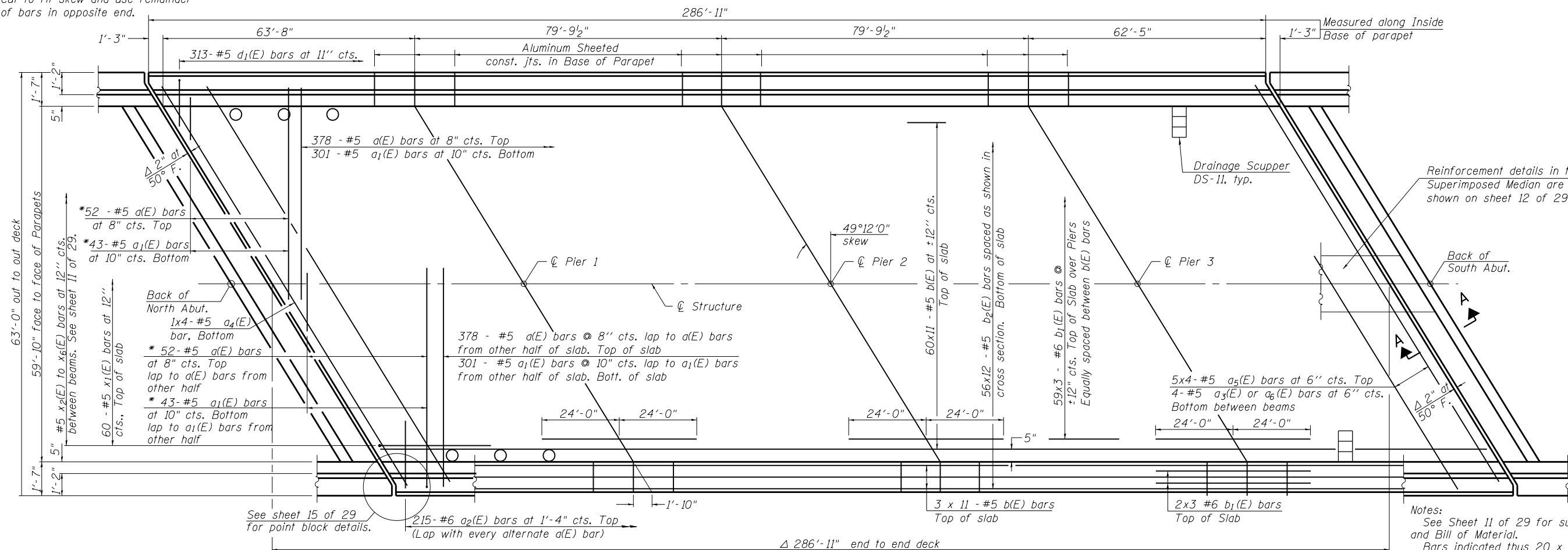

Notes:
See Sheet 11 of 29 for superstructure details and Bill of Material.
Bars indicated thus 20 x 3-#5 etc. indicates 20 lines of bars with 3 lengths per line.
See sheet 11 of 29 for parapet reinforcement & Section A-A. For location of Floor Drains & Scuppers. See sheet 1 of 29.

Minimum Bar Lap
#4 bar = 2'-1"
#5 bar = 2'-7"
#6 bar = 3'-1"

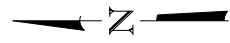

PLAN

Δ Dimensions are based on a Rolled Strip Seal Joint. If the contractor elects to use the Welded Rail Strip Seal Joint, deck dimensions may require adjustments to satisfy the details on sheet 15 of 29

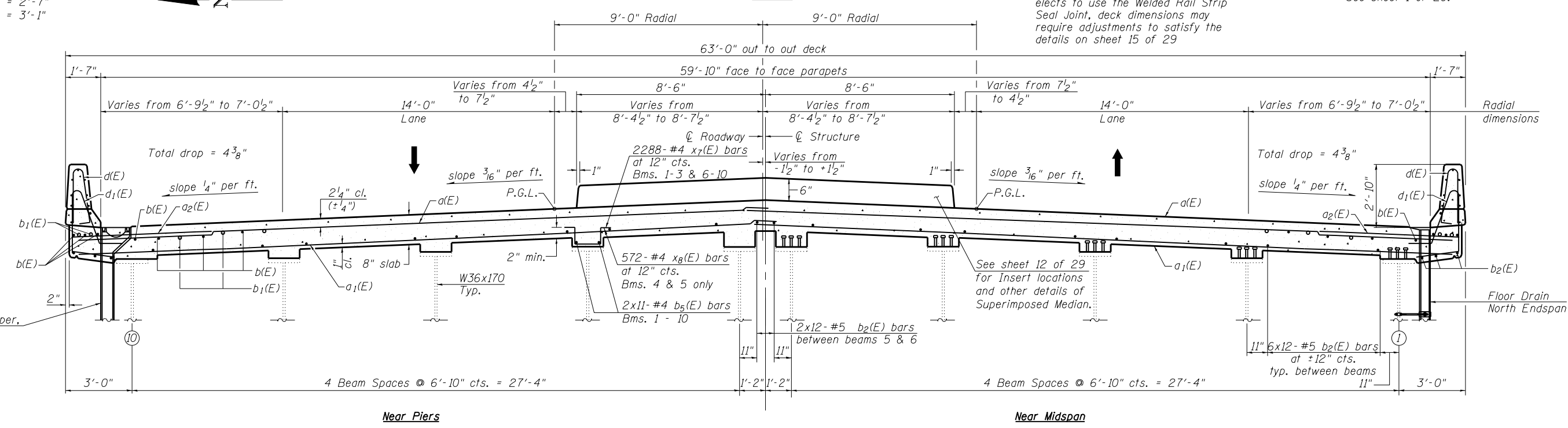

CROSS SECTION
(Looking North)

BENTON & ASSOCIATES, INC.
QUIGG ENGINEERING, INC.

STATE OF ILLINOIS
DEPARTMENT OF TRANSPORTATION

SUPERSTRUCTURE
STRUCTURE NO. 060-0104

FILE NAME 0600104-76G10-010-Superstructure.dgn	USER NAME =	DESIGNED - DRB	REVISED	STATE OF ILLINOIS DEPARTMENT OF TRANSPORTATION	SUPERSTRUCTURE STRUCTURE NO. 060-0104	F.A.I. RTE.	SECTION	COUNTY	TOTAL SHEETS	SHEET NO.
PLOT SCALE =	CHECKED - MBH	REVISOR	55			60-2HB-2	MADISON	52	28	
PLOT DATE	DRAWN - TF	REVISOR	CONTRACT NO. 76G10							
	CHECKED - JK	REVISOR	ILLINOIS FED. AID PROJECT							