

STATE OF ILLINOIS  
DEPARTMENT OF TRANSPORTATION  
DIVISION OF HIGHWAYS

**PROPOSED  
HIGHWAY PLANS**

FAP ROUTE 726 (IL 148)  
SECTION 119(RS-1); 126(RS-11)

RESURFACING 3P  
FRANKLIN COUNTY

F.A.P. RTE.	SECTION	COUNTY	TOTAL SHEETS	SHEET NO.
726	119(RS-1), 126(RS-11)	FRANKLIN	24	1
		ILLINOIS	CONTRACT NO. 78181	

FOR INDEX OF SHEETS, SEE SHEET NO. 3

STATION EQUATIONS  
120+24.65 (N) BK = 120+36.29 (N) AH  
0+00 (N) = 0+00 (S)

IL 148 (FAP 726)  
TRAFFIC DATA

	(2014)	(2034)
PV =	5,300	6,470
SU =	180	220
MU =	380	460
ADT =	5,860	7,150

TOWNSHIP  
GOODE

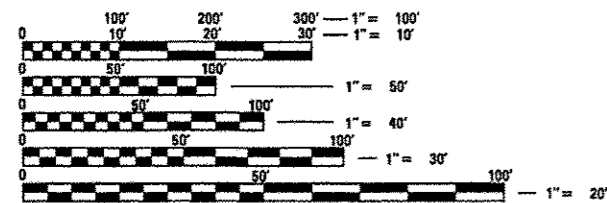

FULL SIZE PLANS HAVE BEEN PREPARED USING STANDARD ENGINEERING SCALES. REDUCED SIZED PLANS WILL NOT CONFORM TO STANDARD SCALES. IN MAKING MEASUREMENTS ON REDUCED PLANS, THE ABOVE SCALES MAY BE USED.

J.U.L.I.E.  
JOINT UTILITY LOCATION INFORMATION FOR EXCAVATION  
1-800-892-0123  
OR 811

PROJECT ENGINEER: CHARLES STEIN  
DESIGNER: PAULA STOVER

CONTRACT NO. 78181

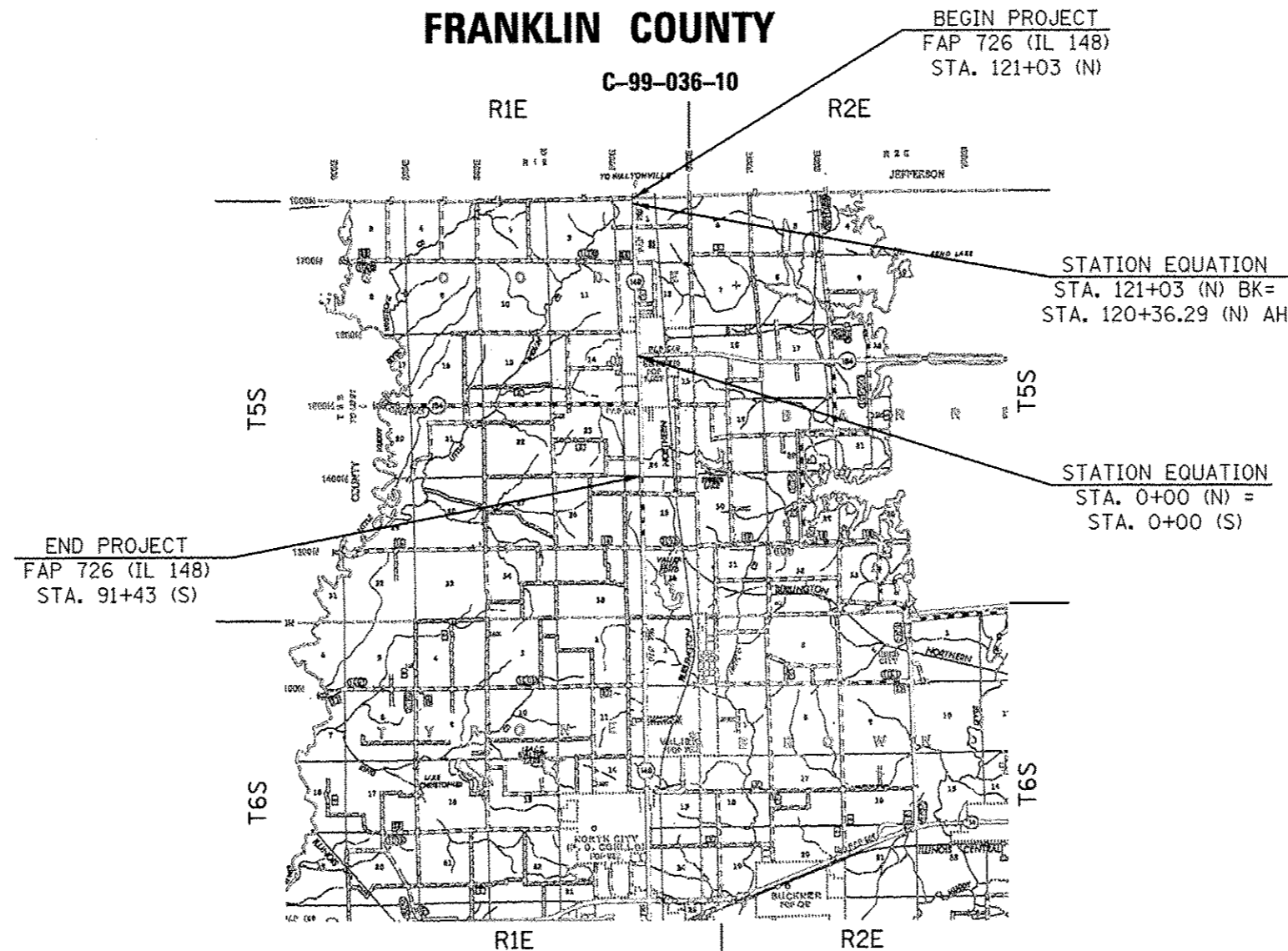

GROSS LENGTH = 21,258 FT. = 4.03 MILE  
NET LENGTH = 21,258 FT. = 4.03 MILE

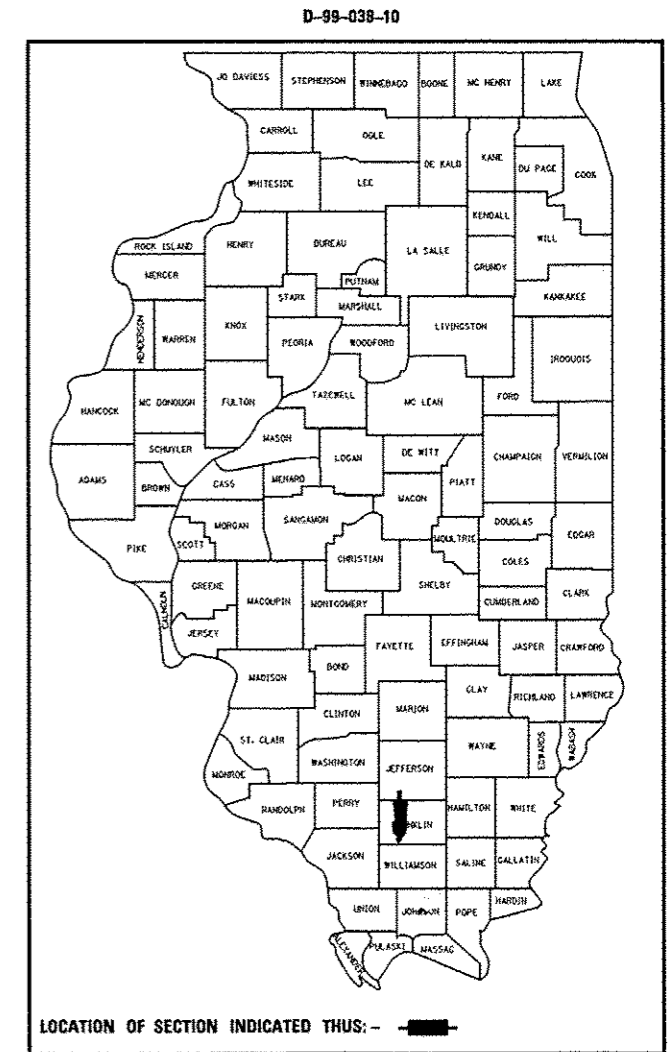

STATE OF ILLINOIS  
DEPARTMENT OF TRANSPORTATION  
DIVISION OF HIGHWAYS

SUBMITTED July 7, 2014  
Jeffrey L. Keim  
DEPUTY DIRECTOR OF HIGHWAYS, REGION ENGINEER

Aug 15, 2014  
John D. Baranzelli, P.E.  
ENGINEER OF DESIGN AND ENVIRONMENT

Aug 15, 2014  
Ormer Osman, P.E.  
DIRECTOR OF HIGHWAYS, CHIEF ENGINEER

PRINTED BY THE AUTHORITY  
OF THE STATE OF ILLINOIS

Prepared By: *Joe Zdanewicz*  
DISTRICT STUDIES & PLANS ENGINEER

Examined By: *Paul E. [Signature]*  
DISTRICT LAND ACQUISITION ENGINEER

Examined By: *Carrie Nelson*  
DISTRICT PROGRAM DEVELOPMENT ENGINEER

Examined By: *Keith Miles*  
DISTRICT OPERATIONS ENGINEER

Examined By: *[Signature]*  
DISTRICT PROJECT IMPLEMENTATION ENGINEER

Examined By: *Daryl J. [Signature]*  
DISTRICT CONSTRUCTION ENGINEER

Examined By: *[Signature]*  
DISTRICT MATERIALS ENGINEER

FILE NAME *	USER NAME * #USER#	DESIGNED -	REVISED -	<b>STATE OF ILLINOIS DEPARTMENT OF TRANSPORTATION</b>	<b>SIGNATURE SHEET</b>				F.A.P. RTE.	SECTION	COUNTY	TOTAL SHEETS	SHEET NO.	
c:\pwwork\pwwork\astovar\pg\d8482826\781	1-sh-to-ovr-req_inform.dgn	DRAWN -	REVISED -		SCALE:	SHEET	OF	SHEETS	STA.	726	119(RS-1), 126(RS-11)	FRANKLIN	24	2
#MODELNAME#	PLOT SCALE * 100.0000' / 1" =	CHECKED -	REVISED -											
	PLOT DATE * 6/28/2014	DATE -	REVISED -											

ILLINOIS FED. AID PROJECT CONTRACT NO. 78181

### INDEX OF SHEETS

SHEET NO.	DESCRIPTION
1	COVER SHEET
2	SIGNATURE SHEET
3	INDEX OF SHEETS, HIGHWAY STANDARDS, & MIXTURE REQUIREMENTS
4	GENERAL NOTES, COMMITMENTS, AND MTD CROSSING RESTRICTIONS TABLE
5-7	SUMMARY OF QUANTITIES
8-16	TYPICAL SECTIONS
17	PATCHING SCHEDULE
18	RESURFACING SCHEDULE
19	CURB RAMP SCHEDULE
20	PAVEMENT MARKING SCHEDULE
21	LEFT TURN LANE STRIPING DETAIL
22	STANDARD DETAIL: TEMPORARY HOT-MIX ASPHALT TRANSITIONS
23	STANDARD DETAIL: UNEVEN LANES SIGN
24	STANDARD DETAIL: ROUGH GROOVED SURFACE SIGN

### HIGHWAY STANDARDS

- 000001-06 STANDARD SYMBOLS, ABBREVIATIONS AND PATTERNS
- 001006 DECIMAL OF AN INCH AND OF A FOOT
- 424001-07 PERPENDICULAR CURB RAMPS
- 424006-01 DIAGONAL CURB RAMPS
- 424011-01 CORNER PARALLEL CURB RAMPS
- 442201-03 CLASS C and D PATCHES
- 606001-05 CONC CURB TYPE B AND COMB CONC CURB AND GUTTER
- 701001-02 OFF-RD OPERATIONS, 2L, 2W, MORE THAN 15\* (4.5 m) AWAY
- 701006-05 OFF-RD OPERATIONS, 2L, 2W, 15\* (4.5 m) TO 24' (600 mm) FROM PAVEMENT EDGE
- 701011-04 OFF-RD MOVING OPERATIONS, 2L, 2W, DAY ONLY
- 701301-04 LANE CLOSURE, 2L, 2W, SHORT TIME OPERATIONS
- 701306-03 LANE CLOSURE, 2L, 2W, SLOW MOVING OPERATIONS DAY ONLY, FOR SPEEDS  $\leq$  45 MPH
- 701311-03 LANE CLOSURE, 2L, 2W, MOVING OPERATIONS - DAY ONLY
- 701336-06 LANE CLOSURE, 2L, 2W, WORK AREAS IN SERIES, FOR SPEEDS  $\leq$  45 MPH
- 701901-03 TRAFFIC CONTROL DEVICES
- 780001-04 TYPICAL PAVEMENT MARKINGS
- 781001-03 TYPICAL APPLICATIONS RAISED REFLECTIVE PAVEMENT MARKERS

### MIXTURE REQUIREMENTS SHALL BE PREPARED AS DIRECTED BELOW:

LOCATIONS	HOT-MIX ASPHALT SURFACE COURSE
MIXTURE USE(S):	HOT-MIX ASPHALT SURFACE COURSE, MIX D, N90
AC/PG:	PG64-22
ABR % (MAX):	SEE SPECIAL PROVISION
DESIGN AIR VOIDS:	4.0 %, 90 GYRATION DESIGN
MIXTURE COMPOSITION: (GRADATION MIXTURE)	IL-9.5 MM
FRICTION AGGREGATE:	D SURFACE
QUALITY MANAGEMENT PROGRAM:	QCP

LOCATIONS	HOT-MIX ASPHALT LEVELING BINDER COURSE
MIXTURE USE(S):	HOT-MIX ASPHALT LEVELING BINDER, N90, IL-9.5MM FINE GRADE
AC/PG:	PG64-22
ABR % (MAX):	SEE SPECIAL PROVISION
DESIGN AIR VOIDS:	4.0 %, 90 GYRATION DESIGN
MIXTURE COMPOSITION: (GRADATION MIXTURE)	IL-9.5MM FINE GRADE
FRICTION AGGREGATE:	NONE
QUALITY MANAGEMENT PROGRAM:	QCP

LOCATIONS	PAVEMENT PATCHING
MIXTURE USE(S):	HOT-MIX ASPHALT BINDER COURSE, N90, IL-19.0MM FINE GRADE
AC/PG:	PG64-22
ABR % (MAX):	SEE SPECIAL PROVISION
DESIGN AIR VOIDS:	4.0 %, 90 GYRATION DESIGN
MIXTURE COMPOSITION: (GRADATION MIXTURE)	IL-19.0MM FINE GRADE
FRICTION AGGREGATE:	NONE
QUALITY MANAGEMENT PROGRAM:	QC/QA

LOCATIONS	HOT-MIX ASPHALT SHOULDERS
MIXTURE USE(S):	HOT-MIX ASPHALT SURFACE COURSE, MIX D, N90
AC/PG:	PG64-22
ABR % (MAX):	SEE SPECIAL PROVISION
DESIGN AIR VOIDS:	4.0 %, 90 GYRATION DESIGN
MIXTURE COMPOSITION: (GRADATION MIXTURE)	IL-9.5MM
FRICTION AGGREGATE:	C SURFACE
QUALITY MANAGEMENT PROGRAM:	QC/QA

FILE NAME *	USER NAME = #USER#	DESIGNED -	REVISED -	<b>STATE OF ILLINOIS DEPARTMENT OF TRANSPORTATION</b>	<b>INDEX OF SHEETS, HIGHWAY STANDARDS, &amp; MIXTURE REQUIREMENTS</b>	F.A.P. RTE.	SECTION	COUNTY	TOTAL SHEETS	SHEET NO.	
01\pwwork\pwwidot\stover\pg\04182025\2011-11-15\sta-evr_sog_index.dgn		DRAWN -	REVISED -			726	119(RS-1), 126(RS-11)	FRANKLIN	24	3	
#MODELNAME#	PLOT SCALE = 100.0000 * / in.	CHECKED -	REVISED -			CONTRACT NO. 78181					
	PLOT DATE = 7/9/2014	DATE -	REVISED -			ILLINOIS FED. AID PROJECT					

**GENERAL NOTES**

THE THICKNESS OF THE HOT-MIX ASPHALT MIXTURE SHOWN ON THE PLANS IS THE NOMINAL THICKNESS. DEVIATIONS FROM THE NOMINAL THICKNESS WILL BE PERMITTED WHEN SUCH DEVIATIONS OCCUR DUE TO IRREGULARITIES IN THE EXISTING SURFACE OR BASE ON WHICH THE HOT-MIX ASPHALT MIXTURE IS PLACED.

FACTORS USED FOR ESTIMATING PLAN QUANTITIES ARE AS FOLLOWS AND SHALL NOT BE USED FOR THE BASIS OF FINAL QUANTITIES.

ALL HOT-MIX ASPHALT                      2.016 TON/CU YD  
 ALL AGGREGATE                              2.05 TON/CU YD

UNLESS OTHERWISE DIRECTED BY THE ENGINEER, RESURFACING SHALL BE PLACED IN A SEQUENCE THAT WILL MINIMIZE THE TIME THE CENTERLINE EDGE IS EXPOSED TO TRAFFIC. WHEN AT THE END OF A DAY'S OPERATION THE EXPOSED CENTERLINE EDGE IS GREATER THAN 2,000 FT., THE CONTRACTOR SHALL BE REQUIRED TO PAVE IN THE ADJACENT LANE ON THE FOLLOWING WORK DAY. PRIOR TO WINTER SHUT DOWN, RESURFACING ON ADJACENT LANES IS TO BE BROUGHT UP TO THE SAME ELEVATION.

THE QUANTITY OF SHORT TERM PAVEMENT MARKING SHOWN IN THE PLANS IS BASED ON ONE APPLICATION EACH FOR THE HMA SURFACE REMOVAL, SURFACE COURSE, AND BINDER COURSE.

QUANTITIES SHOWN IN THE PLANS FOR PATCHING ARE ESTIMATES. THE ACTUAL AMOUNT OF PATCHING REQUIRED SHALL BE DETERMINED BY THE ENGINEER.

THE CONTRACTOR SHALL COMPLETE ALL PATCHING PRIOR TO THE BITUMINOUS SURFACE REMOVAL.

THE CONTRACTOR SHALL STAMP STATIONING IN THE HOT-MIX ASPHALT SURFACE AT 300 FT. INTERVALS ALTERNATING SIDES ON THE OUTSIDE EDGE OF PAVEMENT AND AS DIRECTED BY THE ENGINEER. THE STATION SYMBOL STAMPS USED SHALL BE FURNISHED BY THE CONTRACTOR. THEY SHALL BE 5 1/2 IN. TALL OF A DESIGN APPROVED BY THE ENGINEER, AND SHALL REMAIN THE PROPERTY OF THE CONTRACTOR.

ATTAINMENT OF PROPER CROWN OR SUPERELEVATION SHALL BE FULLY ACCOMPLISHED WITH THE HOT-MIX ASPHALT SURFACE REMOVAL OR HOT-MIX ASPHALT BINDER COURSE, WHEN SPECIFIED.

PRIOR TO PLACEMENT OF THE FINAL PAVEMENT MARKINGS THE RESIDENT ENGINEER SHALL CONTACT THE BUREAU OF OPERATIONS AND ARRANGE FOR INSPECTION AND APPROVAL OF THE PAVEMENT MARKING LAYOUT.

**COMMITMENTS**

NONE

**MTD CROSSING RESTRICTIONS TABLE**

SN & CENTERLINE STATION ROUTE (FAP 726)	EXISTING FILL HEIGHT OVER BOX CULVERT	THICKNESS OF EXISTING PAVEMENT OVER BOX CULVERT	MTD CROSSING RESTRICTIONS
	FOOT	FOOT	
SN 028-7117 - STA. 27+00 (S)	2.5		LOADED

# SUMMARY OF QUANTITIES

COUNTY:	FRANKLIN
ROUTE:	FAP 726 (IL 148)
FUNDING:	100% STATE
LOCATION:	RURAL
TOTAL QUANTITY	ROADWAY 0005

CODE NUMBER	ITEM DESCRIPTION	UNIT	TOTAL QUANTITY	ROADWAY 0005
40600275	BITUMINOUS MATERIALS (PRIME COAT)	POUND	47,019	47,019
40600647	LEVELING BINDER (MACHINE METHOD), IL-9.5FG, N90	TON	2,505	2,505
40600990	TEMPORARY RAMP	SQ YD	50	50
40603345	HOT-MIX ASPHALT SURFACE COURSE, MIX "D", N90	TON	4,998	4,998
42400100	PORTLAND CEMENT CONCRETE SIDEWALK 4 INCH	SQ FT	977	977
42400800	DETECTABLE WARNINGS	SQ FT	150	150
44000158	HOT-MIX ASPHALT SURFACE REMOVAL, 2 1/4"	SQ YD	69,658	69,658
44000300	CURB REMOVAL	FOOT	39	39
44000400	GUTTER REMOVAL	FOOT	104	104
44000600	SIDEWALK REMOVAL	SQ FT	767	767
44200144	PAVEMENT PATCHING, TYPE II, 12 INCH	SQ YD	702.7	702.7
44200148	PAVEMENT PATCHING, TYPE III, 12 INCH	SQ YD	32.0	32.0
44200150	PAVEMENT PATCHING, TYPE IV, 12 INCH	SQ YD	143.3	143.3

# SUMMARY OF QUANTITIES - CONT

COUNTY:	FRANKLIN
ROUTE:	FAP 726 (IL 148)
FUNDING:	100% STATE
LOCATION:	RURAL
TOTAL QUANTITY	ROADWAY 0005

CODE NUMBER	ITEM DESCRIPTION	UNIT	TOTAL QUANTITY	ROADWAY 0005
44300200	STRIP REFLECTIVE CRACK CONTROL TREATMENT	FOOT	42,515	42,515
48203100	HOT-MIX ASPHALT SHOULDERS	TON	1,317	1,317
60600605	CONCRETE CURB, TYPE B	FOOT	75	75
60605000	COMBINATION CONCRETE CURB AND GUTTER, TYPE B-6.24	FOOT	39	39
67000500	ENGINEER'S FIELD OFFICE, TYPE B	CAL MO	3	3
67100100	MOBILIZATION	L SUM	1	1
70100460	TRAFFIC CONTROL AND PROTECTION, STANDARD 701306	L SUM	1	1
70100600	TRAFFIC CONTROL AND PROTECTION, STANDARD 701336	L SUM	1	1
70106800	CHANGEABLE MESSAGE SIGN	CAL MO	14	14
70300100	SHORT TERM PAVEMENT MARKING	FOOT	27,367	27,367
70300210	TEMPORARY PAVEMENT MARKING LETTERS AND SYMBOLS	SQ FT	145.6	145.6
70300220	TEMPORARY PAVEMENT MARKING - LINE 4"	FOOT	44,847	44,847
70300240	TEMPORARY PAVEMENT MARKING - LINE 6"	FOOT	144	144

13



# TYPICAL SECTION - MAINLINE IL 148

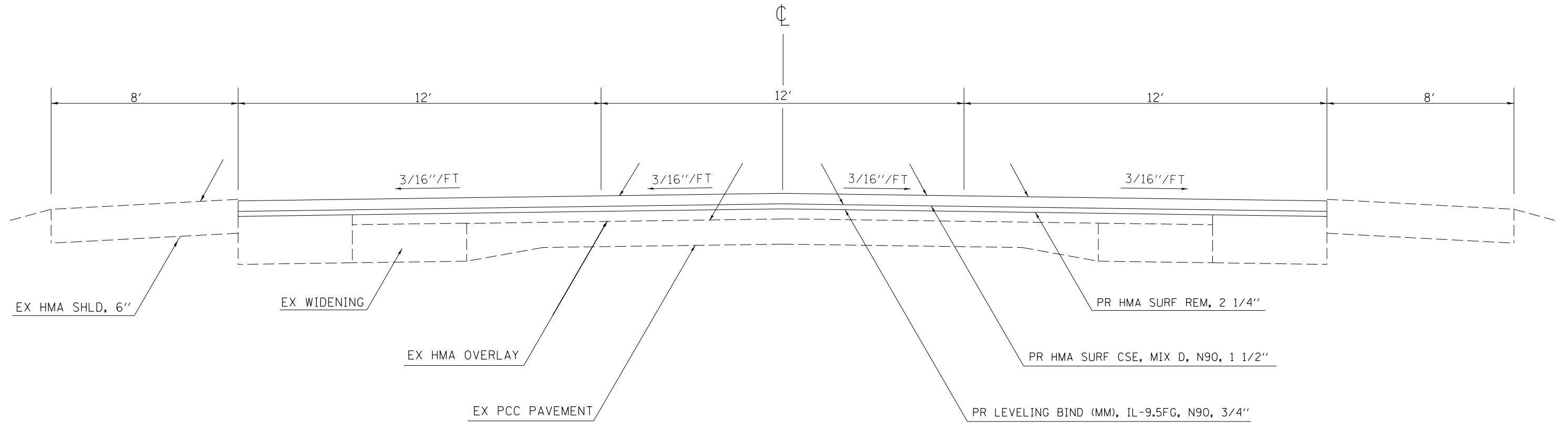

TO BE USED:  
STA 38+00 ( S ) TO STA 39+38 ( S )

FILE NAME =	USER NAME = \$USER\$	DESIGNED -	REVISED -	<b>STATE OF ILLINOIS DEPARTMENT OF TRANSPORTATION</b>	<b>TYPICAL SECTION - MAINLINE</b>		F.A.P. RTE.	SECTION	COUNTY	TOTAL SHEETS	SHEET NO.
ci:\pw\work\p\idot\stoverpg\d0402026\78181	1-sh-ta-cvr-soq.index.dgn	DRAWN -	REVISED -		726	119(RS-1), 126(RS-11)	FRANKLIN	24	8		
PLOT SCALE = 100.0000' / 1in.	CHECKED -	REVISED -	REVISED -		CONTRACT NO. 78181						
PLOT DATE = 7/9/2014	DATE -	REVISED -	REVISED -		SCALE: NONE    SHEET NO. 1 OF 9 SHEETS    STA.    TO STA.						
							FED. ROAD DIST. NO.    ILLINOIS    FED. AID PROJECT				





# TYPICAL SECTION - MAINLINE IL 148

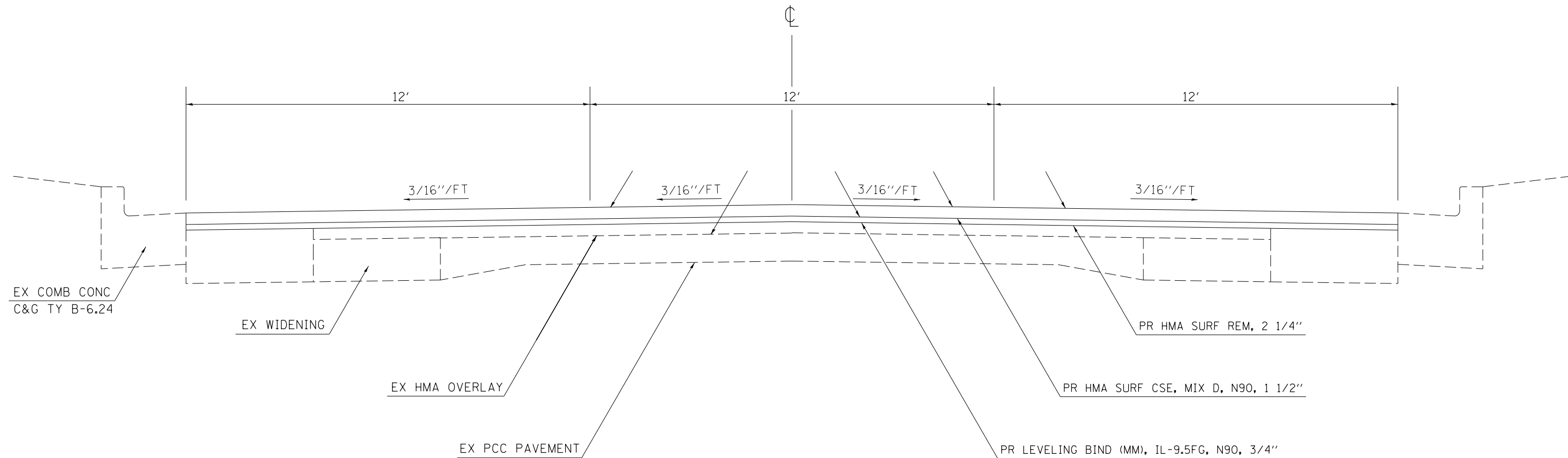

TO BE USED:  
 STA 1+07.45 (N) TO STA 2+76 (N)  
 STA 1+12.08 (S) TO STA 2+76 (S)  
 STA 33+06 (S) TO STA 38+00 (S)

FILE NAME =	USER NAME = \$USER\$	DESIGNED -	REVISED -	<b>STATE OF ILLINOIS          DEPARTMENT OF TRANSPORTATION</b>	<b>TYPICAL SECTION - MAINLINE</b>		F.A.P. RTE.	SECTION	COUNTY	TOTAL SHEETS	SHEET NO.
ci:\pw\work\p\idot\stoverpg\0402026\78181\sh\ta-cvr-soq.index.dgn		DRAWN -	REVISED -		726	119(RS-1), 126(RS-11)	FRANKLIN	24	10		
PLOT SCALE = 100.0000' / 1in.		CHECKED -	REVISED -		CONTRACT NO. 78181						
PLOT DATE = 7/9/2014		DATE -	REVISED -		SCALE: NONE	SHEET NO. 3 OF 9 SHEETS	STA. TO STA.	FED. ROAD DIST. NO.	ILLINOIS FED. AID PROJECT		

# TYPICAL SECTION - MAINLINE IL 148

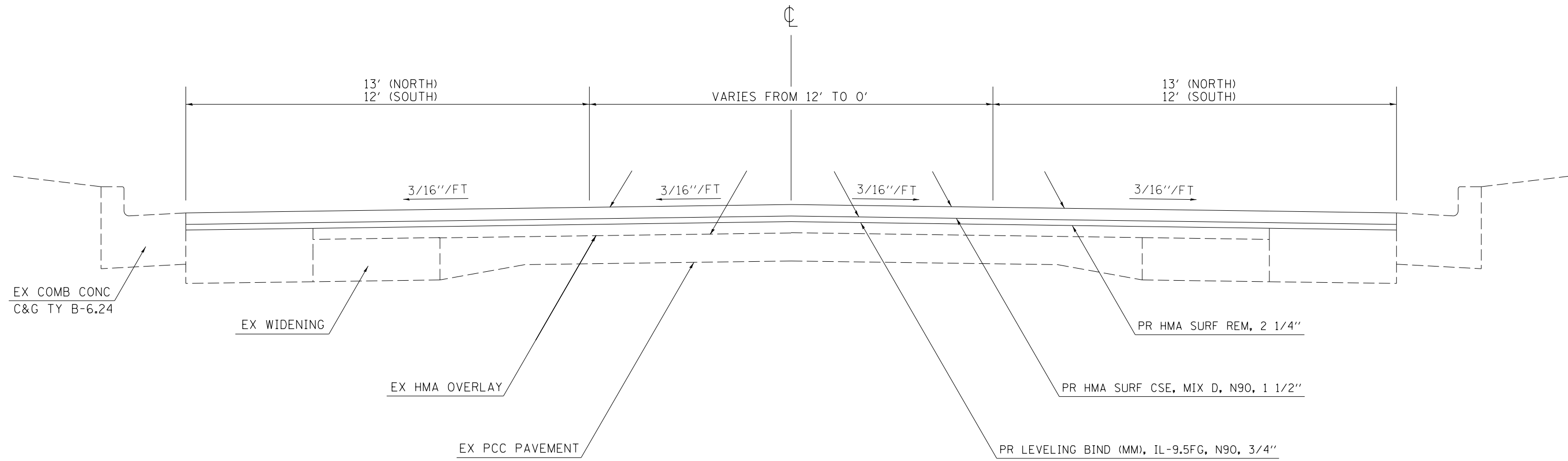

TO BE USED:  
 STA 2+76 (N) TO STA 4+56 (N)  
 STA 2+76 (S) TO STA 4+56 (S)  
 STA 30+66 (S) TO STA 33+06 (S)  
 STA 39+38 (S) TO STA 41+78 (S)

FILE NAME =	USER NAME = \$USER\$	DESIGNED -	REVISED -	<b>STATE OF ILLINOIS DEPARTMENT OF TRANSPORTATION</b>	<b>TYPICAL SECTION - MAINLINE</b>	F.A.P. RTE.	SECTION	COUNTY	TOTAL SHEETS	SHEET NO.
ci:\pw\work\p\dot\stoverpg\d0402026\78181		DRAWN -	REVISED -			726	119(RS-1), 126(RS-11)	FRANKLIN	24	11
	PLOT SCALE = 100.0000' / 1".	CHECKED -	REVISED -		SCALE: NONE	SHEET NO. 4 OF 9 SHEETS		STA.	TO STA.	
	PLOT DATE = 7/9/2014	DATE -	REVISED -		FED. ROAD DIST. NO. ILLINOIS FED. AID PROJECT					

# TYPICAL SECTION - MAINLINE IL 148

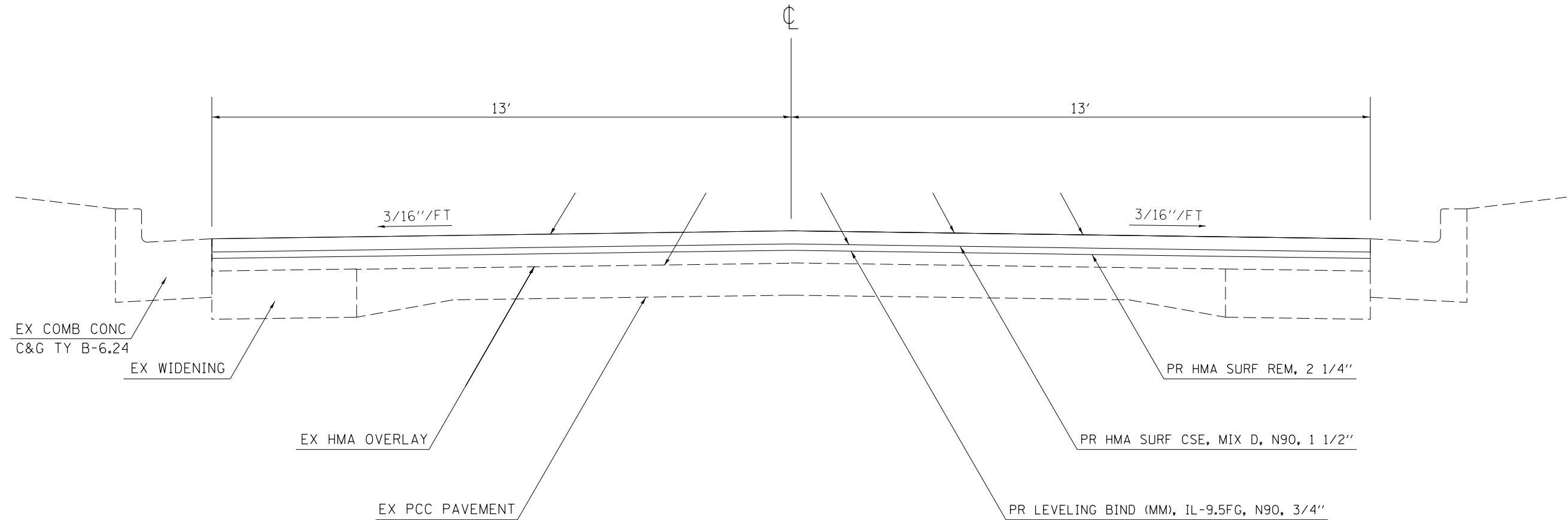

TO BE USED:  
STA 4+56 (N) TO STA 17+28 (N)

FILE NAME =	USER NAME = \$USER\$	DESIGNED -	REVISED -
ci:\pw\work\p\idot\stoverpg\d0402026\78181\1-shta-cvr-soq.index.dgn		DRAWN -	REVISED -
	PLOT SCALE = 100.0000' / 1in.	CHECKED -	REVISED -
	PLOT DATE = 7/9/2014	DATE -	REVISED -

**STATE OF ILLINOIS  
DEPARTMENT OF TRANSPORTATION**

**TYPICAL SECTION - MAINLINE**

SCALE: NONE    SHEET NO. 5 OF 9 SHEETS    STA.    TO STA.

F.A.P. RTE.	SECTION	COUNTY	TOTAL SHEETS	SHEET NO.
726	119(RS-1), 126(RS-11)	FRANKLIN	24	12
CONTRACT NO. 78181				
FED. ROAD DIST. NO.    ILLINOIS FED. AID PROJECT				



# TYPICAL SECTION - MAINLINE IL 148

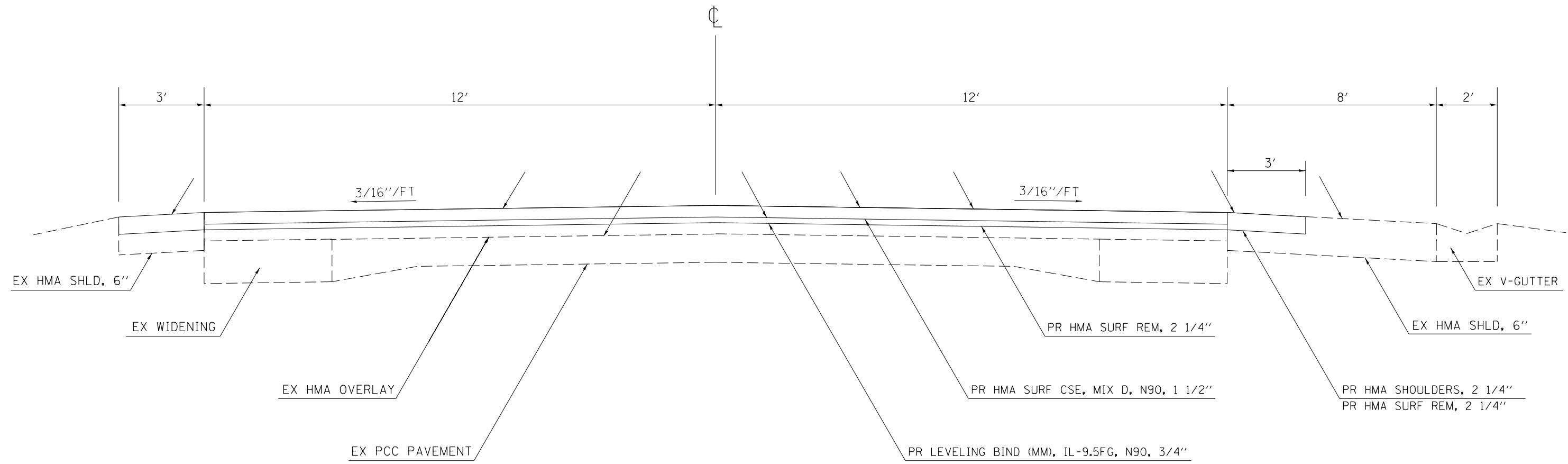

TO BE USED:  
STA 39+70 (N) TO STA 44+00 (N)

FILE NAME =	USER NAME = \$USER\$	DESIGNED -	REVISED -	<b>STATE OF ILLINOIS DEPARTMENT OF TRANSPORTATION</b>	<b>TYPICAL SECTION - MAINLINE</b>			F.A.P. RTE.	SECTION	COUNTY	TOTAL SHEETS	SHEET NO.	
ci:\pw\work\p\dot\stoverpg\d0402026\78181	1-sh-ta-cvr-soq.index.dgn	DRAWN -	REVISED -		SCALE: NONE	SHEET NO. 7 OF 9 SHEETS	STA.	TO STA.	726	119(RS-1), 126(RS-11)	FRANKLIN	24	14
	PLOT SCALE = 100.0000' / 1in.	CHECKED -	REVISED -					CONTRACT NO. 78181					
	PLOT DATE = 7/9/2014	DATE -	REVISED -		FED. ROAD DIST. NO. ILLINOIS FED. AID PROJECT								

# TYPICAL SECTION - MAINLINE IL 148

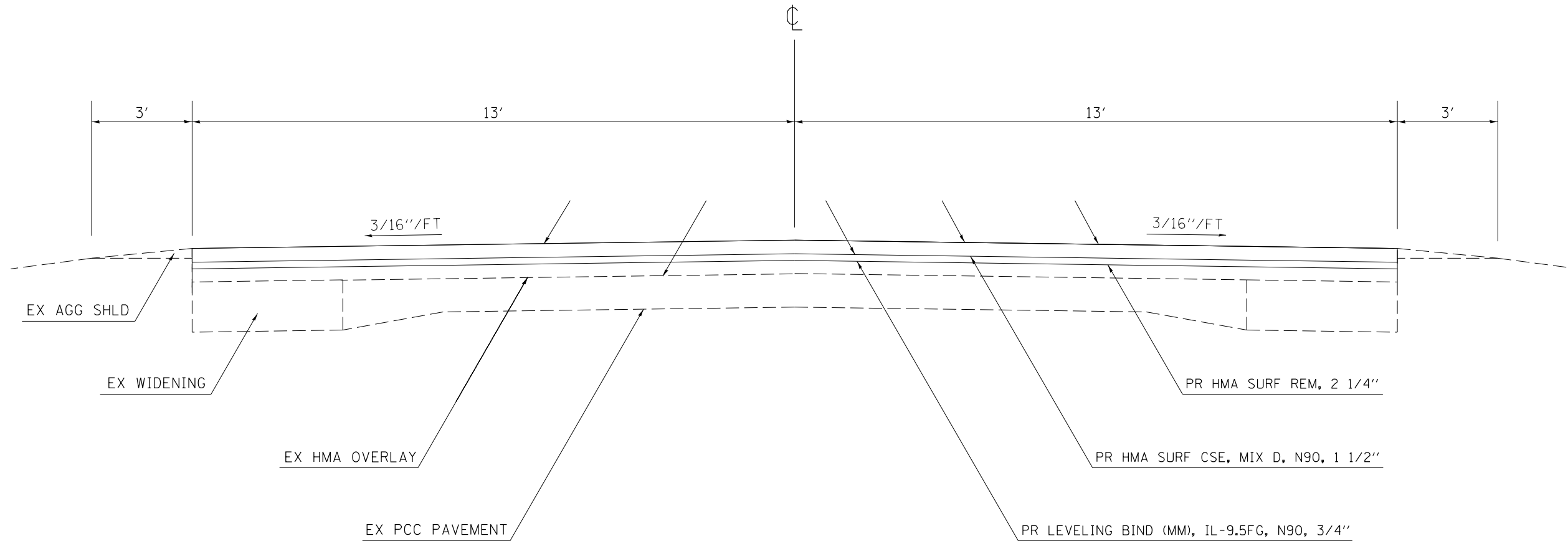

TO BE USED:  
STA 17+28 (N) TO STA 17+81 (N)

FILE NAME =	USER NAME = \$USER\$	DESIGNED -	REVISED -	<b>STATE OF ILLINOIS DEPARTMENT OF TRANSPORTATION</b>	<b>TYPICAL SECTION - MAINLINE</b>			F.A.P. RTE.	SECTION	COUNTY	TOTAL SHEETS	SHEET NO.
ci:\pw\work\p\dot\stoverpg\d0402026\78181	11-sha-cvr-soq.index.dgn	DRAWN -	REVISED -		726	119(RS-1), 126(RS-11)	FRANKLIN	24	15			
PLOT SCALE = 100.0000' / 1in.	CHECKED -	REVISED -	REVISED -		CONTRACT NO. 78181							
PLOT DATE = 7/9/2014	DATE -	REVISED -	REVISED -		SCALE: NONE    SHEET NO. 8 OF 9 SHEETS    STA.    TO STA.			FED. ROAD DIST. NO.	ILLINOIS FED. AID PROJECT			





# IL 148 PATCHING

(FOR INFORMATION ONLY)

LOCATION	PAVEMENT PATCHING, TY II	PAVEMENT PATCHING, TY III	PAVEMENT PATCHING, TY IV
	12 INCH	12 INCH	12 INCH
<b>NORTH BOUND</b>			
IL 154 WB	88.0	16.0	100.0
IL 154 EB	33.2		
YUNG RD	5.8		
ILLINOIS ST	69.3		
CROCKER RD	95.3		
OLD NORTH RD	17.3		
<b>SOUTH BOUND</b>			
IL 154 WB	168.0	16.0	
IL 154 EB	32.2		43.3
YUNG RD	5.8		
ILLINOIS ST	57.8		
CROCKER RD	101.1		
OLD NORTH RD	28.9		
	<b>702.7</b>	<b>32.0</b>	<b>143.3</b>

## PAVEMENT AND SHOULDER SCHEDULE

LOCATION					LENGTH	WIDTH	AREA	HMA SURFACE REMOVAL 2 1/4"	HMA SURF CSE MIX "D", N90	HMA LEVELING BINDER, N90, IL-9.5MM FG	BIT MAT PRIME COAT	HMA SHLDRS	STRIP REFLECTIVE CRACK CONTROL	TEMPORARY RAMP
					FOOT	FOOT	SQ FT	SQ YD	TON	TON	POUND	TON	FOOT	SQ YD
<b>IL 148</b>														
121+03.	N	TO	120+24.65	N	78.35	30	2350.5	261.2	17.6	8.8	176.3	6.6	156.7	25.0
120+24.65	BK	=	120+36.29	AH										
120+36.29	N	TO	44+00.	N	7636.29	30	229088.7	25454.3	1719.4	861.9	17181.7	641.4	15272.6	
44+00.	N	TO	17+81.	N	2619.00	30	78570.0	8730.0	589.7	295.6	5892.8	220.0	5238.0	
17+81.	N	TO	4+56.	N	1325.00	26	34450.0	3827.8	323.1	161.9	2583.8		2650.0	
4+56.	N	TO	2+76.	N	180.00	32	5760.0	640.0	54.0	27.0	432.0		360.0	
2+76.	N	TO	0+00	N	276.00	36	9936.0	1104.0	93.1	46.6	745.2		552.0	
0+00	N	=	0+00	S										
0+00	S	TO	2+76.	S	276.00	36	9936.0	1104.0	93.1	46.6	745.2		552.0	
2+76.	S	TO	4+56.	S	180.00	31	5580.0	620.0	52.3	26.2	418.5		360.0	
4+56.	S	TO	30+66.	S	2610.00	24	62640.0	6960.0	587.7	294.6	4698.0		5220.0	
30+66.	S	TO	33+06.	S	240.00	31	7440.0	826.7	69.7	34.9	558.0		480.0	
33+06.	S	TO	38+00.	S	494.00	36	17784.0	1976.0	166.6	83.4	1333.8		988.0	
38+00.	S	TO	39+38.	S	138.00	42	5796.0	644.0	46.5	23.3	434.7	11.6	276.0	
39+38.	S	TO	41+78.	S	240.00	36	8640.0	960.0	67.5	33.8	648.0	20.2	480.0	
41+78.	S	TO	91+43.	S	4965.00	30	148950.0	16550.0	1118.0	560.4	11171.3	417.1	9930.0	25.0
<b>TOTAL</b>					21257.64			69658	4998	2505	47019	1317	42515	50

## CURB RAMPS SCHEDULE

LOCATION	GUTTER REMOVAL	CURB REMOVAL	DETECTABLE WARNING	CONC CURB, TY B	COMB CC&G, TY B-6.24	SIDEWALK REMOVAL	PC CONC SIDEWALK 4"
	FOOT	FOOT	SQ FT	FOOT	FOOT	SQ FT	SQ FT
<b>W. MATTHEW ST.</b>							
NE QUAD	5.0		10.0	5.0		90.6	107.0
SW QUAD	5.0		10.0	5.0		102.0	132.5
SE QUAD	5.0		10.0	5.0		90.6	107.0
<b>W. CALLIE ST.</b>							
NW QUAD	5.0		10.0	5.0	5.0	32.0	42.5
NE QUAD	5.0		10.0	5.0		44.0	57.5
SW QUAD	5.0		10.0	5.0	5.0	36.0	47.5
SE QUAD	5.0		10.0	5.0		44.0	57.5
<b>IL 154 EAST</b>							
NW QUAD	5.0		10.0	5.0		40.0	52.5
NE QUAD	24.5	19.5	20.0	10.0	14.5	98.0	125.0
SW QUAD	5.0		10.0	5.0		32.0	42.5
SE QUAD	24.5	19.5	20.0	10.0	14.5	98.0	125.0
<b>W. LUCRETIA ST.</b>							
SW QUAD	5.0		10.0	5.0		20.0	27.5
SE QUAD	5.0		10.0	5.0		40.0	52.5
<b>TOTAL</b>							
	<b>104</b>	<b>39</b>	<b>150</b>	<b>75</b>	<b>39</b>	<b>767</b>	<b>977</b>

# PAVEMENT MARKING SCHEDULE

LOCATION					PAINT PAVEMENT MARKING				THERMOPLASTIC PAVEMENT MARKING					TEMPORARY PAVEMENT MARKING					SHORT-TERM PAVEMENT MARKING (*)	WORK ZONE PAVEMENT MARKING REMOVAL	RAISED REFLECTIVE PAVEMENT MARKER	RAISED REFLECTIVE PAVEMENT MARKER REMOVAL				
					LINE 4"				LINE 12"	DOUBLE LINE 4"	LINE 4"	LINE 6"	LINE 24"	WHITE	YELLOW		WHITE									
					WHITE	YELLOW			YELLOW		WHITE			LET & SYM	LINE 12"	LINE 4"	LINE 4"	LINE 6"					LINE 24"	LET & SYM		
					SOLID	SKIP-DA SH	SOLID	LT/RT	SOLID	SOLID	SOLID	SOLID	SOLID		FOOT	FOOT	FOOT	FOOT					FOOT		SQ FT	
IL 148					FOOT	FOOT	FOOT		FOOT	FOOT	FOOT	FOOT	FOOT	FOOT	SQ FT	FOOT	SQ FT	EACH	EACH							
121+03.	N	TO	120+24.65	N	157	20											24	66.6	1	1						
120+24.65	BK	=	120+36.29	AH																						
120+36.29	N	TO	52+00.	N	13673	1709											2,051	5810.8	85	85						
52+00.	N	TO	43+00.	N	1800	225	900	LT									270	1065.0	11	11						
43+00.	N	TO	41+30.	N	340	43											51	144.5	2	2						
41+30.	N	TO	31+75.	N	1910	239	955	RT									287	1130.1	12	12						
31+75.	N	TO	17+50.	N	2850	356											428	1211.3	18	18						
17+50.	N	TO	4+56.	N		324											388	237.2	16	16						
4+56.	N	TO	1+56.	N			84	1200			84	1200					3,852	1768.0	16	16						
1+56.	N	TO	0+44	N				200	112			34	36.4				200	112	34	36.4	1,038	554.4	9	9		
0+00	N	=	0+00	S																						
0+44	S	TO	1+56.	S				200	112			35	36.4				200	112	35	36.4	1,041	557.4	9	9		
1+56.	S	TO	4+56.	S				84	1200								84	1200			3,852	1768.0	16	16		
4+56.	S	TO	30+66.	S		653											653				783	478.5	33	33		
30+66.	S	TO	34+56.	S				109	1560								109	1560			5,007	2298.0	20	20		
34+56.	S	TO	35+56.	S					200	100								200	100		36.4	900	436.4	9	9	
36+88.	S	TO	37+88.	S					200	100								200	100		36.4	900	436.4	9	9	
37+88.	S	TO	41+78.	S	780				109	1560								109	1560	780		5,007	2558.0	20	20	
41+78.	S	TO	91+43.	S	9930	1241													1241	9930		1,490	4220.3	62	62	
CROSSWALK AT 148/154 (N)																										
CROSSWALK AT 148/154 (S)																										
TOTALS					31439	4808	1855		386	6320	424	144	69	145.6	386	12983	31863	144	69	145.6	27,367	24,740.9	348	348		
PROJECT TOTALS					38103				386	6744	144	69	145.6	386	44847	144	69	145.6	27,367	24,741	348	348				

SOLID YELLOW LT/RT FOR NPZ'S SHALL BE ORIENTED LOOKING TO THE NORTH

- ONE APPLICATION EACH FOR HMA SURFACE REMOVAL, BINDER, AND SURFACE COURSE

**LEFT TURN LANE STRIPING DETAIL  
(4 LOCATIONS)**

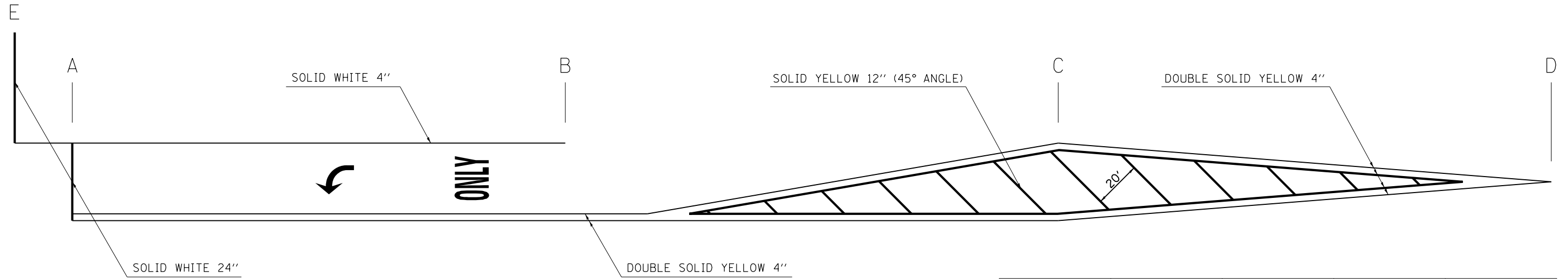

	A	B	C	D	E
LOC 1 - NORTH LEG OF IL 154 EAST INTERSECTION	STA 0+56 (N)	STA 1+56 (N)	STA 2+76 (N)	STA 4+56 (N)	STA 0+46 (N)
LOC 2 - SOUTH LEG OF IL 154 EAST INTERSECTION	STA 0+56 (S)	STA 1+56 (S)	STA 2+76 (S)	STA 4+56 (S)	STA 0+46 (S)

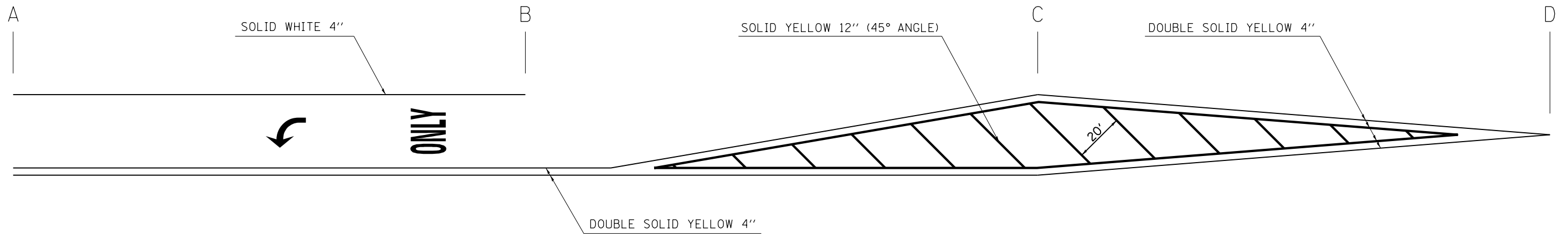

	A	B	C	D
LOC 3 - NORTH LEG OF IL 154 WEST INTERSECTION	STA 35+56 (S)	STA 34+56 (S)	STA 33+06 (S)	STA 30+66 (S)
LOC 4 - SOUTH LEG OF IL 154 WEST INTERSECTION	STA 36+88 (S)	STA 37+88 (S)	STA 39+38 (S)	STA 41+78 (S)

FILE NAME =	USER NAME = \$USER\$	DESIGNED -	REVISED -
ci:\pw\work\p\idot\stoverpg\0402026\78181\sh\ta-cvr-soq.index.dgn		DRAWN -	REVISED -
	PLOT SCALE = 100.0000' / 1in.	CHECKED -	REVISED -
	PLOT DATE = 7/9/2014	DATE -	REVISED -

**STATE OF ILLINOIS  
DEPARTMENT OF TRANSPORTATION**

**LEFT TURN LANE STRIPING DETAIL**

SCALE: NONE    SHEET NO. 1 OF 1 SHEETS    STA.    TO STA.

F.A.P. RTE.	SECTION	COUNTY	TOTAL SHEETS	SHEET NO.
726	119(RS-1), 126(RS-11)	FRANKLIN	24	21
FED. ROAD DIST. NO.    ILLINOIS FED. AID PROJECT				

# TEMPORARY HOT-MIX ASPHALT TRANSITIONS

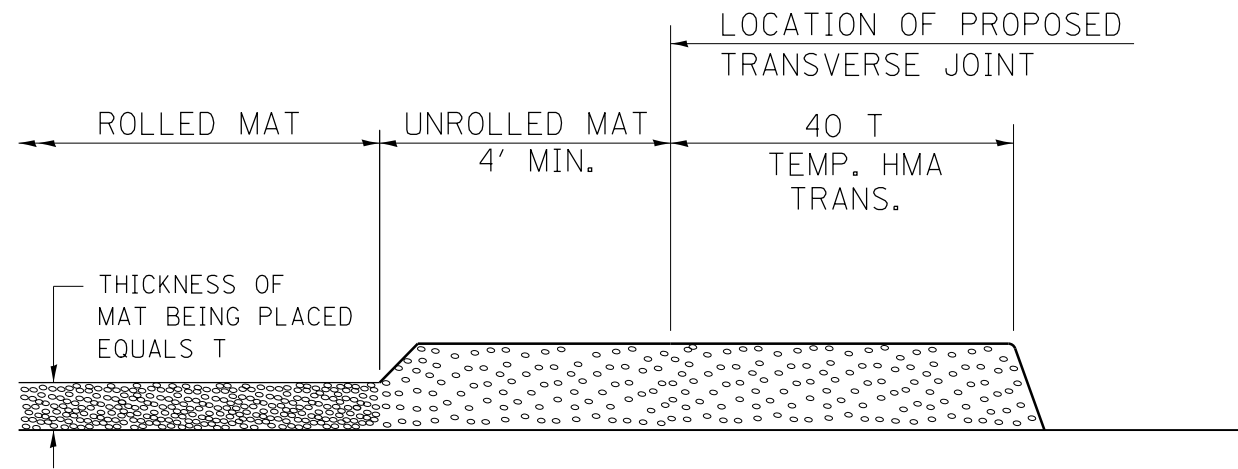

## STEP I

1. PLACE HOT-MIX ASPHALT MAT, LENGTH 40 TIMES THE THICKNESS OF THE MAT BEING PLACED PAST THE PROPOSED TRANSVERSE JOINT LOCATION USING NORMAL OPERATING PROCEDURES.
2. EXTREME CARE SHOULD BE TAKEN TO MAINTAIN ENOUGH MATERIAL IN FRONT OF THE SCREED TO MAINTAIN REQUIRED PAVING DEPTH.

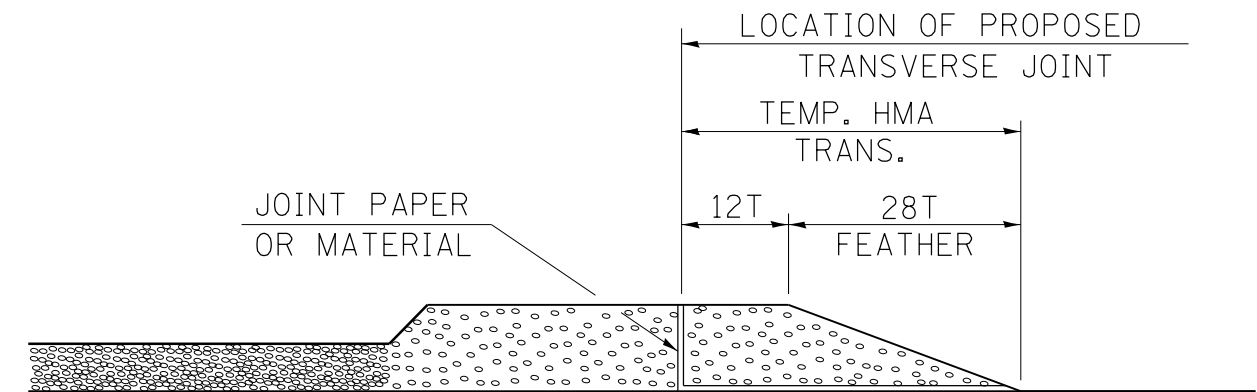

## STEP III

1. JOINT PAPER OR OTHER PRESELECTED JOINT MATERIAL IS THEN PLACED IN THE CLEARED AREA AND THE EXCESS ASPHALT USED TO HAND FORM A TRANSITION TO THE DIMENSIONS SHOWN ABOVE.
2. NOTE THAT IN CONSTRUCTING THE TRANSITION, THE MAT DEPTH IS CONTINUED AS PART OF THE TRANSITION BEFORE FORMING THE FEATHER.

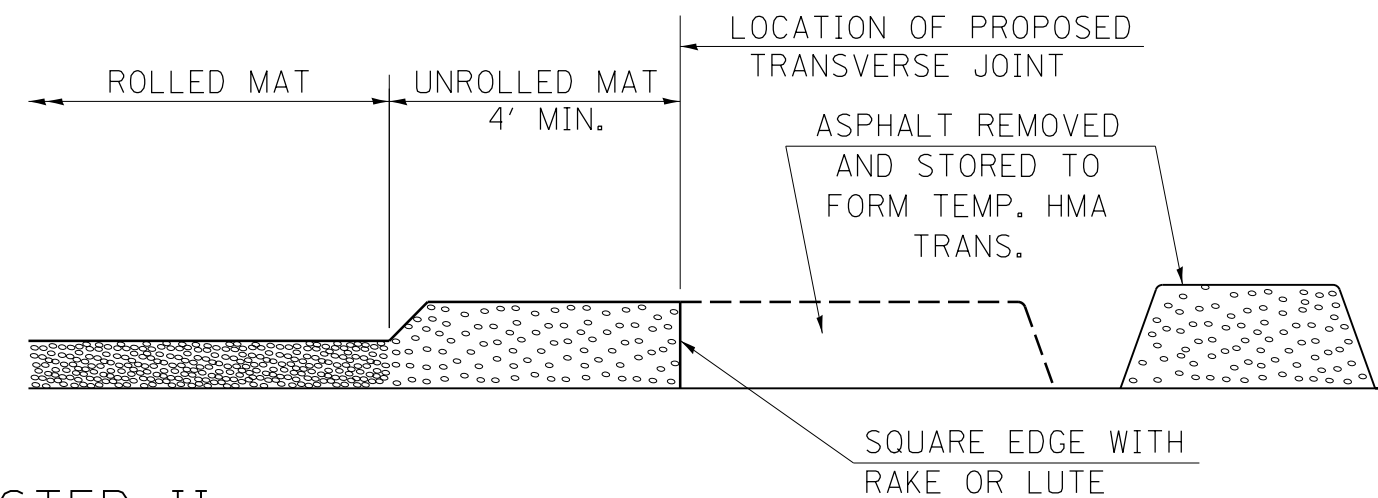

## STEP II

1. MOVE THE PAVER OUT OF THE WAY AND REMOVE THE ASPHALT FROM THE AREA OF THE PROPOSED TEMPORARY HOT-MIX ASPHALT TRANSITION.
2. SQUARE UP THE END OF THE MAT WITH A RAKE OR LUTE.
3. NOTE THAT THE MAT WITHIN 4' OF THE END OF JOINT IS NOT TO BE ROLLED AT THIS TIME.

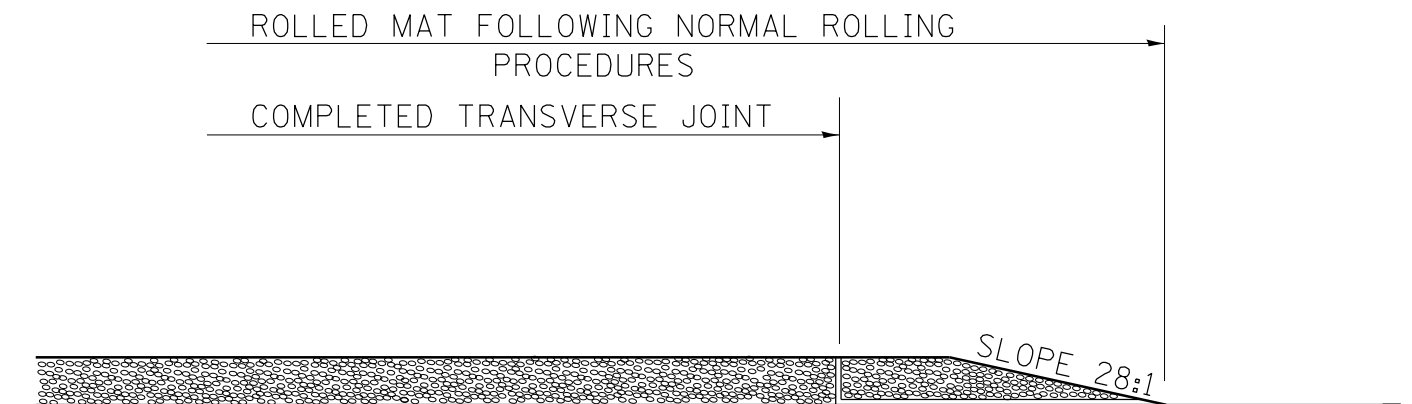

## STEP IV

1. COMPLETE TEMPORARY TRANSITION BY ROLLING.
2. TO RESUME PAVING, AT THE JOINT, REMOVE TEMPORARY TRANSITION AND DISPOSE OF THE MATERIAL ACCORDING TO ART. 202.03 OF THE STD. SPECS. (COST INCLUDED IN THE CONTRACT).
3. CONSTRUCTING THE TEMPORARY TRANSITIONS WILL NOT BE PAID FOR SEPARATELY IN ACCORDANCE WITH ARTICLE 406.14 OF THE STANDARD SPECIFICATIONS.

STD. 9-26

### REVISIONS

REDRAWN	2-15-89
REVISED	8-16-94
REVISED	01-09-07
RESIZED	05-8-08
REVISED	05-16-13

FILE NAME =	USER NAME = \$USER\$	DESIGNED -	REVISED -
ci:\pw\work\p\idot\stover\pg\0402026\78181-shta-cvr-soq.index.dgn		DRAWN -	REVISED -
	PLOT SCALE = 100.0000' / 1in.	CHECKED -	REVISED -
	PLOT DATE = 7/9/2014	DATE -	REVISED -

STATE OF ILLINOIS  
DEPARTMENT OF TRANSPORTATION

TEMPORARY HOT-MIX ASPHALT TRANSITIONS

SCALE: SHEET NO. OF SHEETS STA. TO STA.

F.A.P. RTE.	SECTION	COUNTY	TOTAL SHEETS	SHEET NO.
726	119(RS-1), 126(RS-11)	FRANKLIN	24	22
CONTRACT NO. 78181				
ILLINOIS FED. AID PROJECT				

# UNEVEN LANES SIGN

W8-11 (48'' x 48'')

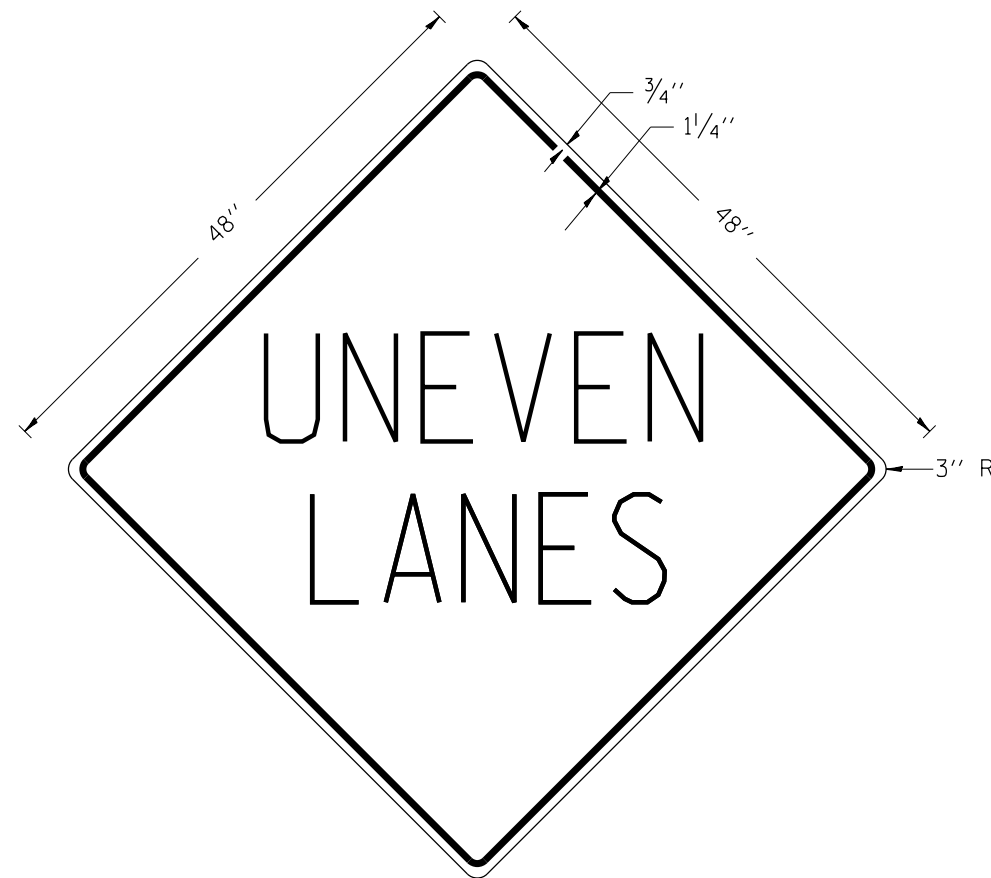

**COLORS:**

LEGEND AND BORDER - BLACK NON-REFLECTORIZED  
 BACKGROUND - ORANGE REFLECTORIZED

**NOTE:** PRIOR TO ALLOWING TRAFFIC ON ANY PORTION OF THE ROADWAY THAT HAS BEEN COLDMILLED OR BEFORE RESURFACING OPERATIONS BEGIN, THE CONTRACTOR SHALL HAVE ERECTED "UNEVEN PAVEMENT" SIGNS THAT CONFORM TO THE ABOVE DETAILS. A MINIMUM OF ONE SIGN AT EACH END OF THE IMPROVEMENT WILL BE REQUIRED. THE CONTRACTOR SHALL MAINTAIN THE "UNEVEN PAVEMENT" SIGNS UNTIL THE RESURFACING OPERATIONS ARE COMPLETED.

IF AT ANY TIME THE SIGNS ARE IN PLACE BUT NOT APPLICABLE, THEY SHALL BE TURNED FROM THE VIEW OF MOTORISTS OR COVERED AS DIRECTED BY THE ENGINEER.

THE COST OF FURNISHING, ERECTING, MAINTAINING, AND REMOVING THE REQUIRED SIGNS SHALL BE INCLUDED IN THE CONTRACT.

REVISIONS

DRAWN	2-15-89
REVISED	4-06-93
REDSIGNED	7-23-04
RESIZED	5-08-08
REVIEWED	5-17-13

STD. 9-41

FILE NAME =	USER NAME = \$USERS	DESIGNED -	REVISED -	<b>STATE OF ILLINOIS DEPARTMENT OF TRANSPORTATION</b>	<b>UNEVEN LANES SIGN</b>			F.A.P. RTE.	SECTION	COUNTY	TOTAL SHEETS	SHEET NO.
ci:\pw\work\p1dot\stoverpg\d0402026\78181	1-sh-ta-cvr-soq-index.dgn	DRAWN -	REVISED -					726	119(RS-1), 126(RS-11)	FRANKLIN	24	23
	PLOT SCALE = 100.0000' / 1in.	CHECKED -	REVISED -		SCALE:			SHEET NO.	OF SHEETS	STA.	TO STA.	ILLINOIS FED. AID PROJECT
	PLOT DATE = 7/9/2014	DATE -	REVISED -		CONTRACT NO. 78181							

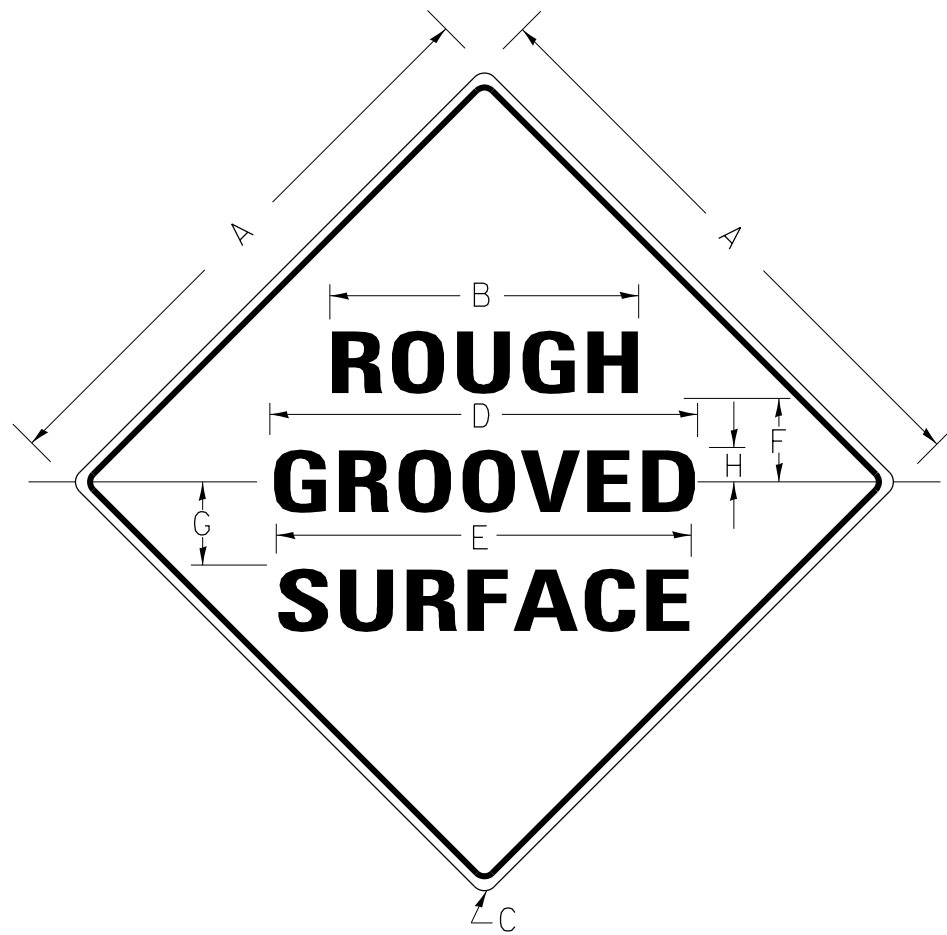

**COLORS:**

LEGEND AND BORDER- BLACK NON-REFLECTORIZED  
 BACKGROUND- ORANGE REFLECTORIZED

SIGN SIZE	DIMENSIONS							
	A	B	C	D	E	F	G	H
48X48	48.0	24.1	3.0	34.0	33.0	6.0	13.0	3.5

SIGN SIZE	SERIES LINES			MARGIN	BORDER	BLANK STD.
	1	2	3			
48X48	7C	7C	7C	0.8	1.2	B4-48D

ALL DIMENSIONS IN INCHES

**NOTES:**

PRIOR TO ALLOWING TRAFFIC ON ANY PORTION OF THE ROADWAY THAT HAS BEEN COLDMILLED, THE CONTRACTOR SHALL HAVE ERECTED "ROUGH GROOVED SURFACE" SIGNS THAT CONFORM TO THE ABOVE DETAILS. A MINIMUM OF ONE SIGN AT EACH END OF THE IMPROVEMENT WILL BE REQUIRED. THE CONTRACTOR SHALL MAINTAIN THE "ROUGH GROOVED SURFACE" SIGNS UNTIL THE COLDMILLED SURFACE IS COVERED WITH LEVELING BINDER OR SURFACE COURSE.

IF AT ANY TIME THE SIGNS ARE IN PLACE BUT NOT APPLICABLE, THEY SHALL BE TURNED FROM THE VIEW OF MOTORISTS OR COVERED AS DIRECTED BY THE ENGINEER.

THE COST OF FURNISHING, ERECTING, MAINTAINING, AND REMOVING THE REQUIRED SIGNS SHALL BE INCLUDED IN THE CONTRACT.

REVISIONS

REDRAWN	2-15-89
REVISED	4-6-93
REVISED	3-27-08
REVIEWED	5-17-13

STD. 9-39