

OMISSION - SN 076-0030 FROM
STA. 1372+42.5 TO STA. 1374+09.5

NOTE: EXISTING PAVEMENT IS 26' E-E.

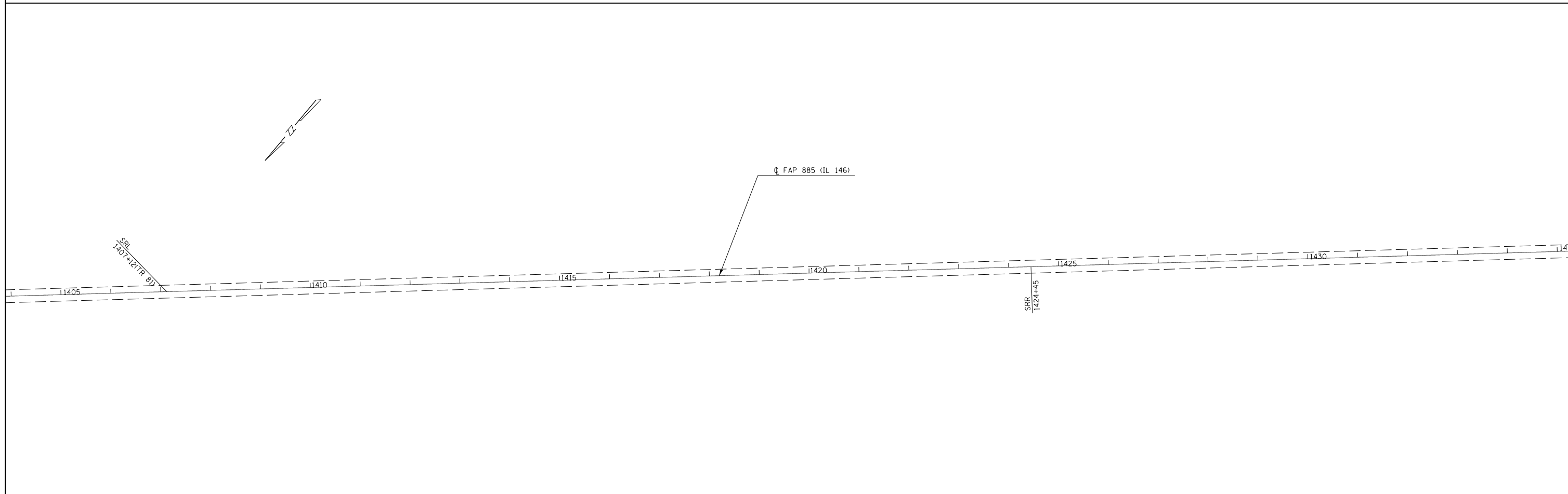
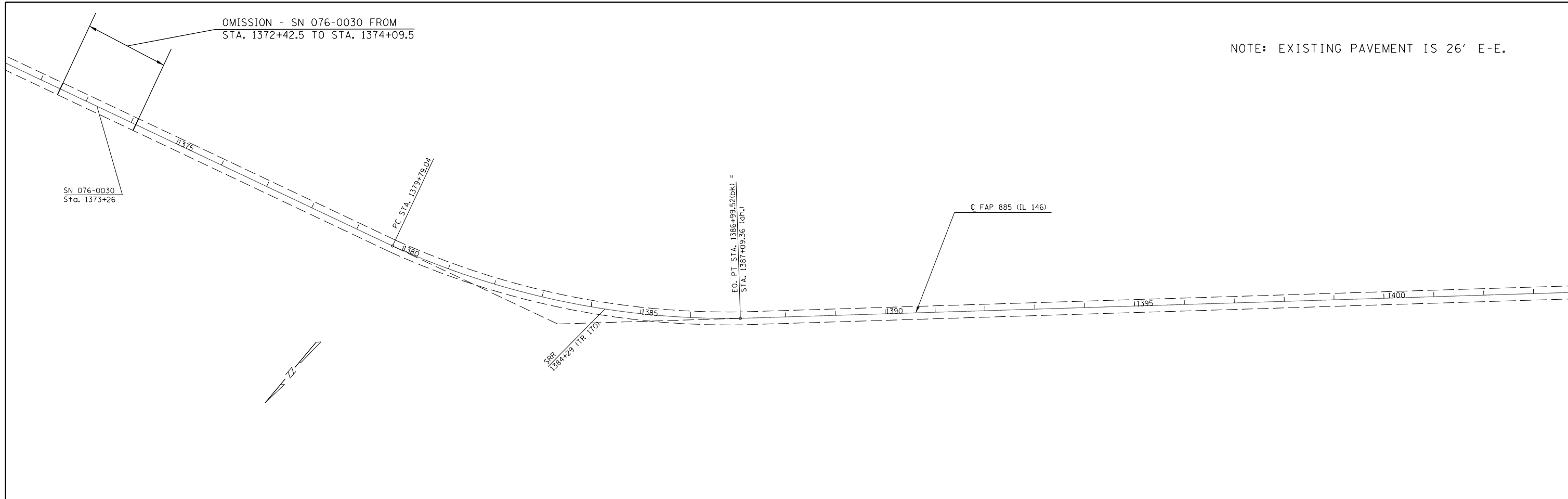

FILE NAME =	USER NAME = mccordkr	DESIGNED -	REVISED -
ei:\pw\work\p\idot\mccordkr\0402536\78339-sh1-plan.dgn		DRAWN -	REVISED -
Default	PLOT SCALE = 200.0000' / in.	CHECKED -	REVISED -
	PLOT DATE = 6/27/2014	DATE -	REVISED -

**STATE OF ILLINOIS
DEPARTMENT OF TRANSPORTATION**

PLAN LAYOUT #4			
SCALE:	SHEET	OF SHEETS	STA. TO STA.

F.A.P. RTE.	SECTION	COUNTY	TOTAL SHEETS	SHEET NO.
885	7RS-3,6RS-7	POPE/HARDIN	28	20
CONTRACT NO. 78339				
ILLINOIS FED. AID PROJECT				