

STATE OF ILLINOIS
DEPARTMENT OF TRANSPORTATION

F.A.U. RTE.	SECTION	COUNTY	TOTAL SHEETS	SHEET NO.
2916	2024-1023-RS	COOK	18	1
		ILLINOIS CONTRACT NO. 62X58		

FOR INDEX OF SHEETS, SEE SHEET NO. 2

THIS IMPROVEMENT IS LOCATED IN THE VILLAGES OF
SOUTH CHICAGO HEIGHTS AND STEGER.

TRAFFIC DATA

STATE ST.
2022 ADT: 3,150
POSTED SPEED LIMIT: 45 MPH

**PROPOSED
HIGHWAY PLANS**
**FAU ROUTE 2916 (STATE ST.)
FROM SAUK TRAIL TO STEGER ROAD
SECTION 2024-1023-RS
PROJECT STP-HBLQ(493)
STANDARD OVERLAY & BOX CULVERT CLEANING
COOK COUNTY**

C-91-069-25

LOCATION 1:
PROJECT BEGINS
FAU 2916 - STATE ST
STA. 17+42

LOCATION 1:
PROJECT ENDS
FAU 2916 - STATE ST
STA. 64+60

LOCATION 2:
SN: 016-1413
TORRENCE AVE OVER DITCH

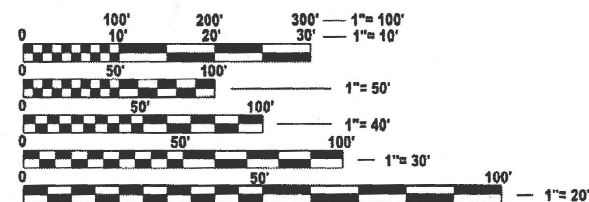

FULL SIZE PLANS HAVE BEEN PREPARED USING STANDARD
ENGINEERING SCALES. REDUCED SIZED PLANS WILL NOT
CONFORM TO STANDARD SCALES. IN MAKING MEASUREMENTS
ON REDUCED PLANS, THE ABOVE SCALES MAY BE USED.

J.U.L.I.E.
JOINT UTILITY LOCATION INFORMATION FOR EXCAVATION
1-800-892-0123
OR 811

PROJECT ENGINEER: RODRIGO LEDEZMA (847) 705-4580
PROJECT MANAGER: J. ALAIN MIDY (847) 221-3056

CONTRACT NO. 62X58

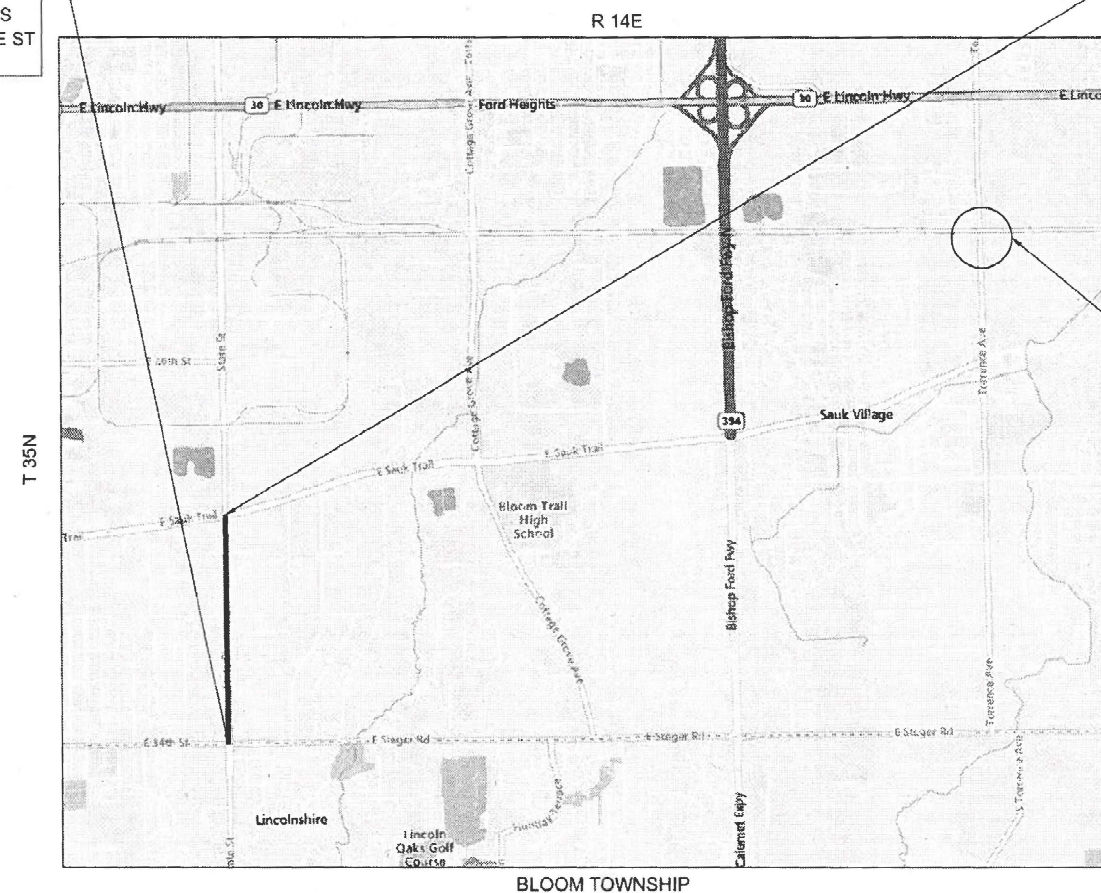

GROSS LENGTH = NET LENGTH = 4,718 FT. = 0.88 MILE



**STATE OF ILLINOIS
DEPARTMENT OF TRANSPORTATION**

SUBMITTED June 23rd 2025
Archives 12

REGIONAL ENGINEER

August 15 2025
Scott A. Etk
ENGINEER OF DESIGN AND ENVIRONMENT

August 15 2025
Harry 5
DIRECTOR OF HIGHWAYS PROJECT IMPLEMENTATION

**PRINTED BY THE AUTHORITY
OF THE STATE OF ILLINOIS**

INDEX OF SHEETS

STANDARD NO.	DESCRIPTION
1.	COVER SHEET
2.	INDEX OF SHEETS, STATE STANDARDS, AND GENERAL NOTES
3. - 4.	SUMMARY OF QUANTITIES
5.	TYPICAL SECTIONS
6. - 7.	ROADWAY PLANS
8.	BOX CULVERT - DEBRIS REMOVAL (SN 016-1413)
9.	DETECTOR LOOP REPLACEMENT PLANS
10.	FRAMES AND LIDS ADJUSTMENT WITH MILLING (BD-08)
11.	PAVEMENT PATCHING FOR HMA SURFACED PAVEMENT (BD-22)
12.	BUTT JOINTS AND HMA TAPER (BD-32)
13.	TRAFFIC CONTROL AND PROTECTION FOR SIDE ROADS, INTERSECTIONS, AND DRIVEWAYS (TC-10)
14.	RAISED REFLECTIVE PAVEMENT MARKERS (SNOW PLOW RESISTANT) (TC-11)
15.	DISTRICT ONE TYPICAL PAVEMENT MARKINGS (TC-13)
16.	TRAFFIC CONTROL AND PROTECTION AT TURN BAYS (TO REMAIN OPEN TO TRAFFIC) (TC-14)
17.	SHORT-TERM PAVEMENT MARKING LETTERS AND SYMBOLS (TC-16)
18.	ARTERIAL ROAD INFORMATION SIGN (TC-22)

STATE STANDARDS

STANDARD NO.	DESCRIPTION
000001-08	STANDARD SYMBOLS, ABBREVIATIONS AND PATTERNS
442201-03	CLASS C&D PATCHES
701001-02	OFF-RD OPERATIONS, 2L 2W, MORE THAN 15 FT
701006-05	OFF-RD OPERATIONS, 2L 2W, 15' TO 24" FROM PAVEMENT EDGE
701011-04	OFF-RD MOVING OPERATIONS, 2L 2W, DAY ONLY
701101-05	OFF-RD OPERATIONS, MULTILANE, 15' TO 24" FROM PAVEMENT EDGE
701106-02	OFF-RD OPERATIONS, MULTILANE, MORE THAN 15' AWAY
701201-05	LANE CLOSURE, 2L 2W, DAY ONLY, 45 MPH OR MORE
701301-04	LANE CLOSURE, 2L, 2W, SHORT TIME OPERATIONS
701306-04	LANE CLOSURE, 2L 2W, SLOW MOVING OPERATIONS, DAY ONLY, 45 MPH OR MORE
701311-03	LANE CLOSURE 2L, 2W, MOVING OPERATIONS - DAY ONLY
701426-09	LANE CLOSURE, MULTILANE, INTERMITTENT OR MOVING OPER., FOR SPEEDS ≥ 45 MPH
701501-06	URBAN LANE CLOSURE 2L, 2W, UNDIVIDED
701502-09	URBAN LANE CLOSURE, 2L, 2W, WITH BIDIRECTIONAL LEFT TURN LANE
701602-10	URBAN LANE CLOSURE, MULTILANE, 2W WITH BIDIRECTIONAL LEFT TURN LANE
701606-10	URBAN SINGLE LANE CLOSURE, MULTILANE, 2W WITH MOUNTABLE MEDIAN
701611-01	URBAN HALF ROAD CLOSURE, MULTILANE, , 2W WITH MOUNTABLE MEDIAN
701701-10	URBAN LANE CLOSURE, MULTILANE INTERSECTION
701901-10	TRAFFIC CONTROL DEVICES

GENERAL NOTES

1. THE CONTRACTOR WILL NOT BE ALLOWED TO SET UP A YARD OR FIELD OFFICE ON STATE PROPERTY WITHOUT WRITTEN PERMISSION FROM THE DEPARTMENT.
2. ALL MILLED SURFACES SHALL BE A UNIFORM CROSS SLOPE PER LANE AND FREE OF RIDGES BETWEEN PASSES. ANY DEVIATIONS SHALL BE CORRECTED AT NO COST TO THE DEPARTMENT.
3. BUTT JOINTS SHALL BE INSTALLED AT THE ENDS OF ALL RESURFACING (WHERE RESURFACING MEETS EXISTING PAVEMENT) ACCORDING TO THE "BUTT JOINT AND HOT-MIX ASPHALT TAPER DETAILS" SHEET INCLUDED IN THE PLANS, UNLESS OTHERWISE SPECIFIED.
4. ALL PAVEMENT PATCHING LOCATIONS WILL BE DETERMINED IN THE FIELD BY THE ENGINEER.
5. LOCATION OF COMBINATION CONCRETE CURB AND GUTTER REMOVAL AND REPLACEMENT [OR COMBINATION CURB AND GUTTER (THE TYPE SPECIFIED ON THE PLANS)], WILL BE DETERMINED IN THE FIELD BY THE ENGINEER.
6. TEN (10) FOOT TRANSITIONS SHALL BE USED TO MATCH PROPOSED CURB AND GUTTER AND MEDIAN ITEMS OF WORK TO EXISTING CURBS AND GUTTER AND MEDIANS IN THE FIELD, UNLESS OTHERWISE SHOWN.
7. DRAINAGE ADJUSTMENT OR RECONSTRUCTION LOCATIONS WILL BE DETERMINED IN THE FIELD BY THE ENGINEER.
8. IT SHALL BE THE CONTRACTOR'S RESPONSIBILITY TO VERIFY ALL DIMENSIONS AND CONDITIONS EXISTING IN THE FIELD PRIOR TO CONSTRUCTION AND ORDERING OF MATERIALS.
9. FRAMES AND GRATES ADJUSTMENT OF PRIVATE UTILITIES WITHIN THE LIMITS OF THE IMPROVEMENTS SHALL BE DONE BY THEIR RESPECTIVE OWNERS AND ARE NOT PART OF THIS CONTRACT.
10. THE CONTRACTOR SHALL BE REQUIRED TO KEEP A RECORD OF THE LOCATIONS OF PLATED STRUCTURES BY STATION AND OFFSET LEFT OR RIGHT OF THE CENTERLINE OF PAVEMENT.
11. THE CONTRACTOR SHALL BE REQUIRED TO KEEP A RECORD OF THE LOCATIONS OF THE BURIED STRUCTURES ACCORDING TO THE STATION AND DISTANCE LEFT OR RIGHT OF THE CENTERLINE OF PAVEMENT. UPON COMPLETION OF THE WORK, THE CONTRACTOR SHALL DELIVER THE RECORD TO THE ENGINEER.
12. EXISTING BROKEN FRAMES AND LIDS SHALL BE REMOVED AND DISPOSED OF BY THE CONTRACTOR AND SHALL BE REPLACED AS DIRECTED BY THE ENGINEER. REPLACEMENT FRAMES AND LIDS WILL BE PAID FOR ACCORDING TO ARTICLE 109.04 OF THE STANDARD SPECIFICATIONS UNLESS A SEPARATE PAY ITEM HAS BEEN PROVIDED.
13. THE CONTRACTOR SHALL CONTACT THE DISTRICT ONE TRAFFIC CONTROL SUPERVISOR KALPANA KANNAN-HOSDURGA AT KALPANA.KANNAN-HOSADURGA@ILLINOIS.GOV A MINIMUM OF 72 HOURS IN ADVANCE OF BEGINNING WORK.
14. THE ENGINEER SHALL CONTACT PATRICE HARRIS, AREA TRAFFIC FIELD TECHNICIAN, AT PATRICE.HARRIS@ILLINOIS.GOV A MINIMUM OF TWO (2) WEEKS PRIOR TO THE PLACEMENT OF PERMANENT PAVEMENT MARKINGS.
15. PAVEMENT MARKING TAPE, TYPE IV SHALL BE USED FOR SHORT TERM PAVEMENT MARKINGS ON ALL FINAL SURFACES.
16. OVERNIGHT LANE CLOSURES SHALL NOT BE ALLOWED FOR REHABILITATION PROJECTS INVOLVING DAYTIME MILLING AND RESURFACING OPERATIONS AND CLASS D PATCHING UNLESS OTHER CONDITIONS WARRANT EXTENDED LANE CLOSURES AS DETERMINED AND APPROVED IN WRITING BY THE ENGINEER OR AS PROVIDED FOR IN THE CONTRACT SPECIFICATIONS.

MODEL: GenNotesShr01 [Sheet]
FILE NAME: c:\pw_work\pwtdot\roth\pjd\104023D\105025-shr-gennote.dgn

	USER NAME = Jacob,Roth	DESIGNED -	REVISED -	STATE OF ILLINOIS DEPARTMENT OF TRANSPORTATION	GENERAL NOTES STATE ST. (SAUK TRAIL TO 34TH ST./STEGER RD.)			F.A.U RTE.	SECTION	COUNTY	TOTAL SHEETS	SHEET NO.
		DRAWN -	REVISED -					2916	2024-1023-RS	COOK		1
	PLOT SCALE = 0.16666633" / in.	CHECKED -	REVISED -					CONTRACT NO. 62X58				
	PLOT DATE = 6/25/2025	DATE -	REVISED -		SCALE:	SHEET	OF 1 SHEETS	STA.	TO STA.	ILLINOIS FED. AID PROJECT		

MODEL: SOQ-1 [Sheet]
FILE NAME: c:\pwy_work\pwydot\proj\pjd\1040623D\05025-sh-SOQ.dgn

SUMMARY OF QUANTITIES					TYPE						CODE													
					URBAN	URBAN	URBAN	URBAN	URBAN	URBAN	URBAN	URBAN	URBAN	URBAN	URBAN	URBAN	URBAN							
					ROADWAY	DRAINAGE							ROADWAY	DRAINAGE										
					80% FED 20% STATE	100% STATE							80% FED 20% STATE	100% STATE										
	Code No.	Item	Unit	Total Quantity	0005	0044							Code No.	Item	Unit	Total Quantity	0005	0044						
	40600290	BITUMINOUS MATERIALS (TACK COAT)	POUND	82378	82378									70102620	TRAFFIC CONTROL AND PROTECTION, STANDARD 701501	L SUM	1	1						
	40600370	LONGITUDINAL JOINT SEALANT	FOOT	5987	5987									70102622	TRAFFIC CONTROL AND PROTECTION, STANDARD 701502	L SUM	1	1						
	40600400	MIXTURE FOR CRACKS, JOINTS, AND FLANGEWAYS	TON	27	27									70102625	TRAFFIC CONTROL AND PROTECTION, STANDARD 701606	L SUM	1	1						
	40600982	HOT-MIX ASPHALT SURFACE REMOVAL - BUTT JOINT	SQ YD	149	149									70102632	TRAFFIC CONTROL AND PROTECTION, STANDARD 701602	L SUM	1	1						
	40601005	HOT-MIX ASPHALT REPLACEMENT OVER PATCHES	TON	110	110									70102634	TRAFFIC CONTROL AND PROTECTION, STANDARD 701611	L SUM	1	1						
	40603200	POLYMERIZED HOT-MIX ASPHALT BINDER COURSE, IL-4.75, N50	TON	725	725									70102635	TRAFFIC CONTROL AND PROTECTION, STANDARD 701701	L SUM	1	1						
	40604062	HOT-MIX ASPHALT SURFACE COURSE, IL-9.5, MIX "D", N70	TON	1476	1476									70300100	SHORT TERM PAVEMENT MARKING	FOOT	13629	13629						
	44000158	HOT-MIX ASPHALT SURFACE REMOVAL, 2 1/4"	SQ YD	17435	17435									70300150	SHORT TERM PAVEMENT MARKING REMOVAL	SQ FT	1136	1136						
	44002209	HOT-MIX ASPHALT REMOVAL OVER PATCHES, 2 1/4"	SQ YD	873	873									70300211	TEMPORARY PAVEMENT MARKING LETTERS AND SYMBOLS - PAINT	SQ FT	154.8	154.8						
	44003510	MEDIAN REMOVAL PARTIAL DEPTH	SQ FT	1229	1229									70300221	TEMPORARY PAVEMENT MARKING - LINE 4"- PAINT	FOOT	26634	26634						
	44201773	CLASS D PATCHES, TYPE I, 11 INCH	SQ YD	44	44									70300241	TEMPORARY PAVEMENT MARKING - LINE 6"- PAINT	FOOT	930	930						
	44201777	CLASS D PATCHES, TYPE II, 11 INCH	SQ YD	349	349									70300261	TEMPORARY PAVEMENT MARKING - LINE 12"- PAINT	FOOT	228	228						
	44201781	CLASS D PATCHES, TYPE III, 11 INCH	SQ YD	262	262									70300281	TEMPORARY PAVEMENT MARKING - LINE 24"- PAINT	FOOT	412	412						
	44201783	CLASS D PATCHES, TYPE IV, 11 INCH	SQ YD	218	218									70307120	TEMPORARY PAVEMENT MARKING - LINE 4" - TYPE IV TAPE	FOOT	3408	3408						
	48102100	AGGREGATE WEDGE SHOULDER, TYPE B	TON	263	263									* 78000100	THERMOPLASTIC PAVEMENT MARKING - LETTERS AND SYMBOLS	SQ FT	77.4	77.4						
*	63000001	STEEL PLATE BEAM GUARDRAIL, TYPE A, 6 FOOT POSTS	FOOT	50	50									* 78000200	THERMOPLASTIC PAVEMENT MARKING - LINE 4"	FOOT	13317	13317						
*	63100167	TRAFFIC BARRIER TERMINAL, TYPE 1 (SPECIAL) TANGENT	EACH	1	1									* 78000400	THERMOPLASTIC PAVEMENT MARKING - LINE 6"	FOOT	465	465						
	63200310	GUARDRAIL REMOVAL	FOOT	50	50									* 78000600	THERMOPLASTIC PAVEMENT MARKING - LINE 12"	FOOT	114	114						
	67100100	MOBILIZATION	L SUM	1	1									* 78000650	THERMOPLASTIC PAVEMENT MARKING - LINE 24"	FOOT	206	206						
	70100450	TRAFFIC CONTROL AND PROTECTION, STANDARD 701201	L SUM	1	1									78100100	RAISED REFLECTIVE PAVEMENT MARKER	EACH	82	82						
	70100460	TRAFFIC CONTROL AND PROTECTION, STANDARD 701306	L SUM	1	1									78300200	RAISED REFLECTIVE PAVEMENT MARKER REMOVAL	EACH	82	82						
* SPECIALTY ITEM																								
	USER NAME = Jacob.Roth		DESIGNED -		REVISED -		STATE OF ILLINOIS DEPARTMENT OF TRANSPORTATION						SUMMARY OF QUANTITIES STATE ST. (SAUK TRAIL TO 34TH ST./STEGER RD.)				F.A.U RTE.	SECTION		COUNTY	TOTAL SHEETS	SHEET NO.		
			DRAWN -		REVISED -												2916	2024-1023-RS		COOK	18	3		
			CHECKED -		REVISED -												CONTRACT NO. 62X58							
	PLOT DATE = 6/27/2025		DATE -		REVISED -												SCALE:		SHEET 1	OF 2	SHEETS	STA.	TO STA.	
																	ILLINOIS FED. AID PROJECT							

[illegible][illegible]

MODEL: SOQ-2 [Sheet]
FILE NAME: c:\pwk\work\pidot\rothj\p1040523\ID105025-sh1-SOQ.dgn

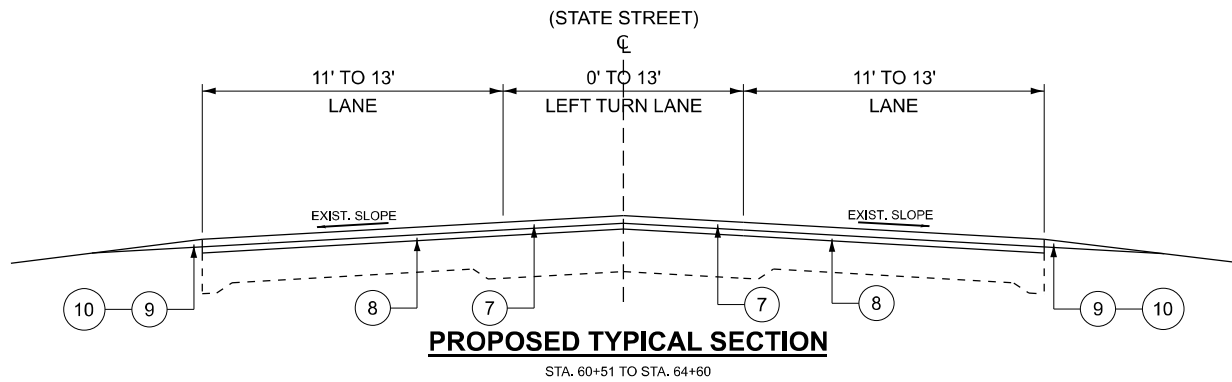
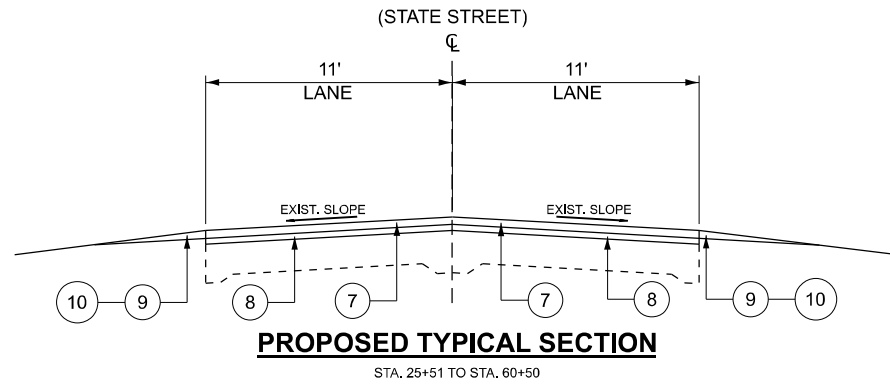
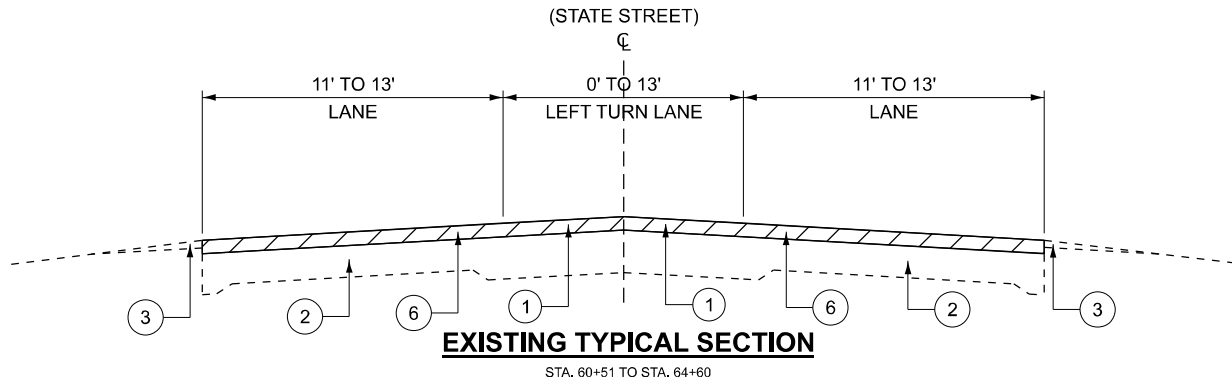
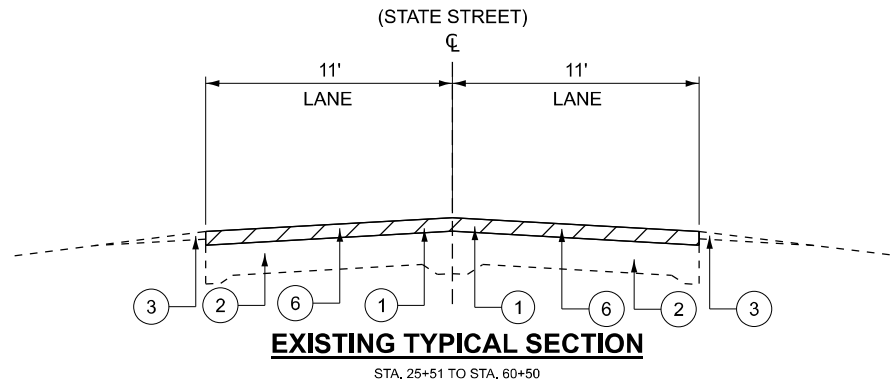

LEGEND

- 1 EXISTING HMA SURFACE COURSE, ±4"
- 2 EXISTING PCC BASE COURSE, ±9"
- 3 EXISTING AGGREGATE SHOULDER
- 4 EXISTING CURB AND GUTTER
- 5 EXISTING CORRUGATED MEDIAN
- 6 PROPOSED SURFACE REMOVAL, 2¼"
- 7 PROPOSED HMA SURFACE COURSE, IL-9.5, MIX "D", N70, 1½"
- 8 PROPOSED POLY. HMA BINDER COURSE, IL-4.75, N50, ¾"
- 9 PROPOSED AGGREGATE WEDGE SHOULDERS
- 10 PROPOSED GRADING AND SHAPING SHOULDERS
- 11 PROPOSED MEDIAN REMOVAL PARTIAL DEPTH, ±4", MILL FLUSH WITH ADJACENT MILLED SURFACE (CORR. MEDIAN ONLY)

NOTE:

- THE CONTRACTOR SHALL PATCH BEFORE MILLING.
- THE LONGITUDINAL JOINT SEALANT SHALL BE PLACED ON THE POLYMERIZED HOT-MIX ASPHALT BINDER COURSE, IL-4.75, N50.

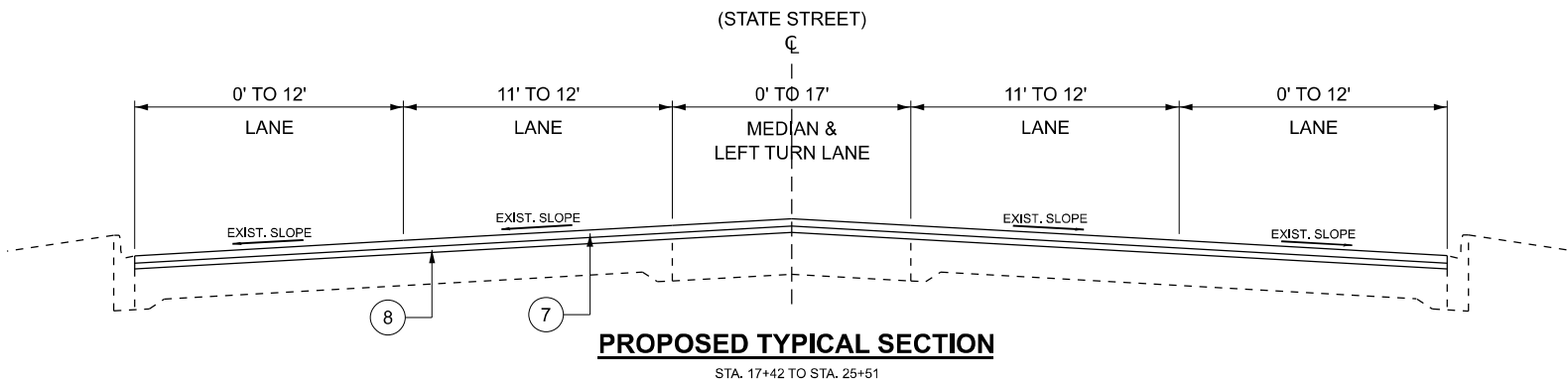
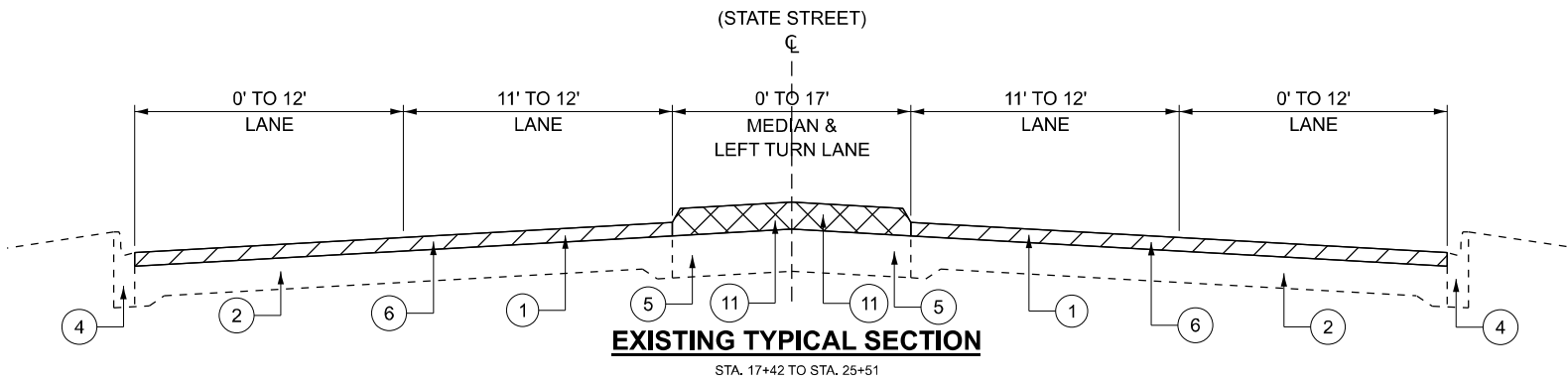

HOT-MIX ASPHALT MIXTURE REQUIREMENTS		QMP
MIXTURE TYPE	AIR VOIDS @ Ndesign	
PAVEMENT RESURFACING (STANDARD OVERLAY)		
HOT-MIX ASPHALT SURFACE COURSE, IL-9.5, MIX "D", N70, 1½"	4% @ 70 Gyr.	QCP
POLYMERIZED HOT-MIX ASPHALT BINDER COURSE, IL-4.75, N50, ¾"	3.5% @ 50 Gyr.	QC/QA
PATCHING		
CLASS D PATCHES (HMA BINDER IL-19.0)	4% @ 70 Gyr.	QC/QA
HMA REPLACEMENT OVER PATCHES (HMA BINDER IL-19.0)	4% @ 70 Gyr.	QC/QA
QMP Designations: Quality Control/Quality Assurance (QC/QA); Quality Control for Performance (QCP); Pay for Performance (PFP)		

THE UNIT WEIGHT USED TO CALCULATE ALL HMA SURFACE MIXTURE QUANTITIES IS 112 LBS/SQ YD/IN.

THE "AC TYPE" FOR POLYMERIZED HMA MIXES SHALL BE "SBS/SBR PG 76-22" AND FOR NON-POLYMERIZED HMA THE "AC TYPE" SHALL BE "PG 64-22" UNLESS MODIFIED BY RECLAIMED MATERIALS SPECIFICATIONS.

MODEL: Typical Sections (Sheet)
FILE NAME: c:\paw\work\road\typical\1040623D\105025-sh-typical.dgn

USER NAME = Jacob,Roth	DESIGNED -	REVISED -
	DRAWN -	REVISED -
	CHECKED -	REVISED -
PLOT DATE = 6/25/2025	DATE -	REVISED -

STATE OF ILLINOIS
DEPARTMENT OF TRANSPORTATION

TYPICAL SECTIONS
STATE ST. (SAUK TRAIL TO 34TH ST./STEGE RD.)

SCALE: SHEET 1 OF 1 SHEETS STA. TO STA.

F.A.U. RTE.	SECTION	COUNTY	TOTAL SHEETS	SHEET NO.
2916	2024-1023-RS	COOK	18	5
CONTRACT NO. 62X58				
ILLINOIS FED. AID PROJECT				

MODEL: STATE - RdwyPlan01 [Sheet]
FILE NAME: c:\pwworking\dot\roth\p\1040023D\105025-shh-plan.dgn

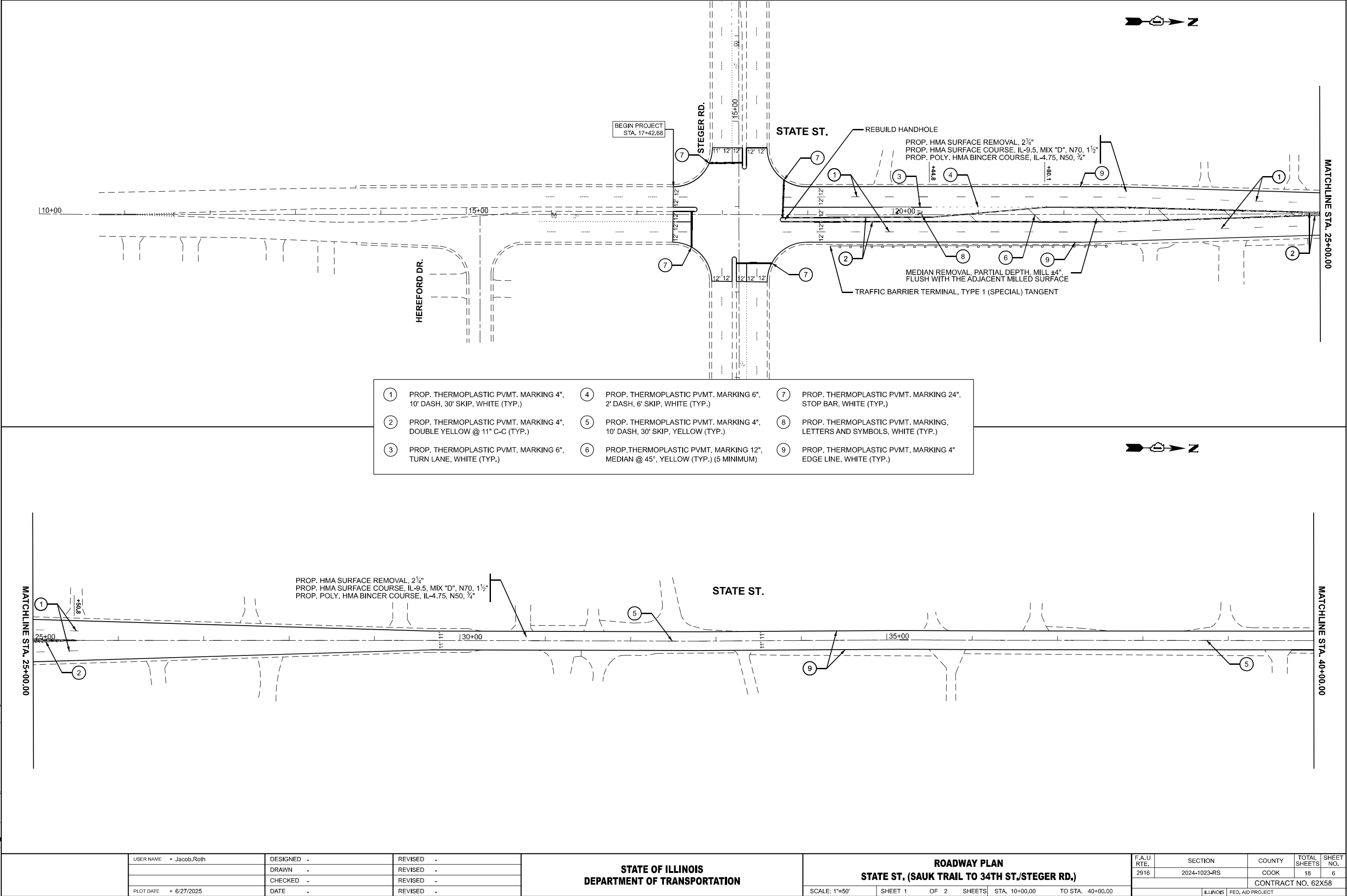

MODEL: STATE-RdwyPlan03 (Sheet)
FILE NAME: c:\pwworking\roth\pjd\104023D\105025-shr-plan.dgn

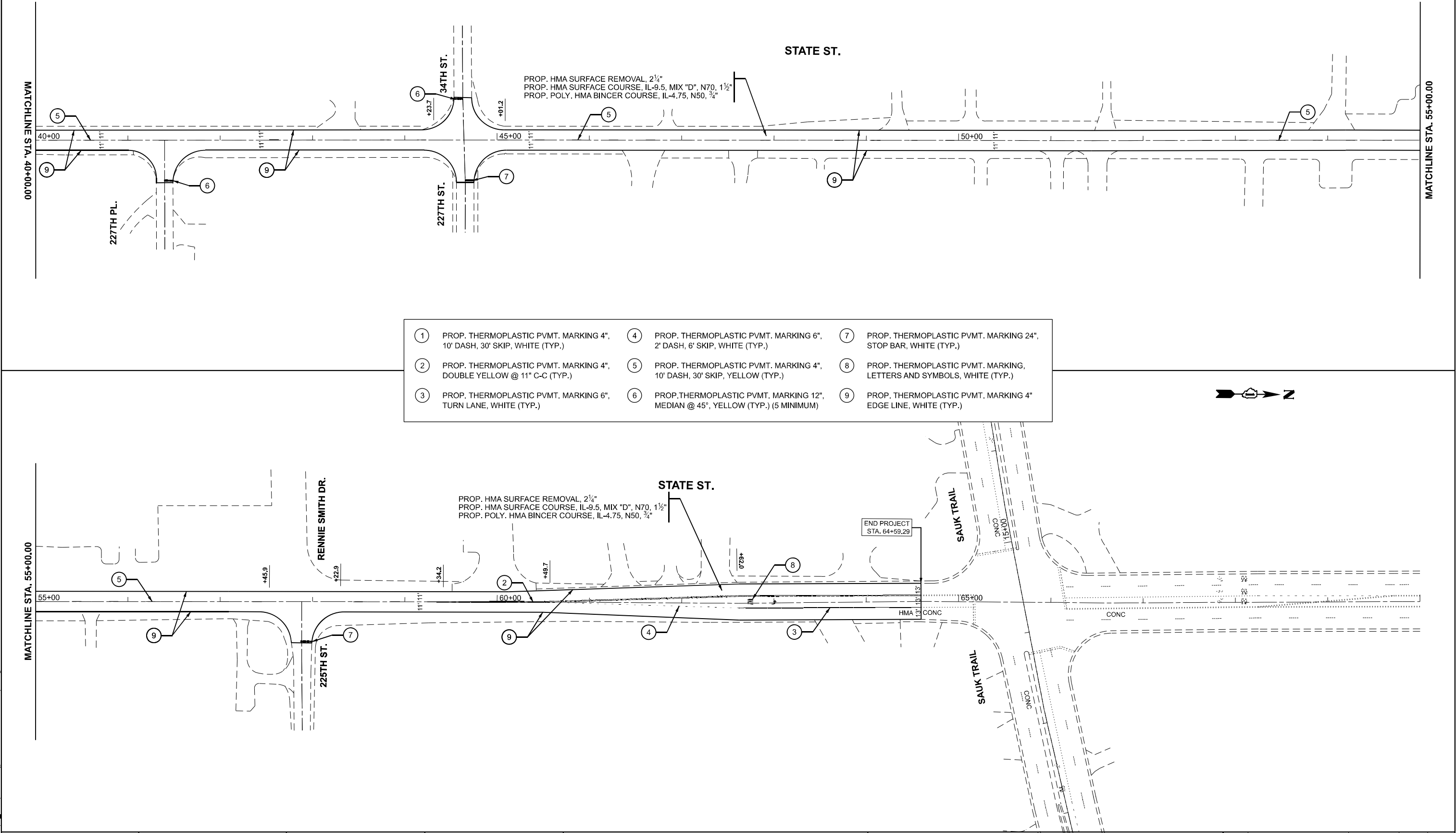

- | | | | | | |
|---|------------------------------------------------------------------------|---|--------------------------------------------------------------------------------|---|----------------------------------------------------------------------|
| 1 | PROP. THERMOPLASTIC PVMT. MARKING 4", 10' DASH, 30' SKIP, WHITE (TYP.) | 4 | PROP. THERMOPLASTIC PVMT. MARKING 6", 2' DASH, 6' SKIP, WHITE (TYP.) | 7 | PROP. THERMOPLASTIC PVMT. MARKING 24", STOP BAR, WHITE (TYP.) |
| 2 | PROP. THERMOPLASTIC PVMT. MARKING 4", DOUBLE YELLOW @ 11" C-C (TYP.) | 5 | PROP. THERMOPLASTIC PVMT. MARKING 4", 10' DASH, 30' SKIP, YELLOW (TYP.) | 8 | PROP. THERMOPLASTIC PVMT. MARKING, LETTERS AND SYMBOLS, WHITE (TYP.) |
| 3 | PROP. THERMOPLASTIC PVMT. MARKING 6", TURN LANE, WHITE (TYP.) | 6 | PROP. THERMOPLASTIC PVMT. MARKING 12", MEDIAN @ 45°, YELLOW (TYP.) (5 MINIMUM) | 9 | PROP. THERMOPLASTIC PVMT. MARKING 4" EDGE LINE, WHITE (TYP.) |

	USER NAME = Jacob,Roth	DESIGNED -	REVISED -
		DRAWN -	REVISED -
		CHECKED -	REVISED -
	PLOT DATE = 6/27/2025	DATE -	REVISED -

STATE OF ILLINOIS
DEPARTMENT OF TRANSPORTATION

ROADWAY PLAN			
STATE ST. (SAUK TRAIL TO 34TH ST./STEGE RD.)			
SCALE: 1"=50'	SHEET 2	OF 2 SHEETS	STA. 40+00.00 TO STA. 70+00.00

F.A.U RTE.	SECTION	COUNTY	TOTAL SHEETS	SHEET NO.
2916	2024-1023-RS	COOK	18	7
CONTRACT NO. 62X58				
ILLINOIS FED. AID PROJECT				

STATE ST.



LOCATION MAP
SN: 016-1413



EXISTING CONDITION
CELL 1



EXISTING CONDITION
CELL 2

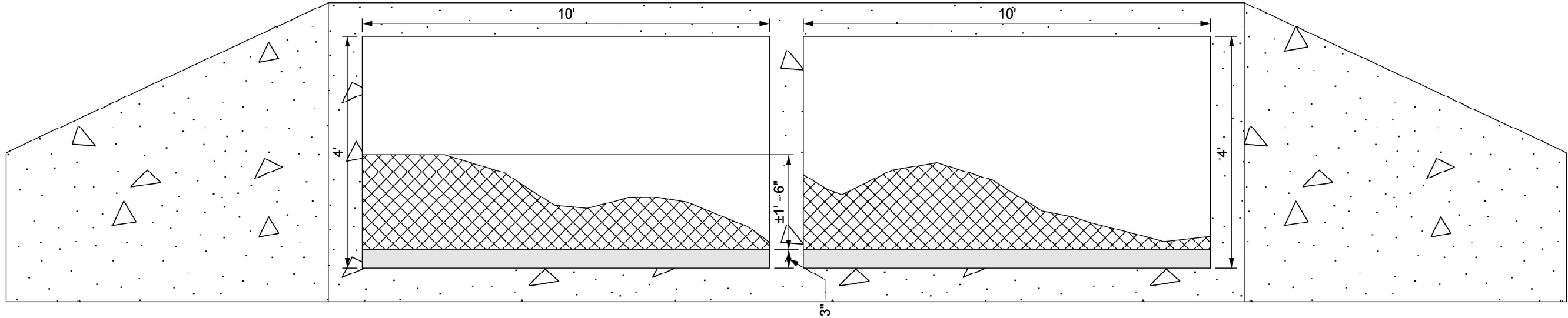

SN 016-1413
TOTAL LENGTH: 50 FT

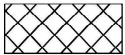

DEBRIS REMOVAL



EMBEDMENT TO REMAIN, 3"

MODEL: DetailSheet01 [Sheet]
FILE NAME: c:\pwworkspace\proj\1040523\1040523-rtt-details.dgn

USER NAME	= Jacob.Roth	DESIGNED	-	REVISED	-
		DRAWN	-	REVISED	-
		CHECKED	-	REVISED	-
PLOT DATE	= 6/27/2025	DATE	-	REVISED	-

STATE OF ILLINOIS
DEPARTMENT OF TRANSPORTATION

BOX CULVERT CLEANING - DEBRIS REMOVAL (SN 016-1413)
STATE ST. (SAUK TRAIL TO 34TH ST./STEGER RD.)

SCALE: SHEET 1 OF 1 SHEETS STA. 0+00.00 TO STA. 0+00.00

F.A.U. RTE.	SECTION	COUNTY	TOTAL SHEETS	SHEET NO.
2916	2024-1023-RS	COOK	18	8
CONTRACT NO. 62X58				
ILLINOIS FED. AID PROJECT				

1. WORK SHALL MEET THE REQUIREMENTS OF THE SPECIAL PROVISION, "DETECTOR LOOP REPLACEMENT AND/OR INSTALLATION (ROADWAY GRINDING, RESURFACING & PATCHING OPERATIONS)".

2. THIS PLAN IS FOR THE SOLE PURPOSE OF DETECTOR LOOP REPLACEMENT.

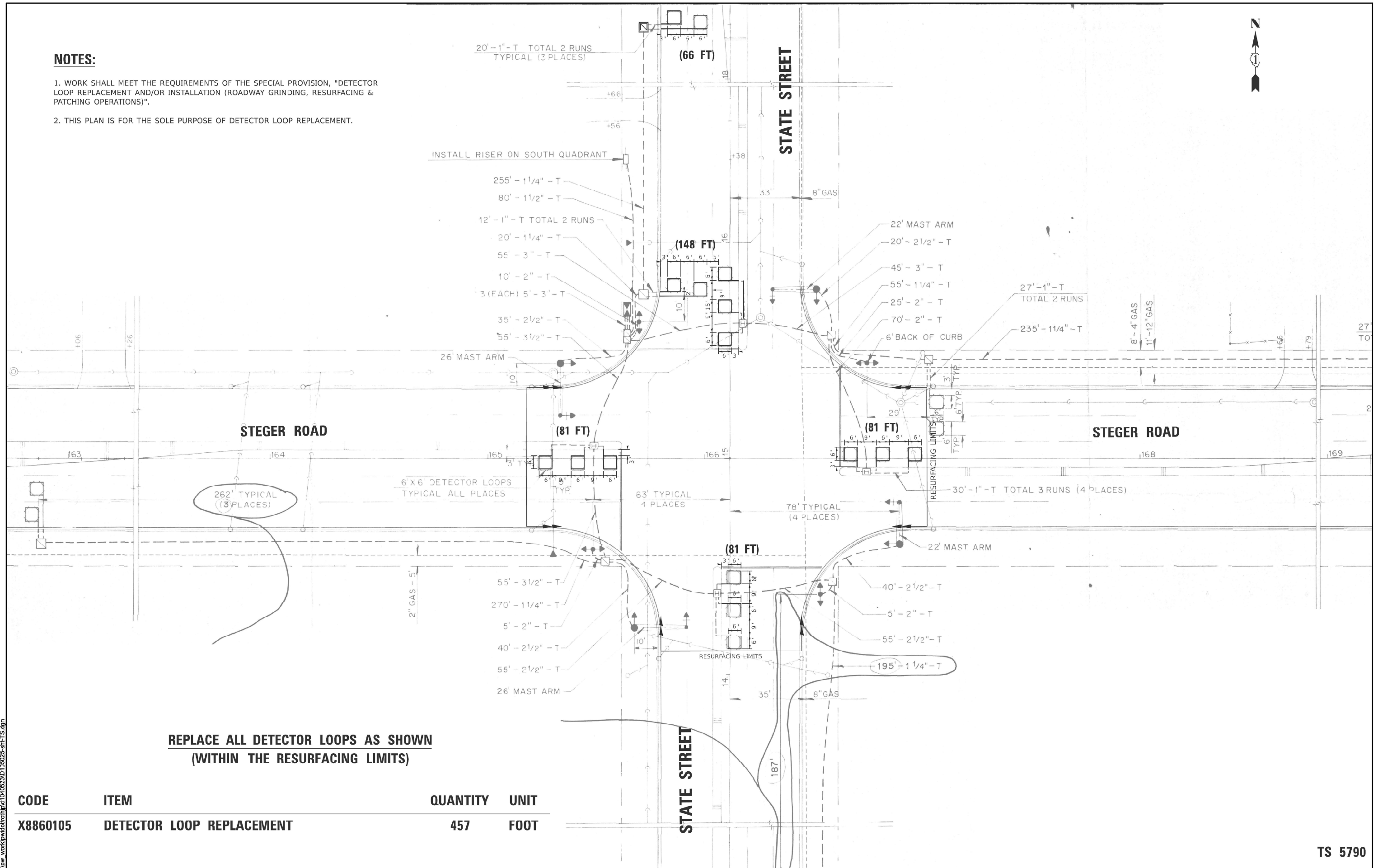

CODE	ITEM	QUANTITY	UNIT
X8860105	DETECTOR LOOP REPLACEMENT	457	FOOT

USER NAME = Jacob Roth	DESIGNED = KJS	REVISED =
	DRAWN = EL	REVISED =
	CHECKED = KJS	REVISED =
PLOT DATE = 6/25/2025	DATE = 06/17/2025	REVISED =

**STATE OF ILLINOIS
DEPARTMENT OF TRANSPORTATION**

DETECTOR LOOP REPLACEMENT DETAILS
STATE ST. (SAUK TRAIL TO 34TH ST./STEGER RD.)

F.A.U RTE.	SECTION	COUNTY	TOTAL SHEETS	SHEET NO.
2916	2024-1023-RS	COOK	18	9
		CONTRACT NO. 62X58		
		ILLINOIS FED. AID PROJECT		

S 5790

MODEL: DL-1 [Sheet]
FILE NAME: c:\pw\work\pwr\trt\p\1040523\DL105025-sht-TS.dgn

MODEL: BD-08 (Sheet)
FILE NAME: c:\paw_work\dwg\road\road\pjd\1040023D\105025-shd-DistSStd.dgn

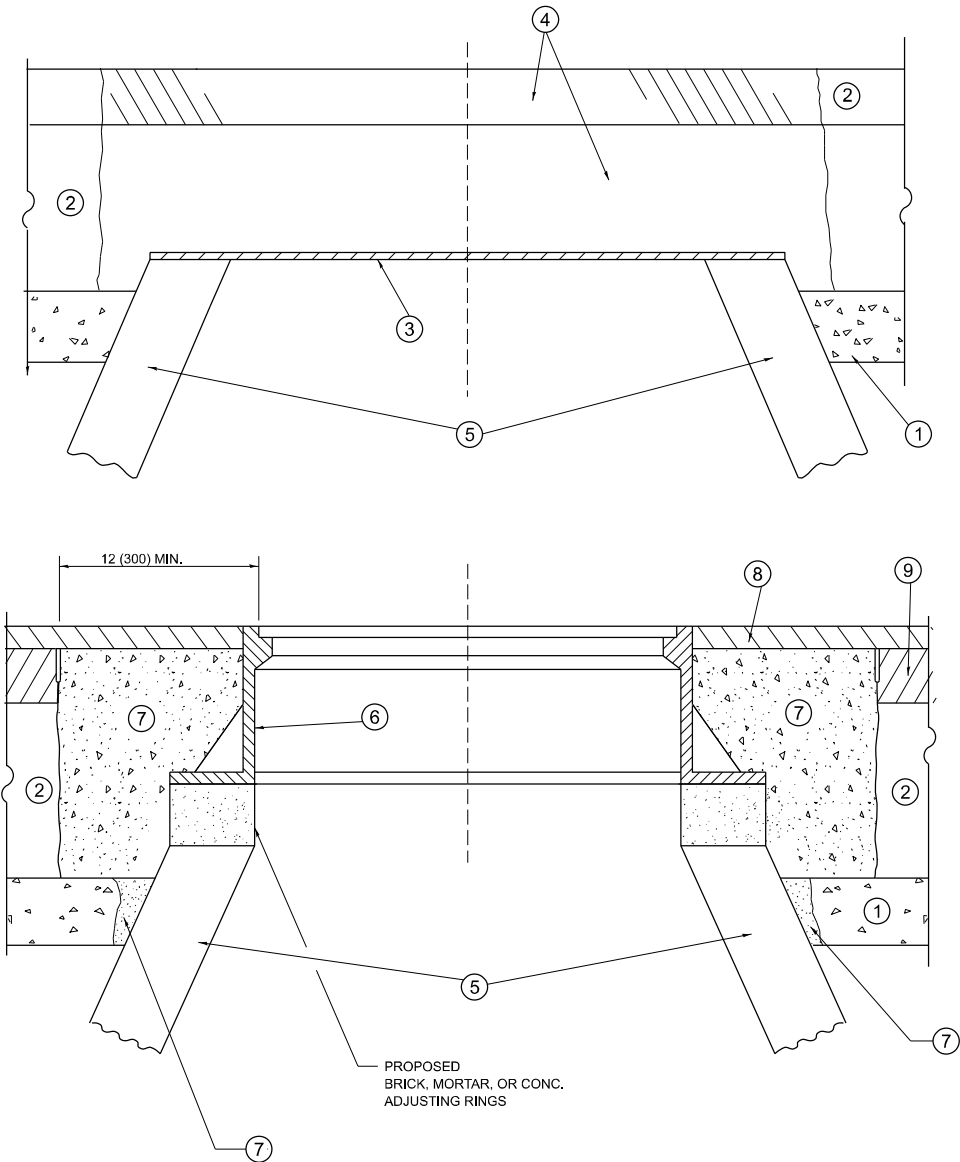

**DETAILS FOR FRAMES AND LIDS ADJUSTMENT
WITH MILLING**

NOTES

- EXISTING BROKEN FRAMES AND LIDS SHALL BE REMOVED AND DISPOSED OF BY THE CONTRACTOR AND SHALL BE REPLACED AS DIRECTED BY THE ENGINEER. REPLACEMENT FRAMES AND LIDS WILL BE PAID FOR IN ACCORDANCE WITH ARTICLE 109.04 OF THE STANDARD SPECIFICATIONS UNLESS A SEPARATE PAY ITEM HAS BEEN PROVIDED.
- IF THE EXISTING LIDS ARE OPEN, THE FRAME WILL BE ADJUSTED TO THE ELEVATION OF THE MILLED PAVEMENT SURFACE PRIOR TO THE MILLING OPERATION. THE FRAME WILL NOT BE REMOVED AND COVERED BY THE METAL PLATE.
- CITY OF CHICAGO CASTINGS ARE THE PROPERTY OF THE CITY AND THE CONTRACTOR SHALL NOTIFY THE CITY FOR REMOVAL AND DISPOSITION OF THE CASTINGS.
- THE METAL PLATE USED TO COVER THE STRUCTURE SHALL REMAIN THE PROPERTY OF THE CONTRACTOR.
- THE CONTRACTOR SHALL REMOVE ALL TRAFFIC CONTROL DEVICES BY THE END OF EACH WORK SHIFT.

CONSTRUCTION PROCEDURES

STAGE 1 (BEFORE PAVEMENT MILLING)

- REMOVE A MINIMUM OF 12 (300) OF THE PAVEMENT FROM AROUND THE STRUCTURE.
- REMOVE THE EXISTING FRAME AND LID FROM THE STRUCTURE.
- COVER THE STRUCTURE OPENING WITH A 36 (900) DIAMETER METAL PLATE.
- BACKFILL WITH CRUSHED STONE AND HMA SURFACE MIX APPROVED BY THE ENGINEER. (MIN. 3 (80) HMA TO REMAIN AFTER MILLING).

STAGE 2 (AFTER PAVEMENT MILLING)

- REMOVE THE HMA SURFACE MIX AND CRUSHED STONE.
- INSTALL THE FRAME AND LID; ADJUST THE FRAME TO ITS FINAL SURFACE ELEVATION.
- THE SURROUNDING SPACE SHALL BE FILLED WITH CLASS PP-2* CONCRETE TO THE ELEVATION OF THE SURFACE OF THE EXISTING BASE COURSE OR THE BINDER COURSE.

*UNLESS OTHERWISE SPECIFIED IN THE PLANS.

THE PROCEDURE EXPLAINED ABOVE SHALL CONFORM TO THE APPLICABLE PORTIONS OF SECTIONS 353, 406, 602, AND 603 OF THE STANDARD SPECIFICATIONS EXCEPT THAT "THE CONTRACTOR SHALL ADJUST THE STRUCTURES TO THE FINISHED PAVEMENT ELEVATION NO MORE THAN 5 CALENDAR DAYS PRIOR TO PLACEMENT OF THE FINAL LIFT OF SURFACE UNLESS APPROVED BY THE ENGINEER."

LEGEND

- | | |
|----------------------------------------------|-------------------------------|
| ① SUB-BASE GRANULAR MATERIAL | ⑥ FRAME AND LID (SEE NOTES) |
| ② EXISTING PAVEMENT | ⑦ CLASS PP-2* CONCRETE |
| ③ 36 (900) DIAMETER METAL PLATE | ⑧ PROPOSED HMA SURFACE COURSE |
| ④ PROPOSED CRUSHED STONE AND HMA SURFACE MIX | ⑨ PROPOSED HMA BINDER COURSE |
| ⑤ EXISTING STRUCTURE | |

LOCATION OF STRUCTURES

THE CONTRACTOR WILL BE REQUIRED TO KEEP A RECORD OF THE LOCATIONS OF THE BURIED STRUCTURES ACCORDING TO THE STATION AND DISTANCE LEFT OR RIGHT OF THE CENTERLINE OF PAVEMENT. UPON COMPLETION OF THE WORK, THE CONTRACTOR WILL DELIVER THE RECORD TO THE ENGINEER.

BASIS OF PAYMENT

- REMOVING FRAMES AND LIDS ON DRAINAGE AND UTILITY STRUCTURES IN THE PAVEMENT PRIOR TO MILLING, AND ADJUSTING TO FINAL GRADE PRIOR TO PLACING THE SURFACE COURSE, WILL BE PAID FOR AT THE CONTRACT UNIT PRICE EACH FOR "FRAMES AND LIDS TO BE ADJUSTED (SPECIAL)."
- THIS WORK WILL NOT BE PAID FOR WHEN DRAINAGE AND UTILITY STRUCTURES ARE SPECIFIED FOR PAYMENT AS STRUCTURE RECONSTRUCTION.
- NEW FRAMES AND LIDS, WHEN SPECIFIED, WILL BE PAID FOR SEPARATELY.
- WHEN STRUCTURES ARE TO BE ADJUSTED OR RECONSTRUCTED, THE LOWERING AND RAISING OF THE FRAMES AND LIDS WILL NOT BE PAID FOR SEPARATELY BUT WILL BE INCLUDED IN THE COST OF THE CORRESPONDING PAY ITEM.

ALL DIMENSIONS ARE IN INCHES (MILLIMETERS) UNLESS OTHERWISE SHOWN

	USER NAME = Jacob,Roth	DESIGNED - R. SHAH	REVISED - R. BORO 03-09-11	STATE OF ILLINOIS DEPARTMENT OF TRANSPORTATION	DETAILS FOR FRAMES AND LIDS ADJUSTMENT WITH MILLING			F.A.U RTE.	SECTION	COUNTY	TOTAL SHEETS	SHEET NO.
		DRAWN -	REVISED - R. BORO 12-06-11					2916	2024-1023-RS	COOK	18	10
		CHECKED -	REVISED - K. SMITH 11-18-22		BD600-03 (BD-08)			CONTRACT NO. 62X58				
	PLOT DATE = 6/27/2025	DATE - 10-25-94	REVISED - K. SMITH 09-15-23		SCALE: NONE	SHEET 1	OF 1 SHEETS	STA.	TO STA.	ILLINOIS FED. AID PROJECT		

METHOD OF MEASUREMENT

REFER TO SECTION 442 OF THE STANDARD SPECIFICATIONS FOR ROAD AND BRIDGE CONSTRUCTION AND THE RECURRING SPECIAL PROVISION "PATCHING WITH HOT-MIX ASPHALT OVERLAY REMOVAL."

BASIS OF PAYMENT

1. REFER TO SECTION 442 OF THE STANDARD SPECIFICATIONS FOR ROAD AND BRIDGE CONSTRUCTION AND THE RECURRING SPECIAL PROVISION "PATCHING WITH HOT-MIX ASPHALT OVERLAY REMOVAL."
2. SAW CUT/SCORING OF EXISTING HMA OVERLAY IS INCLUDED IN THE COST OF PAVEMENT PATCHING.
3. SAW CUT/SCORING OF EXISTING PAVEMENT IS INCLUDED IN THE COST OF PAVEMENT PATCHING.

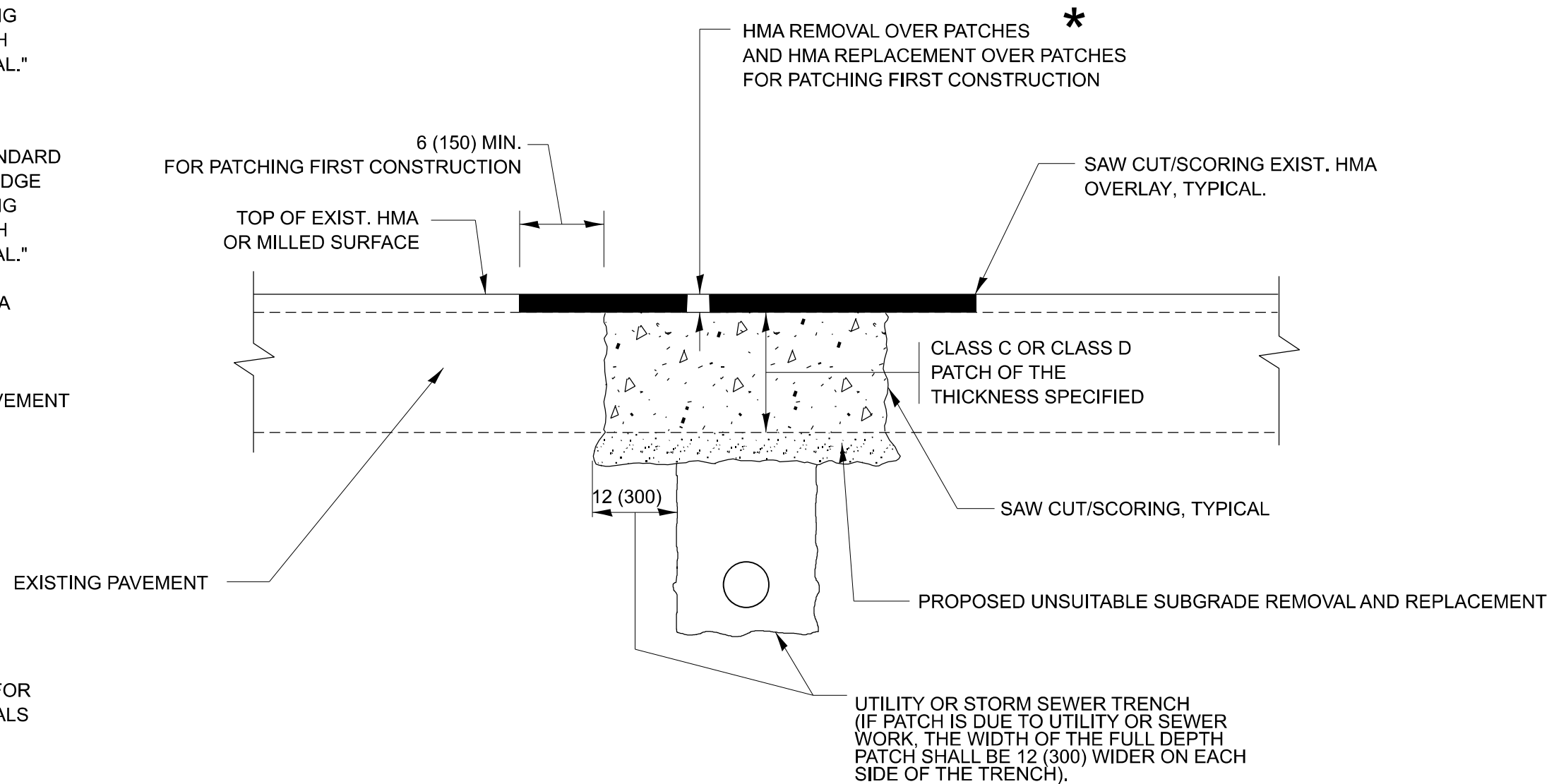

SEQUENCE OF CONSTRUCTION (PATCHING FIRST)

1. REMOVE THE EXISTING HMA MATERIAL OVER THE AREA TO BE PATCHED.
2. REMOVE AND REPLACE WITH CLASS C OR D PATCH.
3. REPLACE HMA MATERIAL OVER THE AREA TO BE PATCHED.

SEQUENCE OF CONSTRUCTION (MILLING FIRST)

1. MILL HMA FIRST IF THERE IS AT LEAST 4 ½ INCHES OR MORE OF HMA MATERIAL ON TOP OF THE EXISTING PAVEMENT OR IF THE PAVEMENT IS FULL DEPTH HMA. A MINIMUM OF 2 INCHES OF HMA MATERIAL SHALL BE IN PLACE AFTER MILLING.
2. REMOVE AND REPLACE WITH FULL DEPTH CLASS D PATCHES TO TOP OF MILLED SURFACE.

ALL DIMENSIONS ARE IN INCHES (MILLIMETERS) UNLESS OTHERWISE SHOWN.

FILE NAME:	USER NAME = Jacob,Roth	DESIGNED - R. SHAH	REVISED - R. BORO 01-01-07	STATE OF ILLINOIS DEPARTMENT OF TRANSPORTATION	PAVEMENT PATCHING FOR HMA SURFACED PAVEMENT				F.A.U RTE.	SECTION	COUNTY	TOTAL SHEETS	SHEET NO.	
		DRAWN -	REVISED - R. BORO 09-04-07						2916	2024-1023-RS	COOK	18	11	
		CHECKED -	REVISED - K. ENG 10-27-08		BD400-04 (BD-22)				CONTRACT NO. 62X58					
	PLOT DATE = 6/27/2025	DATE = 10-25-94	REVISED - K. SMITH 11-18-22		SCALE: NONE	SHEET 1	OF 1	SHEETS	STA.	TO STA.				
					ILLINOIS FED. AID PROJECT									

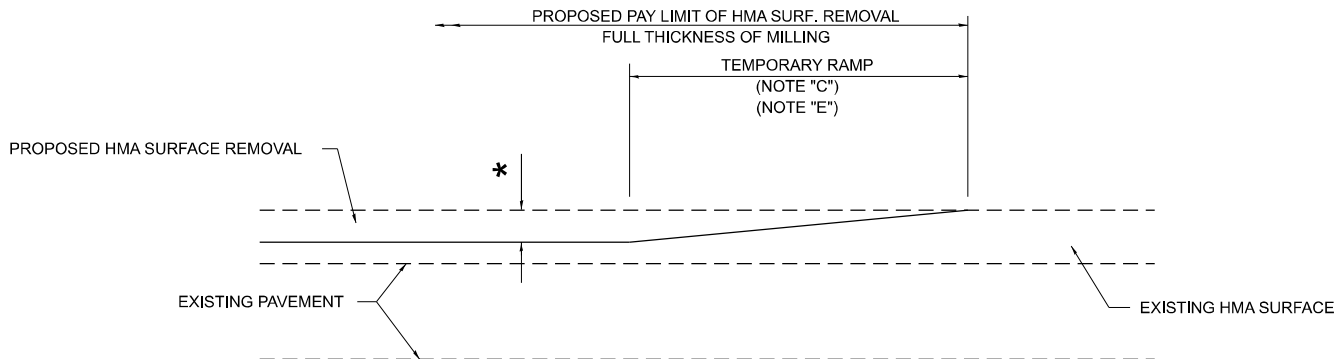

MILLED TEMPORARY RAMP
(FOR BUTT JOINT AND HMA TAPER SEE DETAIL BELOW)

OPTION 1

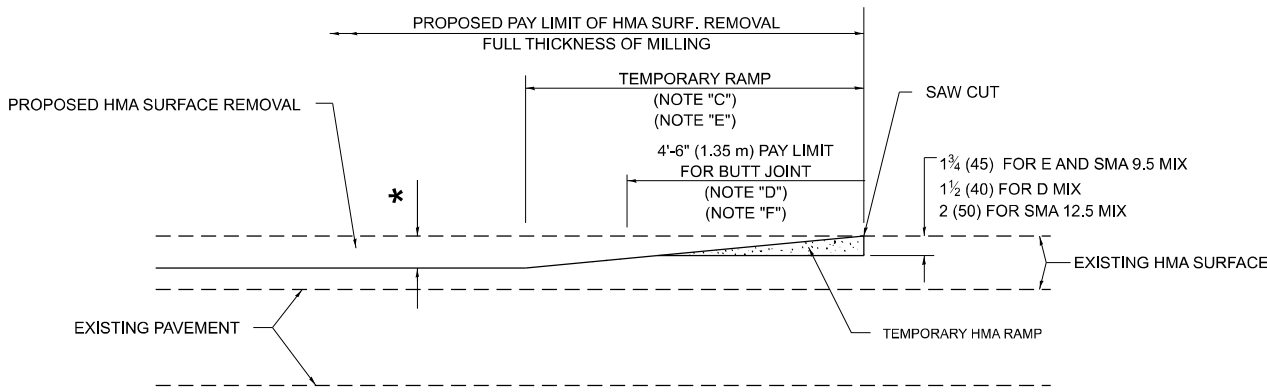

HMA CONSTRUCTED TEMPORARY RAMP
(FOR BUTT JOINT AND HMA TAPER SEE DETAIL BELOW)

OPTION 2

TYPICAL TEMPORARY RAMP

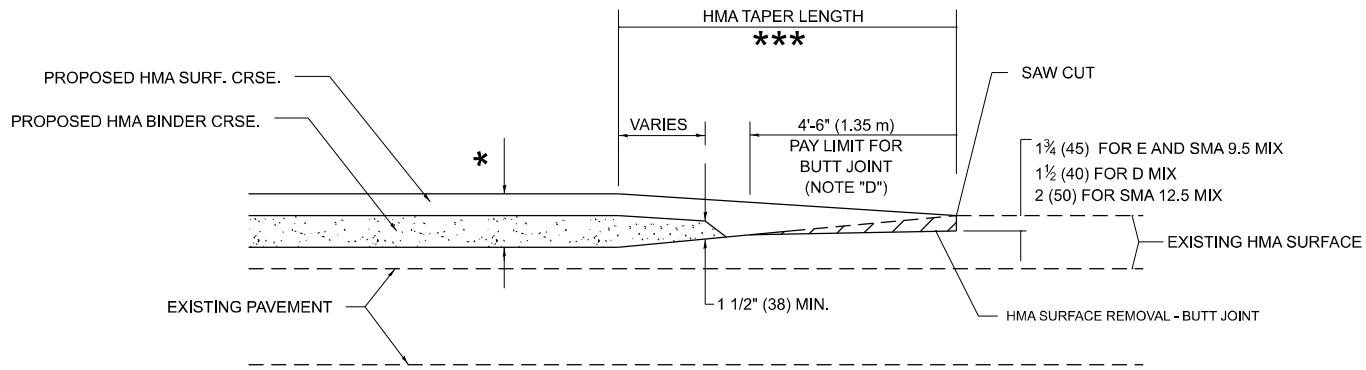

**BUTT JOINT AND
HMA TAPER**

**TYPICAL BUTT JOINT AND HMA TAPER
FOR MILLING AND RESURFACING**

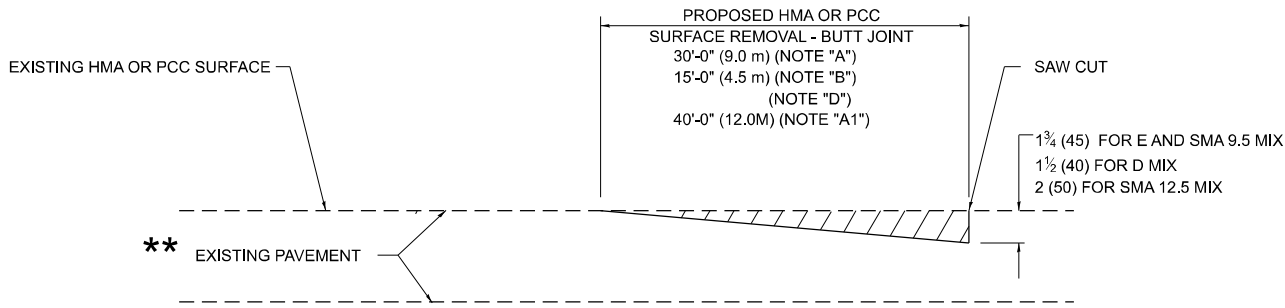

BUTT JOINT DETAIL

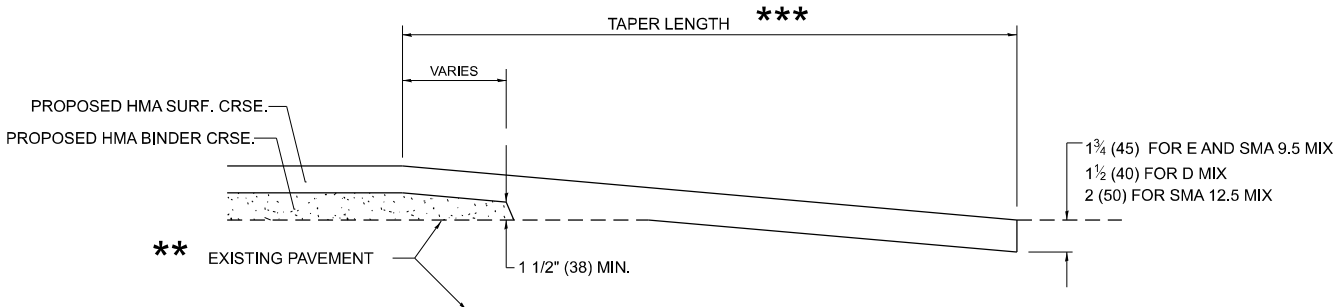

HMA TAPER DETAIL

**TYPICAL BUTT JOINT AND HMA TAPER
FOR RESURFACING ONLY**

** PC CONCRETE, HMA OR HMA RESURFACED PAVEMENT.

GENERAL NOTES

- A. MAINLINE ARTERIAL ROADWAYS AND MAJOR SIDE ROADS.
- A1. INTERSTATES
- B. MINOR SIDE ROADS.
- C. THE TEMP. RAMP SHALL BE CONSTRUCTED IMMEDIATELY UPON REMOVAL OF THE EXISTING HMA SURFACE.
- D. THE BUTT JOINT SHALL BE CONSTRUCTED IMMEDIATELY PRIOR TO PLACING THE PROPOSED HMA COURSES.
- E. TAPER THE TEMP. RAMP AT A RATE OF 3' - 4" (1.02m) PER 1 INCH (25 mm) OF MILLING THICKNESS.
* SEE TYPICAL SECTIONS FOR MILLING THICKNESS.
- F. SEE ARTICLE 406.08 AND 406.14 OF THE STANDARD SPECIFICATIONS FOR "HMA AND/OR PCC SURFACE REMOVAL, BUTT JOINT".

20'-0" (6.1 m) PER 1 (25) RESURFACING (NOTE "A")
10'-0" (3.0 m) PER 1 (25) RESURFACING (NOTE "B")

BASIS OF PAYMENT

1. THE BUTT JOINT WILL BE PAID FOR AT THE CONTRACT UNIT PRICE PER SQUARE YARD (SQUARE METER) FOR "HOT-MIX ASPHALT SURFACE REMOVAL - BUTT JOINT" OR FOR "PORTLAND CEMENT CONCRETE SURFACE REMOVAL- BUTT JOINT".
2. THE TEMPORARY RAMP AND SAW CUT SHALL BE INCLUDED IN THE UNIT COST FOR HMA OR PCC SURFACE REMOVAL-BUTT JOINT.

ALL DIMENSIONS ARE IN INCHES (MILLIMETERS) UNLESS OTHERWISE SHOWN.

MODEL: BD-32 [Sheet]
FILE NAME: c:\pav_work\pav\road\road\pjd\1040023D\105025-sh-ButtJoints.dgn

USER NAME = Jacob,Roth	DESIGNED - M. DE YONG	REVISED - A. ABBAS 03-21-97
	DRAWN - M. GOMEZ 04-06-01	REVISED - R. BORO 01-01-07
	CHECKED -	REVISED - K. SMITH 11-18-22
PLOT DATE = 6/27/2025	DATE - 06-13-90	

STATE OF ILLINOIS
DEPARTMENT OF TRANSPORTATION

**BUTT JOINT AND
HMA TAPER DETAILS**

SCALE: NONE SHEET 1 OF 1 SHEETS STA. TO STA.

F.A.U RTE.	SECTION	COUNTY	TOTAL SHEETS	SHEET NO.
2916	2024-1023-RS	COOK	18	12
BD400-05 BD-32		CONTRACT NO. 62X58		
ILLINOIS		FED. AID PROJECT		

MODEL: TC-10 (Sheet)
FILE NAME: c:\p\work\work\trt\trt\p\104023D\105025-shr-DistSigs.dgn

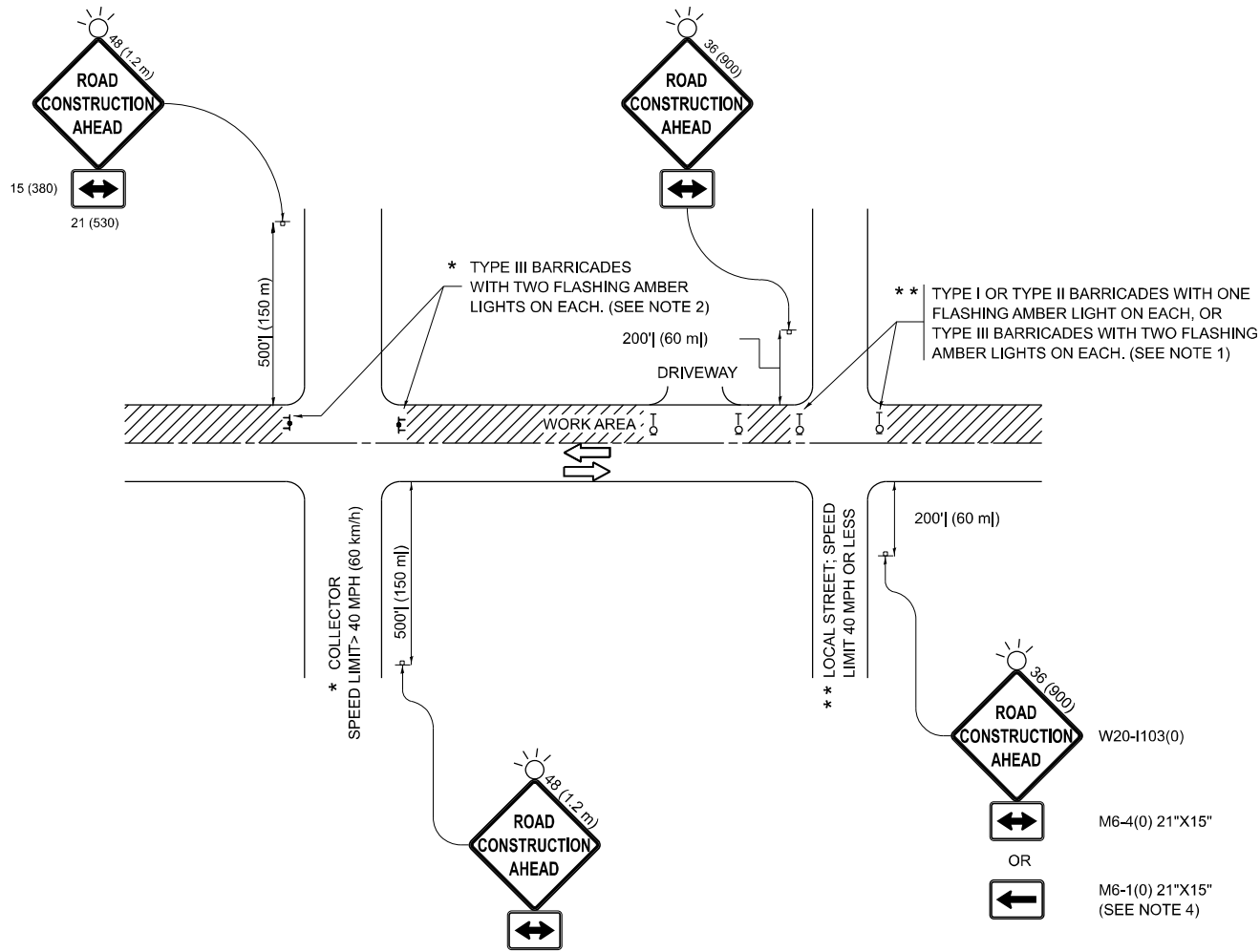

NOTES:

- SIDE ROAD WITH A SPEED LIMIT OF 40 MPH (60 km/h) OR LESS AS SHOWN ON THE DRAWING AND AS DIRECTED BY THE ENGINEER:
 - ONE "ROAD CONSTRUCTION AHEAD" SIGN 36 x 36 (900x900) WITH A FLASHER MOUNTED ON IT APPROXIMATELY 200' (60 m) IN ADVANCE OF THE MAIN ROUTE.
 - THE CLOSED PORTION OF THE MAIN ROUTE SHALL BE PROTECTED BY BLOCKING WITH TYPE I, TYPE II OR TYPE III BARRICADES, 1/3 OF THE CROSS SECTION OF THE CLOSED PORTION.
- SIDE ROAD WITH A SPEED LIMIT GREATER THAN 40 MPH (60 km/h) AS SHOWN ON THE DRAWING AND AS DIRECTED BY THE ENGINEER:
 - ONE "ROAD CONSTRUCTION AHEAD" SIGN 48 x 48 (1.2 m x 1.2 m) WITH A FLASHER MOUNTED ON IT APPROXIMATELY 500' (150 m) IN ADVANCE OF THE MAIN ROUTE.
 - THE CLOSED PORTION OF THE MAIN ROUTE SHALL BE PROTECTED BY BLOCKING WITH TYPE III BARRICADES, 1/2 OF THE CROSS SECTION OF THE CLOSED PORTION.
- CONES MAY BE SUBSTITUTED FOR BARRICADES OR DRUMS AT HALF THE SPACING DURING DAY OPERATIONS. CONES SHALL BE A MINIMUM OF 28 (710) IN HEIGHT.
- WHEN THE SIDE ROAD LIES BETWEEN THE BEGINNING OF THE MAINLINE SIGNING AND THE WORK ZONE, A SINGLE HEADED ARROW (M6-1) SHALL BE USED IN LIEU OF THE DOUBLE HEADED ARROW (M6-4).
- WHEN WORK IS BEING PERFORMED ON A SIDE ROAD OR DRIVEWAY, FOLLOW THE APPLICABLE STANDARD(S). THE DIRECTIONAL ARROW (M6-1 OR M6-4) SHALL BE COVERED OR REMOVED WHEN NO LONGER CONSISTENT WITH THE TRAFFIC CONTROL SET-UP.
- ADVANCE WARNING SIGNS ARE TO BE OMITTED ON DRIVEWAYS UNLESS OTHERWISE SPECIFIED IN THE PLANS OR BY THE ENGINEER.
- THE TRAFFIC CONTROL AND PROTECTION FOR SIDE ROADS, INTERSECTIONS, AND DRIVEWAYS SHALL BE INCLUDED IN THE COST OF SPECIFIED TRAFFIC CONTROL STANDARDS OR ITEMS.

All dimensions are in inches (millimeters)
unless otherwise shown.

	USER NAME = Jacob,Roth	DESIGNED - L.H.A.	REVISED - T. RAMMACHER 01-06-00	STATE OF ILLINOIS DEPARTMENT OF TRANSPORTATION	TRAFFIC CONTROL AND PROTECTION FOR SIDE ROADS, INTERSECTIONS, AND DRIVEWAYS	SCALE:	SHEET	OF	SHEETS	STA.	TO STA.	F.A.U RTE.	SECTION	COUNTY	TOTAL SHEETS	SHEET NO.		
		DRAWN -	REVISED - A. SCHUETZE 07-01-13									2916	2024-1023-RS	COOK	18	13		
		CHECKED -	REVISED - A. SCHUETZE 09-15-06									TC-10					CONTRACT NO. 62X58	
	PLOT DATE = 6/27/2025	DATE - 06-89	REVISED - D. SENDERAK 05-03-24									ILLINOIS FED. AID PROJECT						

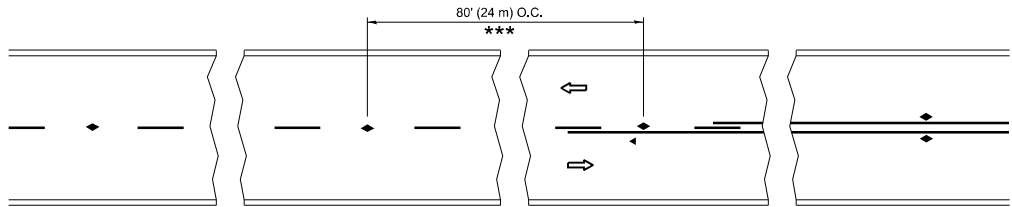

*** REDUCE TO 40' (12 m) O.C. ON CURVES WITH POSTED OR ADVISORY SPEED 45 M.P.H. (70 km/h) OR LESS.

TWO-LANE/TWO-WAY

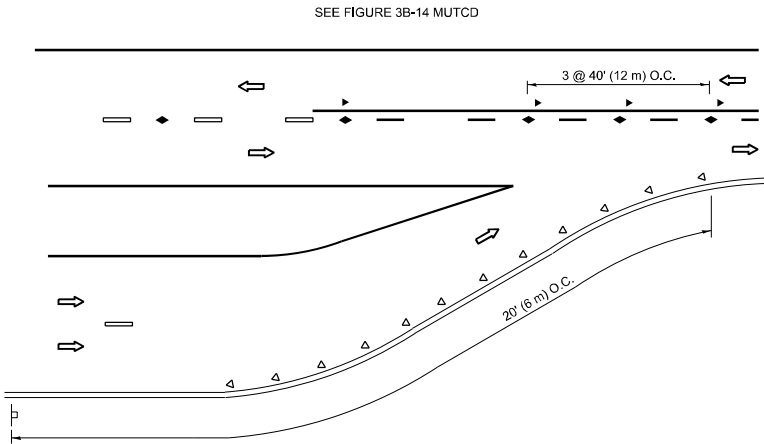

LANE REDUCTION TRANSITION

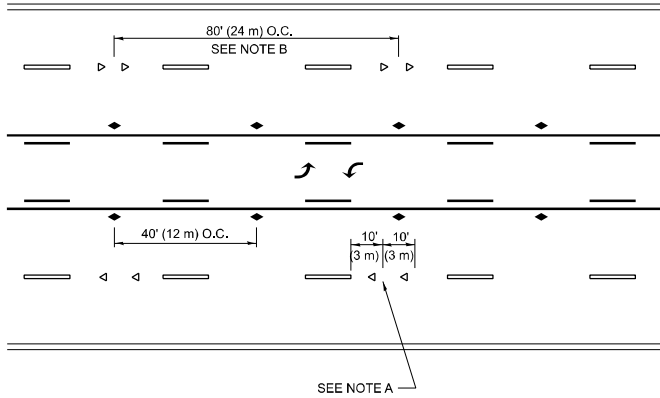

TWO-WAY LEFT TURN

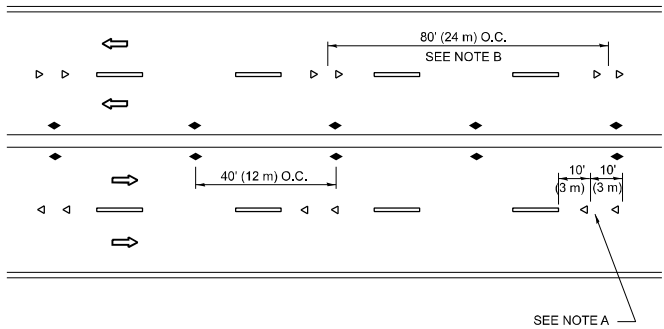

MULTI-LANE/UNDIVIDED

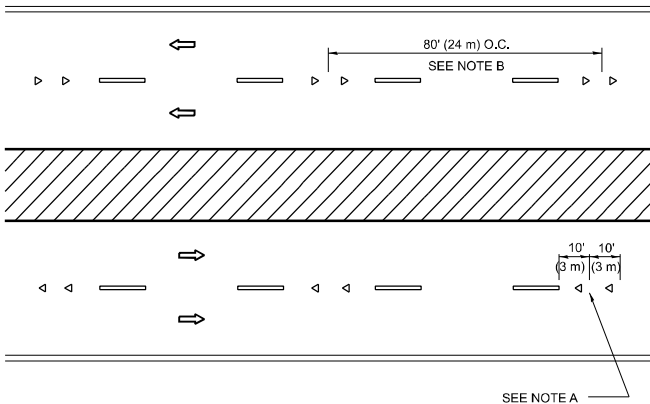

MULTI-LANE/DIVIDED

GENERAL NOTES

- MARKERS USED WITH DASHED LINES SHALL BE CENTERED IN THE GAP BETWEEN SEGMENTS.
- MARKERS USED ADJACENT TO SOLID LINES SHALL BE OFFSET 2 TO 3 (50 TO 75) TOWARD TRAFFIC AS SHOWN.
- MARKERS THROUGH TANGENTS LESS THAN 500' (150 m) IN LENGTH BETWEEN CURVES SHALL BE INSTALLED AT THE LESSER OF THE TWO CURVE SPACINGS.
- MARKERS ARE TO BE USED ADJACENT TO BOTH SOLID WHITE LINES IN DUAL LEFT TURN LANES

SYMBOLS

- YELLOW STRIPE
- WHITE STRIPE
- ONE-WAY AMBER MARKER
- ONE-WAY CRYSTAL MARKER (W/O)
- TWO-WAY AMBER MARKER

LANE MARKER NOTES

- USE DOUBLE LANE LINE MARKERS SPACED AS SHOWN.
- REDUCE TO 40' (12 m) O.C. ON CURVES WHERE ADVISORY SPEEDS ARE 10 M.P.H (20 km/h) LOWER THAN POSTED SPEEDS.

DESIGN NOTES

- DOUBLE LANE LINE MARKERS SHALL BE USED UNLESS SPECIFIED OTHERWISE.
- EXCEPT AS SHOWN ON THE LANE REDUCTION TRANSITION AND FREEWAY EXIT RAMP DETAIL, MARKERS ARE NOT TO BE SPECIFIED ON RIGHT EDGE LINES.
- THE EXACT MARKER LIMITS, SPACING, AND COLOR SHALL BE INCLUDED IN THE PLANS WHEN STANDARD SPECIFICATIONS ARE NOT BEING USED.
- MARKERS SHOULD NOT BE USED ALONGSIDE CURBS EXCEPT FOR EXTREMELY SHORT SECTIONS OF CURBS WHERE NOT MORE THAN TWO MARKERS WOULD BE INVOLVED.

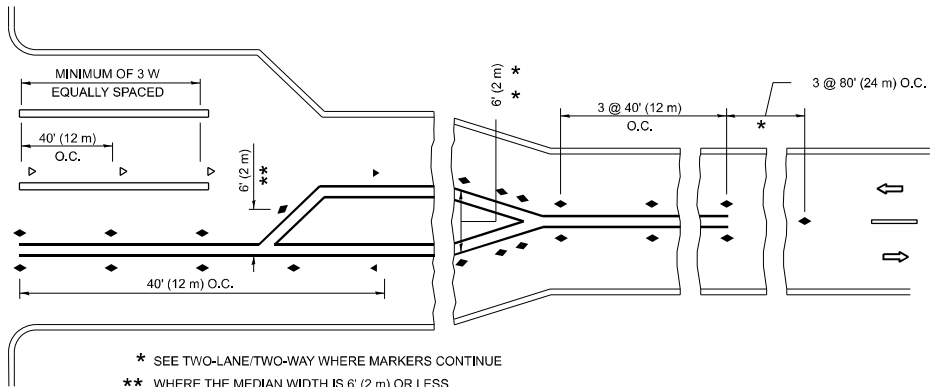
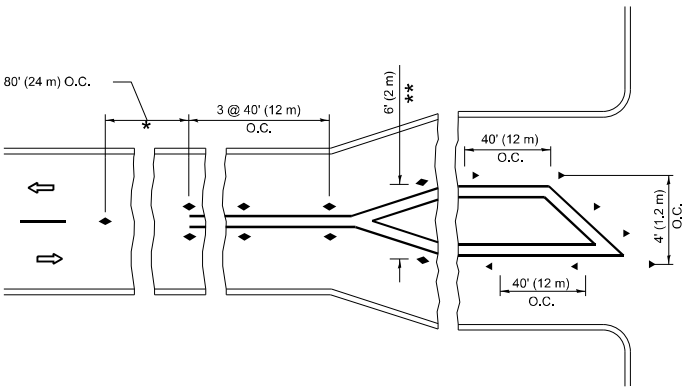

TURN LANES

All dimensions are in inches (millimeters) unless otherwise shown.

MODEL: TC-11 [Sheet]
FILE NAME: c:\p\work\p\work\proj\p\104023D\104023D-shd-DistStd.dgn

PLOT DATE	USER NAME = Jacob,Roth	DESIGNED -	REVISED - T. RAMMACHER 03-12-99
		DRAWN -	REVISED - T. RAMMACHER 01-06-00
		CHECKED -	REVISED - C. JUCIUS 09-09-09
	6/27/2025	DATE -	REVISED - C. JUCIUS 07-01-13

STATE OF ILLINOIS
DEPARTMENT OF TRANSPORTATION

TYPICAL APPLICATIONS
RAISED REFLECTIVE PAVEMENT MARKERS (SNOW-PLOW RESISTANT)

SCALE: NONE SHEET 1 OF 1 SHEETS STA. TO STA.

F.A.U RTE.	SECTION	COUNTY	TOTAL SHEETS	SHEET NO.
2916	2024-1023-RS	COOK	18	14
TC-11		CONTRACT NO. 62X58		
ILLINOIS		FED. AID PROJECT		

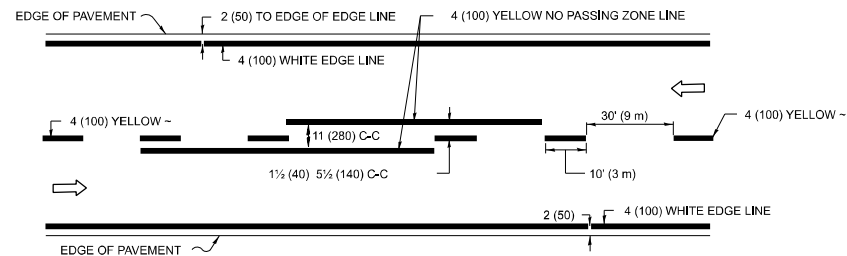

2-LANE ROADWAY

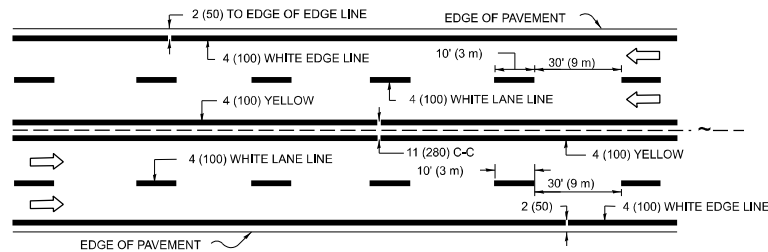

MULTI-LANE UNDIVIDED

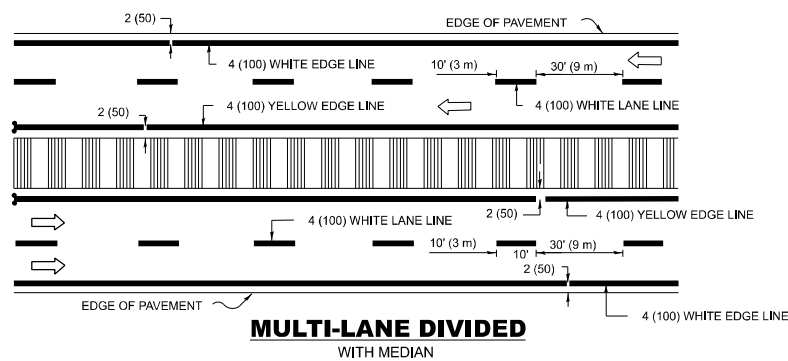

TYPICAL LANE AND EDGE LINE MARKING

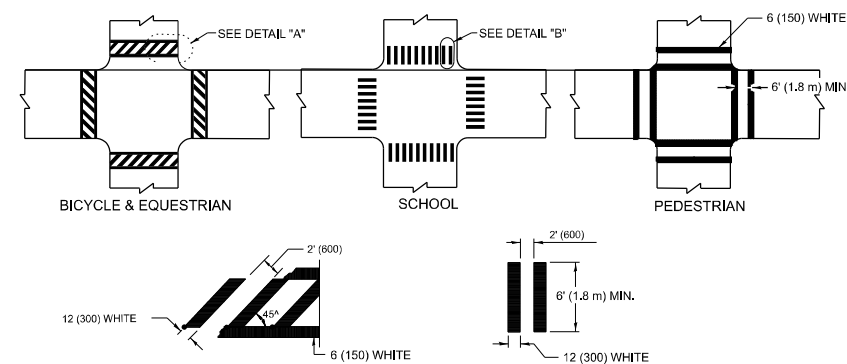

DETAIL "A" **DETAIL "B"**

TYPICAL CROSSWALK MARKING

* MARKINGS SHALL BE INSTALLED PARALLEL TO THE CENTERLINE OF THE ROAD WHICH IT CROSSES

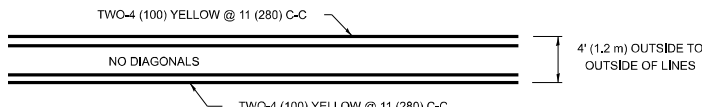

4' (1.2 m) WIDE MEDIANS ONLY

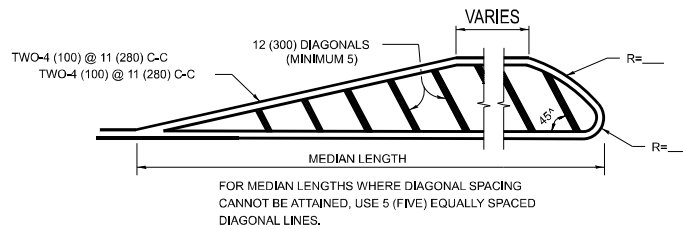

DIAGONAL LINE SPACING: 50' (15 m) C-C (LESS THAN 30MPH (50 km/h))
75' (25 m) C-C 30MPH (50 km/h) TO 45MPH (70 km/h))
150' (45 m) C-C (MORE THAN 45MPH (70 km/h))

MEDIANS OVER 4' (1.2 m) WIDE

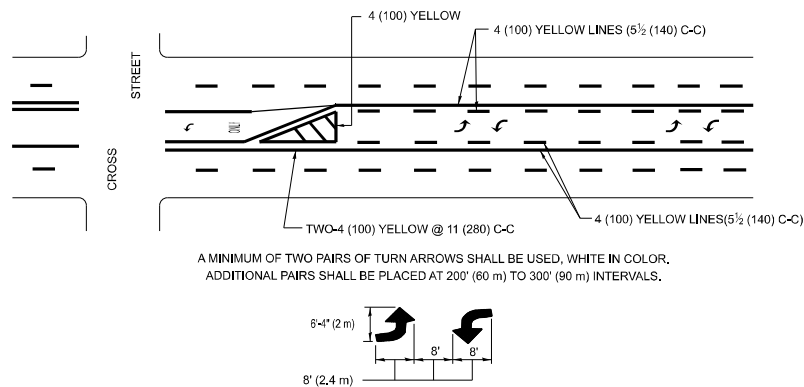

MEDIAN WITH TWO-WAY LEFT TURN LANE
TYPICAL PAINTED MEDIAN MARKING

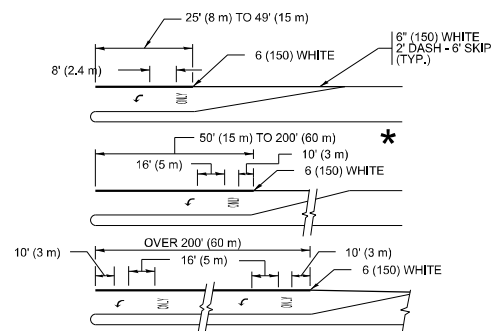

FULL SIZE LETTERS 8" (2.4 m) AND ARROWS SHALL BE USED.

* TURN LANES IN EXCESS OF 400' (120 m) IN LENGTH MAY HAVE AN ADDITIONAL SET OF ARROW - "ONLY" INSTALLED MIDWAY BETWEEN THE OTHER TWO SETS OF ARROW - "ONLY".

TYPICAL LEFT (OR RIGHT) TURN LANE

TYPICAL TURN LANE MARKING

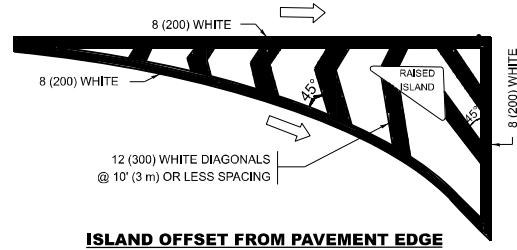

ISLAND OFFSET FROM PAVEMENT EDGE

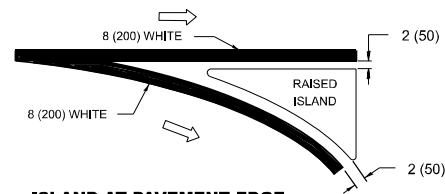

ISLAND AT PAVEMENT EDGE

TYPICAL ISLAND MARKING

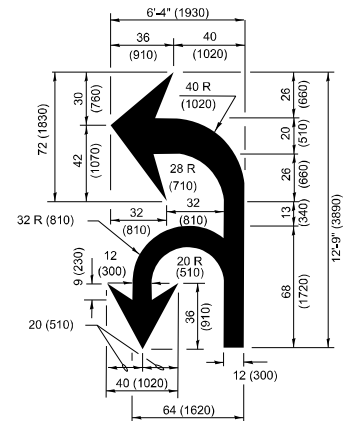

COMBINATION LEFT AND U-TURN

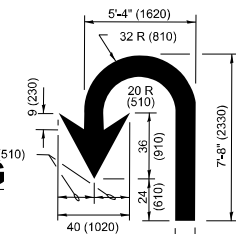

U-TURN

* LANE REDUCTION ARROWS REQUIRED AT SPEEDS OF 45 MPH OR GREATER OR WHEN SPECIFIED IN PLANS.

D(FT)	SPEED LIMIT
345	30
425	35
500	40
580	45
665	50
750	55



TYPE OF MARKING	WIDTH OF LINE	PATTERN	COLOR	SPACING / REMARKS
CENTERLINE ON 2 LANE PAVEMENT	4 (100)	SKIP-DASH	YELLOW	10' (3 m) LINE WITH 30' (9 m) SPACE
CENTERLINE ON MULTI-LANE UNDIVIDED PAVEMENT	2 @ 4 (100)	SOLID	YELLOW	11 (280) C-C
NO PASSING ZONE LINES: FOR ONE DIRECTION FOR BOTH DIRECTIONS	4 (100) 2 @ 4 (100)	SOLID SOLID	YELLOW YELLOW	5½ (140) C-C FROM SKIP-DASH CENTERLINE 11 (280) C-C OMIT SKIP-DASH CENTERLINE BETWEEN
LANE LINES	4 (100) 5 (125) ON FREEWAYS	SKIP-DASH SKIP-DASH	WHITE WHITE	10' (3 m) LINE WITH 30' (9 m) SPACE
DOTTED LINES (EXTENSIONS OF CENTER, LANE OR TURN LANE MARKINGS)	SAME AS LINE BEING EXTENDED	SKIP-DASH	SAME AS LINE BEING EXTENDED	2' (600) LINE WITH 6' (1.8 m) SPACE
EDGE LINES	4 (100)	SOLID	YELLOW-LEFT WHITE-RIGHT	OUTLINE MEDIANS IN YELLOW
TURN LANE MARKINGS	6 (150) LINE: FULL SIZE LETTERS & SYMBOLS (8' (2.4m))	SOLID	WHITE	SEE TYPICAL TURN LANE MARKING DETAIL
TWO WAY LEFT TURN MARKING	2 @ 4 (100) EACH DIRECTION 8' (2.4m) LEFT ARROW	SKIP-DASH AND SOLID IN PAIRS	YELLOW WHITE	10' (3 m) LINE WITH 30' (9 m) SPACE FOR SKIP-DASH: 5½ (140) C-C BETWEEN SOLID LINE AND SKIP-DASH LINE SEE TYPICAL TWO-WAY LEFT TURN MARKING DETAIL
CROSSWALK LINES (PEDESTRIAN) A. DIAGONALS (BIKE & EQUESTRIAN) B. LONGITUDINAL BARS (SCHOOL)	2 @ 6 (150) 12 (300) @ 45° 12 (300) @ 90°	SOLID SOLID SOLID	WHITE WHITE WHITE	NOT LESS THAN 6' (1.8 m) APART 2' (600) APART 2' (600) APART SEE TYPICAL CROSSWALK MARKING DETAILS.
STOP LINES	24 (600)	SOLID	WHITE	PLACE 4' (1.2 m) IN ADVANCE OF AND PARALLEL TO CROSSWALK, IF PRESENT. OTHERWISE, PLACE AT DESIRED STOPPING POINT, PARALLEL TO CROSSROAD CENTERLINE, WHERE POSSIBLE
PAINTED MEDIANS	2 @ 4 (100) WITH 12 (300) DIAGONALS @ 45° NO DIAGONALS USED FOR 4' (1.2 m) WIDE MEDIANS	SOLID	YELLOW: TWO WAY TRAFFIC WHITE: ONE WAY TRAFFIC	11 (280) C-C FOR THE DOUBLE LINE SEE TYPICAL PAINTED MEDIAN MARKING.
GORE MARKING AND CHANNELIZING LINES	8 (200) WITH 12 (300) DIAGONALS @ 45°	SOLID	WHITE	DIAGONALS: 15' (4.5 m) C-C (LESS THAN 30MPH (50 km/h)) 20' (6 m) C-C 30MPH (50 km/h) TO 45MPH (70 km/h)) 30' (9 m) C-C (OVER 45MPH (70 km/h))
RAILROAD CROSSING	24 (600) TRANSVERSE LINES: "RR" IS 6' (1.8 m) LETTERS: 16 (400) LINE FOR "X"	SOLID	WHITE	SEE STATE STANDARD 780001 AREA OF: "R"=3.6 SQ. FT. (0.33 m ²) EACH "X"=54.0 SQ. FT. (5.0 m ²)
SHOULDER DIAGONALS (REQUIRED FOR SHOULDERS ≥ 8')	12 (300) @ 45°	SOLID	WHITE - RIGHT YELLOW - LEFT	50' (15 m) C-C (LESS THAN 30MPH (50 km/h)) 75' (25 m) C-C (30 MPH (50 km/h) TO 45MPH (70 km/h)) 150' (45 m) C-C (OVER 45MPH (70 km/h))
U TURN ARROW	SEE DETAIL	SOLID	WHITE	16.3 SF
2 ARROW COMBINATION LEFT AND U TURN	SEE DETAIL	SOLID	WHITE	30.4 SF

FOR FURTHER DETAILS ON PAVEMENT MARKING REFER TO
STANDARD SPECIFICATIONS FOR ROAD AND BRIDGE
CONSTRUCTION AND STATE STANDARD 780001.

All dimensions are in inches (millimeters)
unless otherwise shown.

USER NAME = Jacob.Roth	DESIGNED = EVERS	REVISED = C. JUCIUS 09-09-09
	DRAWN =	REVISED = C. JUCIUS 07-01-13
	CHECKED =	REVISED = C. JUCIUS 12-21-15
PLOT DATE = 6/27/2025	DATE = 03-19-90	REVISED = C. JUCIUS 04-12-16

STATE OF ILLINOIS
DEPARTMENT OF TRANSPORTATION

DISTRICT ONE				
TYPICAL PAVEMENT MARKINGS				
SCALE: NONE	SHEET 1	OF 1	SHEETS	STA. TO STA.

F.A.U RTE.	SECTION	COUNTY	TOTAL SHEETS	SHEET NO.
2916	2024-1023-RS	COOK	18	15
TC-13		CONTRACT NO. 62X58		
		ILLINOIS	FED. AID PROJECT	

MODEL: TC-13 [Sheet]
FILE NAME: c:\pw work\pwidotr\rothip\d1040523\D105025-sh1-DistStd.s.dgn

TURN BAY ENTRANCE AT START
OF LANE CLOSURE TAPER

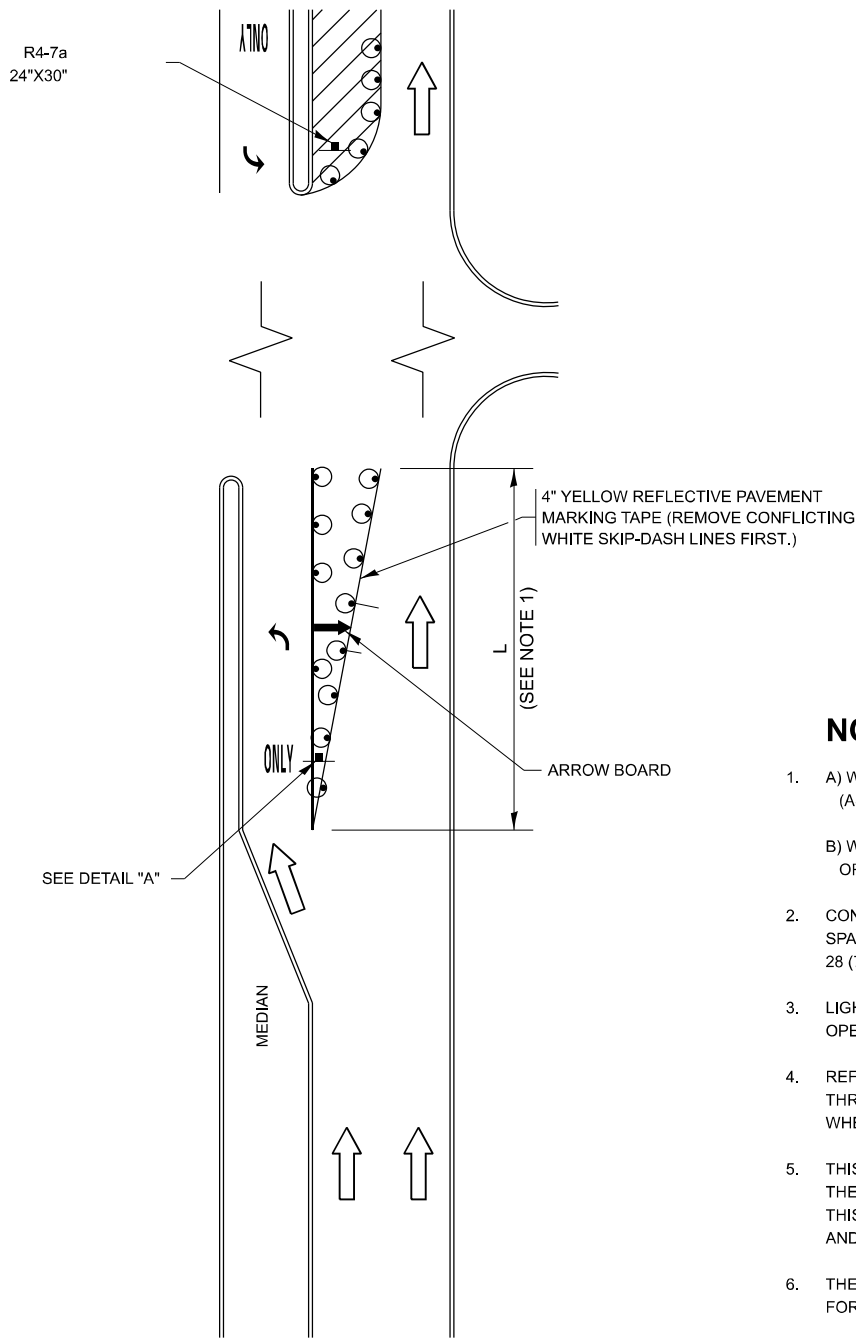
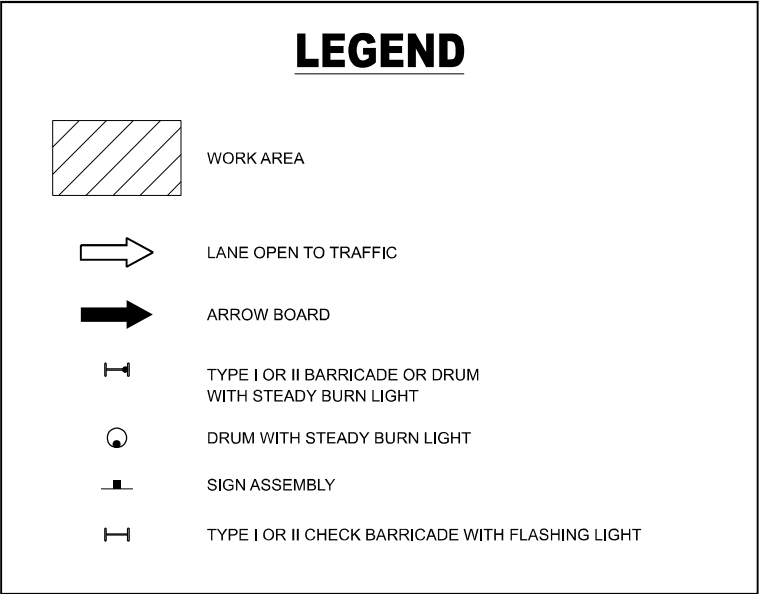

FIGURE 1

LEGEND



NOTES:

- 1. A) WHEN "L" IS ≤ THE STORAGE LENGTH OF THE TURN LANE (AS SHOWN IN FIG. 1), USE FIGURE 1.
B) WHEN "L" IS > THE STORAGE LENGTH OF THE TURN LANE OR THE TURN LANE IS WITHIN THE LANE CLOSURE, USE FIGURE 2.
- 2. CONES MAY BE SUBSTITUTED FOR BARRICADES OR DRUMS AT HALF THE SPACING DURING DAY OPERATIONS. CONES SHALL BE A MINIMUM OF 28 (710) IN HEIGHT.
- 3. LIGHTS WILL NOT BE REQUIRED ON BARRICADES OR DRUMS FOR DAY OPERATIONS. ALL LIGHTS SHALL BE MONODIRECTIONAL.
- 4. REFLECTIVE TEMPORARY PAVEMENT MARKINGS SHALL BE PLACED THROUGHOUT THE BARRICADED AREAS OF EACH TURN BAY AS SHOWN WHERE THE CLOSURE TIME IS GREATER THAN FOURTEEN (14) DAYS.
- 5. THIS APPLICATION ALSO APPLIES WHEN WORK IS BEING PERFORMED IN THE RIGHT LANE(S) AND THE RIGHT TURN BAY IS TO REMAIN OPEN. UNDER THIS CONDITION, "RIGHT TURN LANE" R3-I100R 24 x 24 (600 x 600) AND M6-2R 21 x 15 (530 x 380) SHALL BE USED.
- 6. THESE CONTROLS SHALL SUPPLEMENT MAINLINE TRAFFIC CONTROL FOR LANE CLOSURES.
- 7. THE SIGNS SHALL BE MOUNTED ABOVE THE BARRICADES/DRUMS ON SEPARATE SIGN SUPPORTS THAT MEET NCHRP 350 OR MASH REQUIREMENTS.
- 8. TRAFFIC CONTROL AND PROTECTION AT TURN BAYS (TO REMAIN OPEN TO TRAFFIC) SHALL BE INCLUDED IN THE COST OF SPECIFIED TRAFFIC CONTROL STANDARDS OR ITEMS.

TURN BAY ENTRANCE
WITHIN A LANE CLOSURE

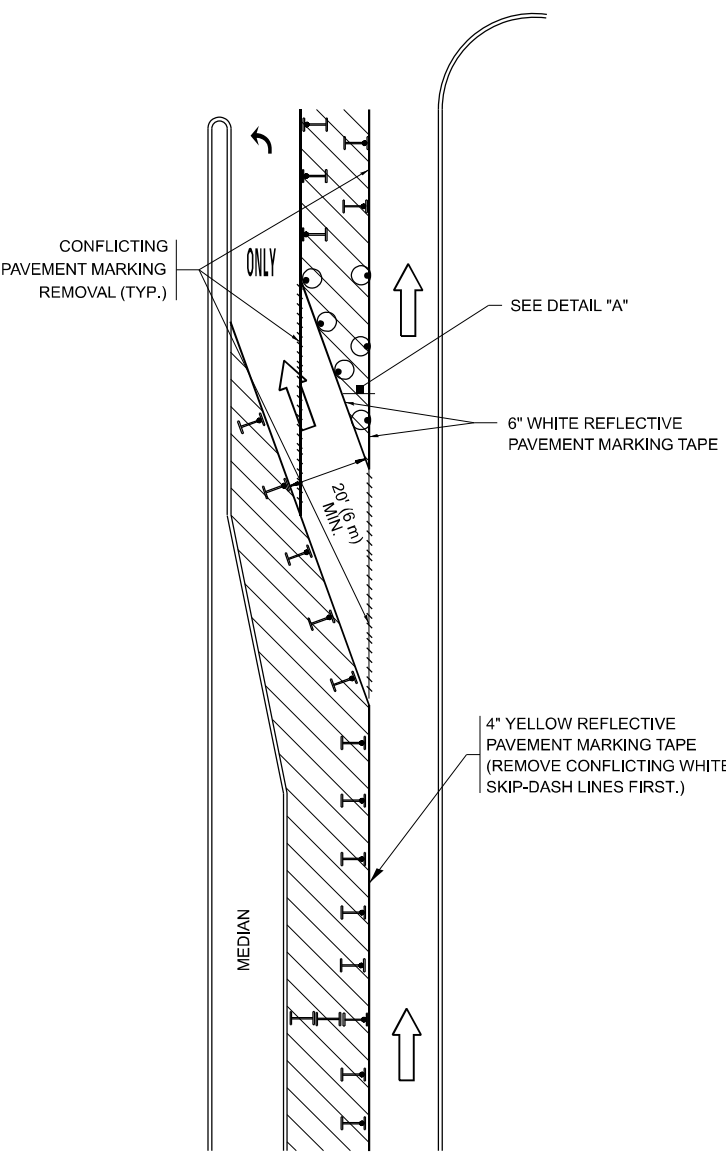
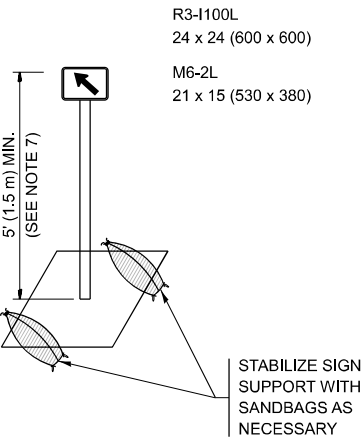

FIGURE 2



DETAIL A

All dimensions are in inches (millimeters) unless otherwise shown.

MODEL: TC-14 (Sheet)
FILE NAME: c:\p\work\proj\trb\trb\104023D\105025-sh-TrafficStd.dgn

	USER NAME = Jacob,Roth		DESIGNED - T. RAMMACHER 09-08-94	REVISED - R. BORO 09-14-09	STATE OF ILLINOIS DEPARTMENT OF TRANSPORTATION	TRAFFIC CONTROL AND PROTECTION AT TURN BAYS (TO REMAIN OPEN TO TRAFFIC)			F.A.U RTE.	SECTION	COUNTY	TOTAL SHEETS	SHEET NO.
			DRAWN - A. HOUSEH 11-07-95	REVISED - A. SCHUETZE 07-01-13					2916	2024-1023-RS	COOK	18	16
			CHECKED - A. HOUSEH 10-12-96	REVISED - A. SCHUETZE 09-15-16		TC-14			CONTRACT NO. 62X58				
	PLOT DATE = 6/27/2025		DATE - T. RAMMACHER 01-06-00	REVISED -		SCALE: NONE	SHEET 1	OF 1 SHEETS	STA.	TO STA.	ILLINOIS FED. AID PROJECT		

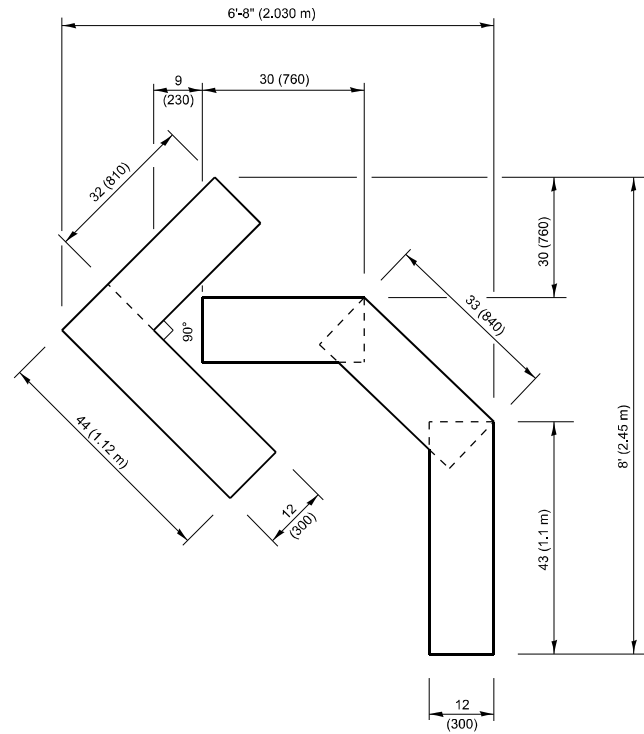

QUANTITY

4 (100) LINE = 45.5 ft. (13.9 m)
15.2 sq. ft. (1.41 sq. m)

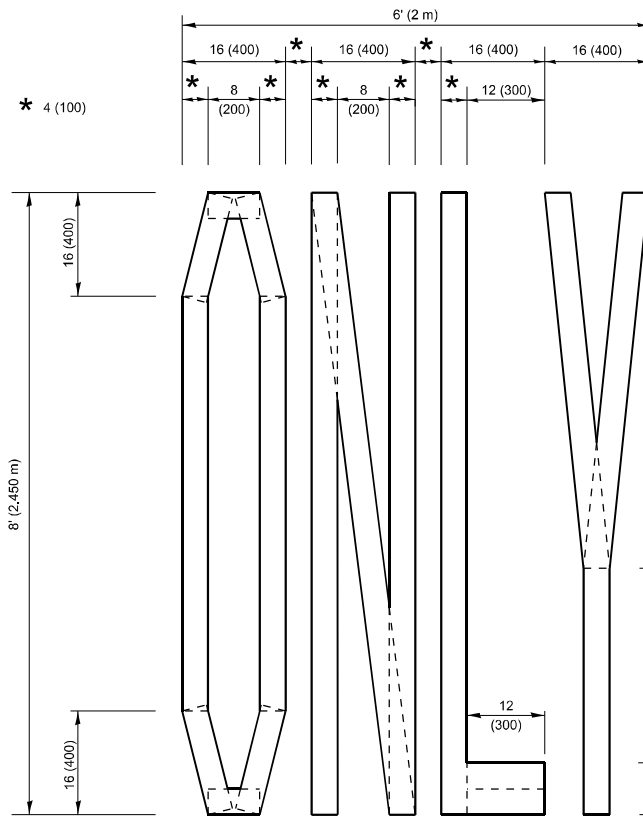

QUANTITY

4 (100) LINE = 64.1 ft. (19.5 m)
21.4 sq. ft. (1.99 sq. m)

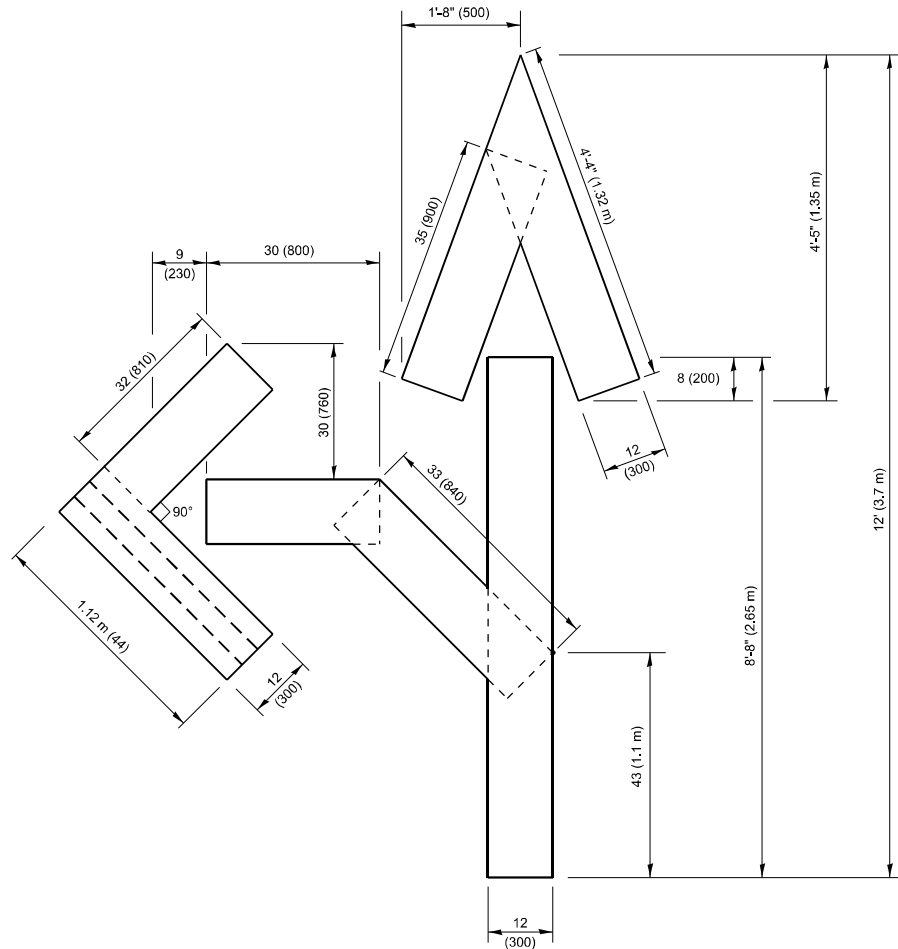

QUANTITY

4 (100) LINE = 82.5 ft. (25.1 m)
27.5 sq. ft. (2.53 sq. m)

NOTE:

ALL QUANTITIES OF PLACEMENT ARE REPRESENTED
IN LINEAR FEET OF 4" LINES TO MATCH THE
4" TEMPORARY TAPE PAY ITEM AND REPRESENTS
THE TOTAL QUANTITY OF 4" TAPE REQUIRED.

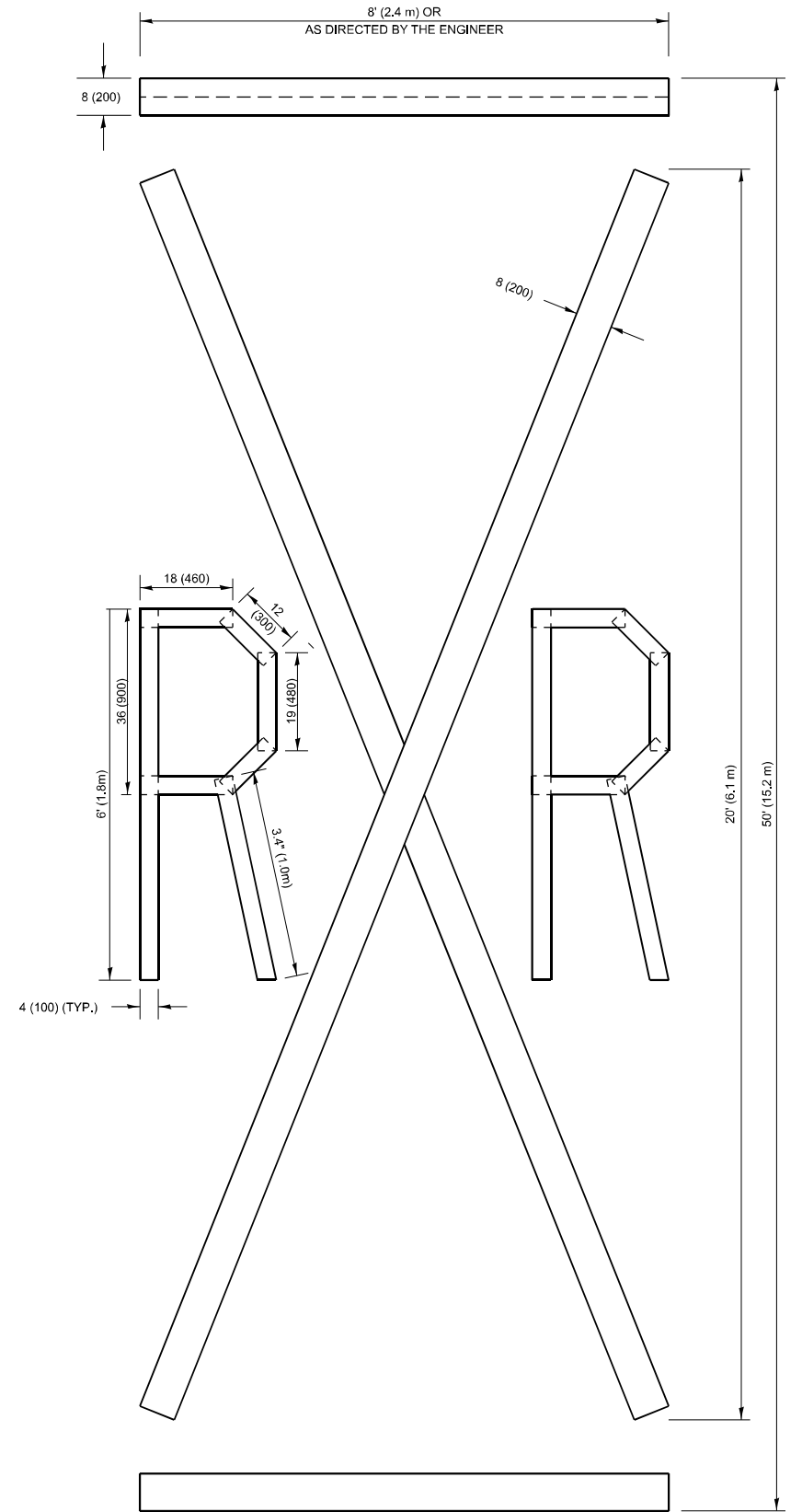

QUANTITY

4 (100) LINE = 225.9 ft. (68.9 m)
75.3 sq. ft. (6.99 sq. m)

All dimensions are in inches (millimeters)
unless otherwise shown.

MODEL: TC-16 (Sheet)
FILE NAME: c:\p\work\proj\traj\p\1040623D\104025-shr-Dwg\Std.dgn

PLOT DATE = 6/27/2025	USER NAME = Jacob,Roth	DESIGNED -	REVISED - T. RAMMACHER 03-02-98
		DRAWN -	REVISED - E. GOMEZ 08-28-00
		CHECKED -	REVISED - E. GOMEZ 08-28-00
	DATE - 09-18-94		REVISED - A. SCHUETZE 09-15-16

STATE OF ILLINOIS
DEPARTMENT OF TRANSPORTATION

SHORT TERM PAVEMENT MARKING LETTERS AND SYMBOLS

SCALE: NONE SHEET 1 OF 1 SHEETS STA. TO STA.

F.A.U RTE.	SECTION	COUNTY	TOTAL SHEETS	SHEET NO.
2916	2024-1023-RS	COOK	18	17
TC-16		CONTRACT NO. 62X58		
ILLINOIS		FED. AID PROJECT		

MODEL: TC-22 [Sheet]
FILE NAME: c:\p\work\proj\roth\pjd\104023D\105025-shh-DiaStd.dgn

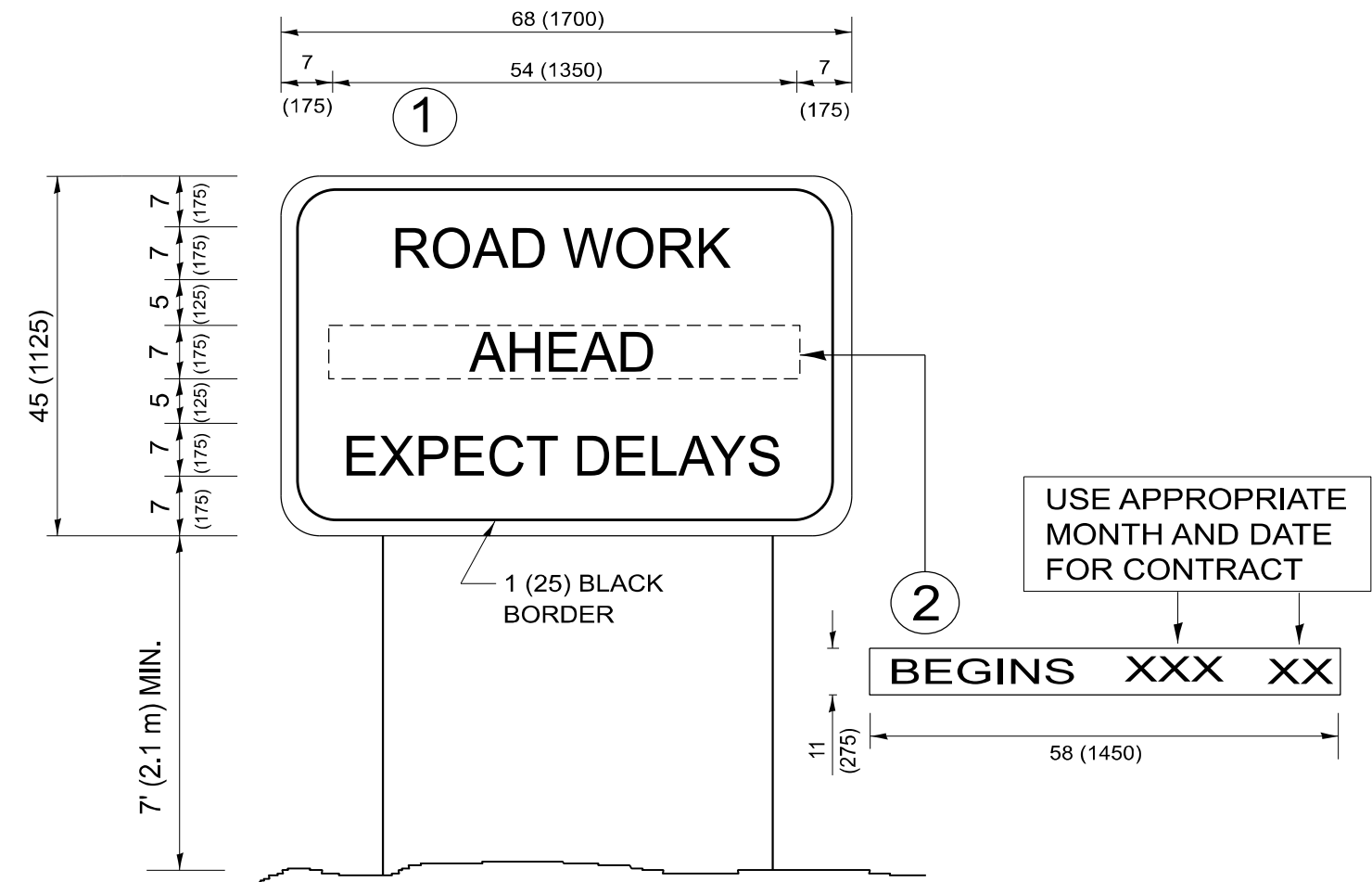

NOTES:

1. USE BLACK LETTERING ON ORANGE BACKGROUND.
2. ERECT SIGNS IN ADVANCE OF THE LOCATION FOR THE "ROAD CONSTRUCTION AHEAD" SIGN AT LOCATIONS AS DIRECTED BY THE ENGINEER.
3. ERECT SIGN ① WITH INSTALLED PANEL ② ONE WEEK PRIOR TO THE START OF CONSTRUCTION.
4. REMOVE PANEL ② SOON AFTER THE START OF CONSTRUCTION.
5. SEE SPECIAL PROVISION FOR "TEMPORARY INFORMATION SIGNING" FOR ADDITIONAL INFORMATION.
6. ONE SIGN ASSEMBLY EQUALS 25.70 SQ. FT. (2.3 SQ. M.)
7. SHALL BE PAID FOR AS TEMPORARY INFORMATION SIGNING.

ALL DIMENSIONS ARE IN INCHES (MILLIMETERS)
UNLESS OTHERWISE SHOWN.

	USER NAME = Jacob,Roth	DESIGNED -	REVISED - R. MIRS 09-15-97	STATE OF ILLINOIS DEPARTMENT OF TRANSPORTATION	ARTERIAL ROAD INFORMATION SIGN				F.A.U RTE.	SECTION	COUNTY	TOTAL SHEETS	SHEET NO.
		DRAWN -	REVISED - R. MIRS 12-11-97						2916	2024-1023-RS	COOK	18	18
		CHECKED -	REVISED - T. RAMMACHER 02-02-99						TC-22		CONTRACT NO. 62X58		
	PLOT DATE = 6/25/2025	DATE -	REVISED - C. JUCIUS 01-31-07						ILLINOIS FED. AID PROJECT				
					SCALE: NONE	SHEET 1	OF 1	SHEETS	STA.	TO STA.			