

STATE OF ILLINOIS
DEPARTMENT OF TRANSPORTATION

FOR INDEX OF SHEETS, SEE SHEET NO. 2

**THE PROJECT IS LOCATED WITHIN
THE VILLAGE OF DOLTON**

TRAFFIC DATA

2022 ADT - 14,700 VPD

POSTED SPEED LIMIT - 35 MPH

MINOR ARTERIAL

**PROPOSED
HIGHWAY PLANS**

**FAU ROUTE 3596 (DOLTON AVE.)
142ND STREET TO I-94 (BISHOP FORD FREEWAY)
SECTION 2024-1048-RS
PROJECT STP-8TBS(840)
STANDARD OVERLAY, ADA IMPROVEMENTS
COOK COUNTY**

C-91-113-25

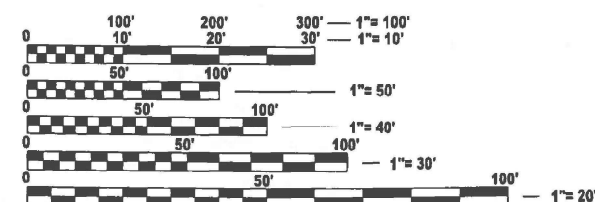
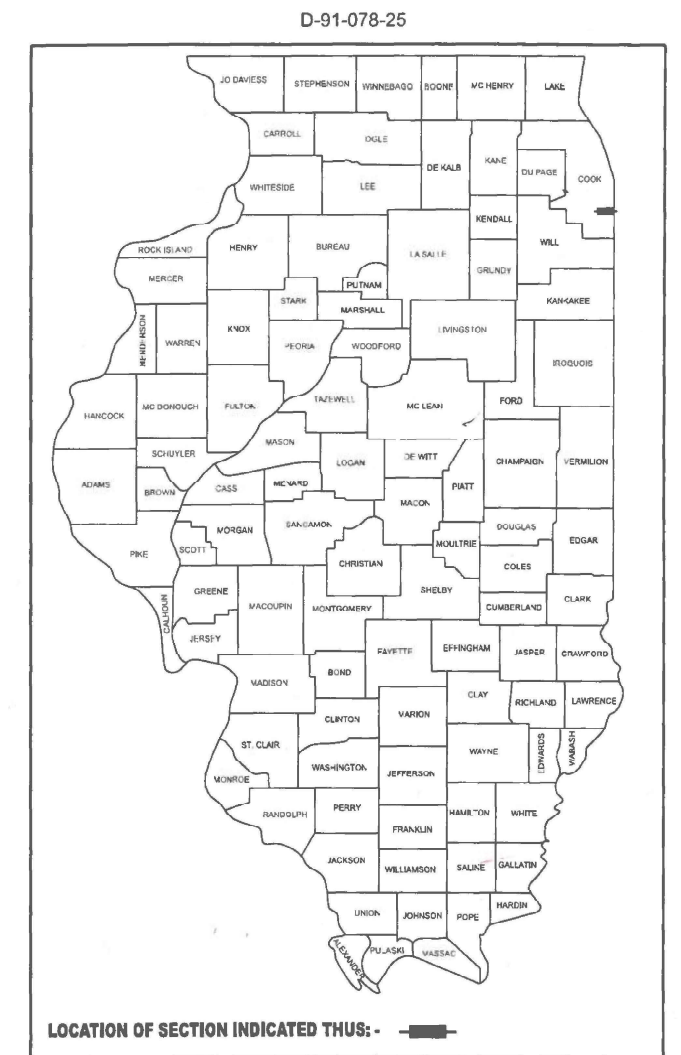

**FULL SIZE PLANS HAVE BEEN PREPARED USING STANDARD
ENGINEERING SCALES. REDUCED SIZED PLANS WILL NOT
CONFORM TO STANDARD SCALES. IN MAKING MEASUREMENTS
ON REDUCED PLANS, THE ABOVE SCALES MAY BE USED.**

J.U.L.I.E.
JOINT UTILITY LOCATION INFORMATION FOR EXCAVATION
1-800-892-0123
QR 811

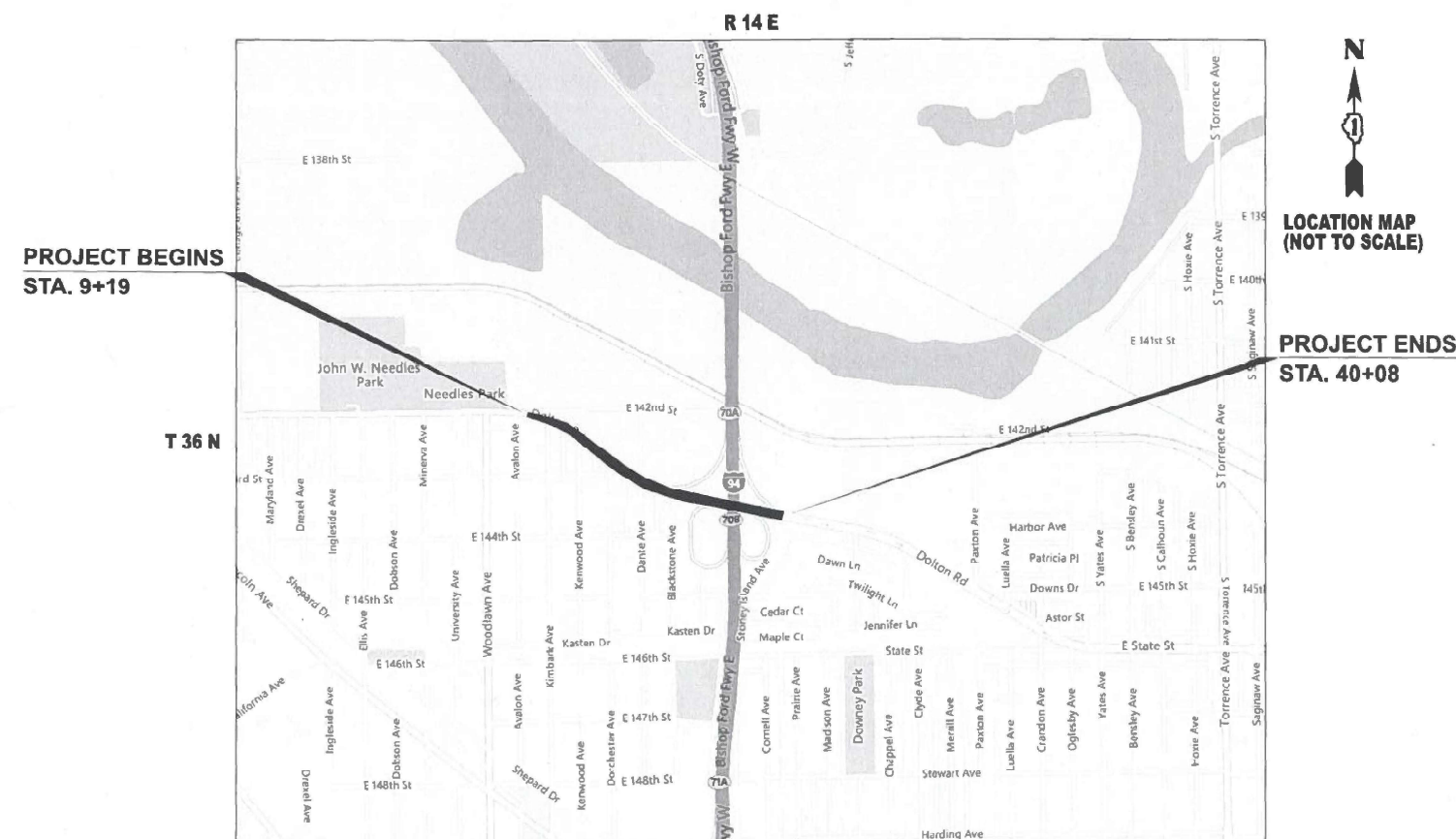

PROJECT ENGINEER LUKASZ POCIECHA (847) 705-4255
PROJECT MANAGER VESELIN VELICHKOV

CONTRACT NO. 62X87

STATE OF ILLINOIS
DEPARTMENT OF TRANSPORTATION

SUBMITTED June 25th 2025
Richard IR

REGIONAL ENGINEER

August 15 2025
SEA ETK
ENGINEER OF DESIGN AND ENVIRONMENT

August 15 2025
Gray 5
DIRECTOR OF HIGHWAYS PROJECT IMPLEMENTATION

PRINTED BY THE AUTHORITY
OF THE STATE OF ILLINOIS

INDEX OF SHEETS

STATE STANDARDS

GENERAL NOTES

SHEET NO.	DESCRIPTION
1	COVER SHEET
2	INDEX OF SHEETS, STATE STANDARDS, AND GENERAL NOTES
3-4	SUMMARY OF QUANTITIES
5	EXISTING AND PROPOSED TYPICAL SECTIONS
6-7	ROADWAY AND PAVEMENT MARKING PLANS
8-12	PEDESTRIAN RAMP DESIGN DETAILS
13	DETAILS FOR FRAMES AND LIDS ADJUSTMENT WITH MILLING (BD-08)
14	DETAILS FOR P.C. CONCRETE DRIVEWAY, ALLEY RETURN AND SIDEWALK (BD-17)
15	PAVEMENT PATCHING FOR HMA SURFACED PAVEMENT (BD-22)
16	CURB OR CURB AND GUTTER REMOVAL AND REPLACEMENT (BD-24)
17	BUTT JOINT AND HMA TAPER DETAILS (BD-32)
18	TRAFFIC CONTROL AND PROTECTION FOR SIDE RAODS, INTERSECTIONS, AND DRIVEWAYS (TC-10)
19	TYPICAL APPLICATIONS RAISED REFLECTIVE PAVEMENT MARKERS (SNOW-PLOW RESISTANT) (TC-11)
20	DISTRICT ONE TYPICAL PAVEMEBT MARKINGS (TC-13)
21	SHORT TERM PAVEMENT MARKING LETTERS AND SYMBOLS (TC-16)
22	TRAFFIC CONTROL DETAILS FOR FREEWAY SHOULDER CLOSURES AND PARTIAL RAMP CLOSURES (TC-17)
23	ARTERIAL ROAD INFORMATION SIGN (TC-22)

STANDARD NO.	DESCRIPTION
000001-08	STANDARD SYMBOLS, ABBREVIATIONS, AND PATTERNS
424001-12	PERPENDICULAR CURB RAMPS FOR SIDEWALKS
424026-04	ENTRANCE / ALLEY PEDESTRIAN CROSSINGS
442201-03	CLASS C AND D PATCHES
604001-05	FRAME AND LIDS, TYPE 1
606001-08	CONCRETE CURB TYPE B AND COMBINATION CONCRETE CURB AND GUTTER
701101-05	OFF-RD OPERATIONS, MULTILANE, 15' TO 24" FROM PAVEMENT EDGE
701411-09	LANE CLOSURE, MULTILANE, AT ENTRANCE OR EXIT RAMP, FOR SPEEDS ≥ 45 MPH
701427-05	LANE CLOSURE, MULTILANE, INTERMITTENT OR MOVING OPER., FOR SPEEDS ≤ 40 MPH
701606-10	URBAN SINGLE LANE CLOSURE, MULTILANE, 2W WITH MOUNTABLE MEDIAN
701801-06	SIDEWALK, CORNER OR CROSSWALK CLOSURE
701901-10	TRAFFIC CONTROL DEVICES
780001-05	TYPICAL PAVEMENT MARKINGS
781001-04	TYPICAL APPLICATIONS RAISED REFLECTIVE PAVEMENT MARKERS

- TEN (10) FOOT TRANSITIONS SHALL BE USED TO MATCH PROPOSED CURB AND GUTTER AND MEDIAN ITEMS OF WORK TO EXISTING CURBS AND GUTTER AND MEDIANS IN THE FIELD, UNLESS OTHERWISE SHOWN.
- THE CONTRACTOR WILL NOT BE ALLOWED TO SET UP A YARD OR FIELD OFFICE ON STATE PROPERTY WITHOUT WRITTEN PERMISSION FROM THE DEPARTMENT.
- ALL MILLED SURFACES SHALL BE A UNIFORM CROSS SLOPE PER LANE AND FREE OF RIDGES BETWEEN PASSES. ANY DEVIATIONS SHALL BE CORRECTED AT NO COST TO THE DEPARTMENT.
- ALL PAVEMENT PATCHING LOCATIONS WILL BE DETERMINED IN THE FIELD BY THE RESIDENT ENGINEER.
- LOCATION OF COMBINATION CONCRETE CURB AND GUTTER REMOVAL AND REPLACEMENT [OR COMBINATION CURB AND GUTTER (THE TYPE SPECIFIED ON THE PLANS)], WILL BE DETERMINED IN THE FIELD BY THE RESIDENT ENGINEER.
- IT SHALL BE THE CONTRACTOR'S RESPONSIBILITY TO VERIFY ALL DIMENSIONS AND CONDITIONS EXISTING IN THE FIELD PRIOR TO CONSTRUCTION AND ORDERING OF MATERIALS.
- FRAMES AND GRATES ADJUSTMENT OF PRIVATE UTILITIES WITHIN THE LIMITS OF IMPROVEMENTS SHALL BE DONE BY THEIR RESPECTIVE OWNERS AND ARE NOT PART OF THIS CONTRACT.
- SIDEWALK REMOVAL AND P.C.C. SIDEWALK 5" LOCATIONS SHALL BE DETERMINED BY THE RESIDENT ENGINEER.
- THE CONTRACTOR SHALL CONTACT KALPANA KANNAN-HOSADURGA, THE DISTRICT ONE TRAFFIC CONTROL SUPERVISOR, AT KALPANA.KANNAN-HOSADURGA@ILLINOIS.GOV A MINIMUM OF 72 HOURS IN ADVANCE OF BEGINNING WORK.
- THE RESIDENT ENGINEER SHALL CONTACT PATRICE HARRIS, AREA TRAFFIC FIELD ENGINEER VIA EMAIL AT PATRICE.HARRIS@ILLINOIS.GOV A MINIMUM OF TWO (2) WEEKS PRIOR TO THE PLACEMENT OF PERMANENT PAVEMENT MARKINGS.
- THE CONTRACTOR SHALL BE REQUIRED TO KEEP A RECORD OF THE LOCATIONS OF PLATED STRUCTURES BY STATION AND OFFSET LEFT OR RIGHT OF THE CENTERLINE OF PAVEMENT.
- THE CONTRACTOR SHALL BE REQUIRED TO KEEP A RECORD OF THE LOCATIONS OF THE BURIED STRUCTURES ACCORDING TO THE STATION AND DISTANCE LEFT OR RIGHT OF THE CENTERLINE OF PAVEMENT. UPON COMPLETION OF THE WORK, THE CONTRACTOR SHALL DELIVER THE RECORD TO THE ENGINEER.
- EXISTING BROKEN FRAMES AND LIDS SHALL BE REMOVED AND DISPOSED OF BY THE CONTRACTOR AND SHALL BE REPLACED AS DIRECTED BY THE ENGINEER. REPLACEMENT FRAMES AND LIDS WILL BE PAID FOR ACCORDING TO ARTICLE 109.04 OF THE STANDARD SPECIFICATIONS UNLESS A SEPARATE PAY ITEM HAS BEEN PROVIDED.
- PAVEMENT MARKING TAPE, TYPE IV SHALL BE USED FOR SHORT TERM PAVEMENT MARKINGS ON ALL FINAL SURFACES.
- BEFORE BEGINNING ANY WORK, THE CONTRACTOR SHALL RETAIN AND RECORD FOR FUTURE REFERENCE, ALL EXISTING PAVEMENT MARKING LINES (AND RAISED REFLECTIVE PAVEMENT MARKERS) IN ORDER THAT THESE LOCATIONS CAN BE RE-ESTABLISHED FOR STRIPING. EXACT LOCATIONS OF ALL PAVEMENT MARKINGS SHALL BE SHOWN ON THE PLANS OR AS DIRECTED BY THE ENGINEER.
- OVERNIGHT LANE CLOSURES SHALL NOT BE ALLOWED FOR REHABILITAION PROJECTS INVOLVING DAYTIME MILLING AND RESURFACING OPERATIONS AND CLASS D PATCHING UNLESS OTHER CONDITIONS WARRANT EXTENDED LANE CLOSURES AS DETERMINED AND APPROVED IN WRITING BY THE ENGINEER OR AS PROVIDED FOR IN THE CONTRACT SPECIFICATIONS.
- RESURFACING OPERATIONS UNDER THE STRUCTURE MUST NOT CHANGE OR NEGATIVELY IMPACT THE MINIMUM VERTICAL CLEARANCE UNDER THE STRUCTURE.
- AFTER RESURFACING OPERATION UNDER THE STRUCTURE THE ACTUAL CLEARANCE VALUES SHALL BE MEASURED AND FORM "OPER 1306" COMPLETED AND SUBMITTED TO THE DISTRICT ONE TRAFFIC ENGINEER. A COPY SHALL BE SUBMITTED TO THE BRIDGE MAINTENANCE ENGINEER.
- THE CONTRACTOR SHALL REQUEST AND GAIN THE APPROVAL FROM THE ILLINOIS DEPARTMENT OF TRANSPORTATION'S EXPRESSWAY TRAFFIC OPERATIONS ENGINEER AT WWW.IDOTLCS.COM SEVENTY TWO (72) HOURS IN ADVANCE OF ALL DAILY LANE, RAMP AND SHOULDER CLOSURES. THIS ADVANCE NOTIFICATION IS CALCULATED BASED ON WORKWEEK OF MONDAY THROUGH FRIDAY AND SHALL NOT INCLUDE WEEKENDS OR HOLIDAYS.

MODEL: GenNotesSh01 [Sheet]
FILE NAME: c:\pwworking\dwg\illinois\gov\10356982\DD07825-sh1-gennotes.dgn

	USER NAME = nicholas.babul	DESIGNED -	REVISED -	STATE OF ILLINOIS DEPARTMENT OF TRANSPORTATION	INDEX OF SHEETS, STATE STANDARDS, AND GENERAL NOTES DOLTON AVE. (142ND ST. TO I-94 [BISHOP FORD FREEWAY])			F A U R T E .	SECTION	COUNTY	TOTAL SHEETS	SHEET NO.
		DRAWN -	REVISED -					3596	2024-1048-RS	COOK	23	2
		CHECKED -	REVISED -					CONTRACT NO. 62X87				
	PLOT DATE = 6/11/2025	DATE -	REVISED -		SCALE:	SHEET 1	OF 1	SHEETS	STA.	TO STA.	ILLINOIS FED. AID PROJECT	

MODEL: SOQ_1 [Sheet]
FILE NAME: c:\pwwork\pwwork\nicholas.babul\illinois.gov\1036982\107825-h-SOQ.dgn

SUMMARY OF QUANTITIES					TYPE CODE					
					URBAN	URBAN	URBAN	URBAN	URBAN	URBAN
					ROADWAY	ROADWAY				
					80% FED 20% STATE	100% STATE				
	Code No.	Item	Unit	Total Quantity	0005	0005				
	20200100	EARTH EXCAVATION	CU YD	80	80					
	21101600	TOPSOIL FURNISH AND PLACE, VARIABLE DEPTH	SQ YD	354	354					
	25200110	SODDING, SALT TOLERANT	SQ YD	354	354					
	25200200	SUPPLEMENTAL WATERING	UNIT	5.3	5.3					
	31101200	SUBBASE GRANULAR MATERIAL, TYPE B 4"	SQ YD	142	142					
	40600290	BITUMINOUS MATERIALS (TACK COAT)	POUND	13215	13215					
	40600370	LONGITUDINAL JOINT SEALANT	FOOT	9267	9267					
	40600400	MIXTURE FOR CRACKS, JOINTS, AND FLANGEWAYS	TON	30	30					
	40600982	HOT-MIX ASPHALT SURFACE REMOVAL - BUTT JOINT	SQ YD	329	329					
	40601005	HOT-MIX ASPHALT REPLACEMENT OVER PATCHES	TON	124	124					
	40603200	POLYMERIZED HOT-MIX ASPHALT BINDER COURSE, IL-4.75, N50	TON	808	808					
	40604062	HOT-MIX ASPHALT SURFACE COURSE, IL-9.5, MIX "D", N70	TON	1645	1645					
	42001300	PROTECTIVE COAT	SQ YD	692	692					
	42300400	PORTLAND CEMENT CONCRETE DRIVEWAY PAVEMENT, 8 INCH	SQ YD	142	142					
	42400200	PORTLAND CEMENT CONCRETE SIDEWALK 5 INCH	SQ FT	2685	2685					
	42400800	DETECTABLE WARNINGS	SQ FT	188	188					
	44000158	HOT-MIX ASPHALT SURFACE REMOVAL, 2 1/4"	SQ YD	19577	19577					
	44000600	SIDEWALK REMOVAL	SQ FT	2943	2943					
	44002212	HOT-MIX ASPHALT REMOVAL OVER PATCHES, 3"	SQ YD	735	735					
	44201761	CLASS D PATCHES, TYPE I, 10 INCH	SQ YD	50	50					
	44201765	CLASS D PATCHES, TYPE II, 10 INCH	SQ YD	300	300					
* = SPECIALTY ITEM										

SUMMARY OF QUANTITIES					TYPE CODE					
					URBAN	URBAN	URBAN	URBAN	URBAN	URBAN
					ROADWAY	ROADWAY				
					80% FED 20% STATE	100% STATE				
	Code No.	Item	Unit	Total Quantity	0005	0005				
	44201769	CLASS D PATCHES, TYPE III, 10 INCH	SQ YD	200	200					
	44201771	CLASS D PATCHES, TYPE IV, 10 INCH	SQ YD	100	100					
	60250200	CATCH BASINS TO BE ADJUSTED	EACH	2	2					
	60250400	CATCH BASINS TO BE ADJUSTED WITH NEW TYPE 1 FRAME, OPEN LID	EACH	2	2					
	60266600	VALVE BOXES TO BE ADJUSTED	EACH	4	4					
	60300105	FRAMES AND GRATES TO BE ADJUSTED	EACH	2	2					
	60300305	FRAMES AND LIDS TO BE ADJUSTED	EACH	1	1					
*	66900200	NON-SPECIAL WASTE DISPOSAL	CU YD	80	80					
*	66900530	SOIL DISPOSAL ANALYSIS	EACH	1	1					
*	66901001	REGULATED SUBSTANCES PRE-CONSTRUCTION PLAN	L SUM	1	1					
*	66901003	REGULATED SUBSTANCES FINAL CONSTRUCTION REPORT	L SUM	1	1					
*	66901006	REGULATED SUBSTANCES MONITORING	CAL DA	2	2					
	67100100	MOBILIZATION	L SUM	1	1					
	70100420	TRAFFIC CONTROL AND PROTECTION, STANDARD 701411	EACH	4	4					
	70102625	TRAFFIC CONTROL AND PROTECTION, STANDARD 701606	L SUM	1	1					
	70102640	TRAFFIC CONTROL AND PROTECTION, STANDARD 701801	L SUM	1	1					
	70300100	SHORT TERM PAVEMENT MARKING	FOOT	6491	6491					
	70300150	SHORT TERM PAVEMENT MARKING REMOVAL	SQ FT	541	541					
	70300221	TEMPORARY PAVEMENT MARKING - LINE 4"- PAINT	FOOT	17578	17578					
	70300251	TEMPORARY PAVEMENT MARKING - LINE 8"- PAINT	FOOT	1510	1510					
	70300261	TEMPORARY PAVEMENT MARKING - LINE 12"- PAINT	FOOT	1102	1102					
* = SPECIALTY ITEM										

	USER NAME = nicholas.babul	DESIGNED -	REVISED -	STATE OF ILLINOIS DEPARTMENT OF TRANSPORTATION	SUMMARY OF QUANTITIES DOLTON AVE. (142ND ST. TO I-94 [BISHOP FORD FREEWAY])				F.A.U RTE.	SECTION	COUNTY	TOTAL SHEETS	SHEET NO.
		DRAWN -	REVISED -		3596	2024-1048-RS	COOK	23	3				
		CHECKED -	REVISED -		CONTRACT NO. 62X87								
	PLOT DATE = 6/11/2025	DATE -	REVISED -										
					SCALE:	SHEET 1	OF 2	SHEETS	STA.	TO STA.			

[illegible][illegible]

MODEL: SOQ 2 [Sheet]
FILE NAME: c:\pw_ work\pwidot\nicholas.babul@illinois.gov\d1036982\D107825-shl-SOQ.dgn

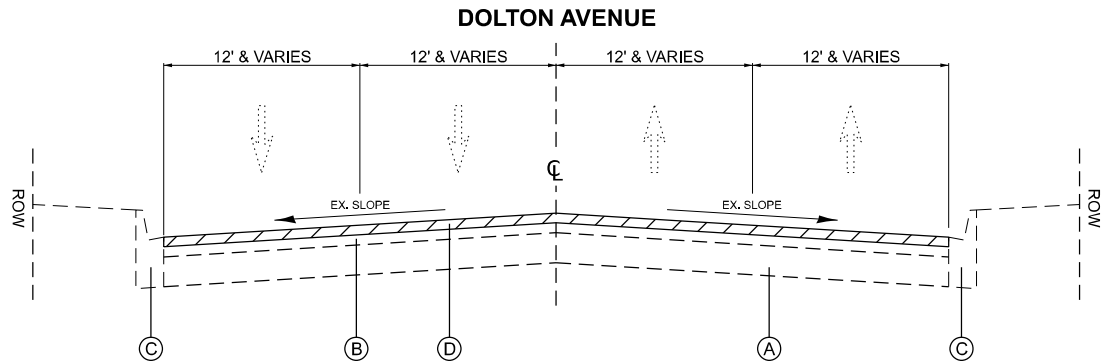

EXISTING TYPICAL SECTION

STA. 9+19 TO STA. 20+10

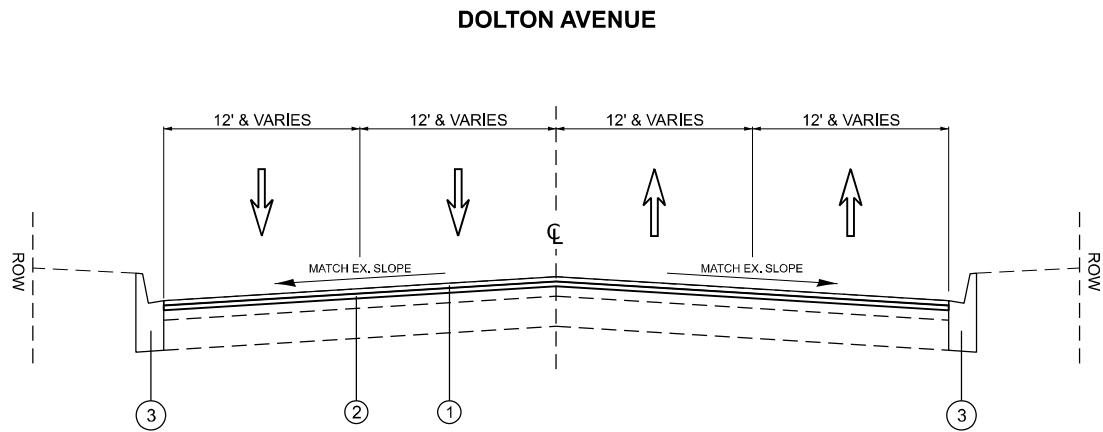

PRPOSED TYPICAL SECTION

STA. 9+19 TO STA. 20+10

LEGEND - EXISTING

- (A) CONCRETE PAVEMENT, ±10"
- (B) HOT MIX ASPHALT SURFACE BEFORE MILLING, ±3"
- (C) COMBINATION CONCRETE CURB & GUTTER, TYPE B-6.12
- (D) HOT MIX ASPHALT SURFACE REMOVAL, 2 ¼"
- (E) MOUNTABLE MEDIAN

LEGEND - PROPOSED

- (1) HOT-MIX ASPHALT SURFACE COURSE, IL-9.5, MIX "D", N70, 1 ½"
- (2) POLYMERIZED HOT-MIX ASPHALT BINDER COURSE, IL-4.75, N50, ¾"
- (3) COMBINATION CONCRETE CURB & GUTTER, TYPE B-6.12

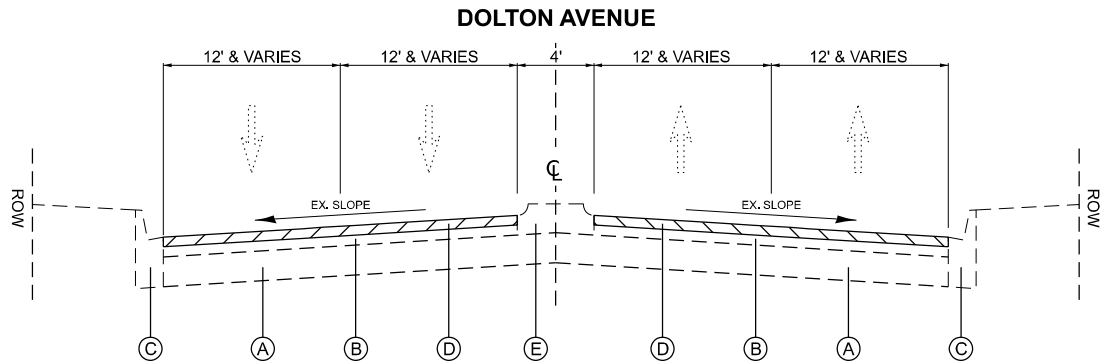

EXISTING TYPICAL SECTION

STA. 20+10 TO STA. 40+08

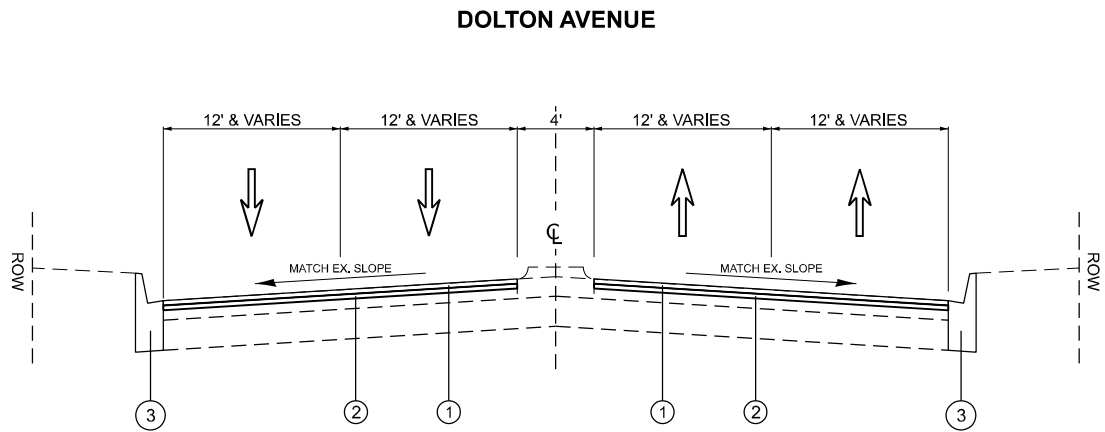

PRPOSED TYPICAL SECTION

STA. 20+10 TO STA. 40+08

HOT-MIX ASPHALT MIXTURE REQUIREMENTS		QUALITY MANAGEMENT PROGRAM (QMP)
MIXTURE TYPE	AIR VOIDS(%) @ Ndes	
PAVEMENT RESURFACING		
HOT-MIX ASPHALT SURFACE COURSE, IL-9.5, MIX "D", N70, 1 ½"	4% @ 70 GYR.	QCP
POLYMERIZED HOT-MIX ASPHALT BINDER COURSE, IL-4.75, N50, ¾"	3.5% @ 50 GYR.	QC/QA
PATCHING		
CLASS D PATCHES (HMA BINDER IL-19.0)	4% @ 70 GYR.	QC/QA
HOT-MIX ASPHALT REPLACEMENT OVER PATCHES (HMA BINDER IL-19.0), 3"	4% @ 70 GYR.	QC/QA
QMP DESIGNATION: QUALITY CONTROL/QUALITY ASSURANCE (QC/QA); QUALITY CONTROL FOR PERFORMANCE (QCP); PAY FOR PERFORMANCE (PFP)		

- NOTE 1: THE UNIT WEIGHT USED TO CALCULATE ALL HMA SURFACE MIXTURE QUANTITIES IS 112 LBS/SQ YD/IN.
- NOTE 2: THE "AC TYPE" FOR POLYMERIZED HMA MIXES SHALL BE "SBS/SBR PG 76-22" AND FOR NON-POLYMERIZED HMA THE "AC TYPE" SHALL BE "PG 64-22" UNLESS MODIFIED BY RECLAIMED MATERIALS SPECIFICATIONS.
- NOTE 3: THE CONTRACTOR SHALL PATCH FIRST THEN MILL.
- NOTE 4: THE LONGITUDINAL JOINT SEALANT SHALL BE PLACED OVER THE POLYMERIZED HMA BINDER COURSE, IL-4.75, N50.

MODEL: TwpSec01 [Sheet]
FILE NAME: c:\pva\work\mitcholas.babul\illinois.gov\1036982\107825-sh-typical.dgn

	USER NAME = nicholas.babul	DESIGNED -	REVISED -
		DRAWN -	REVISED -
		CHECKED -	REVISED -
	PLOT DATE = 6/4/2025	DATE -	REVISED -

STATE OF ILLINOIS
DEPARTMENT OF TRANSPORTATION

TYPICAL SECTIONS DOLTON AVENUE			
SCALE:	SHEET 1	OF 1 SHEETS	STA. TO STA.

F.A.U RTE.	SECTION	COUNTY	TOTAL SHEETS	SHEET NO.
3596	2024-1048-RS	COOK	23	5
CONTRACT NO. 62X87				
ILLINOIS FED. AID PROJECT				

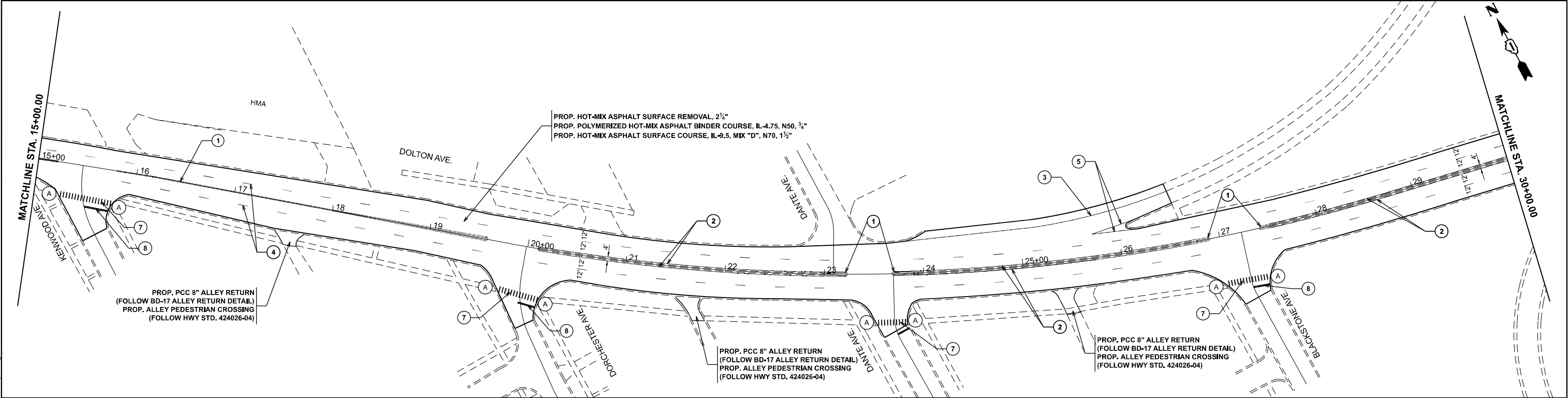
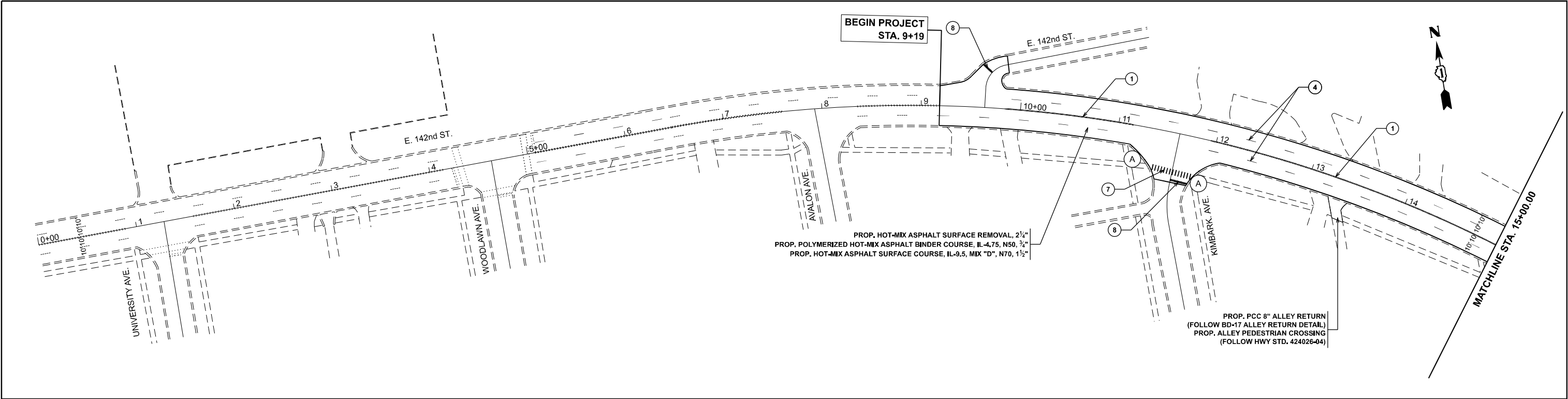

THERMOPLASTIC PAVEMENT MARKING LEGEND

- 1 4" DOUBLE SOLID YELLOW CENTERLINE, 2 @ 11" C-C (TYP.)
- 2 4" SINGLE SOLID YELLOW LINE (TYP.)
- 3 4" SINGLE SOLID WHITE LINE (TYP.)
- 4 4" SKIP DASH WHITE LINE, 10' DASH - 30' SKIP (TYP.)
- 5 8" SOLID WHITE GORE MARKING AND CHANNELIZING LINES (TYP.)
- 6 12" DIAGONAL SOLID WHITE LINE @ 20' C-C (5 MINIMUM) (TYP.)
- 7 12" SOLID WHITE SCHOOL CROSSWALK (TYP.)
- 8 24" SOLID WHITE STOP BAR (TYP.)

ROADWAY LEGEND

- A PROPOSED PEDESTRIAN RAMP IMPROVEMENT, SEE ADA DETAILS

NOTES

- 1) LIMITS OF RESURFACING ON THE SIDE-STREETS THROUGHOUT THE PROJECT SHALL BE TO THE RADIUS RETURN, UNLESS OTHERWISE SHOWN ON THE PLANS, OR AS DIRECTED BY THE RESIDENT ENGINEER.
- 2) ALL FINAL PAVEMENT MARKINGS SHALL BE PLACED IN ACCORDANCE WITH TC-13 "DISTRICT ONE TYPICAL PAVEMENT MARKINGS" STANDARD DETAIL.
- 3) ALL RAISED REFLECTIVE PAVEMENT MARKERS SHALL BE PLACED IN ACCORDANCE WITH TC-11 "TYPICAL APPLICATIONS RAISED REFLECTIVE PAVEMENT MARKERS (SNOW-PLOW RESISTANT)" STANDARD DETAIL.
- 4) BUTT JOINTS SHALL BE INSTALLED AT THE ENDS OF ALL RESURFACING (WHERE RESURFACING MEETS EXISTING PAVEMENT) ACCORDING WITH BD-32 "BUTT JOINT AND HOT-MIX ASPHALT TAPER DETAILS" UNLESS OTHERWISE SPECIFIED.

MODEL: DOLTON_E - Roadway Sheet 1 [Sheet]
FILE NAME: c:\p\work\1048\1048-RS.dgn

USER NAME	= nicholas.babul	DESIGNED -	REVISED -
		DRAWN -	REVISED -
		CHECKED -	REVISED -
PLOT DATE	= 6/17/2025	DATE -	REVISED -

STATE OF ILLINOIS
DEPARTMENT OF TRANSPORTATION

ROADWAY AND PAVEMENT MARKING PLAN
DOLTON AVE. (142ND ST. TO I-94 [BISHOP FORD FREEWAY])

SCALE: SHEET 1 OF 2 SHEETS STA. 0+00.00 TO STA. 30+00.00

F.A.U. RTE.	SECTION	COUNTY	TOTAL SHEETS	SHEET NO.
3596	2024-1048-RS	COOK	23	6
CONTRACT NO. 62X87				
ILLINOIS FED. AID PROJECT				

MODEL: DOLTON_E_Roadway_Sheet 3 [Sheet]
FILE NAME: c:\p\work\dot\dot\nicholas.babul\Illinois.gov\dot\dot\107825-sh-plan.dgn

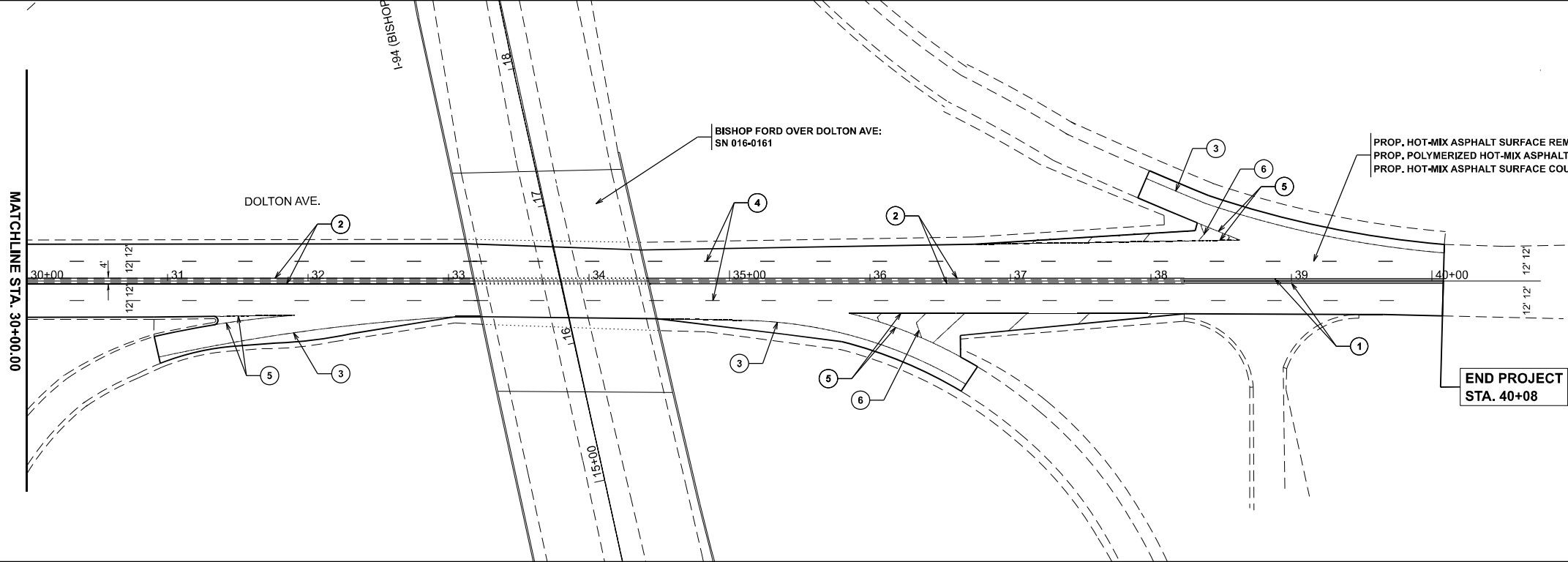

THERMOPLASTIC PAVEMENT MARKING LEGEND

- 1 4" DOUBLE SOLID YELLOW CENTERLINE, 2 @ 11" C-C (TYP.)
- 2 4" SINGLE SOLID YELLOW LINE (TYP.)
- 3 4" SINGLE SOLID WHITE LINE (TYP.)
- 4 4" SKIP DASH WHITE LINE, 10' DASH - 30' SKIP (TYP.)
- 5 8" SOLID WHITE GORE MARKING AND CHANNELIZING LINES (TYP.)
- 6 12" DIAGONAL SOLID WHITE LINE @ 20' C-C (5 MINIMUM) (TYP.)
- 7 12" SOLID WHITE SCHOOL CROSSWALK (TYP.)
- 8 24" SOLID WHITE STOP BAR (TYP.)

ROADWAY LEGEND

- A PROPOSED PEDESTRIAN RAMP IMPROVEMENT, SEE ADA DETAILS

NOTES

- 1) LIMITS OF RESURFACING ON THE SIDE-STREETS THROUGHOUT THE PROJECT SHALL BE TO THE RADIUS RETURN, UNLESS OTHERWISE SHOWN ON THE PLANS, OR AS DIRECTED BY THE RESIDENT ENGINEER.
- 2) ALL FINAL PAVEMENT MARKINGS SHALL BE PLACED IN ACCORDANCE WITH TC-13 "DISTRICT ONE TYPICAL PAVEMENT MARKINGS" STANDARD DETAIL.
- 3) ALL RAISED REFLECTIVE PAVEMENT MARKERS SHALL BE PLACED IN ACCORDANCE WITH TC-11 "TYPICAL APPLICATIONS RAISED REFLECTIVE PAVEMENT MARKERS (SNOW-PLOW RESISTANT)" STANDARD DETAIL.
- 4) BUTT JOINTS SHALL BE INSTALLED AT THE ENDS OF ALL RESURFACING (WHERE RESURFACING MEETS EXISTING PAVEMENT) ACCORDING WITH BD-32 "BUTT JOINT AND HOT-MIX ASPHALT TAPER DETAILS" UNLESS OTHERWISE SPECIFIED.

	USER NAME	= nicholas.babul	DESIGNED	-	REVISED	-
			DRAWN	-	REVISED	-
			CHECKED	-	REVISED	-
	PLOT DATE	= 6/17/2025	DATE	-	REVISED	-

STATE OF ILLINOIS
DEPARTMENT OF TRANSPORTATION

ROADWAY AND PAVEMENT MARKING PLAN
DOLTON AVE. (142ND ST. TO I-94 [BISHOP FORD FREEWAY])

SCALE: SHEET 2 OF 2 SHEETS STA. 30+00.00 TO STA. 45+00.00

F.A.U RTE.	SECTION	COUNTY	TOTAL SHEETS	SHEET NO.
3596	2024-1048-RS	COOK	23	7
CONTRACT NO. 62X87				
ILLINOIS FED. AID PROJECT				



SOUTHWEST CORNER OF
DOLTON AVENUE & KIMBARK AVENUE

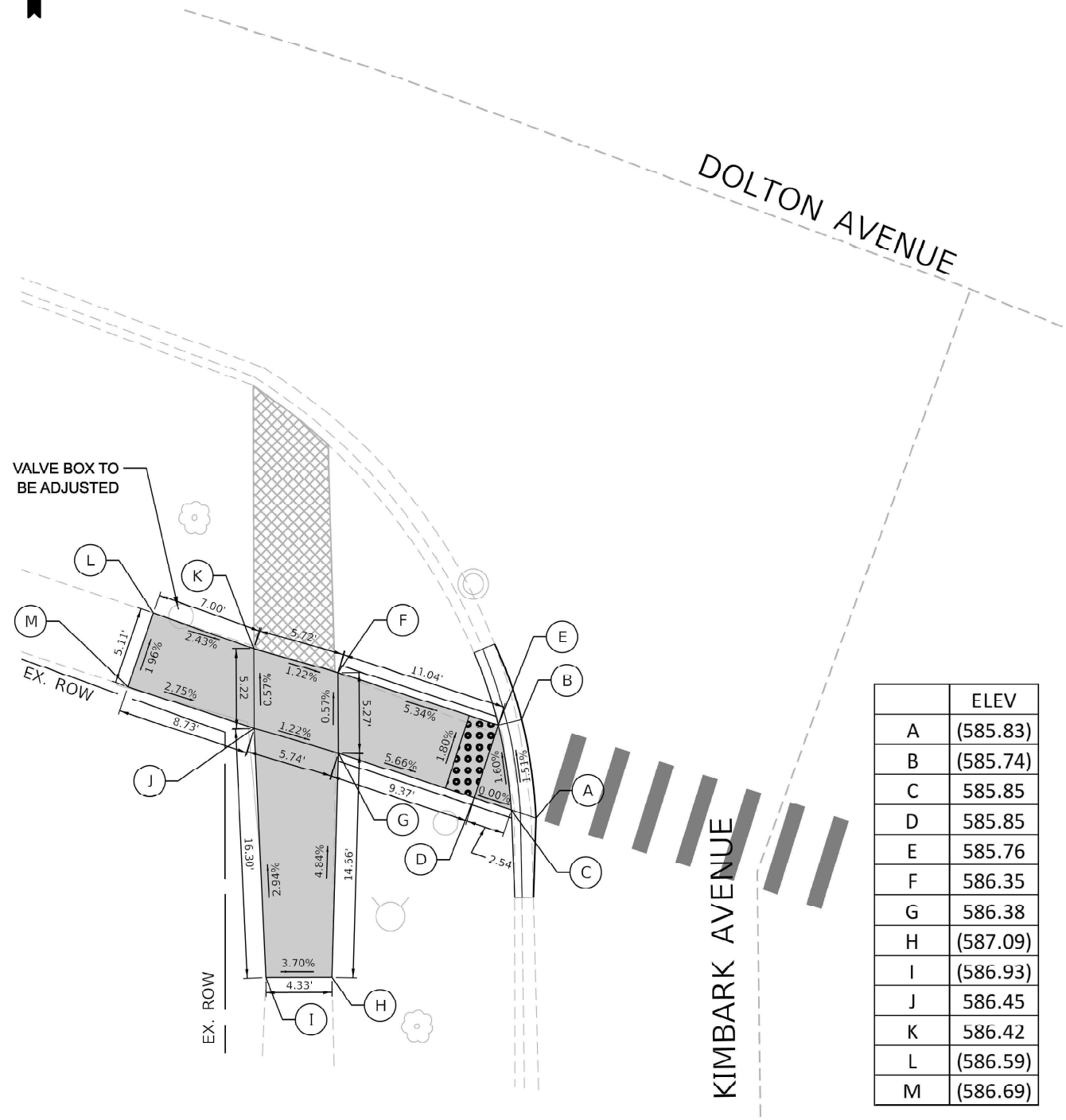

	ELEV
A	(585.83)
B	(585.74)
C	585.85
D	585.85
E	585.76
F	586.35
G	586.38
H	(587.09)
I	(586.93)
J	586.45
K	586.42
L	(586.59)
M	(586.69)

REFERENCE BENCHMARK ELEV 587.81
BENCHMARK :
CROSS @ NW FLANGE BOLT OF HYDRANT
LOCATION :
SOUTHWEST CORNER @ KIMBARK AVE. & DOLTON AVE.

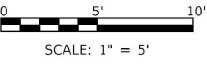

LEGEND

- (XXX.XX) EXISTING ELEVATION
- PROPOSED SIDE CURBS
- PROPOSED SIDEWALK
- DETECTABLE WARNINGS
- SIDEWALK REMOVAL
REPLACE W/ TOPSOIL

STATE OF ILLINOIS
DEPARTMENT OF TRANSPORTATION

SOUTHEAST CORNER OF
DOLTON AVENUE & KIMBARK AVENUE

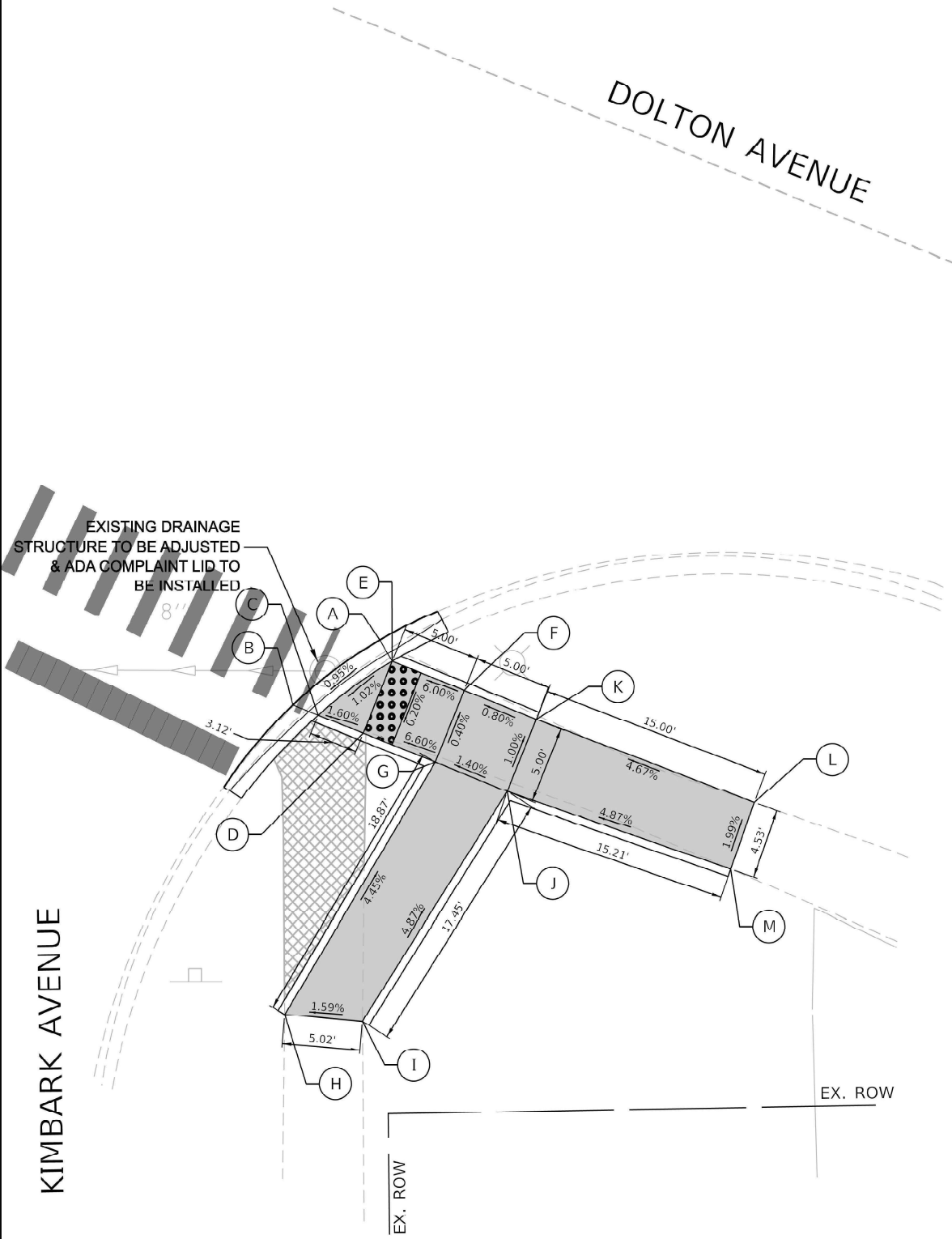

	ELEV
A	(585.54)
B	(585.48)
C	585.49
D	585.54
E	585.55
F	585.85
G	585.87
H	(586.71)
I	(586.79)
J	585.94
K	585.89
L	(586.59)
M	(586.68)

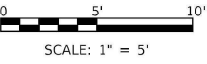

MOBIL: Phase 1 Design 1 (Sheet)
FILE NAME: c:\p\work\2024\1048\2024-1048-RS-111-111.dgn DA-60195-60092.dgn



USER NAME = PAnimugam	DESIGNED - MJM	REVISED -
	DRAWN - PA	REVISED -
PLOT SCALE = 10.0000' / in.	CHECKED - MW	REVISED -
PLOT DATE = 2/18/2025	DATE -	REVISED -

PEDESTRIAN RAMP DETAILS DOLTON AVE & KIMBARK AVE			
SCALE:	SHEET	OF	SHEETS
	STA.		TO STA.

F.A.U. RTE.	SECTION	COUNTY	TOTAL SHEETS	SHEET NO.
359B	2024-1048-RS	COOK	23	8
CONTRACT NO. 62X87				
ILLINOIS FED. AID PROJECT				



	ELEV
A	(586.82)
B	(586.75)
C	586.84
D	586.85
E	586.77
F	587.08
G	587.09
H	(587.10)
I	(587.20)
J	587.17
K	587.16
L	(587.12)
M	(587.19)

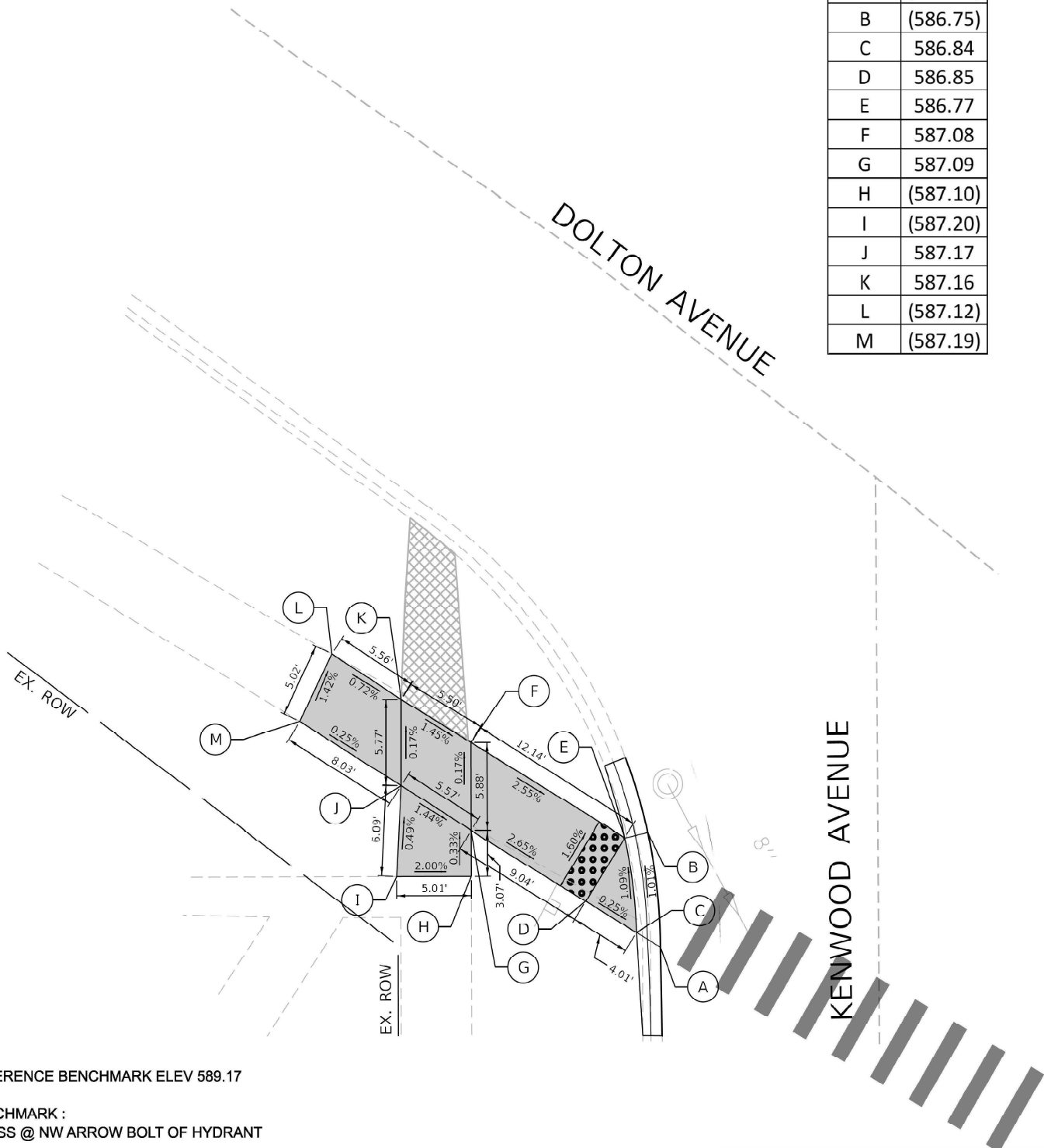

REFERENCE BENCHMARK ELEV 589.17

BENCHMARK :
CROSS @ NW ARROW BOLT OF HYDRANT

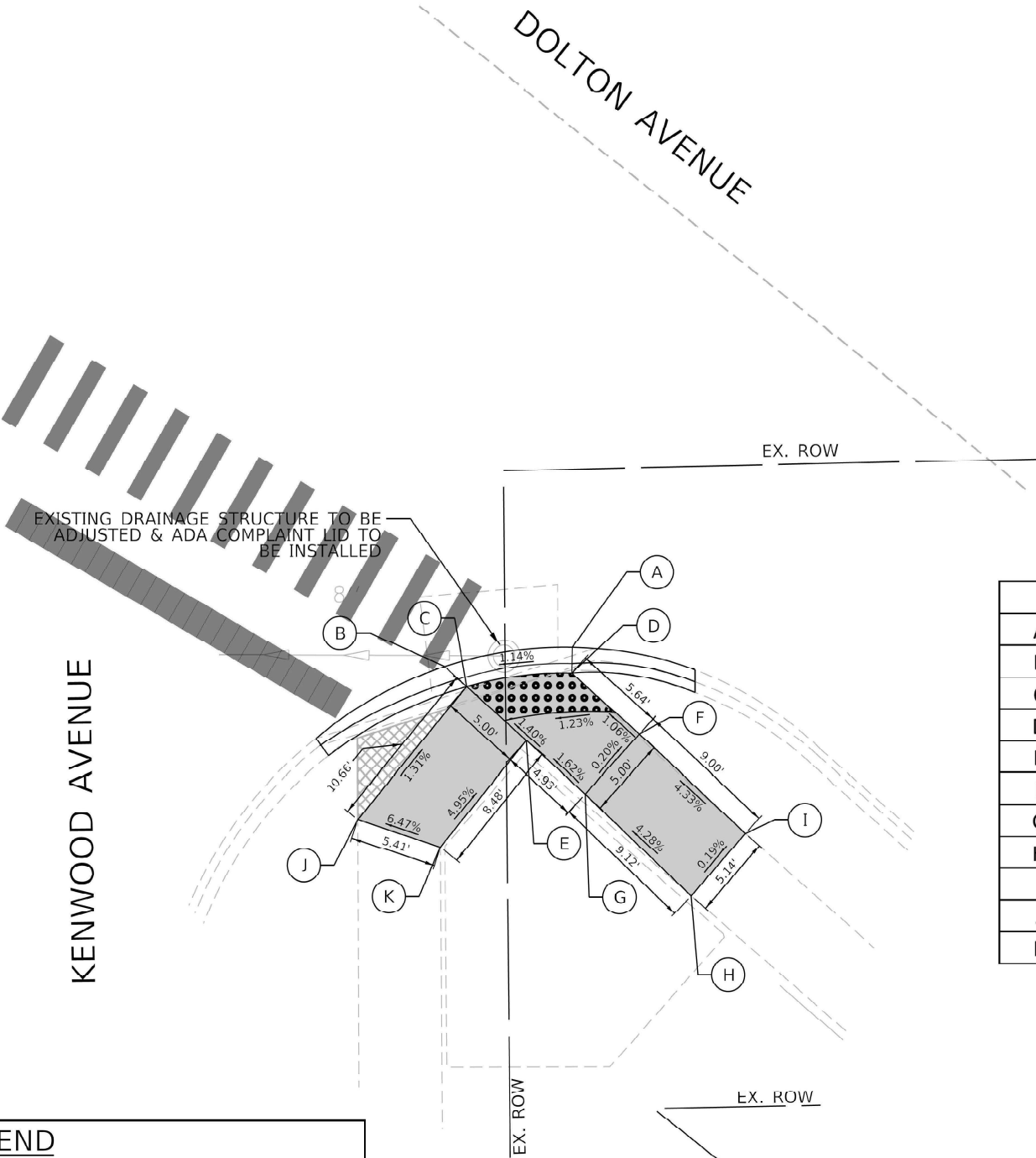
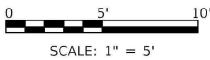

LOCATION :
SOUTHWEST CORNER @ KENWOOD AVE. & DOLTON AVE.



	ELEV
A	(586.65)
B	(586.57)
C	586.58
D	586.66
E	586.65
F	586.72
G	586.73
H	(587.12)
I	(587.11)
J	(586.72)
K	(587.07)

LEGEND

(XXX.XX) EXISTING ELEVATION
 == PROPOSED SIDE CURBS

 PROPOSED SIDEWALK
 DETECTABLE WARNINGS
 SIDEWALK REMOVAL
 REPLACE W/ TOPSOIL

STATE OF ILLINOIS
DEPARTMENT OF TRANSPORTATION

PEDESTRIAN RAMP DETAILS

DOLTON AVE & KENWOOD AVE

F.A.U RTE.	SECTION	COUNTY	TOTAL SHEETS	SHEET NO.
3596	2024-1048-RS	COOK	23	9
		CONTRACT NO. 62X87		
ILLINOIS		FED. AID PROJECT		

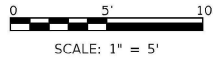

SOUTHWEST CORNER OF
DOLTON AVENUE & DORCHESTER AVENUE



DOLTON AVENUE

DORCHESTER AVENUE

	ELEV
A	587.49
B	587.40
C	587.41
D	587.42
E	587.50
F	587.66
G	587.68
H	(587.70)
I	(587.71)
J	587.70
K	587.67
L	(587.92)
M	(588.03)

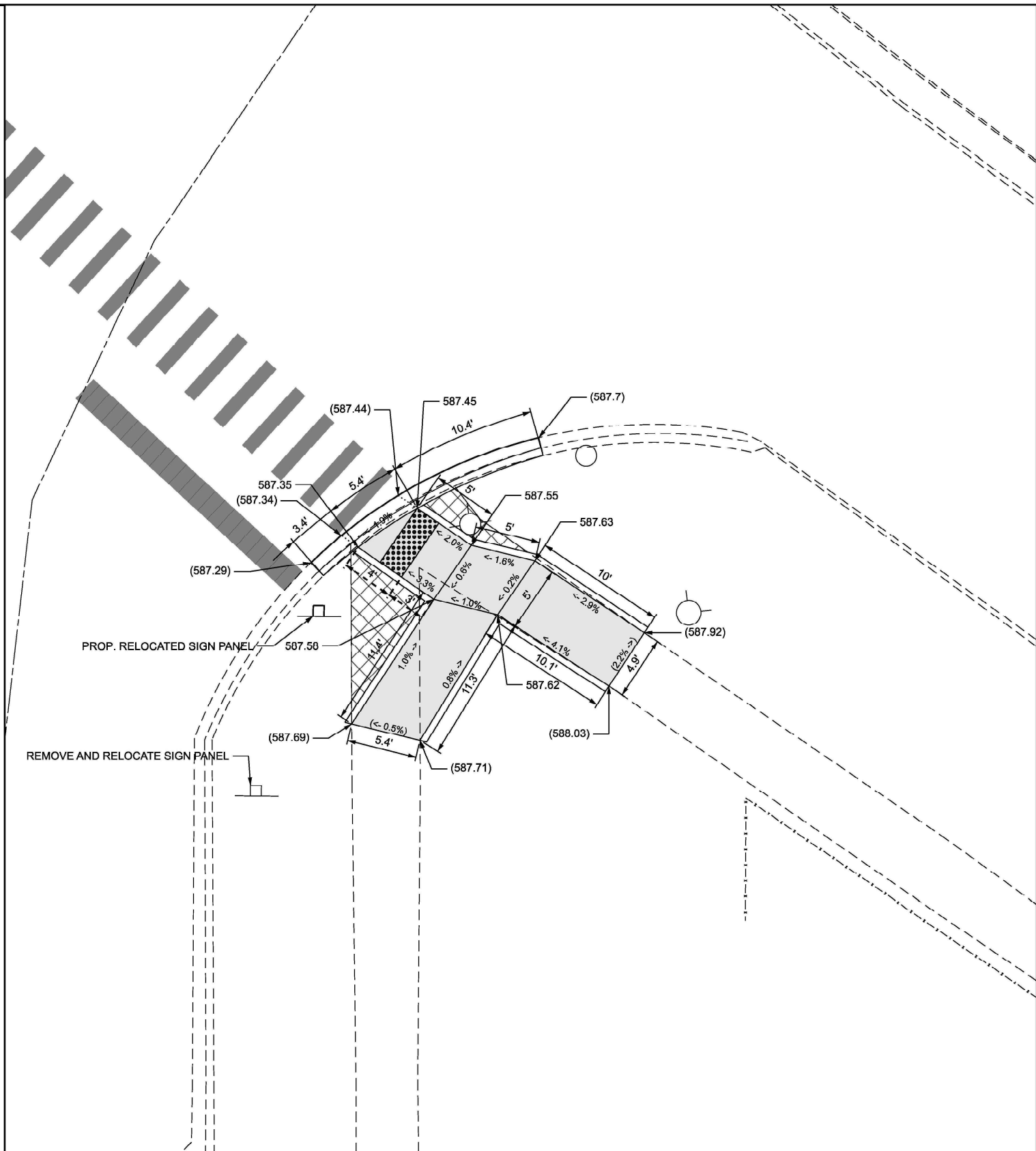
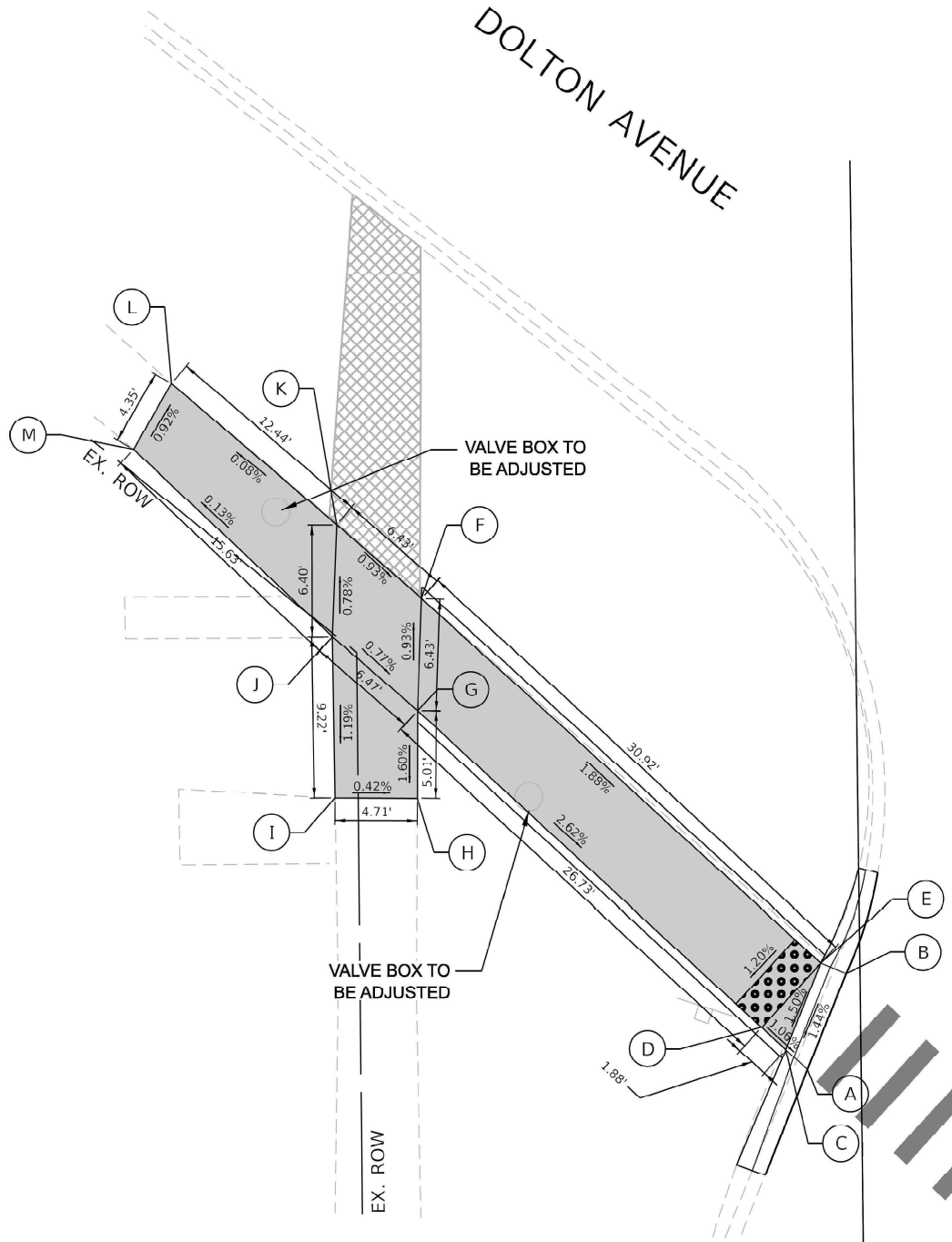

REFERENCE BENCHMARK ELEV 588.24

BENCHMARK :
SQUARE @ NORTH SIDE CONC. LIGHT POLE BASE @ SW QUADRANT

LOCATION :
SOUTHWEST CORNER @ DORCHESTER AVE. & DOLTON AVE.

LEGEND

PROPOSED SIDE CURB

(xxx.xx) EXISTING ELEVATION/SLOPE

PROPOSED SIDEWALK

DETECTABLE WARNINGS

SIDEWALK REMOVAL
REPLACE W/TOPSOIL & SOD

REFERENCE BENCHMARK ELEV 588.24

BENCHMARK :
SQUARE @ NORTH SIDE CONC. LIGHT POLE BASE @ SW QUADRANT

LOCATION :
SOUTHWEST CORNER @ DORCHESTER AVE. & DOLTON AVE.

MODEL: Dorchester Ave [Sheet]
FILE NAME: c:\pwworking\illinois\gov\1036863\1017825-ADA-Design.dgn

USER NAME = nicholas.babul	DESIGNED -	REVISED -
	DRAWN -	REVISED -
	CHECKED -	REVISED -
PLOT DATE = 6/17/2025	DATE -	REVISED -

STATE OF ILLINOIS
DEPARTMENT OF TRANSPORTATION

PEDESTRIAN RAMP DETAILS
DOLTON AVE & DORCHESTER AVE

SCALE: SHEET A003 OF 5 SHEETS STA. 0+00.00 TO STA. 0+00.00

F.A.U. RTE.	SECTION	COUNTY	TOTAL SHEETS	SHEET NO.
3596	2024-1048-RS	COOK	23	10
CONTRACT NO. 62X87				
ILLINOIS FED. AID PROJECT				

SOUTHWEST CORNER OF
DOLTON AVENUE & DANTE AVENUE

SOUTHEAST CORNER OF
DOLTON AVENUE & DANTE AVENUE

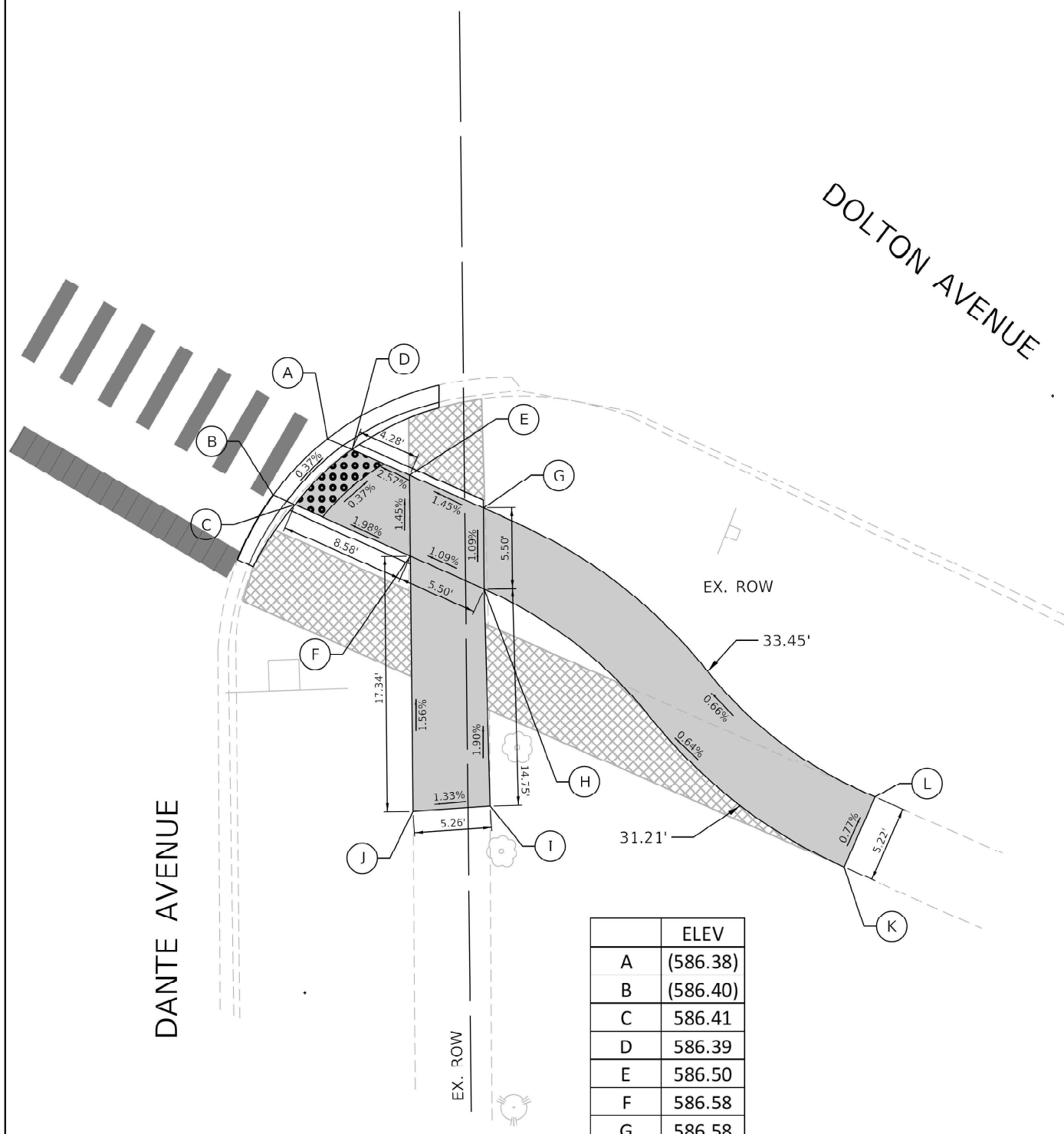
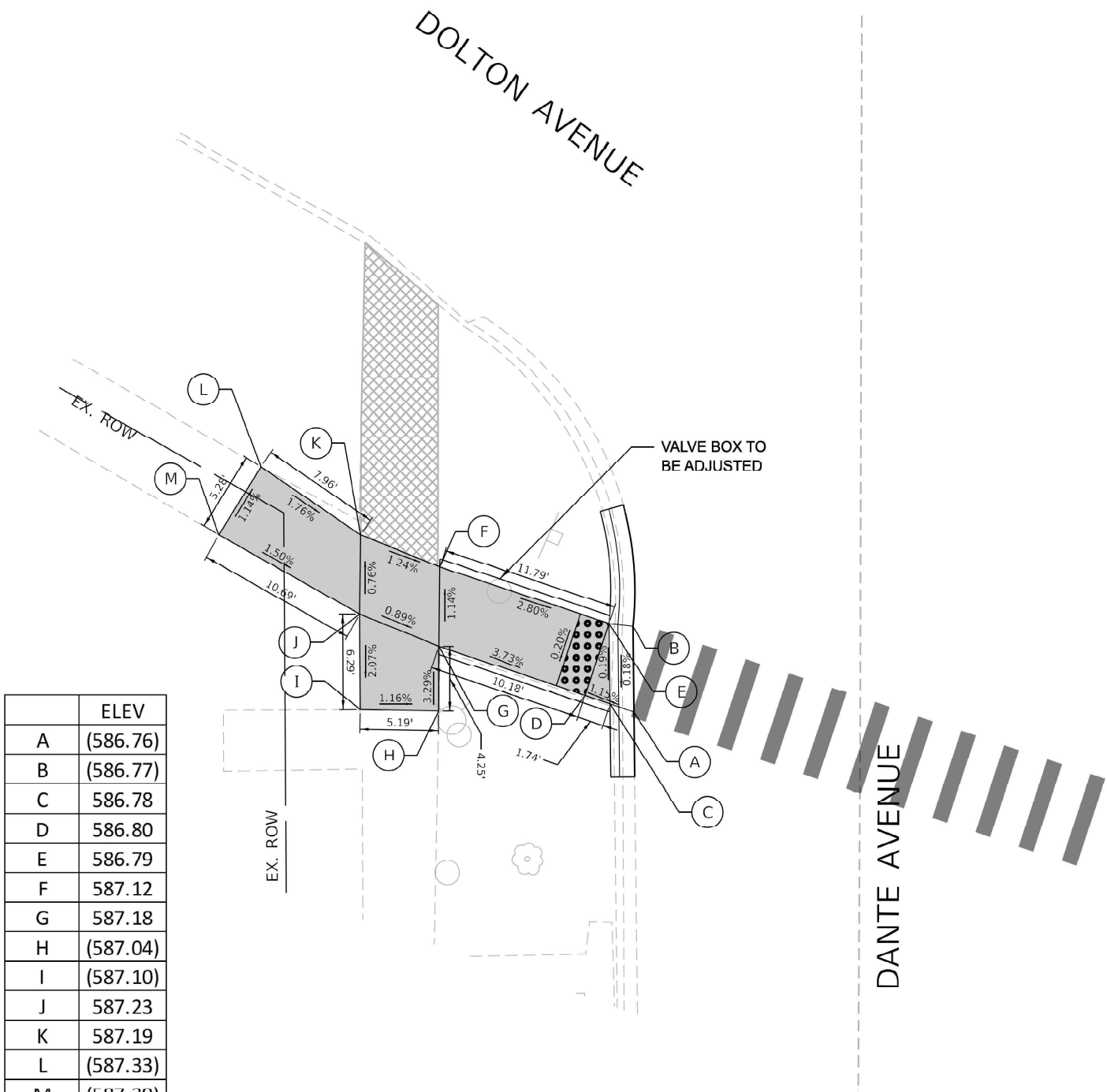
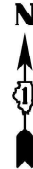

	ELEV
A	(586.76)
B	(586.77)
C	586.78
D	586.80
E	586.79
F	587.12
G	587.18
H	(587.04)
I	(587.10)
J	587.23
K	587.19
L	(587.33)
M	(587.39)

	ELEV
A	(586.38)
B	(586.40)
C	586.41
D	586.39
E	586.50
F	586.58
G	586.58
H	586.64
I	(586.92)
J	(586.85)
K	(586.84)
L	(586.80)

REFERENCE BENCHMARK ELEV 587.10

BENCHMARK :
CROSS @ WEST FLANGE BOLT OF HYDRANT

LOCATION :
SOUTHWEST CORNER @ DANTE AVE. & DOLTON AVE.

LEGEND

(XXX.XX) EXISTING ELEVATION

PROPOSED SIDE CURBS

PROPOSED SIDEWALK

DETECTABLE WARNINGS

SIDEWALK REMOVAL
REPLACE W/ TOPSOIL

STATE OF ILLINOIS
DEPARTMENT OF TRANSPORTATION

PEDESTRIAN RAMP DETAILS
DOLTON AVE & DANTE AVE

F.A.U. RTE.	SECTION	COUNTY	TOTAL SHEETS	SHEET NO.
359B	2024-1048-RS	COOK	23	11
CONTRACT NO. 62X87				

SCALE: SHEET OF SHEETS STA. TO STA.

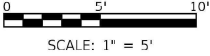

MOBIL: Phase 1 Design of Sheet
FILES NAME: c:\p\work\2024\1048-RS\11\11.dwg
DATE: 2/18/2025
DRAWN: PA
CHECKED: MW
DATE: -



USER NAME = Panmugam	DESIGNED - MJM	REVISED -
PLOT SCALE = 10.0000' / in.	DRAWN - PA	REVISED -
PLOT DATE = 2/18/2025	CHECKED - MW	REVISED -
	DATE -	REVISED -



1. EXISTING BROKEN FRAMES AND LIDS SHALL BE REMOVED AND DISPOSED OF BY THE CONTRACTOR AND SHALL BE REPLACED AS DIRECTED BY THE ENGINEER. REPLACEMENT FRAMES AND LIDS WILL BE PAID FOR IN ACCORDANCE WITH ARTICLE 109.04 OF THE STANDARD SPECIFICATIONS UNLESS A SEPARATE PAY ITEM HAS BEEN PROVIDED.
2. IF THE EXISTING LIDS ARE OPEN, THE FRAME WILL BE ADJUSTED TO THE ELEVATION OF THE MILLED PAVEMENT SURFACE PRIOR TO THE MILLING OPERATION. THE FRAME WILL NOT BE REMOVED AND COVERED BY THE METAL PLATE.
3. CITY OF CHICAGO CASTINGS ARE THE PROPERTY OF THE CITY AND THE CONTRACTOR SHALL NOTIFY THE CITY FOR REMOVAL AND DISPOSITION OF THE CASTINGS.
4. THE METAL PLATE USED TO COVER THE STRUCTURE SHALL REMAIN THE PROPERTY OF THE CONTRACTOR.
5. THE CONTRACTOR SHALL REMOVE ALL TRAFFIC CONTROL DEVICES BY THE END OF EACH WORK SHIFT.

STAGE 1 (BEFORE PAVEMENT MILLING)

- A) REMOVE A MINIMUM OF 12 (300) OF THE PAVEMENT FROM AROUND THE STRUCTURE.
- B) REMOVE THE EXISTING FRAME AND LID FROM THE STRUCTURE.
- C) COVER THE STRUCTURE OPENING WITH A 36 (900) DIAMETER METAL PLATE.
- D) BACKFILL WITH CRUSHED STONE AND HMA SURFACE MIX APPROVED BY THE ENGINEER. (MIN. 3 (80) HMA TO REMAIN AFTER MILLING).

***UNLESS OTHERWISE SPECIFIED IN THE PLANS.**

THE PROCEDURE EXPLAINED ABOVE SHALL CONFORM TO THE APPLICABLE PORTIONS OF SECTIONS 353, 406, 602, AND 603 OF THE STANDARD SPECIFICATIONS EXCEPT THAT "THE CONTRACTOR SHALL ADJUST THE STRUCTURES TO THE FINISHED PAVEMENT ELEVATION NO MORE THAN 5 CALENDAR DAYS PRIOR TO PLACEMENT OF THE FINAL LIFT OF SURFACE UNLESS APPROVED BY THE ENGINEER."

① SUB-BASE GRANULAR MATERIAL	⑥ FRAME AND LID (SEE NOTES)
② EXISTING PAVEMENT	⑦ CLASS PP-2* CONCRETE
③ 36 (900) DIAMETER METAL PLATE	⑧ PROPOSED HMA SURFACE COURSE
④ PROPOSED CRUSHED STONE AND HMA SURFACE MIX	⑨ PROPOSED HMA BINDER COURSE
⑤ EXISTING STRUCTURE	

THE CONTRACTOR WILL BE REQUIRED TO KEEP A RECORD OF THE LOCATIONS OF THE BURIED STRUCTURES ACCORDING TO THE STATION AND DISTANCE LEFT OR RIGHT OF THE CENTERLINE OF PAVEMENT. UPON COMPLETION OF THE WORK, THE CONTRACTOR WILL DELIVER THE RECORD TO THE ENGINEER.

1. REMOVING FRAMES AND LIDS ON DRAINAGE AND UTILITY STRUCTURES IN THE PAVEMENT PRIOR TO MILLING, AND ADJUSTING TO FINAL GRADE PRIOR TO PLACING THE SURFACE COURSE, WILL BE PAID FOR AT THE CONTRACT UNIT PRICE EACH FOR "FRAMES AND LIDS TO BE ADJUSTED (SPECIAL)."
2. THIS WORK WILL NOT BE PAID FOR WHEN DRAINAGE AND UTILITY STRUCTURES ARE SPECIFIED FOR PAYMENT AS STRUCTURE RECONSTRUCTION.
3. NEW FRAMES AND LIDS, WHEN SPECIFIED, WILL BE PAID FOR SEPARATELY.
4. WHEN STRUCTURES ARE TO BE ADJUSTED OR RECONSTRUCTED, THE LOWERING AND RAISING OF THE FRAMES AND LIDS WILL NOT BE PAID FOR SEPARATELY BUT WILL BE INCLUDED IN THE COST OF THE CORRESPONDING PAY ITEM.

DETAILS FOR FRAMES AND LIDS ADJUSTMENT WITH MILLING

F.A.U RTE.	SECTION	COUNTY	TOTAL SHEETS	SHEET NO.
3596	2024-1048-RS	COOK	23	13
BD600-03 (BD-08)		CONTRACT NO. 62X87		
ILLINOIS		FED. AID PROJECT		

MODEL: BD-17 [Sheet]
FILE NAME: c:\p\work\p\work\nicholas.babul\illinois.gov\1036982\107825-sh-Ds\Sd\ss.dgn

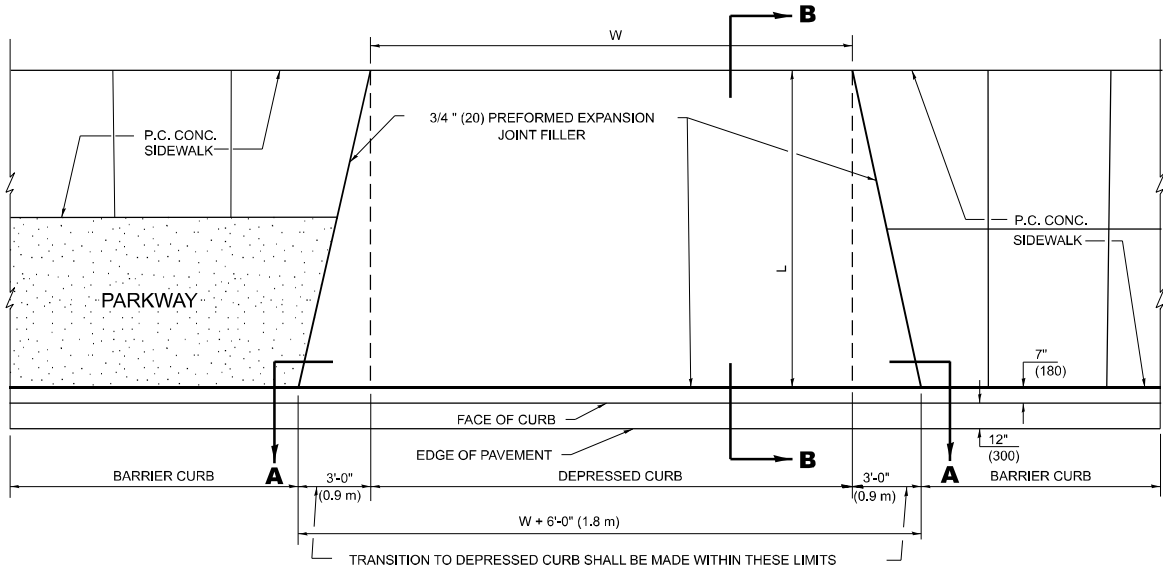

PLAN VIEW

NOTES:

- EXPANSION JOINTS SHALL BE CONSTRUCTED AS SHOWN ON THE DETAILS FOR P.C.C. SIDEWALK.
- THE CURB BETWEEN ADJACENT DRIVEWAYS SHALL BE FULL HEIGHT FOR A DISTANCE OF AT LEAST FOUR FEET (1.2 METERS).
- P.C. CONCRETE DRIVEWAYS SHALL BE CONSTRUCTED AT LOCATIONS SHOWN ON THE PLANS OR AS DIRECTED BY THE ENGINEER.

BASIS OF PAVEMENT

- 3/4" (20) PREFORMED EXPANSION JOINTS WILL NOT BE PAID FOR SEPARATELY BUT SHALL BE INCLUDED IN P.C.C. DRIVEWAY PAVEMENT 8" (200).
- COMBINATION CONC. CURB AND GUTTER SHALL BE MEASURED STRAIGHT ACROSS THE DRIVEWAY. NO ADDITIONAL COMPENSATION WILL BE ALLOWED FOR THE TRANSITION CURB AND GUTTER.

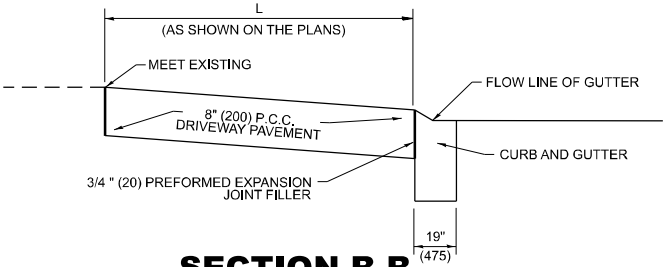

SECTION B-B

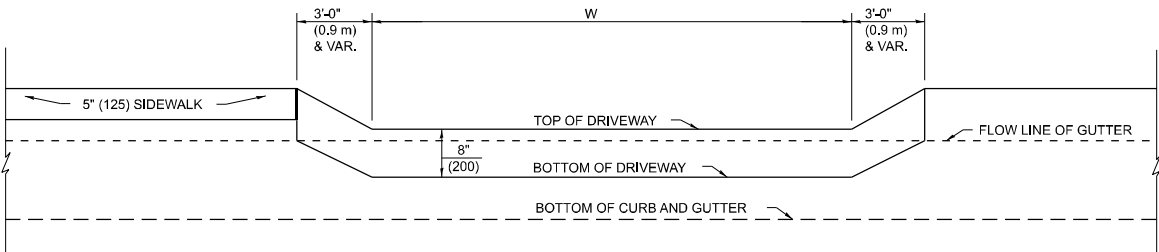

SECTION A-A

P.C.C. DRIVEWAY PAVEMENT DETAIL

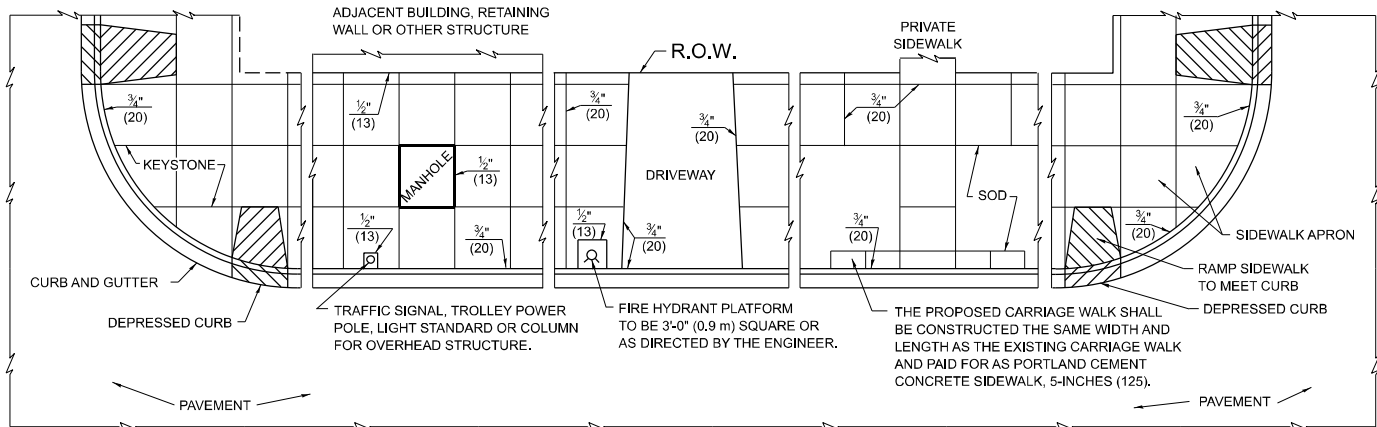

NOTES:

- ONE-HALF INCH THICK EXPANSION JOINTS SHALL BE PLACED BETWEEN THE SIDEWALK AND ALL STRYCTURES SUCH AS LIGHT STANDARDS, TRAFFIC LIGHT STANDARDS, MANHOLES, WHICH EXTEND THROUGH THE SIDEWALK.
- 3/4" (20) THICK EXPANSION JOINTS SHALL BE PLACED AT INTERVALS OF NOT MORE THAN 100 FEET (30 METERS) IN THE SIDEWALK. WHERE THE SIDEWALK IS CONSTRUCTED ADJACENT TO PAVEMENT OR CURB HAVING EXPANSION JOINTS, THE EXPANSION JOINTS IN THE SIDEWALK SHALL BE PLACED OPPOSITE THE EXISTING EXPANSION JOINTS AS NEARLY AS PRACTICABLE. EXPANSION JOINTS SHALL ALSO BE PLACED WHERE THE SIDEWALK ABUTS EXISTING SIDEWALKS, BETWEEN DRIVEWAY PAVEMENT AND SIDEWALK, AND BETWEEN SIDEWALK AND CURBS WHERE THE SIDEWALK ABUTS THE CURB.

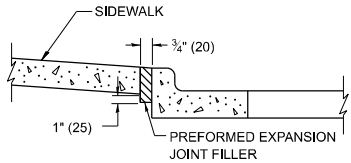

SLOPE FOR SIDEWALK
1" (25) IN 3'-0" (0.9 m) IN CHICAGO

PORTLAND CEMENT CONCRETE SIDEWALK DETAILS

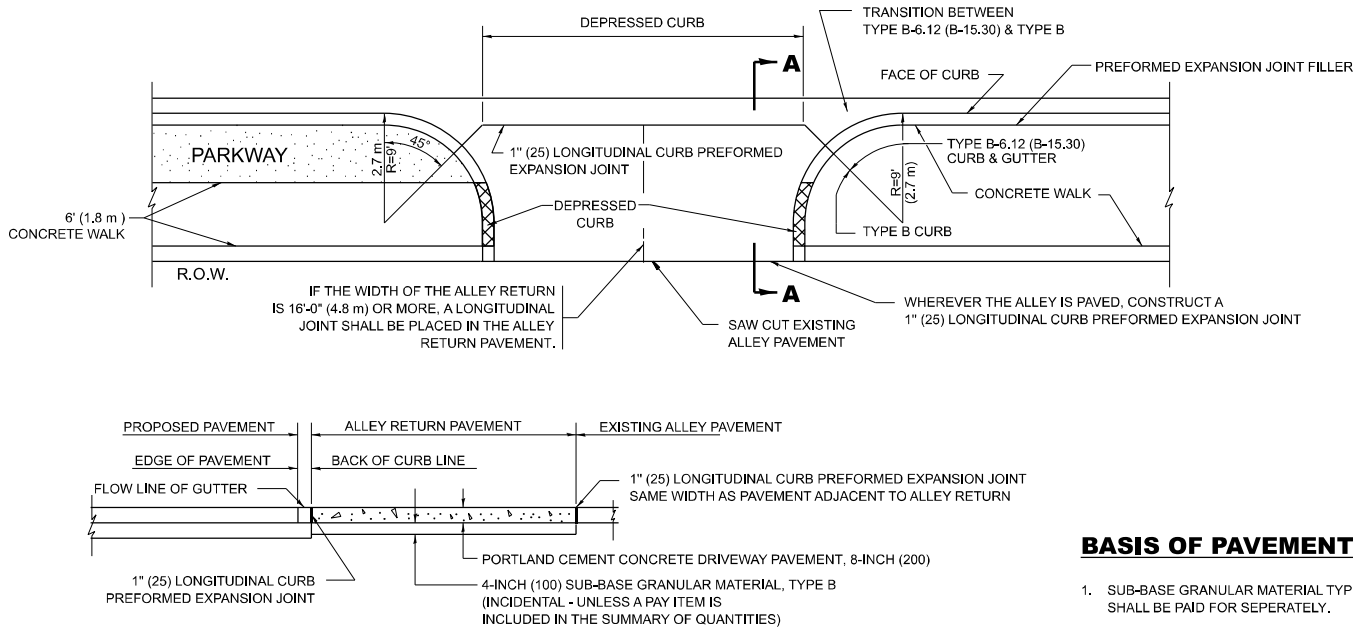

SECTION A-A

ALLEY RETURN DETAIL

BASIS OF PAVEMENT

- SUB-BASE GRANULAR MATERIAL TYPE B SHALL BE PAID FOR SEPERATELY.
- NO EXTRA COMPENSATION SHALL BE ALLOWED FOR THE GUTTER FLARE.

ALL DIMENSIONS ARE IN INCHES (MILLIMETERS)
UNLESS OTHERWISE SHOWN

STATE OF ILLINOIS
DEPARTMENT OF TRANSPORTATION

CITY OF CHICAGO
DETAILS FOR P.C. CONCRETE DRIVEWAY, ALLEY RETURN AND SIDEWALK

SCALE: NONE SHEET 1 OF 1 SHEETS STA. TO STA.

F.A.U RTE.	SECTION	COUNTY	TOTAL SHEETS	SHEET NO.
3596	2024-1048-RS	COOK	23	14
BD400-03 (BD-17)		CONTRACT NO. 62X87		
ILLINOIS		FED. AID PROJECT		

METHOD OF MEASUREMENT

REFER TO SECTION 442 OF THE STANDARD SPECIFICATIONS FOR ROAD AND BRIDGE CONSTRUCTION AND THE RECURRING SPECIAL PROVISION "PATCHING WITH HOT-MIX ASPHALT OVERLAY REMOVAL."

BASIS OF PAYMENT

- 1. REFER TO SECTION 442 OF THE STANDARD SPECIFICATIONS FOR ROAD AND BRIDGE CONSTRUCTION AND THE RECURRING SPECIAL PROVISION "PATCHING WITH HOT-MIX ASPHALT OVERLAY REMOVAL."
- 2. SAW CUT/SCORING OF EXISTING HMA OVERLAY IS INCLUDED IN THE COST OF PAVEMENT PATCHING.
- 3. SAW CUT/SCORING OF EXISTING PAVEMENT IS INCLUDED IN THE COST OF PAVEMENT PATCHING.

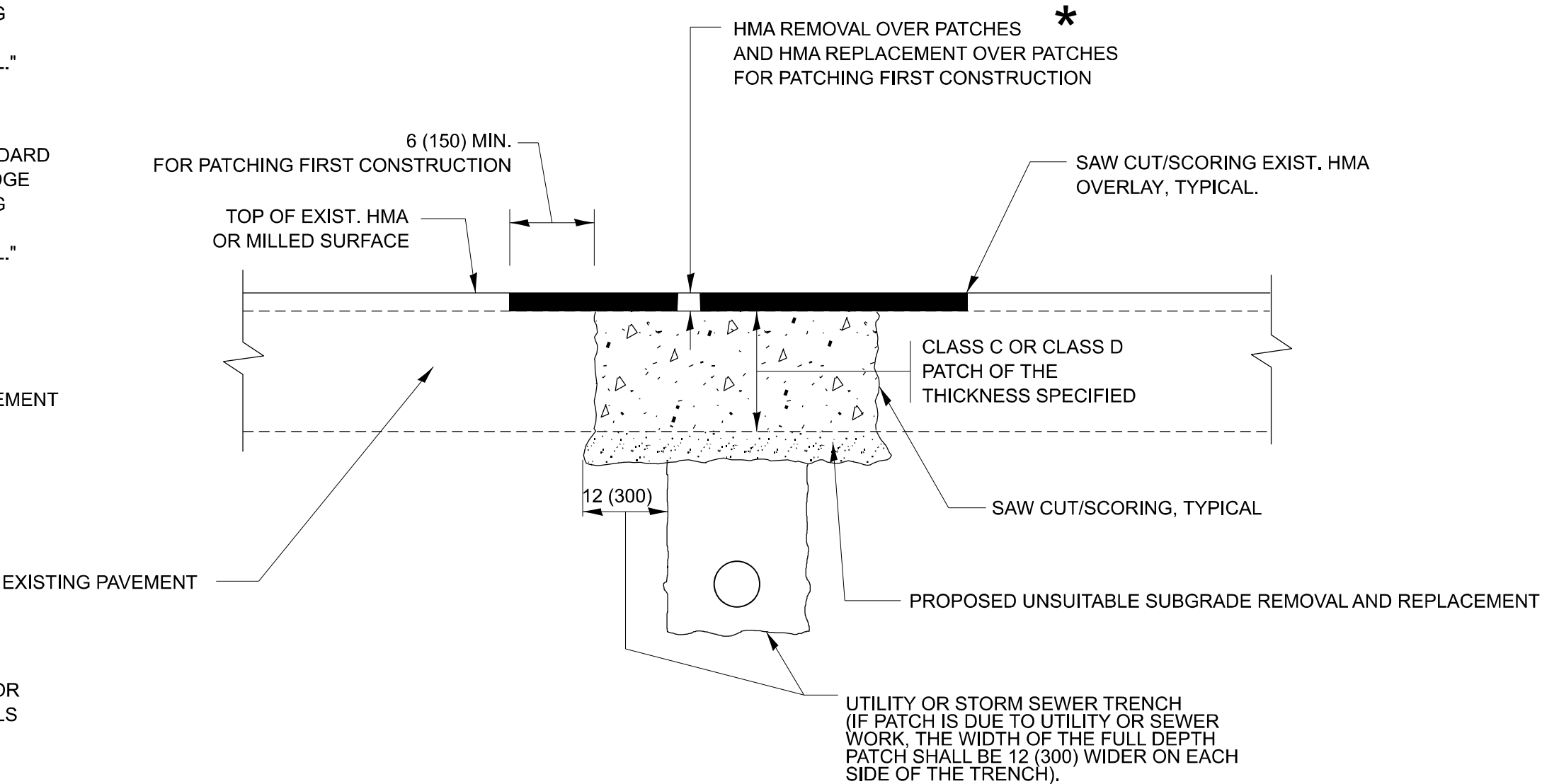

SEQUENCE OF CONSTRUCTION (PATCHING FIRST)

- 1. REMOVE THE EXISTING HMA MATERIAL OVER THE AREA TO BE PATCHED.
- 2. REMOVE AND REPLACE WITH CLASS C OR D PATCH.
- 3. REPLACE HMA MATERIAL OVER THE AREA TO BE PATCHED.

SEQUENCE OF CONSTRUCTION (MILLING FIRST)

- 1. MILL HMA FIRST IF THERE IS AT LEAST 4 1/2 INCHES OR MORE OF HMA MATERIAL ON TOP OF THE EXISTING PAVEMENT OR IF THE PAVEMENT IS FULL DEPTH HMA. A MINIMUM OF 2 INCHES OF HMA MATERIAL SHALL BE IN PLACE AFTER MILLING.
- 2. REMOVE AND REPLACE WITH FULL DEPTH CLASS D PATCHES TO TOP OF MILLED SURFACE.

ALL DIMENSIONS ARE IN INCHES (MILLIMETERS) UNLESS OTHERWISE SHOWN.

MODEL: BD-22 (Sheet)
FILE NAME: c:\pav_work\pav\mitcholas.babul\036982\0107825-sh-DistShts.dgn

	USER NAME = nicholas.babul	DESIGNED - R. SHAH	REVISED - R. BORO 01-01-07	STATE OF ILLINOIS DEPARTMENT OF TRANSPORTATION	PAVEMENT PATCHING FOR HMA SURFACED PAVEMENT				F.A.U RTE.	SECTION	COUNTY	TOTAL SHEETS	SHEET NO.
		DRAWN -	REVISED - R. BORO 09-04-07						3596	2024-1048-RS	COOK	23	15
		CHECKED -	REVISED - K. ENG 10-27-08						BD400-04 (BD-22) CONTRACT NO. 62X87				
	PLOT DATE = 6/17/2025	DATE - 10-25-94	REVISED - K. SMITH 11-18-22		ILLINOIS FED. AID PROJECT								
						SCALE: NONE	SHEET 1	OF 1	SHEETS	STA.	TO STA.		

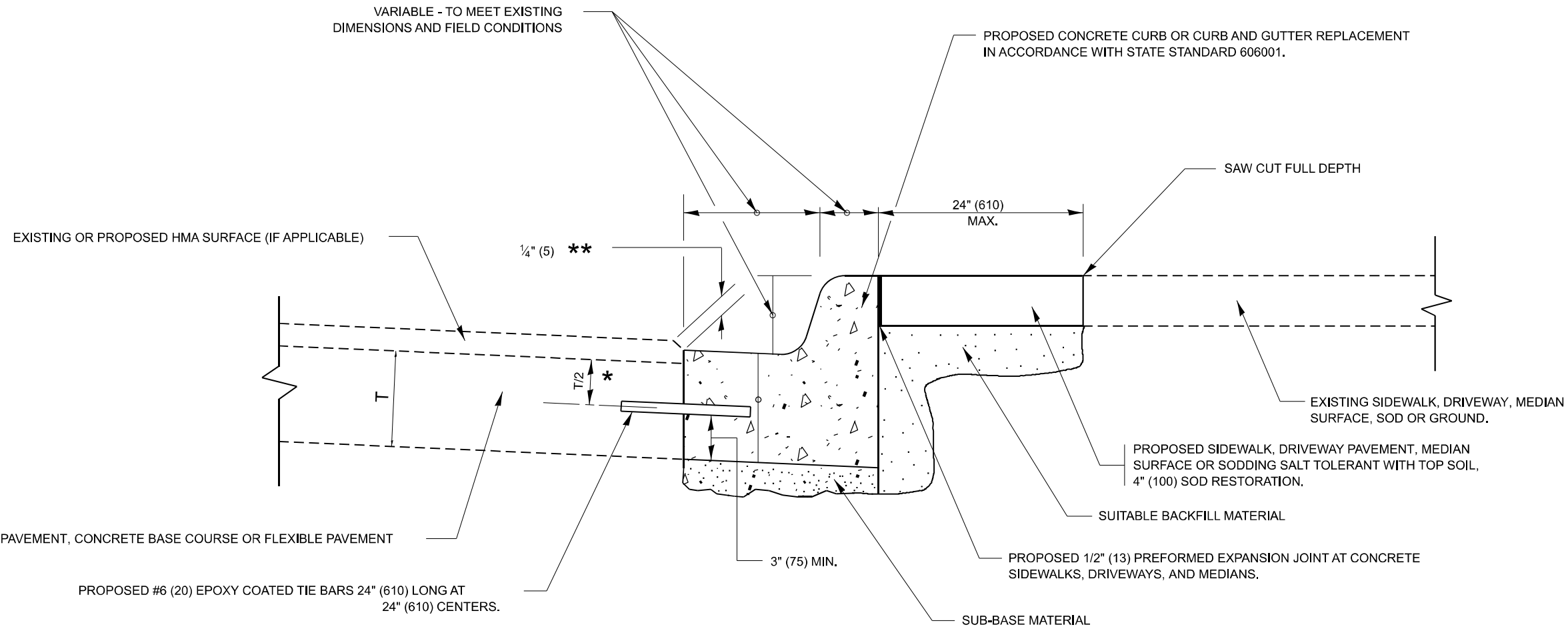

* 3" (75) MINIMUM FROM TOP AND BOTTOM OF THE CONCRETE PAVEMENT OR BASE COURSE.

** IF THE FINAL SURFACE OF THE PAVEMENT IS CONCRETE, THE GUTTER IS TO BE FLUSH WITH THE PAVEMENT.

CURB OR CURB AND GUTTER REMOVAL AND REPLACEMENT

ALL DIMENSIONS ARE IN INCHES (MILLIMETERS)
UNLESS OTHERWISE SHOWN.

MODEL: BD-24 [Sheet]
FILE NAME: c:\pawork\jw\dwg\bd\bd24\bd24-01.dwg

	USER NAME = nicholas.babul	DESIGNED - A. HOUSEH	REVISED - A. ABBAS 03-21-97	STATE OF ILLINOIS DEPARTMENT OF TRANSPORTATION	CURB OR CURB AND GUTTER REMOVAL AND REPLACEMENT			F.A.U RTE.	SECTION	COUNTY	TOTAL SHEETS	SHEET NO.
		DRAWN -	REVISED - M. GOMEZ 01-22-01					3596	2024-1048-RS	COOK	23	16
		CHECKED -	REVISED - R. BORO 12-15-09		BD600-06 (BD-24)			CONTRACT NO. 62X87				
	PLOT DATE = 6/17/2025	DATE - 03-11-94	REVISED - K. SMITH 07-11-19		SCALE: NONE	SHEET 1	OF 1 SHEETS	STA.	TO STA.	ILLINOIS FED. AID PROJECT		

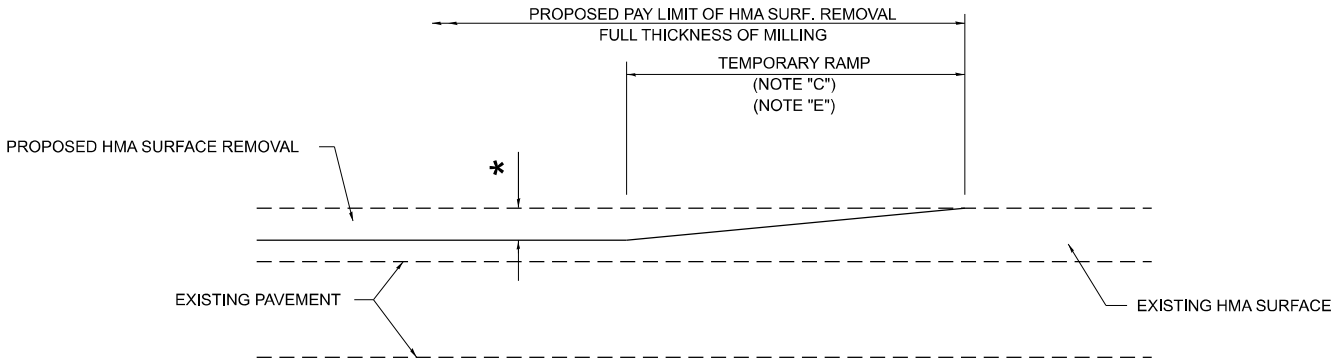

MILLED TEMPORARY RAMP
(FOR BUTT JOINT AND HMA TAPER SEE DETAIL BELOW)

OPTION 1

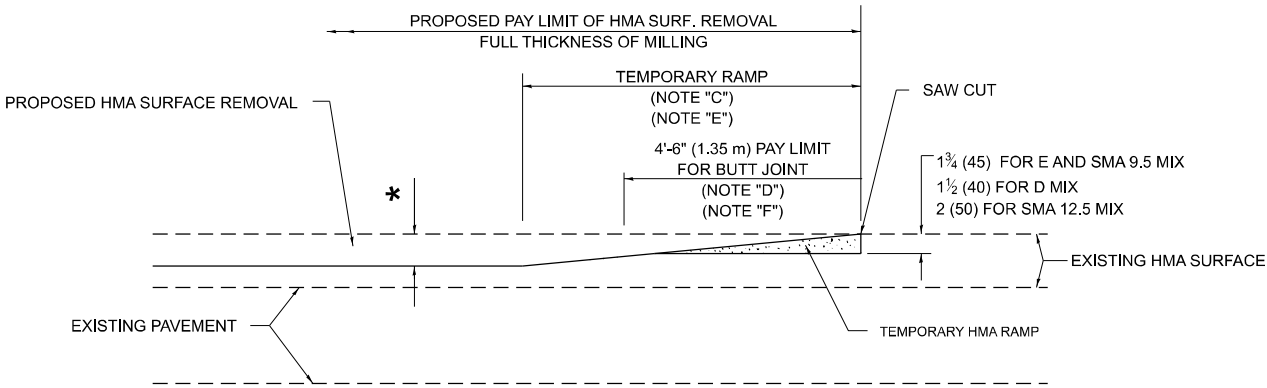

HMA CONSTRUCTED TEMPORARY RAMP
(FOR BUTT JOINT AND HMA TAPER SEE DETAIL BELOW)

OPTION 2

TYPICAL TEMPORARY RAMP

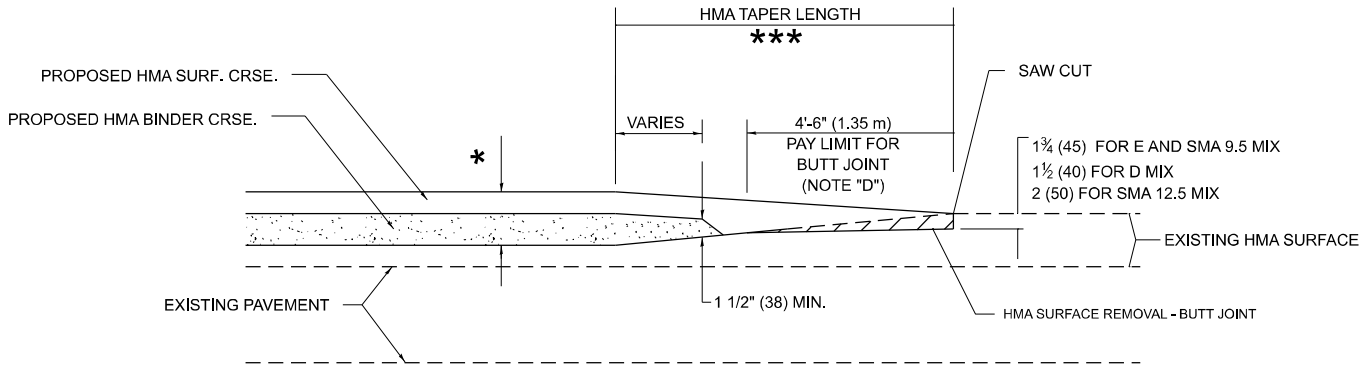

BUTT JOINT AND
HMA TAPER

TYPICAL BUTT JOINT AND HMA TAPER
FOR MILLING AND RESURFACING

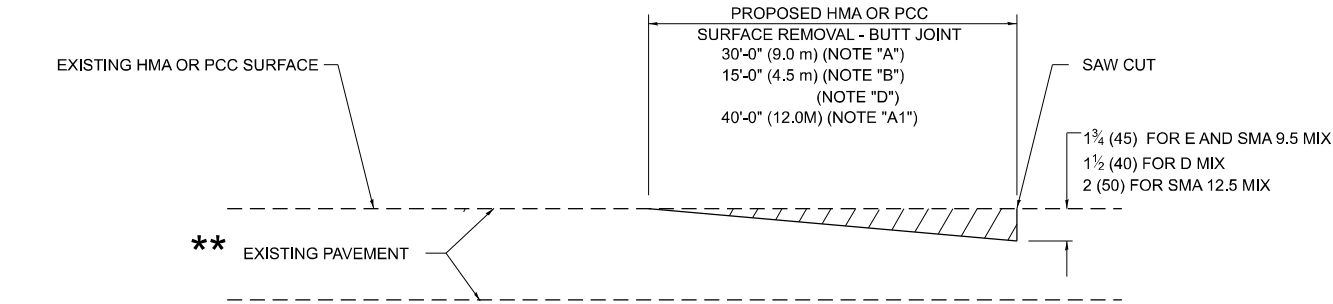

BUTT JOINT DETAIL

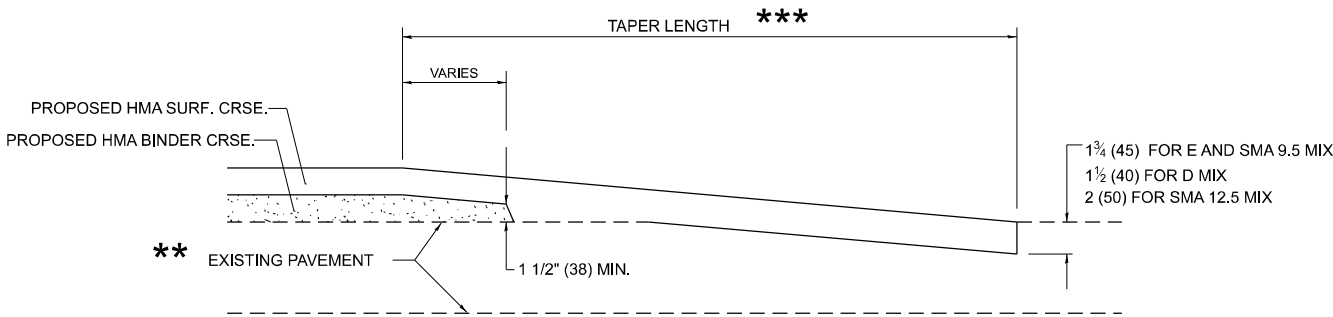

HMA TAPER DETAIL

TYPICAL BUTT JOINT AND HMA TAPER
FOR RESURFACING ONLY

** PC CONCRETE, HMA OR HMA RESURFACED PAVEMENT.

GENERAL NOTES

- A. MAINLINE ARTERIAL ROADWAYS AND MAJOR SIDE ROADS.
- A1. INTERSTATES
- B. MINOR SIDE ROADS.
- C. THE TEMP. RAMP SHALL BE CONSTRUCTED IMMEDIATELY UPON REMOVAL OF THE EXISTING HMA SURFACE.
- D. THE BUTT JOINT SHALL BE CONSTRUCTED IMMEDIATELY PRIOR TO PLACING THE PROPOSED HMA COURSES.
- E. TAPER THE TEMP. RAMP AT A RATE OF 3' - 4" (1.02m) PER 1 INCH (25 mm) OF MILLING THICKNESS.
* SEE TYPICAL SECTIONS FOR MILLING THICKNESS.
- F. SEE ARTICLE 406.08 AND 406.14 OF THE STANDARD SPECIFICATIONS FOR "HMA AND/OR PCC SURFACE REMOVAL, BUTT JOINT".

20'-0" (6.1 m) PER 1 (25) RESURFACING (NOTE "A")
10'-0" (3.0 m) PER 1 (25) RESURFACING (NOTE "B")

BASIS OF PAYMENT

- 1. THE BUTT JOINT WILL BE PAID FOR AT THE CONTRACT UNIT PRICE PER SQUARE YARD (SQUARE METER) FOR "HOT-MIX ASPHALT SURFACE REMOVAL - BUTT JOINT" OR FOR "PORTLAND CEMENT CONCRETE SURFACE REMOVAL- BUTT JOINT".
- 2. THE TEMPORARY RAMP AND SAW CUT SHALL BE INCLUDED IN THE UNIT COST FOR HMA OR PCC SURFACE REMOVAL-BUTT JOINT.

ALL DIMENSIONS ARE IN INCHES (MILLIMETERS) UNLESS OTHERWISE SHOWN.

MODEL: BD-32 [Sheet]
FILE NAME: c:\pav_work\pav\mitcholas.babul\Illinois.gov\1036982\107825-sh-Ds\Sds.dgn

PLOT DATE = 6/17/2025	USER NAME = nicholas.babul	DESIGNED - M. DE YONG	REVISED - A. ABBAS 03-21-97
		DRAWN -	REVISED - M. GOMEZ 04-06-01
		CHECKED -	REVISED - R. BORO 01-01-07
		DATE - 06-13-90	REVISED - K. SMITH 11-18-22

STATE OF ILLINOIS
DEPARTMENT OF TRANSPORTATION

BUTT JOINT AND
HMA TAPER DETAILS

SCALE: NONE SHEET 1 OF 1 SHEETS STA. TO STA.

F.A.U RTE.	SECTION	COUNTY	TOTAL SHEETS	SHEET NO.
3596	2024-1048-RS	COOK	23	17
BD400-05 BD-32		CONTRACT NO. 62X87		
ILLINOIS		FED. AID PROJECT		

MODEL: TC-10 (Sheet)
FILE NAME: c:\p\work\pwtol\nicholas.babul\Illinois.gov\1036982\107825-eh-Dts\Sds.dgn

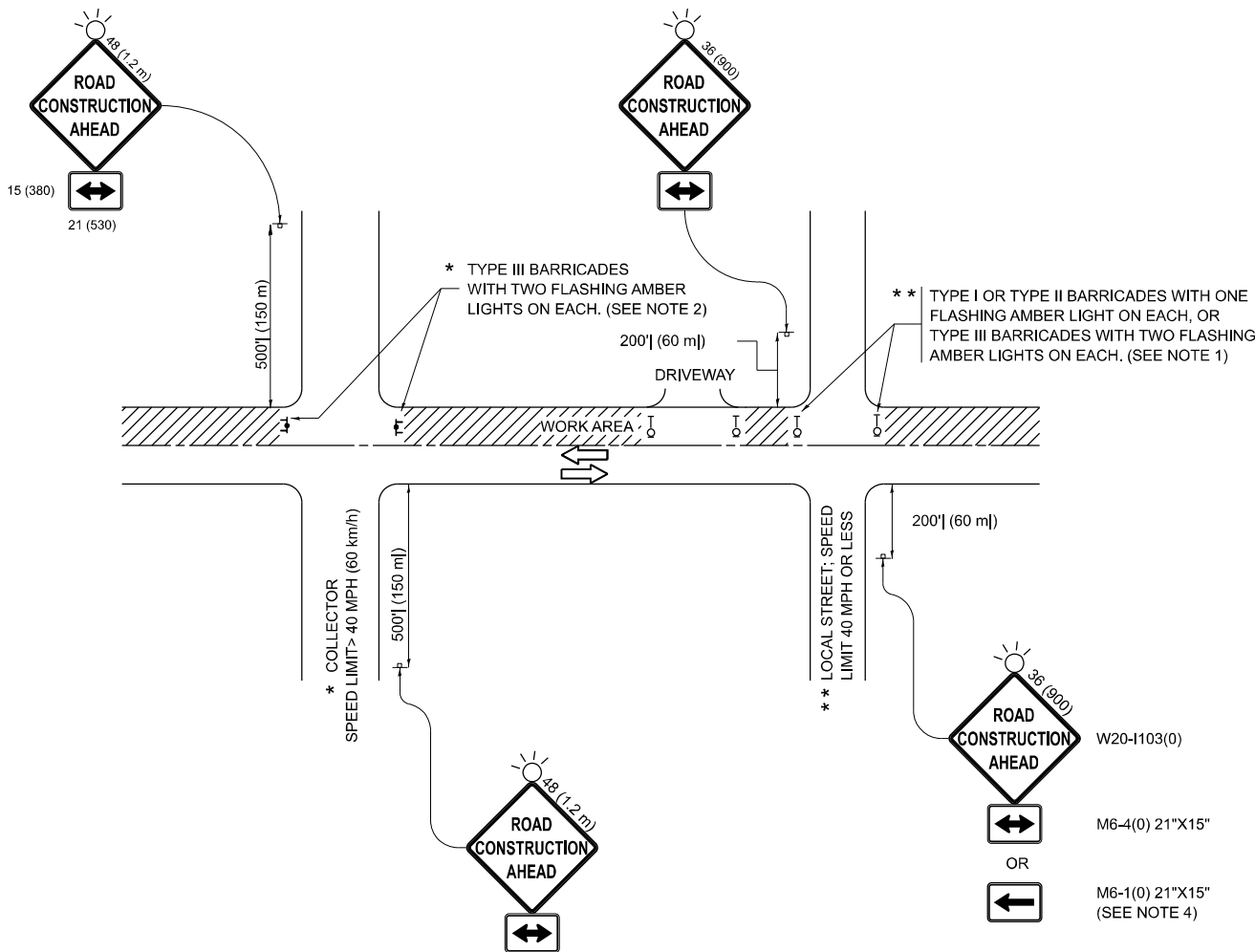

NOTES:

- SIDE ROAD WITH A SPEED LIMIT OF 40 MPH (60 km/h) OR LESS AS SHOWN ON THE DRAWING AND AS DIRECTED BY THE ENGINEER:
 - ONE "ROAD CONSTRUCTION AHEAD" SIGN 36 x 36 (900x900) WITH A FLASHER MOUNTED ON IT APPROXIMATELY 200' (60 m) IN ADVANCE OF THE MAIN ROUTE.
 - THE CLOSED PORTION OF THE MAIN ROUTE SHALL BE PROTECTED BY BLOCKING WITH TYPE I, TYPE II OR TYPE III BARRICADES, 1/3 OF THE CROSS SECTION OF THE CLOSED PORTION.
- SIDE ROAD WITH A SPEED LIMIT GREATER THAN 40 MPH (60 km/h) AS SHOWN ON THE DRAWING AND AS DIRECTED BY THE ENGINEER:
 - ONE "ROAD CONSTRUCTION AHEAD" SIGN 48 x 48 (1.2 m x 1.2 m) WITH A FLASHER MOUNTED ON IT APPROXIMATELY 500' (150 m) IN ADVANCE OF THE MAIN ROUTE.
 - THE CLOSED PORTION OF THE MAIN ROUTE SHALL BE PROTECTED BY BLOCKING WITH TYPE III BARRICADES, 1/2 OF THE CROSS SECTION OF THE CLOSED PORTION.
- CONES MAY BE SUBSTITUTED FOR BARRICADES OR DRUMS AT HALF THE SPACING DURING DAY OPERATIONS. CONES SHALL BE A MINIMUM OF 28 (710) IN HEIGHT.
- WHEN THE SIDE ROAD LIES BETWEEN THE BEGINNING OF THE MAINLINE SIGNING AND THE WORK ZONE, A SINGLE HEADED ARROW (M6-1) SHALL BE USED IN LIEU OF THE DOUBLE HEADED ARROW (M6-4).
- WHEN WORK IS BEING PERFORMED ON A SIDE ROAD OR DRIVEWAY, FOLLOW THE APPLICABLE STANDARD(S). THE DIRECTIONAL ARROW (M6-1 OR M6-4) SHALL BE COVERED OR REMOVED WHEN NO LONGER CONSISTENT WITH THE TRAFFIC CONTROL SET-UP.
- ADVANCE WARNING SIGNS ARE TO BE OMITTED ON DRIVEWAYS UNLESS OTHERWISE SPECIFIED IN THE PLANS OR BY THE ENGINEER.
- THE TRAFFIC CONTROL AND PROTECTION FOR SIDE ROADS, INTERSECTIONS, AND DRIVEWAYS SHALL BE INCLUDED IN THE COST OF SPECIFIED TRAFFIC CONTROL STANDARDS OR ITEMS.

All dimensions are in inches (millimeters)
unless otherwise shown.

	USER NAME = nicholas.babul	DESIGNED - L.H.A.	REVISED - T. RAMMACHER 01-06-00	STATE OF ILLINOIS DEPARTMENT OF TRANSPORTATION	TRAFFIC CONTROL AND PROTECTION FOR SIDE ROADS, INTERSECTIONS, AND DRIVEWAYS	F.A.U RTE.									
		DRAWN -	REVISED - A. SCHUETZE 07-01-13			SECTION									
		CHECKED -	REVISED - A. SCHUETZE 09-15-06			COUNTY									
	PLOT DATE = 6/17/2025	DATE - 06-89	REVISED - D. SENDERAK 05-03-24			TOTAL SHEETS									
						3596	2024-1048-RS		COOK	23	18	SHEET NO.			
						TC-10						CONTRACT NO. 62X87			
						SCALE:	SHEET	OF	SHEETS	STA.	TO STA.	ILLINOIS FED. AID PROJECT			

MODEL: TC-11 [Sheet]
FILE NAME: c:\p\work\pwt\nicholas.babul\illinois.gov\1036982\107825-sh-01s\107825-sh-01s.dgn

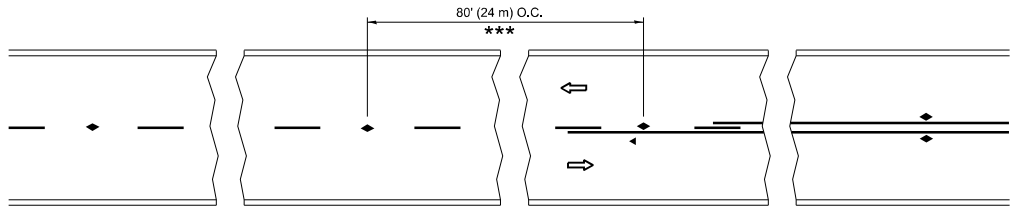

*** REDUCE TO 40' (12 m) O.C. ON CURVES WITH POSTED OR ADVISORY SPEED 45 M.P.H. (70 km/h) OR LESS.

TWO-LANE/TWO-WAY

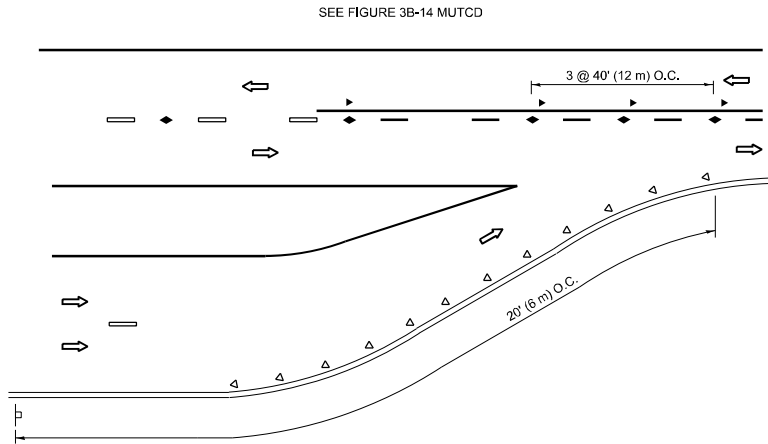

LANE REDUCTION TRANSITION

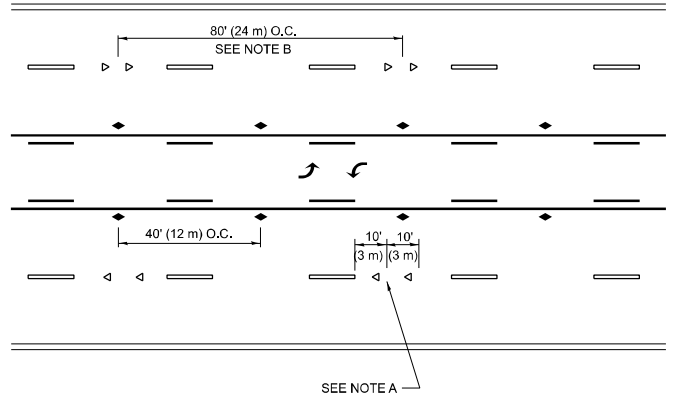

SEE NOTE A

TWO-WAY LEFT TURN

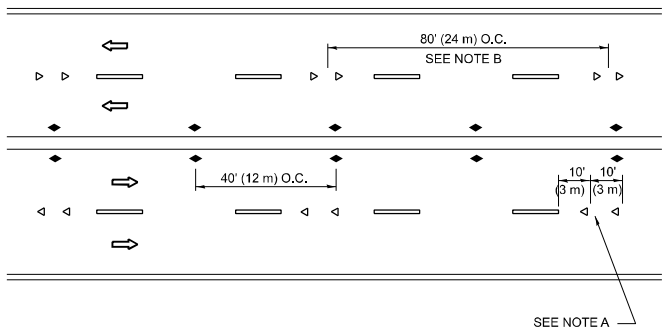

SEE NOTE A

MULTI-LANE/UNDIVIDED

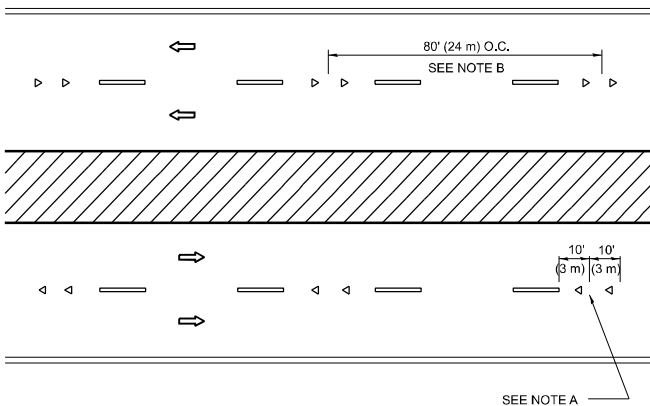

SEE NOTE A

MULTI-LANE/DIVIDED

GENERAL NOTES

- MARKERS USED WITH DASHED LINES SHALL BE CENTERED IN THE GAP BETWEEN SEGMENTS.
- MARKERS USED ADJACENT TO SOLID LINES SHALL BE OFFSET 2 TO 3 (50 TO 75) TOWARD TRAFFIC AS SHOWN.
- MARKERS THROUGH TANGENTS LESS THAN 500' (150 m) IN LENGTH BETWEEN CURVES SHALL BE INSTALLED AT THE LESSER OF THE TWO CURVE SPACINGS.
- MARKERS ARE TO BE USED ADJACENT TO BOTH SOLID WHITE LINES IN DUAL LEFT TURN LANES

SYMBOLS

- YELLOW STRIPE
- WHITE STRIPE
- ONE-WAY AMBER MARKER
- ONE-WAY CRYSTAL MARKER (W/O)
- TWO-WAY AMBER MARKER

LANE MARKER NOTES

- USE DOUBLE LANE LINE MARKERS SPACED AS SHOWN.
- REDUCE TO 40' (12 m) O.C. ON CURVES WHERE ADVISORY SPEEDS ARE 10 M.P.H (20 km/h) LOWER THAN POSTED SPEEDS.

DESIGN NOTES

- DOUBLE LANE LINE MARKERS SHALL BE USED UNLESS SPECIFIED OTHERWISE.
- EXCEPT AS SHOWN ON THE LANE REDUCTION TRANSITION AND FREEWAY EXIT RAMP DETAIL, MARKERS ARE NOT TO BE SPECIFIED ON RIGHT EDGE LINES.
- THE EXACT MARKER LIMITS, SPACING, AND COLOR SHALL BE INCLUDED IN THE PLANS WHEN STANDARD SPECIFICATIONS ARE NOT BEING USED.
- MARKERS SHOULD NOT BE USED ALONGSIDE CURBS EXCEPT FOR EXTREMELY SHORT SECTIONS OF CURBS WHERE NOT MORE THAN TWO MARKERS WOULD BE INVOLVED.

All dimensions are in inches (millimeters) unless otherwise shown.

USER NAME	= nicholas.babul	DESIGNED	-	REVISED	- T. RAMMACHER 03-12-99
		DRAWN	-	REVISED	- T. RAMMACHER 01-06-00
		CHECKED	-	REVISED	- C. JUCIUS 09-09-09
PLOT DATE	= 6/17/2025	DATE	-	REVISED	- C. JUCIUS 07-01-13

STATE OF ILLINOIS
DEPARTMENT OF TRANSPORTATION

TYPICAL APPLICATIONS
RAISED REFLECTIVE PAVEMENT MARKERS (SNOW-PLOW RESISTANT)

SCALE: NONE SHEET 1 OF 1 SHEETS STA. TO STA.

F.A.U RTE.	SECTION	COUNTY	TOTAL SHEETS	SHEET NO.
3596	2024-1048-RS	COOK	23	19
TC-11		CONTRACT NO. 62X87		
ILLINOIS		FED. AID PROJECT		

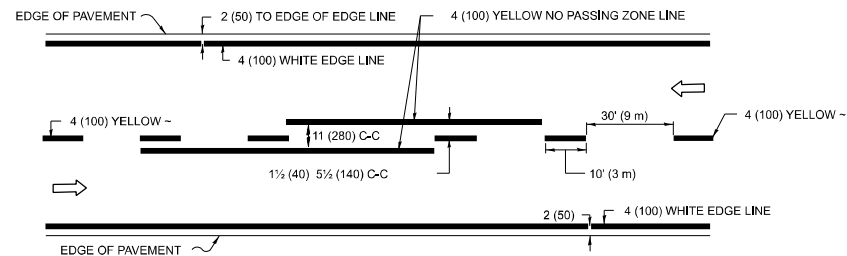

2-LANE ROADWAY

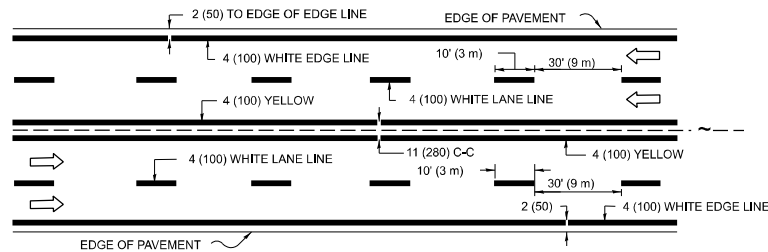

MULTI-LANE UNDIVIDED

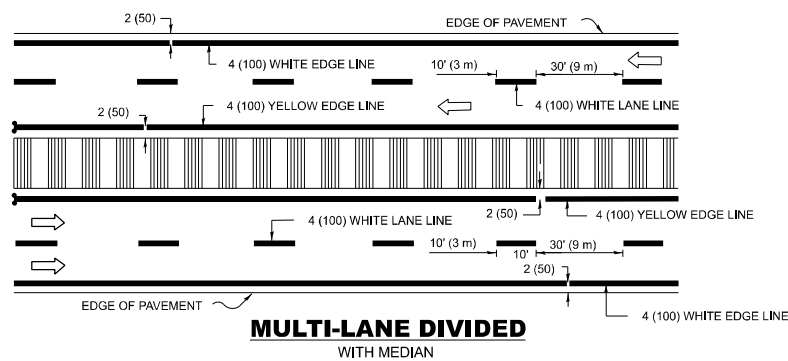

TYPICAL LANE AND EDGE LINE MARKING

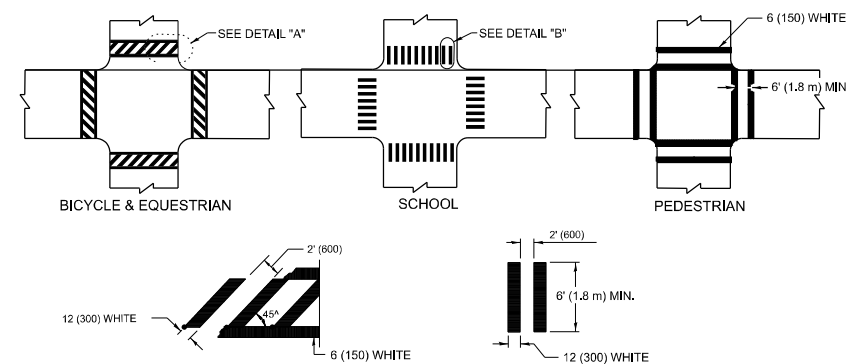

DETAIL "A"

DETAIL "B"

TYPICAL CROSSWALK MARKING

* MARKINGS SHALL BE INSTALLED PARALLEL TO THE CENTERLINE OF THE ROAD WHICH IT CROSSES

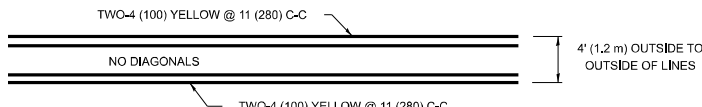

4' (1.2 m) WIDE MEDIANS ONLY

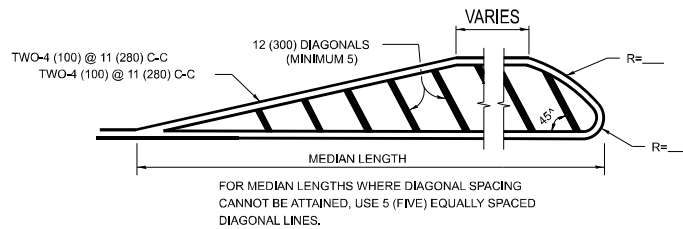

DIAGONAL LINE SPACING: 50' (15 m) C-C (LESS THAN 30MPH (50 km/h))
75' (25 m) C-C 30MPH (50 km/h) TO 45MPH (70 km/h))
150' (45 m) C-C (MORE THAN 45MPH (70 km/h))

MEDIANS OVER 4' (1.2 m) WIDE

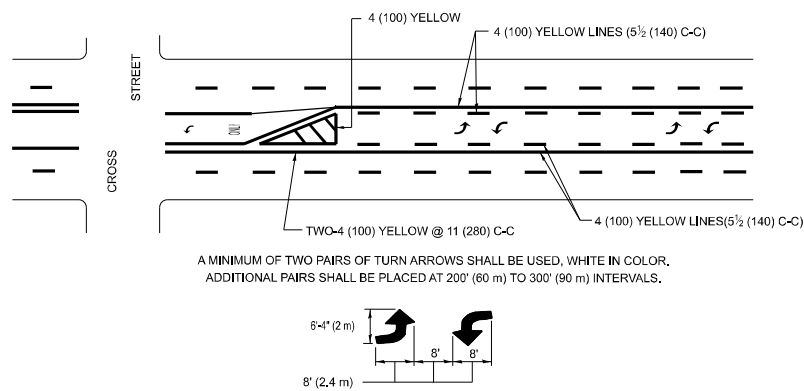

MEDIAN WITH TWO-WAY LEFT TURN LANE

TYPICAL PAINTED MEDIAN MARKING

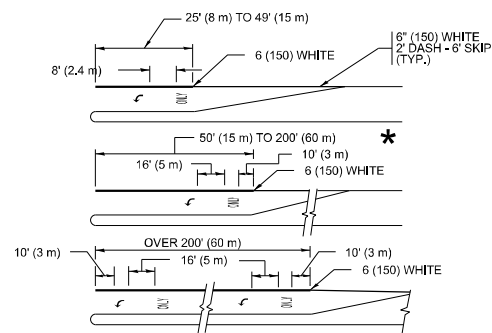

FULL SIZE LETTERS 8" (2.4 m) AND ARROWS SHALL BE USED.

* TURN LANES IN EXCESS OF 400' (120 m) IN LENGTH MAY HAVE AN ADDITIONAL SET OF ARROW - "ONLY" INSTALLED MIDWAY BETWEEN THE OTHER TWO SETS OF ARROW - "ONLY".

TYPICAL LEFT (OR RIGHT) TURN LANE

TYPICAL TURN LANE MARKING

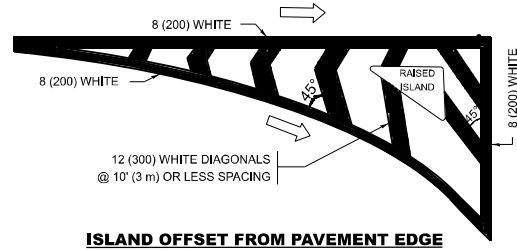

ISLAND OFFSET FROM PAVEMENT EDGE

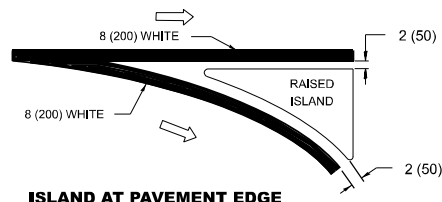

ISLAND AT PAVEMENT EDGE

20 (5) TYPICAL ISLAND MARKING

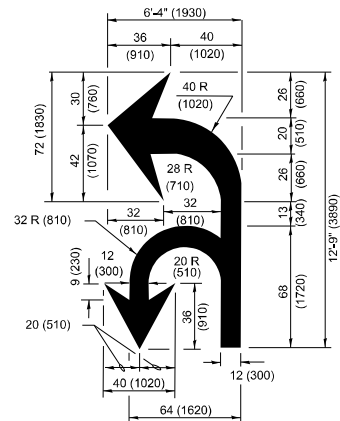

COMBINATION **LEFT AND U-TURN**

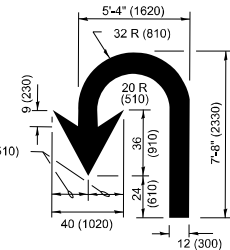

U-TURN

LANE REDUCTION TRANSITION

* LANE REDUCTION ARROWS REQUIRED AT SPEEDS OF 45 MPH OR GREATER OR WHEN SPECIFIED IN PLANS.

D(FT)	SPEED LIMIT
345	30
425	35
500	40
580	45
665	50
750	55

TYPE OF MARKING	WIDTH OF LINE	PATTERN	COLOR	SPACING / REMARKS
CENTERLINE ON 2 LANE PAVEMENT	4 (100)	SKIP-DASH	YELLOW	10' (3 m) LINE WITH 30' (9 m) SPACE
CENTERLINE ON MULTI-LANE UNDIVIDED PAVEMENT	2 @ 4 (100)	SOLID	YELLOW	11 (280) C-C
NO PASSING ZONE LINES: FOR ONE DIRECTION FOR BOTH DIRECTIONS	4 (100) 2 @ 4 (100)	SOLID SOLID	YELLOW YELLOW	5½ (140) C-C FROM SKIP-DASH CENTERLINE 11 (280) C-C OMIT SKIP-DASH CENTERLINE BETWEEN
LANE LINES	4 (100) 5 (125) ON FREEWAYS	SKIP-DASH SKIP-DASH	WHITE WHITE	10' (3 m) LINE WITH 30' (9 m) SPACE
DOTTED LINES (EXTENSIONS OF CENTER, LANE OR TURN LANE MARKINGS)	SAME AS LINE BEING EXTENDED	SKIP-DASH	SAME AS LINE BEING EXTENDED	2' (600) LINE WITH 6' (1.8 m) SPACE
EDGE LINES	4 (100)	SOLID	YELLOW-LEFT WHITE-RIGHT	OUTLINE MEDIANS IN YELLOW
TURN LANE MARKINGS	6 (150) LINE: FULL SIZE LETTERS & SYMBOLS (8' (2.4m))	SOLID	WHITE	SEE TYPICAL TURN LANE MARKING DETAIL
TWO WAY LEFT TURN MARKING	2 @ 4 (100) EACH DIRECTION 8' (2.4m) LEFT ARROW	SKIP-DASH AND SOLID IN PAIRS	YELLOW WHITE	10' (3 m) LINE WITH 30' (9 m) SPACE FOR SKIP-DASH: 5½ (140) C-C BETWEEN SOLID LINE AND SKIP-DASH LINE SEE TYPICAL TWO-WAY LEFT TURN MARKING DETAIL
CROSSWALK LINES (PEDESTRIAN) A. DIAGONALS (BIKE & EQUESTRIAN) B. LONGITUDINAL BARS (SCHOOL)	2 @ 6 (150) 12 (300) @ 45° 12 (300) @ 90°	SOLID SOLID SOLID	WHITE WHITE WHITE	NOT LESS THAN 6' (1.8 m) APART 2' (600) APART 2' (600) APART SEE TYPICAL CROSSWALK MARKING DETAILS.
STOP LINES	24 (600)	SOLID	WHITE	PLACE 4' (1.2 m) IN ADVANCE OF AND PARALLEL TO CROSSWALK, IF PRESENT. OTHERWISE, PLACE AT DESIRED STOPPING POINT, PARALLEL TO CROSSROAD CENTERLINE, WHERE POSSIBLE
PAINTED MEDIANS	2 @ 4 (100) WITH 12 (300) DIAGONALS @ 45° NO DIAGONALS USED FOR 4' (1.2 m) WIDE MEDIANS	SOLID	YELLOW; TWO WAY TRAFFIC WHITE: ONE WAY TRAFFIC	11 (280) C-C FOR THE DOUBLE LINE SEE TYPICAL PAINTED MEDIAN MARKING.
GORE MARKING AND CHANNELIZING LINES	8 (200) WITH 12 (300) DIAGONALS @ 45°	SOLID	WHITE	DIAGONALS: 15' (4.5 m) C-C (LESS THAN 30MPH (50 km/h)) 20' (6 m) C-C 30MPH (50 km/h) TO 45MPH (70 km/h)) 30' (9 m) C-C (OVER 45MPH (70 km/h))
RAILROAD CROSSING	24 (600) TRANSVERSE LINES; "RR" IS 6' (1.8 m) LETTERS; 16 (400) LINE FOR "X"	SOLID	WHITE	SEE STATE STANDARD 780001 AREA OF: "R"=3.8 SQ. FT. (0.33 m ²) EACH "X"=54.0 SQ. FT. (5.0 m ²)
SHOULDER DIAGONALS (REQUIRED FOR SHOULDERS ≥ 8')	12 (300) @ 45°	SOLID	WHITE - RIGHT YELLOW - LEFT	50' (15 m) C-C (LESS THAN 30MPH (50 km/h)) 75' (25 m) C-C (30 MPH (50 km/h) TO 45MPH (70 km/h)) 150' (45 m) C-C (OVER 45MPH (70 km/h))
U TURN ARROW	SEE DETAIL	SOLID	WHITE	16,3 SF
2 ARROW COMBINATION LEFT AND U TURN	SEE DETAIL	SOLID	WHITE	30,4 SF

FOR FURTHER DETAILS ON PAVEMENT MARKING REFER TO
STANDARD SPECIFICATIONS FOR ROAD AND BRIDGE
CONSTRUCTION AND STATE STANDARD 780001.

All dimensions are in inches (millimeters) unless otherwise shown.

USER NAME = nicholas.babul	DESIGNED = EVERS	REVISED = C. JUCIUS 09-09-09
	DRAWN =	REVISED = C. JUCIUS 07-01-13
	CHECKED =	REVISED = C. JUCIUS 12-21-15
PLOT DATE = 6/17/2025	DATE = 03-19-90	REVISED = C. JUCIUS 04-12-16

STATE OF ILLINOIS
DEPARTMENT OF TRANSPORTATION

<div style="text-align: center;"> DISTRICT ONE TYPICAL PAVEMENT MARKINGS </div>					F.A.U. RTE.	SECTION	COUNTY	TOTAL SHEETS	SHEET NO.
					3596	2024-1048-RS	COOK	23	20
					TC-13				
SCALE: NONE					SHEET 1 OF 1 SHEETS		STA. TO STA.		
					CONTRACT NO. 62X87				
					ILLINOIS		FED. AID PROJECT		

MODEL: TC-13 [Sheet]
FILE NAME: c:\pw work\pwidot\nicholas.babul@illinois.gov\d1036982\DI107825-sh1-DistStds.dgn

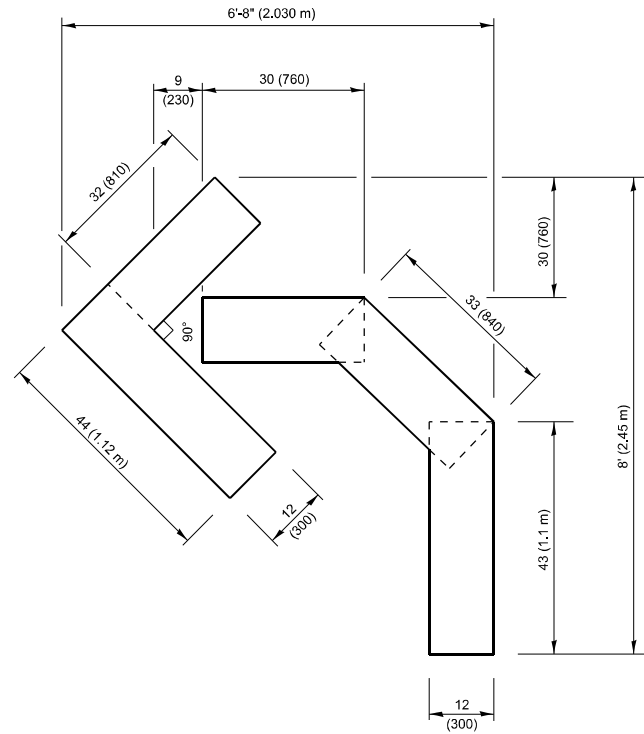

QUANTITY

4 (100) LINE = 45.5 ft. (13.9 m)
15.2 sq. ft. (1.41 sq. m)

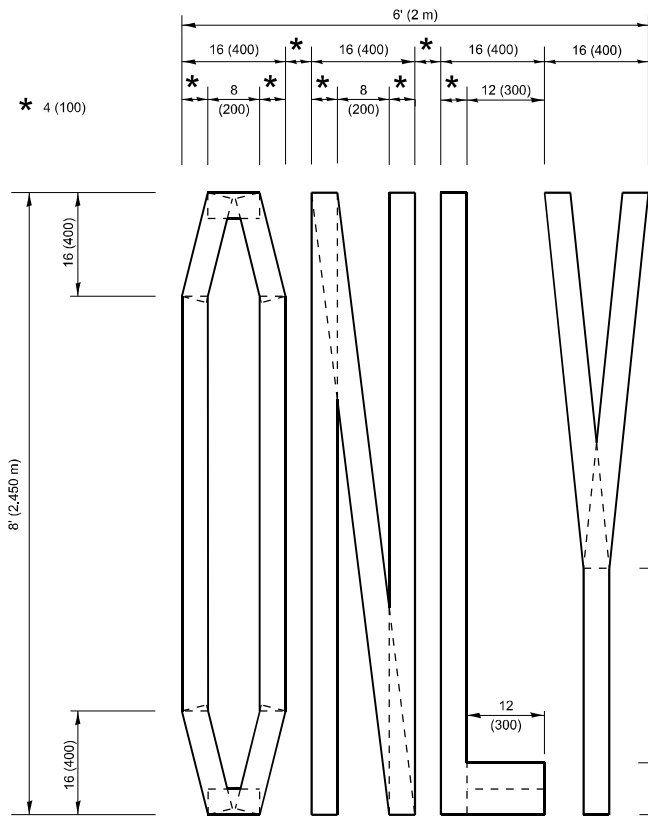

QUANTITY

4 (100) LINE = 64.1 ft. (19.5 m)
21.4 sq. ft. (1.99 sq. m)

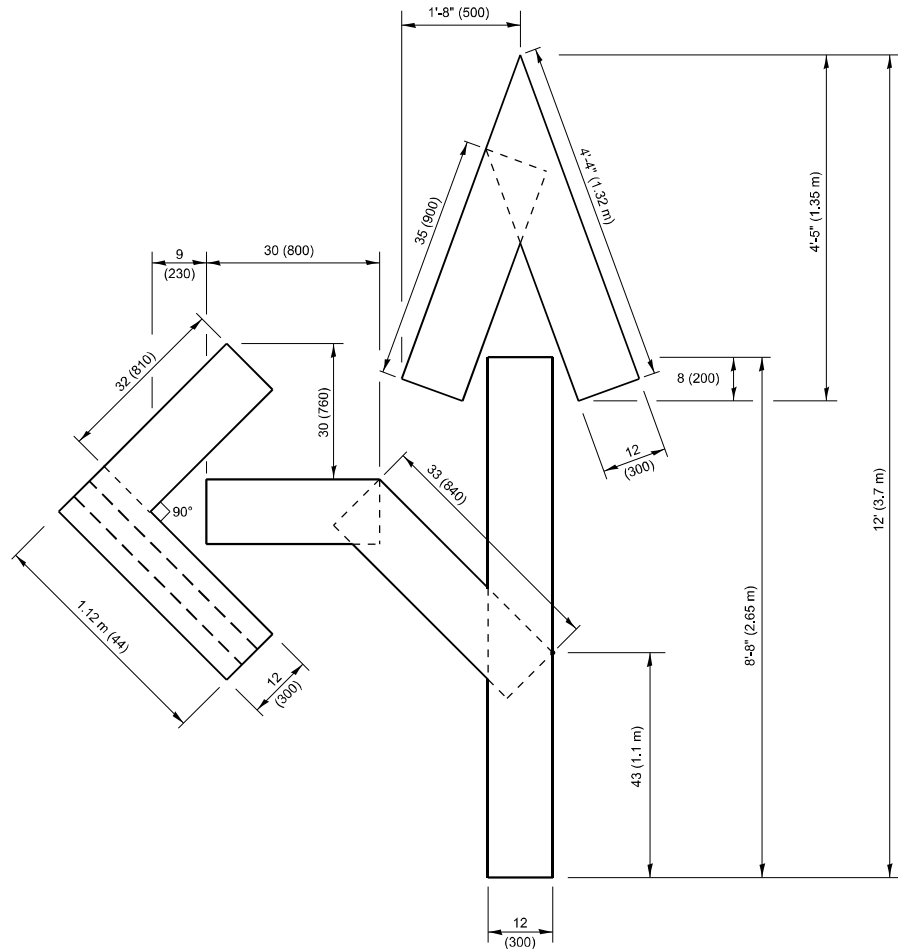

QUANTITY

4 (100) LINE = 82.5 ft. (25.1 m)
27.5 sq. ft. (2.53 sq. m)

NOTE:

ALL QUANTITIES OF PLACEMENT ARE REPRESENTED
IN LINEAR FEET OF 4" LINES TO MATCH THE
4" TEMPORARY TAPE PAY ITEM AND REPRESENTS
THE TOTAL QUANTITY OF 4" TAPE REQUIRED.

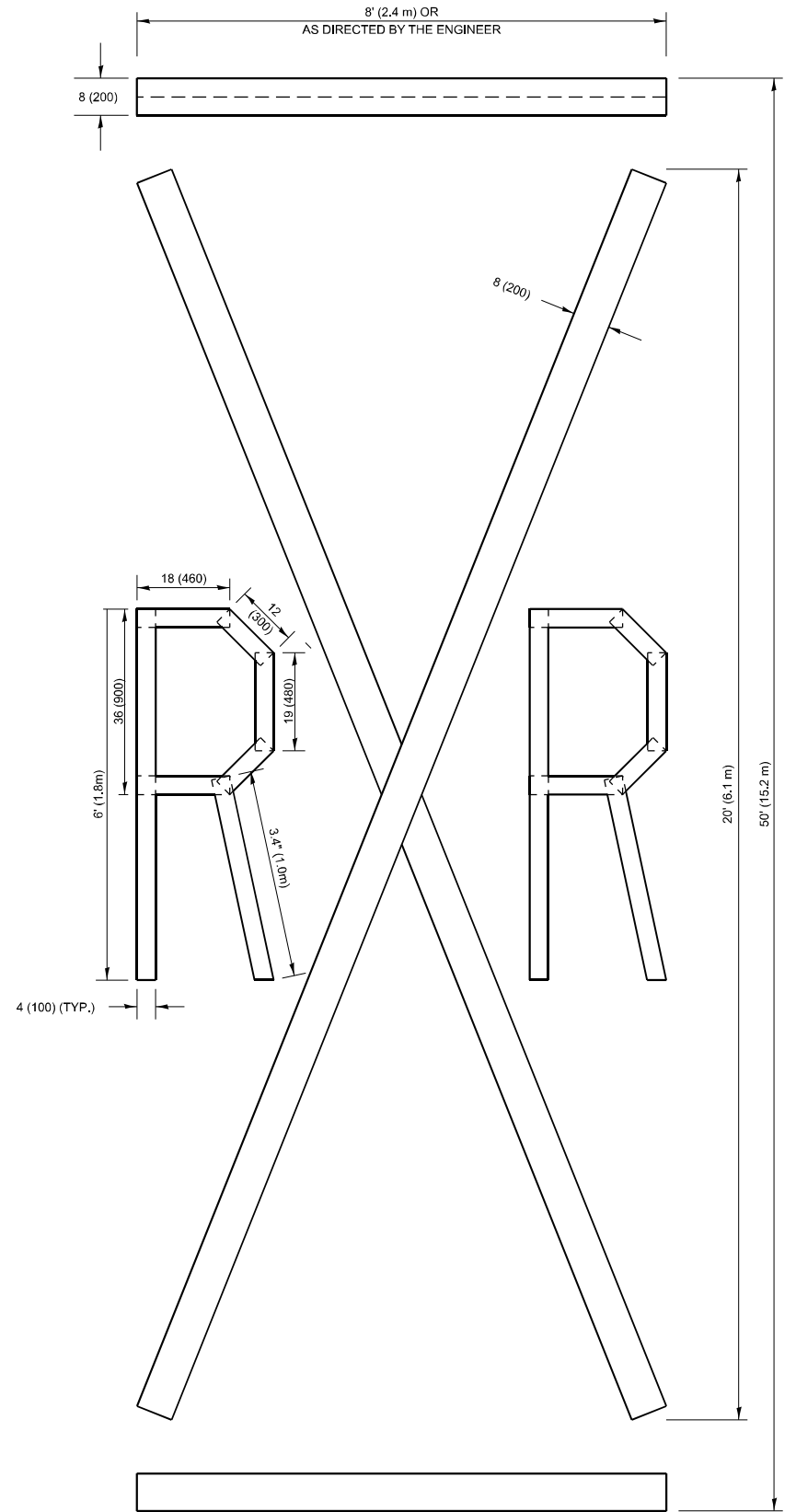

QUANTITY

4 (100) LINE = 225.9 ft. (68.9 m)
75.3 sq. ft. (6.99 sq. m)

All dimensions are in inches (millimeters)
unless otherwise shown.

MODEL: TC-16 (Sheet)
FILE NAME: c:\pav_work\wilson\nicholas.babul\illinois.gov\036982D\07825-eh-Dist\Sds.dgn

PLOT DATE = 6/17/2025	USER NAME = nicholas.babul	DESIGNED -	REVISED - T. RAMMACHER 03-02-98
		DRAWN -	REVISED - E. GOMEZ 08-28-00
		CHECKED -	REVISED - E. GOMEZ 08-28-00
	DATE - 09-18-94	REVISED - A. SCHUETZE 09-15-16	

STATE OF ILLINOIS
DEPARTMENT OF TRANSPORTATION

SHORT TERM PAVEMENT MARKING LETTERS AND SYMBOLS

SCALE: NONE SHEET 1 OF 1 SHEETS STA. TO STA.

F.A.U RTE.	SECTION	COUNTY	TOTAL SHEETS	SHEET NO.
3596	2024-1048-RS	COOK	23	21
TC-16		CONTRACT NO. 62X87		
		ILLINOIS	FED. AID PROJECT	

PARTIAL RAMP CLOSURE DETAILS

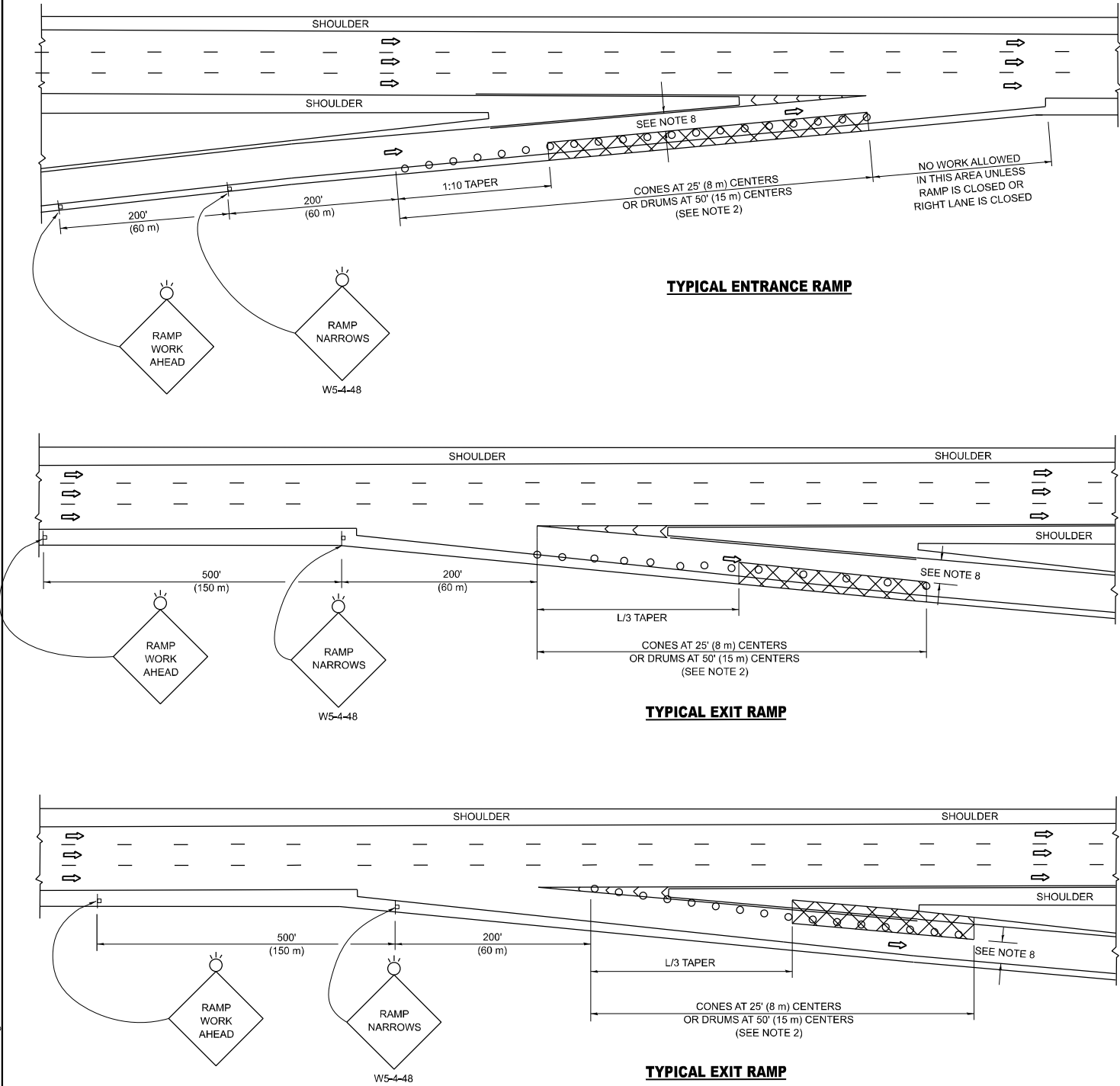

SYMBOLS

- ACTIVE WORK AREA
- SIGN ON PORTABLE OR PERMANENT SUPPORT
- FLAGGER WITH CONTROL SIGN
- TYPE II BARRICADE OR DRUM
- CONE, DRUM OR BARRICADE
- IMPACT ATTENUATOR OF TYPE AND TEST LEVEL SPECIFIED

GENERAL NOTES:

- THE "L" DISTANCE EQUALS:
SPEED LIMIT FORMULAS
45 mph (80 km/h) METRIC ENGLISH
OR GREATER: $L=0.65(W)(S)$ $L=(W)(S)$
W = WIDTH OF OFFSET IN FEET (METERS)
S = NORMAL POSTED SPEED MPH (KM/H)
- TYPE II BARRICADES OR DRUMS ARE REQUIRED FOR ALL NIGHTTIME CLOSURES. TYPE II BARRICADES OR DRUMS WITH MONODIRECTIONAL STEADY BURN LIGHTS ARE REQUIRED FOR DELINEATING OBSTACLES, EXCAVATIONS, OR HAZARDS EXCEEDING 100 FT (30m) IN LENGTH AT NIGHT.
- ALL SIGNS SHALL BE POST MOUNTED IF THE CLOSURE TIME EXCEEDS FOUR DAYS.
- FLASHING LIGHTS SHALL BE USED DURING THE HOURS OF DARKNESS AND SHALL BE INSTALLED ABOVE THE FIRST TWO SETS OF SIGNS.

SHOULDER CLOSURE DETAILS

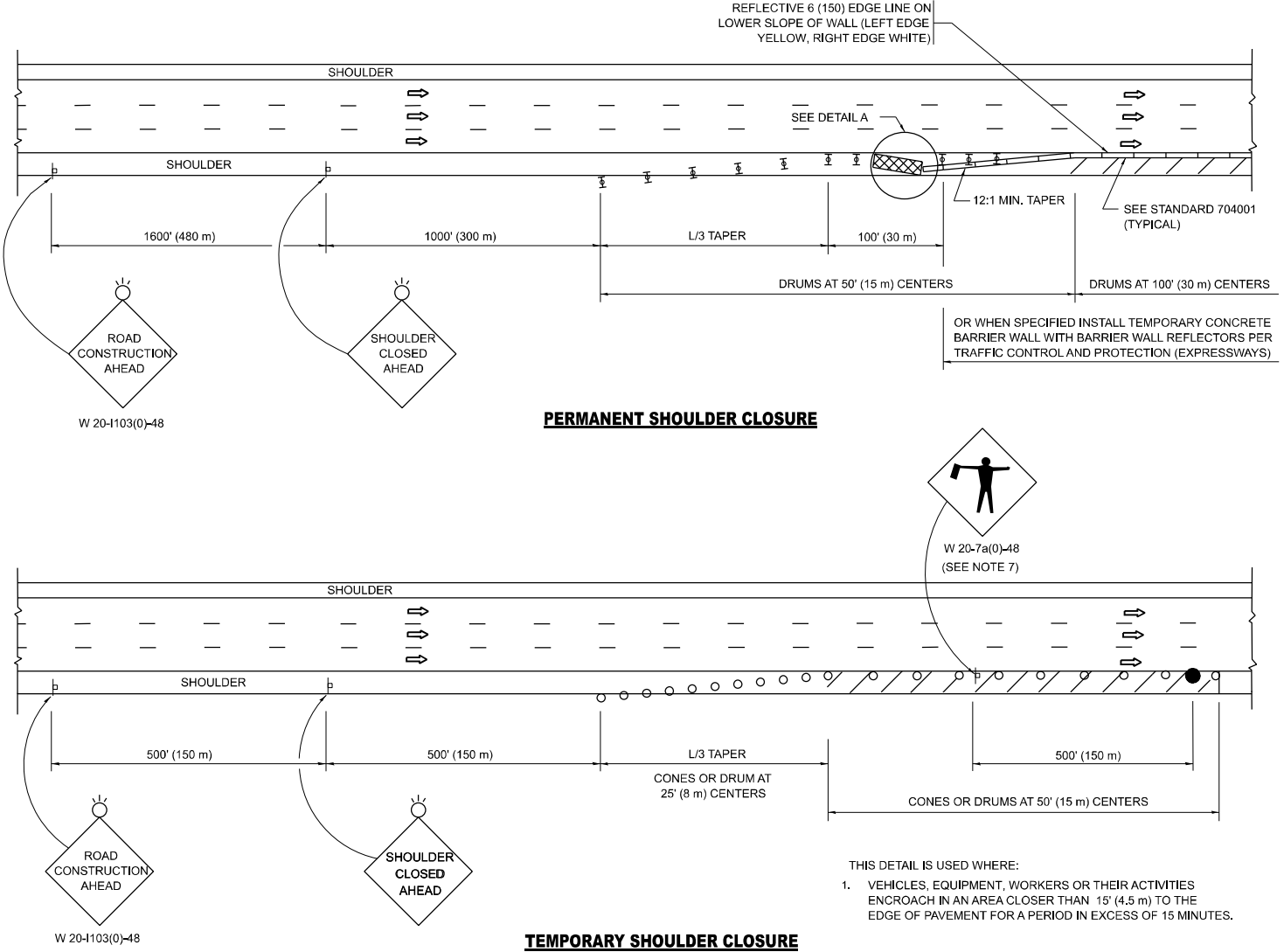

PERMANENT SHOULDER CLOSURE

TEMPORARY SHOULDER CLOSURE

- THIS DETAIL IS USED WHERE:
- VEHICLES, EQUIPMENT, WORKERS OR THEIR ACTIVITIES ENCR OACH IN AN AREA CLOSER THAN 15' (4.5 m) TO THE EDGE OF PAVEMENT FOR A PERIOD IN EXCESS OF 15 MINUTES.



DETAIL "A"
IMPACT ATTENUATOR, TEMPORARY
(SEE NOTE 5)

- THE IMPACT ATTENUATOR, TEMPORARY IS NOT REQUIRED WHEN THE TEMPORARY CONCRETE BARRIER WALL IS PROTECTED BY OR IS TIED INTO THE EXISTING GUARDRAIL. IF OFFSET IS LESS THAN 5 FEET USE NARROW USE TYPE DEVICE TO MEET NCHRP350/MASH.
- AUTHORIZATION FROM THE DISTRICT'S BUREAU OF TRAFFIC IS REQUIRED FOR ALL FREEWAY CLOSURES.
- THE FLAGGER AND FLAGGER SIGN ARE REQUIRED AT THE ABOVE WORK SITES WHEN:
a. FOUR OR MORE WORK VEHICLES ENTER THE TRAFFIC LANES IN A ONE HOUR PERIOD.
b. THE WORK ACTIVITY REQUIRES FREQUENT ENCROACHMENT INTO THE LANE OPEN TO TRAFFIC.
THE FLAGGER SHALL BE STATIONED APPROXIMATELY 100' (30 m) TO 200' (60 m) IN ADVANCE OF THE WORKERS.
- 12' MIN. WIDTH TANGENT SECTION
16' MIN. WIDTH CURVE SECTION.
- TEMPORARY SHOULDER AND NON-SYSTEM INTERCHANGE PARTIAL RAMP CLOSURES ARE ALLOWED WEEKDAYS BETWEEN 9:00 A.M. AND 3:00 P.M. AND BETWEEN 7:00 P.M. AND 5:00 A.M. OR AS APPROVED BY THE EXPRESSWAY TRAFFIC OPERATIONS ENGINEER. PERMANENT SHOULDER AND PARTIAL RAMP CLOSURES WILL ONLY BE PERMITTED IF CALLED FOR IN THE PLANS OR AS APPROVED BY THE EXPRESSWAY OPERATIONS ENGINEER.

ALL DIMENSIONS ARE IN INCHES (MILLIMETERS) UNLESS OTHERWISE SHOWN.

STATE OF ILLINOIS
DEPARTMENT OF TRANSPORTATION

TRAFFIC CONTROL DETAILS FOR FREEWAY
SHOULDER CLOSURES AND PARTIAL RAMP CLOSURES

SCALE: NONE SHEET 1 OF 1 SHEETS STA. TO STA.

F.A.U RTE.	SECTION	COUNTY	TOTAL SHEETS	SHEET NO.
3596	2024-1048-RS	COOK	23	22
TC-17		CONTRACT NO. 62X87		
ILLINOIS		FED. AID PROJECT		

MODEL: TC-22 [Sheet]
FILE NAME: c:\p\work\pwr\inicholas.babul@illinois.gov\1036982\107825-sh-Dis\Sds.dgn

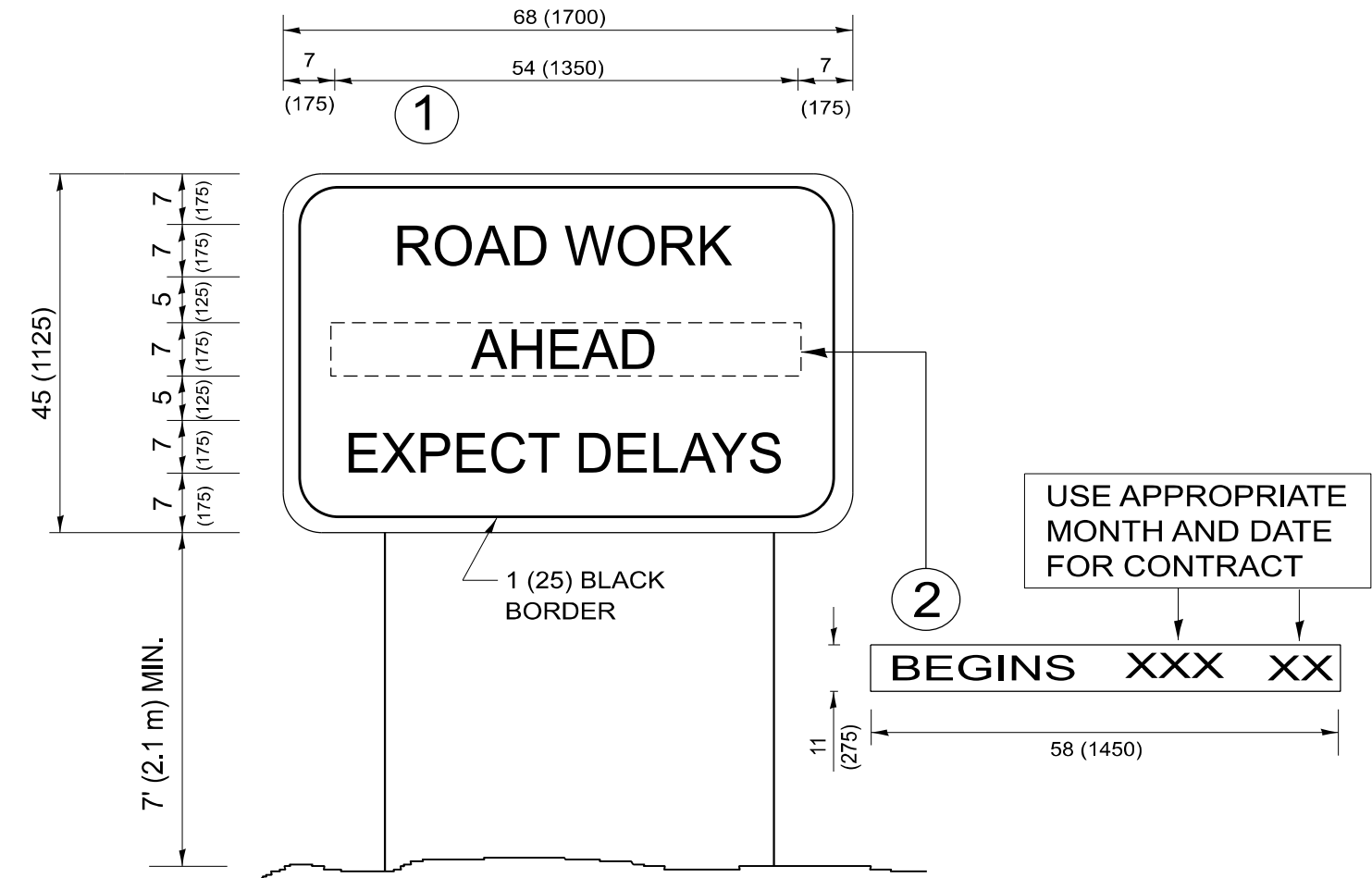

NOTES:

1. USE BLACK LETTERING ON ORANGE BACKGROUND.
2. ERECT SIGNS IN ADVANCE OF THE LOCATION FOR THE "ROAD CONSTRUCTION AHEAD" SIGN AT LOCATIONS AS DIRECTED BY THE ENGINEER.
3. ERECT SIGN ① WITH INSTALLED PANEL ② ONE WEEK PRIOR TO THE START OF CONSTRUCTION.
4. REMOVE PANEL ② SOON AFTER THE START OF CONSTRUCTION.
5. SEE SPECIAL PROVISION FOR "TEMPORARY INFORMATION SIGNING" FOR ADDITIONAL INFORMATION.
6. ONE SIGN ASSEMBLY EQUALS 25.70 SQ. FT. (2.3 SQ. M.)
7. SHALL BE PAID FOR AS TEMPORARY INFORMATION SIGNING.

ALL DIMENSIONS ARE IN INCHES (MILLIMETERS)
UNLESS OTHERWISE SHOWN.

	USER NAME	= nicholas.babul	DESIGNED	-		REVISED	-	R. MIRS 09-15-97	STATE OF ILLINOIS DEPARTMENT OF TRANSPORTATION	ARTERIAL ROAD INFORMATION SIGN					F.A.U RTE.	SECTION	COUNTY	TOTAL SHEETS	SHEET NO.
			DRAWN	-		REVISED	-	R. MIRS 12-11-97							3596	2024-1048-RS	COOK	23	23
			CHECKED	-		REVISED	-	T. RAMMACHER 02-02-99							TC-22		CONTRACT NO. 62X87		
	PLOT DATE	= 6/17/2025	DATE	-		REVISED	-	C. JUCIUS 01-31-07							ILLINOIS FED. AID PROJECT				
	SCALE: NONE			SHEET 1			OF 1 SHEETS												