

INDEX OF SHEETS

- 1. COVER SHEET
- 2. GENERAL NOTES
- 3 - 5. SUMMARY OF QUANTITIES
- 6. TYPICAL SECTIONS
- 7. SCHEDULES
- 8 - 9. STAGING DETAILS
- 10. TEMPORARY CONCRETE BARRIER DELINEATION
- 11. TRAFFIC CONTROL AND PROTECTION, STANDARD 701321
- 12. TEMPORARY INFORMATION SIGNING
- 13. PRE-STAGE SHOULDER RECONSTRUCTION
- 16. PAVEMENT MARKING
- 15 - 23. STRUCTUR DETAILS FOR STRUCTURE NO. 006-0116

HIGHWAY STANDARDS

- 000001-08 STANDARD SYMBOLS, ABBREVIATIONS AND PATTERNS
- 001001-02 AREAS OF REINFORCEMENT BARS
- 001006 DECIMAL OF AN INCH AND OF A FOOT
- 442201-03 CLASS C AND D PATCHES
- 482001-02 HMA SHOULDER ADJACENT TO FLEXIBLE PAVEMENT
- 701001-02 OFF-ROAD OPERATIONS 2L, 2W, MORE THAN 15' AWAY
- 701006-05 OFF-ROAD OPERATIONS 2L, 2W, 15' TO 24" FROM PAVEMENT EDGE
- 701101-05 OFF-ROAD OPERATIONS, MULTILANE, 15' TO 24" FROM PAVEMENT EDGE
- 701106-02 OFF-ROAD OPERATIONS, MULTILANE, MORE THAN 15' AWAY
- 701201-05 LANE CLOSURE, 2L, 2W, DAY ONLY, FOR SPEEDS ≥ 45 MPH
- 701206-05 LANE CLOSURE, 2L, 2W, NIGHT ONLY, FOR SPEEDS ≥ 45 MPH
- 701301-04 LANE CLOSURE, 2L, 2W, SHORT TIME OPERATIONS
- 701306-04 LANE CLOSURE, 2L, 2W, SLOW MOVING OPERATIONS DAY ONLY, FOR SPEEDS ≥ 45 MPH
- 701426-09 LANE CLOSURE, MULTILANE INTERMITTENT OR MOVING OPERATION, FOR SPEEDS ≥ 45 MPH
- 701428-01 TRAFFIC CONTROL, SETUP AND REMOVAL, FREEWAY/EXPRESSWAY
- 701901-10 TRAFFIC CONTROL DEVICES
- 704001-08 TEMPORARY CONCRETE BARRIER

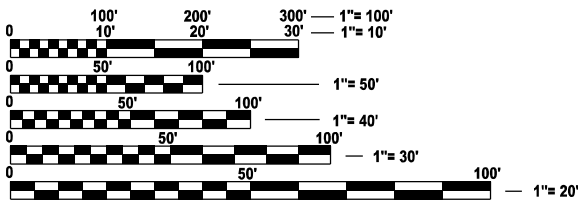

FULL SIZE PLANS HAVE BEEN PREPARED USING STANDARD ENGINEERING SCALES. REDUCED SIZED PLANS WILL NOT CONFORM TO STANDARD SCALES. IN MAKING MEASUREMENTS ON REDUCED PLANS, THE ABOVE SCALES MAY BE USED.

J.U.L.I.E.
JOINT UTILITY LOCATION INFORMATION FOR EXCAVATION
1-800-892-0123
OR 811

PROJECT ENGINEER JUNIOR SENAT
UNIT CHIEF RON WOODSHANK
DISTRICT 3 (815) 434-6131
CONTRACT NO. 66R60

STATE OF ILLINOIS
DEPARTMENT OF TRANSPORTATION

PROPOSED
HIGHWAY PLANS

F.A.I. ROUTE 80 (I-80)
(06-4HB-1)BRR
BRIDGE REPAIRS
BUREAU COUNTY
C-93-019-26

PROJECT LOCATION

STRUCTURE NO. 006-0116
CARRYING BACKBONE RD. OVER
F.A.I. ROUTE 80 (I-80)
1.8 MI. WEST OF JUNCTION IL ROUTE 26
(WEST OF PRINCETON)

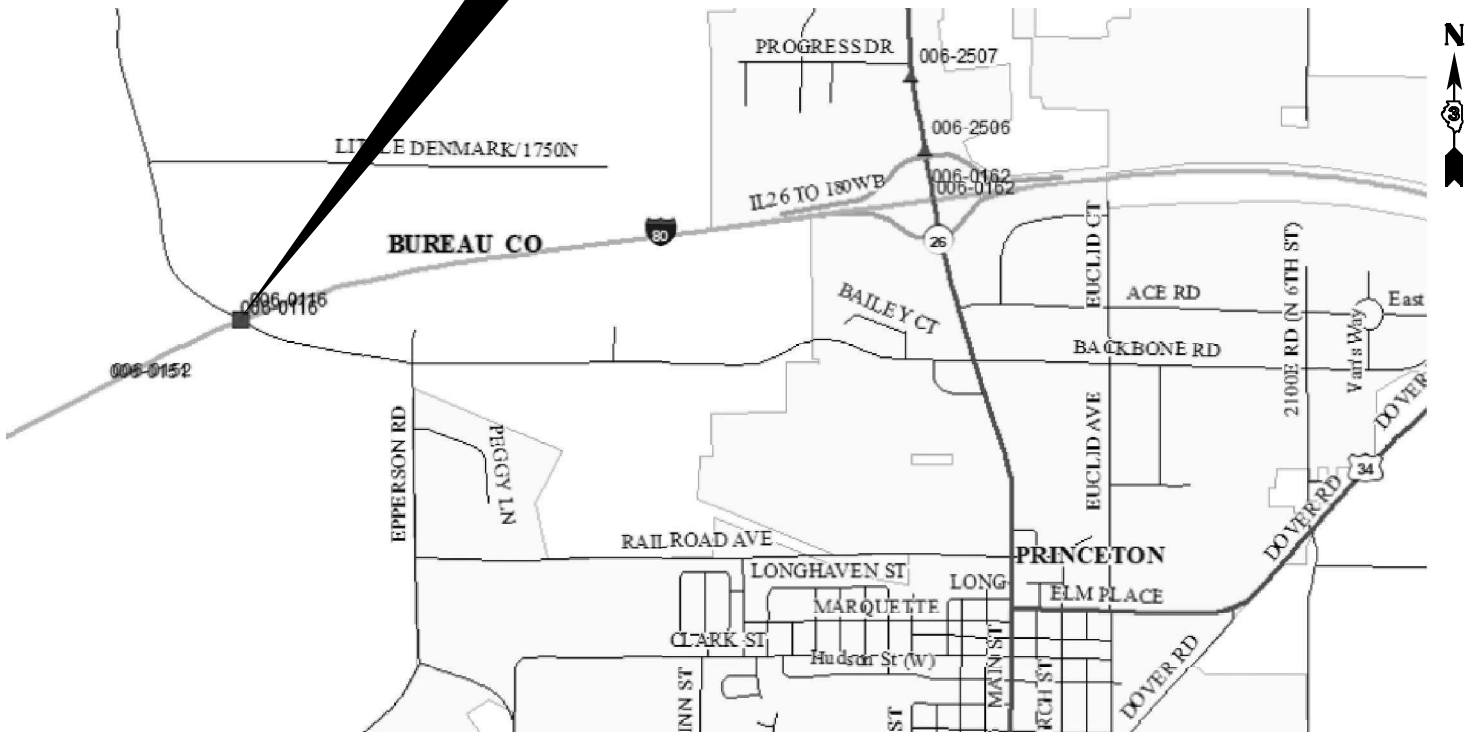

F.A.I. RTE.	SECTION	COUNTY	TOTAL SHEETS	SHEET NO.
80	(06-4HB-1)BRR	BUREAU	23	1
ILLINOIS		CONTRACT NO. 66R60		

D-93-003-26

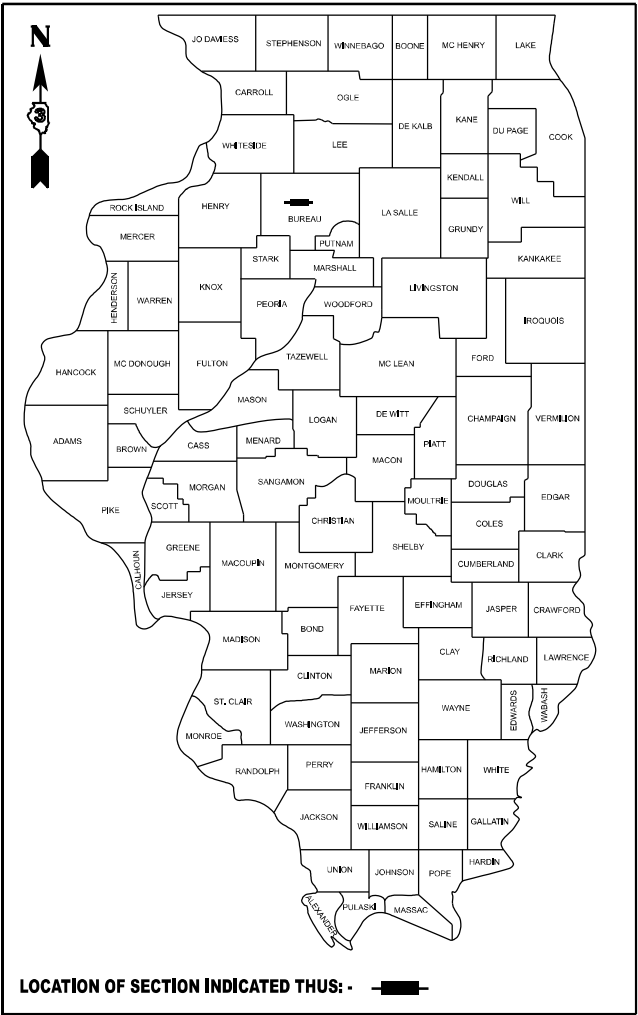

SEE SHEET 2 OF 23 FOR ADT

STATE OF ILLINOIS
DEPARTMENT OF TRANSPORTATION

SUBMITTED August 11, 2025
Trisha Thompson REGIONAL ENGINEER
August 15, 2025
Scott A. Etkin ENGINEER OF DESIGN AND ENVIRONMENT
August 15, 2025
Charles J. Barry DIRECTOR OF HIGHWAYS PROJECT IMPLEMENTATION

PRINTED BY THE AUTHORITY
OF THE STATE OF ILLINOIS

GENERAL NOTES

THE ENGINEER WILL BE THE SOLE JUDGE CONCERNING CURING TIME FOR THE VARIOUS HMA LIFTS.

ALL EXCAVATED MATERIAL, WHICH INCLUDES DIGGING OR GRADING OF ANY SOIL OR FILL MATERIAL, WITH THE EXCEPTION OF AGGREGATE FILLS, MUST BE INCORPORATED WITHIN THE IDOT RIGHT OF WAY.

SHORT TERM PAVEMENT MARKING SHALL BE USED TO OUTLINE NO-PASSING ZONES IN EACH DIRECTION OF TRAFFIC.

ON EXISTING PAVEMENT WHICH MAY BE SUPERELEVATED, THE NEW HMA PAVEMENT SHALL BE BUILT WITH THE SAME SUPERELEVATION UNLESS NEW SUPERELEVATION RATES ARE GIVEN ON THE PLANS.

THE FOLLOWING RATES OF APPLICATION HAVE BEEN USED IN CALCULATING PLAN QUANTITIES:

GRANULAR MATERIALS	2.05	TONS / CU YD
HMA RESURFACING	112	LBS / SQ YD / IN
SHORT TERM PAVEMENT MARKING	10	FT /100 FT OF APPLICATION

COMMITMENTS

FUNCTIONAL CLASSIFICATION
RURAL - INTERSTATE
F.A.I. ROUTE 80 (I-80)
2023 ADT = 19,000
P.V. 49.0 % S.U. 4.0 % M.U. 47.0 %

FUNCTIONAL CLASSIFICATION
RURAL - MAJOR COLLECTOR
BACKBONE RD
2023 ADT = 1,050

STATE OF ILLINOIS
DEPARTMENT OF TRANSPORTATION
DISTRICT THREE
AS BUILT INFORMATION

SUPERVISING CONSTRUCTION FIELD ENGINEER

RESIDENT ENGINEER / TECHNICIAN

START & END DATES
OF CONSTRUCTION:

INSPECTORS:

HMA MIXTURE REQUIREMENT TABLE				
LOCATIONS:	BACKBONE RD	BACKBONE RD	BACKBONE RD	BACKBONE RD
MIXTURE USE(S):	HMA SHOULDER BOTTOM LIFT(S)	HMA SHOULDER TOP LIFT	HMA PATCH BOTTOM LIFT(S)	HMA PATCH TOP LIFT
BINDER GRADE (PG):	PG 64-22	PG 64-22	PG 64-22	PG 64-22
DESIGN AIR VOIDS:	4.0% @ N50	4.0% @ N50	4.0% @ N50	4.0% @ N50
MIXTURE COMPOSITION: (MIXTURE GRADATION)	IL 19.0	IL 9.5	IL 19.0	IL 9.5
FRICTION AGGREGATE:		MIXTURE C		MIXTURE C
MIXTURE WEIGHT:	112.0 LB/SY/IN	112.0 LB/SY/IN	112.0 LB/SY/IN	112.0 LB/SY/IN
QUALITY MANAGEMENT PROGRAM:	QC/QA	QC/QA	QC/QA	QC/QA
SUBLOT SIZE:	N/A	N/A	N/A	N/A
DENSITY TEST METHOD:	CORES/NUCLEAR	CORES/NUCLEAR	CORES/NUCLEAR	CORES/NUCLEAR
MATERIAL TRANSFER DEVICE (REQUIRED):	NO	NO	NO	NO

MODEL: Default
FILE NAME: c:\pwwork\woodshank\1095872\0366R60.dgn

	USER NAME = ronald.woodshank	DESIGNED - RW	REVISED -	STATE OF ILLINOIS DEPARTMENT OF TRANSPORTATION	GENERAL NOTES			F.A.I. RTE.	SECTION	COUNTY	TOTAL SHEETS	SHEET NO.
		DRAWN - RW	REVISED -					80	(06-4HB-1)BRR	BUREAU	23	2
		CHECKED - JS	REVISED -					CONTRACT NO. 66R60				
	PLOT DATE = 7/8/2025	DATE - 4/28/2025	REVISED -		SCALE:	SHEET 1	OF 1 SHEETS	STA.	TO STA.	ILLINOIS FED. AID PROJECT		

MODEL: Default
FILE NAME: c:\pwwork\pwwork\woodshank\rd1095872\0368R60.dgn

CODE NO.	ITEM	UNIT	TOTAL QUANTITY	CONSTRUCTION CODE
				CONTRACT MAINTENANCE
				100% STATE
				BRIDGE
				0047
				S.N. 006-0116
20200500	EARTH EXCAVATION (WIDENING)	CU YD	304	304
40600290	BITUMINOUS MATERIALS (TACK COAT)	POUND	313	313
44004250	PAVED SHOULDER REMOVAL	SQ YD	176	176
48203029	HOT-MIX ASPHALT SHOULDERS, 8"	SQ YD	464	464
50102400	CONCRETE REMOVAL	CU YD	10.2	10.2
50300255	CONCRETE SUPERSTRUCTURE	CU YD	10.4	10.4
50500405	FURNISHING AND ERECTING STRUCTURAL STEEL	POUND	1620	1620
50800205	REINFORCEMENT BARS, EPOXY COATED	POUND	1800	1800
50800515	BAR SPLICERS	EACH	28	28
50800530	MECHANICAL SPLICERS	EACH	18	18
52000110	PREFORMED JOINT STRIP SEAL	FOOT	76	76
52100020	ELASTOMERIC BEARING ASSEMBLY, TYPE II	EACH	10	10
52100520	ANCHOR BOLTS, 1"	EACH	20	20
67100100	MOBILIZATION	L SUM	1	1

	USER NAME = ronald.woodshank	DESIGNED - RW	REVISED -	STATE OF ILLINOIS DEPARTMENT OF TRANSPORTATION	SUMMARY OF QUANTITIES			F.A.I. RTE.	SECTION	COUNTY	TOTAL SHEETS	SHEET NO.
		DRAWN - RW	REVISED -					80	(06-4HB-1)BRR	BUREAU	25	3
		CHECKED - JS	REVISED -					CONTRACT NO. 66R60				
	PLOT DATE = 5/12/2025	DATE - 4/28/2025	REVISED -		SCALE:	SHEET 1 OF 3 SHEETS	STA.	TO STA.	ILLINOIS FED. AID PROJECT			

MODEL: Default
FILE NAME: c:\pwwork\pwwork\woodshank\rd1095872\0366R60.dgn

CODE NO.	ITEM	UNIT	TOTAL QUANTITY	CONSTRUCTION CODE
				CONTRACT MAINTENANCE
				100% STATE
				BRIDGE
				0047
				S.N. 006-0116
70100405	TRAFFIC CONTROL AND PROTECTION, STANDARD 701321	EACH	1	1
70100450	TRAFFIC CONTROL AND PROTECTION, STANDARD 701201	L SUM	1	1
70106500	TEMPORARY BRIDGE TRAFFIC SIGNALS	EACH	1	1
70106700	TEMPORARY RUMBLE STRIPS	EACH	14	14
70107025	CHANGEABLE MESSAGE SIGN	CAL DA	14	14
70300100	SHORT TERM PAVEMENT MARKING	FOOT	160	160
70300150	SHORT TERM PAVEMENT MARKING REMOVAL	SQ FT	53	53
70400100	TEMPORARY CONCRETE BARRIER	FOOT	500	500
70400200	RELOCATE TEMPORARY CONCRETE BARRIER	FOOT	500	500
70600251	IMPACT ATTENUATORS, TEMPORARY (NON- REDIRECTIVE, NARROW), TEST LEVEL 3	EACH	2	2
70600352	IMPACT ATTENUATORS, RELOCATE (NON- REDIRECTIVE,NARROW), TEST LEVEL 3	EACH	2	2
* 78009004	MODIFIED URETHANE PAVEMENT MARKING - LINE 4"	FOOT	3200	3200
78300202	PAVEMENT MARKING REMOVAL - WATER BLASTING	SQ FT	1056	1056

*SPECIALITY ITEMS

	USER NAME = ronald.woodshank	DESIGNED - RW	REVISED -	STATE OF ILLINOIS DEPARTMENT OF TRANSPORTATION	SUMMARY OF QUANTITIES			F.A.I RTE.	SECTION	COUNTY	TOTAL SHEETS	SHEET NO.
		DRAWN - RW	REVISED -					80	(06-4HB-1)BRR	BUREAU	25	4
		CHECKED - JS	REVISED -					CONTRACT NO. 66R60				
	PLOT DATE = 5/12/2025	DATE - 4/28/2025	REVISED -		SCALE:	SHEET 2	OF 3	SHEETS	STA.	TO STA.	ILLINOIS FED. AID PROJECT	

MODEL: Default
FILE NAME: c:\p\p_work\pwork\woodshank\1095872\0366R60.dgn

CODE NO.	ITEM	UNIT	TOTAL QUANTITY	CONSTRUCTION CODE
				CONTRACT MAINTENANCE
				100% STATE
				BRIDGE
				0047
				S.N. 006-0116
X7200061	TEMPORARY INFORMATION SIGNING	SQ FT	42	42
Z0001899	JACK AND REMOVE EXISTING BEARINGS	EACH	10	10

	USER NAME = ronald.woodshank	DESIGNED - RW	REVISED -	STATE OF ILLINOIS DEPARTMENT OF TRANSPORTATION	SUMMARY OF QUANTITIES			F.A.I. RTE.	SECTION	COUNTY	TOTAL SHEETS	SHEET NO.
		DRAWN - RW	REVISED -					80	(06-4HB-1)BRR	BUREAU	23	5
		CHECKED - JS	REVISED -					CONTRACT NO. 66R60				
	PLOT DATE = 7/8/2025	DATE - 4/28/2025	REVISED -		SCALE:	SHEET 3 OF 3 SHEETS	STA. TO STA.	ILLINOIS FED. AID PROJECT				

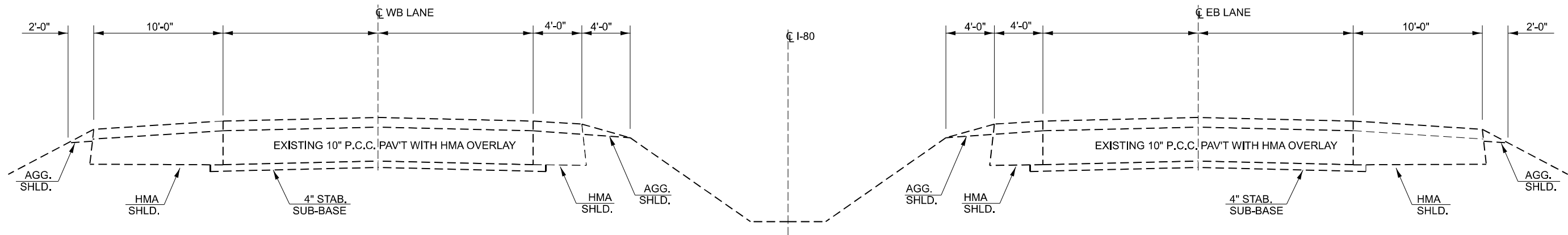

TYPICAL SECTION 1
F.A.I. ROUTE 80 (I-80)

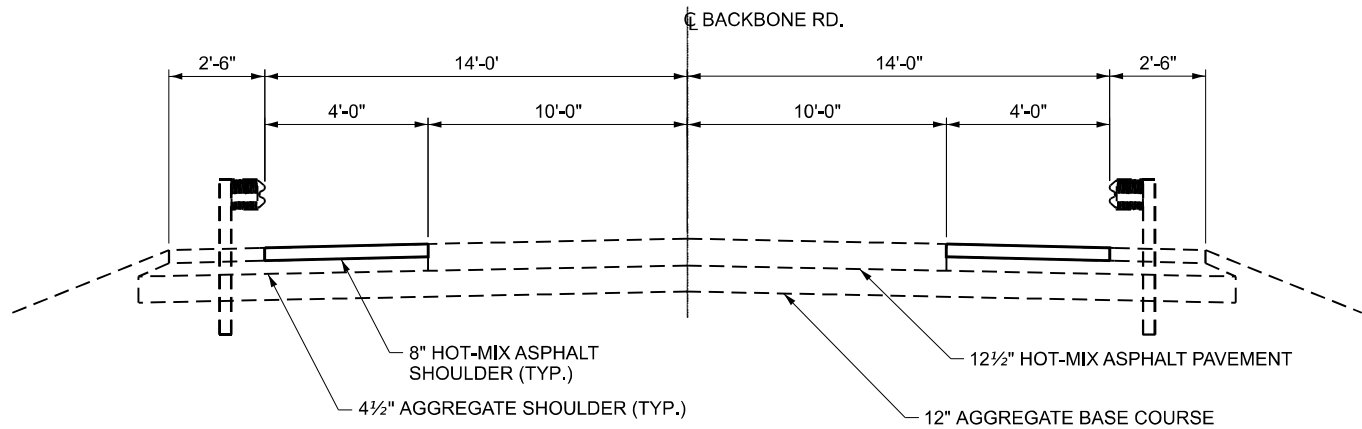

TYPICAL SECTION 2
BACKBONE RD.

MODEL: Default
FILE NAME: c:\p\work\p\woodshank\1055872\0366R60.dgn

	USER NAME = ronald.woodshank	DESIGNED - RW	REVISED -	STATE OF ILLINOIS DEPARTMENT OF TRANSPORTATION	TYPICAL SECTIONS			F.A.I. RTE.	SECTION	COUNTY	TOTAL SHEETS	SHEET NO.
		DRAWN - RW	REVISED -					80	(06-4HB-1)BRR	BUREAU	23	6
		CHECKED - JS	REVISED -					CONTRACT NO. 66R60				
	PLOT DATE = 7/8/2025	DATE - 4/28/2025	REVISED -		SCALE:	SHEET 1	OF 1 SHEETS	STA.	TO STA.	ILLINOIS FED. AID PROJECT		

MODEL: Default
FILE NAME: c:\pwwork\pwwork\woodshank\1095872\0366R60.dgn

SCHEDULE - TRAFFIC CONTROL AND PROTECTION									
LOCATION	TRAFFIC CONTROL AND PROTECTION STANDARD 701321	TRAFFIC CONTROL AND PROTECTION STANDARD 701201	TEMPORARY BRIDGE TRAFFIC SIGNALS	TEMPORARY RUMBLE STRIPS	TEMPORARY CONCRETE BARRIER	RELOCATE TEMPORARY CONCRETE BARRIER	IMPACT ATTENUATORS TEMPORARY (NON-REDIRECTIVE, NARROW) TEST LEVEL 3	IMPACT ATTENUATORS RELOCATE (NON-REDIRECTIVE, NARROW) TEST LEVEL 3	TEMPORARY INFORMATION SIGNING
	EACH	L SUM	EACH	EACH	FOOT	FOOT	EACH	EACH	SQ FT
STAGE I	0.5	0.5	1	6	500		2		42
STAGE II	0.5	0.5				500		2	
TOTAL	1	1	1	6	500	500	2	2	42

SCHEDULE - PAVEMENT MARKING						
LOCATION		PAVEMENT MARKING REMOVAL	SHORT TERM PAVEMENT MARKING	SHORT TERM PAVEMENT MARKING REMOVAL	MODIFIED URETHANE PAVEMENT MARKING LINE 4"	
					(WHITE, EDGE LINE)	(YELLOW, DOUBLE NPZ)
		SQ FT	FOOT	SQ FT	FOOT	
BACKBONE RD.	STAGE I	792				
	STAGE II	264	160	53	1600	1600
TOTAL		1056	160	53	3200	

SCHEDULE - SHOULDERS								
LOCATION		LENGTH	WIDTH	PAVED SHOULDER REMOVAL	EARTH EXCAVATION (WIDENING)	BITUMINOUS MATERIALS (TACK COAT)		HOT-MIX ASPHALT SHOULDERS 8"
						0.05 LBS/FT	0.025 LBS/FT	
		FEET	FEET	SY YD	CU YD	POUND		SQ YD
BACKBONE RD.	NW CORNER	190	4		18.9			
		80	4	36	2			
		270	4			54	27	120
	NE CORNER	113	4		11.2			
		141	4	63	3.6			
		254	4			51	25	113
	SW CORNER	80	4	36	2			
		172	4		17.1			
		252	4			50	25	112
	SE CORNER	92	4	41	17.5			
		176	4		231.7			
		268	4			54	27	119
TOTAL				176	304	313		464

	USER NAME = ronald.woodshank	DESIGNED - RW	REVISED -	STATE OF ILLINOIS DEPARTMENT OF TRANSPORTATION	SCHEDULES			F.A.I. RTE.	SECTION	COUNTY	TOTAL SHEETS	SHEET NO.
		DRAWN - RW	REVISED -					80	(06-4HB-1)BRR	BUREAU	23	7
		CHECKED - JS	REVISED -		SCALE: SHEET 1 OF 1 SHEETS STA. TO STA.			CONTRACT NO. 66R60				
	PLOT DATE = 7/8/2025	DATE - 4/28/2025	REVISED -					ILLINOIS FED. AID PROJECT				

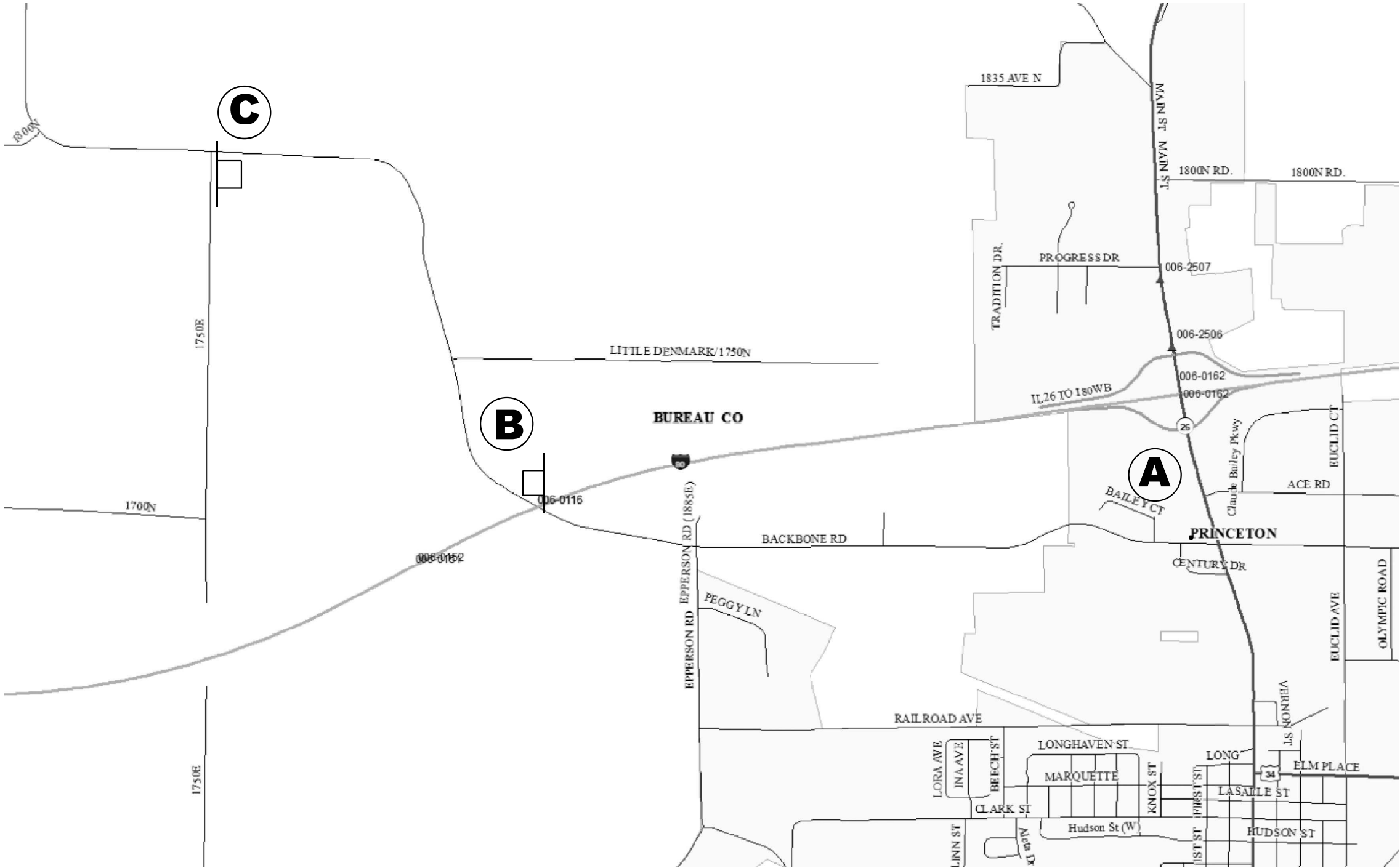

WIDTH RESTRICTION SIGN



SIGN

A



W12-I103-4848

WIDTH RESTRICTION SIGN

XX'-XX" width and X miles are variable.

B



W12-I103-4848

WIDTH RESTRICTION SIGN

XX'-XX" width and X miles are variable.

C



W12-I103-4848

WIDTH RESTRICTION SIGN

XX'-XX" width and X miles are variable.

MODEL: Default
FILE NAME: c:\pwwork\woodshank\1055872\0366R60.dgn

	USER NAME	= ronald.woodshank	DESIGNED	-	RW	REVISED	-	
	DRAWN	-	RW			REVISED	-	
	CHECKED	-	JS			REVISED	-	
	PLOT DATE	=	7/8/2025	DATE	-	4/28/2025	REVISED	-

STATE OF ILLINOIS
DEPARTMENT OF TRANSPORTATION

WIDTH RESTRICTION SIGNING

SCALE: SHEET 2 OF 2 SHEETS STA. TO STA.

F.A.I. RTE.	SECTION	COUNTY	TOTAL SHEETS	SHEET NO.
80	(06-4HB-1)BRR	BUREAU	23	8
CONTRACT NO. 66R60				
ILLINOIS FED. AID PROJECT				

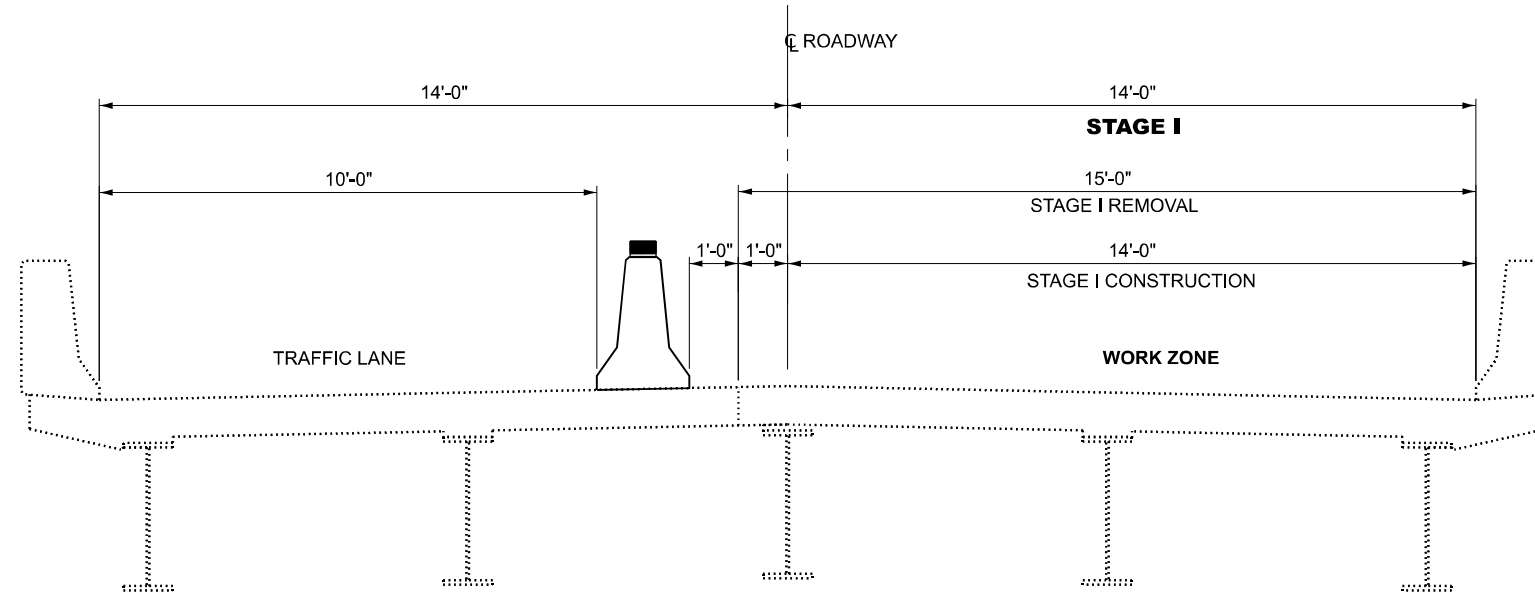

CROSS SECTION
STAGE I
BACKBONE RD.
LOOKING EAST

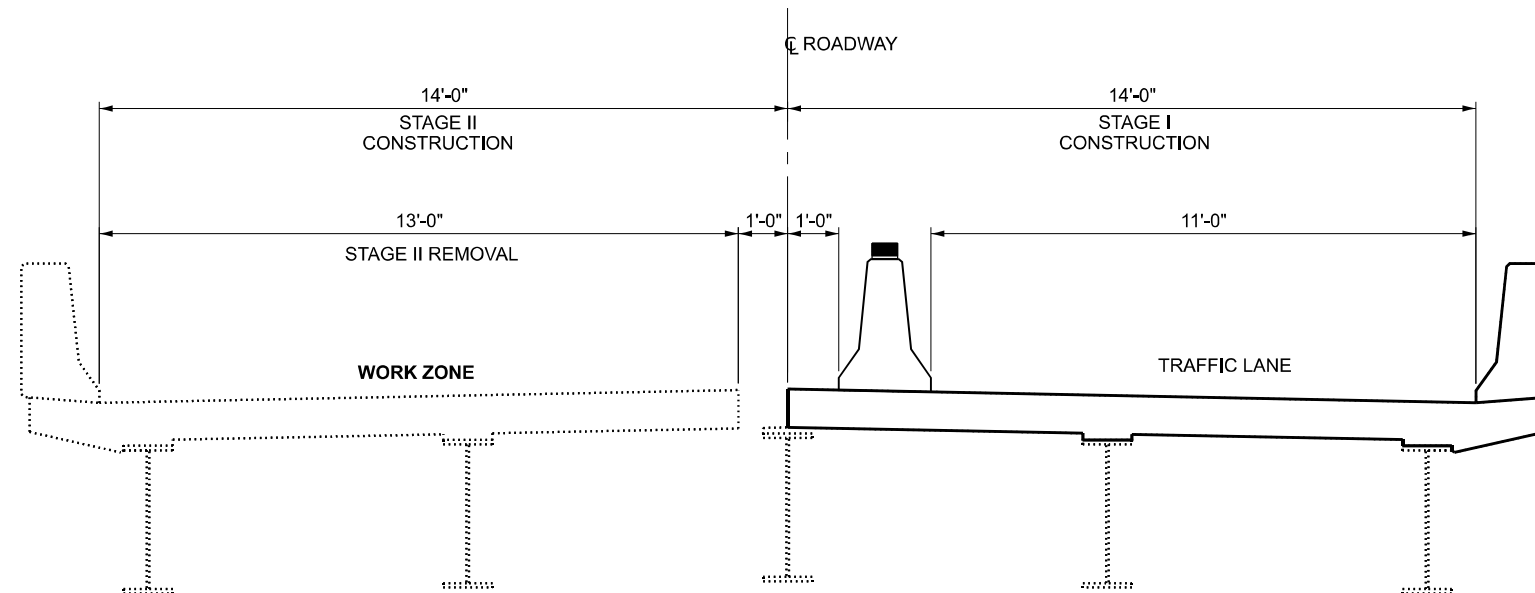

CROSS SECTION
STAGE II
BACKBONE RD.
LOOKING EAST

MODEL: Default
FILE NAME: c:\p\work\p\work\woodshank\1095872\0366R60.dgn

	USER NAME = ronald.woodshank	DESIGNED - RW	REVISED -	STATE OF ILLINOIS DEPARTMENT OF TRANSPORTATION	STAGING DETAILS BACKBONE RD.			F.A.I. RTE.	SECTION	COUNTY	TOTAL SHEETS	SHEET NO.
		DRAWN - RW	REVISED -					80	(06-4HB-1)BRR	BUREAU	23	9
		CHECKED - JS	REVISED -					CONTRACT NO. 66R60				
	PLOT DATE = 7/8/2025	DATE - 4/28/2025	REVISED -		SCALE:	SHEET 2	OF 2 SHEETS	STA.	TO STA.	ILLINOIS FED. AID PROJECT		

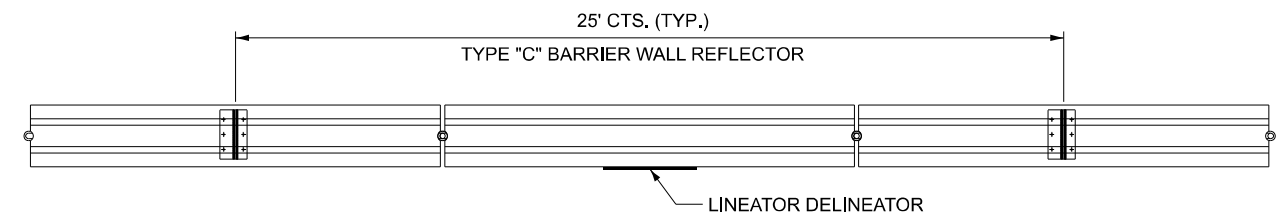
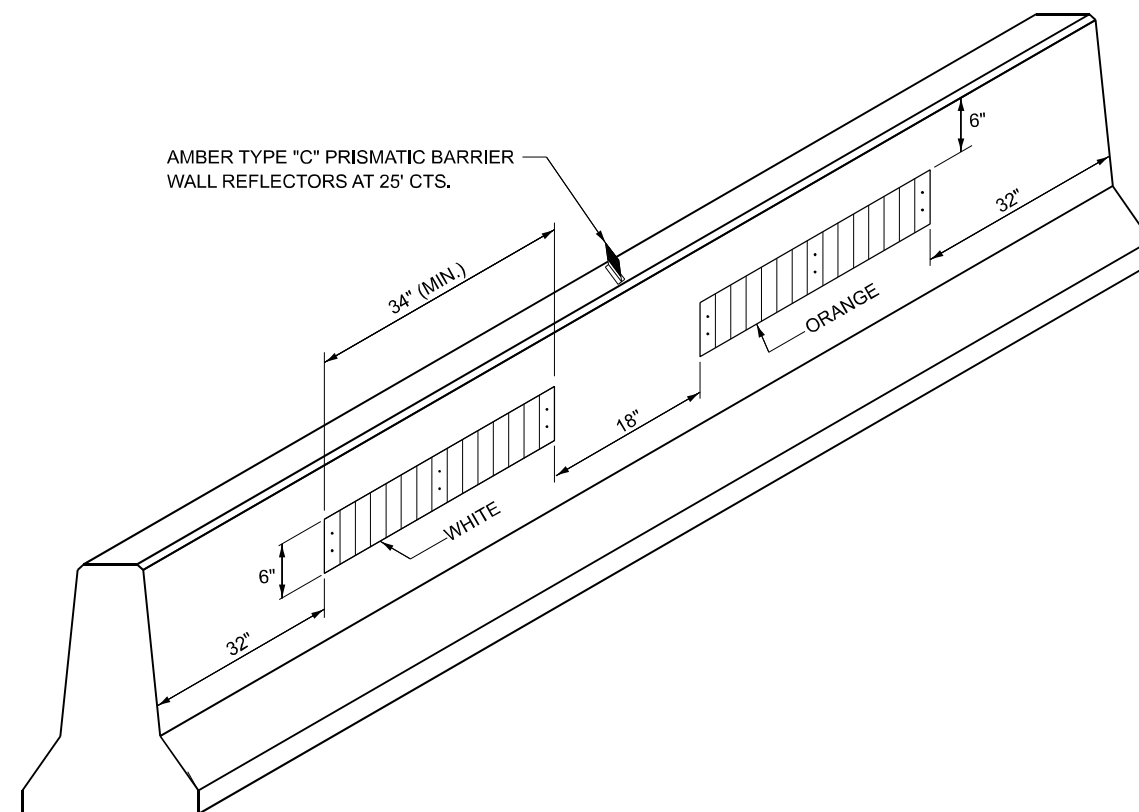

TYPC "C" REFLECTOR FOR TEMPORARY CONCRETE BARRIER

NOTE:
DELINEATION INCLUDING LINEAR DELINEATION PANELS AND TYPE C REFLECTORS
FOR TEMPORARY CONCRETE BARRIER DELINEATION SHALL NOT BE PAID FOR
SEPARATELY BUT SHALL BE INCLUDED IN THE COST OF THE TEMPORARY CONCRETE
BARRIER.

LINEAR DELINEATOR PANELS FOR TEMPORARY CONCRETE BARRIER

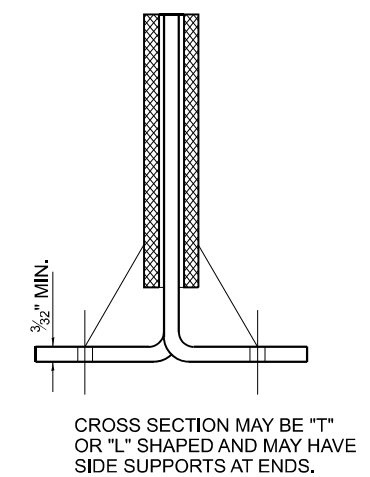
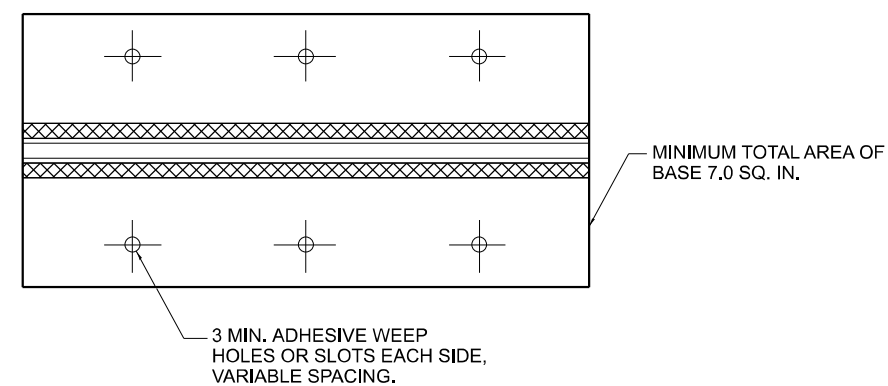
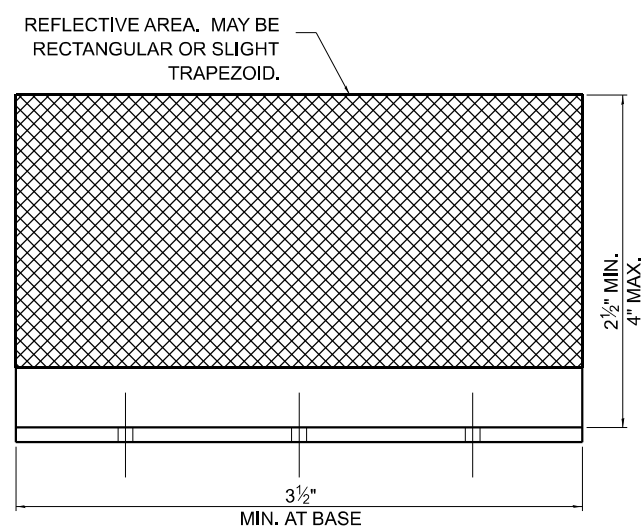

REFLECTOR TYPE C

FILE NAME:	USER NAME = ronald.woodshank	DESIGNED - RW	REVISED -	STATE OF ILLINOIS DEPARTMENT OF TRANSPORTATION	TEMPORARY CONCRETE BARRIER DELINEATION	F.A.I. RTE.	SECTION	COUNTY	TOTAL SHEETS	SHEET NO.		
		DRAWN - RW	REVISED -			80	(06-4HB-1)BRR	BUREAU	23	10		
		CHECKED - JS	REVISED -			CONTRACT NO. 66R60						
	PLOT DATE = 7/8/2025	DATE - 4/28/2025	REVISED -			SCALE:	SHEET 1 OF 1 SHEETS	STA.	TO STA.			
						ILLINOIS FED. AID PROJECT						

MODEL: Default
FILE NAME: c:\pwwork\woodshank\1095872\0366R60.dgn

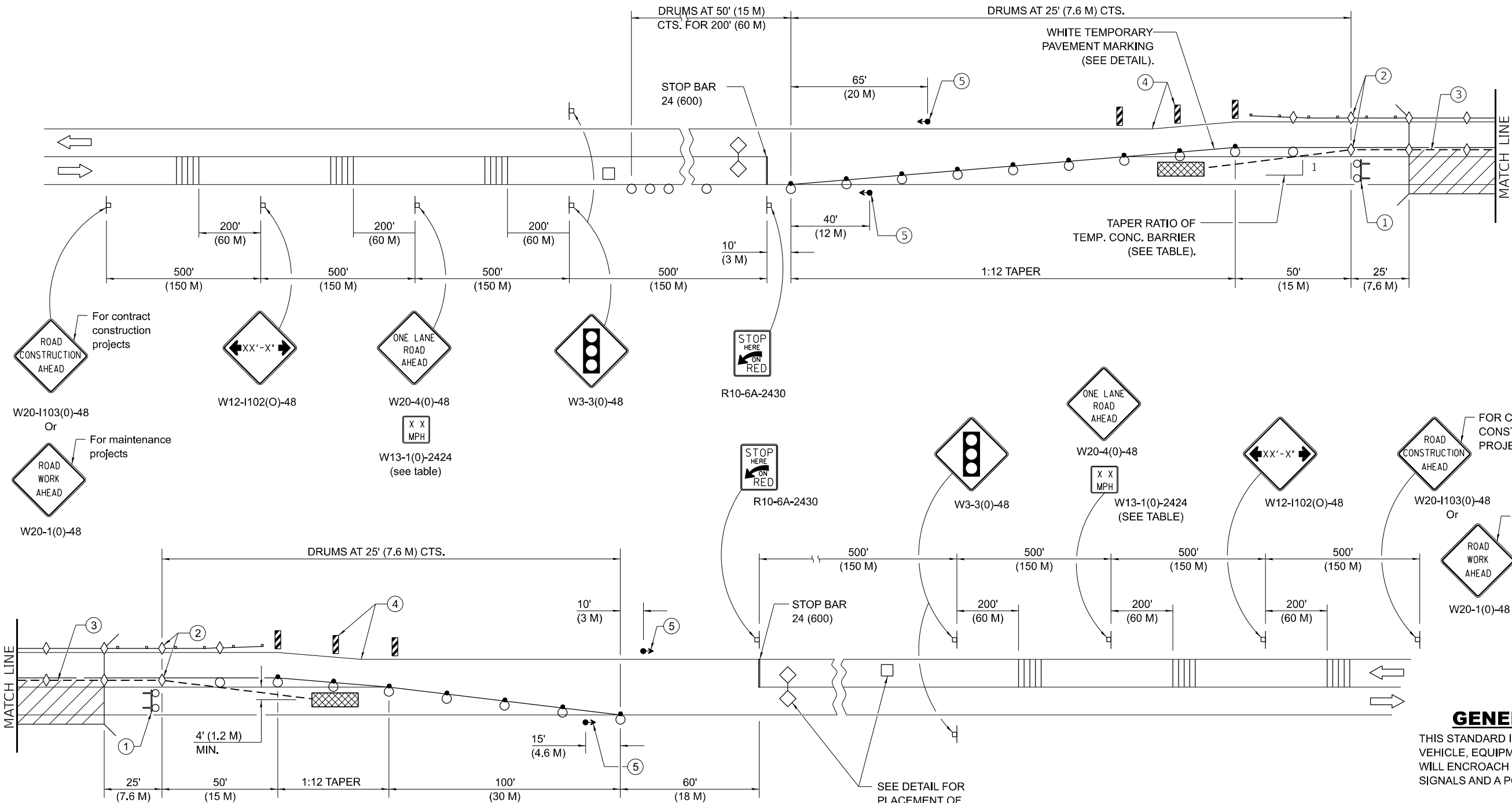

- 1 TYPE III BARRICADE TO BE PLACED WHEN NO WORK IS BEING PERFORMED.
- 2 GUARDRAIL/BARRIER WALL REFLECTORS AT 25' (7.6 M) CTS. SEE STANDARDS 704001 & 782006.
- 3 WHEN TEMP. BRIDGE RAIL IS SPECIFIED, IT SHALL BE CONNECTED TO THE TEMP. CONC. BARRIER USING A TRAFFIC BARRIER TERMINAL TYPE 11.
- 4 VERTICAL PANELS AT 25' (7.6 M) CTS. THROUGHOUT LANE SHIFT. THESE DEVICES MAY BE OMITTED WHEN THE GUARDRAIL, W/MARKERS, EXTENDS TO AT LEAST THIS POINT ON THE TAPER.
- 5 THE EDGE OF THE POST MOUNTED SIGNAL HEAD SHALL BE BETWEEN 24 (610) AND 6' (1.8 M) FROM EDGE OF SHOULDER.

SYMBOLS

	WORK AREA		DRUM WITH STEADY BURNING BI-DIRECTIONAL LIGHT
	SIGN		TEMPORARY CONCRETE BARRIER
	TYPE III BARRICADE WITH FLASHING LIGHTS		TEMPORARY RUMBLE STRIP (WHEN SPECIFIED)
	TRAFFIC SIGNAL		DOUBLE VERTICAL PANEL (SEE DETAIL)
	DETECTOR LOOPS		CRYSTAL, BIDIRECTIONAL GUARDRAIL/BARRIER WALL REFLECTOR
	IMPACT ATTENUATOR		DRUM

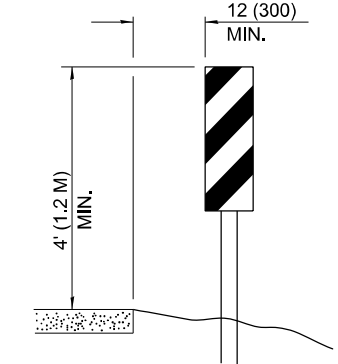

VERTICAL PANELS
(POST MOUNTED, ONE EACH SIDE)

ADVISORY SPEED LIMIT	
NORMAL POSTED SPEED	ADVISORY SPEED
55 - 45 mph	40 mph
40 mph	35 mph
35 - 30 mph	30 mph

TEMPORARY CONCRETE BARRIER	
NORMAL POSTED SPEED	TAPER RATIO
40 mph AND ABOVE	12:1
BELOW 40 mph	8:1

GENERAL NOTES

THIS STANDARD IS USED WHERE, AT ANY TIME, ANY VEHICLE, EQUIPMENT, WORKERS, OR THEIR ACTIVITIES WILL ENCROACH ON ONE LANE OF A BRIDGE. TRAFFIC SIGNALS AND A POSITIVE BARRIER ARE REQUIRED.

MICROWAVE DETECTORS SHALL BE INSTALLED INSTEAD OF INDUCTION LOOP DETECTORS. SEE SPECIAL PROVISION FOR "TEMPORARY BRIDGE TRAFFIC SIGNALS".

TRAFFIC SIGNALS SHALL BE OPERATIONAL ONLY WHEN ALL TRAFFIC CONTROLS ARE IN PLACE. WHEN TRAFFIC SIGNALS ARE NOT IN OPERATION, FLAGGERS SHALL BE USED AND TRAFFIC CONTROL SHALL CONFORM TO STANDARD 701201 OR 701206.

TEMPORARY CONCRETE BARRIER SHALL BE ACCORDING TO STANDARD 704001.

EXISTING OR TEMPORARY PAVEMENT MARKINGS SHALL BE ON BOTH SIDES OF OPEN LANE FROM STOP BAR TO STOP BAR.

ALL DIMENSIONS ARE IN INCHES (MILLIMETERS) UNLESS OTHERWISE SHOWN.

PLOT DATE = 7/8/2025	USER NAME = ronald.woodshank	DESIGNED - RW	REVISED -
		DRAWN - RW	REVISED -
		CHECKED - JS	REVISED -
	DATE - 4/28/2025	REVISED -	

STATE OF ILLINOIS
DEPARTMENT OF TRANSPORTATION

TRAFFIC CONTROL AND PROTECTION STANDARD 701321

SCALE: SHEET 1 OF 1 SHEETS STA. TO STA.

F.A.I. RTE.	SECTION	COUNTY	TOTAL SHEETS	SHEET NO.
80	(06-4HB-1)BRR	BUREAU	25	11
CONTRACT NO. 66R60				
ILLINOIS FED. AID PROJECT				

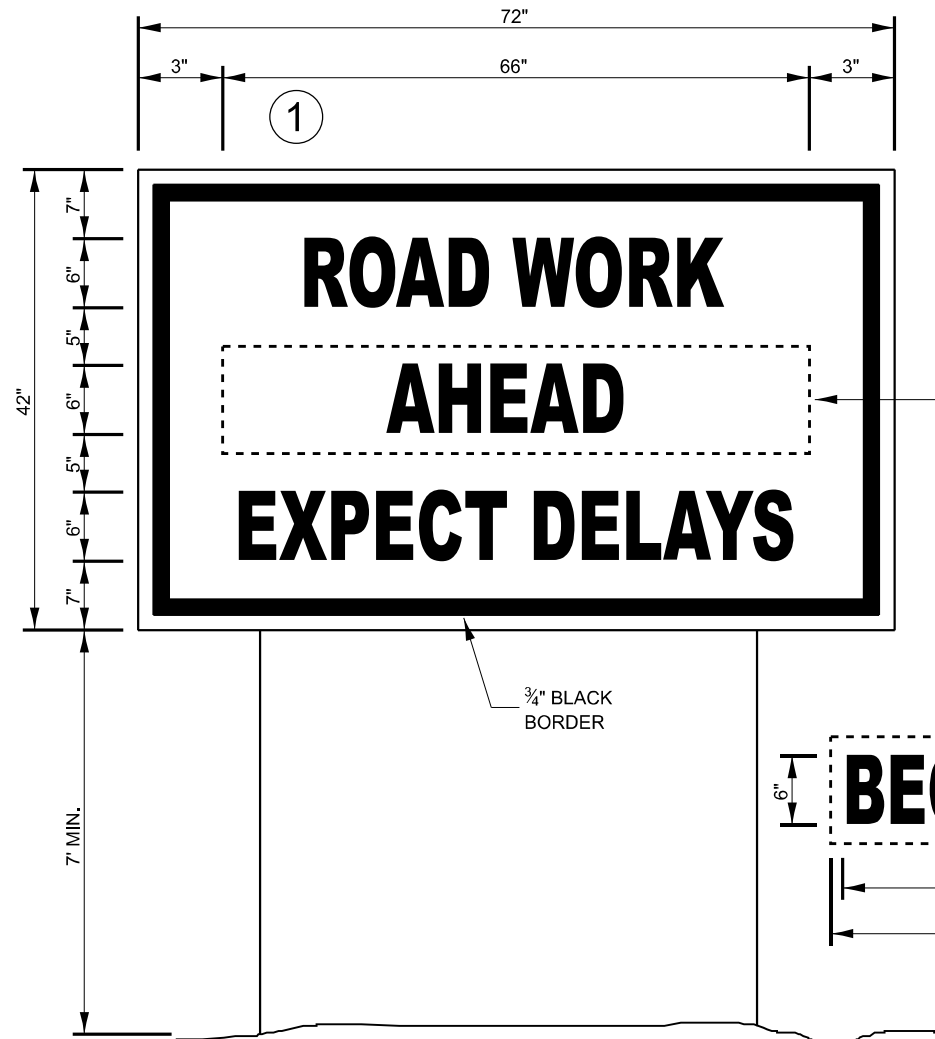

TEMPORARY INFORMATION SIGNING

NOTES:

- 1. USE 6" D BLACK LETTERING ON FLOURESENT ORANGE BACKGROUND.
- 2. ERECT SIGNS AT LOCATIONS IN ADVANCE OF THE "ROAD CONSTRUCTION AHEAD" SIGNS AS DIRECTED BY THE ENGINEER.
- 3. ERECT SIGN ① WITH INSTALLED PANEL ② A MINIMUM OF ONE WEEK PRIOR TO THE START OF THE LANE CLOSURE.
- 4. REMOVE PANEL ② ON THAT DATE.
- 5. SEE SPECIAL PROVISION "TEMPORARY INFORMATION SIGNING" FOR ADDITIONAL INFORMATION.
- 6. WILL BE PAID FOR PER SQ FT AS "TEMPORARY INFORMATION SIGNING". EACH SIGN = 21 SQ FT. THE DATE PANEL ② RESUMES PANEL ③ AND SPRING 202X PANEL ④ WILL NOT BE MEASURED SEPARATELY FOR PAYMENT.

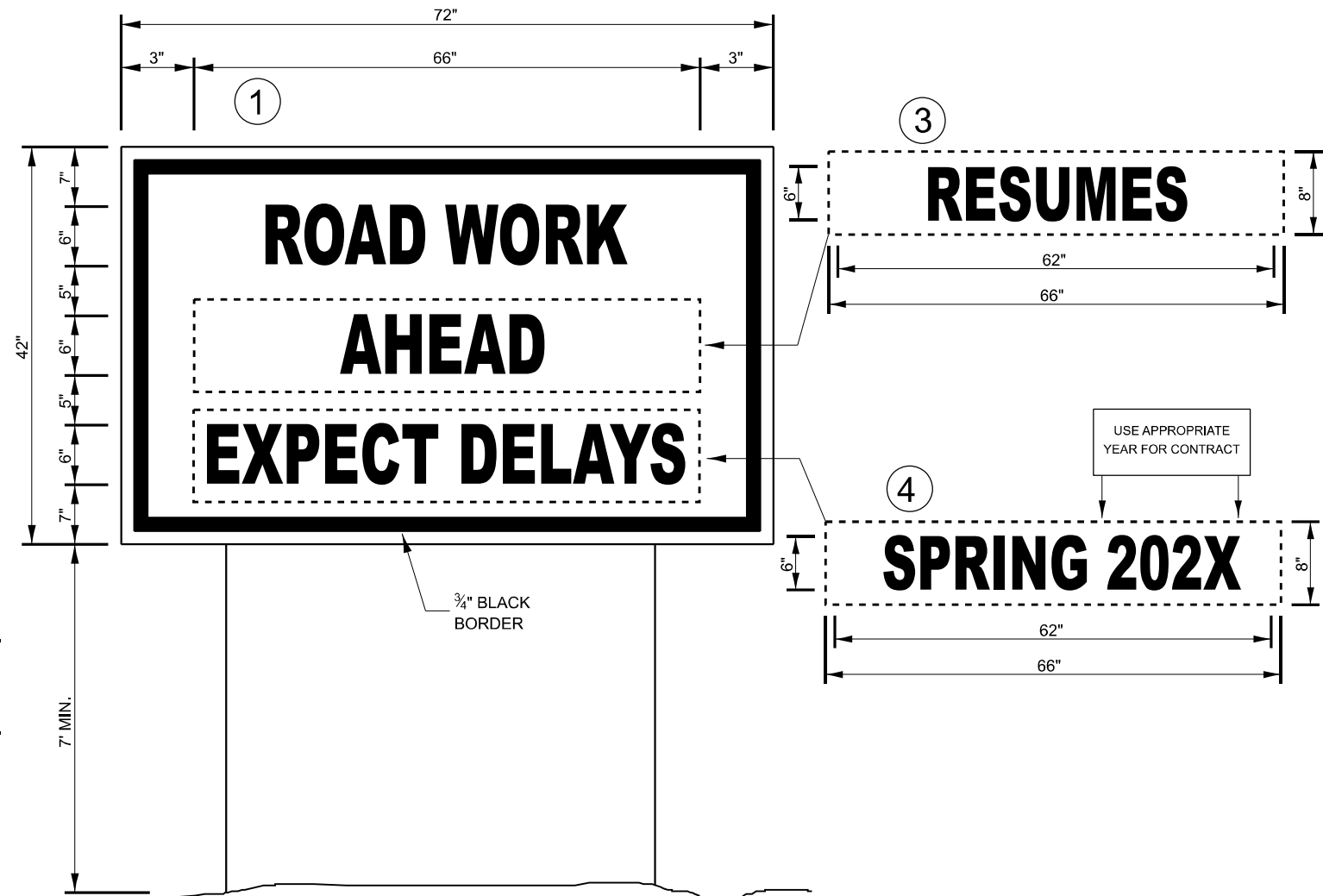

WINTER SHUT DOWN SIGNING

MODEL: Default
FILE NAME: c:\pwork\woodshank\td1095872\0366R60.dgn

	USER NAME = ronald.woodshank	DESIGNED - RW	REVISED -	STATE OF ILLINOIS DEPARTMENT OF TRANSPORTATION	TEMPORARY INFORMATION SIGNING			F.A.I. RTE.	SECTION	COUNTY	TOTAL SHEETS	SHEET NO.
		DRAWN - RW	REVISED -					80	(06-4HB-1)BRR	BUREAU	23	12
		CHECKED - JS	REVISED -					CONTRACT NO. 66R60				
	PLOT DATE = 7/8/2025	DATE - 4/28/2025	REVISED -		SCALE:	SHEET 1	OF 1 SHEETS	STA.	TO STA.	ILLINOIS FED. AID PROJECT		

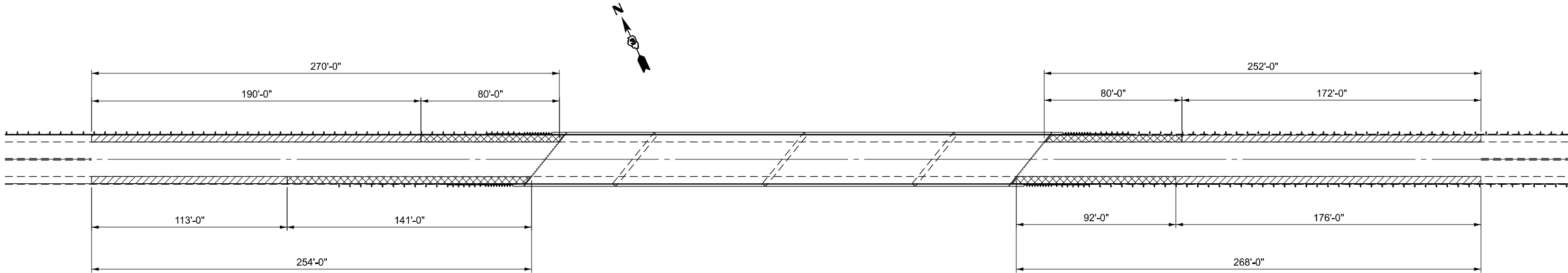

LEGEND

-  **PAVED SHOULDER REMOVAL**
-  **EARTH EXCAVATION (WIDENING)**

- NOTES:
1. LENGTH MEASUREMENTS HAVE BEEN TAKEN ALONG THE EDGE OF PAVEENT
 2. THE CONTRACTOR HAS THE OPTION OF REMOVING AND RE-INSTALLING THE EXISTING STEEL PLATE BEAM GUARDRAIL AND TERMINAL SECTION RAIL TO FACILITATE CONSTRUCTION OF THE PROPOSED HOT-MIX ASPHALT SHOULDERS. COST OF REMOCING AND REINSTALLING THE RAIL SHALL NOT BE PAID FOR SEPARATELY BUT SHALL BE INCLUDED IN THE SHOULDER WOR.

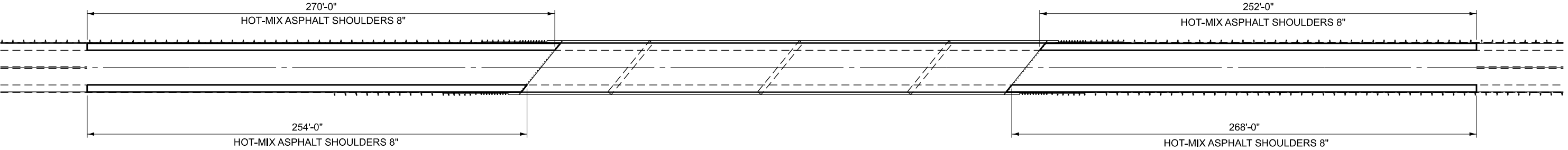
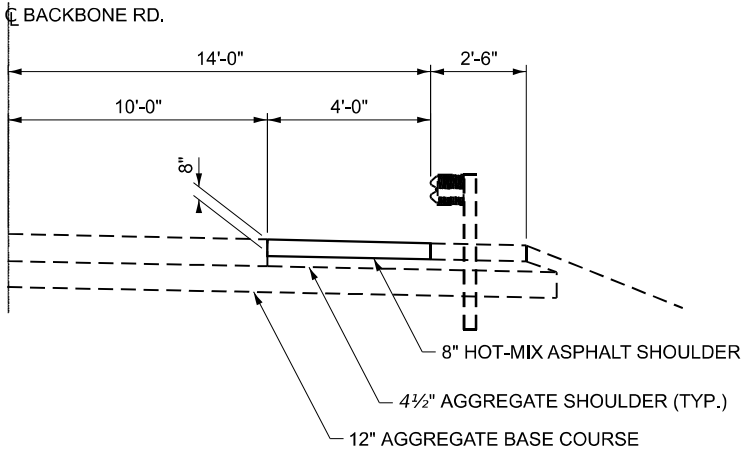

**PROPOSED ROADWAY PLAN
HOTMIX ASPHALT SHOULDERS 8"**

MODEL: Default
FILE NAME: c:\p\p\work\p\woodshank\1055872\0366R60.dgn

	USER NAME = ronald.woodshank	DESIGNED - RW	REVISED -	STATE OF ILLINOIS DEPARTMENT OF TRANSPORTATION	PRE-STAGE SHOULDER RECONSTRUCTION			F.A.I. RTE.	SECTION	COUNTY	TOTAL SHEETS	SHEET NO.
		DRAWN - RW	REVISED -					80	(06-4HB-1)BRR	BUREAU	23	13
		CHECKED - JS	REVISED -					CONTRACT NO. 66R60				
	PLOT DATE = 7/8/2025	DATE - 4/28/2025	REVISED -		SCALE:	SHEET 1	OF 1 SHEETS	STA.	TO STA.	ILLINOIS FED. AID PROJECT		



NOTE: NO EXISTING RAISED REFLECTIVE PAVEMENT MARKERS ARE PRESENT.
RAISED REFLECTIVE MAVEMENT MARKERS SHALL NOT BE REQUIRED.

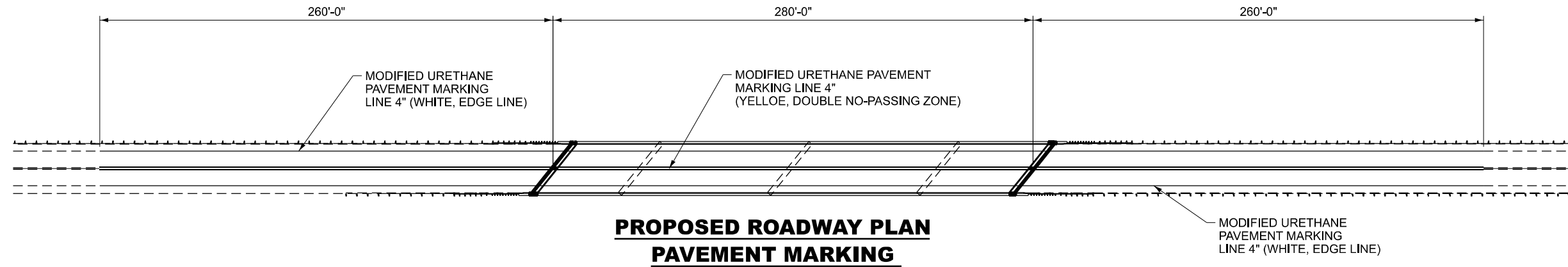
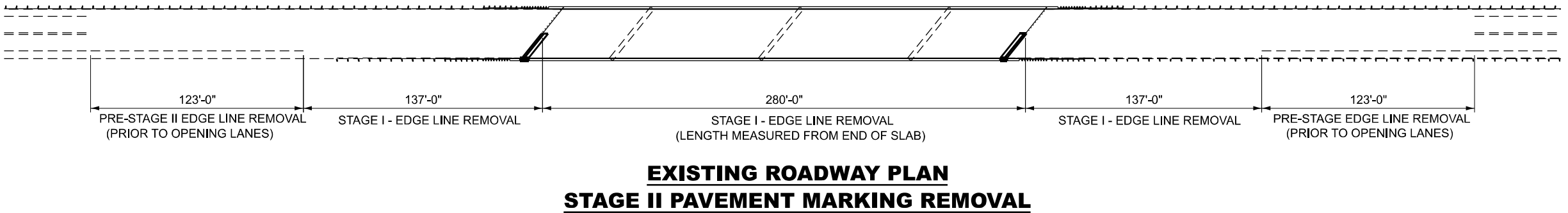
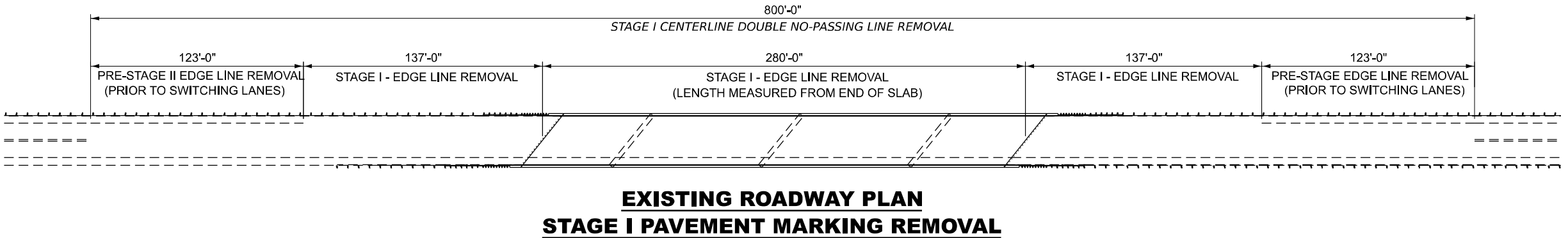
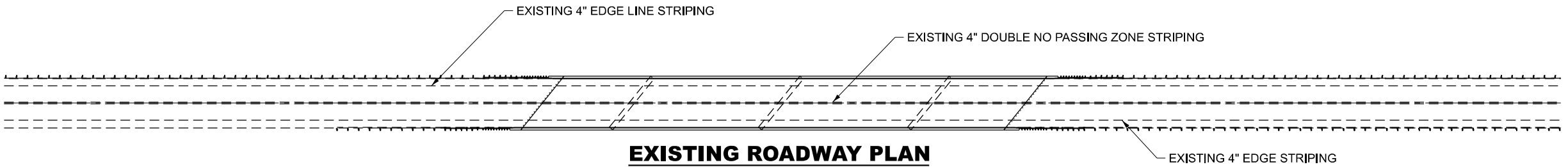

MODEL: Default
FILE NAME: c:\p\work\pav\tdh\woodshank\td1095872\0366R60.dgn

USER NAME = ronald.woodshank	DESIGNED - RW	REVISED -
	DRAWN - RW	REVISED -
	CHECKED - JS	REVISED -
PLOT DATE = 7/8/2025	DATE - 4/28/2025	REVISED -

STATE OF ILLINOIS
DEPARTMENT OF TRANSPORTATION

PAVEMENT MARKING

SCALE: SHEET 1 OF 1 SHEETS STA. TO STA.

F.A.I. RTE.	SECTION	COUNTY	TOTAL SHEETS	SHEET NO.
80	(06-4HB-1)BRR	BUREAU	23	14
CONTRACT NO. 66R60				
ILLINOIS FED. AID PROJECT				

EXISTING STRUCTURE:

Structure No. 006-0116. Built as F.A.S. 244 (Backbone Rd.)
grade separation over F.A.I. 80 (I-80) in 1963.
New deck in 2006 with modified wing walls.
Consists of 4 spans of continuous non-composite wide flange
beams. 280'-6" Bk. to Bk. Abutments. 31'-8" Out to Out of deck.
7½" thick concrete deck. supported on pile bent abutments and 3 piers.

SCOPE OF WORK

1. REMOVE EXISTING CONCRETE SUPERSTRUCTURE
2. REMOVE EXISTING CONCRETE SUBSTRUCTURE
3. REMOVE EXISTING HOT-MIX ASPHALT PAVEMENT
4. REMOVE EXISTING ROCKER BEARING ASSEMBLIES
5. INSTALL STRIP SEAL EXPANSION JOINT
6. CONSTRUCT CONCRETE SUPERSTRUCTURE
7. CONSTRUCT CONCRETE SUBSTRUCTURE
8. INSTALL ELASTOMERIC BEARING WITH STEEL EXTENSION

GENERAL NOTES

Plan dimensions and details relative to the existing structure have been taken from existing plans are subject to nominal construction variations. The Contactor shall field verify existing dimensions and details affecting new construction and make necessary approved adjustments prior to construction or ordering of materials. Such variations shall not be cause for additional compensation for a change in scope of the work, however, the Contractor will be paid for the quantity actually furnished at the unit price bid for the work.

All structural steel shall be AASHTO M270, Grade 36unless otherwise noted and shall be galvanized. See Special Provision for :Hot Dip Galvanizing for Structural Steel. Reinforcement bars designated (E) shall be epoxy coated.

Two ¼ in. adjusting shims shall be provided for each bearing in addition to all other plates or shims and placed as shown on bearing details.

Fasteners shall be ASTM F 3125 Grade A325 Type 1. Fasteners shall be Hot Dip Galvanized. See Special Provision for "Hot Dip Galvanizing for Str4uctural Steel."

Existing reinforcement shall be cleaned, straightened, and incorporated into the new construction. Cost included with Concrete Removal.

Prior to pouring the new concrete deck, all heavy or loose rust, loose mill scale, and other loose detrimental foreign material shall be removed from the surfaces in contact with concrete (SSPC-SP3 standards). Tightly adhered paint may remain unless otherwise noted. Removal shall be accomplished by methods that will not damage the steel and the cost will be paid for according to Article 109.04 of the Standard Specifications.

As directed by the Engineer, existing construction accessories welded to the top flange of beams and girders shall be removed. The weld areas shall be ground flush and inspected for cracks using magnetic particle testing (MT) or dye penetrant testing (PT) by qualified personnel approved by the Engineer. Any cracks that cannot be removed by grinding ¼ in. deep shall be identified and reported to the Bureau of Bridges & Structures for further disposition. The cost of removing welded accessories, grinding and inspecting weld areas and grinding cracks will be paid for according to Article 109.04 of the Standard Specifications.

TOTAL BILL OF MATERIAL
FOR TWO ABUTMENTS

ITEM	UNIT	TOTAL
Concrete Removal	Cu Yd	10.2
Jack and Remove Existing Bearings	Each	10
Concrete Superstructure	Cu Yd	10.4
Anchor Bolts 1" Ø	Each	20
Reinforcement Bars Epoxy Coated	Pound	1800
Preformed Joint Strip seal	Foot	76
Elastomeric Bearing Assembly, Type II	Each	10
Furnishing and Erecting Structural Steel	Pound	1620
Bar Splicers	Each	26
Mechanical Splicers	Each	18

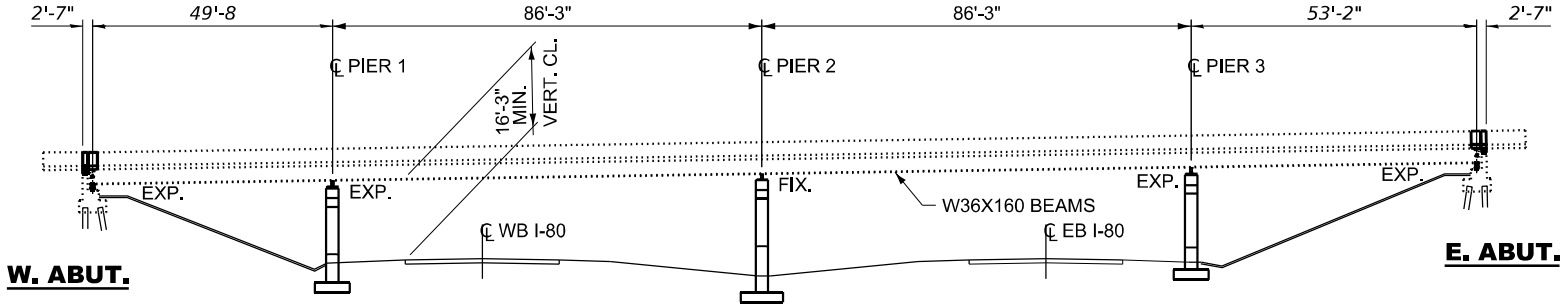

ELEVATION

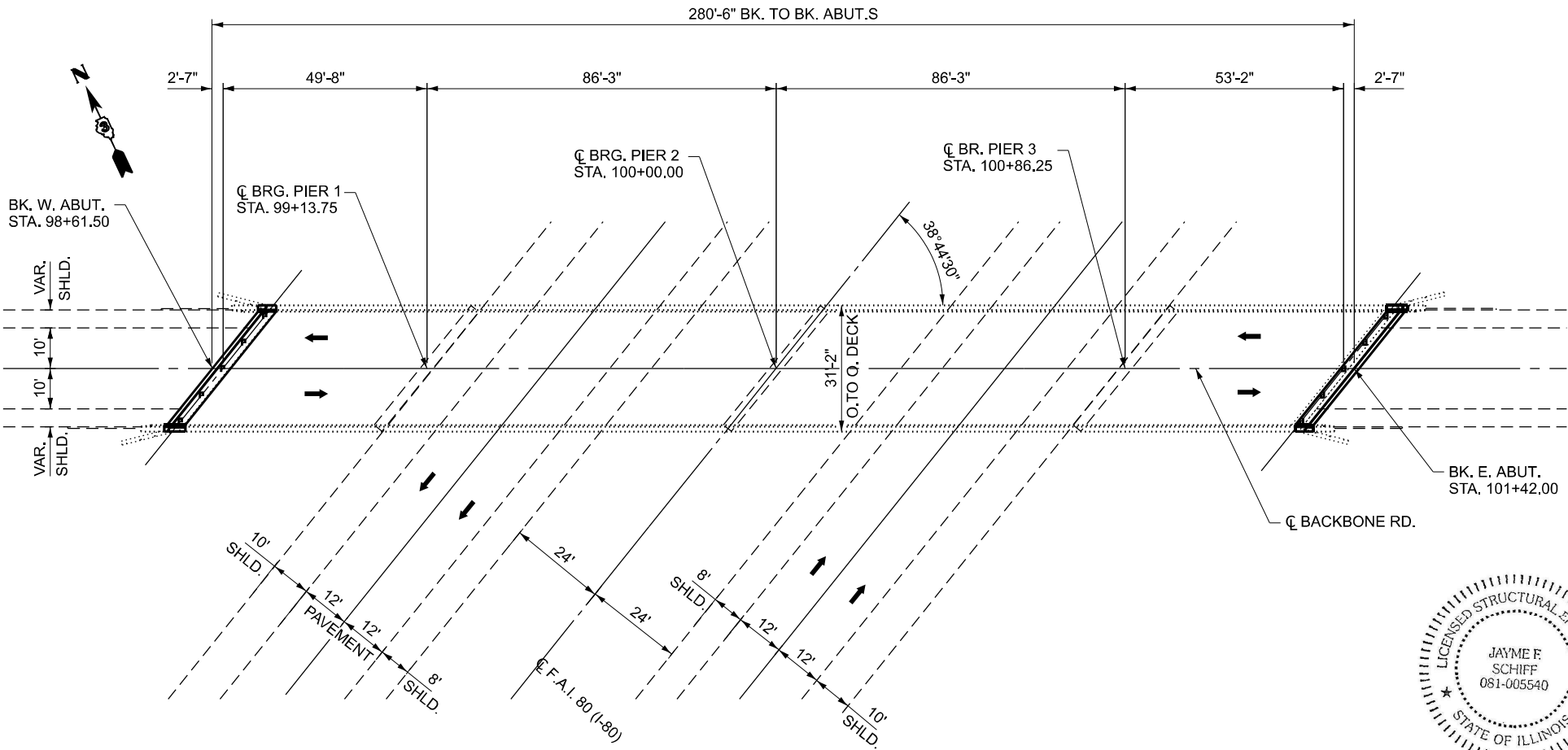

PLAN
STRUCTURE NO. 006-0116

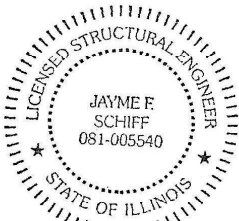

EXPIRES 11-30-2026

Jayme F. Schiff

MODEL: Default
FILE NAME: c:\pwworking\woodshank\1095872\0366R60.dgn

USER NAME = ronald.woodshank	DESIGNED - RW	REVISED -
	DRAWN - RW	REVISED -
	CHECKED - JS	REVISED -
PLOT DATE = 7/8/2025	DATE - 4/28/2025	REVISED -

STATE OF ILLINOIS
DEPARTMENT OF TRANSPORTATION

GENERAL PLANS AND ELEVATION
STRUCTURE NO. 006-0116

SCALE: SHEET 1 OF 9 SHEETS STA. TO STA.

F.A.I. RTE.	SECTION	COUNTY	TOTAL SHEETS	SHEET NO.
80	(06-4HB-1)BRR	BUREAU	23	15
CONTRACT NO. 66R60				
ILLINOIS FED. AID PROJECT				

MODEL: Default
FILE NAME: c:\pwworking\woodshank\rd1095872\0366R60.dgn

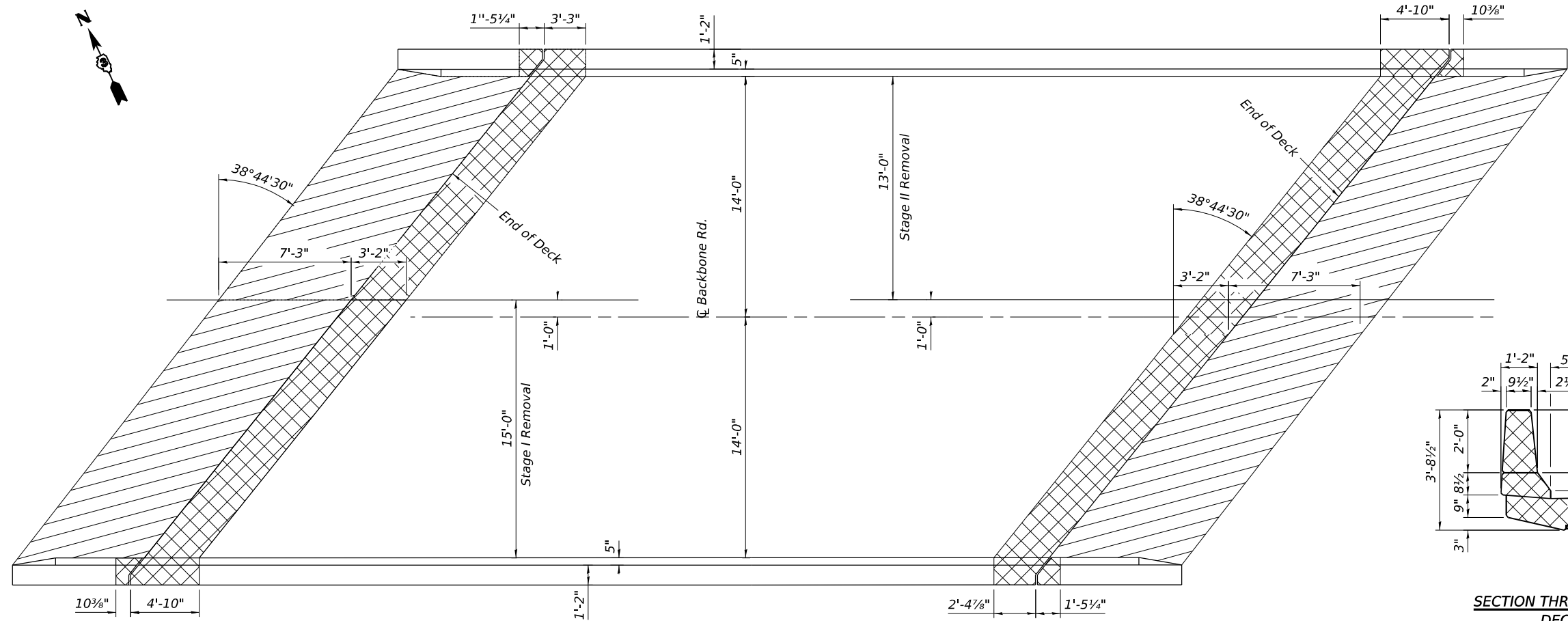

DECK PLAN
WEST ABUTMENT

DECK PLAN
EAST ABUTMENT

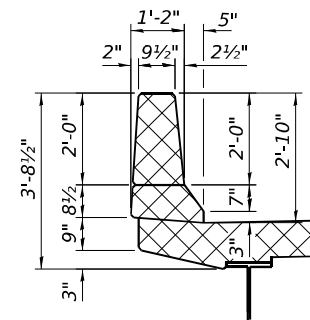
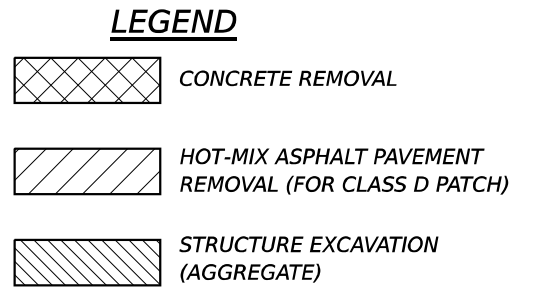

SECTION THRU PARAPET
DECK

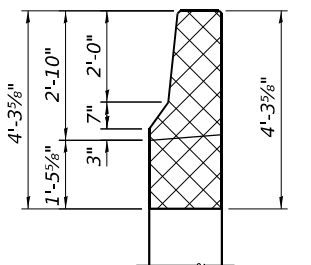

SECTION THRU PARAPET
ABUTMENT

Note:
Existing vertical reinforcement bars in the abutment parapet shall be cut off a minimum of 6" above concrete removal line for mechanical splicers.

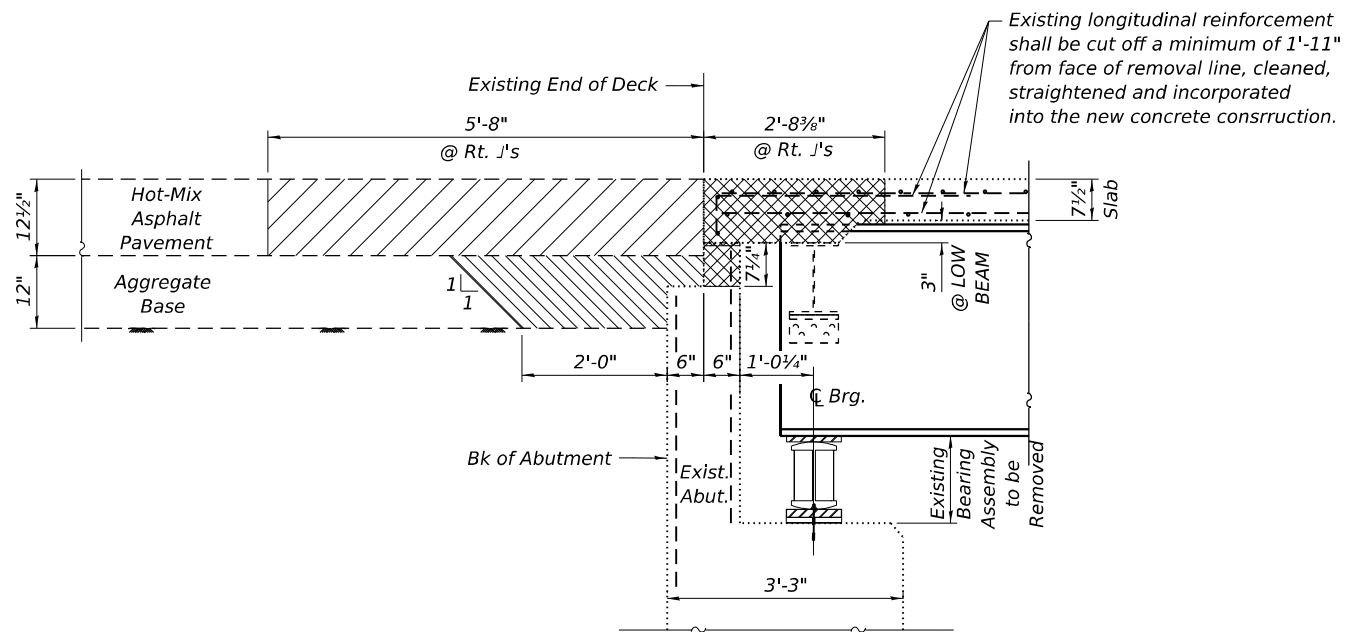

SECTION THRU WEST ABUTMENT

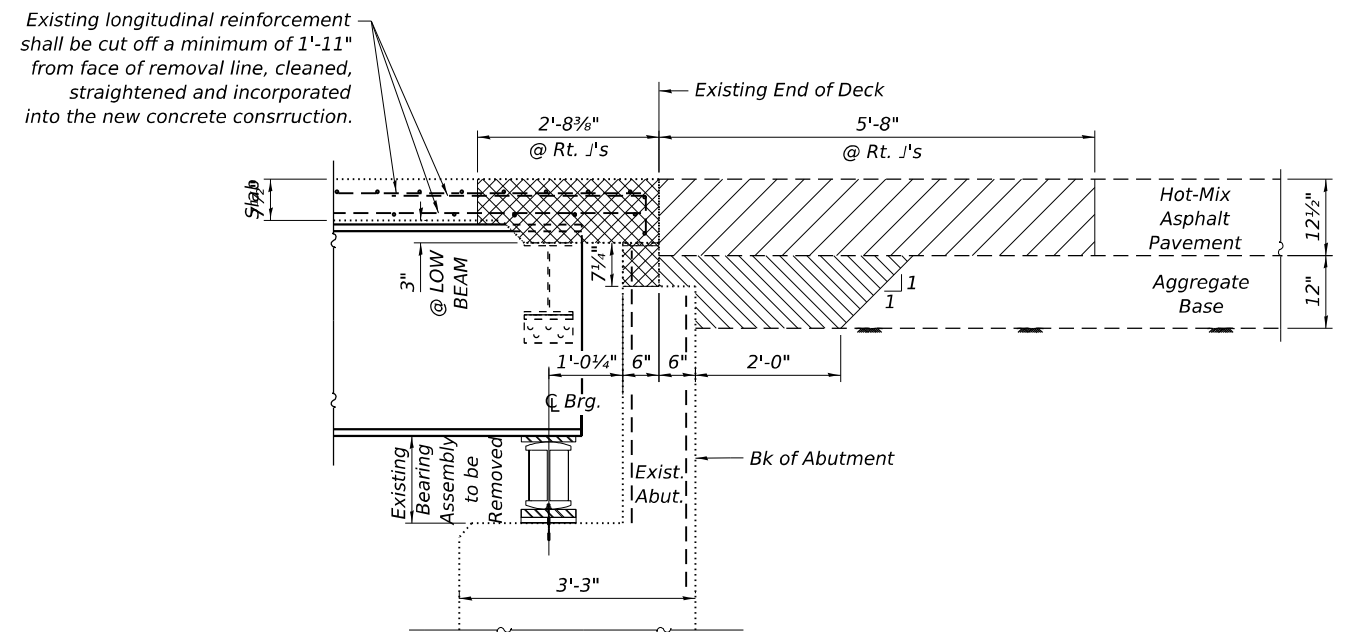

SECTION THRU EAST ABUTMENT

STATE OF ILLINOIS
DEPARTMENT OF TRANSPORTATION

REMOVAL DETAILS - DECK
STRUCTURE NO. 006-0116

SCALE: SHEET 2 OF 9 SHEETS STA. TO STA.

F.A.I. RTE.	SECTION	COUNTY	TOTAL SHEETS	SHEET NO.
80	(06-4HB-1)BRR	BUREAU	23	16
CONTRACT NO. 66R60				
ILLINOIS FED. AID PROJECT				

USER NAME = ronald.woodshank	DESIGNED - RW	REVISED -
	DRAWN - RW	REVISED -
	CHECKED - JS	REVISED -
PLOT DATE = 7/8/2025	DATE - 4/28/2025	REVISED -

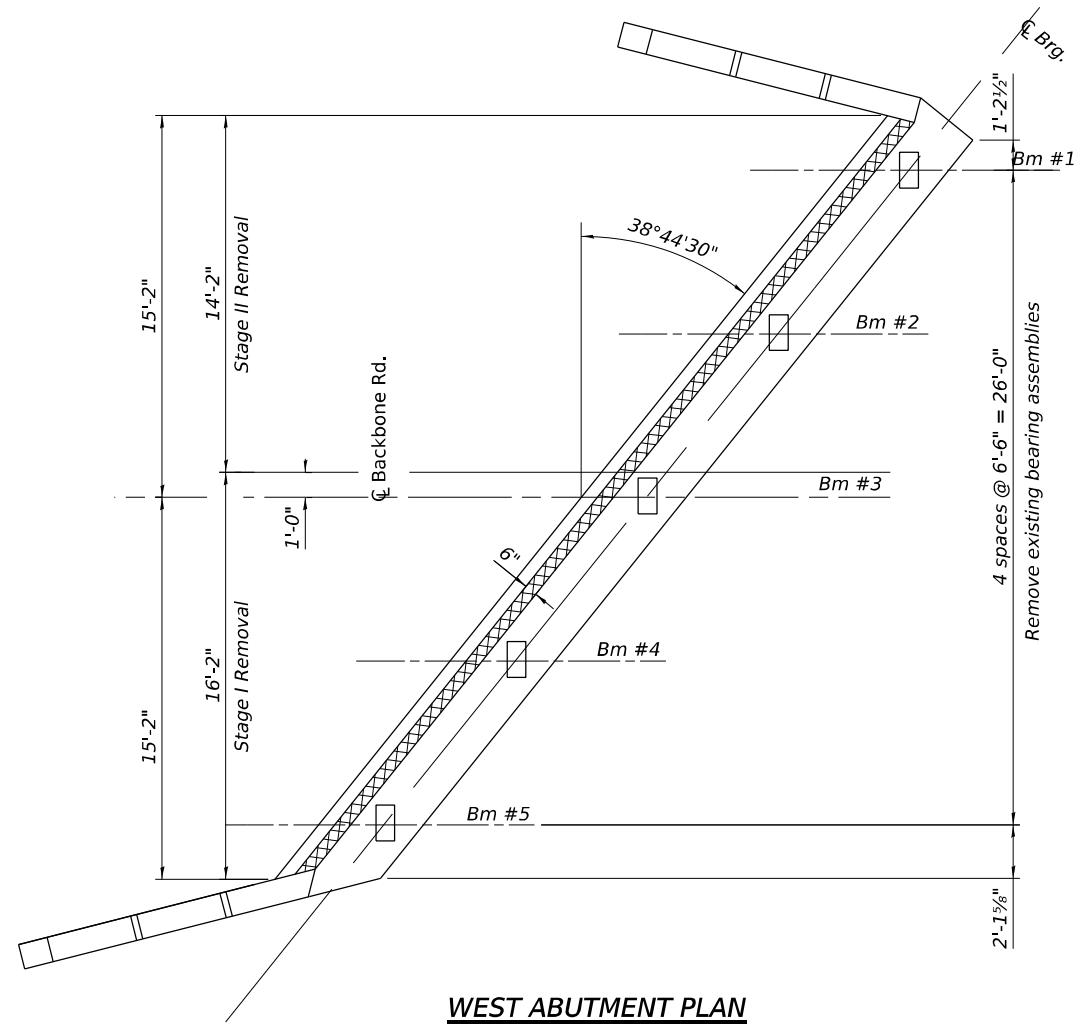

WEST ABUTMENT PLAN

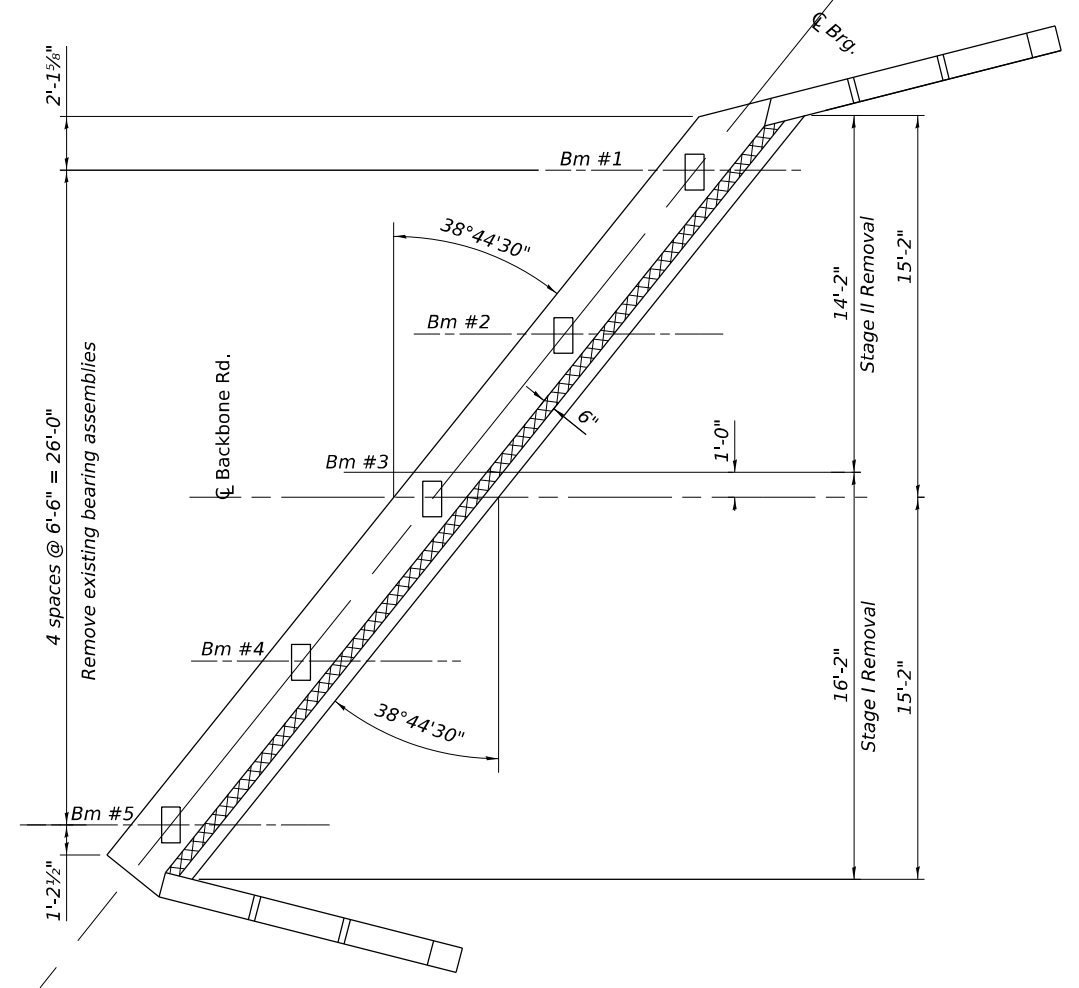

EAST ABUTMENT PLAN

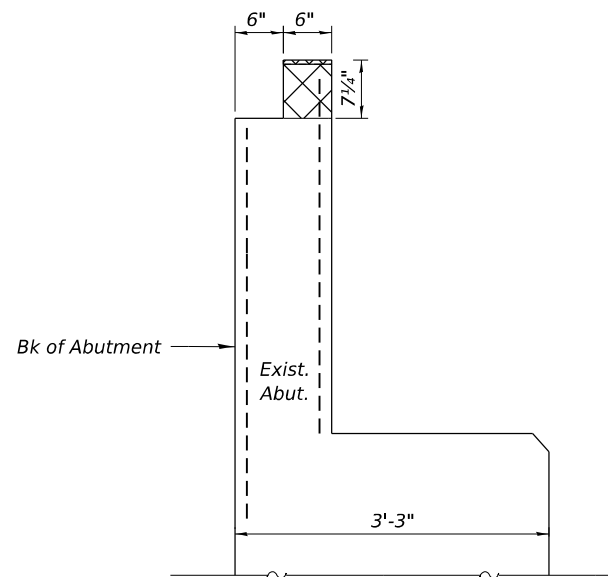

SECTION AT ABUTMENT

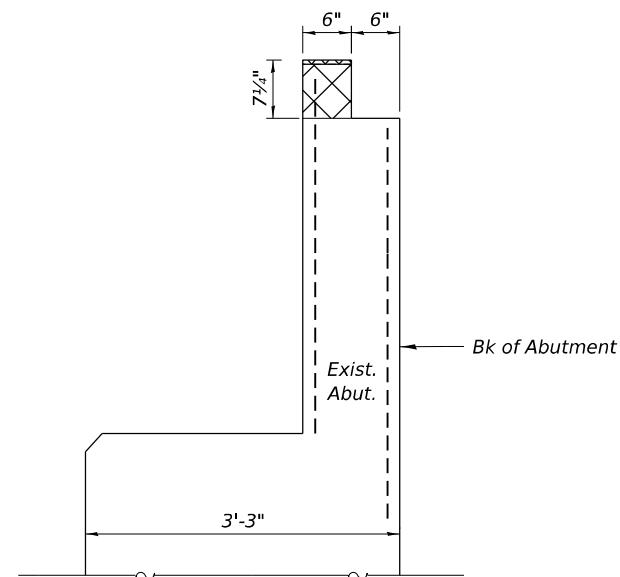
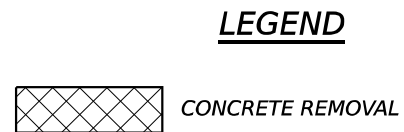

SECTION AT ABUTMENT

MODEL: Default
FILE NAME: c:\p\work\p\woodshank\1055872\0366R60.dgn

USER NAME = ronald.woodshank	DESIGNED - RW	REVISED -
	DRAWN - RW	REVISED -
	CHECKED - JS	REVISED -
PLOT DATE = 7/8/2025	DATE - 4/28/2025	REVISED -

**STATE OF ILLINOIS
DEPARTMENT OF TRANSPORTATION**

**REMOVAL DETAILS - ABUTMENTS
STRUCTURE NO. 006-0116**

SCALE: SHEET 3 OF 9 SHEETS STA. TO STA.

F.A.I. RTE.	SECTION	COUNTY	TOTAL SHEETS	SHEET NO.
80	(06-4HB-1)BRR	BUREAU	23	17
CONTRACT NO. 66R60				
ILLINOIS FED. AID PROJECT				

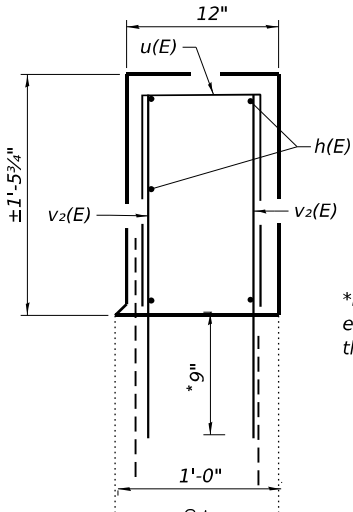
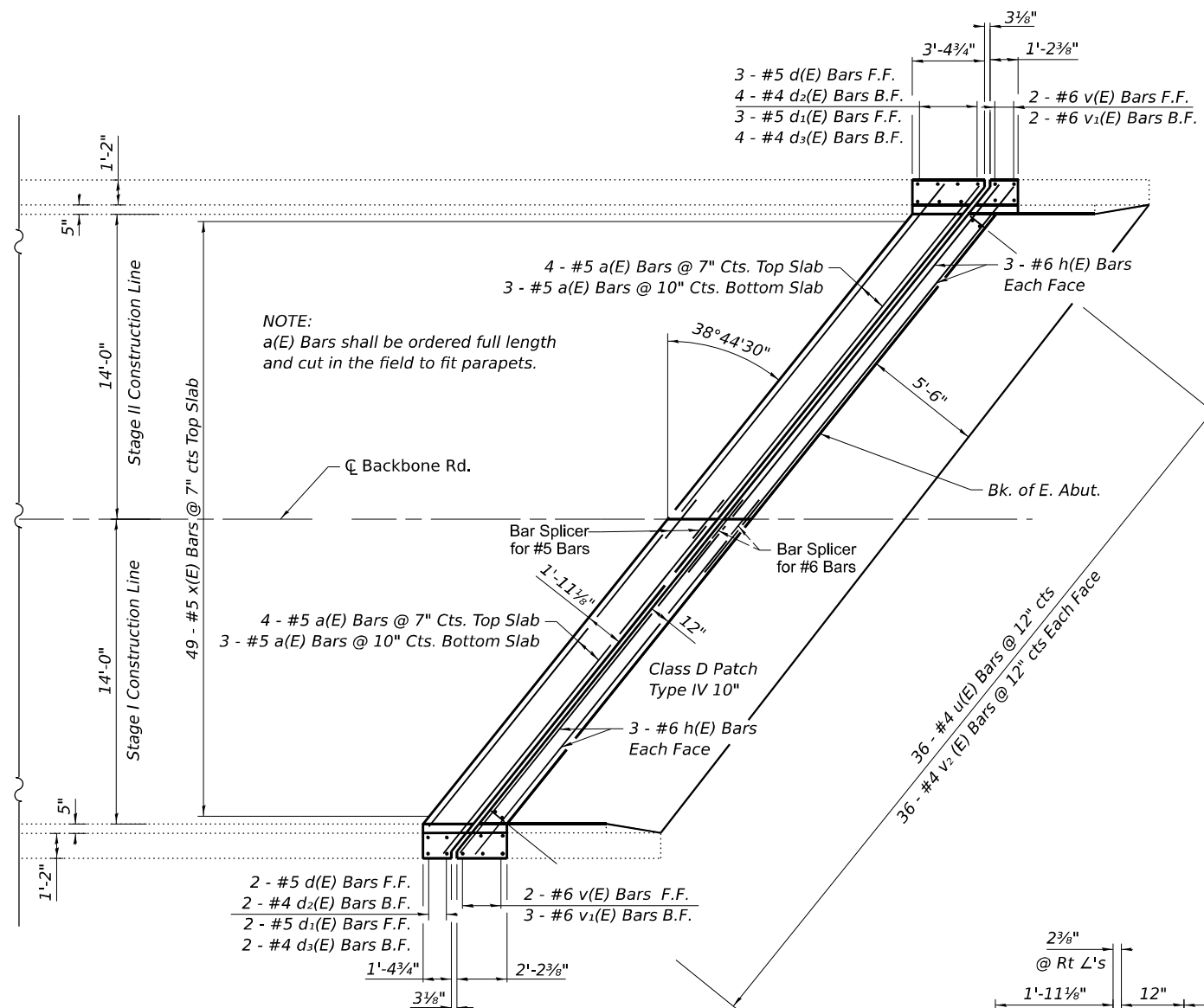

DECK PLAN
EAST ABUTMENT

*Drill and Grout v(E) bars a minimum of 9" into existing concrete according to Section 584 of the Standard Specifications.

**Elastomeric Bearing Assembly with Steel Extension

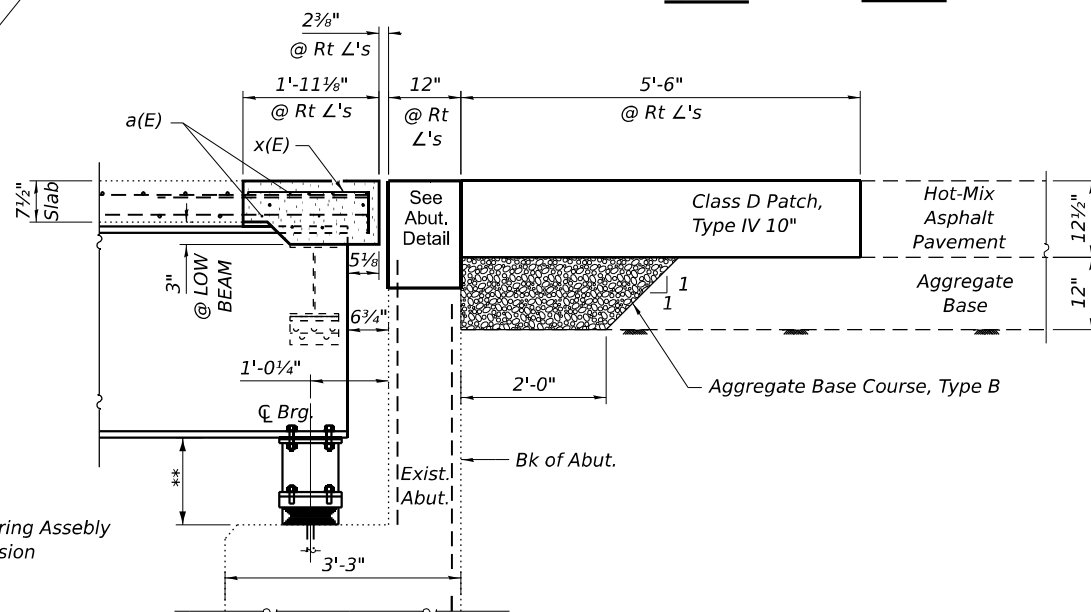

SECTION THRU EAST ABUTMENT

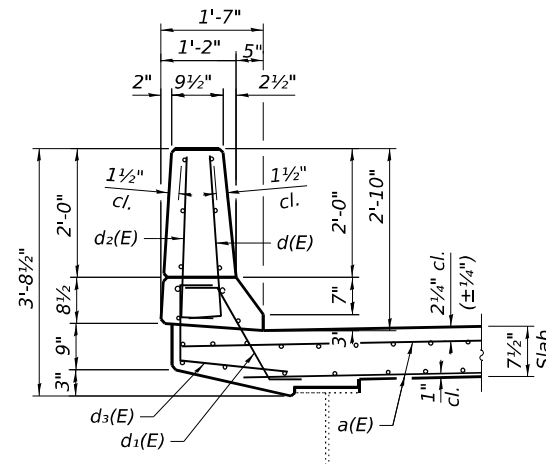

SECTION THRU PARAPET
DECK

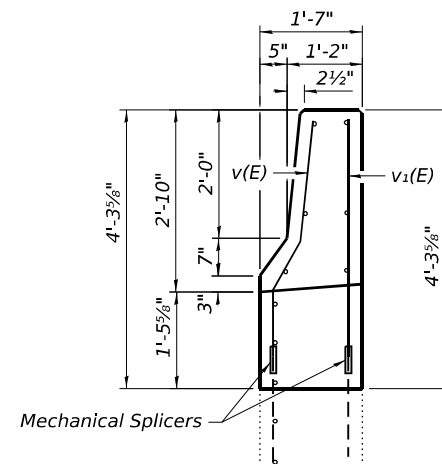

SECTION THRU PARAPET
ABUTMENT

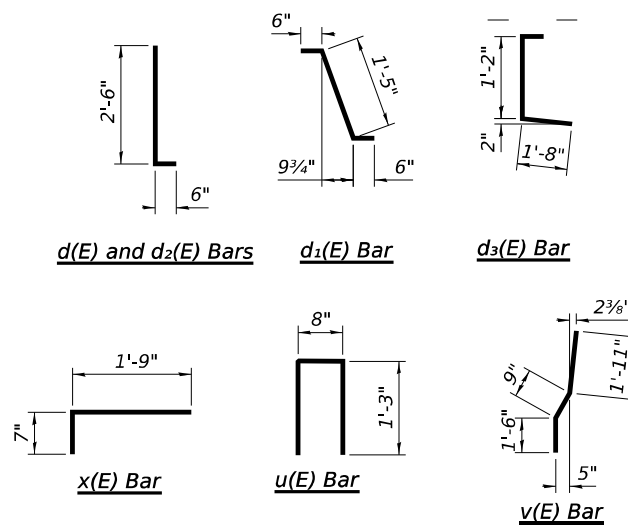

BILL OF MATERIAL
EAST ABUTMENT

Bar	No.	Size	Length	Shape
a(E)	14	#5	19'-8"	
d(E)	5	#5	3'-0"	
d1(E)	5	#5	2'-5"	
d2(E)	6	#4	3'-0"	
d3(E)	6	#4	3'-4"	
h(E)	12	#6	17'-7"	
u(E)	36	#4	3'-2"	
v(E)	4	#6	4'-2"	
v1(E)	5	#6	3'-9"	
v2(E)	72	#4	2'-1"	
x(E)	28	#5	2'-4"	
Concrete Removal		Cu Yd	5.1	
Concrete Superstructure		Cu Yd	5.2	
Reinforcement Bars, Epoxy Coated		Lbs.	900	

Reinforcement designated thus (E) shall be Epoxy Coated.

STATE OF ILLINOIS
DEPARTMENT OF TRANSPORTATION

CONSTRUCTION DETAILS - EAST ABUTMENT
STRUCTURE NO. 006-0116

SCALE: SHEET 5 OF 9 SHEETS STA. TO STA.

F.A.I. RTE.	SECTION	COUNTY	TOTAL SHEETS	SHEET NO.
80	(06-4HB-1)BRR	BUREAU	23	19
CONTRACT NO. 66R60				
ILLINOIS FED. AID PROJECT				

USER NAME = ronald.woodshank	DESIGNED - RW	REVISED -
	DRAWN - RW	REVISED -
	CHECKED - JS	REVISED -
PLOT DATE = 7/8/2025	DATE - 4/28/2025	REVISED -

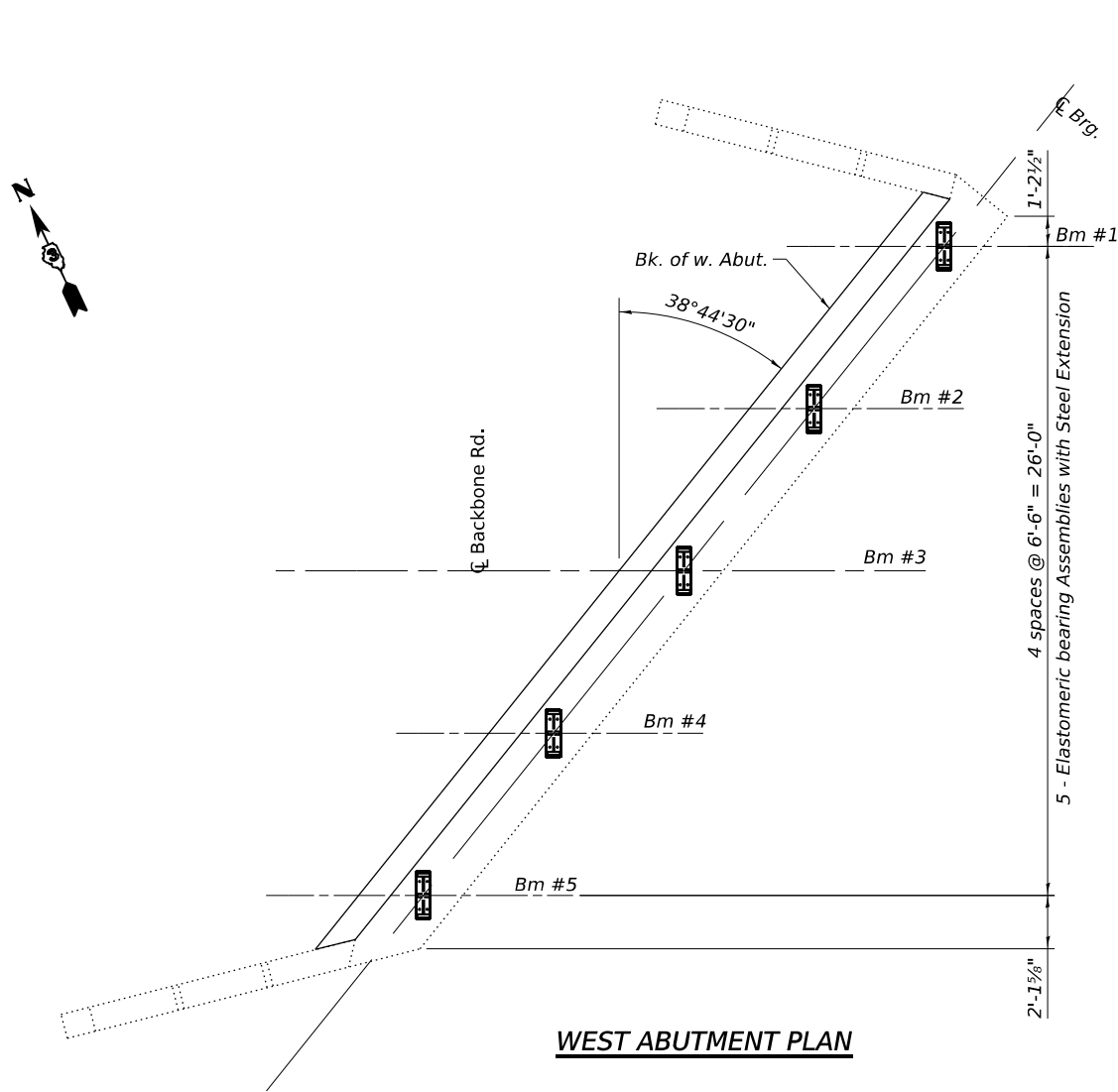

WEST ABUTMENT PLAN

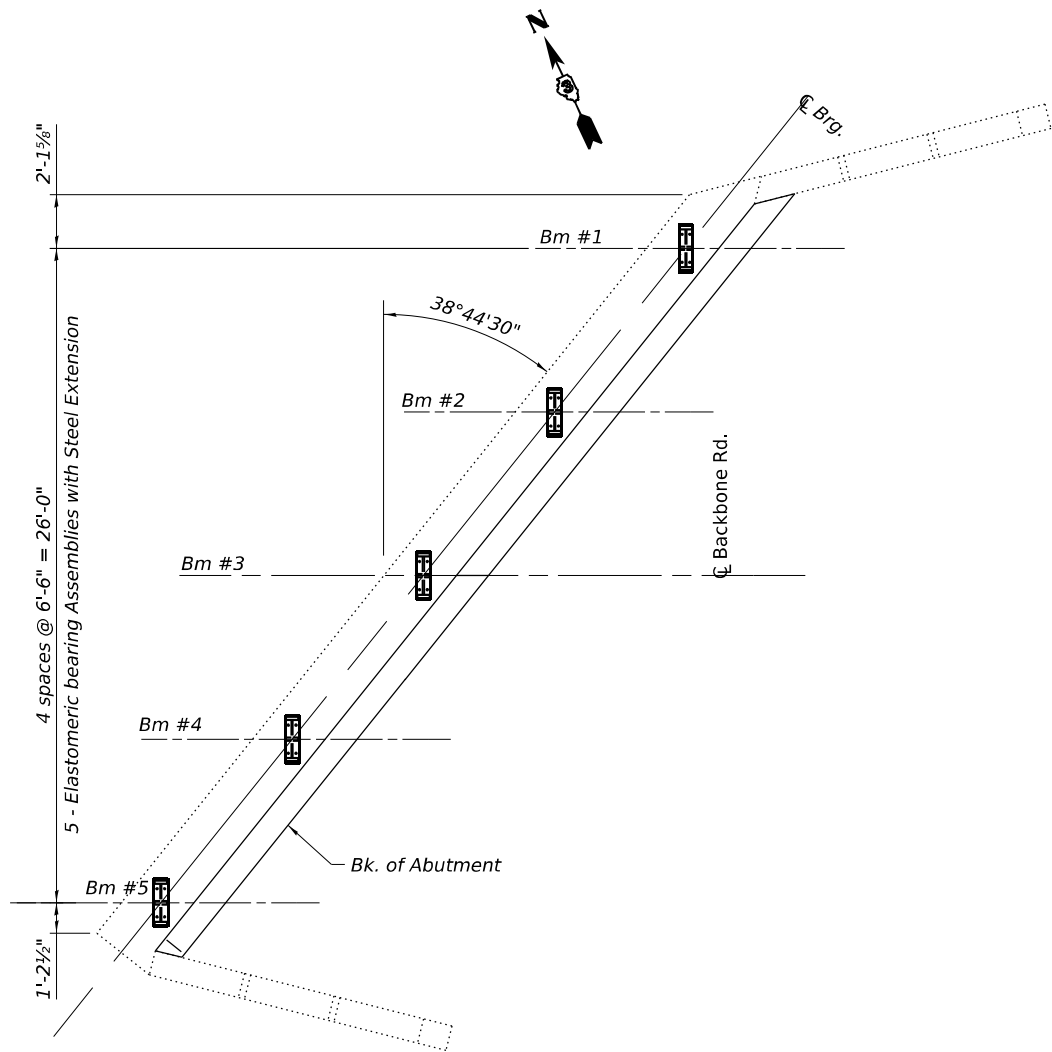

EAST ABUTMENT PLAN

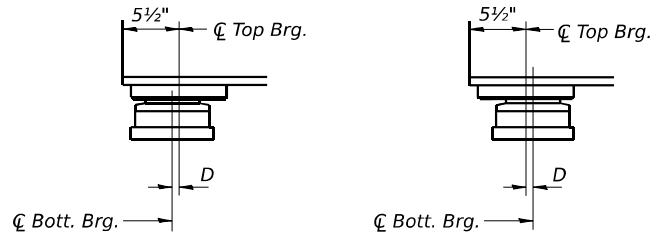

EXPANSION BEARING ORIENTATION
The above diagrams are for informational purposes only to show the amount of expected offset "D" for the current temperature in the field.

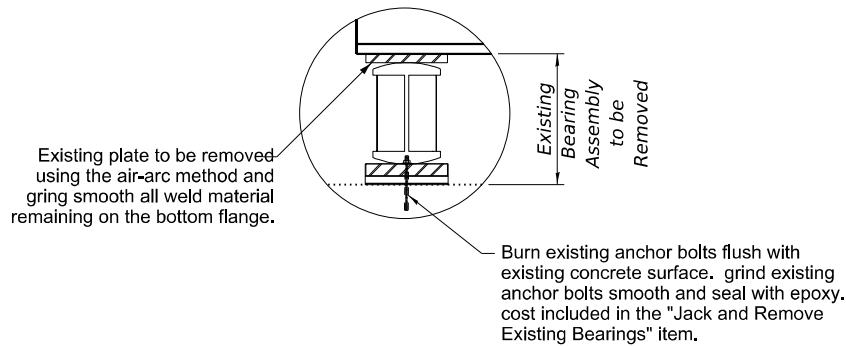

BEARING REMOVAL

**WEST ABUTMENT
BILL OF MATERIAL**

Item	Unit	Total
Elastomeric Bearing Assembly, Type II	Each	5
Jack and Remove Existing Bearings	Each	5
Furnishing and Erecting Structural Steel	Pound	810
Anchor Bolts, 1" Ø	Each	10

**EAST ABUTMENT
BILL OF MATERIAL**

Item	Unit	Total
Elastomeric Bearing Assembly, Type II	Each	5
Jack and Remove Existing Bearings	Each	5
Furnishing and Erecting Structural Steel	Pound	810
Anchor Bolts, 1" Ø	Each	10

MODEL: Default
FILE NAME: c:\p\work\p\woodshank\1055872\0366R60.dgn

USER NAME = ronald.woodshank	DESIGNED - RW	REVISED -
	DRAWN - RW	REVISED -
	CHECKED - JS	REVISED -
PLOT DATE = 7/8/2025	DATE - 4/28/2025	REVISED -

**STATE OF ILLINOIS
DEPARTMENT OF TRANSPORTATION**

**ELASTOMERIC BEARING DETAILS - ABUTMENTS
STRUCTURE NO. 006-0116**

SCALE: SHEET 6 OF 9 SHEETS STA. TO STA.

F.A.I. RTE.	SECTION	COUNTY	TOTAL SHEETS	SHEET NO.
80	(06-4HB-1)BRR	BUREAU	23	20
CONTRACT NO. 66R60				
ILLINOIS FED. AID PROJECT				

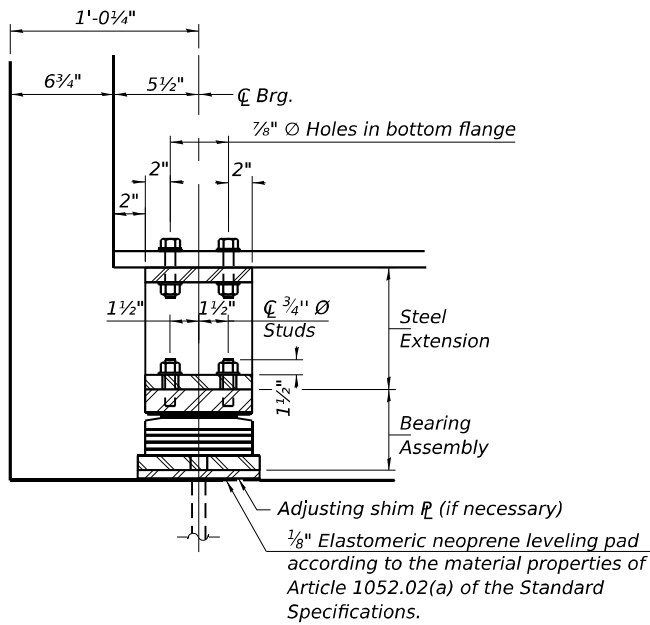

ELEVATION AT ABUT.

TYPE II ELASTOMERIC EXP. BRG.

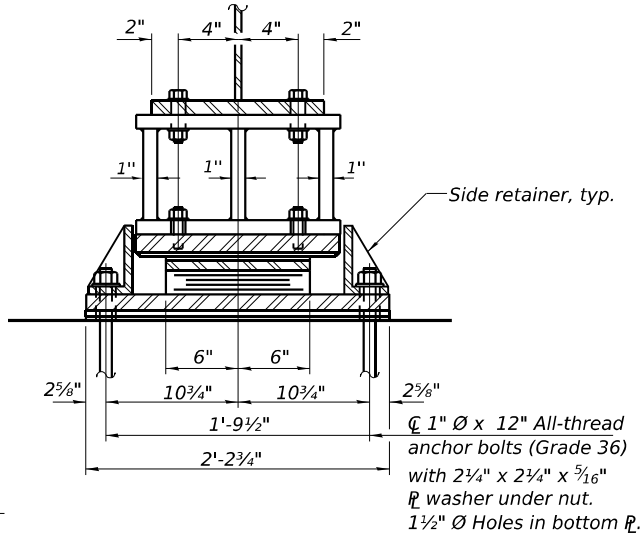

SECTION A-A

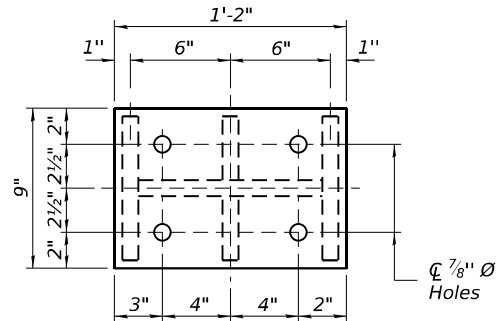

PLAN TOP AND BOTTOM PLATE

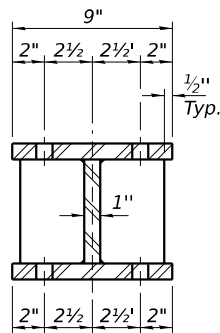

SECTION B-B

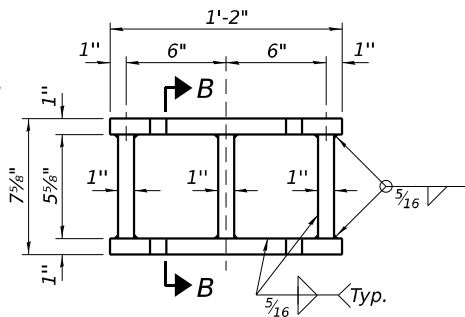

STEEL EXTENSION DETAIL

BEAM REACTIONS

	W. Abut	E. Abut
R \bar{p}	(K) 15.5	17.7
R \bar{t}	(K) 33.4	34.0
Imp.	(K) 9.6	9.5
R (Total)	(K) 58.5	61.2

TABLE OF "t" DIMENSIONS

Location	Bm #1	Bm #2	Bm #3	Bm #4	Bm #5
\bar{C} Brg W. Abut.	1/4"	—	—	—	—
\bar{C} Brg E. Abut.	—	3/8"	7/8"	7/8"	—

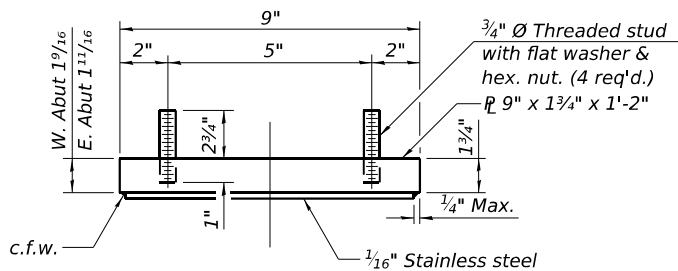

TOP BEARING ASSEMBLY

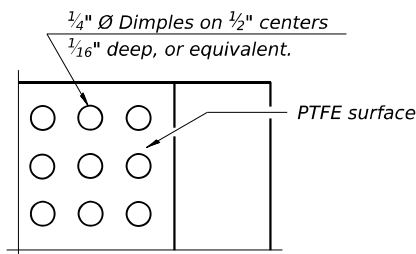

PLAN-PTFE SURFACE

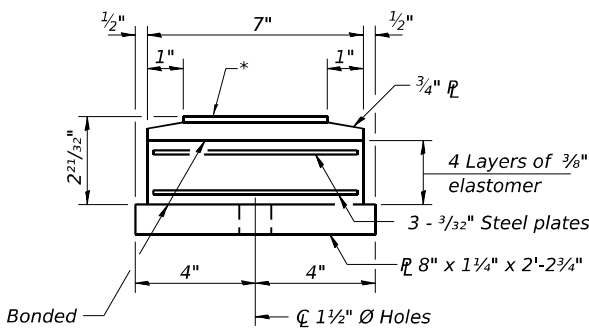

BOTTOM BEARING ASSEMBLY

*1/8" PTFE dimpled, unlubricated.

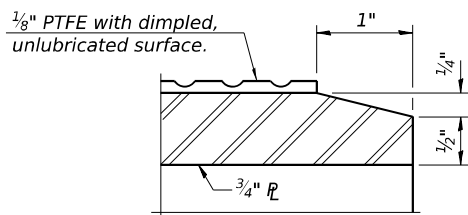

SECTION THRU PTFE

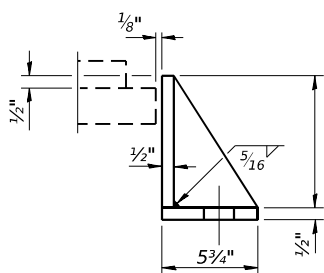

SIDE RETAINER

Equivalent rolled angle with stiffeners will be allowed in lieu of welded plates.

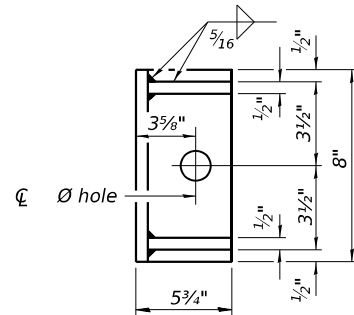

Notes:

Side retainers and leveling pad required for the elastomeric bearing assembly shall be included in the cost of Elastomeric Bearing Assembly, Type II.

The 1/8" PTFE sheet shall be bonded directly to the top steel plate with a two-component, medium viscosity epoxy resin, conforming to the requirements of the Federal Specification MMM-A-134, Type I. The bond agent shall be applied on the full area of the contact surfaces. Bonding of 1/8" PTFE sheet during vulcanizing process will be permitted provided the process and method of adjusting assembly height is approved by the Engineer.

Anchor bolts and side retainers at all supports shall be installed as each member is erected unless an equivalent temporary means of lateral restraint is used.

Diaphragm removal and reinstallation may be required to facilitate drilling holes. Cost included with Furnishing and Erecting Structural Steel.

New steel extensions, shim plates and connection bolts are included with Furnishing and Erecting Structural Steel. Prior to ordering any material, the Contractor shall verify in the field all bearing height and shim thickness dimensions. Adjustment must account for deck heave due to pack rust (if present).

Min. jack capacity = 30 Tons.

Anchor bolts shall be ASTM F1554 all-thread (or an Engineer-approved alternate material) of the grade(s) and diameter(s) specified. ASTM A307 Grade C anchor bolts may be used in lieu of ASTM F1554 Grade 36 (Fy=36ksi). The corresponding specified grade of AASHTO M314 anchor bolts may be used in lieu of ASTM F1554.

Drilled and set anchor bolts shall be installed according to Article 521.06 of the Standard Specifications. Cost of Side retainers and Stainless Steel plates shall be included in the cost of Elastomeric Bearing Assembly, Type II.

USER NAME	= ronald.woodshank	DESIGNED	- RW	REVISED	-
		DRAWN	- RW	REVISED	-
		CHECKED	- JS	REVISED	-
PLOT DATE	= 7/8/2025	DATE	- 4/28/2025	REVISED	-

F.A.I. RTE.	SECTION	COUNTY	TOTAL SHEETS	SHEET NO.
80	(06-4HB-1)BRR	BUREAU	23	21
CONTRACT NO. 66R60				
ILLINOIS FED. AID PROJECT				

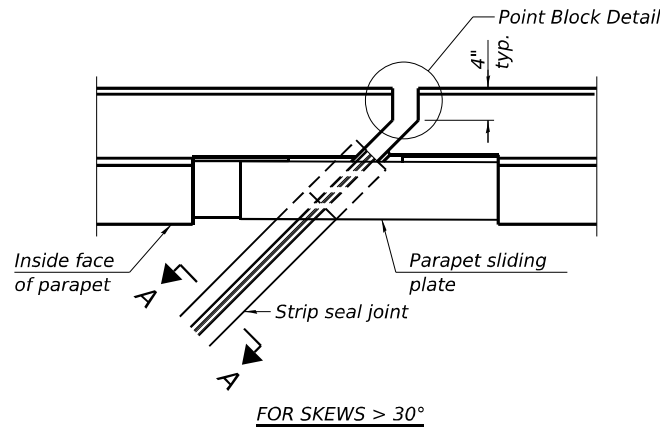

PLAN AT PARAPET

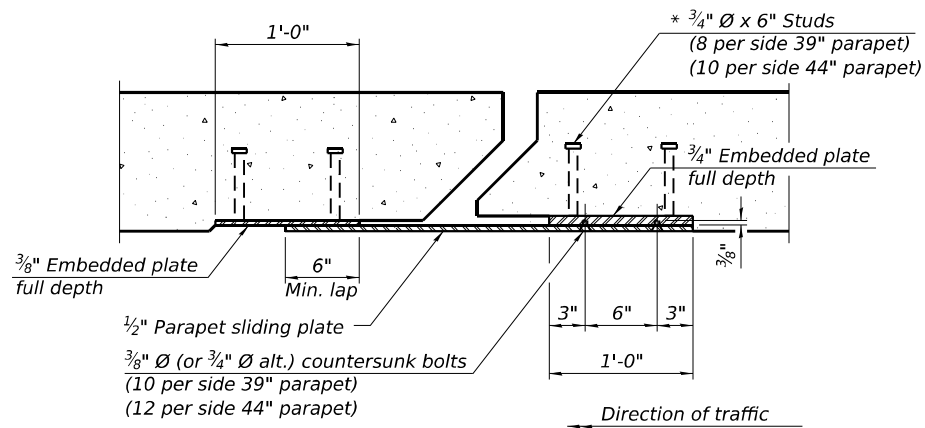

SECTION B-B

($\frac{3}{4}$ " \varnothing countersunk bolts extending into concrete shall have hex nuts tack welded to the back of the embedded plates with end caps provided.)

Notes:
The strip seal shall be made continuous and shall have a minimum thickness of $\frac{1}{4}$ ". The configuration of the strip seal shall match the configuration of the locking edge rails. Open or "webbed" strip seal gland configurations are not permitted. The gland shall be sized for a maximum rated movement of 4 inches.
The locking edge rails depicted are configured for typical applications and are conceptual only. The actual configuration of the locking edge rails and matching strip seal may vary from manufacturer to manufacturer provided they fit the application and meet the minimum anchorage shown. Flanged edge rails, however, will not be allowed. Locking edge rails may exceed the $4\frac{1}{2}$ " maximum depth provided the anchorage system is revised according to the manufacturer's recommendation.
The manufacturer's recommended installation methods shall be followed.

All steel components shall be galvanized after fabrication according to Article 520.03 of the Standard Specifications.
The Maximum space between locking edge rail segments shall be $\frac{3}{16}$ " and sealed with a suitable sealant; however, any rail joint within 10' measured perpendicular to the face of the curb or parapet shall be welded as shown in the locking edge rail splice detail.

Cost of parapet sliding plates, embedded plates, and anchorage studs included with Preformed Joint Strip Seal.
39" constant slope barrier shown, 44" constant slope barrier similar as noted.

The concrete opening below the strip seal will vary based on the locking edge rail chosen by the Contractor. Deck and parapet lengths shown elsewhere in the plans are dimensioned to the concrete opening, not the joint opening, and are based on the rolled locking edge rail. If the Contractor elects to use a different locking edge rail, dimensional adjustments may be required. One exception to this would be the strip seal joint at the end of the precast bridge approach slab. For these cases the pavement connector length shall be adjusted, not the length of the bridge approach slab.

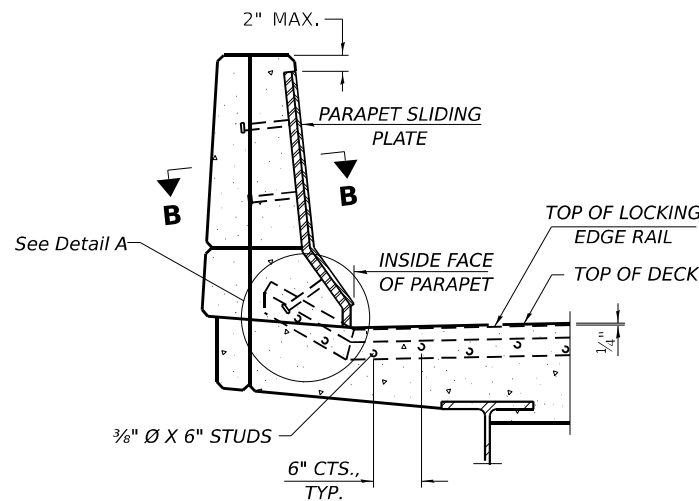

SECTION AT PARAPET

Skews > 30° shown.

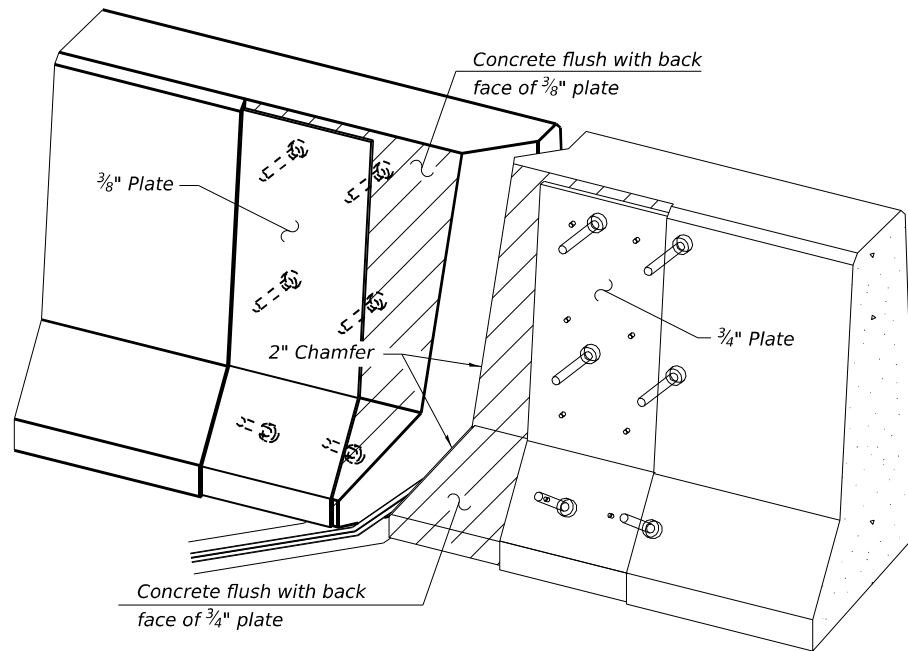

TRIMETRIC VIEW
(Showing embedded plates only)

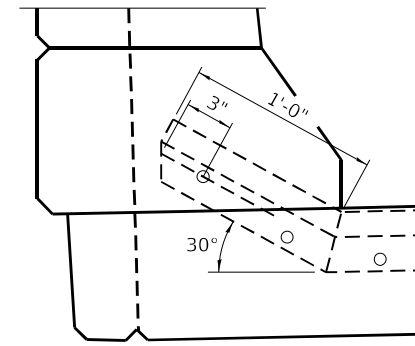

DETAIL A

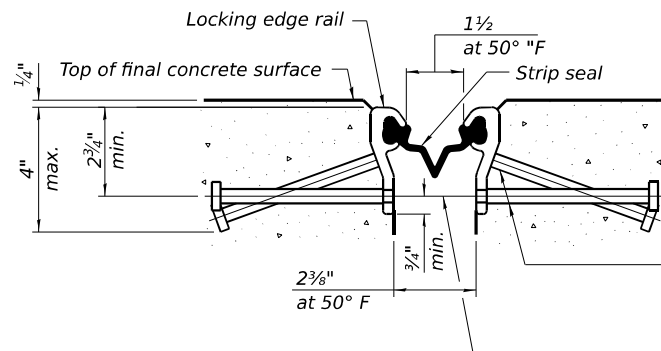

SHOWING ROLLED RAIL JOINT

* $\frac{5}{8}$ " \varnothing x 6" studs @ 6" cts. (alternate angled/bent studs with horizontal studs)

$\frac{3}{8}$ " \varnothing threaded rods in $\frac{7}{16}$ " \varnothing holes at 4'-0" \pm cts. for holding the proper joint opening based on the temperature during the deck pour. Place to miss studs. All rods shall be burned, or sawed off flush with the plates after concrete is set.

SECTION A-A

* Granular or solid flux filled headed studs conforming to Article 1006.32 of the Std. Specs., automatically end welded.

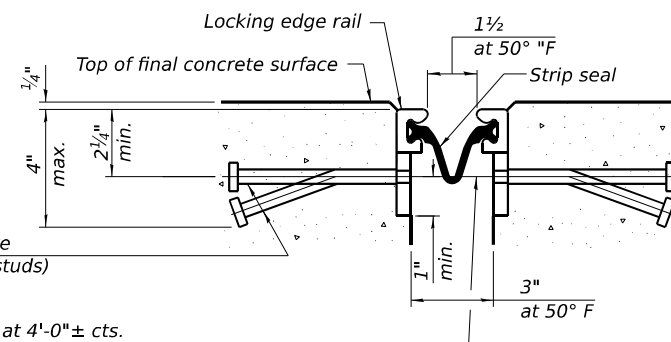

SHOWING WELDED RAIL JOINT

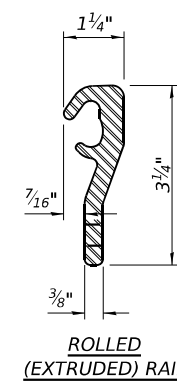

ROLLED (EXTRUDED) RAIL

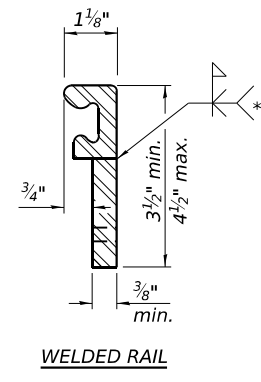

WELDED RAIL

LOCKING EDGE RAILS

** Back gouge not required if complete joint penetration is verified by mock-up.

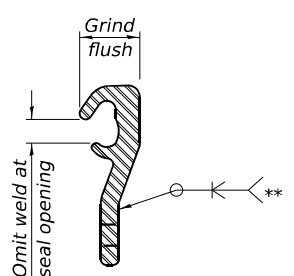

LOCKING EDGE RAIL SPLICE

The inside of the locking edge rail groove shall be free of weld residue.
Rolled rail shown, welded rail similar.

BILL OF MATERIAL
WEST ABUTMENT

Item	Unit	Total
Preformed Joint Strip Seal	Foot	38

BILL OF MATERIAL
EAST ABUTMENT

Item	Unit	Total
Preformed Joint Strip Seal	Foot	38

STATE OF ILLINOIS
DEPARTMENT OF TRANSPORTATION

ELASTOMERIC BEARING DETAILS
FOR STRUCTURE NO. 006-0116

SCALE: SHEET 8 OF 9 SHEETS STA. TO STA.

F.A.I. RTE.	SECTION	COUNTY	TOTAL SHEETS	SHEET NO.
80	(06-4HB-1)BRR	BUREAU	23	22
CONTRACT NO. 66R60				
ILLINOIS FED. AID PROJECT				

USER NAME = ronald.woodshank	DESIGNED - RW	REVISED -
	DRAWN - RW	REVISED -
	CHECKED - JS	REVISED -
PLOT DATE = 7/8/2025	DATE - 4/28/2025	REVISED -

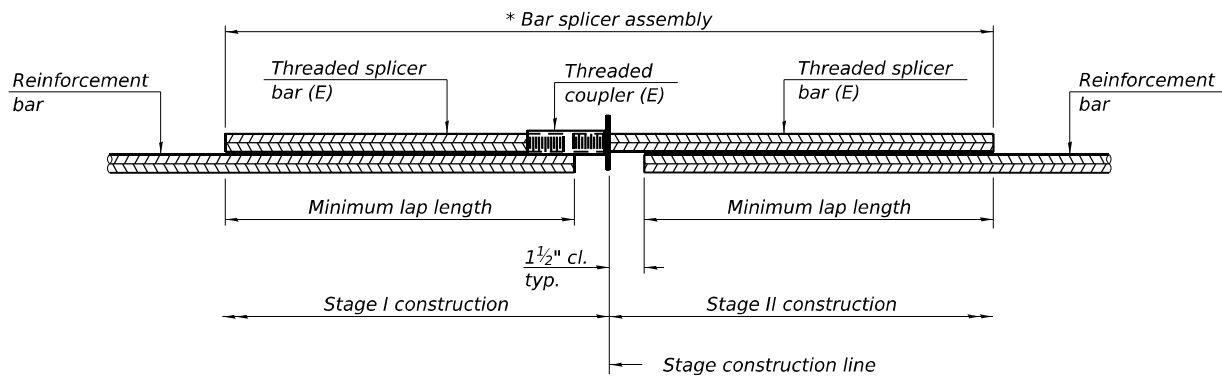

STANDARD BAR SPLICER ASSEMBLY PLAN

Only bar splicer assemblies as presented on the approved QPL list may be used.

Threaded splicer bar length = min. lap length + 1 1/2" + thread length

* Epoxy not required on Bar Splicer Assembly components used in conjunction with black bars.

Location	Bar size	No. assemblies required	Minimum lap length
West Abut. Deck	#5	7	3'-6"
East Abut. Deck	#5	7	3'-6"
West Abut.	#6	6	4'-0"
East Abut.	#6	6	4'-0"

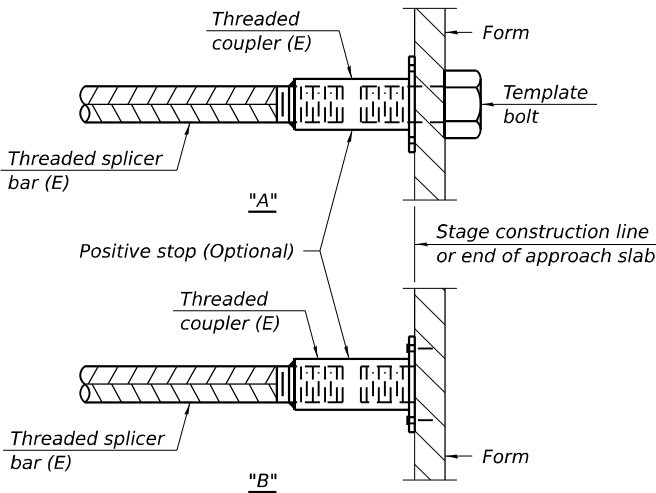

INSTALLATION AND SETTING METHODS

"A" : Set bar splicer assembly by means of a template bolt.

"B" : Set bar splicer assembly by nailing to wood forms or cementing to steel forms.

(E) : Indicates epoxy coating.

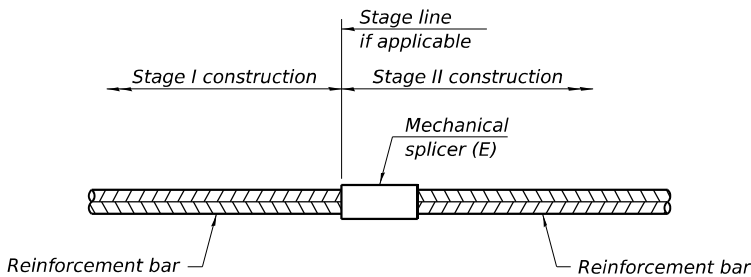

STANDARD MECHANICAL SPLICER

Location	Bar size	No. assemblies required
W. Abut. NE Corner	#6	5
W. Abut. NW Corner	#6	4
E. Abut. SE Corner	#6	4
E. Abut. SW Corner	#6	5

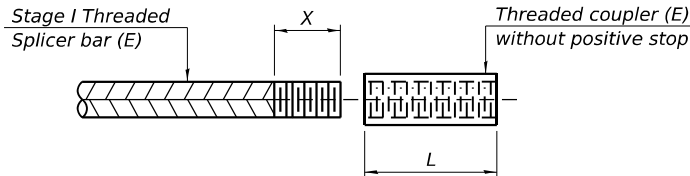

THREADING OF ASSEMBLIES

The threaded length "X" shall be no more than L/2. The bar should be tightened until 0-1 thread(s) is/are exposed.

Notes:
Splicer bars shall be deformed with threaded ends and have a minimum 60 ksi yield strength.
All reinforcement shall be lapped and tied to the splicer bars.
Bar splicer assemblies shall be epoxy coated according to the requirements for reinforcement bars. See Section 508 of the Standard Specifications.
See approved list of bar splicer assemblies and mechanical splicers for alternatives.

BSD-1

4-4-2025

STATE OF ILLINOIS
DEPARTMENT OF TRANSPORTATION

BAR SPLICER ASSEMBLY AND MECHANICAL SPLICER DETAILS
STRUCTURE NO. 006-0116

SCALE: SHEET 9 OF 9 SHEETS STA. TO STA.

F.A.I. RTE.	SECTION	COUNTY	TOTAL SHEETS	SHEET NO.
80	(06-4HB-1)BRR	BUREAU	23	23
CONTRACT NO. 66R60				
ILLINOIS FED. AID PROJECT				