

ALIGNMENT COORDINATES
W. 63rd STREET - S. STEWART AV. TO EAST OF S. WENTWORTH AV.

| 63rd STATION | N | E | |
|--------------|----------|--------------|--------------|
| POT | 10+00.00 | 1,863,159.83 | 1,174,638.25 |
| PC | 15+88.70 | 1,863,177.66 | 1,175,226.68 |
| PI | 16+04.07 | 1,863,178.12 | 1,175,242.04 |
| PT | 16+19.43 | 1,863,177.68 | 1,175,257.40 |
| PC | 17+77.70 | 1,863,173.08 | 1,175,415.61 |
| PI | 17+93.30 | 1,863,172.63 | 1,175,431.20 |
| PT | 18+08.89 | 1,863,173.10 | 1,175,446.79 |
| PC | 23+86.73 | 1,863,190.51 | 1,176,024.37 |
| PI | 24+06.91 | 1,863,191.11 | 1,176,044.54 |
| PT | 24+27.07 | 1,863,193.05 | 1,176,064.63 |
| PC | 25+01.29 | 1,863,200.17 | 1,176,138.51 |
| PI | 25+21.48 | 1,863,202.11 | 1,176,158.60 |
| PT | 25+41.65 | 1,863,202.75 | 1,176,178.78 |
| POT | 29+10.68 | 1,863,214.45 | 1,176,547.62 |

CURVE C1
PI STA. = 16+04.07
 $\Delta = 3^\circ 23' 57''$ (RT)
D = 11° 03' 40"
R = 517.99'
T = 15.37'
L = 30.73'
E = 0.23'
P.C. STA. = 15+88.70
P.T. STA. = 16+19.43

CURVE C2
PI STA. = 17+93.30
 $\Delta = 3^\circ 23' 26''$ (LT)
D = 10° 52' 17"
R = 527.04'
T = 15.60'
L = 31.19'
E = 0.23'
P.C. STA. = 17+77.70
P.T. STA. = 18+08.89

CURVE C3
PI STA. = 24+06.91
 $\Delta = 3^\circ 46' 39''$ (LT)
D = 9° 21' 49"
R = 611.89'
T = 20.18'
L = 40.34'
E = 0.33'
P.C. STA. = 23+86.73
P.T. STA. = 24+27.07

CURVE C4
PI STA. = 25+21.48
 $\Delta = 3^\circ 41' 13''$ (RT)
D = 9° 08' 06"
R = 627.21'
T = 20.19'
L = 40.36'
E = 0.32'
P.C. STA. = 25+01.29
P.T. STA. = 25+41.65

BENCHMARK #1
ELEV. 603.071'
CHISELED SQUARE ON THE
NORTHEAST CORNER OF CONCRETE
BASE FOR TRAFFIC CONTROL BOX
AT THE SOUTHEAST CORNER OF
W. 63rd STREET & S. WENTWORTH AVENUE
STATION 24+42.75, 42.63' RT.
N 1,863,152.12
E 1,176,084.33

BENCHMARK #2
ELEV. 601.095'
CHISELED CROSS ON CHAIN BOLT
OF HYDRANT AT THE SOUTHWEST CORNER
OF S. YALE AVENUE & W. 63rd STREET
STATION 19+20.27, 48.49' RT.
N 1,863,128.00
E 1,175,559.54

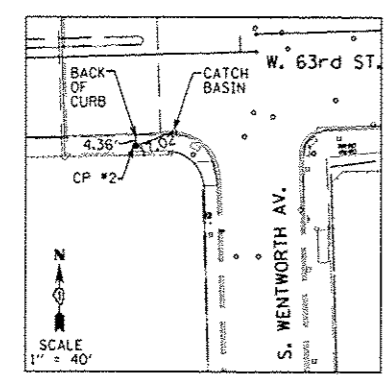

CONTROL POINT #2
CHISELED CROSS IN
CONCRETE WALK ON THE
SOUTH SIDE OF W. 63rd STREET
AT THE EAST END OF BRIDGE,
WEST OF S. WENTWORTH AVENUE
ELEV. 600.14'
STATION 23+55.39, 37.95' RT.
N 1,863,151.637
E 1,175,994.484

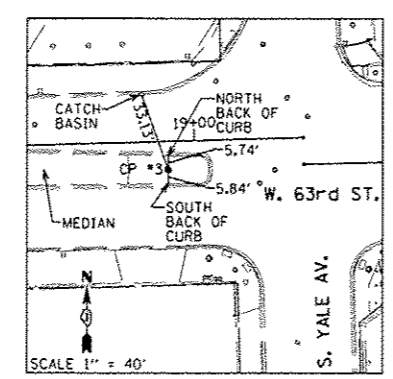

CONTROL POINT #3
CHISELED CROSS IN
CONCRETE MEDIAN ISLAND
30' WEST OF MEDIAN NOSE
WEST OF S. YALE AV.
IN W. 63rd STREET
ELEV. 600.25'
STATION 18+89.02, 11.77' RT.
N 1,863,174.983
E 1,175,527.219

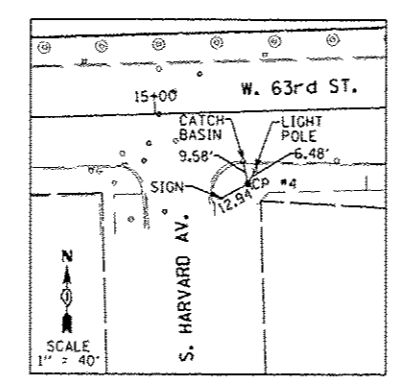

CONTROL POINT #4
CHISELED CROSS IN SIDEWALK
AT THE NE CORNER OF
S. HARVARD AVENUE & W. 63rd STREET
ELEV. 599.01'
STATION 15+37.90, 30.31' RT.
N 1,863,145.819
E 1,175,176.823

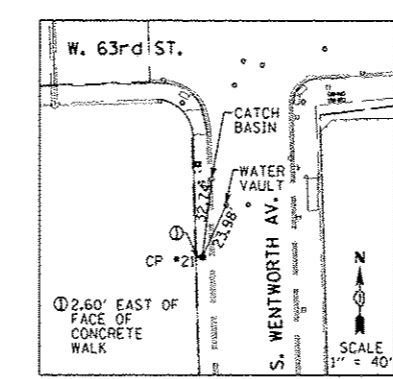

CONTROL POINT #21
CHISELED CROSS IN
CONCRETE WALK ON THE
WEST SIDE OF S. WENTWORTH AVENUE
66.20' SOUTH OF THE SOUTH LINE
OF W. 63rd STREET
ELEV. 600.92'
STATION 23+85.55, 106.76' RT.
N 1,863,083.76
E 1,176,026.70

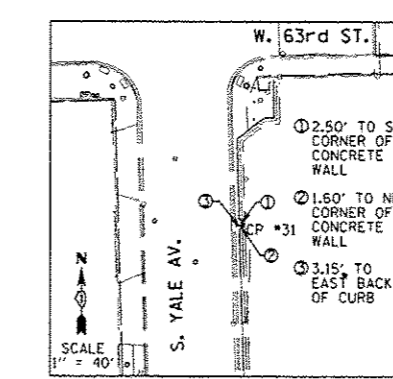

CONTROL POINT #31
CHISELED CROSS IN
CONCRETE WALK ON THE
EAST SIDE OF S. YALE AVENUE
62.00' SOUTH OF THE SOUTH LINE
OF W. 63rd STREET
ELEV. 599.65'
STATION 19+68.01, 102.78' RT.
N 1,863,075.16
E 1,175,609.23

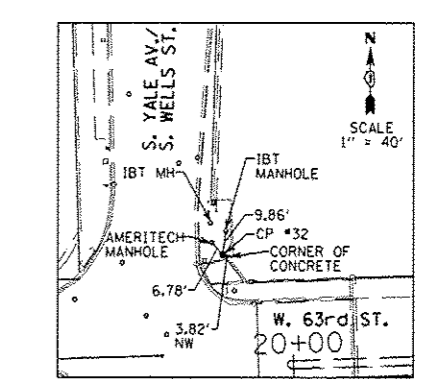

CONTROL POINT #32
CHISELED CROSS IN
CONCRETE WALK AT THE
NE CORNER OF
S. YALE AVENUE/S. WELLS STREET
& W. 63rd STREET
ELEV. 599.90'
STATION 19+71.80, 52.56' LT.
N 1,863,230.55
E 1,175,608.34

FILES 5/21/2013 10:15:4 AM

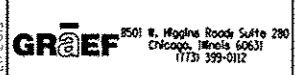

USER NAME - #766
DESIGNED - JSO
DRAWN - HJM
CHECKED - TNS
DATE - 03-15-2013
PLOT SCALE = 1/80,000 / IN.
PLOT DATE = 5/21/2013

REVISED -
REVISED -
REVISED -
REVISED -

STATE OF ILLINOIS
DEPARTMENT OF TRANSPORTATION

63rd STREET BRIDGE REPLACEMENT - COOK COUNTY
ALIGNMENT, TIES AND BENCHMARKS

SCALE: 1"=50' SHEET 1 OF 1 SHEETS STA. TO STA.

| F.A.I. RTE. | SECTION | COUNTY | TOTAL SHEETS | SHEET NO. |
|---------------------------|---------|--------|--------------|-----------|
| 94 | 1920-B | COOK | 137 | 10 |
| CONTRACT NO. 60J15 | | | | |
| ILLINOIS FED. AID PROJECT | | | | |