





LEGEND

-  STORM DRAIN PROTECTION CONSISTING OF DITCH CHECKS, TEMPORARY SEEDING AND EROSION CONTROL BLANKETS
-  PERIMETER EROSION BARRIER
-  TEMPORARY EROSION CONTROL SEEDING
-  TEMPORARY DITCH CHECK
-  PROPOSED DITCH

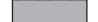

NOTES

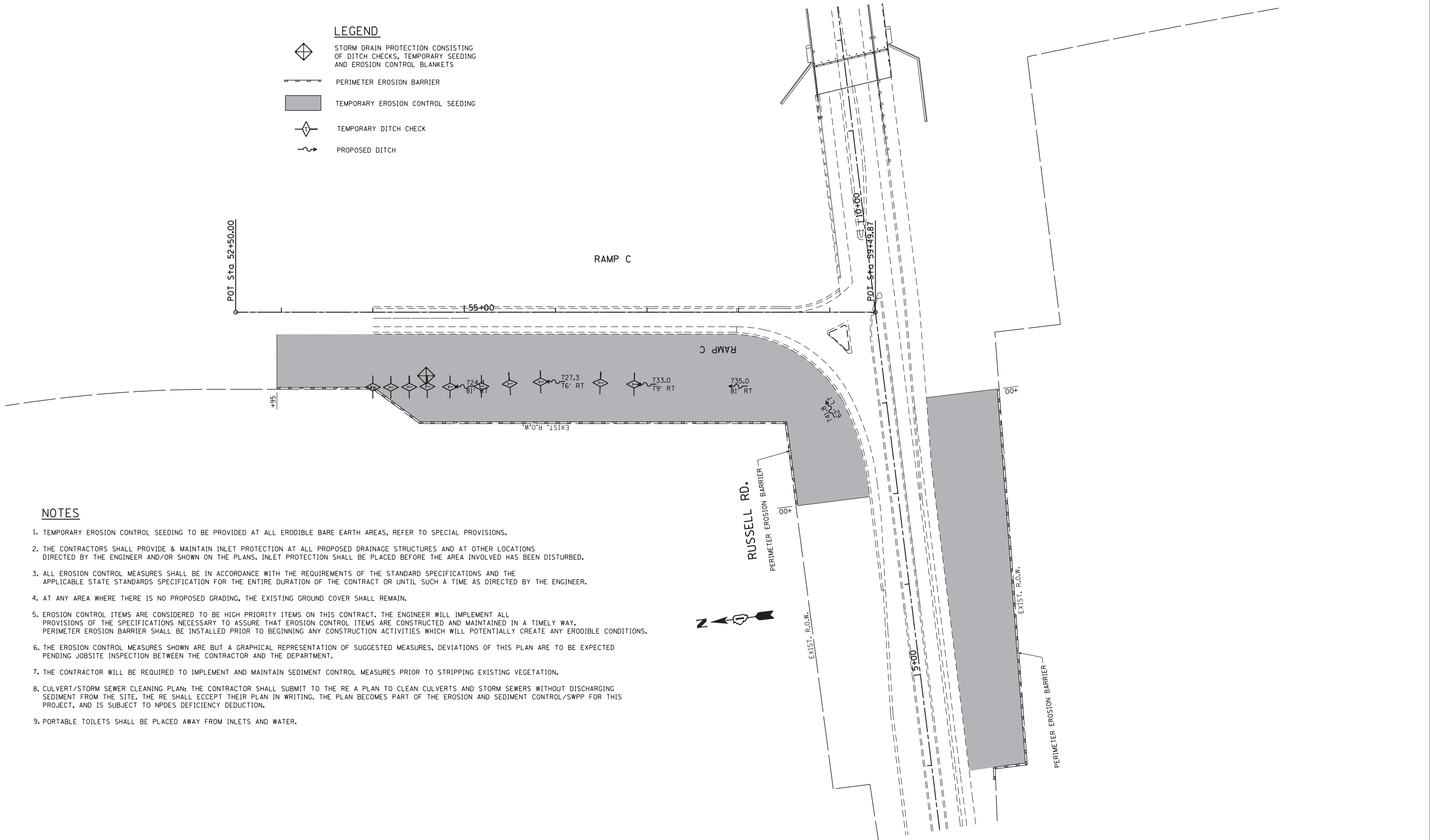
1. TEMPORARY EROSION CONTROL SEEDING TO BE PROVIDED AT ALL ERODIBLE BARE EARTH AREAS, REFER TO SPECIAL PROVISIONS.
2. THE CONTRACTORS SHALL PROVIDE & MAINTAIN INLET PROTECTION AT ALL PROPOSED DRAINAGE STRUCTURES AND AT OTHER LOCATIONS DIRECTED BY THE ENGINEER AND/OR SHOWN ON THE PLANS. INLET PROTECTION SHALL BE PLACED BEFORE THE AREA INVOLVED HAS BEEN DISTURBED.
3. ALL EROSION CONTROL MEASURES SHALL BE IN ACCORDANCE WITH THE REQUIREMENTS OF THE STANDARD SPECIFICATIONS AND THE APPLICABLE STATE STANDARDS SPECIFICATION FOR THE ENTIRE DURATION OF THE CONTRACT OR UNTIL SUCH A TIME AS DIRECTED BY THE ENGINEER.
4. AT ANY AREA WHERE THERE IS NO PROPOSED GRADING, THE EXISTING GROUND COVER SHALL REMAIN.
5. EROSION CONTROL ITEMS ARE CONSIDERED TO BE HIGH PRIORITY ITEMS ON THIS CONTRACT. THE ENGINEER WILL IMPLEMENT ALL PROVISIONS OF THE SPECIFICATIONS NECESSARY TO ASSURE THAT EROSION CONTROL ITEMS ARE CONSTRUCTED AND MAINTAINED IN A TIMELY WAY. PERIMETER EROSION BARRIER SHALL BE INSTALLED PRIOR TO BEGINNING ANY CONSTRUCTION ACTIVITIES WHICH WILL POTENTIALLY CREATE ANY ERODIBLE CONDITIONS.
6. THE EROSION CONTROL MEASURES SHOWN ARE BUT A GRAPHICAL REPRESENTATION OF SUGGESTED MEASURES, DEVIATIONS OF THIS PLAN ARE TO BE EXPECTED PENDING JOBSITE INSPECTION BETWEEN THE CONTRACTOR AND THE DEPARTMENT.
7. THE CONTRACTOR WILL BE REQUIRED TO IMPLEMENT AND MAINTAIN SEDIMENT CONTROL MEASURES PRIOR TO STRIPPING EXISTING VEGETATION.
8. CULVERT/STORM SEWER CLEANING PLAN: THE CONTRACTOR SHALL SUBMIT TO THE RE A PLAN TO CLEAN CULVERTS AND STORM SEWERS WITHOUT DISCHARGING SEDIMENT FROM THE SITE. THE RE SHALL EXCEPT THEIR PLAN IN WRITING. THE PLAN BECOMES PART OF THE EROSION AND SEDIMENT CONTROL/SWPP FOR THIS PROJECT, AND IS SUBJECT TO NPDES DEFICIENCY DEDUCTION.
9. PORTABLE TOILETS SHALL BE PLACED AWAY FROM INLETS AND WATER.

FILE NAME =	USER NAME = MaldonadoHM	DESIGNED -	REVISED -
et:\pw\work\p\dot\maldonadohm\d0350654\I-94@Russell-sht-cover.dgn		DRAWN -	REVISED -
Default	PLOT SCALE = 100.0000' / in.	CHECKED -	REVISED -
	PLOT DATE = 8/6/2013	DATE -	REVISED -

**STATE OF ILLINOIS
DEPARTMENT OF TRANSPORTATION**

**EROSION CONTROL /DRAINAGE PLAN
I-94 AT RUSSELL ROAD - RAMP C**

SCALE: 1"=50' SHEET OF SHEETS STA. TO STA.

F.A.I. RTE.	SECTION	COUNTY	TOTAL SHEETS	SHEET NO.
94	49-1-A	LAKE	16	5
CONTRACT NO. 60X05				
ILLINOIS FED. AID PROJECT				