

ROUTE NO.	SEC.	COUNTY	TOTAL SHEETS	SHEET NO.
FAS200	*	WHITESIDE	273	90
FED. ROAD DIST. NO. 7 ILLINOIS PROJECT				
* (141B136) WARS-2 & 141B-1				

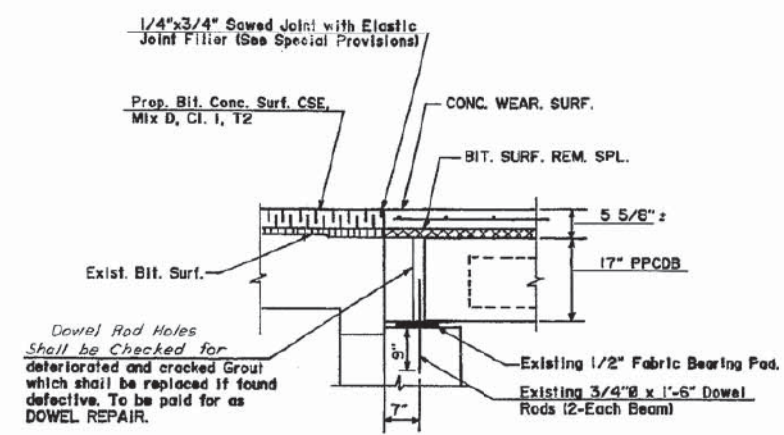

SEC. THRU NORTH ABUT.

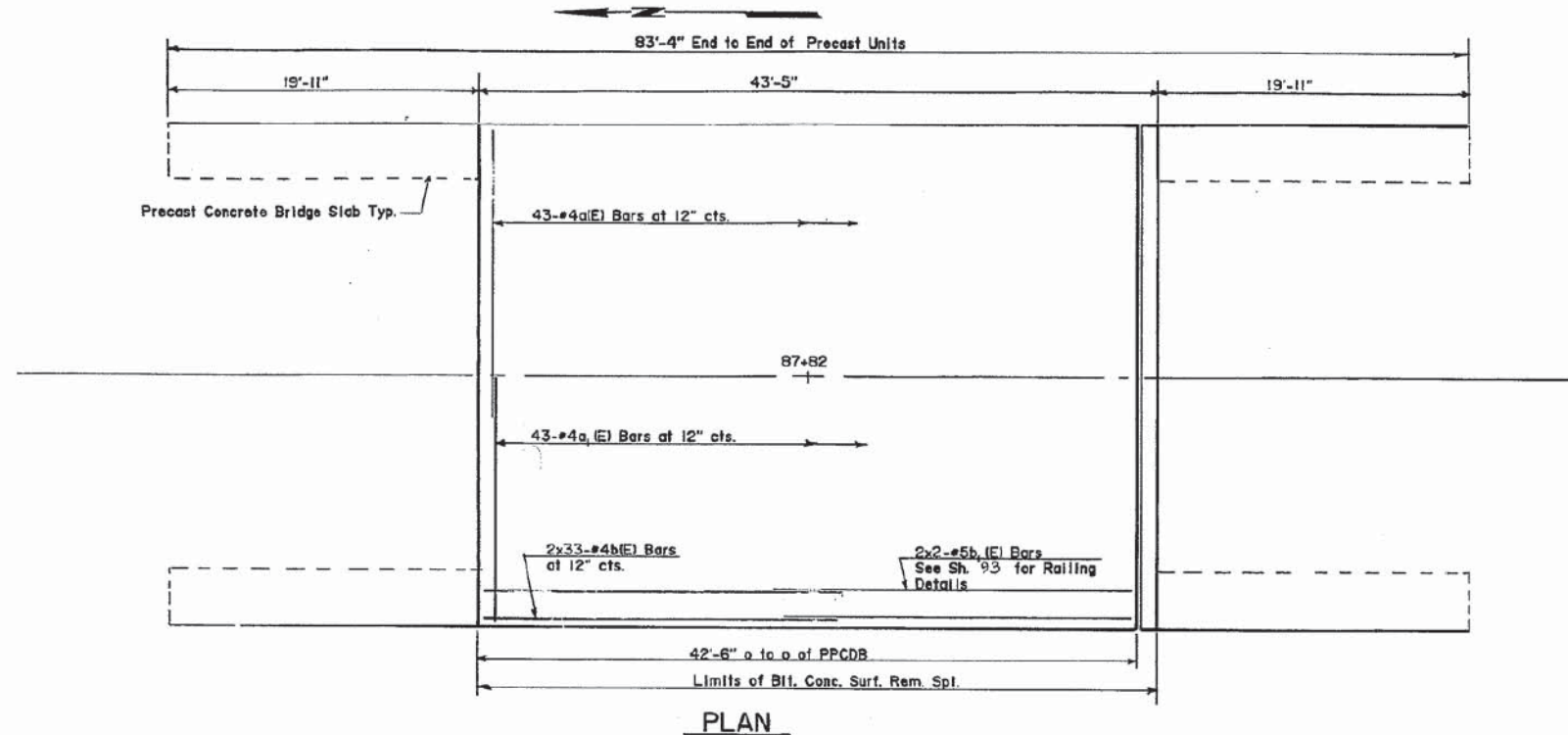
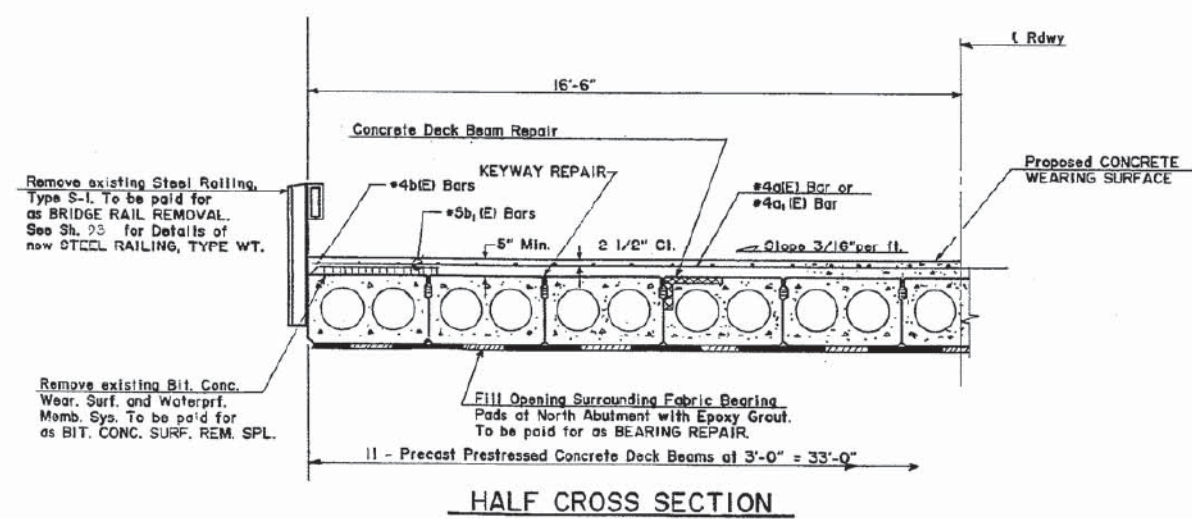

HALF CROSS SECTION

BILL OF MATERIAL

BAR	NO.	SIZE	LENGTH	SHAPE
a (E)	43	#4	17'-11"	—
a ₁ (E)	43	#4	16'-8"	—
b (E)	66	#4	21'-11"	—
b ₁ (E)	8	#5	22'-2"	—
PREF JT SEAL 2 1/2"			LIN. FT.	33
BIT CONC SURF REM SPL			SQ. YD.	160
CONC WEAR SURF			SQ. YD.	156
REINF BARS EPOXY CTD			POUND	2140
* DOWEL REPAIR			EACH	44
BEARING REPAIR			LIN. FT.	33
* KEYWAY REPAIR			LIN. FT.	425
* CONC DECK BEAM REP			SQ. FT.	50

* ESTIMATED QUANTITY

DISTRICT NO. 2 DIXON
 DESIGNED D. Pauser
 DRAWN DATE 4/93
 CHECKED M. Etemodi SCALE None

Revised 6/4/93

SN 098-0044

FILE NAME =	USER NAME = \$USER\$	DESIGNED - RAC	REVISED -
\$FILEL\$		DRAWN - LCR	REVISED -
	PLOT SCALE = \$SCALE\$	CHECKED - DAZ	REVISED -
	PLOT DATE = \$DATE\$	DATE - 06-21-13	REVISED -

STATE OF ILLINOIS
 DEPARTMENT OF TRANSPORTATION

ZROKA
 engineering
 Zroka Engineering, P.C.
 4216 North Hermitage
 Chicago, IL 60613

EXISTING BRIDGE PLANS - 1994
 FOR INFORMATION ONLY

F.A.S. RTE.	SECTION	COUNTY	TOTAL SHEETS	SHEET NO.
200	141B-2	WHITESIDE	77	60
CONTRACT NO. 64D81				
ILLINOIS FED. AID PROJECT				

SCALE: SHEET OF SHEETS STA. 283+43 TO STA. 293+50