

1. COVER SHEET
2. CONSTRUCTION NOTES
3. SUMMARY OF QUANTITIES
- 4.-9. CCTV INSTALLATION ALONG US 150 WAR MEMORIAL DR. (PEORIA COUNTY)
10. CCTV INSTALLATION ALONG I-74 AT HEINZ LANE DMS (PEORIA COUNTY)
- 11.-12. CONDUIT & FIBER OPTIC CABLE INSTALLATION AT STERLING AVE. (PEORIA COUNTY)
- 13.-14. CCTV INSTALLATION ALONG IL 8 WASHINGTON ST. (TAZEWELL COUNTY)
15. CCTV INSTALLATION ALONG US 24 AT IL 9 ORCHARD MINES (TAZEWELL COUNTY)
- 16.-18. FIBER OPTIC CABLE AND CCTV INSTALLATION ALONG IL 9 PEKIN BRIDGE (TAZEWELL COUNTY)
19. CCTV INSTALLATION ALONG IL 116 AT WOODLAND KNOLLS (WOODFORD COUNTY)
20. FIBER OPTIC TERMINATION NOTES AND DIAGRAM
21. MAST ARM EXTENSION DETAIL
22. ITS EQUIPMENT CABINET DETAIL

HIGHWAY STANDARDS

- 701001-02
- 701006-04
- 701011-03
- 701101-03
- 701106-02
- 701422-05
- 701701-08
- 701901-02

PROJECT DESCRIPTION

INSTALLATION OF CCTV CAMERAS, FIBER OPTIC CABLE, CONDUIT, ALONG VARIOUS ROUTES IN PEORIA, TAZEWELL, AND WOODFORD COUNTIES.

J.U.L.I.E.
JOINT UTILITY LOCATION INFORMATION FOR EXCAVATION
1-800-892-0123
OR 811

PROJECT ENGINEER: ERIC HOWALD (309) 671-4481
PROJECT MANAGER: RANDY LANINGA (309) 671-4477
CATALOG NO. 34954-00D
CONTRACT NO. 68B58

STATE OF ILLINOIS
DEPARTMENT OF TRANSPORTATION
DIVISION OF HIGHWAYS
PROPOSED
HIGHWAY PLANS

VARIOUS ROUTES
SECTION D4 ITS 2014
WOODFORD, TAZEWELL, & PEORIA COUNTIES

C-94-066-13

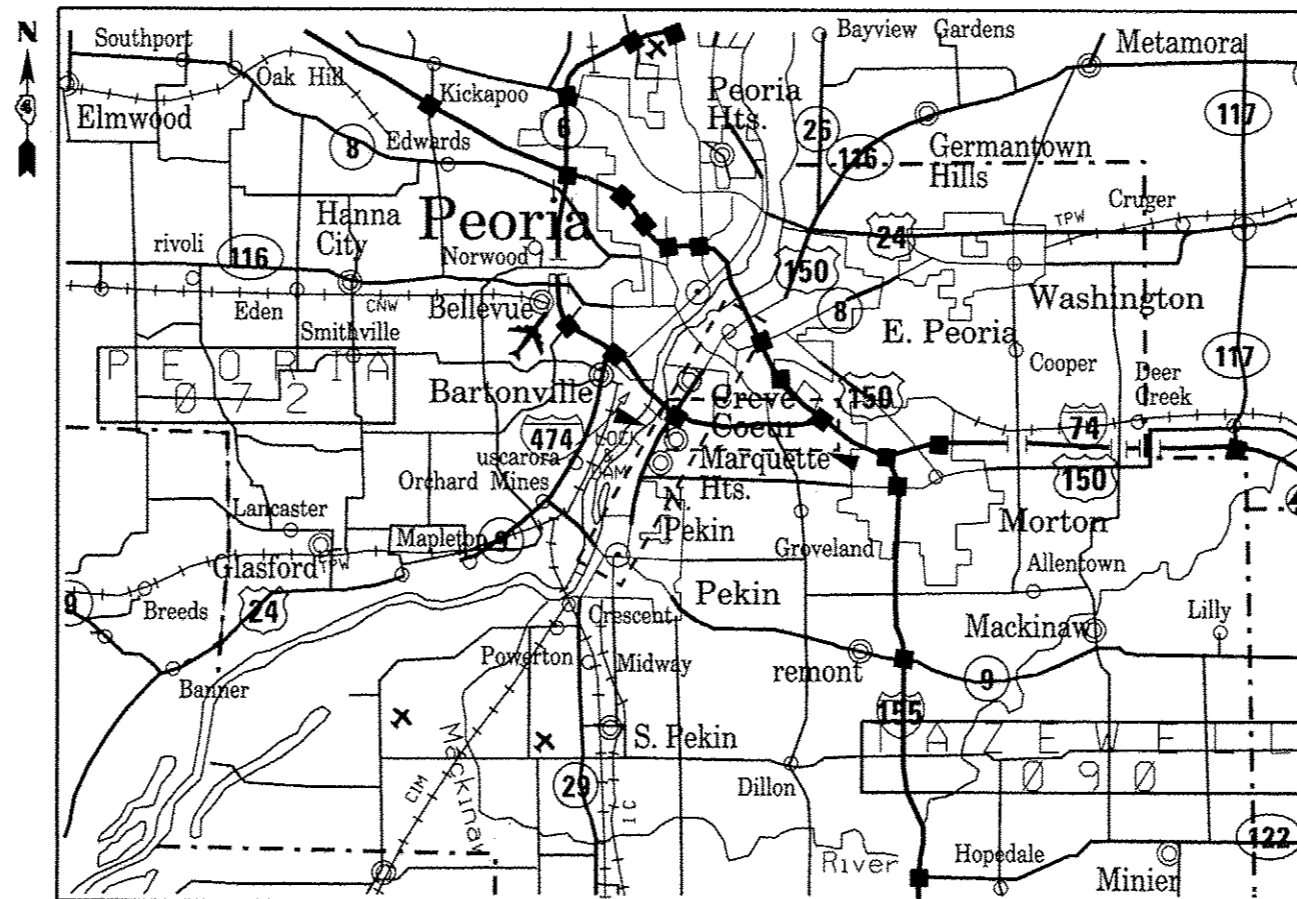

| RTE. | SECTION | COUNTY | TOTAL SHEETS | SHEET NO. |
|-----------------------------|-------------|---------|--------------|-----------|
| VAR. | D4 ITS 2014 | VARIOUS | 22 | 1 |
| ILLINOIS CONTRACT NO. 68B58 | | | | |

D-94-040-13

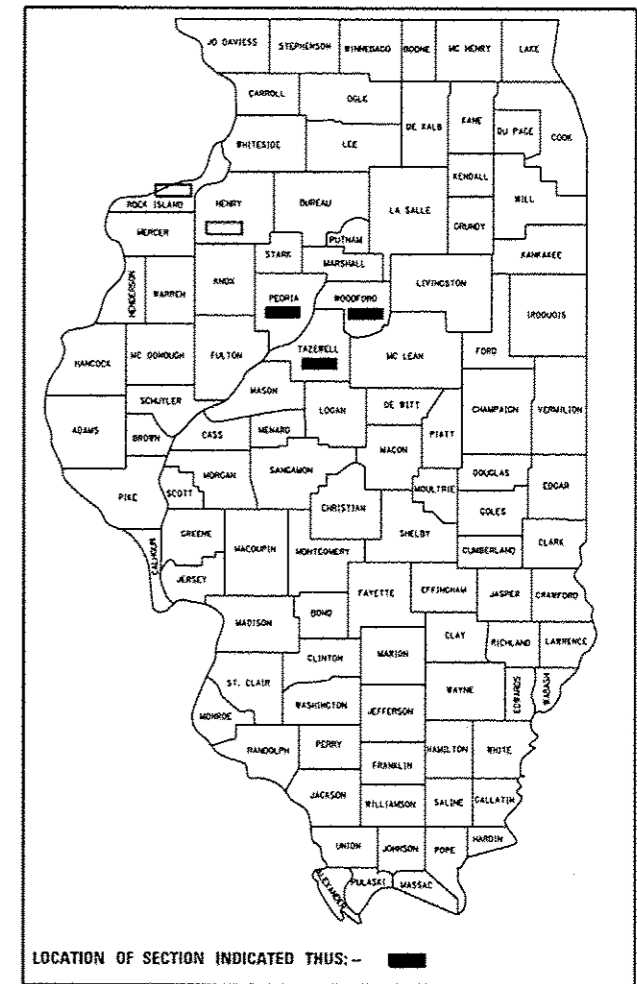

STATE OF ILLINOIS
DEPARTMENT OF TRANSPORTATION
DIVISION OF HIGHWAYS

SUBMITTED July 12 20 13
Joseph P. Crowe, PE, SE
DEPUTY DIRECTOR OF HIGHWAYS, REGION ENGINEER







Aug 16 20 13
John D. Baranelli, PE, SE
ENGINEER OF DESIGN AND ENVIRONMENT

Aug 16 20 13
Omer Osman, PE, SE
DIRECTOR OF HIGHWAYS, CHIEF ENGINEER

PRINTED BY THE AUTHORITY
OF THE STATE OF ILLINOIS

| CONSTRUCTION NOTES | |
|--------------------|---|
| 1. | EXISTING UTILITY LOCATION INFORMATION IS NOT SHOWN ON THE PLAN SHEETS. THE CONTRACTOR SHALL FIELD VERIFY THE LOCATION OF ALL UTILITIES AND PRIVATELY OWNED FACILITIES PRIOR TO THE INSTALLATION OF ANY COMPONENTS. THE CONTRACTOR SHALL VERIFY EXISTING FIELD CONDITIONS PRIOR TO COMMENCING WORK ON THE PROJECT. |
| 2. | THE CONTRACTOR SHALL BE RESPONSIBLE FOR LOCATING EXISTING IDOT ELECTRICAL FACILITIES AT HIS/HER OWN EXPENSE IF REQUIRED. THE CONTRACTOR SHALL ALSO BE LIABLE FOR ANY DAMAGE TO IDOT FACILITIES RESULTING FROM INACCURATE LOCATING. |
| 3. | ELECTRICAL WORK SHALL CONFORM WITH NATIONAL, STATE, AND LOCAL CODES. |
| 4. | THE CONTRACTOR SHALL PROVIDE ELECTRICAL CABLE SLACK IN ACCORDANCE WITH ARTICLE 873.03 UNLESS SPECIFIED OTHERWISE. |
| 5. | ELECTRICAL CABLE WILL BE MEASURED FOR PAYMENT IN ACCORDANCE WITH ARTICLE 873.04. |
| 6. | ALL SURPLUS MATERIALS SHALL BE DISPOSED OF IN ACCORDANCE WITH ARTICLE 202.03 OF THE STANDARD SPECIFICATION. |
| 7. | COILABLE POLYETHYLENE DUCT MAY BE SUBSTITUTED FOR PVC PUSHED OR TRENCHED. |
| 8. | POTHOLING TO LOCATE EXISTING UNDERGROUND UTILITIES SHALL BE INCLUDED IN THE CONTRACT BID PRICE FOR THE CONDUIT PAY ITEMS (PUSHED OR TRENCHED). |
| 9. | REMOVAL AND REPLACEMENT OF EXISTING SIDEWALK, PAVEMENT, AND ISLANDS FOR UTILITY LOCATING PURPOSES WILL NOT BE PAID FOR SEPARATELY, BUT SHALL BE INCLUDED IN THE CONTRACT BID PRICE FOR THE CONDUIT PAY ITEMS. |
| 10. | NO ADDITIONAL COMPENSATION SHALL BE ALLOWED FOR PLACING CONDUIT AT GREATER THAN 2 FT. MINIMUM DEPTH TO AVOID OBSTACLES SUCH AS UNDERGROUND UTILITIES. |
| 11. | THE CONTRACTOR IS RESPONSIBLE FOR THE COST OF UNCOVERING OR HAND DIGGING AROUND UTILITIES AS NECESSARY. THIS COST OF THIS WORK SHALL BE INCLUDED IN THE UNIT PRICES FOR THE CONDUITS. |
| 12. | THE CONTRACTOR SHALL INSTALL A #12 (XLP-TYPE USE) TRACER WIRE ALONG WITH THE FIBER OPTIC CABLE FOR LOCATING PURPOSES. THE TRACER WIRE SHALL BE CONTINUOUS AND BE ACCESSIBLE FROM THE HANDHOLES. THE COST OF FURNISHING AND INSTALLING THE TRACER WIRE SHALL BE INCLUDED IN THE UNIT BID PRICE FOR THE FIBER OPTIC CABLE IN CONDUIT PAY ITEM. |
| 13. | ALL CAMERAS SHALL BE INSTALLED AT A MINIMUM MOUNTING HEIGHT OF 43 FT. |
| 14. | ALL SEAL-TITE CONDUIT SHALL BE NON-METALLIC AND SHALL INCLUDE CONNECTORS WITH INTEGRAL STAINLESS STEEL KELLUM GRIPS AT THE ENDS FOR INCREASED STRENGTH AND DURABILITY. |
| 15. | THE CONTRACTOR SHALL GROUND ALL EXPOSED STEEL CONDUITS IN ACCORDANCE WITH NEC REQUIREMENTS. THE CONTRACTOR SHALL MAINTAIN THE CONTINUITY OF THE GROUND SYSTEM WHEN USING NON-METALLIC SEAL-TITE CONDUIT BY INSTALLING A #6 GROUNDING CONDUCTOR INSIDE THE SEAL-TITE AND BONDING THIS WIRE TO THE GALVANIZED STEEL CONDUITS AT EACH END. THE COST OF THIS WORK SHALL BE INCLUDED IN THE UNIT BID PRICE FOR THE GALVANIZED STEEL CONDUIT PAY ITEMS. |
| 16. | THE CONTRACTOR SHALL REMOVE THE EXISTING CCTV CAMERAS, CABLES, AND BRACKETS. THE COST OF REMOVING THE EXISTING COMPONENTS WILL NOT BE PAID FOR SEPARATELY, BUT SHALL BE INCLUDED IN THE PAY ITEM FOR THE PROPOSED CCTV CAMERAS. THE CONTRACTOR MAY RE-USE THE EXISTING CAMERA BRACKETING. |
| 17. | THE CONTRACTOR SHALL VERIFY FIELD CONDITIONS PRIOR TO BIDDING. THERE WILL BE NO ADDITIONAL COMPENSATION PAID FOR CLAIMS THAT ARISE FROM A FAILURE TO FULLY INVESTIGATE EXISTING FIELD CONDITIONS. |

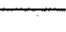
COMMITMENTS: THERE ARE NO COMMITMENTS MADE IN CONJUNCTION WITH THIS PROJECT.

| LEGEND | |
|---|----------------------------|
|  | PROP. SERVICE INSTALLATION |
|  | PROP. CCTV CABINET |
|  | PROP. CCTV DOME CAMERA |
|  | PROP. CAMERA POLE |
|  | PROP. CONDUIT, UNDERGROUND |
|  | EX. CONDUIT, PUSHED |
|  | EX. TYPE IV CABINET |

| FIBER OPTIC CABLE SLACK |
|---------------------------------|
| DOUBLE HANDHOLE: 30.0 FT. |
| COMMUNICATIONS VAULT: 30.0 FT. |
| JUNCTION BOX: 10.0 FT. |
| HANDHOLE: 10.0 FT. |
| ITS OR SIGNAL CABINET: 10.0 FT. |
| EQUIPMENT CABINET: 3.0 FT. |

SUMMARY OF QUANTITIES

| | | | | | PEORIA COUNTY | TAZEWELL COUNTY | WOODFORD COUNTY |
|----------|---|-------|------------|--------|--|--|--|
| | | | | | CONST. TYPE CODE 0021 (100% STATE) ITS AND FIBER URBAN | CONST. TYPE CODE 0021 (100% STATE) ITS AND FIBER URBAN | CONST. TYPE CODE 0021 (100% STATE) ITS AND FIBER URBAN |
| CODE | ITEM DESCRIPTION | UNIT | TOTAL QTY. | | | | |
| 67100100 | MOBILIZATION | L SUM | 1.0 | 0.50 | 0.45 | 0.05 | |
| 70100320 | TRAFFIC CONTROL AND PROTECTION, STANDARD 701422 | L SUM | 1.0 | | 1.0 | | |
| 70102635 | TRAFFIC CONTROL AND PROTECTION, STANDARD 701701 | L SUM | 1.0 | 0.50 | 0.45 | 0.05 | |
| 80500200 | SERVICE INSTALLATION, TYPE B | EACH | 1.0 | | 1.0 | | |
| 81028320 | UNDERGROUND CONDUIT, PVC, 1" DIA. | FOOT | 65.0 | | 65.0 | | |
| 81028350 | UNDERGROUND CONDUIT, PVC, 2" DIA. | FOOT | 1260.0 | 1130.0 | 130.0 | | |
| 81100300 | CONDUIT ATTACHED TO STRUCTURE, 1" DIA., GALVANIZED STEEL | FOOT | 131.0 | | 131.0 | | |
| 81702110 | ELECTRIC CABLE IN CONDUIT, 600V (XLP-TYPE USE) 1/C NO. 10 | FOOT | 294.0 | | 294.0 | | |
| 87100020 | FIBER OPTIC CABLE IN CONDUIT, NO. 62.5/125, MM12F SM12F | FOOT | 1479.0 | 1479.0 | | | |
| 87900200 | DRILL EXISTING HANDHOLE | EACH | 4.0 | 2.0 | 2.0 | | |
| X0323920 | POLE MOUNTED EQUIPMENT CABINET, TYPE B | EACH | 1.0 | | 1.0 | | |
| X0326812 | CAT 5 ETHERNET CABLE | FOOT | 3115.5 | 1530.5 | 1502.0 | 83.0 | |
| X0326905 | CLOSED CIRCUIT TELEVISION DOME CAMERA, IP BASED | EACH | 7.0 | 3.0 | 3.0 | 1.0 | |
| X0327122 | WIRELESS RADIO LINK (INSTALL ONLY) | L SUM | 1.0 | | 1.0 | | |
| X0327238 | MAST ARM EXTENSION | EACH | 1.0 | 1.0 | | | |
| X8710030 | FIBER OPTIC CABLE 48 FIBERS, SINGLE MODE | FOOT | 2954.0 | | 2954.0 | | |
| Z0033052 | COMMUNICATIONS VAULT | EACH | 1.0 | | 1.0 | | |
| X0327905 | DOME CAMERA, IP BASED (INSTALL ONLY) CLOSED CIRCUIT TELEVISION | EACH | 5.0 | 4.0 | 1.0 | | |

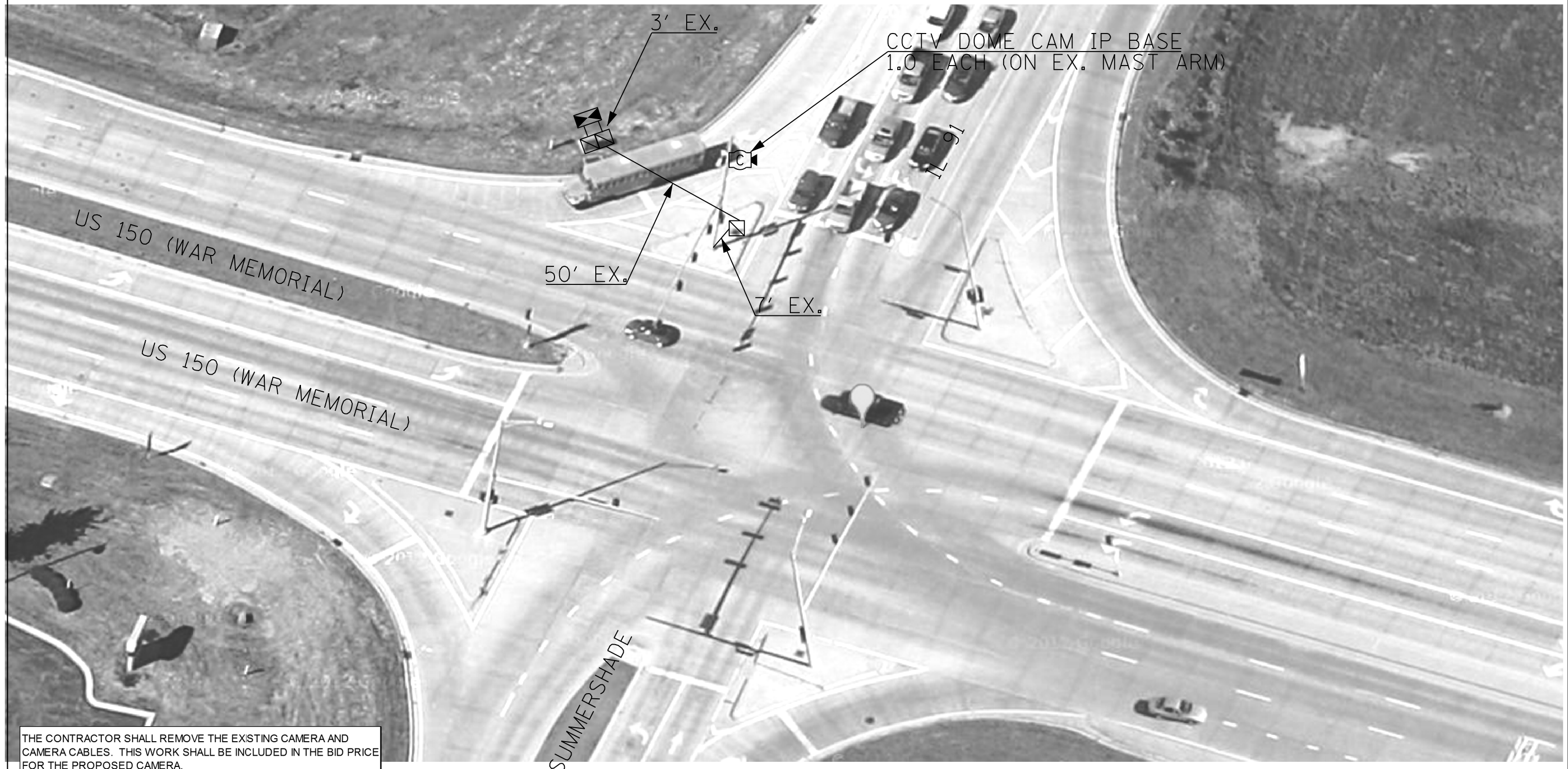

THE CONTRACTOR SHALL REMOVE THE EXISTING CAMERA AND CAMERA CABLES. THIS WORK SHALL BE INCLUDED IN THE BID PRICE FOR THE PROPOSED CAMERA.

| SCHEDULE OF QUANTITIES (SHEET 4) | | |
|---|------|-------|
| CAT 5 ETHERNET CABLE | FOOT | 133.5 |
| CLOSED-CIRCUIT TELEVISION DOME CAMERA, IP BASED | EACH | 1.0 |

| | | | |
|-----------------------------------|------------------------------|------------|-----------|
| FILE NAME = 68B58 Final Plans.dgn | USER NAME = keathbr | DESIGNED - | REVISED - |
| | | DRAWN - | REVISED - |
| | PLOT SCALE = 164.7568' / in. | CHECKED - | REVISED - |
| | PLOT DATE = 7/12/2013 | DATE - | REVISED - |

**STATE OF ILLINOIS
DEPARTMENT OF TRANSPORTATION**

**CCTV CAMERA INSTALLATION
US 150 (WAR MEMORIAL) & IL 91 / SUMMERSHADE CIRCLE**

| | | | | |
|---------------------------|-------------|---------|--------------|-----------|
| F.A.P. RTE. | SECTION | COUNTY | TOTAL SHEETS | SHEET NO. |
| VAR | D4 ITS 2014 | VARIOUS | 22 | 4 |
| CONTRACT NO. 68B58 | | | | |
| ILLINOIS FED. AID PROJECT | | | | |

SCALE: SHEET NO. 1 OF 62 SHEETS STA. TO STA.



THE CONTRACTOR SHALL REMOVE THE EXISTING CAMERA AND CAMERA CABLES. THIS WORK SHALL BE INCLUDED IN THE BID PRICE FOR THE PROPOSED CAMERA.

| SCHEDULE OF QUANTITIES (SHEET 5) | | |
|---|------|------|
| CAT 5 ETHERNET CABLE | FOOT | 42.0 |
| CCTV DOME CAMERA, IP BASED (INSTALL ONLY) | EACH | 1.0 |

FILE NAME = 68B58 Final Plans.dgn

USER NAME = keithbr
 PLOT SCALE = 1/4" = 100'
 PLOT DATE = 7/12/2013

DESIGNED -
 DRAWN -
 CHECKED -
 DATE -

REVISED -
 REVISED -
 REVISED -
 REVISED -

**STATE OF ILLINOIS
 DEPARTMENT OF TRANSPORTATION**

**CCTV CAMERA REPLACEMENT
 US 150 (WAR MEMORIAL) & IL 6**
 SCALE: SHEET NO. 2 OF 62 SHEETS STA. TO STA.

| F.A.P. RTE. | SECTION | COUNTY | TOTAL SHEETS | SHEET NO. |
|---------------------------|-------------|---------|--------------|-----------|
| VAR | D4 ITS 2014 | VARIOUS | 22 | 5 |
| CONTRACT NO. 68B58 | | | | |
| ILLINOIS FED. AID PROJECT | | | | |

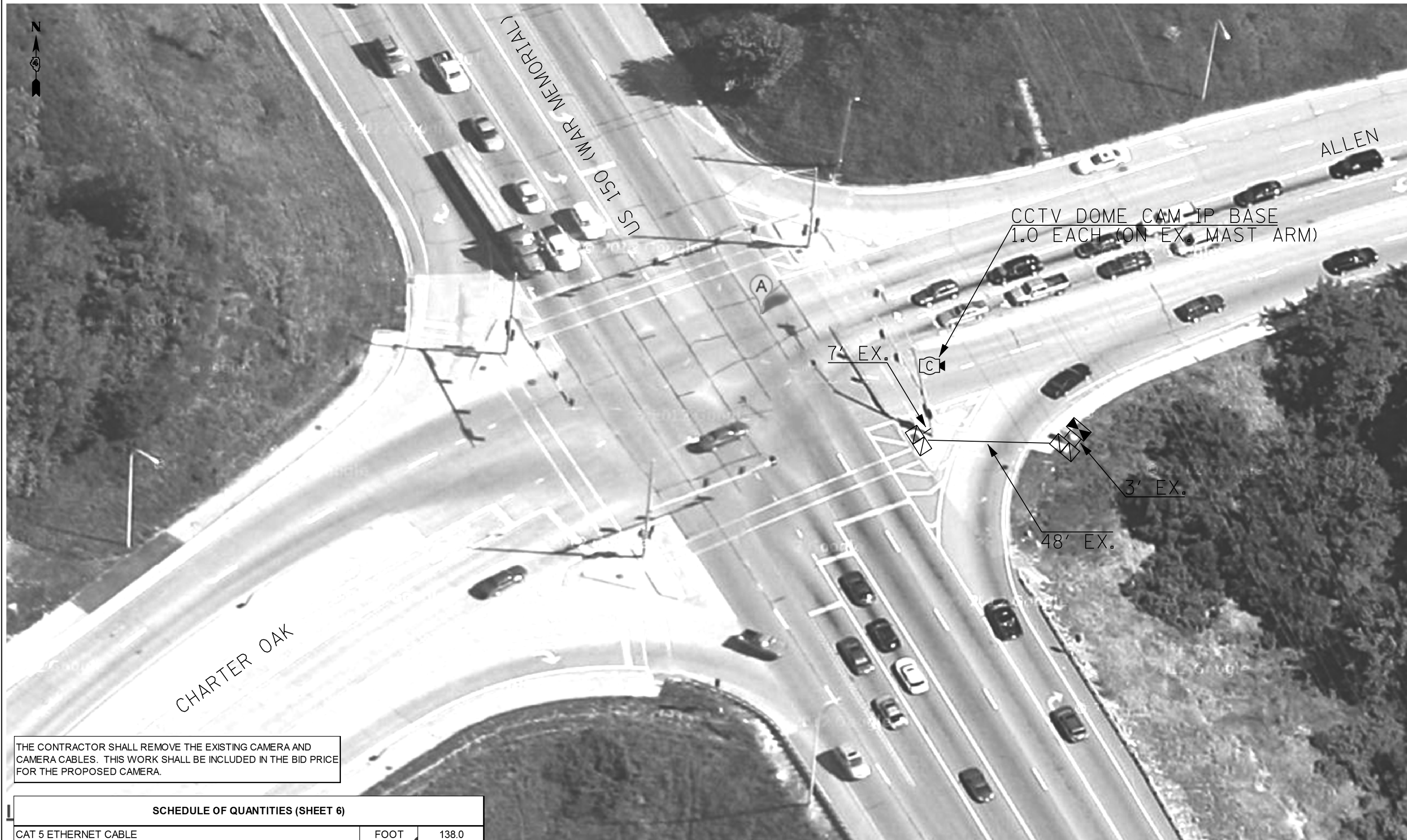

THE CONTRACTOR SHALL REMOVE THE EXISTING CAMERA AND CAMERA CABLES. THIS WORK SHALL BE INCLUDED IN THE BID PRICE FOR THE PROPOSED CAMERA.

| SCHEDULE OF QUANTITIES (SHEET 6) | | |
|---|------|-------|
| CAT 5 ETHERNET CABLE | FOOT | 138.0 |
| CCTV DOME CAMERA, IP BASED (INSTALL ONLY) | EACH | 1.0 |

| | | | |
|-----------------------------------|-------------------------------|------------|-----------|
| FILE NAME = 68B58 Final Plans.dgn | USER NAME = kesthbr | DESIGNED - | REVISED - |
| | | DRAWN - | REVISED - |
| | PLOT SCALE = 164.7568' / 1" = | CHECKED - | REVISED - |
| | PLOT DATE = 7/12/2013 | DATE - | REVISED - |

STATE OF ILLINOIS
DEPARTMENT OF TRANSPORTATION

| | | | |
|--|--------------------------|------|---------|
| CCTV CAMERA REPLACEMENT US 150 (WAR MEMORIAL) & ALLEN | | | |
| SCALE: | SHEET NO. 3 OF 62 SHEETS | STA. | TO STA. |

| | | | | |
|---------------------------|-------------|---------|--------------|-----------|
| F.A.P. RTE. | SECTION | COUNTY | TOTAL SHEETS | SHEET NO. |
| VAR | D4 ITS 2014 | VARIOUS | 22 | 6 |
| CONTRACT NO. 68B58 | | | | |
| ILLINOIS FED. AID PROJECT | | | | |

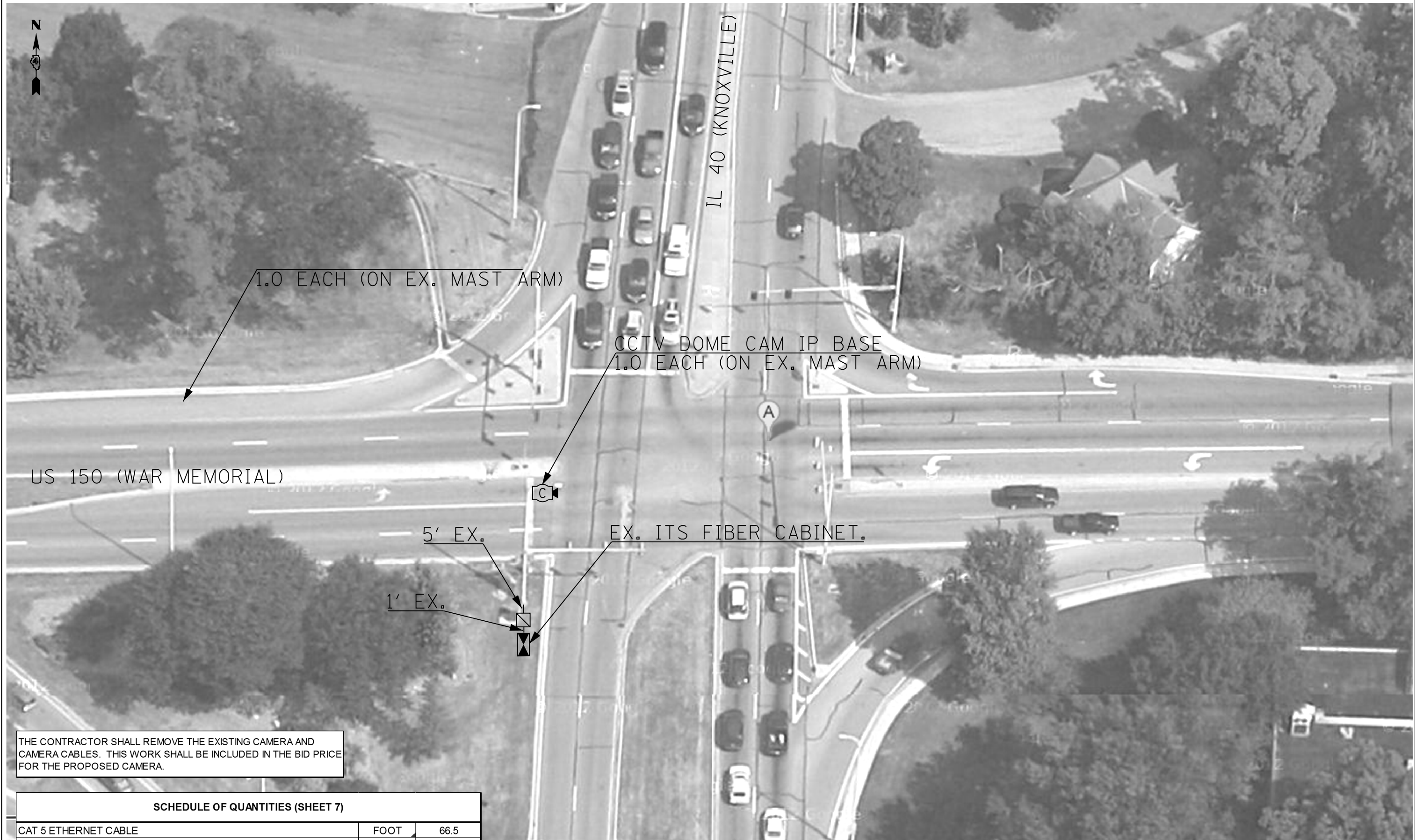

THE CONTRACTOR SHALL REMOVE THE EXISTING CAMERA AND CAMERA CABLES. THIS WORK SHALL BE INCLUDED IN THE BID PRICE FOR THE PROPOSED CAMERA.

| SCHEDULE OF QUANTITIES (SHEET 7) | | |
|---|------|------|
| CAT 5 ETHERNET CABLE | FOOT | 66.5 |
| CCTV DOME CAMERA, IP BASED (INSTALL ONLY) | EACH | 1.0 |

| | | | |
|-----------------------------------|------------------------------|------------|-----------|
| FILE NAME = 68B58 Final Plans.dgn | USER NAME = kesthbr | DESIGNED - | REVISED - |
| | | DRAWN - | REVISED - |
| | PLOT SCALE = 164.7568' / in. | CHECKED - | REVISED - |
| | PLOT DATE = 7/12/2013 | DATE - | REVISED - |

**STATE OF ILLINOIS
DEPARTMENT OF TRANSPORTATION**

| | | | |
|--|--------------------------|------|---------|
| CCTV CAMERA REPLACEMENT US 150 (WAR MEMORIAL) & IL 40 (KNOXVILLE) | | | |
| SCALE: | SHEET NO. 4 OF 62 SHEETS | STA. | TO STA. |

| | | | | |
|---------------------------|-------------|---------|--------------|-----------|
| F.A.P. RTE. | SECTION | COUNTY | TOTAL SHEETS | SHEET NO. |
| VAR | D4 ITS 2014 | VARIOUS | 22 | 7 |
| CONTRACT NO. 68B58 | | | | |
| ILLINOIS FED. AID PROJECT | | | | |

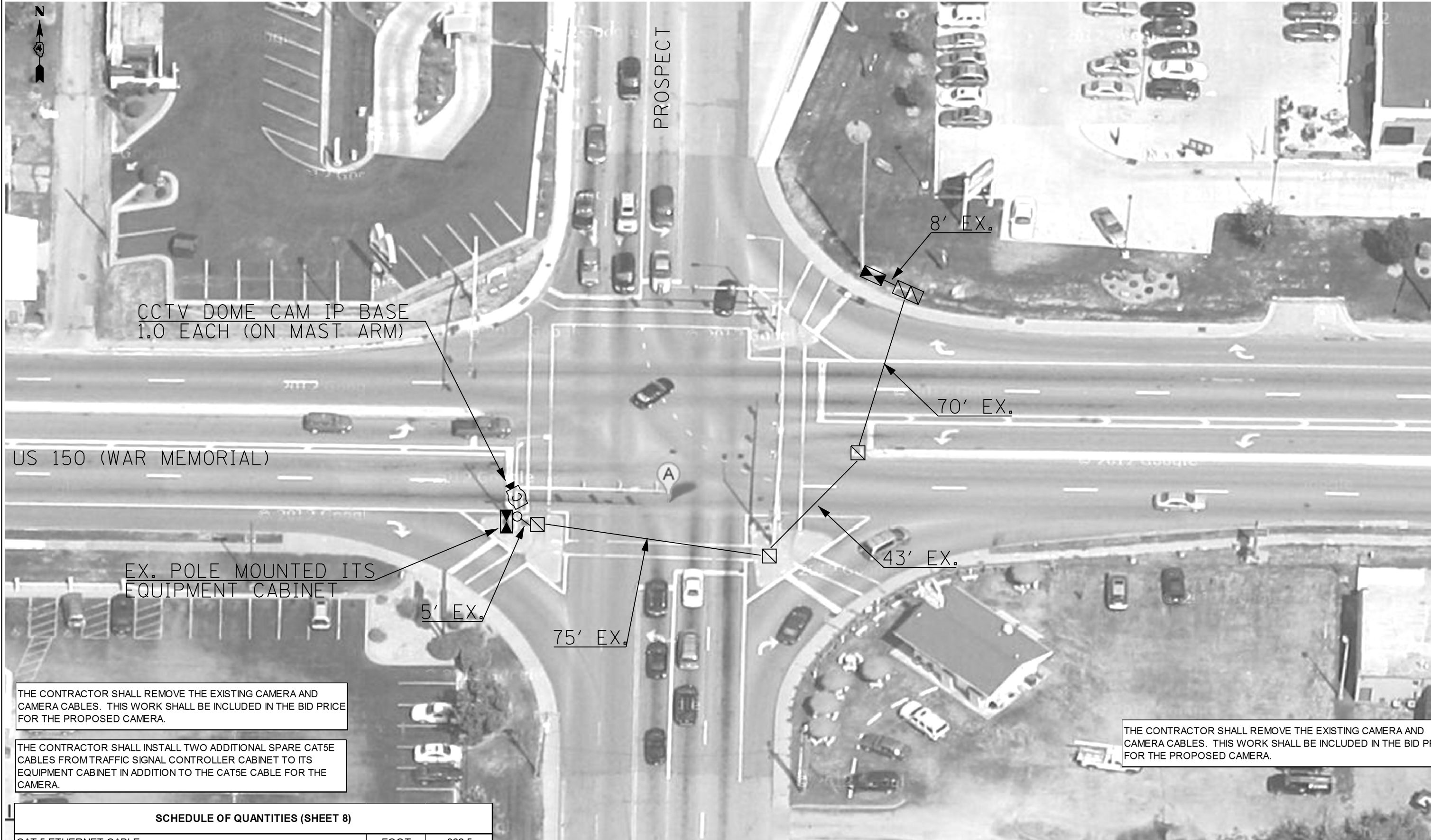

CCTV DOME CAM IP BASE
1.0 EACH (ON MAST ARM)

US 150 (WAR MEMORIAL)

EX. POLE MOUNTED ITS
EQUIPMENT CABINET

THE CONTRACTOR SHALL REMOVE THE EXISTING CAMERA AND
CAMERA CABLES. THIS WORK SHALL BE INCLUDED IN THE BID PRICE
FOR THE PROPOSED CAMERA.

THE CONTRACTOR SHALL INSTALL TWO ADDITIONAL SPARE CAT5E
CABLES FROM TRAFFIC SIGNAL CONTROLLER CABINET TO ITS
EQUIPMENT CABINET IN ADDITION TO THE CAT5E CABLE FOR THE
CAMERA.

THE CONTRACTOR SHALL REMOVE THE EXISTING CAMERA AND
CAMERA CABLES. THIS WORK SHALL BE INCLUDED IN THE BID PRICE
FOR THE PROPOSED CAMERA.

SCHEDULE OF QUANTITIES (SHEET 8)

| | | |
|---|------|-------|
| CAT 5 ETHERNET CABLE | FOOT | 862.5 |
| CCTV DOME CAMERA, IP BASED (INSTALL ONLY) | EACH | 1.0 |

FILE NAME =
68B58 Final Plans.dgn

USER NAME = keathbr
PLOT SCALE = 164.7568' / in.
PLOT DATE = 7/12/2013

DESIGNED -
DRAWN -
CHECKED -
DATE -

REVISED -
REVISED -
REVISED -
REVISED -

**STATE OF ILLINOIS
DEPARTMENT OF TRANSPORTATION**

**CCTV CAMERA REPLACEMENT
US 150 (WAR MEMORIAL) & PROSPECT**

SCALE: SHEET NO. 5 OF 62 SHEETS STA. TO STA.

| | | | | |
|---------------------------|-------------|---------|--------------|-----------|
| F.A.P. RTE. | SECTION | COUNTY | TOTAL SHEETS | SHEET NO. |
| VAR | D4 ITS 2014 | VARIOUS | 22 | 8 |
| CONTRACT NO. 68B58 | | | | |
| ILLINOIS FED. AID PROJECT | | | | |



THE CONTRACTOR SHALL REMOVE THE EXISTING CAMERA AND CAMERA CABLES. THIS WORK SHALL BE INCLUDED IN THE BID PRICE FOR THE PROPOSED CAMERA.

SCHEDULE OF QUANTITIES (SHEET 9)

| | | |
|---|------|------|
| CAT 5 ETHERNET CABLE | FOOT | 72.0 |
| CLOSED-CIRCUIT TELEVISION DOME CAMERA, IP BASED | EACH | 1.0 |

| | | | |
|-----------------------------------|------------------------------|------------|-----------|
| FILE NAME = 68B58 Final Plans.dgn | USER NAME = keathbr | DESIGNED - | REVISED - |
| | | DRAWN - | REVISED - |
| | PLOT SCALE = 164.7568' / in. | CHECKED - | REVISED - |
| | PLOT DATE = 7/12/2013 | DATE - | REVISED - |

**STATE OF ILLINOIS
DEPARTMENT OF TRANSPORTATION**

**CCTV CAMERA REPLACEMENT
US 150 (WAR MEMORIAL) & IL 29 (ADAMS)**

SCALE: SHEET NO. 6 OF 62 SHEETS STA. TO STA.

| | | | | |
|---------------------------|-------------|---------|--------------|-----------|
| F.A.P. RTE. | SECTION | COUNTY | TOTAL SHEETS | SHEET NO. |
| VAR | 04 ITS 2014 | VARIOUS | 22 | 9 |
| CONTRACT NO. 68B58 | | | | |
| ILLINOIS FED. AID PROJECT | | | | |



THE CONTRACTOR SHALL INSTALL THE CAT5E CABLE THROUGH THE SIGN TRUSS TO THE CAMERA EXTENSION. IN THE EVENT THAT THE CABLE CAN NOT BE INSTALLED THROUGH THE SIGN TRUSS, THE CONTRACTOR SHALL SECURE THE CABLE WITH TIE WRAPS TO THE SIGN STRUCTURE. THIS WORK SHALL BE INCLUDED IN THE COST OF THE MAST ARM EXTENSION.

| SCHEDULE OF QUANTITIES (SHEET 10) | | |
|---|------|-------|
| CAT 5 ETHERNET CABLE | FOOT | 216.0 |
| CLOSED-CIRCUIT TELEVISION DOME CAMERA, IP BASED | EACH | 1.0 |
| MAST ARM EXTENSION | EACH | 1.0 |

FILE NAME = 68B58 Final Plans.dgn

USER NAME = keathbr
 PLOT SCALE = 164.7568' / in.
 PLOT DATE = 7/12/2013

DESIGNED -
 DRAWN -
 CHECKED -
 DATE -

REVISED -
 REVISED -
 REVISED -
 REVISED -

STATE OF ILLINOIS
 DEPARTMENT OF TRANSPORTATION

CCTV CAMERA INSTALLATION
 I-74 AT HEINZ LANE DMS

SCALE: SHEET NO. 7 OF 62 SHEETS STA. TO STA.

| F.A.P. RTE. | SECTION | COUNTY | TOTAL SHEETS | SHEET NO. |
|---------------------------|-------------|---------|--------------|-----------|
| VAR | D4 ITS 2014 | VARIOUS | 22 | 10 |
| CONTRACT NO. 68B58 | | | | |
| ILLINOIS FED. AID PROJECT | | | | |

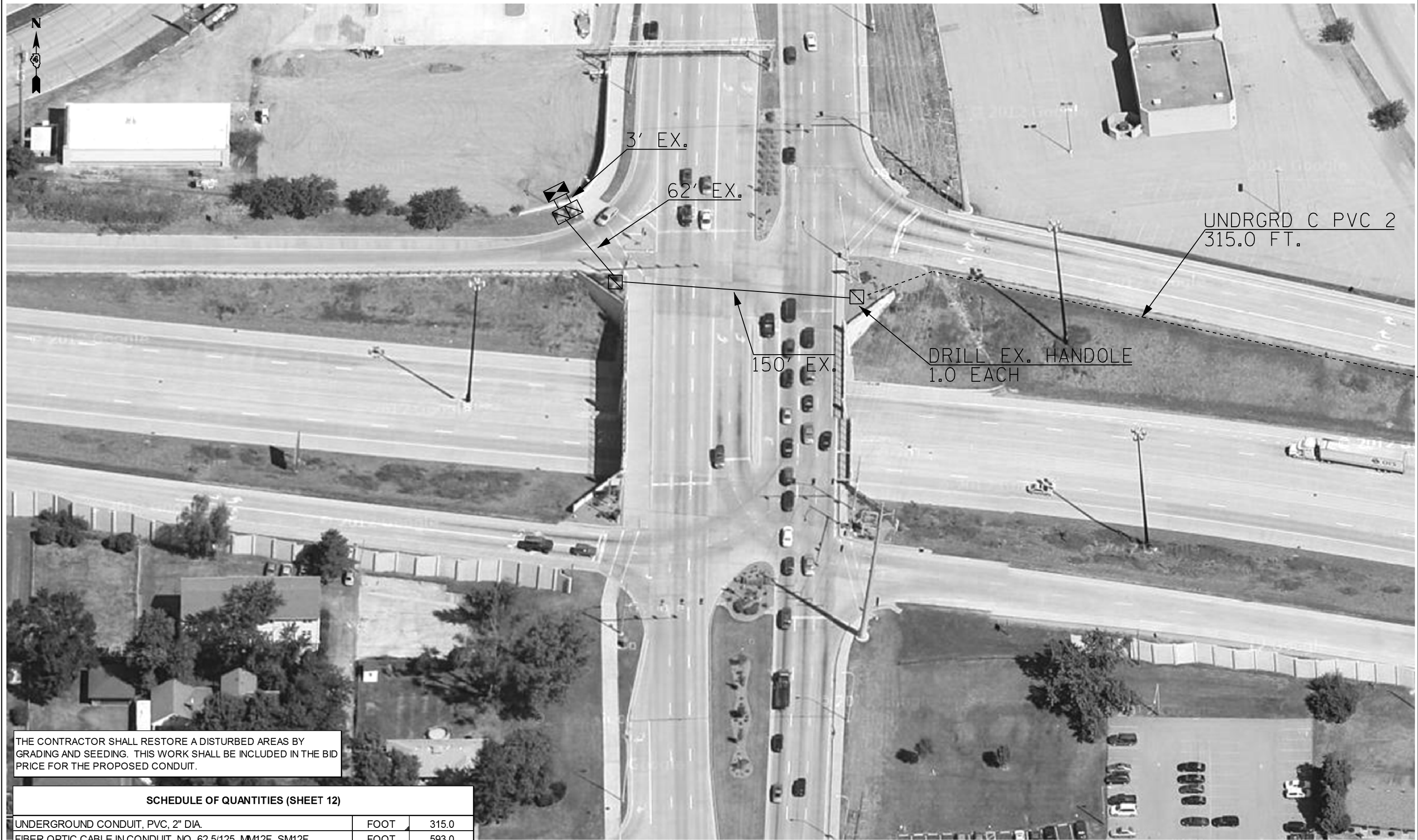

THE CONTRACTOR SHALL RESTORE A DISTURBED AREAS BY GRADING AND SEEDING. THIS WORK SHALL BE INCLUDED IN THE BID PRICE FOR THE PROPOSED CONDUIT.

| SCHEDULE OF QUANTITIES (SHEET 12) | | |
|---|------|-------|
| UNDERGROUND CONDUIT, PVC, 2" DIA. | FOOT | 315.0 |
| FIBER OPTIC CABLE IN CONDUIT, NO. 62.5/125, MM12F SM12F | FOOT | 593.0 |
| DRILL EXISTING HANDHOLE | EACH | 1.0 |

| | | | |
|-----------------------------------|------------------------------|------------|-----------|
| FILE NAME = 68B58 Final Plans.dgn | USER NAME = kesthbr | DESIGNED - | REVISED - |
| | | DRAWN - | REVISED - |
| | PLOT SCALE = 164.7568' / in. | CHECKED - | REVISED - |
| | PLOT DATE = 7/12/2013 | DATE - | REVISED - |

**STATE OF ILLINOIS
DEPARTMENT OF TRANSPORTATION**

**FIBER OPTIC CABLE AND CONDUIT INSTALLATION
I-74 WB RAMP AT STERLING AVE.**

SCALE: SHEET NO. 8 OF 62 SHEETS STA. TO STA.

| | | | | |
|---------------------------|-------------|---------|--------------|-----------|
| F.A.P. RTE. | SECTION | COUNTY | TOTAL SHEETS | SHEET NO. |
| VAR | D4 ITS 2014 | VARIOUS | 22 | 11 |
| CONTRACT NO. 68B58 | | | | |
| ILLINOIS FED. AID PROJECT | | | | |



THE CONTRACTOR SHALL RESTORE A DISTURBED AREAS BY GRADING AND SEEDING. THIS WORK SHALL BE INCLUDED IN THE BID PRICE FOR THE PROPOSED CONDUIT.

| SCHEDULE OF QUANTITIES (SHEET 11) | | |
|---|------|-------|
| UNDERGROUND CONDUIT, PVC, 2" DIA. | FOOT | 815.0 |
| FIBER OPTIC CABLE IN CONDUIT, NO. 62.5/125, MM12F SM12F | FOOT | 886.0 |
| DRILL EXISTING HANDHOLE | EACH | 1.0 |
| COMMUNICATIONS VAULT | EACH | 1.0 |

FILE NAME = 68B58 Final Plans.dgn

USER NAME = keathbr
 PLOT SCALE = 164.7568' / in.
 PLOT DATE = 7/12/2013

DESIGNED -
 DRAWN -
 CHECKED -
 DATE -

REVISED -
 REVISED -
 REVISED -
 REVISED -

**STATE OF ILLINOIS
 DEPARTMENT OF TRANSPORTATION**

**FIBER OPTIC CABLE AND CONDUIT INSTALLATION
 I-74 WB RAMP AT STERLING AVE. (CONTINUED)**
 SCALE: SHEET NO. 9 OF 62 SHEETS STA. TO STA.

| F.A.P. RTE. | SECTION | COUNTY | TOTAL SHEETS | SHEET NO. |
|---------------------------|-------------|---------|--------------|-----------|
| VAR | D4 ITS 2014 | VARIOUS | 22 | 12 |
| CONTRACT NO. 68B58 | | | | |
| ILLINOIS FED. AID PROJECT | | | | |

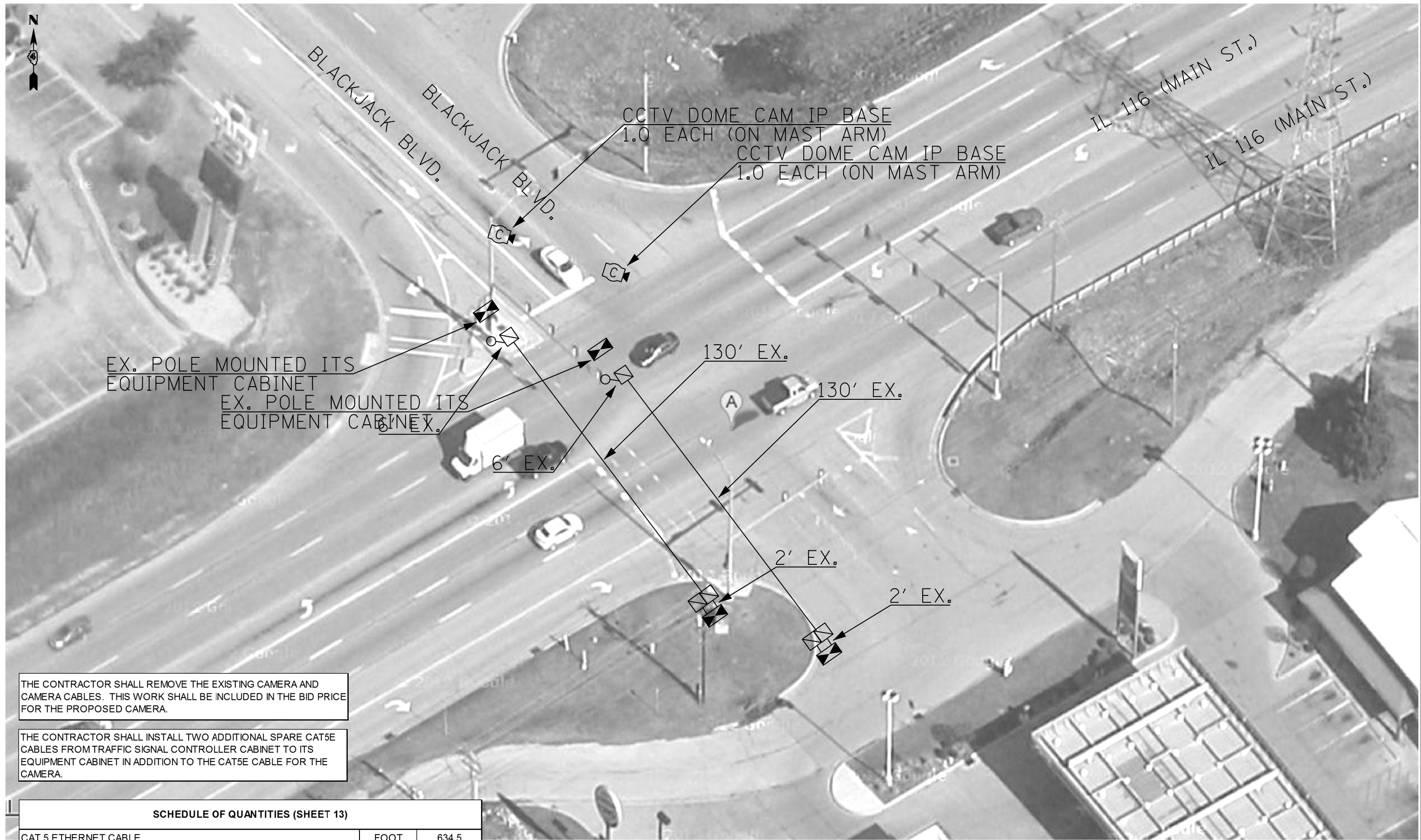

THE CONTRACTOR SHALL REMOVE THE EXISTING CAMERA AND CAMERA CABLES. THIS WORK SHALL BE INCLUDED IN THE BID PRICE FOR THE PROPOSED CAMERA.

THE CONTRACTOR SHALL INSTALL TWO ADDITIONAL SPARE CAT5E CABLES FROM TRAFFIC SIGNAL CONTROLLER CABINET TO ITS EQUIPMENT CABINET IN ADDITION TO THE CAT5E CABLE FOR THE CAMERA.

| SCHEDULE OF QUANTITIES (SHEET 13) | | |
|---|------|-------|
| CAT 5 ETHERNET CABLE | FOOT | 634.5 |
| CLOSED CIRCUIT TELEVISION DOME CAMERA, IP BASED | EACH | 1.0 |

| | | | |
|-----------------------------------|------------------------------|------------|-----------|
| FILE NAME = 68B58 Final Plans.dgn | USER NAME = keathbr | DESIGNED - | REVISED - |
| | | DRAWN - | REVISED - |
| | PLOT SCALE = 164.7568' / in. | CHECKED - | REVISED - |
| | PLOT DATE = 7/12/2013 | DATE - | REVISED - |

**STATE OF ILLINOIS
DEPARTMENT OF TRANSPORTATION**

**CCTV CAMERA REPLACEMENT
IL 116 (MAIN) & BLACKJACK BLVD.**

SCALE: SHEET NO. 10 OF 62 SHEETS STA. TO STA.

| | | | | |
|---------------------------|-------------|---------|--------------|-----------|
| F.A.P. RTE. | SECTION | COUNTY | TOTAL SHEETS | SHEET NO. |
| VAR | D4 ITS 2014 | VARIOUS | 22 | 13 |
| CONTRACT NO. 68B58 | | | | |
| ILLINOIS FED. AID PROJECT | | | | |



THE CONTRACTOR SHALL REMOVE THE EXISTING CAMERA AND CAMERA CABLES. THIS WORK SHALL BE INCLUDED IN THE BID PRICE FOR THE PROPOSED CAMERA.

| SCHEDULE OF QUANTITIES (SHEET 14) | | |
|---|------|------|
| CAT 5 ETHERNET CABLE | FOOT | 68.5 |
| CCTV DOME CAMERA, IP BASED (INSTALL ONLY) | EACH | 1.0 |

| | | | |
|-----------------------------------|---------------------------|------------|-----------|
| FILE NAME = 68B58 Final Plans.dgn | USER NAME = keathbr | DESIGNED - | REVISED - |
| | | DRAWN - | REVISED - |
| | PLOT SCALE = 1/4" = 1'-0" | CHECKED - | REVISED - |
| | PLOT DATE = 7/12/2013 | DATE - | REVISED - |

**STATE OF ILLINOIS
DEPARTMENT OF TRANSPORTATION**

**CCTV CAMERA REPLACEMENT
IL 8 (WASHINGTON) & FIRE STATION #3**

SCALE: SHEET NO. 11 OF 62 SHEETS STA. TO STA.

| | | | | |
|---------------------------|-------------|---------|--------------|-----------|
| F.A.P. RTE. | SECTION | COUNTY | TOTAL SHEETS | SHEET NO. |
| VAR | D4 ITS 2014 | VARIOUS | 22 | 14 |
| CONTRACT NO. 68B58 | | | | |
| ILLINOIS FED. AID PROJECT | | | | |

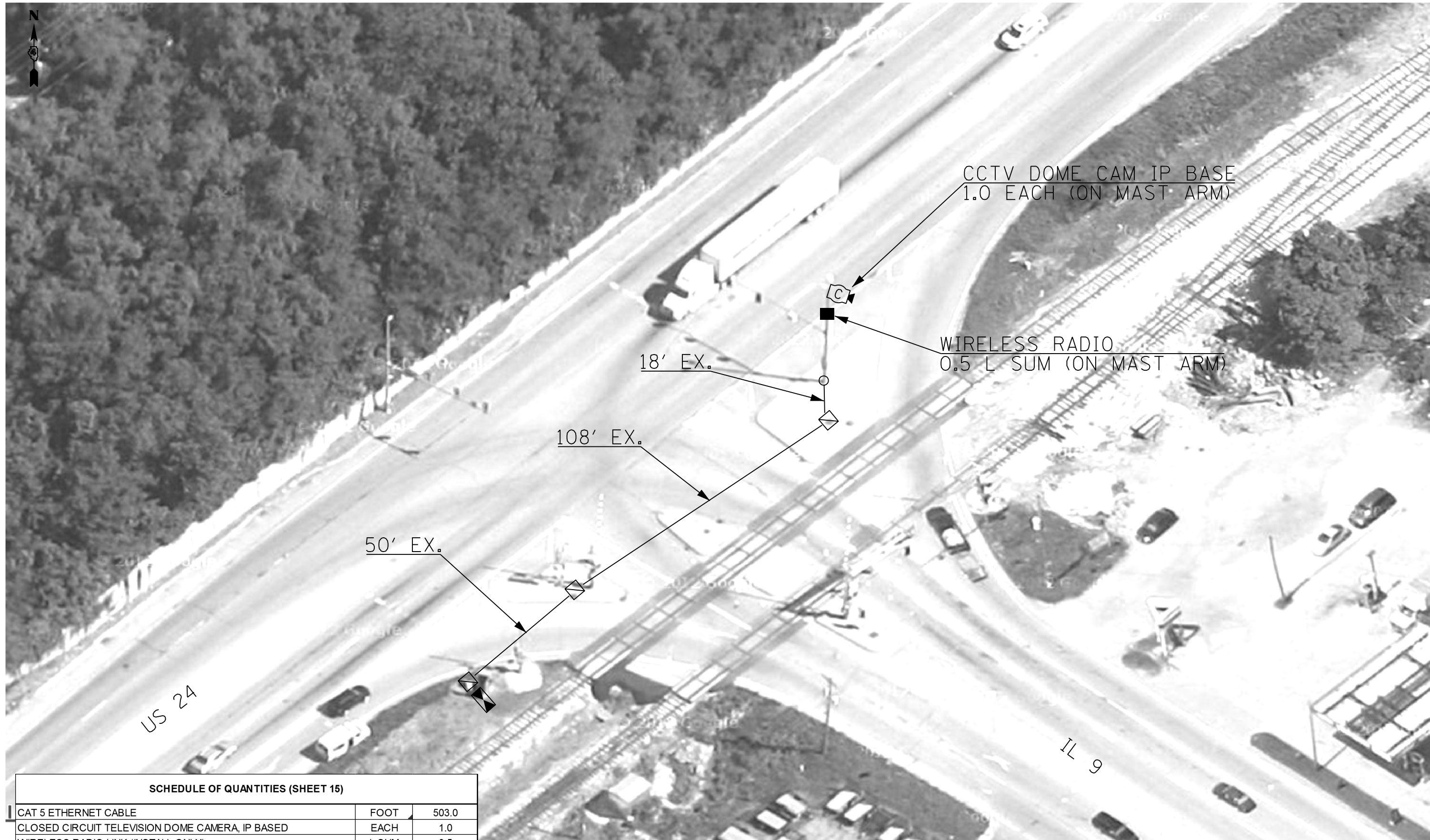

| SCHEDULE OF QUANTITIES (SHEET 15) | | |
|---|-------|-------|
| CAT 5 ETHERNET CABLE | FOOT | 503.0 |
| CLOSED CIRCUIT TELEVISION DOME CAMERA, IP BASED | EACH | 1.0 |
| WIRELESS RADIO LINK (INSTALL ONLY) | L SUM | 0.5 |

FILE NAME = 68B58 Final Plans.dgn

USER NAME = keathbr
 PLOT SCALE = 164.7568' / in.
 PLOT DATE = 7/12/2013

| | |
|------------|-----------|
| DESIGNED - | REVISED - |
| DRAWN - | REVISED - |
| CHECKED - | REVISED - |
| DATE - | REVISED - |

**STATE OF ILLINOIS
 DEPARTMENT OF TRANSPORTATION**

**CCTV CAMERA INSTALLATION
 US 24 & IL 9 (ORCHARD MINES)**

SCALE: SHEET NO. 12 OF 62 SHEETS STA. TO STA.

| | | | | |
|---------------------------|-------------|---------|--------------|-----------|
| F.A.P. RTE. | SECTION | COUNTY | TOTAL SHEETS | SHEET NO. |
| VAR | D4 ITS 2014 | VARIOUS | 22 | 15 |
| CONTRACT NO. 68B58 | | | | |
| ILLINOIS FED. AID PROJECT | | | | |



INSTALL 1" DIA. GALVS NIPPLE IN LIGHT POLE (COST INCLUDED IN CONDUIT)

CAT 5 ETHERNET CABLE 148 FT. (X2) (FOR CAMERA AND RADIO)

CON AT ST 1 GALVS 60.0 FT. (ATTACHED TO EX. UNISTRUTS)

POLE MT EQUIP CAB TB 1.0 EACH (BOTTOM OF THE CABINET MOUNTED 6 FT. FROM GROUND)

CON AT ST 1 GALVS 6.0 FT.

EX. LIGHT POLE CONCRETE BASE
CON AT ST 1 GALVS 40.0 FT. (TO EXISTING LIGHT POLE)

EX. CONDUITS TO CATWALK AND ACROSS BRIDGE

WEATHERHEAD (INCLUDED IN COST OF TYPE B SERVICE)

OVERHEAD SERVICE CABLE 75.0 FT (INCLUDED IN COST OF TYPE B SERVICE)

EX. UNISTRUT

EX. METAL CONDUIT SHIELD

SERV INSTALL TY B 1.0 EACH (25' WOOD POLE WITH SERVICE DROP FROM AMEREN TRANSFORMER)

CON AT ST 1 GALVS 25.0 FT.

EC C XLP USE 1C 10 98.0 FT. (X 3)

UNDRGRD C PVC 1 65.0 FT.

SCHEDULE OF QUANTITIES (SHEET 16)

| DESCRIPTION | UNIT | QUANTITY |
|---|------|----------|
| SERVICE INSTALLATION, TYPE B | EACH | 1 |
| UNDERGROUND CONDUIT, PVC, 1" DIA. | FOOT | 65.0 |
| CONDUIT ATTACHED TO STRUCTURE, 1" DIA., GALVS | FOOT | 131.0 |
| ELECTRIC CABLE IN CONDUIT, 600V (XLP-TYPE USE) 1/C NO. 10 | FOOT | 294.0 |
| POLE MOUNTED EQUIPMENT CABINET, TYPE B | EACH | 1.0 |
| CAT 5 ETHERNET CABLE | FOOT | 296.0 |

FILE NAME = 68B58 Final Plans.dgn

USER NAME = keathbr
PLOT SCALE = 1/4" = 10'-0"
PLOT DATE = 7/12/2013

DESIGNED -
DRAWN -
CHECKED -
DATE -

REVISED -
REVISED -
REVISED -
REVISED -

STATE OF ILLINOIS
DEPARTMENT OF TRANSPORTATION

CCTV CAMERA INSTALLATION
UNDER PEKIN BRIDGE (WEST END)
SCALE: SHEET NO. 13 OF 62 SHEETS STA. TO STA.

| F.A.P. RTE. | SECTION | COUNTY | TOTAL SHEETS | SHEET NO. |
|---------------------------|-------------|---------|--------------|-----------|
| | D4 ITS 2014 | VARIOUS | 22 | 16 |
| CONTRACT NO. 68B58 | | | | |
| ILLINOIS FED. AID PROJECT | | | | |

CCTV DOME CAM IP BASE
 1.0 EACH (ON LIGHT POLE)
 WIRELESS RADIO (IO)
 0.5 L SUM (ON LIGHT POLE)
 (MOUNT AT 35 FT. HEIGHT AND
 AIM TOWARDS US 24 & IL 9 RADIO)

EX. CONDUIT ATTACHED TO STRUCTURE
 AND CATWALK ACROSS PEKIN BRIDGE

2265' EX.

130' PROP.

315' EX.

75' EX.

7' EX.

49' EX.

SCHEDULE OF QUANTITIES (SHEET 17)

| | | |
|---|-------|--------|
| CLOSED CIRCUIT TELEVISION DOME CAMERA, IP BASED | EACH | 1.0 |
| WIRELESS RADIO LINK (INSTALL ONLY) | L SUM | 0.5 |
| FIBER OPTIC CABLE 48 FIBERS, SINGLE MODE | FOOT | 2954.0 |

| | | | |
|-----------------------------------|------------------------------|------------|-----------|
| FILE NAME = 68B58 Final Plans.dgn | USER NAME = keathbr | DESIGNED - | REVISED - |
| | | DRAWN - | REVISED - |
| | PLOT SCALE = 164.7568' / in. | CHECKED - | REVISED - |
| | PLOT DATE = 7/12/2013 | DATE - | REVISED - |

**STATE OF ILLINOIS
 DEPARTMENT OF TRANSPORTATION**

**CCTV CAMERA INSTALLATION
 IL 9 AT PEKIN BRIDGE**

SCALE: SHEET NO. 14 OF 62 SHEETS STA. TO STA.

| | | | | |
|---------------------------|-------------|---------|--------------|-----------|
| F.A.P. RTE. | SECTION | COUNTY | TOTAL SHEETS | SHEET NO. |
| VAR | D4 ITS 2014 | VARIOUS | 22 | 17 |
| CONTRACT NO. 68B58 | | | | |
| ILLINOIS FED. AID PROJECT | | | | |



SCHEDULE OF QUANTITIES (SHEET 18)

| | | |
|-----------------------------------|------|-------|
| UNDERGROUND CONDUIT, PVC, 2" DIA. | FOOT | 130.0 |
| DRILL EXISTING HANDHOLE | EACH | 2.0 |

FILE NAME = 68B58 Final Plans.dgn

USER NAME = kesthbr
 PLOT SCALE = 1/4" = 100'
 PLOT DATE = 7/12/2013

DESIGNED -
 DRAWN -
 CHECKED -
 DATE -

REVISED -
 REVISED -
 REVISED -
 REVISED -

**STATE OF ILLINOIS
 DEPARTMENT OF TRANSPORTATION**

**CCTV CAMERA INSTALLATION
 UNDER PEKIN BRIDGE (EAST END)**

SCALE: SHEET NO. 15 OF 62 SHEETS STA. TO STA.

| | | | | |
|---------------------------|-------------|---------|--------------|-----------|
| F.A.P. RTE. | SECTION | COUNTY | TOTAL SHEETS | SHEET NO. |
| VAR | D4 ITS 2014 | VARIOUS | 22 | 18 |
| CONTRACT NO. 68B58 | | | | |
| ILLINOIS FED. AID PROJECT | | | | |



SCHEDULE OF QUANTITIES (SHEET 19)

| | | |
|---|------|------|
| CAT 5 ETHERNET CABLE | FOOT | 83.0 |
| CLOSED-CIRCUIT TELEVISION DOME CAMERA, IP BASED | EACH | 1.0 |

| | | | |
|-----------------------------------|-------------------------|------------|-----------|
| FILE NAME = 68B58 Final Plans.dgn | USER NAME = keathbr | DESIGNED - | REVISED - |
| | | DRAWN - | REVISED - |
| | PLOT SCALE = 1/4" = 10' | CHECKED - | REVISED - |
| | PLOT DATE = 7/12/2013 | DATE - | REVISED - |

**STATE OF ILLINOIS
DEPARTMENT OF TRANSPORTATION**

**FIBER OPTIC CONDUIT AND CABLE PROJECT
I-74 (FROM WOODHULL TO MOLINE) CONTINUED**

SCALE: SHEET NO. 16 OF 62 SHEETS STA. TO STA.

| | | | | |
|---------------------------|-------------|---------|--------------|-----------|
| F.A.P. RTE. | SECTION | COUNTY | TOTAL SHEETS | SHEET NO. |
| VAR | D4 ITS 2014 | VARIOUS | 22 | 19 |
| CONTRACT NO. 68B58 | | | | |
| ILLINOIS FED. AID PROJECT | | | | |

FIBER OPTIC CABLE TERMINATION NOTES (SINGLE MODE CABLE)

1. THE PROPOSED FIBER OPTIC CABLE SHALL BE TERMINATED AS SHOWN ON THE FIBER OPTIC LINE/TERMINATION DIAGRAM WITH ST CONNECTORS.
2. ALL CABLE SPLICES AND TERMINATIONS SHALL BE FUSION SPLICED.
3. THE CONTRACTOR SHALL FURNISH AND INSTALL ALL ITEMS REQUIRED FOR FIBER OPTIC CABLE TERMINATION, INCLUDING, BUT NOT LIMITED TO, BREAKOUT KITS, FANOUT KITS, ENCLOSURES, WEATHERPROOF SPLICE BOOTS, SPLICE SLEEVES, CONNECTORS, INTERCONNECT CENTERS, ETC.
4. ALL ST CONNECTORS SHALL BE FUSION SPLICED UTILIZING PRE-FORMED CABLES WITH CONNECTORS THAT ARE FUSION SPLICED TO THE PROPOSED FIBER.
5. ALL LABOR, MATERIALS, AND EQUIPMENT REQUIRED TO COMPLY WITH THESE REQUIREMENTS SHALL BE INCLUDED IN THE BID PRICE FOR THE PROPOSED FIBER OPTIC CABLE. THERE WILL BE NO ADDITIONAL COMPENSATION FOR THIS WORK.

PROPOSED FIBER OPTIC TERMINATION (48 SINGLE MODE) FROM EXISTING TRAFFIC SIGNAL CABINET LOCATED AT IL 9/29 (SECOND) & MARGARET TO PROPOSED EQUIPMENT CABINET ON WEST SIDE OF PEKIN BRIDGE

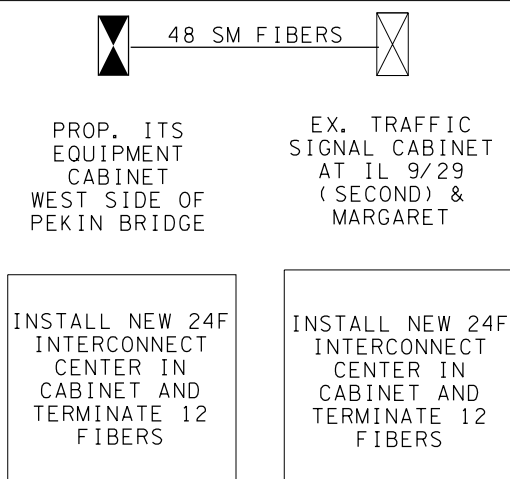

PROPOSED FIBER OPTIC TERMINATION (12 SINGLE MODE) FROM EXISTING TRAFFIC SIGNAL CABINET LOCATED AT STERLING AVE & I-74 WB RAMPS TO EXISTING TRAFFIC COUNTER CABINET LOCATED ALONG I-74 WB EXIT RAMP

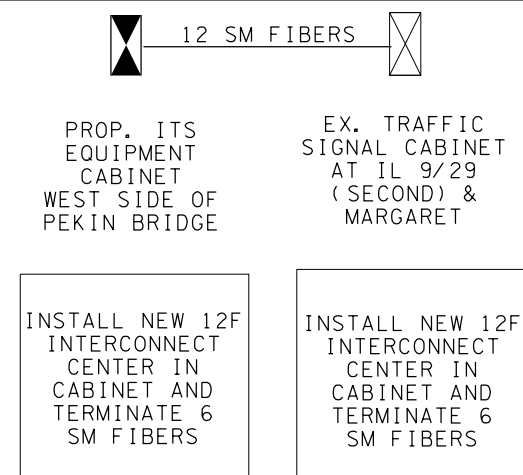

FILE NAME = 68B58 Final Plans.dgn

USER NAME = keithbr

DESIGNED -

REVISED -

DRAWN -

REVISED -

PLOT SCALE = 1/4" = 1'-0"

CHECKED -

REVISED -

PLOT DATE = 7/12/2013

DATE -

REVISED -

**STATE OF ILLINOIS
DEPARTMENT OF TRANSPORTATION**

FIBER OPTIC CABLE TERMINATION NOTES AND DIAGRAM

SCALE:

SHEET NO. 17 OF 62 SHEETS

STA.

TO STA.

F.A.P. RTE.

SECTION

COUNTY

TOTAL SHEETS

SHEET NO.

VAR

D4 ITS 2014

VARIOUS

22

20

CONTRACT NO. 68B58

ILLINOIS FED. AID PROJECT

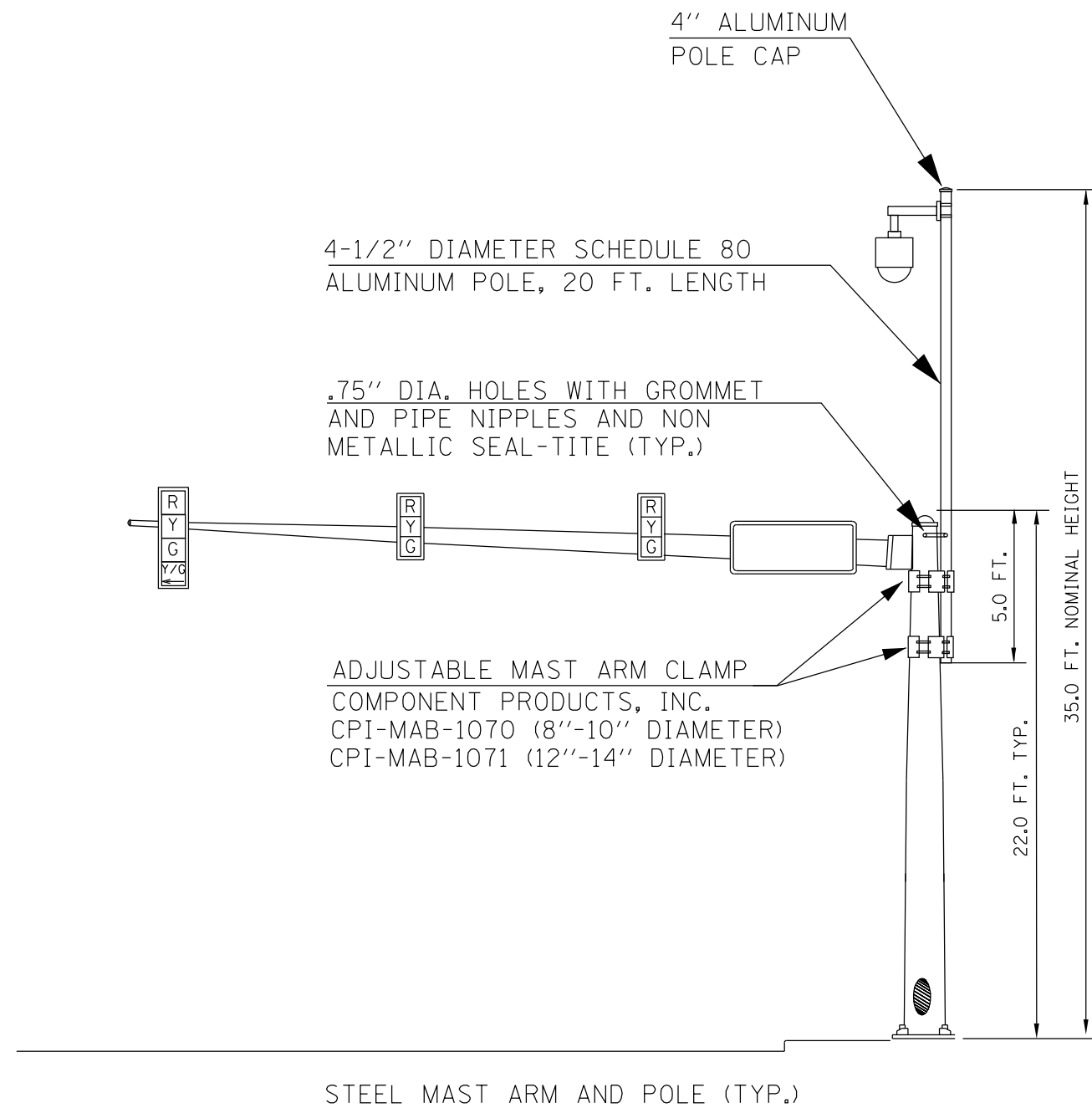

ADJUSTABLE MAST ARM CLAMP
 COMPONENT PRODUCTS, INC.
 CPI-MAB-1070 (8"-10" DIAMETER)

ADJUSTABLE MAST ARM CLAMP
 COMPONENT PRODUCTS, INC.
 CPI-MAB-1071 (12"-14" DIAMETER)

| | | | | | | | | | | | |
|--------------------------------------|---------------------------|------------|-----------|---|----------------------------------|---------------------------|----------------|-------------|--------------------|-----------------|--------------|
| FILE NAME = 68B58 Final Plans.dgn | USER NAME = keithbr | DESIGNED - | REVISED - | STATE OF ILLINOIS DEPARTMENT OF TRANSPORTATION | MAST ARM EXTENSION DETAIL | | F.A.P. RTE. | SECTION | COUNTY | TOTAL SHEETS | SHEET NO. |
| | PLOT SCALE = 1/4" = 1'-0" | DRAWN - | REVISED - | | | | VAR | D4 ITS 2014 | VARIOUS | 22 | 21 |
| PLOT DATE = 7/12/2013 | CHECKED - | REVISED - | REVISED - | SCALE: | | SHEET NO. 18 OF 62 SHEETS | STA. | TO STA. | CONTRACT NO. 68B58 | | |
| | DATE - | REVISED - | REVISED - | ILLINOIS FED. AID PROJECT | | | | | | | |

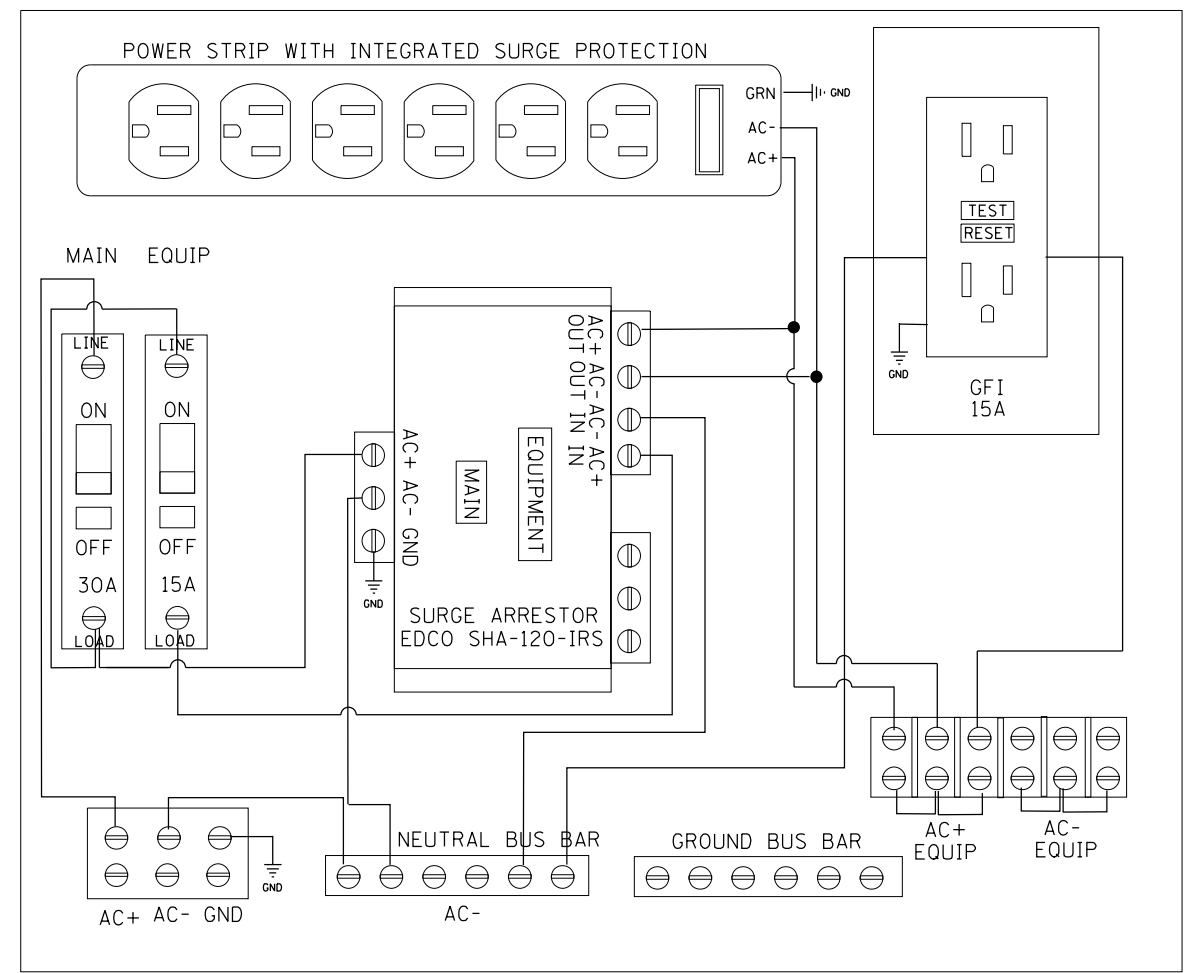
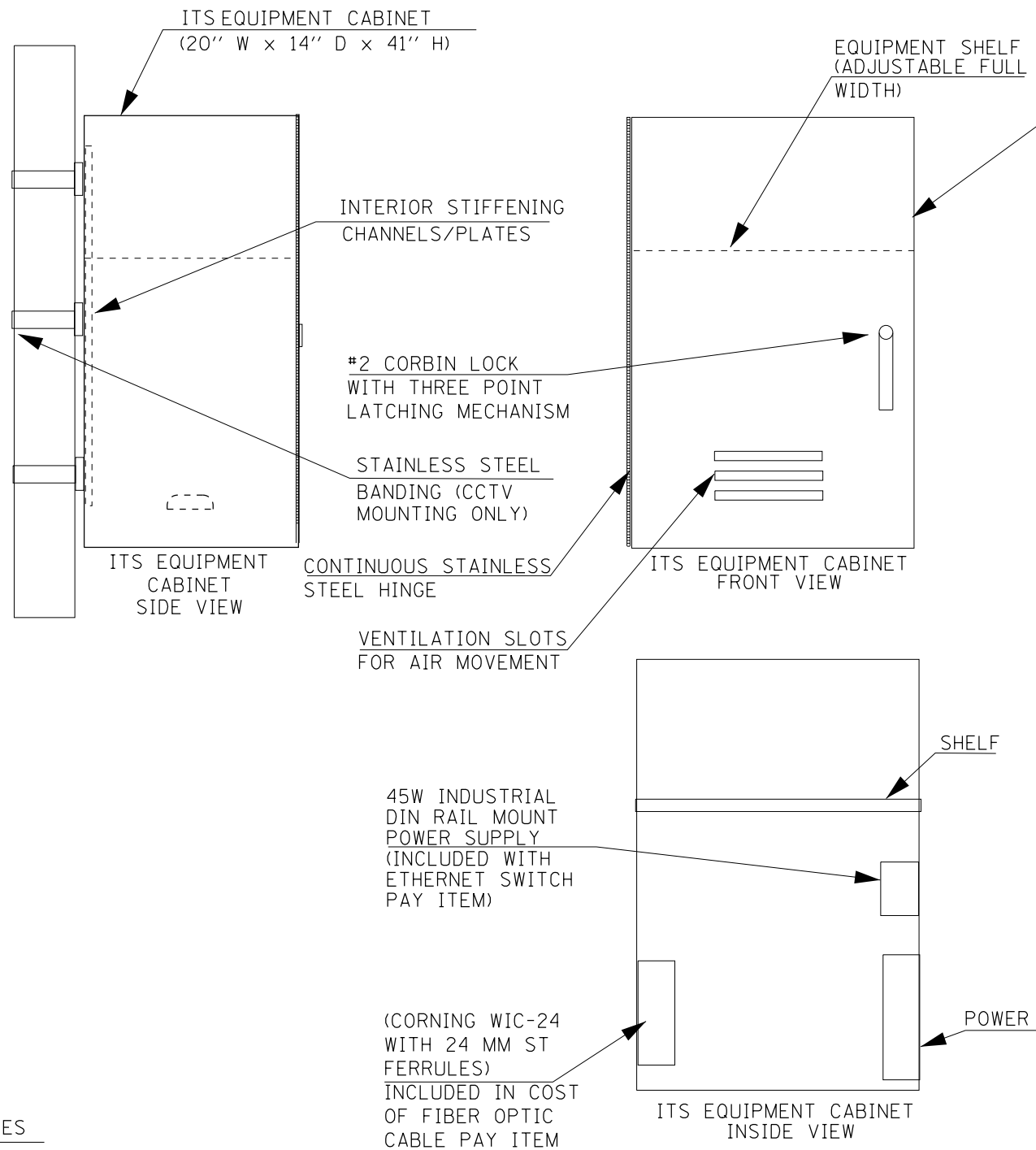

ITS EQUIPMENT CABINET POWER PANEL DETAIL
(POWER PANEL TO BE EQUIPPED WITH PLEXI-GLASS SAFETY SHIELD)

NOTES

1. THE ITS EQUIPMENT CABINET SHALL BE A NEMA TYPE 3R CABINET WITH MINIMUM OUTSIDE DIMENSIONS OF 34" (H) X 20" (W) X 14" (D). THE CABINET SHALL BE CONSTRUCTED FROM .125" THICK ALUMINUM AND HAVE A NATURAL FINISH.
2. THE CABINET SHALL BE FURNISHED WITH ONE ADJUSTABLE HEIGHT SHELF, THREE POSITION DOOR STOP (90, 120, 180 DEGREES), NEOPRENE DOOR GASKET, AIR VENT LOUVERS, CONTINUOUS STAINLESS STEEL DOOR HINGE, INTERIOR STIFFENERS FOR MOUNTING, THREE POINT LATCHING MECHANISM WITH #2 CORBIN LOCK, POWER PANEL, AND ALL STAINLESS STEEL HARDWARE.
3. THE CABINET SHALL BE EQUIPPED WITH A THERMOSTATICALLY CONTROLLER VENTILATION FAN AND DELUXE PLEATED AIR FILTER.
4. THE CONTRACTOR SHALL INSTALL ALL DIN RAIL MOUNTED EQUIPMENT (ETHERNET SWITCH AND POWER SUPPLY) IN THE CABINET.

| | | | | | | | | | | | |
|--------------------------------------|---------------------------|------------|-----------|---|--|--------------------|-------------|-------------|---------|--------------|-----------|
| FILE NAME = 68B58 Final Plans.dgn | USER NAME = keathbr | DESIGNED - | REVISED - | STATE OF ILLINOIS DEPARTMENT OF TRANSPORTATION | POLE MOUNTED EQUIPMENT CABINET, TYPE B DETAIL | | F.A.P. RTE. | SECTION | COUNTY | TOTAL SHEETS | SHEET NO. |
| | PLOT SCALE = 1/4" = 1'-0" | DRAWN - | REVISED - | | | | VAR | D4 ITS 2014 | VARIOUS | 22 | 22 |
| PLOT DATE = 7/12/2013 | CHECKED - | DATE - | REVISED - | SCALE: SHEET NO. 19 OF 62 SHEETS STA. TO STA. | | CONTRACT NO. 68B58 | | | | | |
| ILLINOIS FED. AID PROJECT | | | | | | | | | | | |