

PLAN	SURVEYED	DATE
	PLOTTED	BY
	ALIGNED	CHECKED
	NOTE BOOK	NO.
	NO.	FILE NAME

PROFILE	SURVEYED	DATE
	PLOTTED	BY
	GRADES CHECKED	CHECKED
	STRUCTURE	NOTATIONS
	NO.	CHFD

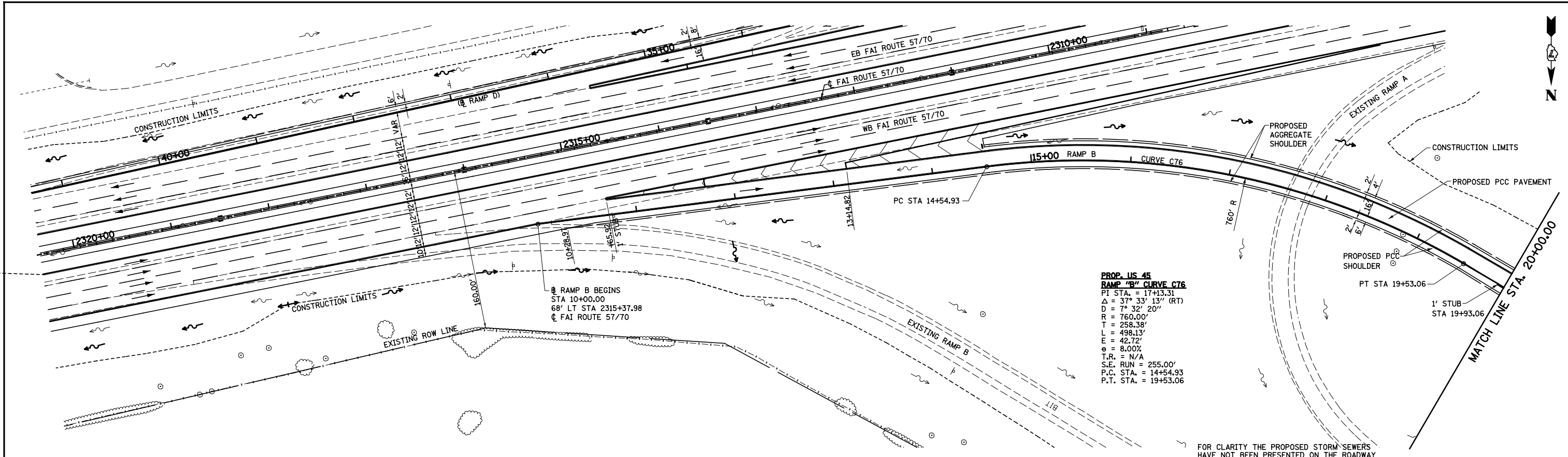

NOTE: STATIONING OF 57/70 IS REVERSED.

FOR CLARITY THE PROPOSED STORM SEWERS
 HAVE NOT BEEN PRESENTED ON THE ROADWAY
 PLAN AND PROFILE SHEETS. SEE DRAINAGE SHEETS
 FOR STORM SEWER INFORMATION

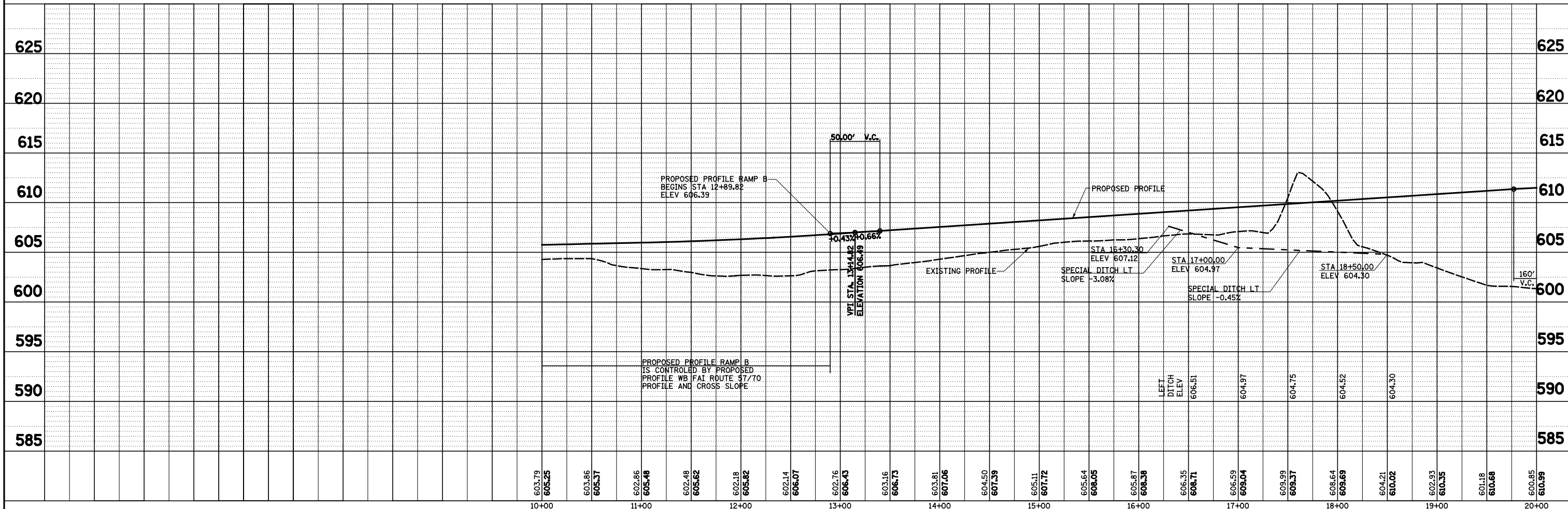
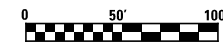

FILE NAME	USER NAME = *USER*	DESIGNED - JWS	REVISED -	STATE OF ILLINOIS DEPARTMENT OF TRANSPORTATION	PLAN AND PROFILE, US ROUTE 45 - RAMP B	F.A.I. RTE.	SECTION	COUNTY	TOTAL SHEETS	SHEET NO.	
S:\Projects\403-00072-57-70\ dgn\N Tr\lv\PP_Ntr1570.dgn	PLOT SCALE = *SCALE*	DRAWN - PDB	REVISED -			57/70	(25-4R)	EFFINGHAM	1760	120	
PLOT DATE = *DATE*	DATE - 6-5-08	CHECKED - BRM	REVISED -			CONTRACT NO. 74295					
		DATE - 6-5-08	REVISED -			SCALE: 1"=50'	SHEET NO. 5 OF 11 SHEETS	STA. 10+00.00 TO STA. 20+00.00	FED. ROAD DIST. NO. ILLINOIS FED. AID PROJECT		