

SECTION D-D • FOR PROFILE DETAILS, SEE SHEET 13 OF 14

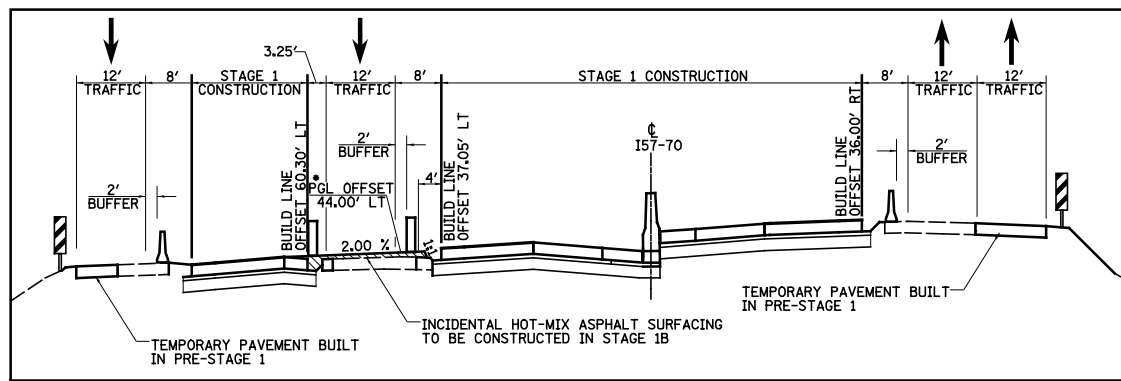
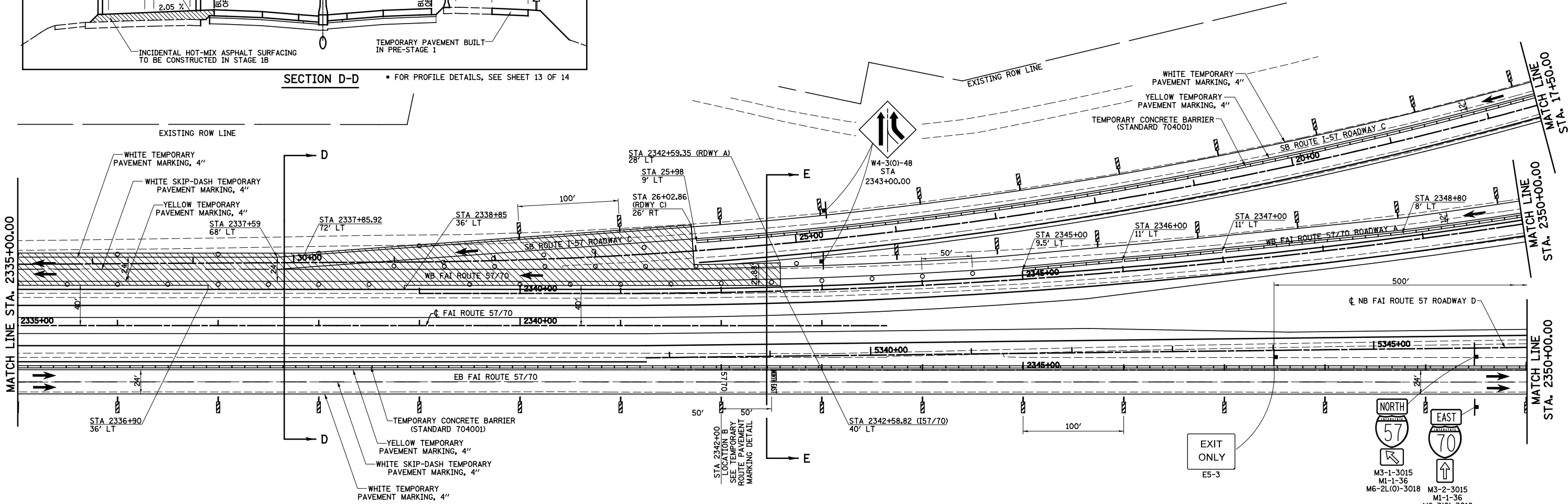

SECTION E-E • FOR PROFILE DETAILS, SEE SHEET 13 OF 14

- LEGEND**
- TEMPORARY PCC PAVEMENT
 - TEMPORARY HOT-MIX ASPHALT RAMP
 - CONSTRUCTION THIS STAGE
 - SIGN
 - DIRECTION OF TRAFFIC
 - DIRECTION INDICATOR BARRICADE WITH STEADY BURN MONODIRECTIONAL LIGHT
 - TYPE II BARRICADES OR DRUMS WITH MONO-DIRECTIONAL STEADY BURNING LIGHTS
 - VERTICAL PANEL
 - TEMPORARY WOOD POLE, 55 FEET, CLASS 4
 - TEMPORARY WOOD POLE, 55 FEET, CLASS 4 WITH 250W HPS LUMINAIRE, 45 FEET MOUNTING HEIGHT,
 - TYPE III BARRICADES
 - ARROW BOARD

EXISTING HIGH MAST TOWER USED FOR TEMPORARY LIGHTING AND THEN REMOVED

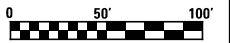

FILE NAME =
S:\Project\103\1007257-70.dgn\11 Trk\1\ext\5b.dgn

USER NAME = *USER*	DESIGNED - JWS	REVISED -
PLOT SCALE = *SCALE*	DRAWN - MAB	REVISED -
PLOT DATE = *DATE*	CHECKED - BRM	REVISED -
	DATE - 8-06-08	REVISED -

**STATE OF ILLINOIS
DEPARTMENT OF TRANSPORTATION**

MAINTENANCE OF TRAFFIC, STAGE 1B, NORTH TRI LEVEL
SCALE: 1"=50' SHEET NO. 8 OF 14 SHEETS STA. 2335+00.00 TO STA. 2350+00.00

F.A.I. RTE. 57/70	SECTION (25-4R)	COUNTY EFFINGHAM	TOTAL SHEETS 1760	SHEET NO. 199
FED. ROAD DIST. NO. ILLINOIS FED. AID PROJECT			CONTRACT NO. 74295	