

SECTION G-G

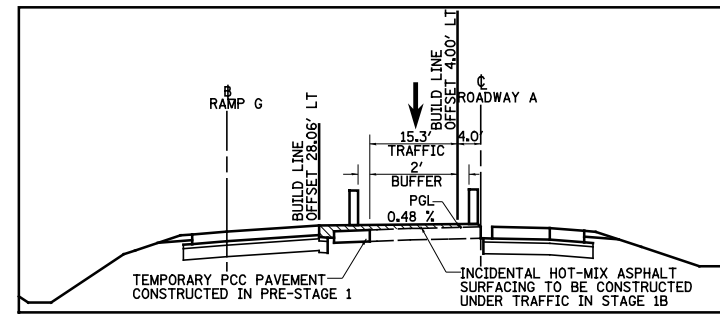

SECTION H-H

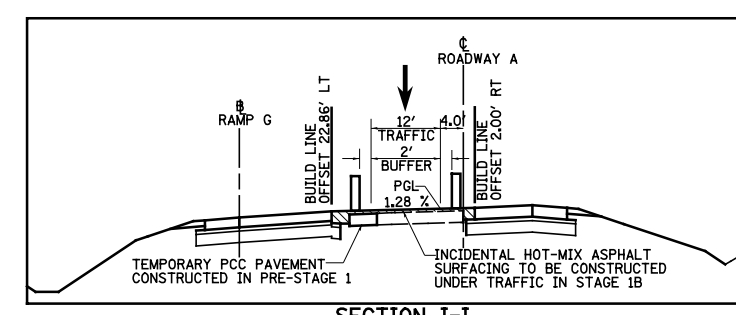

SECTION I-I

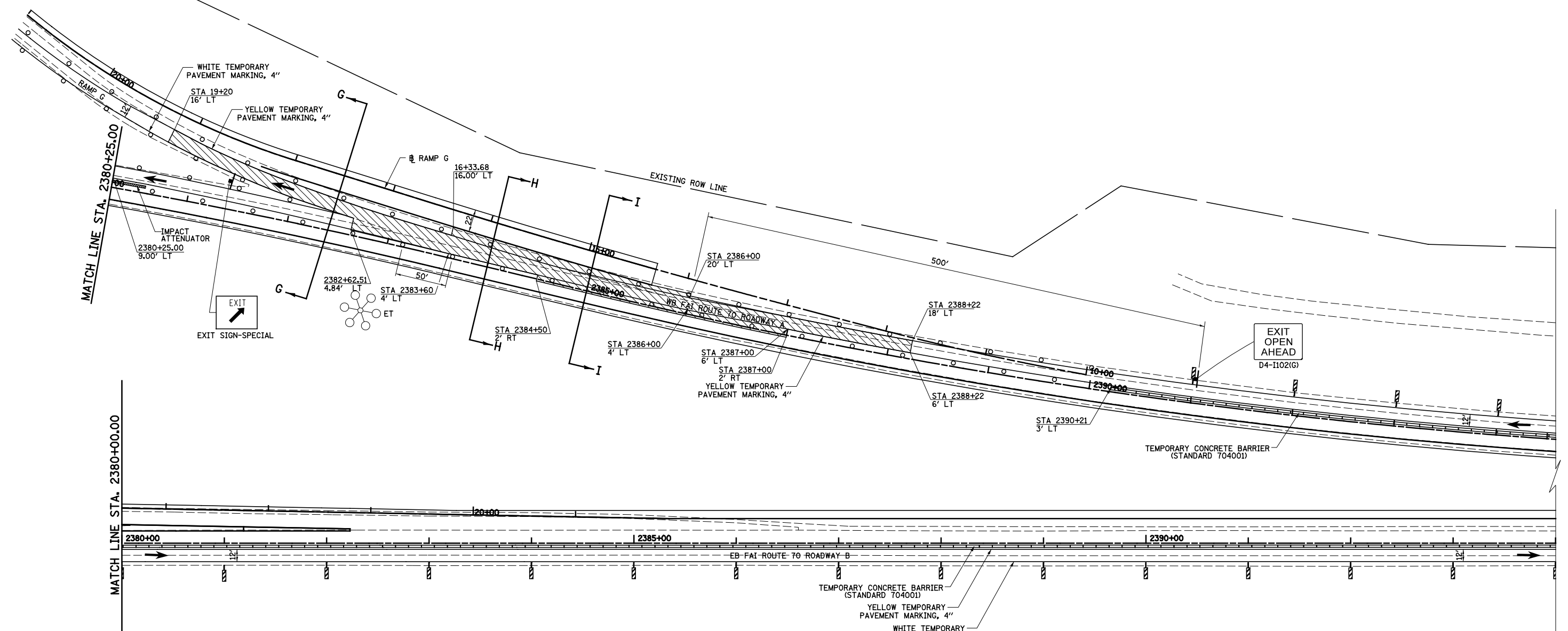

LEGEND

	TEMPORARY PCC PAVEMENT		TYPE II BARRICADES OR DRUMS WITH MONO-DIRECTIONAL STEADY BURNING LIGHTS
	TEMPORARY HOT-MIX ASPHALT RAMP		VERTICAL PANEL
	CONSTRUCTION THIS STAGE		TEMPORARY WOOD POLE, 55 FEET, CLASS 4
	SIGN		TEMPORARY WOOD POLE, 55 FEET, CLASS 4 WITH 250W HPS LUMINAIRE, 45 FEET MOUNTING HEIGHT,
	DIRECTION OF TRAFFIC		TYPE III BARRICADES
	DIRECTION INDICATOR BARRICADE WITH STEADY BURN MONODIRECTIONAL LIGHT		ARROW BOARD

EXISTING HIGH MAST TOWER USED FOR TEMPORARY LIGHTING AND THEN REMOVED

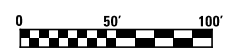

FILE NAME =	USER NAME = \$USER*	DESIGNED - JWS	REVISED -	STATE OF ILLINOIS DEPARTMENT OF TRANSPORTATION	MAINTENANCE OF TRAFFIC, STAGE 1B, NORTH TRI LEVEL		F.A.I. RTE.	SECTION	COUNTY	TOTAL SHEETS	SHEET NO.
st:\project\0007257\7d\p\15 Trk\1\p\15.st\p	PLOT SCALE = \$SCALE*	DRAWN - MAB	REVISED -				57/70	(25-4R)	EFFINGHAM	1760	202
	PLOT DATE = \$DATE*	CHECKED - BRM	REVISED -				CONTRACT NO. 74295				
		DATE - 3-04-08	REVISED -				SCALE: 1"=50'	SHEET NO. 11 OF 14 SHEETS	STA. 2380+00.00 TO STA. 2390+00.00	FED. ROAD DIST. NO.	ILLINOIS FED. AID PROJECT