

SECTION H-H

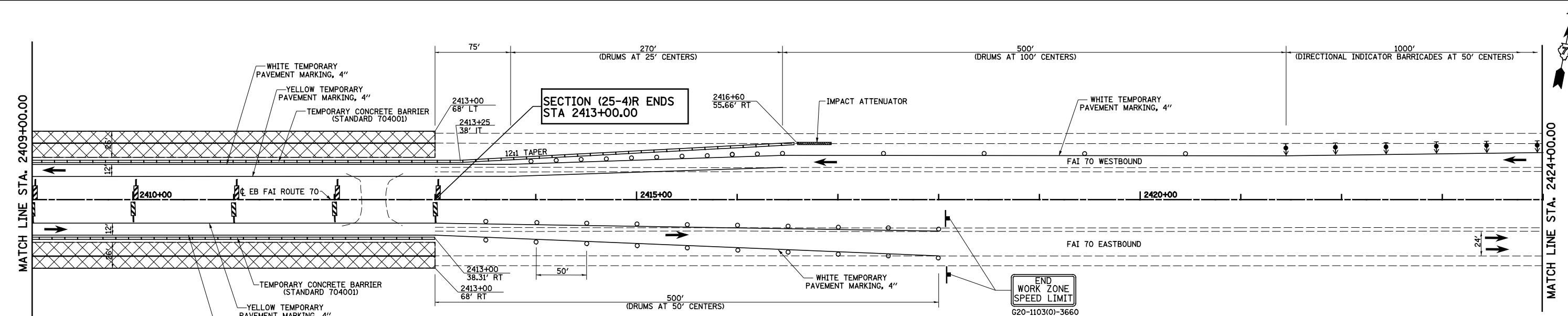

SECTION (25-4)R ENDS  
STA 2413+00.00

END  
WORK ZONE  
SPEED LIMIT  
G20-1103(0)-3660

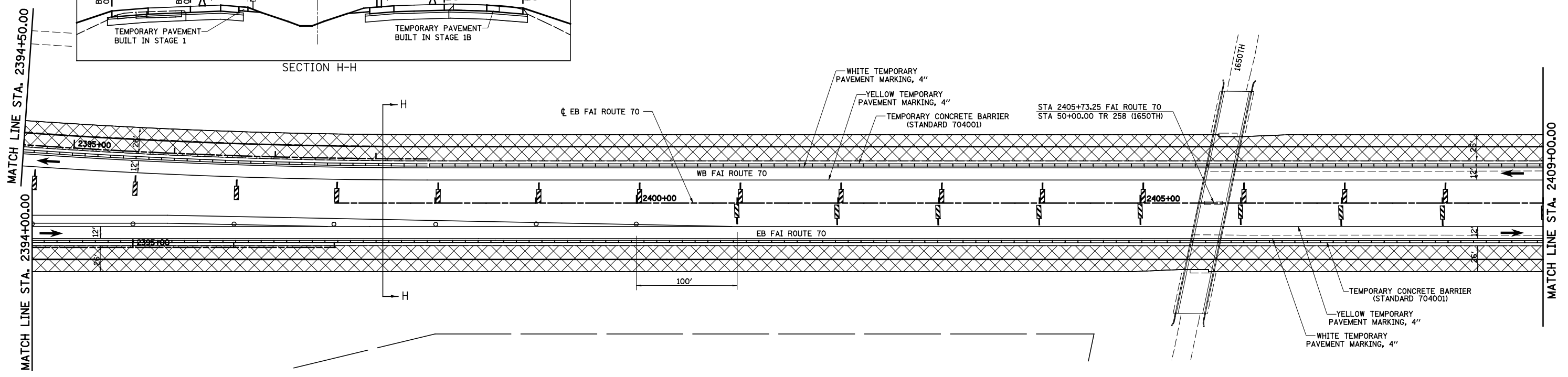

- LEGEND**
- TEMPORARY PCC PAVEMENT
  - TEMPORARY HOT-MIX ASPHALT RAMP
  - CONSTRUCTION THIS STAGE
  - SIGN
  - DIRECTION OF TRAFFIC
  - DIRECTION INDICATOR BARRICADE WITH STEADY BURN MONODIRECTIONAL LIGHT
  - TYPE II BARRICADES OR DRUMS WITH MONO-DIRECTIONAL STEADY BURNING LIGHTS
  - VERTICAL PANEL
  - TEMPORARY WOOD POLE, 55 FEET, CLASS 4
  - TEMPORARY WOOD POLE, 55 FEET, CLASS 4 WITH 250W HPS LUMINAIRE, 45 FEET MOUNTING HEIGHT,
  - TYPE III BARRICADES
  - ARROW BOARD

EXISTING HIGH MAST TOWER USED FOR TEMPORARY LIGHTING AND THEN REMOVED

FILE NAME =  
S:\Projects\403-00072-57-70\dm\W Tr\LV\m01\_s2.dgn

USER NAME = #USER#  
PLOT SCALE = #SCALE#  
PLOT DATE = #DATE#

DESIGNED - JWS  
DRAWN - MAB  
CHECKED - BRM  
DATE - 3-04-08

REVISED -  
REVISED -  
REVISED -  
REVISED -

STATE OF ILLINOIS  
DEPARTMENT OF TRANSPORTATION

MAINTENANCE OF TRAFFIC, STAGE 2, FAI ROUTE 70

SCALE: 1"=50' SHEET NO. 14 OF 20 SHEETS STA. 2394+00.00 TO STA. 2424+00.00

F.A.I. RTE.	SECTION	COUNTY	TOTAL SHEETS	SHEET NO.
57/70	(25-4)R	EFFINGHAM	1760	229
CONTRACT NO. 74295				
FED. ROAD DIST. NO. ILLINOIS FED. AID PROJECT				