

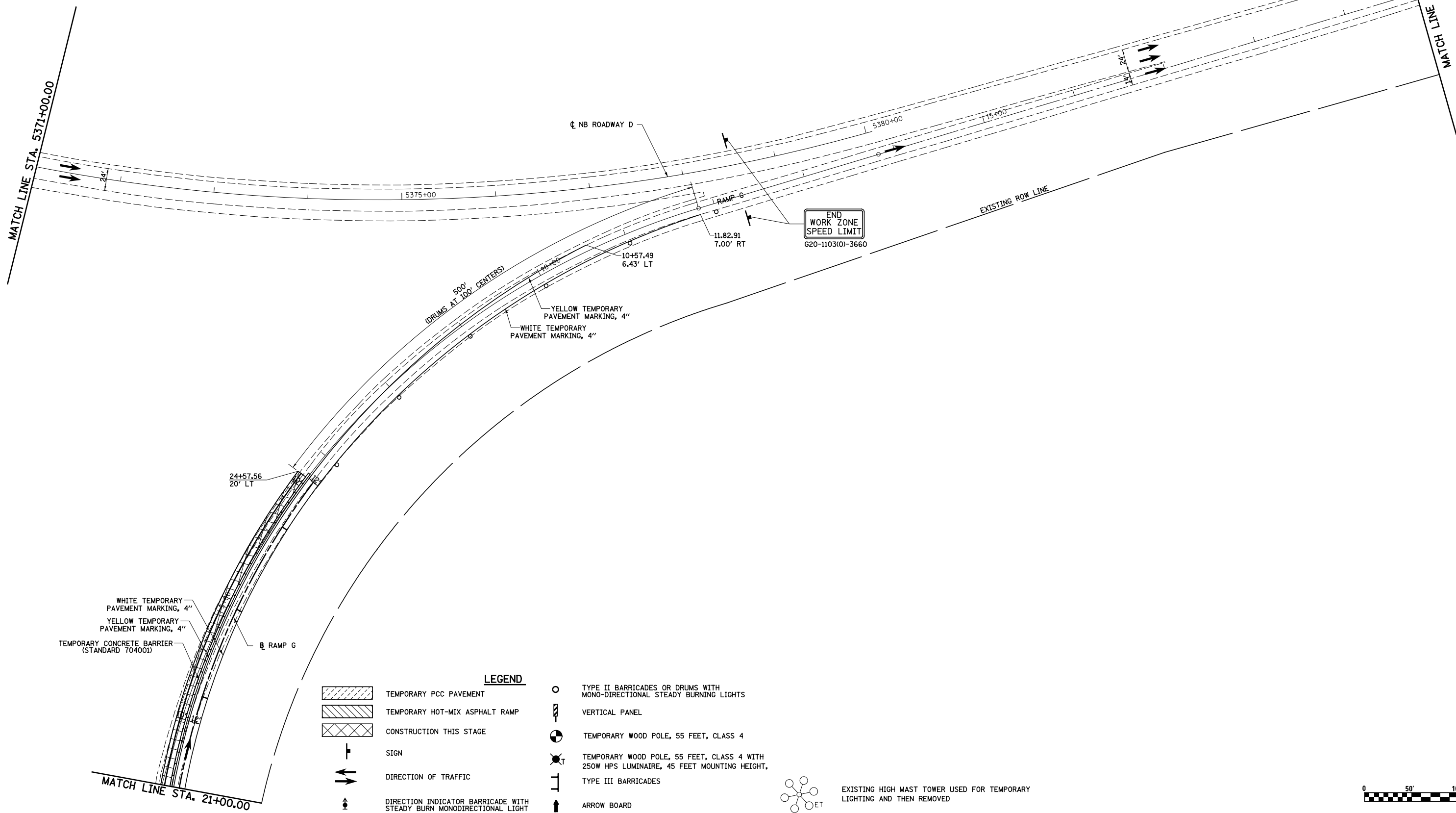

MATCH LINE STA. 5371+00.00

MATCH LINE STA. 5385+00.00



WHITE TEMPORARY PAVEMENT MARKING, 4"  
 YELLOW TEMPORARY PAVEMENT MARKING, 4"  
 TEMPORARY CONCRETE BARRIER (STANDARD 704001)

**LEGEND**

	TEMPORARY PCC PAVEMENT		TYPE II BARRICADES OR DRUMS WITH MONO-DIRECTIONAL STEADY BURNING LIGHTS
	TEMPORARY HOT-MIX ASPHALT RAMP		VERTICAL PANEL
	CONSTRUCTION THIS STAGE		TEMPORARY WOOD POLE, 55 FEET, CLASS 4
	SIGN		TEMPORARY WOOD POLE, 55 FEET, CLASS 4 WITH 250W HPS LUMINAIRE, 45 FEET MOUNTING HEIGHT,
	DIRECTION OF TRAFFIC		TYPE III BARRICADES
	DIRECTION INDICATOR BARRICADE WITH STEADY BURN MONODIRECTIONAL LIGHT		ARROW BOARD

EXISTING HIGH MAST TOWER USED FOR TEMPORARY LIGHTING AND THEN REMOVED

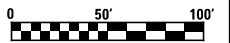

FILE NAME =	USER NAME = \$USER\$	DESIGNED - JWS	REVISED -
S:\Projects\403-00072-57-70\dgn\W Tr\ILV\mot_52.dgn		DRAWN - MAB	REVISED -
	PLOT SCALE = \$SCALE\$	CHECKED - BRM	REVISED -
	PLOT DATE = \$DATE\$	DATE - 3-04-08	REVISED -

**STATE OF ILLINOIS  
 DEPARTMENT OF TRANSPORTATION**

**MAINTENANCE OF TRAFFIC, STAGE 2, RAMP G NORTH TRI LEVEL**

SCALE: 1"=50'      SHEET NO. 17 OF 20 SHEETS      STA. 21+00.00 TO STA. 5386+00.00

F.A.I. RTE.	SECTION	COUNTY	TOTAL SHEETS	SHEET NO.
57/70	(25-4)R	EFFINGHAM	1760	232
CONTRACT NO. 74295				
FED. ROAD DIST. NO.	ILLINOIS FED. AID PROJECT			