

LEGEND

- EXISTING LIGHTING UNIT, TWIN
- PROPOSED LIGHTING UNIT, 45 FT ALUMINUM POLE, TWIN 8 FT DAVIT ARM, (2) 400W HPS LUMINAIRES, M-C-3
- PROPOSED LIGHTING UNIT, 50 FT ALUMINUM POLE, 15 FT DAVIT ARM, 400W HPS LUMINAIRE, M-C-3
- EXISTING LIGHTING CONTROLLER
- PROPOSED LIGHTING CONTROLLER
- SERVICE INSTALLATION
- COMBINATION LIGHTING UNIT, 45 FT MH, 15 FT MAST ARM, 400 HPS LUMINAIRE, PHOTO-CELL CONTROL, M-C-3
- PROPOSED LIGHTING UNIT, 50 FT ALUMINUM POLE, TWIN 15 FT DAVIT ARM, (2) 400W HPS LUMINAIRES, M-C-3
- JUNCTION BOX, STAINLESS STEEL, ATTACHED TO STRUCTURE OR EMBEDDED IN STRUCTURE, SIZE AS NOTED
- PROPOSED UNIT DUCT, SIZE AS NOTED
- PROPOSED ELECTRIC CABLE IN CONDUIT, SIZE AS NOTED
- PROPOSED UNDERGROUND COILABLE NON-METALLIC CONDUIT, SIZE AS NOTED
- EXISTING UNIT DUCT OR CABLE IN CONDUIT

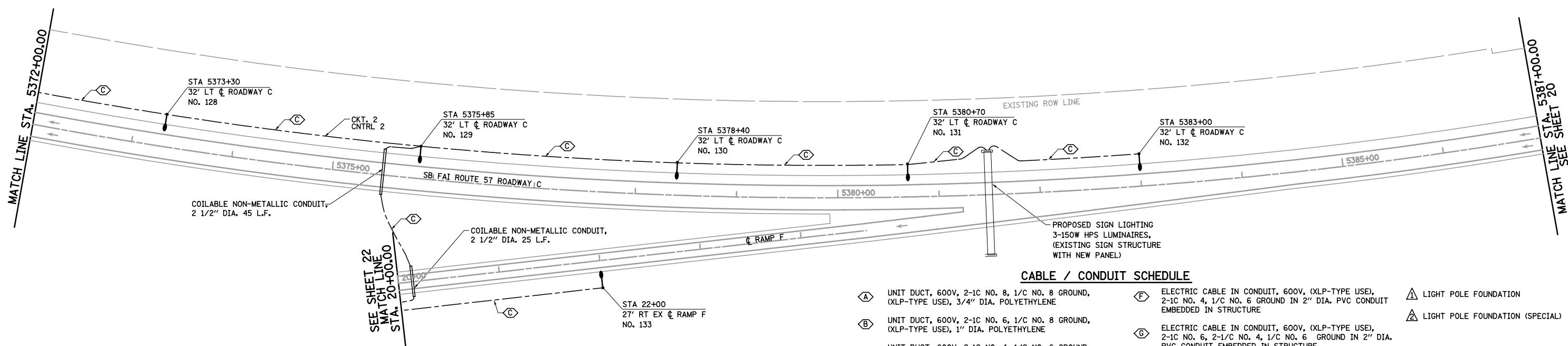
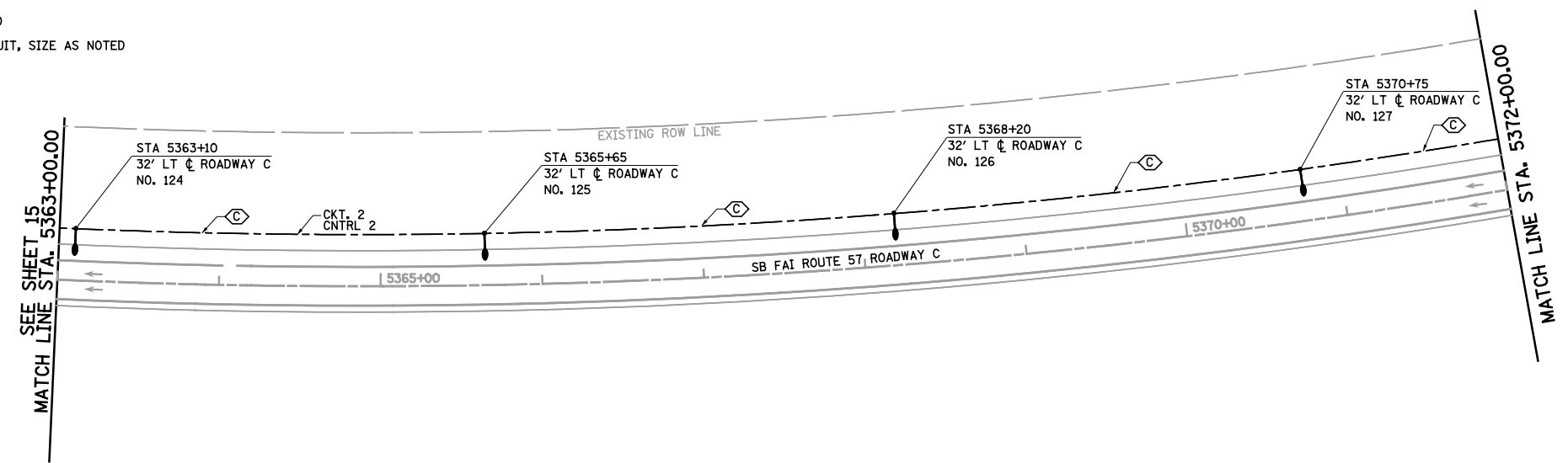

COILABLE NON-METALLIC CONDUIT,
2 1/2" DIA. 45 L.F.

COILABLE NON-METALLIC CONDUIT,
2 1/2" DIA. 25 L.F.

PROPOSED SIGN LIGHTING
3-150W HPS LUMINAIRES,
(EXISTING SIGN STRUCTURE
WITH NEW PANEL)

CABLE / CONDUIT SCHEDULE

- (A)** UNIT DUCT, 600V, 2-1C NO. 8, 1/C NO. 8 GROUND, (XLP-TYPE USE), 3/4" DIA. POLYETHYLENE
- (B)** UNIT DUCT, 600V, 2-1C NO. 6, 1/C NO. 8 GROUND, (XLP-TYPE USE), 1" DIA. POLYETHYLENE
- (C)** UNIT DUCT, 600V, 2-1C NO. 4, 1/C NO. 6 GROUND, (XLP-TYPE USE), 1" DIA. POLYETHYLENE
- (D)** ELECTRIC CABLE IN CONDUIT, 600V, (XLP-TYPE USE), 2-1C NO. 8, 1/C NO. 8 GROUND IN 2" DIA. PVC CONDUIT EMBEDDED IN STRUCTURE
- (E)** ELECTRIC CABLE IN CONDUIT, 600V, (XLP-TYPE USE), 2-1C NO. 6, 1/C NO. 8 GROUND IN 2" DIA. PVC CONDUIT EMBEDDED IN STRUCTURE
- (F)** ELECTRIC CABLE IN CONDUIT, 600V, (XLP-TYPE USE), 2-1C NO. 4, 1/C NO. 6 GROUND IN 2" DIA. PVC CONDUIT EMBEDDED IN STRUCTURE
- (G)** ELECTRIC CABLE IN CONDUIT, 600V, (XLP-TYPE USE), 2-1C NO. 6, 2-1/C NO. 4, 1/C NO. 6 GROUND IN 2" DIA. PVC CONDUIT EMBEDDED IN STRUCTURE
- (H)** UNIT DUCT, 600V, 2-1C NO. 2, 1/C NO. 4 GROUND, (XLP-TYPE USE), 1 1/4" DIA. POLYETHYLENE
- (I)** LIGHT POLE FOUNDATION
- (J)** LIGHT POLE FOUNDATION (SPECIAL)

FILE NAME =	USER NAME = *USER*	DESIGNED - JWS	REVISED -	STATE OF ILLINOIS DEPARTMENT OF TRANSPORTATION	PROPOSED LIGHTING, ROADWAY C NORTH TRI LEVEL			F.A.I. RTE.	SECTION	COUNTY	TOTAL SHEETS	SHEET NO.
st:\project\00072.57-70\p1\05 Trk\l\p1mk.st\p1		DRAWN - PDB	REVISED -		SCALE: 1"=50'	SHEET NO. 23 OF 35 SHEETS	STA. 5363+00.00 TO STA. 5387+00.00	57/70	(25-4R)	EFFINGHAM	1760	470
		CHECKED - BRM	REVISED -					CONTRACT NO. 74295				
		DATE - 11-02-12	REVISED -					FED. ROAD DIST. NO. ILLINOIS FED. AID PROJECT				