

SECTION THRU HEADWALL

D.H.W. Elev. 580.12

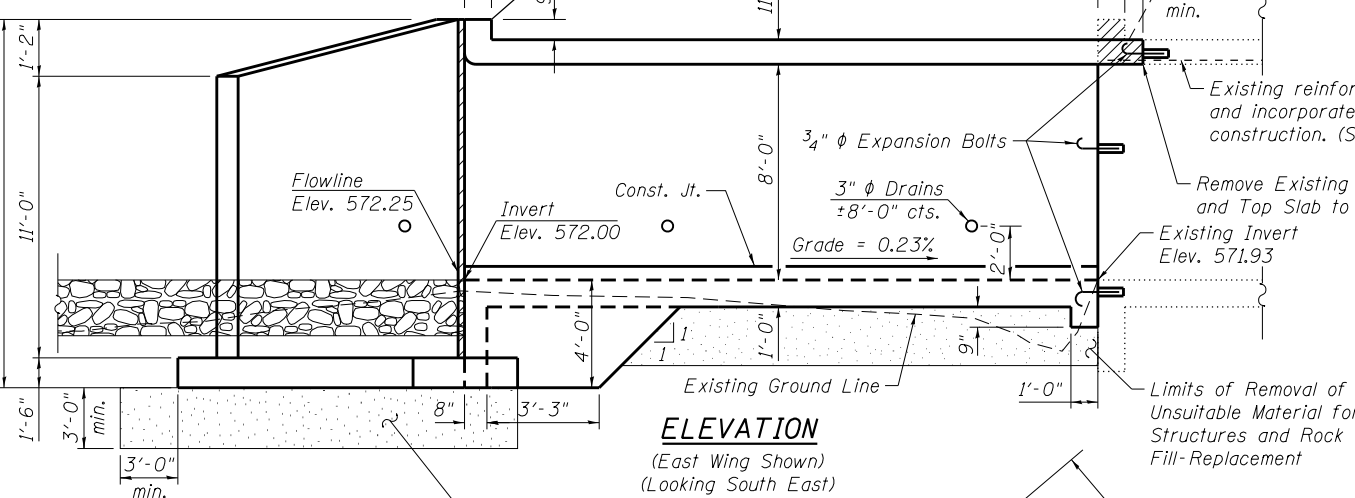

ELEVATION
(East Wing Shown)
(Looking South East)

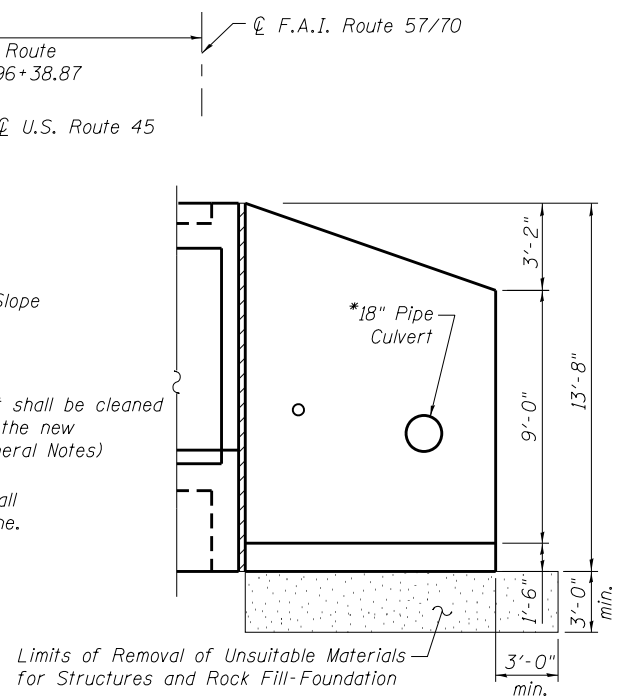

VIEW A-A
(West Wing)

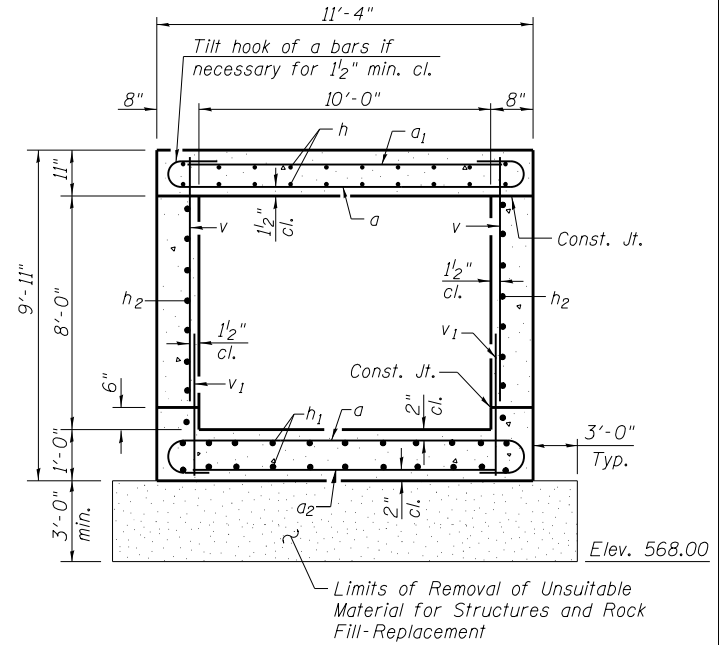

SECTION THRU BARREL

Max. Soil Pressure Under Barrel = 2620 psf

NORTH EXTENSION
BILL OF MATERIAL

Bar	No.	Size	Length	Shape
a	123	#8	12'-10"	U
a1	22	#5	11'-0"	—
a2	17	#4	11'-0"	—
d	21	#4	5'-6"	L
h	26	#6	31'-0"	—
h1	26	#6	29'-3"	—
h2	18	#4	29'-3"	—
h3	11	#6	11'-0"	—
h4	22	#4	16'-5"	—
h5	17	#4	9'-11"	—
h6	5	#4	10'-4"	—
n(E)	46	#8	9'-1"	U
s	12	#4	4'-11"	□
s1	12	#4	5'-3"	□
t	8	#4	2'-2"	—
t1	54	#5	6'-8"	—
t2	26	#4	6'-8"	—
v	102	#5	8'-1"	—
v1	102	#5	3'-2"	—
v2	4	#5	8'-10"	—
v3	4	#5	6'-2"	—
v4	18	#4	22'-6"	—
v5	10	#4	20'-6"	—
w	12	#5	16'-5"	—
w1	12	#5	9'-11"	—
Removal and Disposal of Unsuitable Material for Structures			Cu. Yd.	102.9
Concrete Removal			Cu. Yd.	21.1
Rock Fill-Replacement			Ton	74.5
Reinforcement Bars			Pound	10530
Reinforcement Bars, Epoxy Coated			Pound	1120
Expansion Bolts 3/4 Inch			Each	22
Concrete Box Culverts			Cu. Yd.	60.4
Rock-Fill Foundation			Ton	64.4

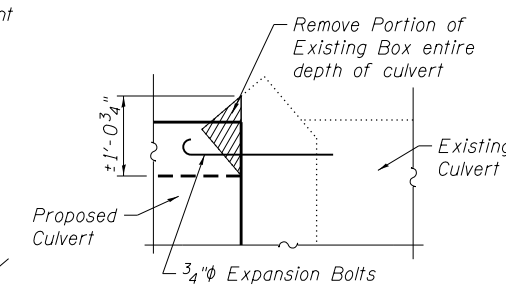

DETAIL A
(West Side Similar)

SECTION THRU EXISTING
WING WALLS

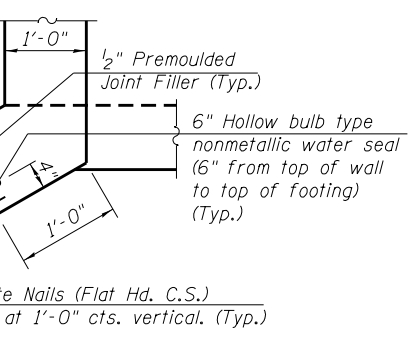

CORNER DETAILS

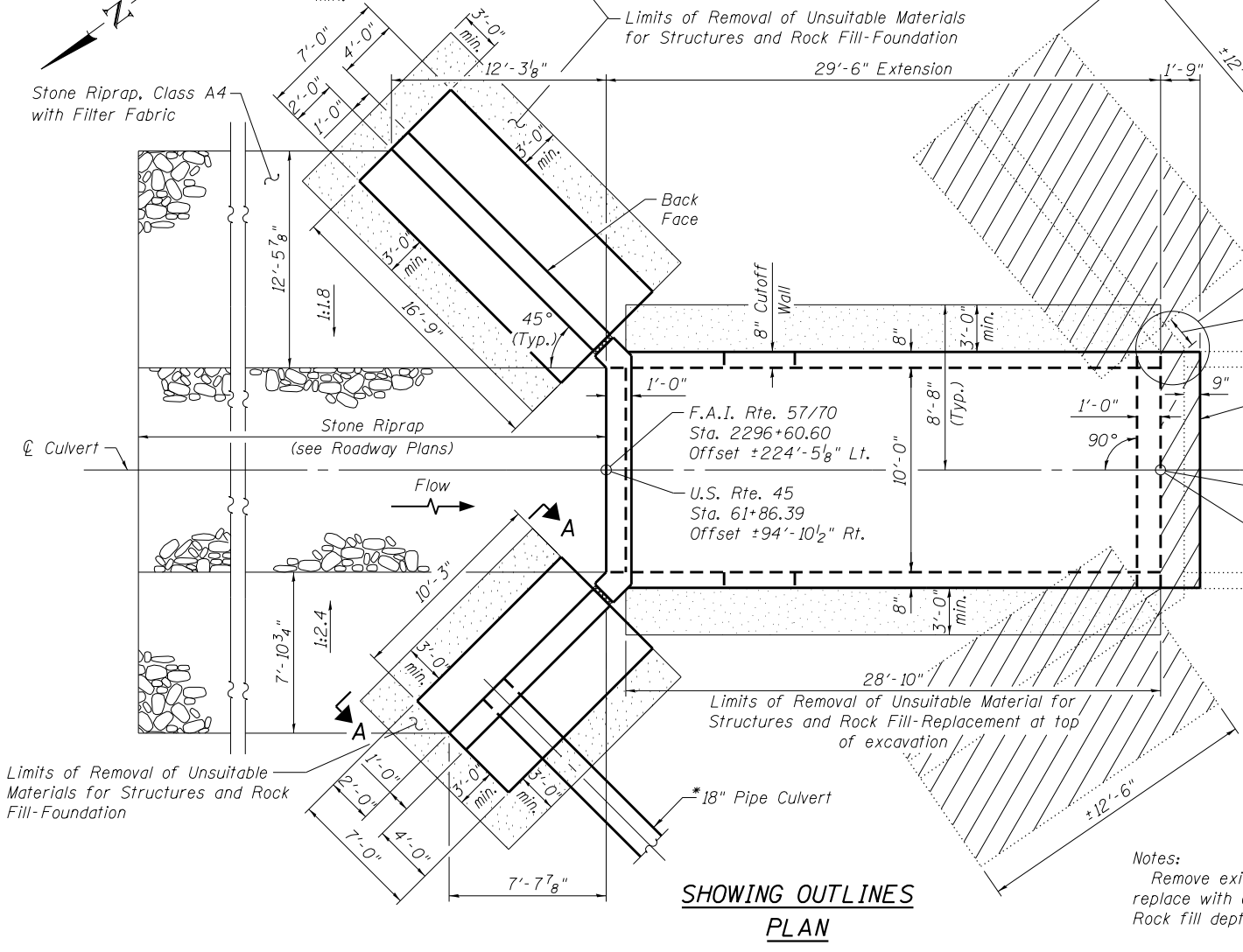

SHOWING OUTLINES
PLAN

Notes:
Remove existing unsuitable material under the culvert as shown and replace with one foot of crushed limestone above two feet of rock fill. Rock fill depth may increase during construction.

Indicates Concrete Removal

S:\Projects\403\0002_5770\Bridges\Bridges\0258648-74295-004-N_Ext Dis Outlines.dwg

FILE NAME = 0258648-74295-004-N Ext Dis
DESIGNED - ACS
CHECKED - BB
DRAWN - WJS
CHECKED - CJF

DESIGNED - ACS
CHECKED - BB
DRAWN - WJS
CHECKED - CJF

DESIGNED - ACS
CHECKED - BB
DRAWN - WJS
CHECKED - CJF

DESIGNED - ACS
CHECKED - BB
DRAWN - WJS
CHECKED - CJF

STATE OF ILLINOIS
DEPARTMENT OF TRANSPORTATION

NORTH EXTENSION DETAILS
STRUCTURE NO. 025-8648
SHEET NO. 4 OF 12 SHEETS

F.A.I. R.T.E. 57/70
SECTION (25-4HV-B-1)BY
COUNTY EFFINGHAM
TOTAL SHEETS 1760
SHEET NO. 523
CONTRACT NO. 74295
ILLINOIS FED. AID PROJECT